

QUICK START GUIDE

1. Remove the food tank cover.

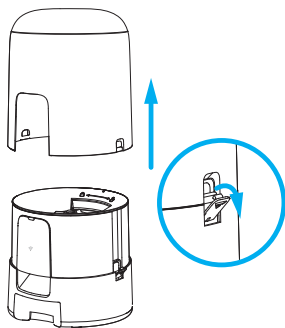

2. Take out the food bowl, power adapter, power cable, user manual, and other accessories.

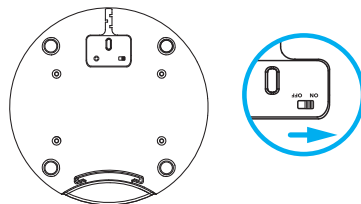

3. Connect the power cable. (Use the feeder wirelessly after fully charging its battery.)

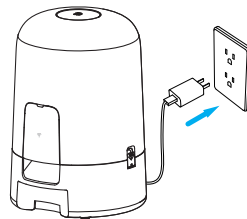

4. Toggle the power switch to "ON" to turn on the feeder.

5. Remove the lid and add dry pet food.

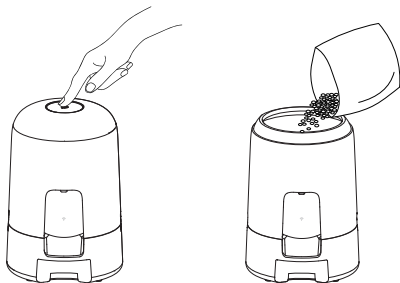

6. Install the stainless steel bowl and bowl tray.

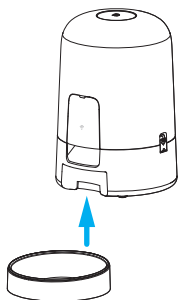

7. Scan the QR code to download and install the PETLIBRO app, and follow the instructions to configure the network.



8. Set a feeding schedule in the app.

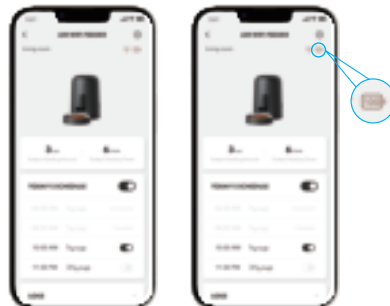

Reminder: Before first use, please charge until the battery icon is full to obtain longer battery life.