

Pairing

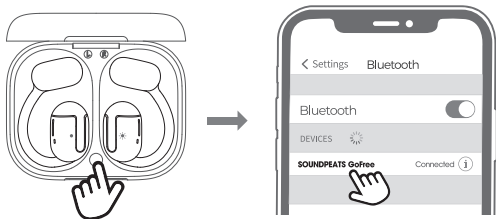

1. Open the charging case cover, take out the earbuds and remove the insulating film on them, then put the two earbuds back into the charging case. Press and hold the button inside the charging box for 3 seconds until the indicator light flashes white. At this time, the indicator light on one earbud flashes red and white alternately, the indicator light on another earbud stays white, and then two earbuds enter the pairing state.
2. Turn on your device's Bluetooth and select SOUNDPEATS GoFree from the Bluetooth list to complete the pairing.

After the first time use, open the lid of charging case, earbuds will turn on and connect the phones automatically.

Pairing Two Devices

SOUNDPEATS GoFree can be paired and used with two devices at the same time. The method is: after the earbuds are paired with Device A, turn off Device A's Bluetooth. Next, repeat the pairing operation to connect the earbuds to Device B. After connecting Device B successfully, turn on Device A's Bluetooth, then you can use the earbuds with two devices at the same time.

Reset

Open the charging case cover,

1. Place the earphones back into the charging case, and make sure they are correctly placed.
2. Keep the charging case lid open, and press and hold the button on the charging case for 10 seconds until the lights in the charging case flash white twice, and the reset is complete.
3. Close the charging case lid and re-open it, the earphones are activated.

Wearing

1. Identify the left earphone and the right earphone.
2. Adjust the earphones to fit your ears.

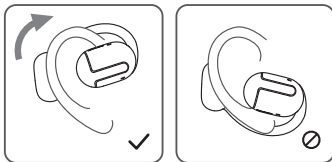

Product Diagram

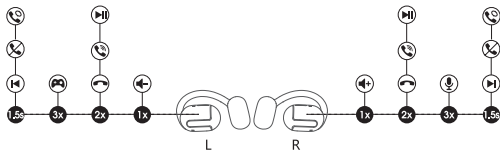

Control

| | |
|--|---|
| Power On | Auto: Open the charging case; the earphones turn on automatically. Manually: Press and hold the multifunctional button for 1.5s when earphones are off. |
| Power off | Auto: Place the earphones back into the charging case and close the case lid. Manually: Press and hold the multifunctional button for 10s when earphones are on. |
| Play/Pause | Double-tap on the multifunctional button |
| Volume- | Single-tap on the left multifunctional button |
| Volume+ | Single-tap on the right multifunctional button |
| Next Track | Press and hold the right multifunctional button for 1.5s |
| Previous Track | Press and hold the left multifunctional button for 1.5s |
| Answer/ Hang Up a Phone Call | Double-tap on the multifunctional button |
| Reject a Phone Call | Press and hold the multifunctional button for 1.5s |
| Switch Between Two Active Calls | Press and hold the multifunctional button for 1.5s |
| Activate the Voice Assistant | Triple-tap on the right multifunctional button |
| Activate/ Deactivate the Game Mode | Triple-tap on the left multifunctional button |

Q&A

Q1: What does the indicator light of the charging case display?

1. The battery power of the charging case:

| | |
|----------------------------|---------------|
| Three white lights stay on | 100%—60% |
| Two white lights stay on | 59%-30% |
| One white light stays on | Less than 30% |

2. When charging the charging box, the indicator light shows:

| | |
|----------------------------|---------------|
| Three white lights stay on | 100% |
| Three white lights flash | 99%-60% |
| Two white lights flash | 59% - 30% |
| One white light flashes | Less than 30% |

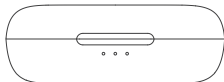

Q2: How to charge the charging case?

1. Connect the charging case to a Type-C charger. (The current does not exceed 1A).
2. If the earphones stay idle for an extended period, charge them at least every three months to prevent the battery from being damaged.

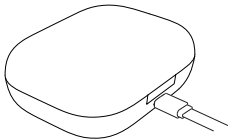
**Q3: Why are the earphones still connected to the phone when they are put back to the charging case and the case lid is closed?**

1. Check whether the charging case has battery power. If it has run out of battery, closing it will not disconnect the earphones from the device.
2. Make sure the earphones are properly placed in the charging case and the charging contacts on the earphones and charging case are all clean. Please use a soft cloth and a bit of alcohol to clean the contact points on the earphones and the charging case.

Q4: How to disconnect the earbuds from the phone?

Method 1: Put the earbuds back into the charging case and close the lid of the charging case, the earbuds will automatically turn off and disconnect.

Method 2: Turn off the Bluetooth on phone to disconnect.

Method 3: Put the earbuds back into the charging case, press and hold the button inside the charging case for 3 seconds, and the earbuds will disconnect from the current phone and enter the pairing state.