

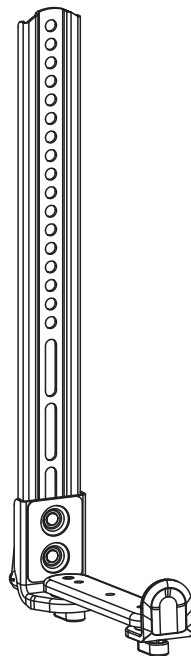

Universal Soundbar Bracket

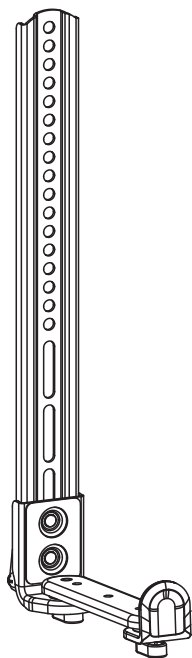

SBR203



support@walelectric.com

WARNING!

If you do not understand these directions, or if you have any doubts about the safety of the installation, please call a qualified technician. Check carefully to make sure there are no missing or defective parts. Improper installation may cause damage or serious injury. Do not use this product for any purpose that is not explicitly specified in this manual. Do not exceed weight capacity. We cannot be liable for damage or injury caused by improper mounting, incorrect assembly or inappropriate use.



TIPOVER WARNING

**SERIOUS OR FATAL CRUSHING INJURIES CAN OCCUR FROM TIPOVER.
TO HELP PREVENT TIPOVER:**

- NEVER ALLOW CHILDREN TO CLIMB, STAND, HANG, OR PLAY ON ANY PART OF MONITOR OR STAND.
- USE TIPOVER RESTRAINT OR ANCHOR STAND TO WALL.

USE OF TIPOVER RESTRAINTS MAY ONLY REDUCE, BUT NOT ELIMINATE RISK OF TIP OVER.

SMALL PARTS- NOT FOR CHILDREN UNDER 3 YEARS. ADULT SUPERVISION IS REQUIRED.

Supplied Parts List

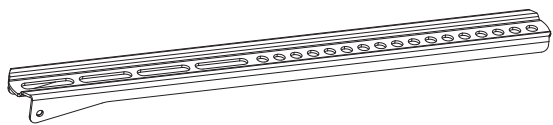

Arm
A(x2)

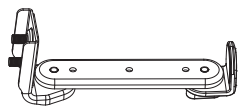

Holder
B(x2)



Spacer
C(x2)



Spacer
D(x4)



Nut
E(x4)



Screw
F(x4)



Wrench
G(x1)



M5x16 Bolt
M-A(x4)



M6x16 Bolt
M-B(x4)

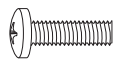

M5x25 Bolt
M-C(x4)

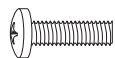

M6x25 Bolt
M-D(x4)

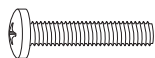

M6x40 Bolt
M-E(x4)

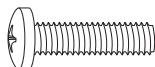

M8x40 Bolt
M-F(x4)

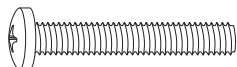

M8x60 Bolt
M-G(x4)



D5 Washer
M-H(x4)



Spacer
M-I(x8)



Spacer
M-J(x8)

Install Options

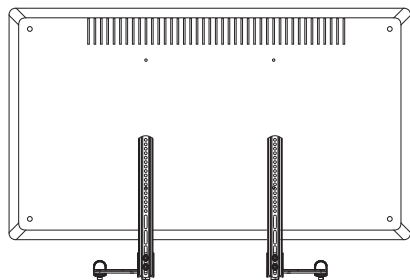

Below The TV

Page 4-7

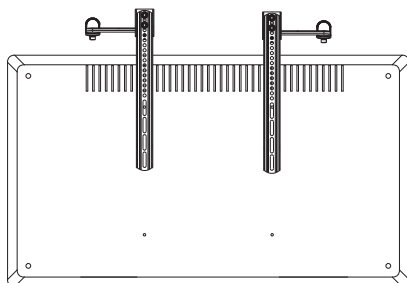

Above The TV

Page 8-10

Option A Below The TV

Step 1

Attach the Holder **B** to Arms **A**. Screw Holder **B** into the preferred key slots on Arm **A** with Nut **E** and tighten using Wrench **G**.

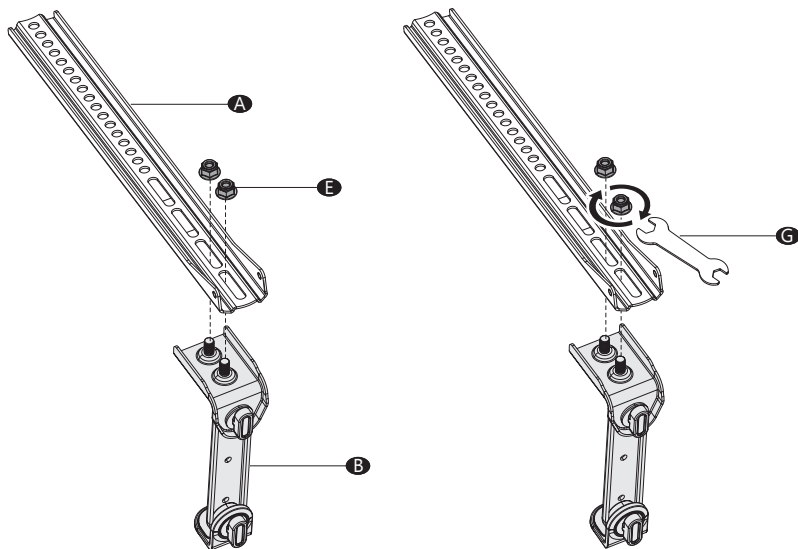

Option A Below The TV

Step 2.1 Leave ample room for your speaker

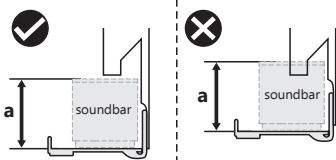

Note: Measure the speaker height before installation. Make sure there is ample room for the speaker.

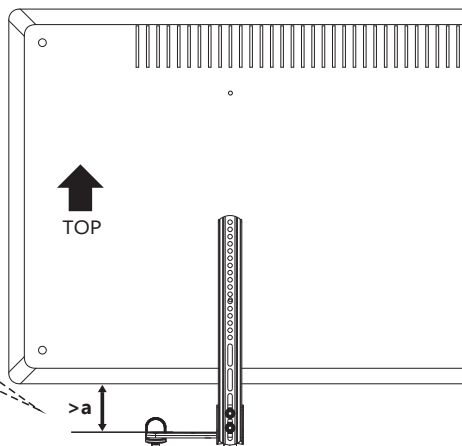

Step 2.2 Select the right TV mounting screws

Only one screw size fits your TV

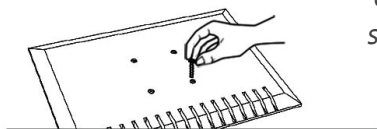
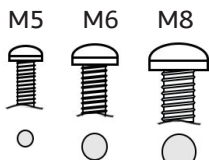

Manually thread screws into the mounting holes on the back of your TV to determine what size of screws will fit.(M5/M6/M8)

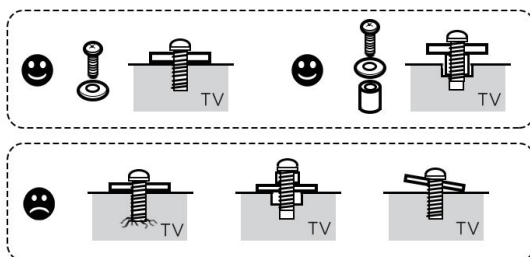

Option A Below The TV

Step 2.3 Attach the soundbar brackets to your TV

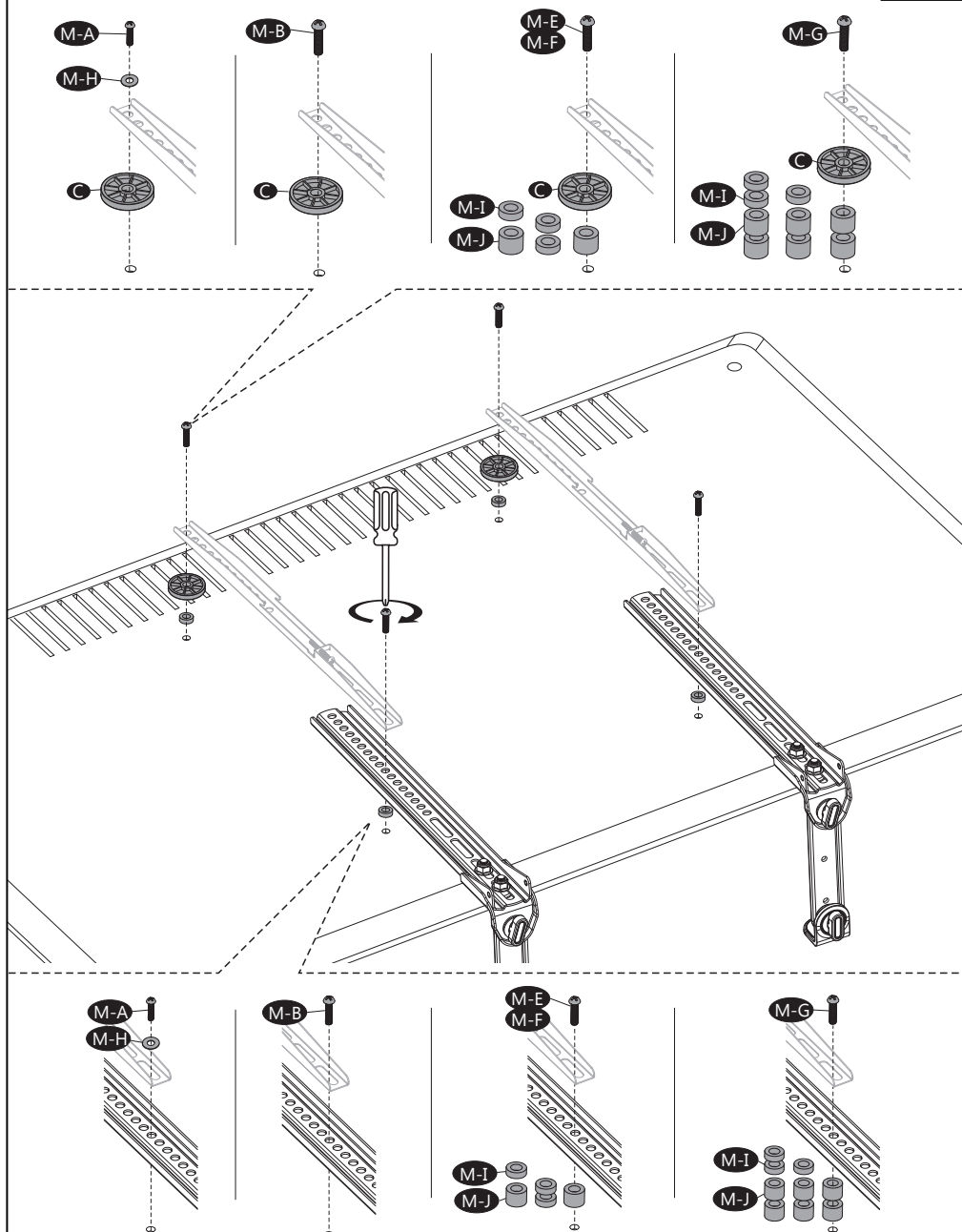

Step 3

1. Adjust the holder according to the depth of your soundbar.

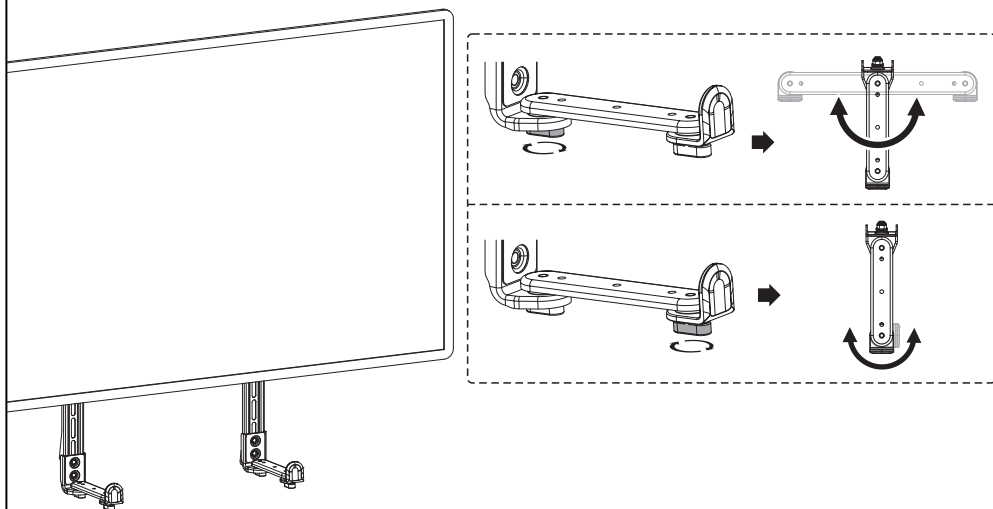

2. Tighten the knobs to secure soundbar sitting sturdy.

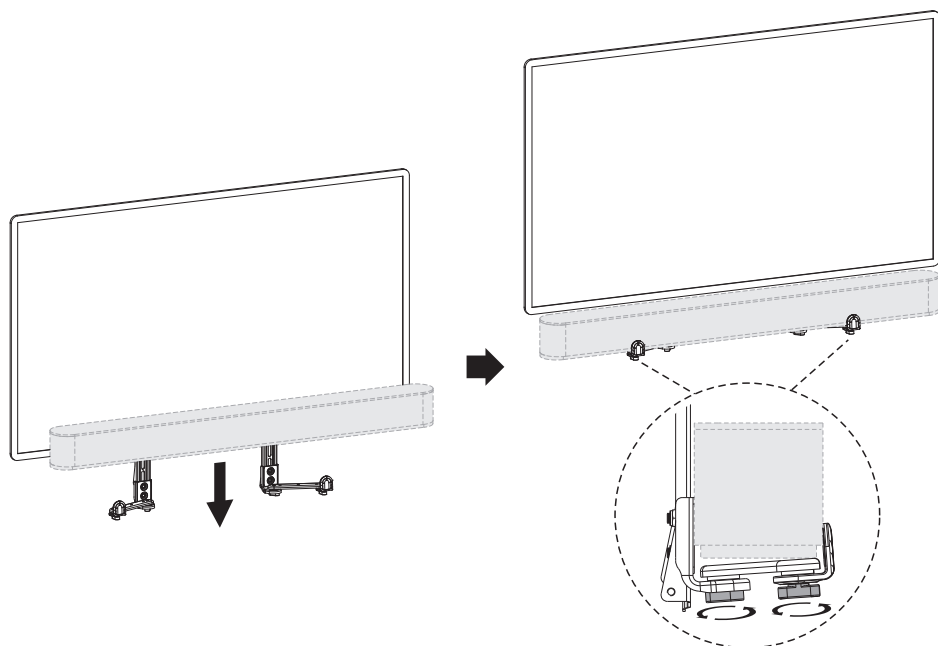

Option B Above The TV

Step 1

Attach the Holder **B** to Arms **A**. Screw Holder **B** into the preferred key slots on Arm **A** with Nut **E** and tighten using Wrench **G**.

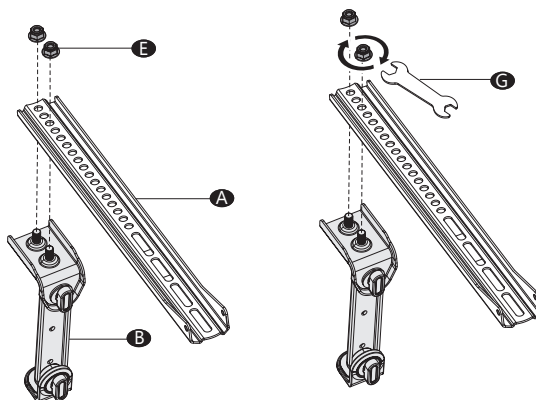

Step 2.1 Leave ample room between the holder and the TV

Note: When top mounting the soundbar, make sure there is ample room between the bracket and the TV as shown

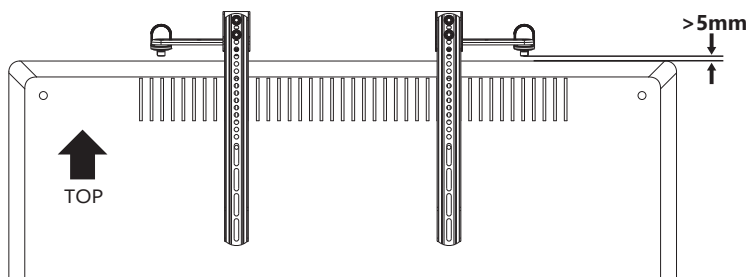

Step 2.2 Select the right TV mounting screws

Only one screw size fits your TV

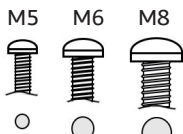

Manually thread screws into the mounting holes on the back of your TV to determine what size of screws will fit. (M5/M6/M8)

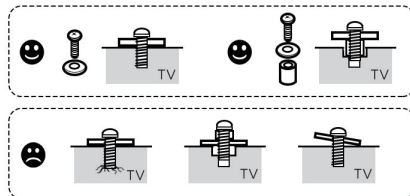

Option B Above The TV

Step 2.3 Attach the soundbar brackets to your TV

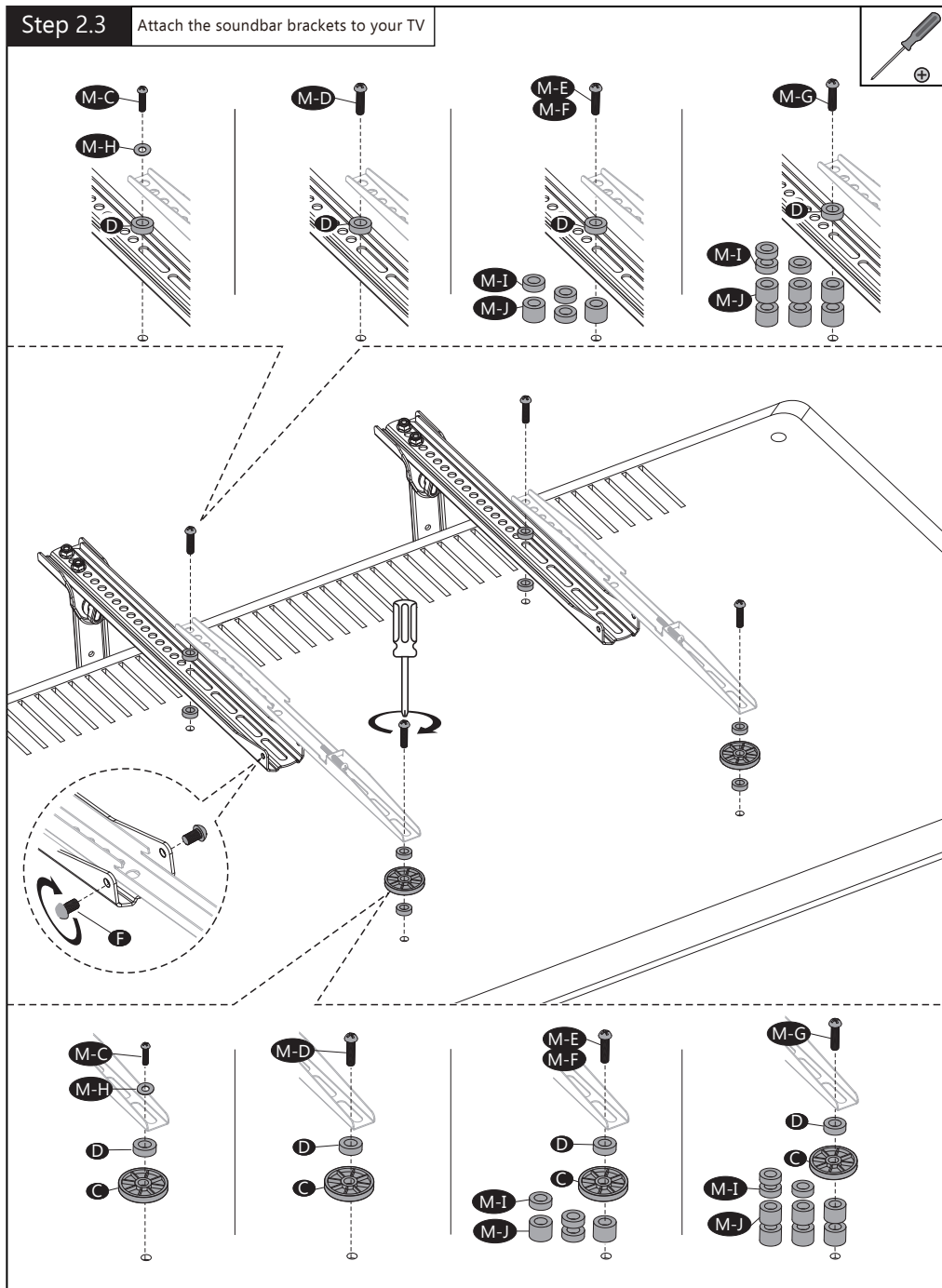

Step 3

1. Adjust the holder according to the depth of your soundbar.

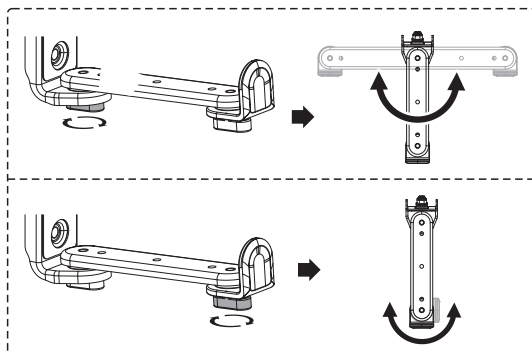
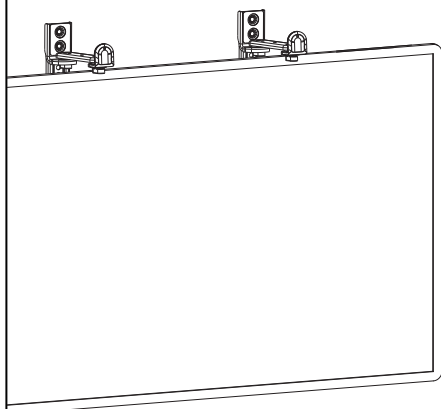

2. Tighten the knobs to secure soundbar sitting sturdy.

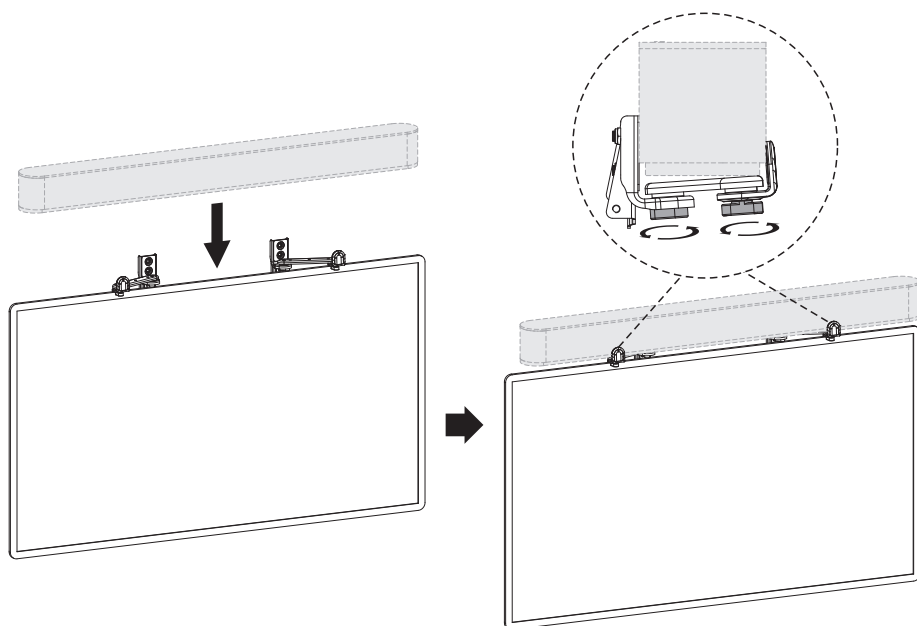



Thank you for choosing us!

We support the technology that brings your home to life.
We offer high quality products, professional customer service,
and extensive technical support.

If you have any questions, please contact us.

☎ 1-844-SATTLER (18447288537)

✉ support@wallielectric.com