



# RAZER COBRA PRO

MASTER GUIDE

Cut the competition down to size and dazzle them all with the **Razer Cobra Pro**—a wireless gaming mouse powered by Razer Chroma™ RGB. Featuring Razer™ HyperSpeed Wireless and 11 individually programmable lighting zones, color your play with an illuminating level of freedom and immersion.

CONTENTS

1. WHAT'S INSIDE ..... 3

2. WHAT'S NEEDED ..... 4

3. LET'S GET YOU COVERED..... 4

4. TECHNICAL SPECIFICATIONS ..... 5

5. SETTING UP YOUR RAZER COBRA PRO..... 6

6. USING YOUR MOUSE..... 10

7. CONFIGURING YOUR RAZER COBRA PRO VIA RAZER SYNAPSE ..... 12

8. SAFETY AND MAINTENANCE ..... 30

9. LEGALESE..... 32

## 1. WHAT'S INSIDE

### ▪ Razer Cobra Pro

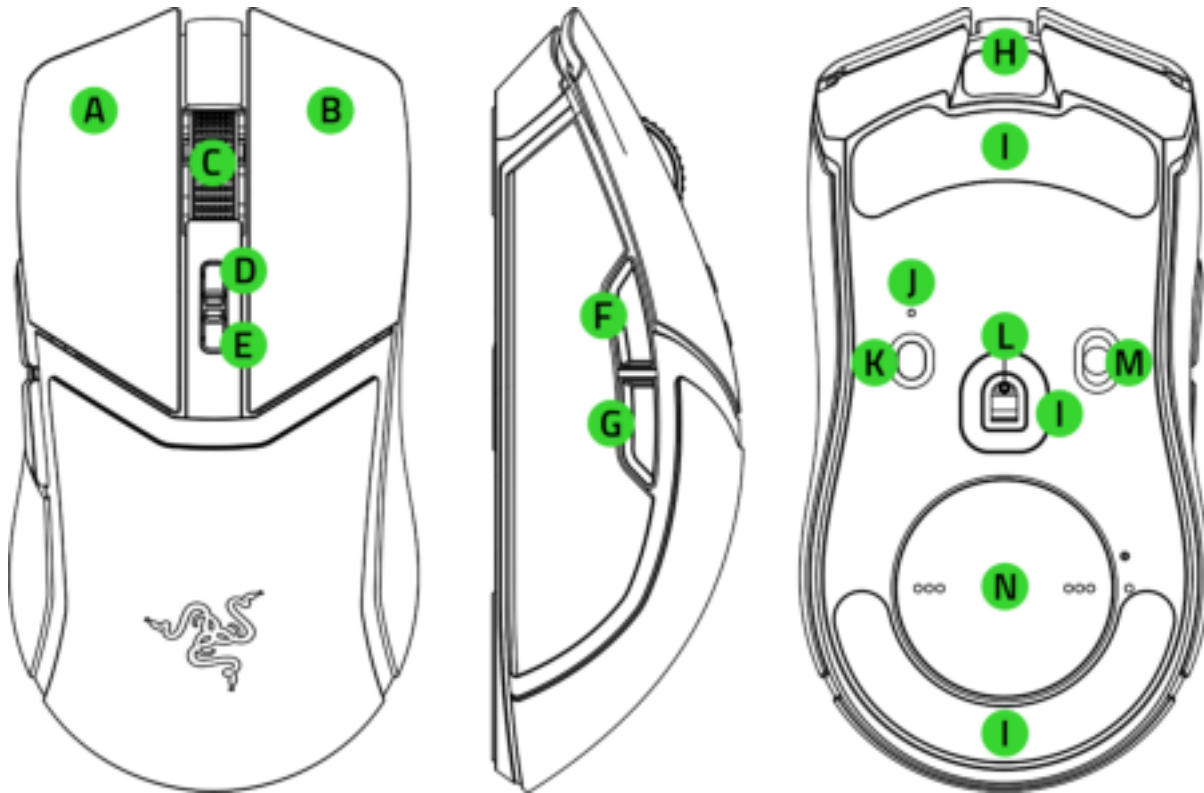

- A. Left mouse button
- B. Right mouse button
- C. Scroll wheel
- D. DPI stage up button\*
- E. DPI stage down button\*
- F. Mouse button 5
- G. Mouse button 4
- H. USB Type C port
- I. PTFE mouse feet
- J. Profile indicator

- K. Profile button
- L. Razer™ Focus Pro 30K Optical Sensor
- M. Slider switch
  - Bluetooth mode
  - Power off mode
  - Razer™ HyperSpeed Wireless (2.4 GHz) mode
- N. Wireless dongle compartment / Cover puck\*\*

*\*The DPI stages are 400, 800, 1600 (default), 3200, and 6400, and can be customized using Razer Synapse.*

*\*\*Interchangeable with the Razer Wireless Charging Puck for wireless charging via Razer Mouse Dock Pro (each sold separately).*

- Razer HyperSpeed Wireless dongle + USB dongle adapter



- USB Type A to USB Type C Speedflex cable

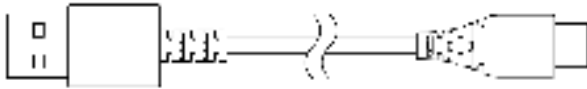

- Important Product Information Guide

---

## 2. WHAT'S NEEDED

### PRODUCT REQUIREMENTS

- USB Type A port or Bluetooth connectivity

### RAZER SYNAPSE REQUIREMENTS

- Windows® 10 64-bit (or higher)
- Internet connection for software installation

---

### 3. LET'S GET YOU COVERED



Register your product and score exclusive benefits

[razerid.razer.com/warranty](https://razerid.razer.com/warranty)

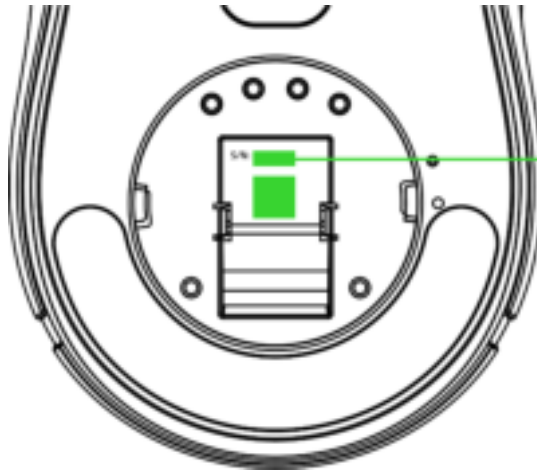

*Your product's  
serial number can  
be found here.*

---

## 4. TECHNICAL SPECIFICATIONS

- Form factor: Right-handed Symmetrical
- Connectivity:
  - Razer HyperSpeed Wireless (2.4 GHz)
  - Bluetooth
  - Wired – Speedflex Cable USB Type C
- Battery Life:
  - Up to 170 hours on Bluetooth
  - Up to 100 hours on Razer HyperSpeed Wireless (constant motion at 1000 Hz)
  - Up to 33 hours with the Razer HyperPolling Wireless Dongle and Mouse Dock Pro\* (constant motion at 4000 Hz)

*\*both sold separately*
- RGB lighting: Razer Chroma RGB (Scroll Wheel, Logo, Multi-zone Underglow)
- Sensor: Focus Pro 30K Optical Sensor
- Max sensitivity (DPI): 30000
- Max speed (IPS): 750
- Max acceleration (G): 70
- Programmable buttons: 8
- Switch type: Optical Mouse Switches Gen-3
- Switch lifecycle: 90-Million Clicks
- On-board memory profiles: 5
- Mouse feet: 100% PTFE
- Cable: Razer™ Speedflex Cable USB Type C
- Dock compatibility: Razer Mouse Dock Pro with Razer Wireless Charging Puck (both sold separately)
- Polling rate / interval: 1000 Hz (Up to 4000 Hz with Mouse Dock Pro, or HyperPolling Wireless Dongle, sold separately)

---

## 5. SETTING UP YOUR RAZER COBRA PRO

### CHARGING YOUR MOUSE

Plug the USB Type A to USB Type C cable from your PC's USB port into the Razer Cobra Pro. A depleted battery will be fully charged in approximately 4 hours.

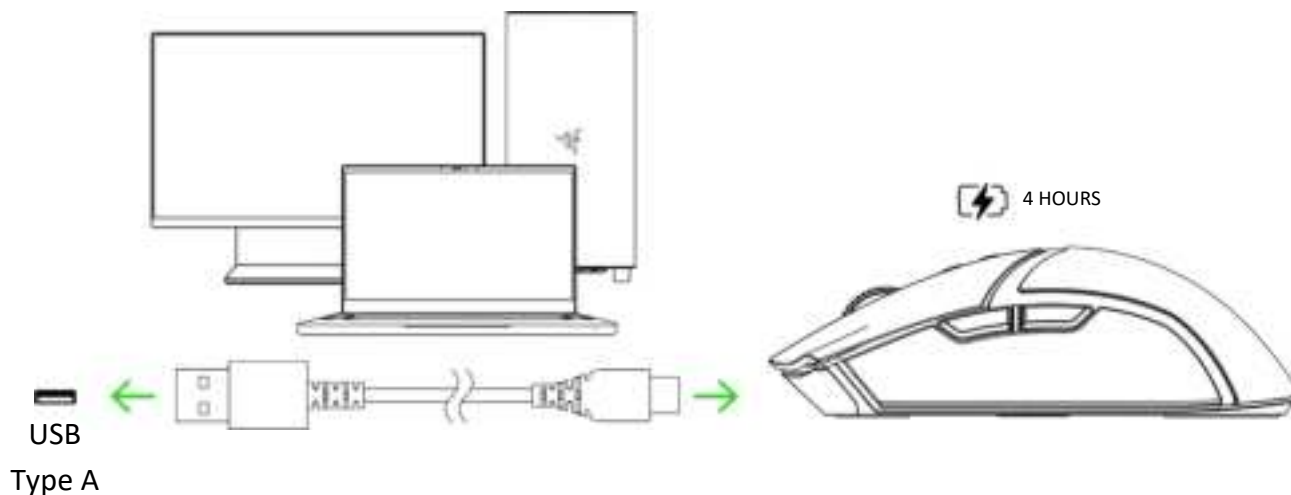

**i** For best results, please fully charge the mouse before using it for the first time. Install Razer Synapse when prompted, or download the installer from [razer.com/synapse](https://razer.com/synapse)

### CONNECTING YOUR MOUSE

#### A. Via wired mode

Connect the mouse to any of your PC's USB ports using the charging cable to use it in wired mode.

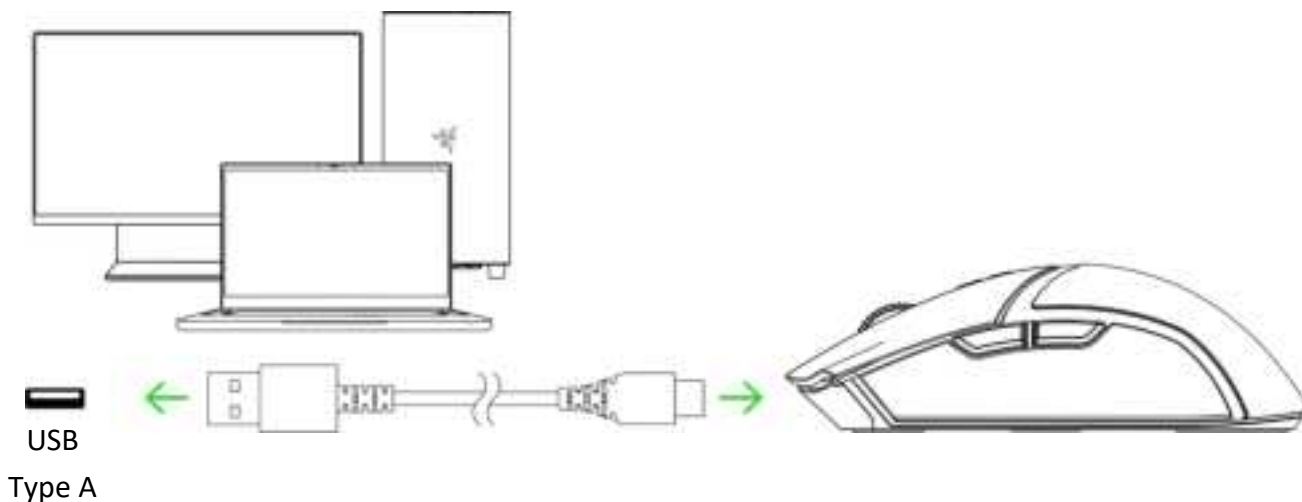



## B. Via Razer™ HyperSpeed Wireless (2.4 GHz) mode

1. Connect the wireless dongle to your PC using the USB Type A to USB Type C cable.

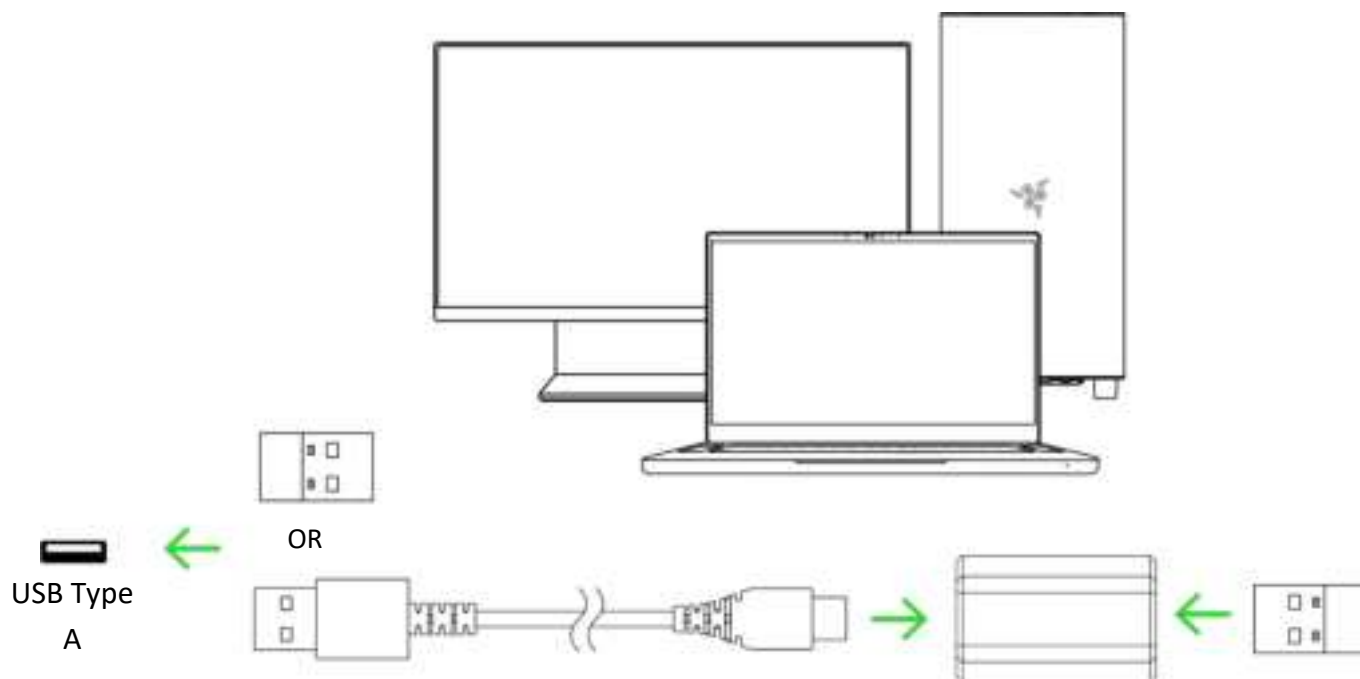

2. Push the slider switch to Razer™ HyperSpeed Wireless (2.4 GHz) mode.

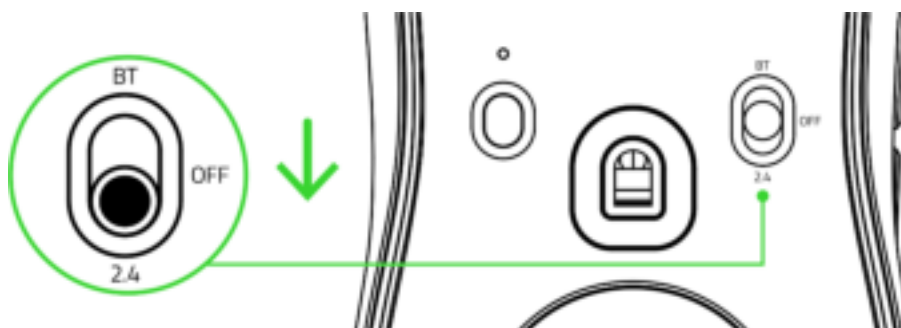

Your Razer Cobra Pro is now ready for use in Razer HyperSpeed Wireless (2.4 GHz) mode.

### C. Via Bluetooth mode

1. Push the slider switch to Bluetooth mode (BT).

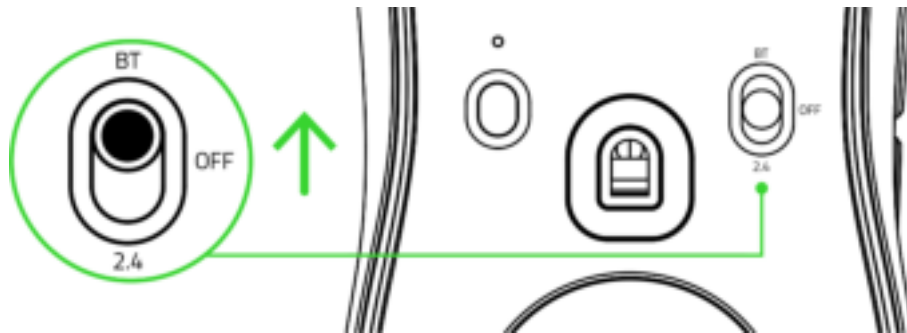

2. Press and hold the mouse button 5, the scroll wheel and the right mouse button simultaneously for three seconds to activate pairing mode. The Razer logo will blink twice in repeated intervals to show that the mouse is in pairing mode.

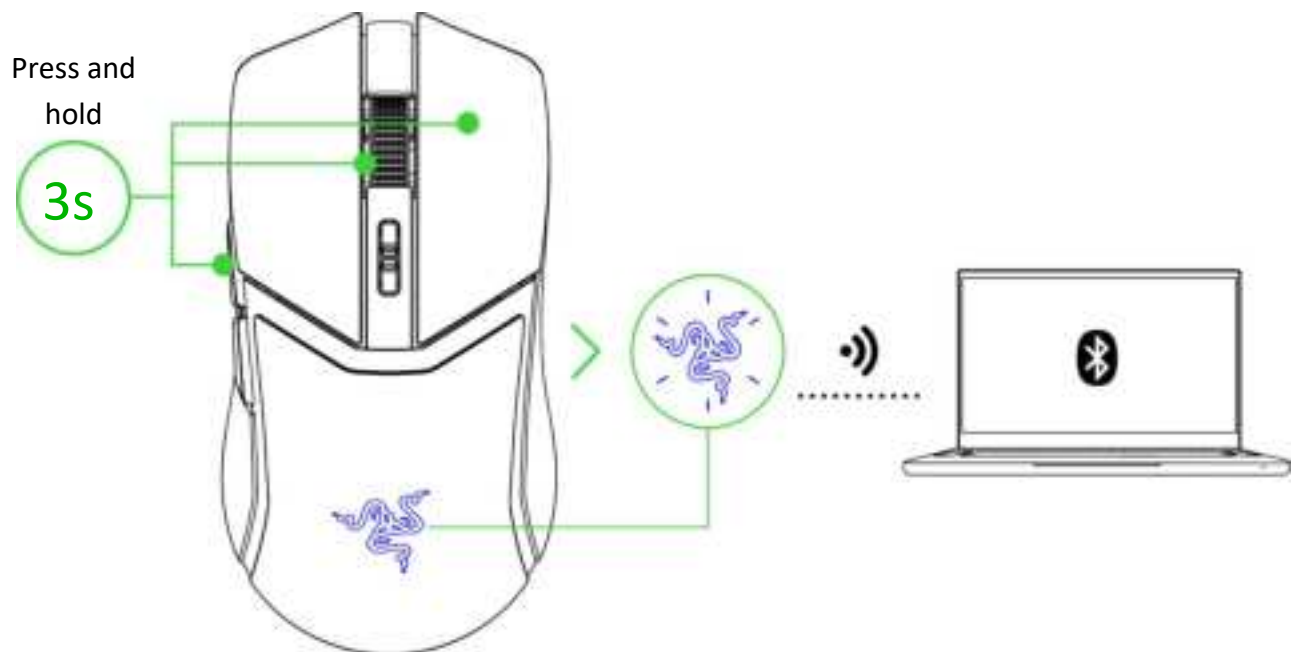

3. Activate Bluetooth on your device and select "**Cobra Pro**" from the list of devices found.

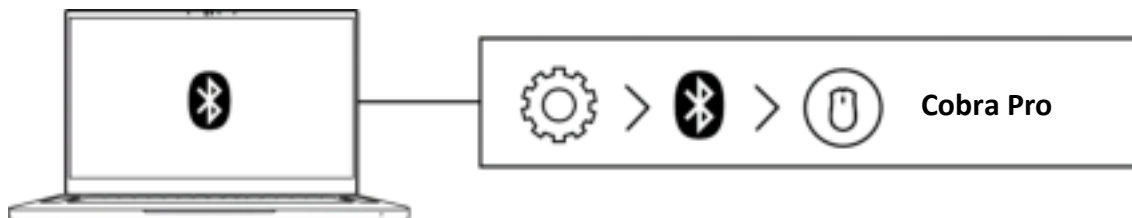

4. Wait until the mouse pairs with your device. When paired, the Razer logo will briefly turn static blue.

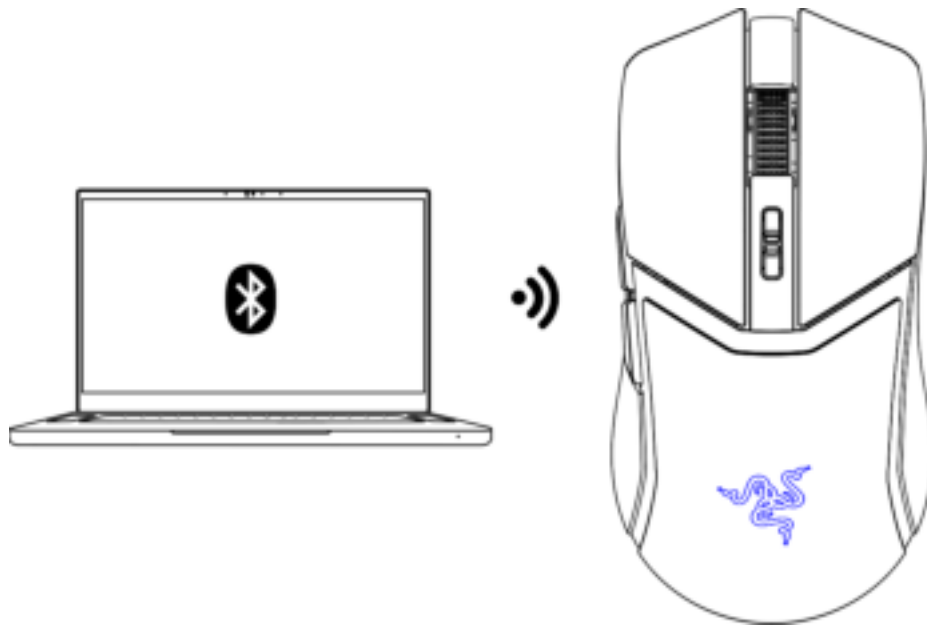

 *Once paired, your Razer Cobra Pro will automatically reconnect to your device whenever in Bluetooth mode and within range. Keep your devices close to each other for a faster and more stable connection.*

The Razer Cobra Pro is now ready for use in Bluetooth mode.

---

## 6. USING YOUR MOUSE

### LOW BATTERY NOTIFICATION

The scroll wheel will blink red twice in repeated intervals to indicate that the battery power of the mouse is less than 5%. This lighting sequence will repeat until the battery is drained or the mouse is connected to a PC via the charging cable.

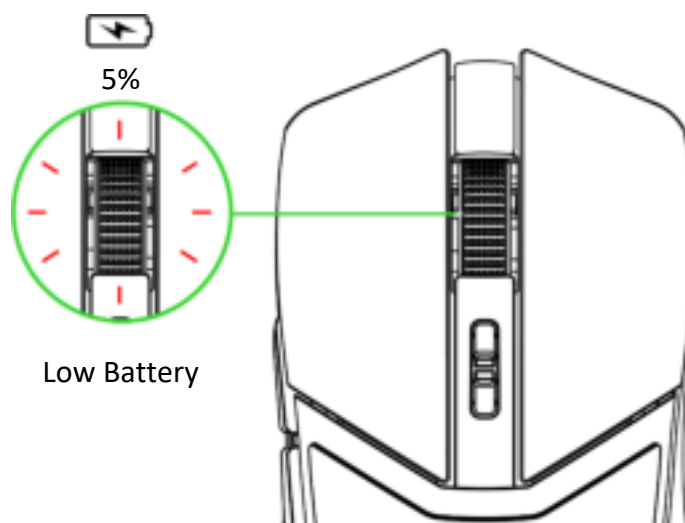

### CHANGING THE DPI

Change the mouse's DPI to match your playstyle with a press of the DPI stage up or down buttons, or fine-tune your own sensitivity settings using the Razer Synapse app.

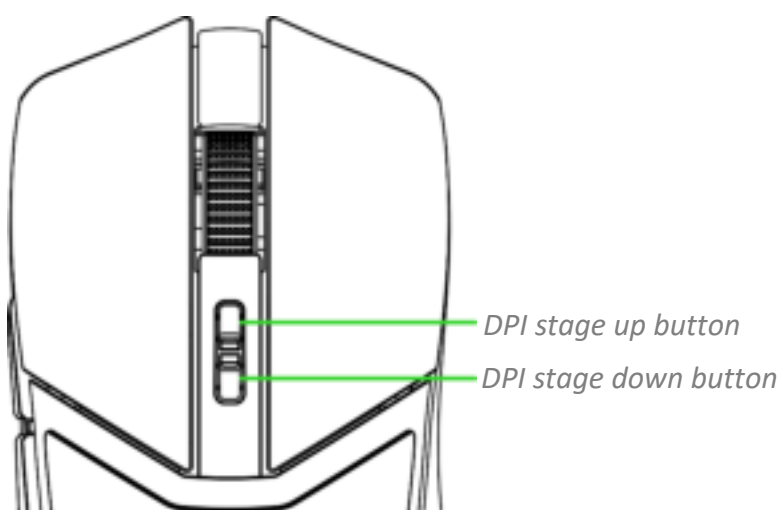

 When Razer Synapse is installed, an on-screen prompt will display as you cycle through each DPI

stage.

## SWITCHING BETWEEN PROFILES

Your Razer Cobra Pro can store up to 5 profiles from the Razer Synapse app, allowing you to use these profiles even on systems without the app installed. Pressing the profile button will cycle through the different profiles, with the profile indicator's color showing which profile is active. [Learn more about Stored profiles](#)

Profile	Designated color
Active Profile	White
Profile 1	Red
Profile 2	Green
Profile 3	Blue
Profile 4	Cyan

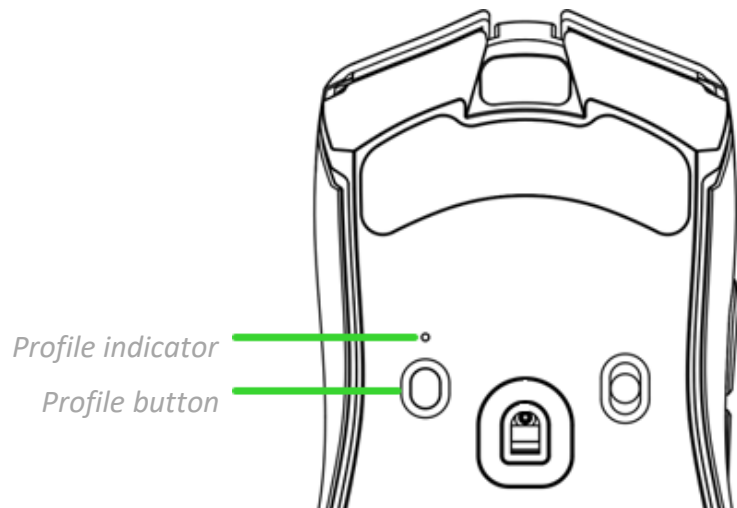

---

## 7. CONFIGURING YOUR RAZER COBRA PRO VIA RAZER SYNAPSE

**i** *Internet connection is required for installation, updates, and cloud-based features. Registering for a Razer ID account is recommended but optional. All listed features are subject to change based on the current software version, the connected device(s), and supported apps and software.*

### SYNAPSE TAB

The Synapse tab is your default tab when you first launch Razer Synapse. This tab allows you to navigate the Dashboard subtab.

#### Dashboard

The Dashboard subtab is an overview of your Razer Synapse, where you can access all your Razer devices, modules, and online services.

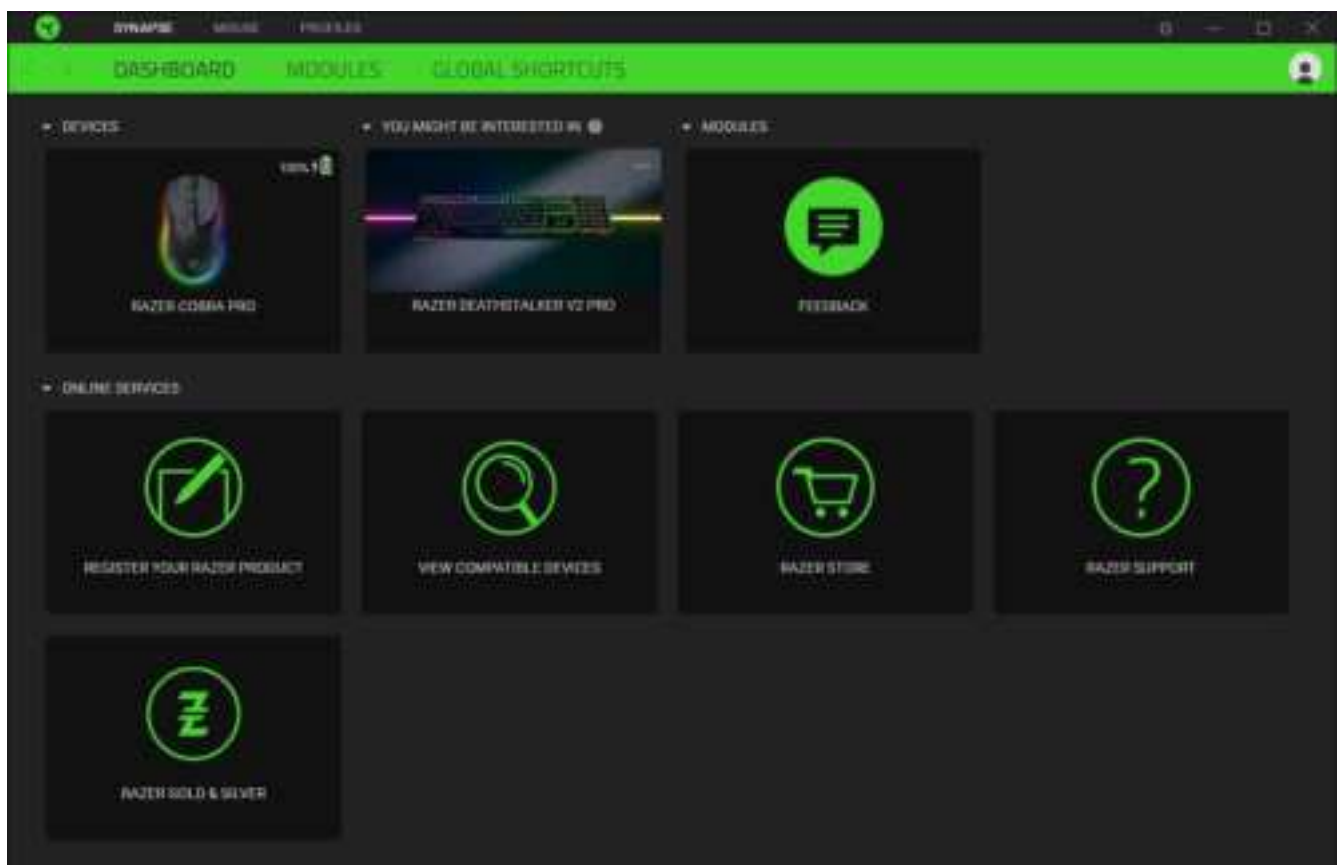

## Modules

The Modules subtab displays all installed and available modules for installation.

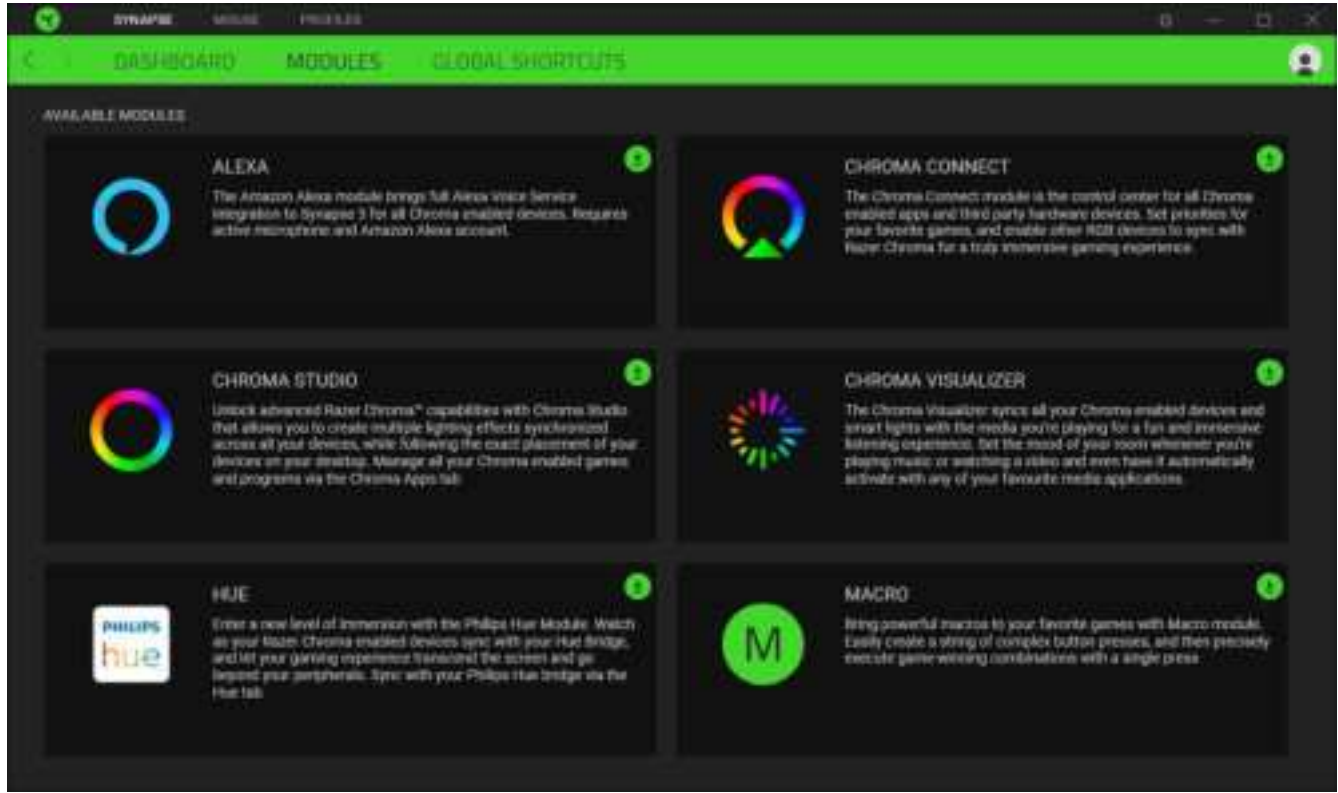

## Global Shortcuts

Bind operations or Razer Synapse functions to custom key combinations from any Razer Synapse-enabled device inputs, which apply across all device profiles. [Learn more about Profiles](#)

 *Only Razer Synapse-enabled device inputs will be recognized.*

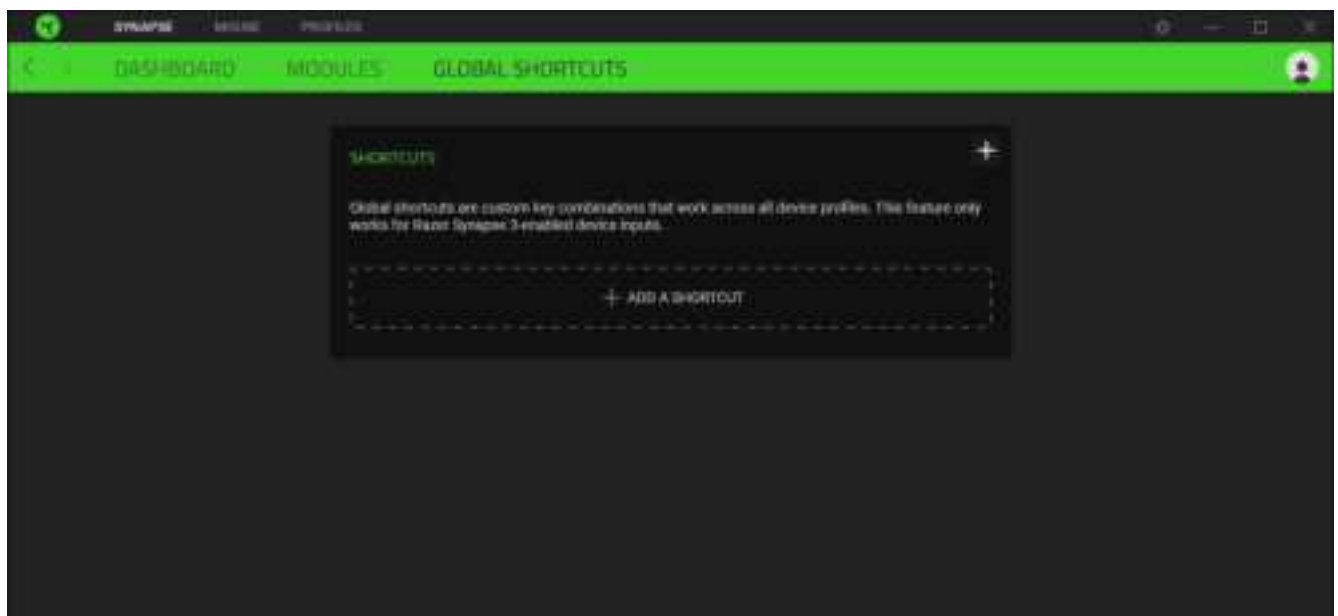

## MOUSE TAB

The Mouse tab is the main tab for your Razer Cobra Pro. From here, you can change your device's settings, such as button assignment, stored profiles, DPI sensitivity and lighting. Changes under this tab are automatically saved to your system and cloud storage.

### Customize

The Customize subtab is for modifying your mouse's button assignments.

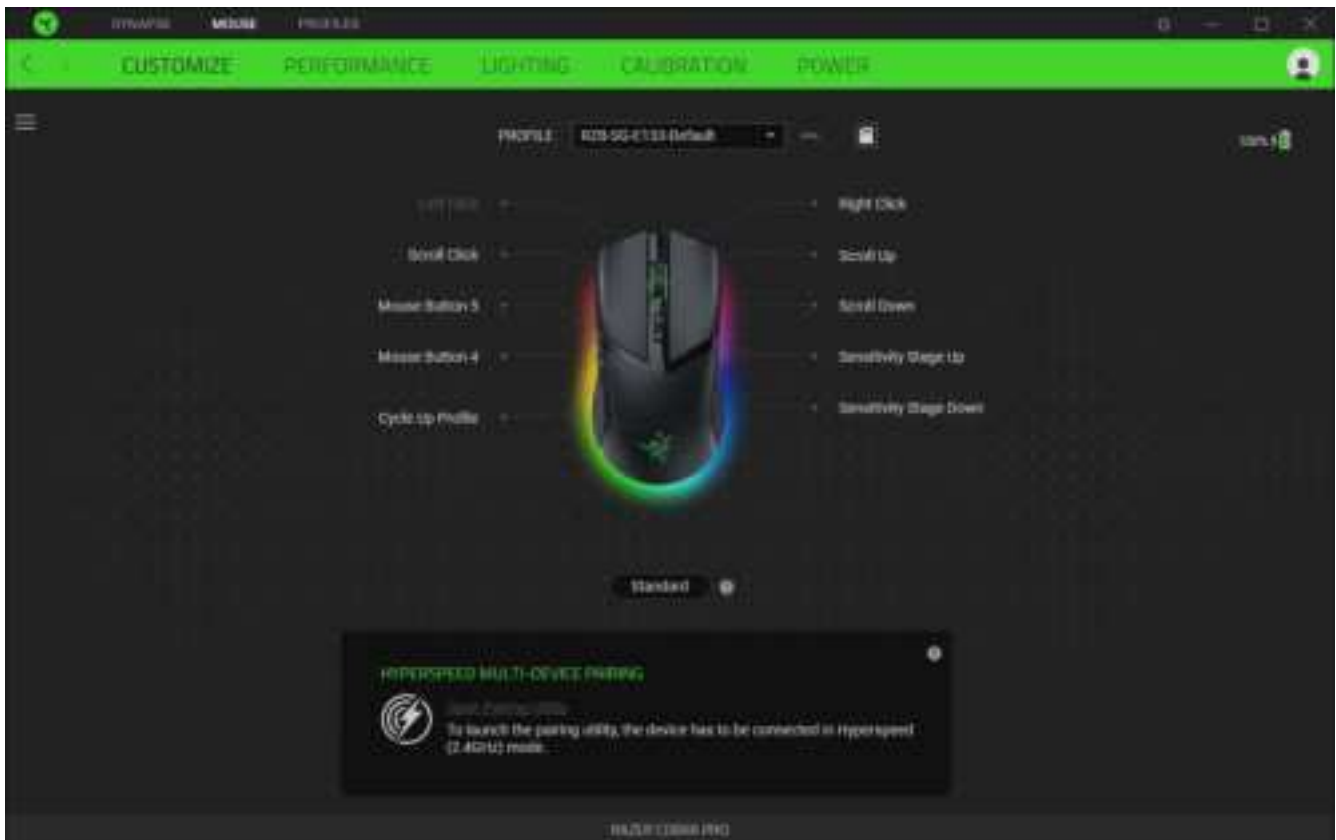

### Profile

A Profile is a data storage for keeping all your Razer peripheral's settings. By default, the profile name is based on your system's name. To add, import, rename, duplicate, export, reset or delete a profile, press the Miscellaneous button ( ■■■■ ).

### Standard / Hypershift

Hypershift mode is a secondary set of button assignments activated when the Hypershift key is held down. By default, the Hypershift key is assigned to the fn key of your Razer Synapse-supported keyboard. However, you can also set any mouse button to activate Hypershift mode.



### HyperSpeed Multi-Device Pairing

Use this feature to pair an additional HyperSpeed-compatible device with the Razer HyperSpeed Wireless Dongle of your Razer Cobra Pro. As its wireless dongle can support a keyboard and mouse simultaneously, you can remove the usage of separate dongles for each peripheral.

 To use this feature, your Razer Cobra Pro must be connected via Razer HyperSpeed Wireless (2.4 GHz) mode. Each peripheral can only connect to one dongle at a time.

### Stored Profiles

Your Razer Cobra Pro can store up to 5 profiles from the Razer Synapse app, allowing you to use these profiles even on systems without the app installed.

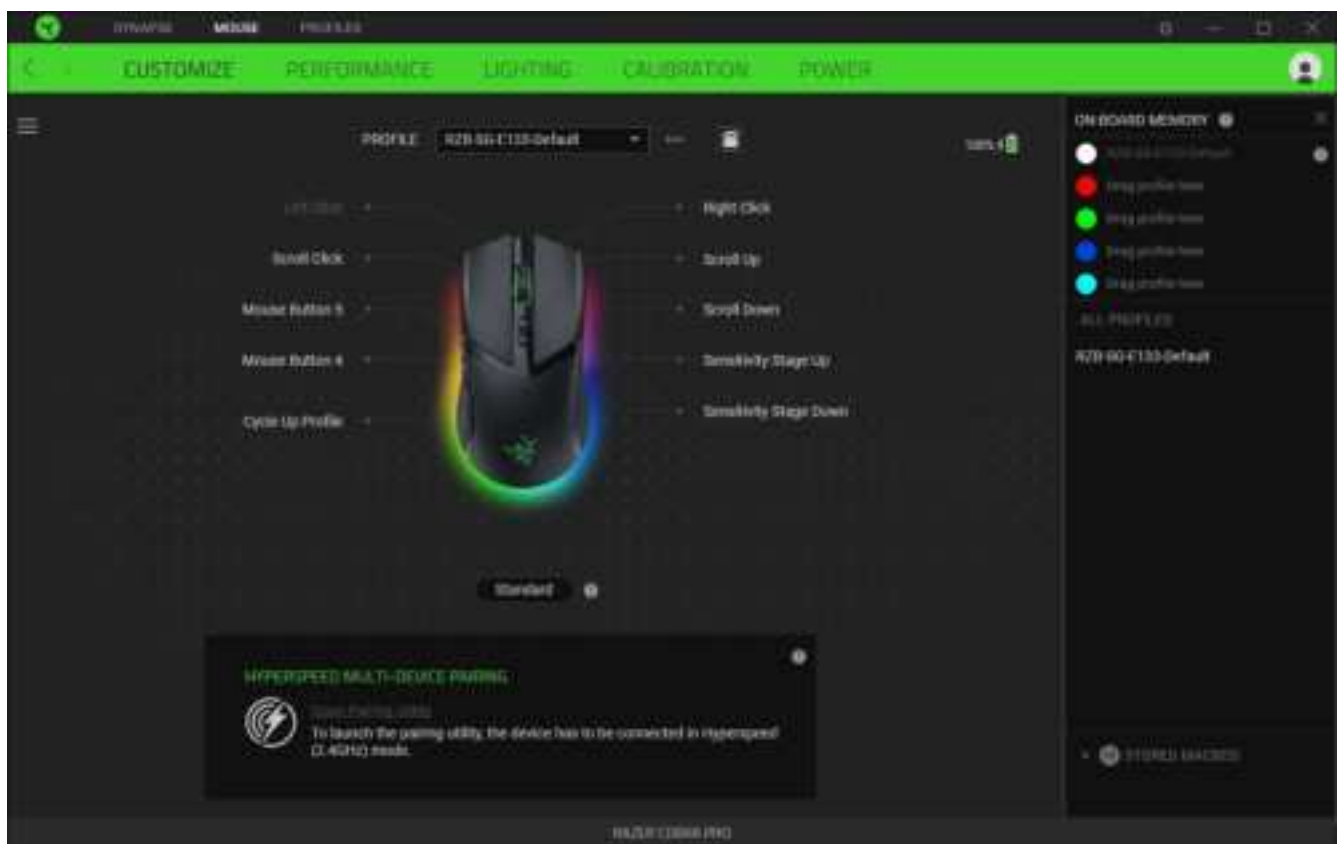

To assign a profile to available on-board memory slots, click the On-board Profiles button (  ) and drag the profile you want to assign to the preferred memory slot.

## Sidebar

Clicking the Sidebar button (  ) will reveal all current button assignments for your Razer Cobra Pro.

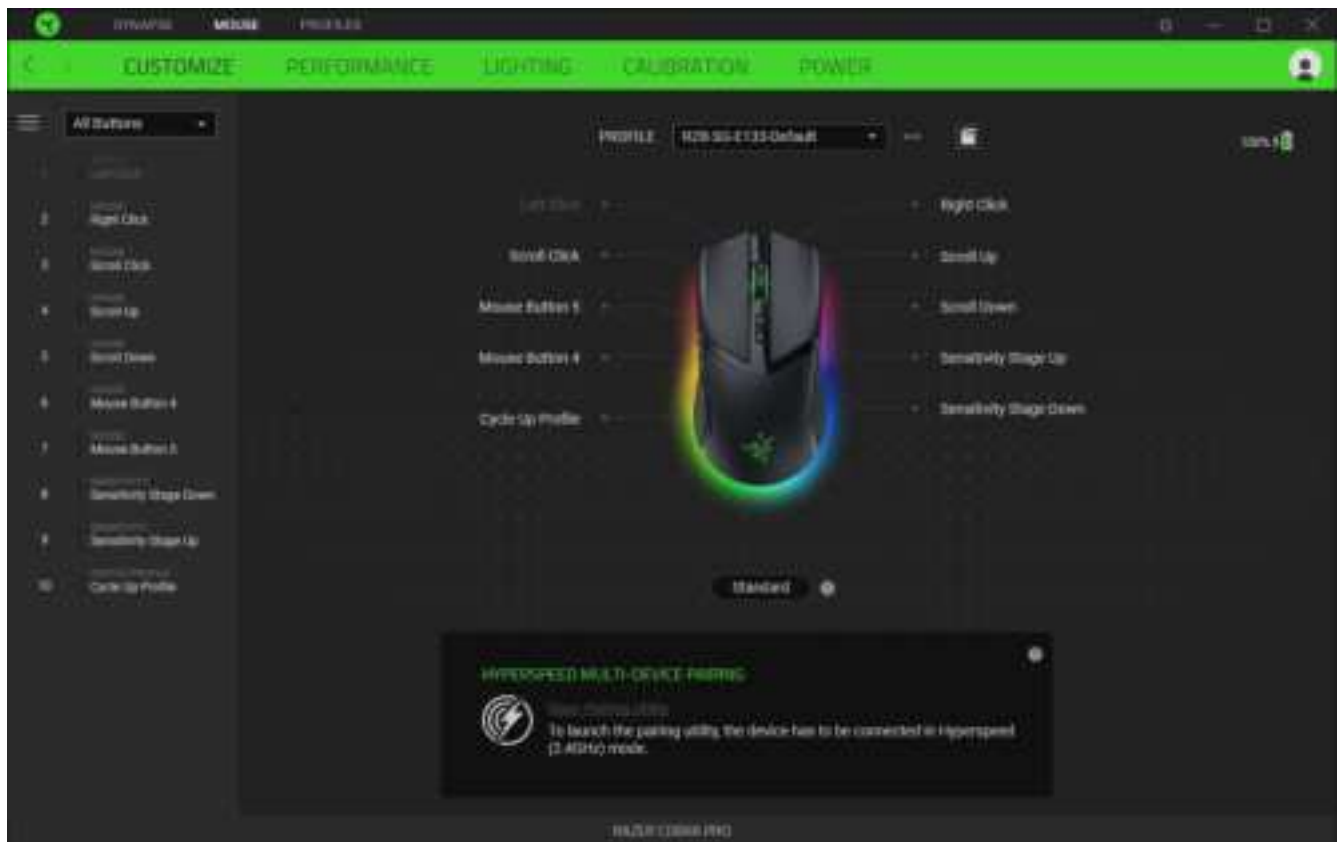

Alternatively, you can skip to a specific button assignment by selecting it on the Customize tab.

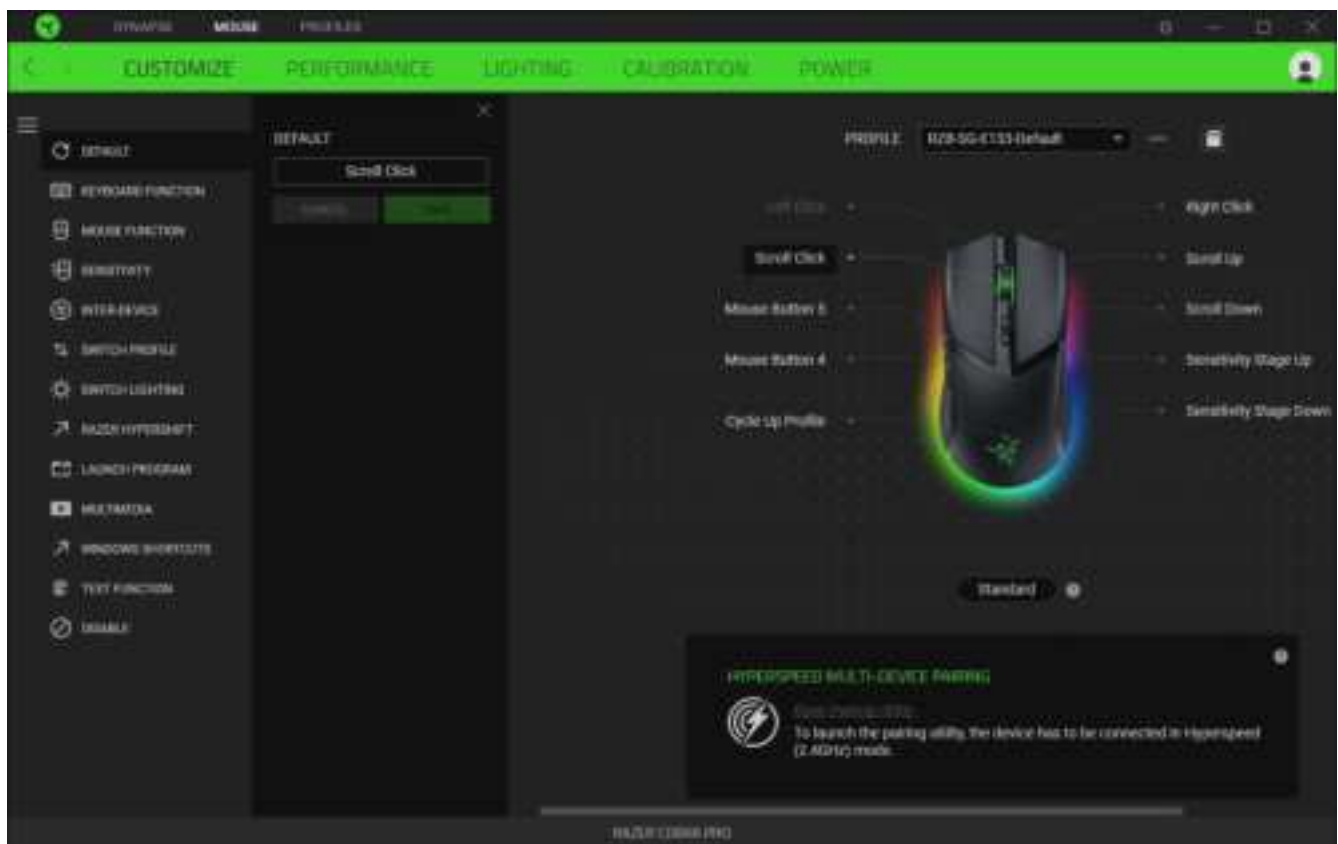

## Default

This option enables you to return the mouse button to its original setting.

## Keyboard Function

This option changes the button assignment into a keyboard function. You can also enable Turbo mode, which allows you to emulate a repeated keyboard function while the button is held down.

## Mouse Function

This option substitutes the current button assignment for another mouse function. Listed below are the functions which you can choose from:

- Left Click - Performs a left mouse click using the assigned button.
- Right Click - Performs a right mouse click using the assigned button.
- Scroll Click - Activates the universal scrolling function.
- Double Click - Performs a double left click using the assigned button.
- Mouse Button 4 - Performs a "Backward" command for most internet browsers.
- Mouse Button 5 - Performs a "Forward" command for most internet browsers.
- Scroll Up - Performs a "Scroll Up" command using the assigned button.
- Scroll Down - Performs a "Scroll Down" command using the assigned button.
- Scroll Left - Performs a "Scroll Left" command using the assigned button.
- Scroll Right - Performs a "Scroll Right" command using the assigned button.

You can also choose to enable Turbo mode in some of the mouse functions, which allows you to emulate repeatedly pressing and releasing said function while the button is held down.

## Sensitivity

This function allows you to manipulate the DPI setting of your Razer Cobra Pro with a touch of a button. Listed below are the Sensitivity options and their description:

- Sensitivity Clutch - Changes the sensitivity to a predefined DPI while the designated button is held down. Releasing the button will return it to the previous sensitivity.
- Sensitivity Stage Up - Increases the current sensitivity by one stage.
- Sensitivity Stage Down - Decreases the current sensitivity by one stage.

- On-The-Fly Sensitivity - Pressing the designated button and moving the scroll wheel either up or down will increase or decrease the current DPI.
- Cycle Up Sensitivity Stages - Increases the current sensitivity stage by one. Once it reaches the highest sensitivity stage, it will return to stage 1 when the button is pressed again.
- Cycle Down Sensitivity Stages - Decreases the current sensitivity stage by one. Once it reaches stage 1, it will return to the highest sensitivity stage when the button is pressed again. [Learn more about Sensitivity Stages](#)

## Macro

A Macro is a prerecorded sequence of keystrokes and button presses that is executed with precise timing. You can conveniently execute a chain of commands by setting the button function to Macro. This function will only be visible when the Macro module is installed.

## Inter-device

Inter-device allows you to change the functionality of other Razer Synapse-enabled devices. Some of these functionalities are device-specific such as using your Razer gaming keyboard to change the Sensitivity Stage of your Razer gaming mouse.

## Switch Profile

Switch Profile lets you quickly change profiles and load a new set of button assignments. An on-screen notification will appear whenever you switch profiles.

## Switch Lighting

Switch Lighting allows you to switch between all advanced lighting effects easily. This function will only be visible when the Chroma Studio module is installed.

## Razer Hypershift

Setting the button to Razer Hypershift will allow you to activate Hypershift mode as long as the button is held down.

## Launch Program

Launch Program lets you open an app or a website using the assigned button. When you select Launch Program, two choices will appear, which require you to search for a specific app you want to open or write the website address you want to visit.

## Multimedia

This option allows you to assign multimedia controls to your Razer device. Listed below are the multimedia controls you can choose from:

- Volume Down - Decreases the audio output.
- Volume Up - Increases the audio output.
- Mute Volume - Mutes the audio.
- Mic Volume Up - Increases the microphone volume.
- Mic Volume Down - Decreases the microphone volume.
- Mute Mic - Mutes the microphone.
- Mute All - Mutes both microphone and audio output.
- Play / Pause - Play, pause, or resume playback of the current media.
- Previous Track - Play the previous media track.
- Next Track - Play the next media track.

## Windows Shortcuts

This option allows you to assign your preferred button to a Windows Operating System shortcut command. For more information, please visit: [support.microsoft.com/kb/126449](https://support.microsoft.com/kb/126449)

## Text Function

Text Function enables you to type a prewritten text with a touch of a button. Simply write your desired text on the given field, and your text will be typed whenever the assigned button is pressed. This function has full Unicode support, and you can also insert special symbols from character maps.

## Disable

This option renders the assigned button unusable. Use Disable if you do not want to use the selected button or if it interferes with your gaming.

## Performance

The Performance subtab allows you to modify the sensitivity, acceleration, and polling rate.

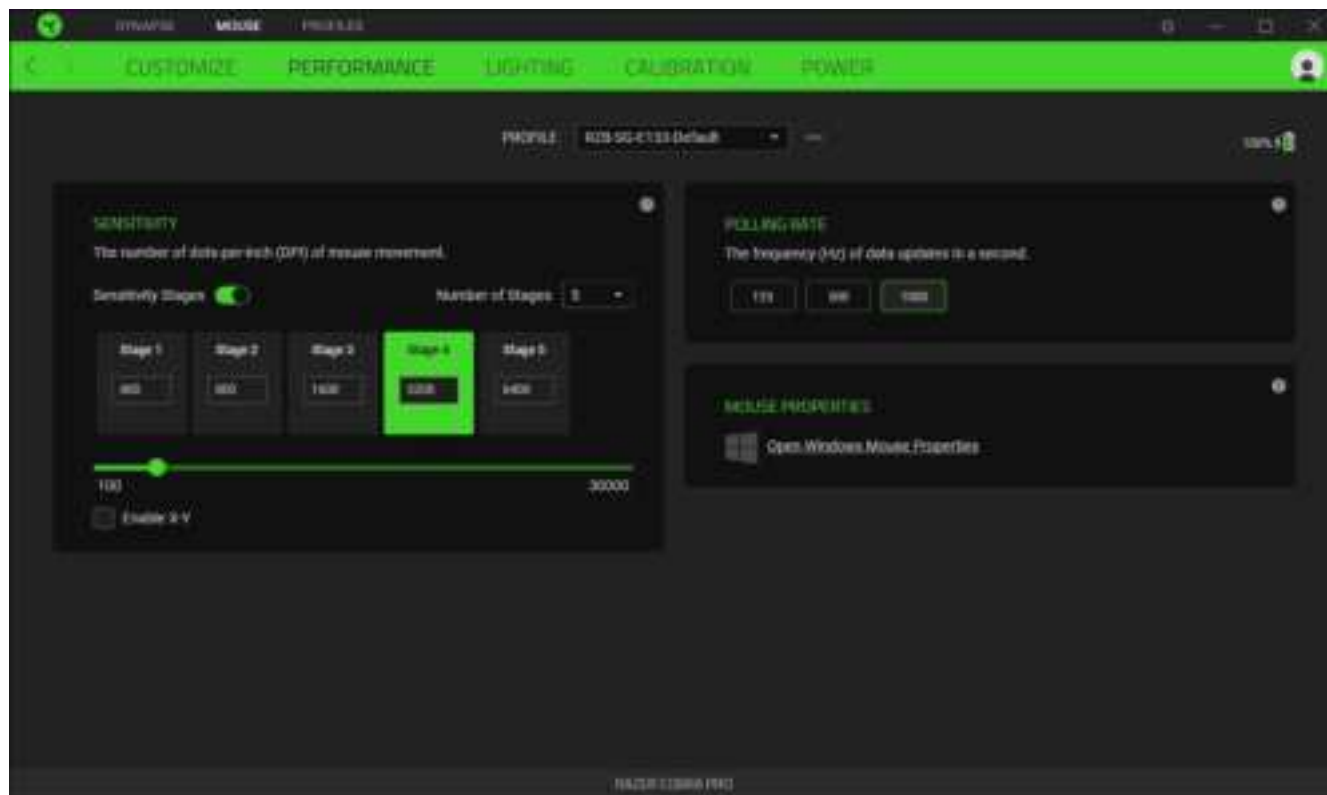

### Sensitivity

Sensitivity refers to the distance the cursor will travel based on how far the mouse moves. The higher the DPI, the farther the cursor will travel, given the same mouse movement distance.

### Sensitivity Stages

A sensitivity stage is a preset sensitivity value. When enabled, you can create up to 5 different sensitivity stages, which you can cycle through using the DPI stage up and down buttons.

### Enable X-Y Sensitivity

By default, the X-axis (horizontal) and Y-axis (vertical) use the same sensitivity values. However, you may set different sensitivity values for each axis by selecting the Enable X-Y option.

### Polling Rate

The higher the polling rate, the more often the computer receives information about the status of your mouse, effectively reducing input latency and improving your mouse pointer's reaction time. You can switch between 125Hz, 500Hz, and 1000Hz by selecting your desired polling rate from the options provided.

### *Mouse Properties*

Access the Windows Mouse Properties, where you can modify operating system settings that directly affect your mouse.

Lighting

The Lighting subtab enables you to modify your Razer device's light settings.

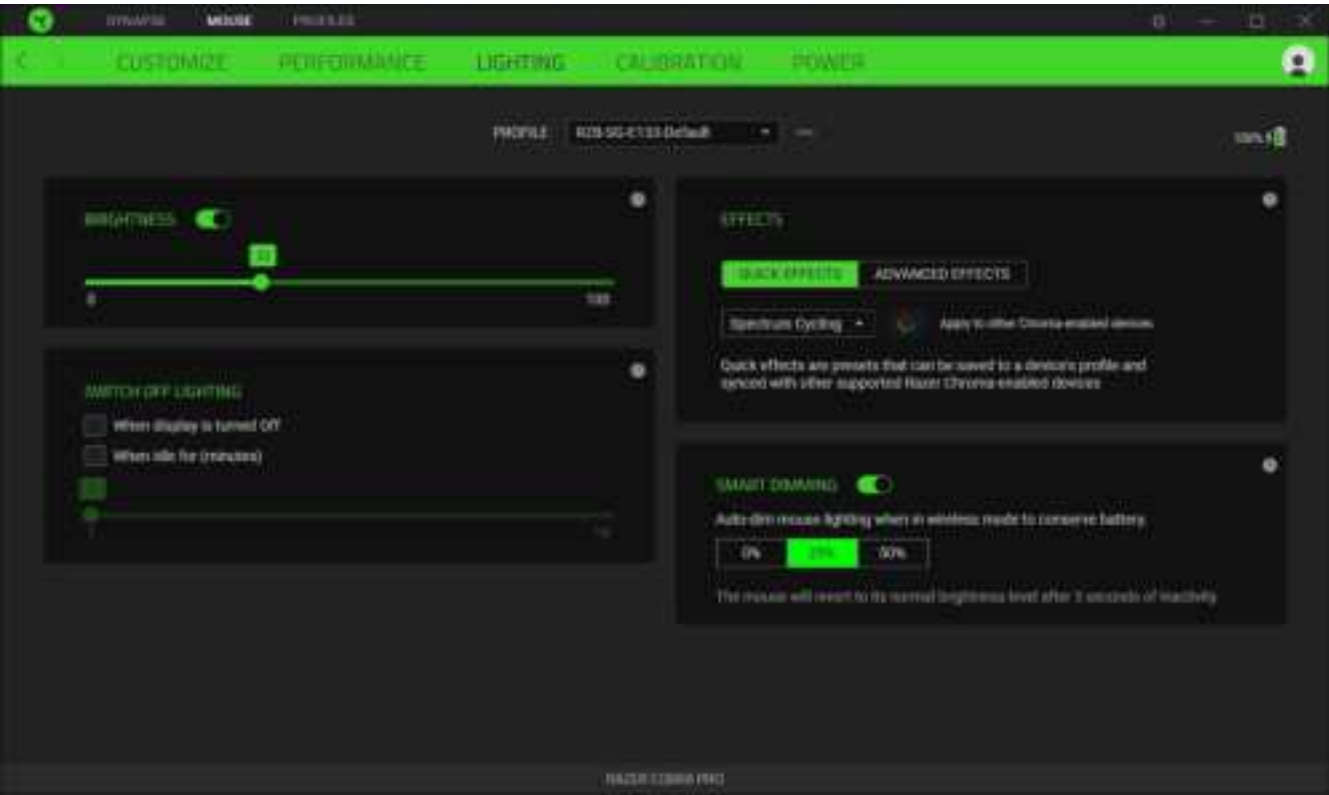

Brightness

You can turn off your Razer device's lighting by toggling the Brightness option or increase/decrease the luminance using the slider.

Switch Off Lighting







This power-saving tool allows you to disable your device's lighting in response to your system's display turning off and/or automatically power down when your Razer Cobra Pro has been idle for a set time.

Quick effects

Several quick effects can be selected and applied to your mouse's lighting, as listed here:

	Name	Description	How to set up
	Audio meter	The mouse will light up according to the audio level with a default spectrum of colors	Select a Color Boost level



	Breathing	The lighting will fade in and out of the selected color(s)	Select up to 2 colors or randomize colors
	Fire	The LEDs will light up in warm colors to mimic the motion of flames	No further customization required
	Reactive	The mouse will light up when you click any of the mouse buttons	Select a color and a duration
	Spectrum cycling	The lighting will cycle between 16.8 million colors indefinitely	No further customization required
	Starlight	Each LED will have a chance of fading in and out at a random time and duration	Select up to 2 colors or randomize colors and select a duration
	Static	The mouse will remain lit in the selected color	Select a color
	Wave	The lighting will scroll in the direction selected	Select a wave direction

If you have other supported Razer Chroma-enabled devices, you can synchronize their quick effects with your Razer device by clicking the Chroma Sync button (  ).

 Only devices that support the selected lighting effect will synchronize.

### Advanced Effects

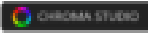
The Advanced Effects option allows you to choose a Chroma Effect you want to use on your Razer Chroma-enabled peripheral. To start making your own Chroma Effect, simply press the Chroma Studio button (  ).

### Smart Dimming

Set the mouse to dim its lighting automatically when using it in Razer HyperSpeed Wireless or Bluetooth mode. When left inactive for 3 seconds, the mouse will revert to its normal brightness.

## Calibration

The Calibration subtab allows you to optimize the sensor of your Razer mouse to any surface for better tracking.

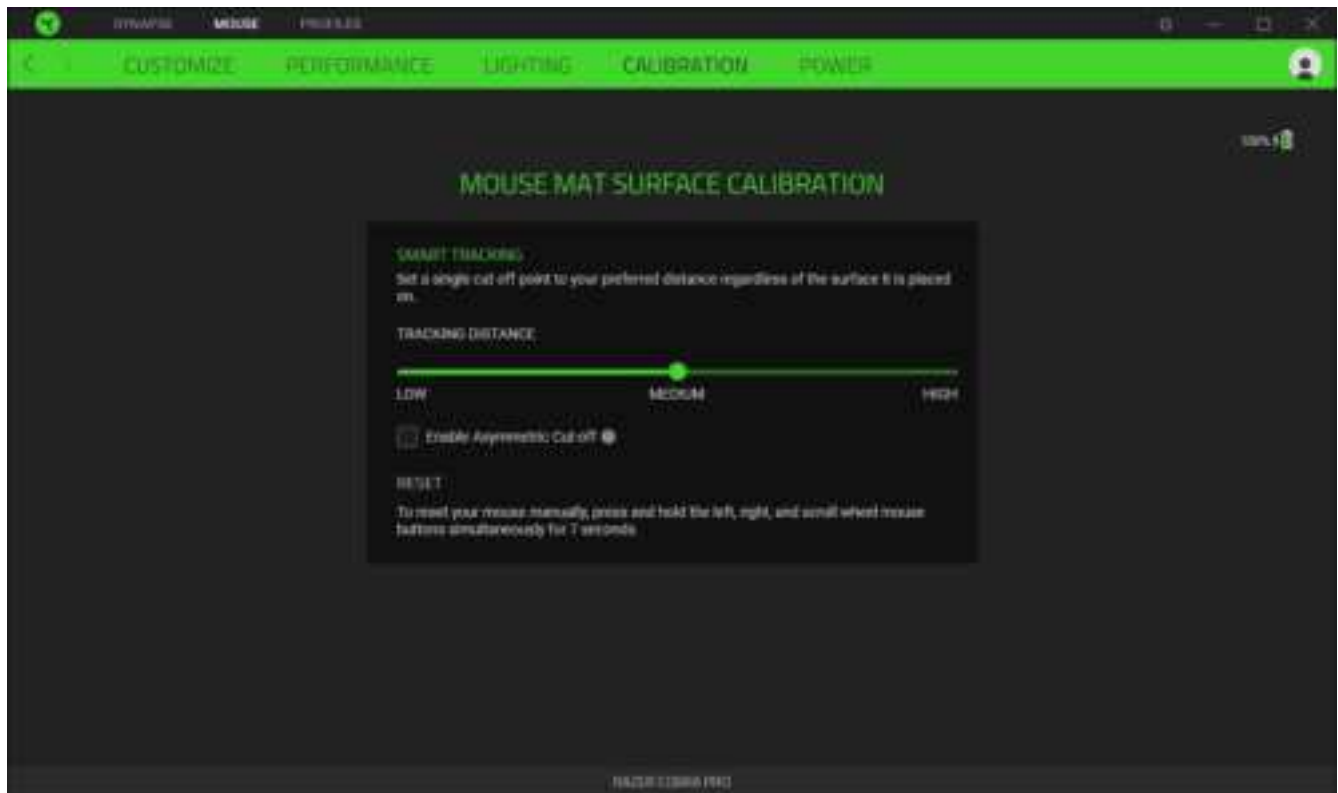

### Smart Tracking

Smart Tracking lets you set the distance the sensor stops tracking when it's lifted from its surface to avoid unwanted cursor movement. You may assign different values to the lift-off and landing distances by selecting the Enable Asymmetric Cut-Off.

## Power

The Power subtab allows you to set your device to enter sleep mode when idle for a certain amount of time or manage its energy consumption when wireless.

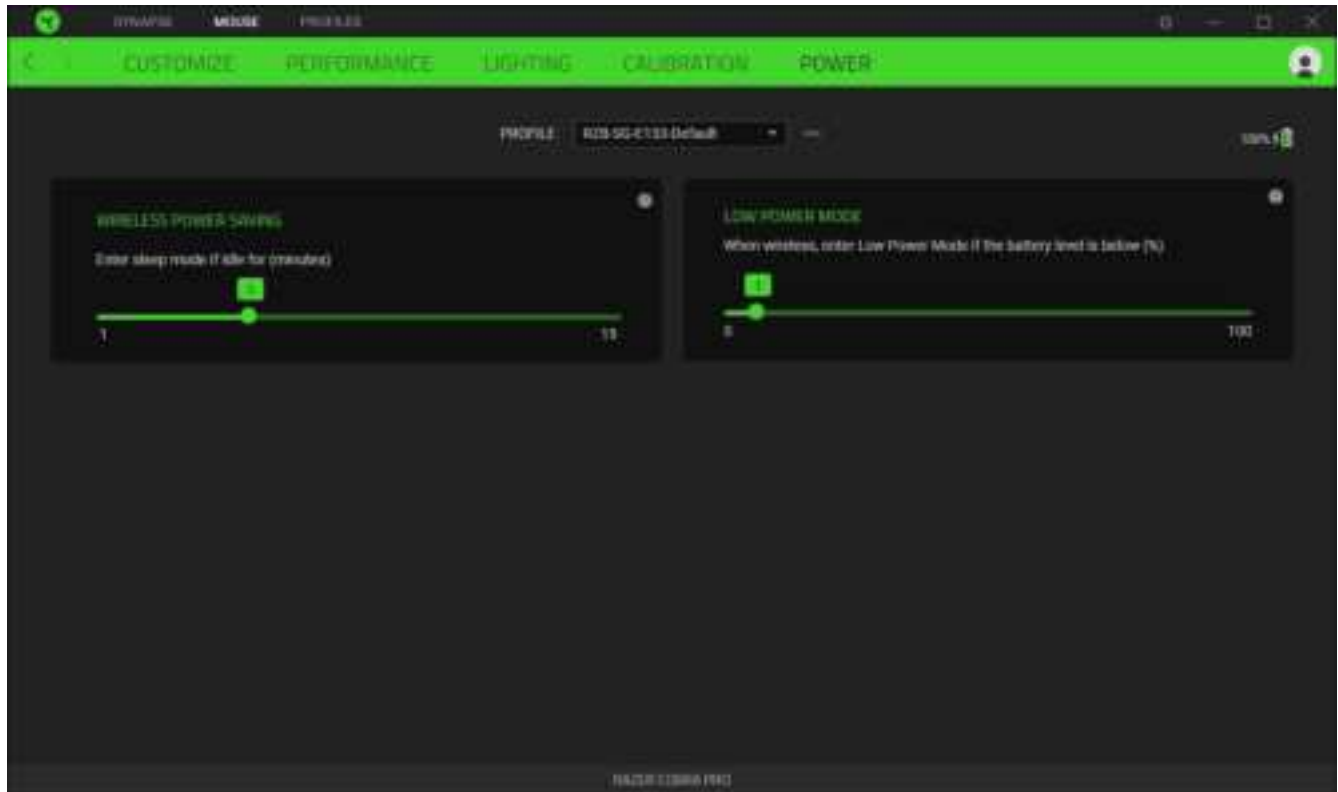



## PROFILES TAB

The Profiles tab is a convenient way to manage all your profiles and link them to your games and applications.

### Devices

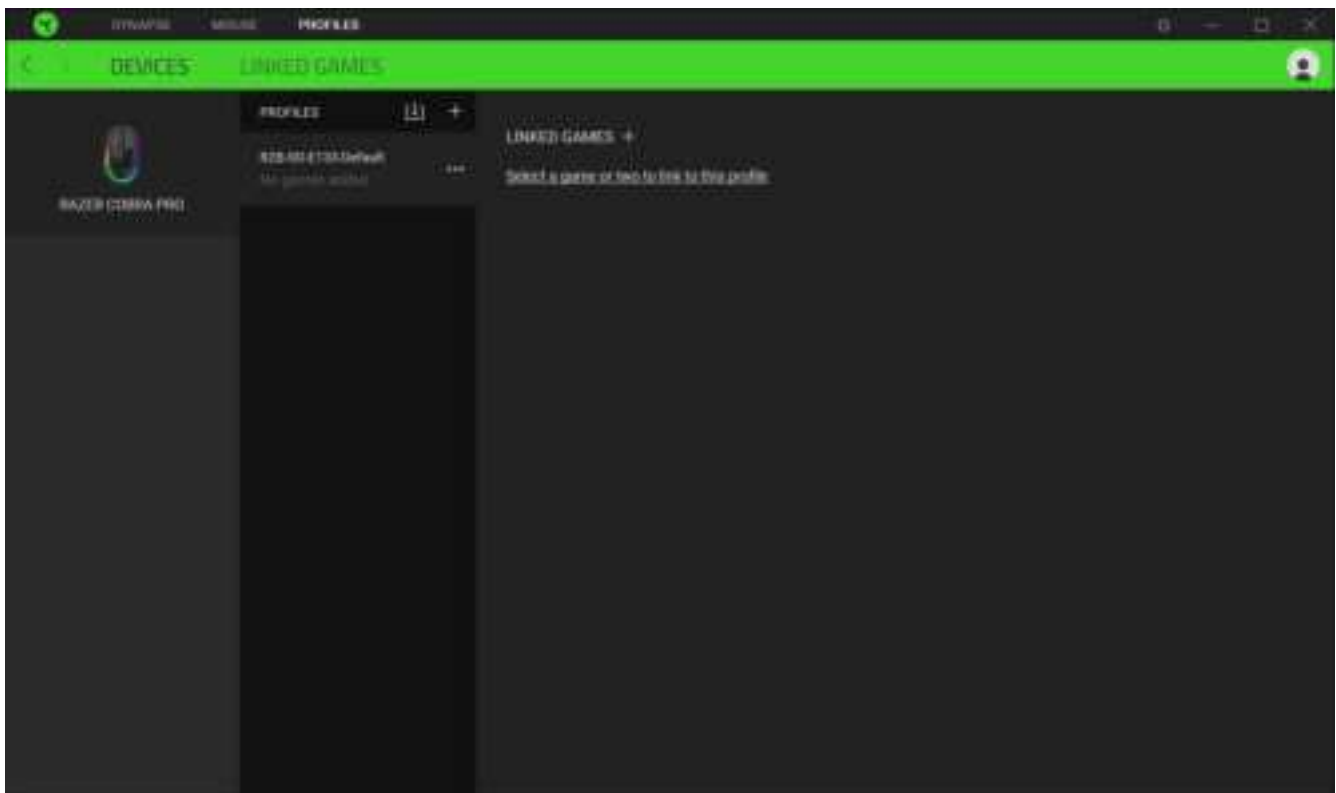
View which games are linked to each device's profiles or which Chroma Effect is linked to specific games using the Devices subtab.

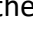
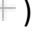

You can import Profiles from your computer or the cloud through the import button (  ) or create new profiles within the selected device using the add button (  ). To rename, duplicate, export, or delete a profile, simply press the Miscellaneous button (  ). Each profile can be set to activate when you run an application using the Linked Games option.

## Linked Games

The Linked Games subtab allows you to add games, view devices linked to games, or search for added games. You can also sort games based on alphabetical order, last played, or most played. Added games will still be listed here, even if they are not linked to a Razer device.

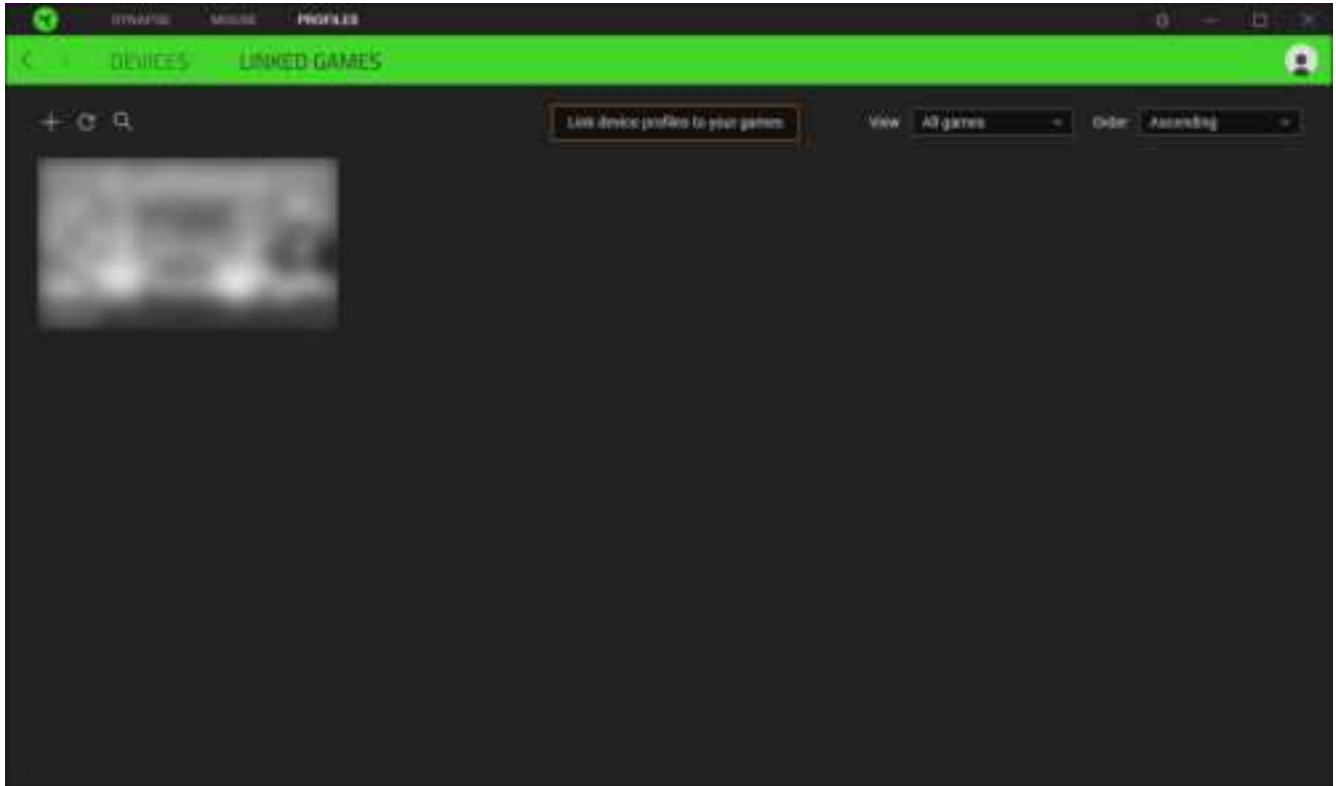

To link games to connected Razer devices or Chroma Effects, simply click on any game from the list, and then click **Select a device and its profile to launch automatically during gameplay** to select the Razer device or Chroma Effect it will link with. Once connected, you may click the Miscellaneous button ( ■■■ ) of the corresponding Chroma Effect or device to select a specific Chroma Effect or profile.

## SETTINGS WINDOW

The Settings window, accessible by clicking the (  ) button on Razer Synapse, enables you to configure the startup behavior and display language of Razer Synapse, control the recommendations you see on the Dashboard, check the firmware version and master guide of each Razer device, or perform a factory reset on any connected Razer device.

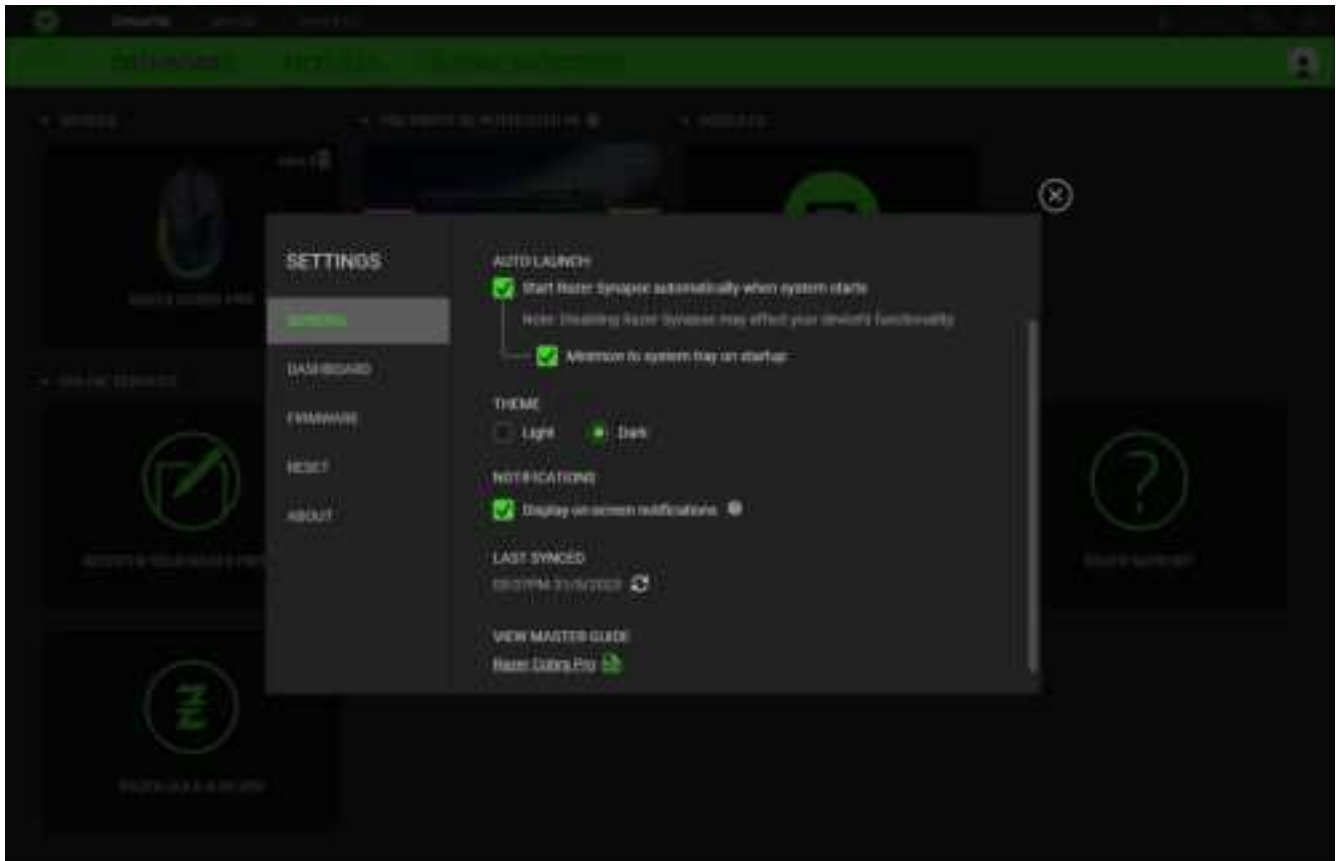

### General tab

The General tab lets you change the software's display language, startup behavior, theme, and on-screen notifications. You may also manually sync your profiles to the cloud (  ) or view the master guide of all connected Razer devices and installed modules.

### Dashboard tab

Use the Dashboard tab to customize which Razer device recommendations based on your setup, and the games you play will appear on the Dashboard.

### Firmware tab

Access the Firmware tab to view the current firmware version of your Razer device(s), and/or visit the Software and Firmware Update page to see whether a firmware update is available for your device(s).

## Reset tab

The Reset tab allows you to perform a factory reset on all connected Razer devices with on-board memory and/or reset Razer Synapse tutorials to acquaint yourself again with Razer Synapse's new features on its next launch.



*All profiles stored on the selected device's on-board memory will be erased when you reset a Razer device.*

## About tab

The About tab displays brief software information and copyright statement, and provides relevant links for its terms of use. You may also use this tab to check for software updates, or as quick access to Razer's social communities.

---

## 8. SAFETY AND MAINTENANCE

### SAFETY GUIDELINES

To achieve maximum safety while using your Razer Cobra Pro, we suggest that you adopt the following guidelines:

Should you have trouble operating the device properly and troubleshooting does not work, unplug the device and contact the Razer hotline or go to [support.razer.com](https://support.razer.com) for support.

Don't take apart the device, and don't attempt to operate it under abnormal current loads. Doing so will void your warranty.

Keep the device away from liquid, humidity, or moisture. Operate the device only within the specific temperature range of 0°C (32°F) to 40°C (104°F). Should the temperature exceed this range, unplug and/or switch off the device to stabilize the temperature to an optimal level.

### COMFORT

Research has shown that long periods of repetitive motion, improper positioning of your computer peripherals, incorrect body position, and poor habits may be associated with physical discomfort and injury to nerves, tendons, and muscles. Below are some guidelines to avoid injury and ensure optimum comfort while using your Razer Cobra Pro.

- Position your keyboard and monitor directly in front of you with your mouse next to it. Place your elbows next to your side, not too far away, and your keyboard within easy reach.
- Adjust the height of your chair and table so that the keyboard and mouse are at or below elbow-height.
- Keep your feet well supported, posture straight, and your shoulders relaxed.
- During gameplay, relax your wrist and keep it straight. If you do the same tasks with your hands repeatedly, try not to bend, extend or twist your hands for long periods.
- Don't rest your wrists on hard surfaces for long periods. Use a wrist rest to support your wrist while gaming.
- Don't sit in the same position all day. Get up, step away from your desk and do exercises to stretch your arms, shoulders, neck, and legs.

If you experience any physical discomfort while using your mouse, such as pain, numbness, or tingling in your hands, wrists, elbows, shoulders, neck, or back, please consult a qualified medical doctor immediately.



## MAINTENANCE AND USE

The Razer Cobra Pro requires minimum maintenance to keep it in optimum condition. Once a month, we recommend you unplug the device from the computer and clean it using a soft cloth or cotton swab to prevent dirt buildup. Don't use soap or harsh cleaning agents.

To get the ultimate experience in movement and control, we highly recommend a premium mouse mat from Razer. Some surfaces will cause undue wear on the feet requiring constant care and eventual replacement.

Do note that the Razer Cobra Pro's sensor is 'tuned' or optimized specially for the Razer mouse mats. This means that the sensor has been tested extensively to confirm that the Razer Cobra Pro reads and tracks best on Razer mouse mats.

## BATTERY WARNING

The Razer Cobra Pro contains a Li-ion rechargeable battery. In general, the life expectancy of such batteries is dependent upon usage. If you suspect that the Li-ion rechargeable battery inside the Razer Cobra Pro may be drained (has a low charge), try charging it.

**Caution:** Don't open, mutilate, or expose to conducting materials (metal), moisture, liquid, fire, or heat. Doing so may cause batteries to leak or explode, resulting in personal injury. Battery life varies with usage.

---

## 9. LEGALESE

### COPYRIGHT AND INTELLECTUAL PROPERTY INFORMATION

©2023 Razer Inc. All rights reserved. Razer, the triple-headed snake logo, Razer logo, "For Gamers. By Gamers.", and "Powered by Razer Chroma" logo are trademarks or registered trademarks of Razer Inc. and/or affiliated companies in the United States or other countries. All other trademarks are the property of their respective owners.

The Bluetooth® word mark and logos are registered trademarks owned by Bluetooth SIG, Inc., and any use of such marks by Razer is under license.

Windows and the Windows logo are trademarks of the Microsoft group of companies.

Razer Inc. ("Razer") may have copyright, trademarks, trade secrets, patents, patent applications, or other intellectual property rights (whether registered or unregistered) concerning the product in this guide. Furnishing of this guide does not give you a license to any such copyright, trademark, patent or other intellectual property right. The Razer Cobra Pro (the "Product") may differ from pictures whether on packaging or otherwise. Razer assumes no responsibility for such differences or for any errors that may appear. Information contained herein is subject to change without notice.

### LIMITED PRODUCT WARRANTY

For the latest and current terms of the Limited Product Warranty, please visit [razer.com/warranty](https://www.razer.com/warranty).

### LIMITATION OF LIABILITY

Razer shall in no event be liable for any lost profits, loss of information or data, special, incidental, indirect, punitive or consequential or incidental damages, arising in any way out of distribution of, sale of, resale of, use of, or inability to use the Product. In no event shall Razer's liability exceed the retail purchase price of the Product.

### GENERAL

These terms shall be governed by and construed under the laws of the jurisdiction in which the Product was purchased. If any term herein is held to be invalid or unenforceable, then such term (in so far as it is invalid or unenforceable) shall be given no effect and deemed to be excluded without invalidating any of the remaining terms. Razer reserves the right to amend any term at any time without notice.