

# USER MANUAL

Motorcycle Intercom System

**V4 Plus**

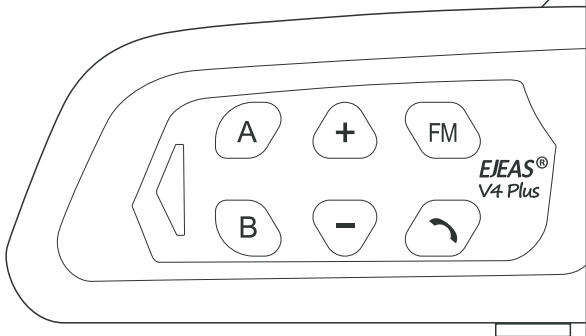

**EJEAS**

Q [www.ejeas.com](http://www.ejeas.com)

# Product Details

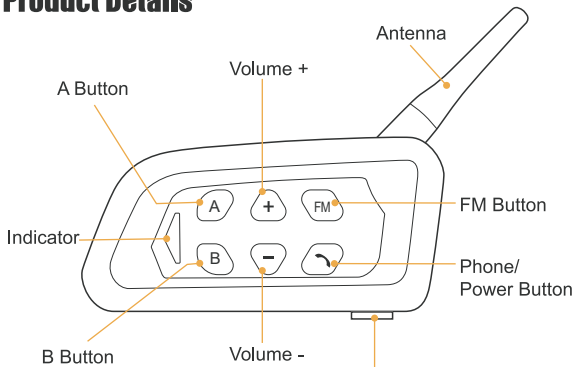

# Product Installation



- ① Loosen the screws of the clip, install it on your helmet for fixed.

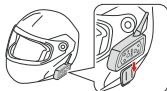

- ② Install the intercom on the clip.

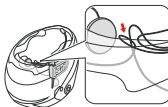

- ④ Organize the inside messy cables, and put them inside your helmet foam for easy wearing.



- ③ Use the Velcro stick inside your helmet, choose the stick / soft mic for your need.

# Product Operations

## Operation Diagram



Click



Double Click

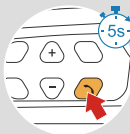

Long Press  
for 5s

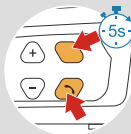

Long Press  
Simultaneously  
for 5s

## Basic Operations

**Power ON/OFF** Please charge it before using.

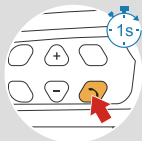

**ON** ? Prompt tone  
Standby ⚡ Blue light flashes slowly



**OFF** ⚡ Lights off

## Battery Level



or

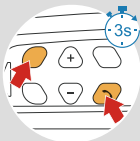

- ? "Battery Level High"
- ? "Battery Level Medium"
- ? "Battery Level Low"

## Low Battery Indication



- Red light double flashes quickly
- ? "Low Battery"

## Charging Indication



- Charging**
  - Red light is on
- Full**
  - Red light is off

## Volume Control

FM and intercom can be used at the same time.

### Intercom / Calling / Music / FM

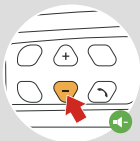

When Intercom & FM use simultaneously, FM volume control

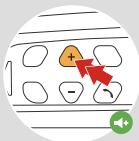

## Factory Reset

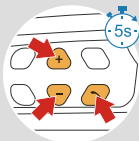

Long press the <Volume +>, <Volume ->, <Phone Button> for 5s at the same time.

- The red and blue lights quickly flash three times simultaneously
- ? "Restore Default Settings"

## Bluetooth Intercom

### 2-Way Intercom Pairing

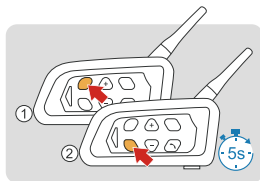

- 1 Long press both <A Button> of device 1 and <B Button> of device 2 for 5s, waiting to pair.

Red and blue lights flash alternately

Searching and pairing.

Pairing successfully.

Connected, start communication.

### 3-Way Intercom Pairing

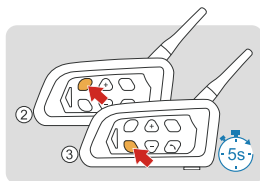

- 1 Pair device 1 and device 2 as above one step.
- 2 Long press both <A Button> of device 2 and <B Button> of device 3 for 5s, waiting to pair.

Red and blue lights flash alternately

Searching and pairing.

Pairing successfully.

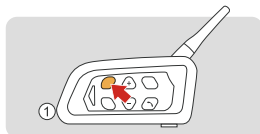

- 3 Click <A Button> of device 1.

{Blue light flashes once + stays on for 2s} and cycle

Connected, start communication.

## 4-Way Intercom Pairing

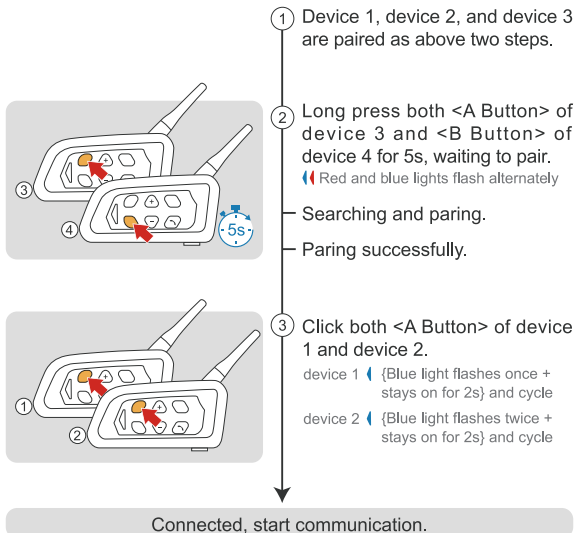

## Intercom Reconnection Reconnect after disconnection or boot.

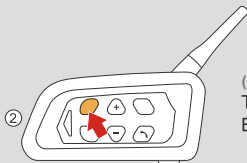

(Examples of the device 2)

To connect device 3, click <A Button> of device 2.

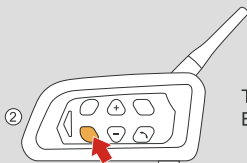

To connect device 1, click <B Button> of device 2.

Device 1 & device 2 (or device 2 & device 3) connection is successful.

⚡ {Blue light flashes once + stays on for 2s} and cycle

Device 1 & device 2 & device 3 simultaneously connected.

⚡ {Blue light flashes twice + stays on for 2s} and cycle

## Intercom Disconnection

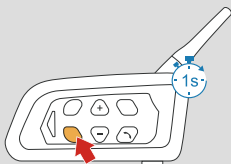
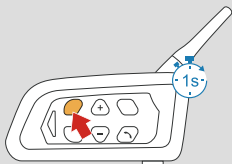

## Compatible with Old Intercom Pairing

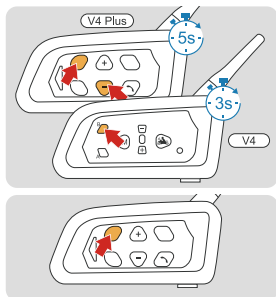

- 1 Long press both < Volume - > and <A Button> of V4 Plus for 5s, while long press <B Button> of V4 for 3s.

Red and blue lights flash alternately

Pairing successfully.

- 2 Click <A Button> of V4 Plus .

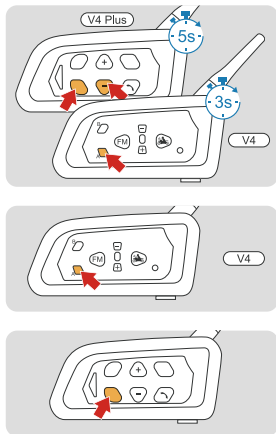

- 1 Long press both < Volume - > and <B Button> of V4 Plus for 5s, while long press <A Button> of V4 for 3s.

Red and blue lights flash alternately

- 2 Click <A Button> of V4.

Blue light flashes

Pairing successfully.

- 3 Click <B Button> of V4 Plus .



## Pairing of Bluetooth HFP-AG

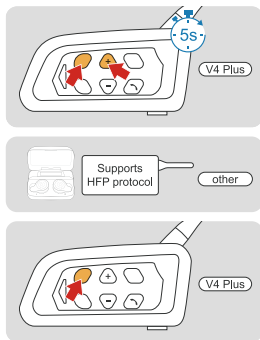

- 1 Long press both <Volume +> and <A Button> of V4 Plus simultaneously for 5s.  
Red and blue lights flash alternately
- 2 Other devices enter Bluetooth search mode.
- 3 Click <A Button> of V4 Plus to connect.

## Pairing of Bluetooth HFP-HF

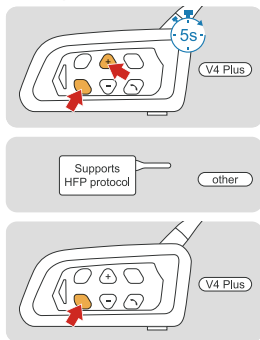

- 1 Long press both <Volume +> and <B Button> of V4 Plus simultaneously for 5s.  
Red and blue lights flash alternately
- 2 Other devices enter Bluetooth search mode.
- 3 Click <B Button> of V4 Plus to connect.

## Bluetooth Pairing

### Phone Pairing

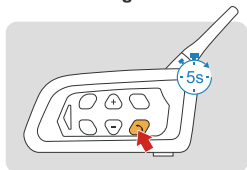

- 1 In standby mode, long press the <Phone Button> for 5s to enter the pairing state.

Red and blue lights flash alternately  
? "Phone Pairing"

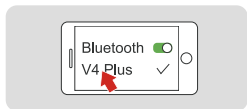

- 2 Turn on the Bluetooth of the mobile phone and click on the device.

Pairing successful.

Blue light twice flashes slowly  
? "Pairing Successful"



Current power will be shown on your phone.  
(the mobile phone needs to support HFP)

### Phone Reconnection

Automatically connect  
back to the last paired.

or

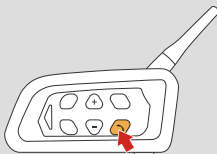

## Mobile Phone

### Answer a Call

Auto answering within 8s  
if no any operation.

or

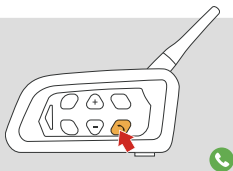

### Reject a Call



### Last Call Replay

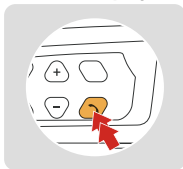

### End a Call

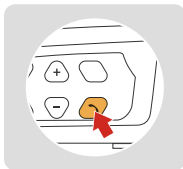

**TEL Priority** When listening to music/FM/intercom, and receiving a phone call.

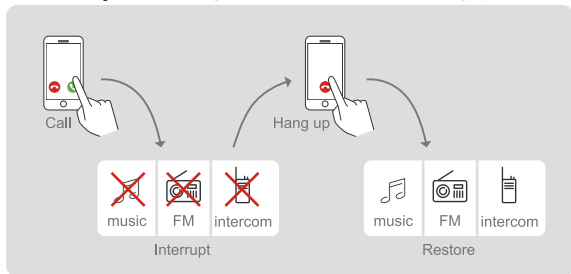

## Voice Assistant

Phone must support the voice assistant (Google assistant & Siri).

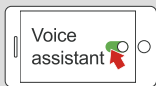

①

Turn on voice assistant.

②

Long press the <Phone Button> for 1s.



## Music Control

### Music Play/Pause



### Music Switching

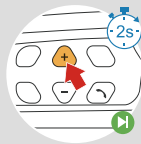

## FM Radio

### FM On/Off 76~108MHz

Auto search and radio, intercom and radio could working at the same time.



Long press <FM Button> for 1s to open FM.

Blue light is always on for 4s

Red light double flashes quickly

⚡ "FM radio"

Long press <FM Button> for 1s to close FM.

⚡ "FM radio off"

## Frequency Switching



## EUC Remote Control (Optional)

### EUC Details

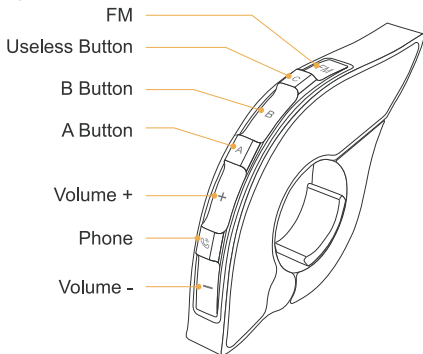

## EUC Pairing

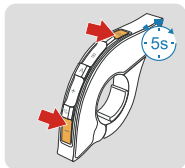

- 1 Long press both <FM Button> and <Volume -> of EUC for 5s to clear the pairing record of EUC.

 Red and Blue lights consistently on



- 2 Long press both <Phone Button> and <B Button> of V4 Plus for 5s.

 Red and blue lights flash alternately and quickly  
? "Remote Control Pairing"



- 3 Click any key of EUC.

**Pairing Successfully** ? "Pairing Successful"

(If EUC cannot be successful paired in 2 mins, it will automatically exit the pairing mode.)

NOTE: This equipment has been tested and found to comply with the limits for a Class B digital device, pursuant to part 15 of the FCC Rules. These limits are designed to provide reasonable protection against harmful interference in a residential installation. This equipment generates uses and can radiate radio frequency energy and, if not installed and used in accordance with the instructions, may cause harmful interference to radio communications. However, there is no guarantee that interference will not occur in a particular installation. If this equipment does cause harmful interference to radio or television reception, which can be determined by turning the equipment off and on, the user is encouraged to try to correct the interference by one or more of the following measures:

- Reorient or relocate the receiving antenna.
- Increase the separation between the equipment and receiver.
- Connect the equipment into an outlet on a circuit different from that to which the receiver is connected.
- Consult the dealer or an experienced radio/TV technician for help

Changes or modifications not expressly approved by the party responsible for compliance could void the user's authority to operate the equipment. This device complies with Part 15 of the FCC Rules. Operation is subject to the following two conditions:

- (1) this device may not cause harmful interference, and
- (2) this device must accept any interference received, including interference that may cause undesired operation