

49825 Setting Face recognize

1. Open IE browser , enter camera IP and Install plugin to log in camera web.

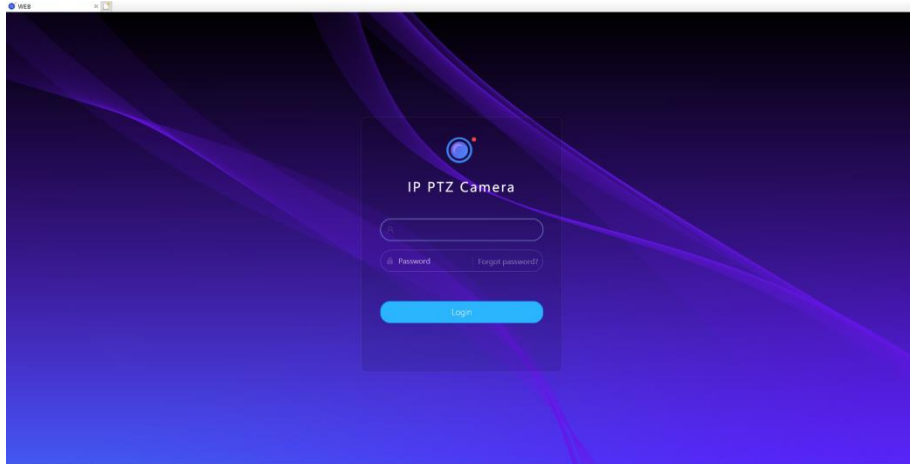

2. Click on the "", Select the "AI".

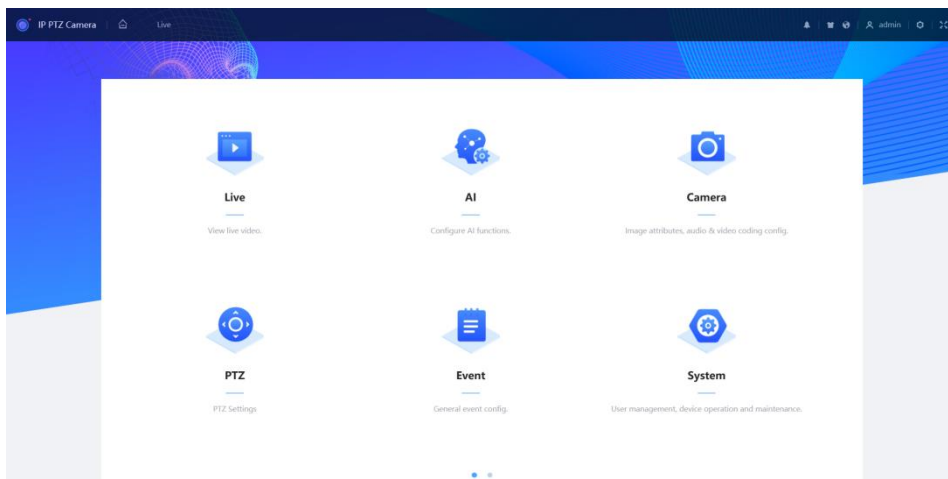

3. Select Face Detection and go to the next step.

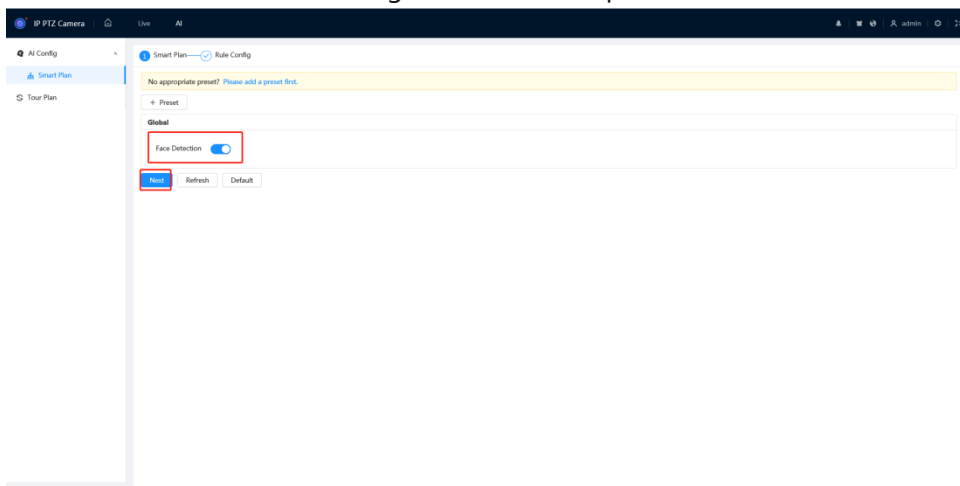

4. Click on "Face Detection".

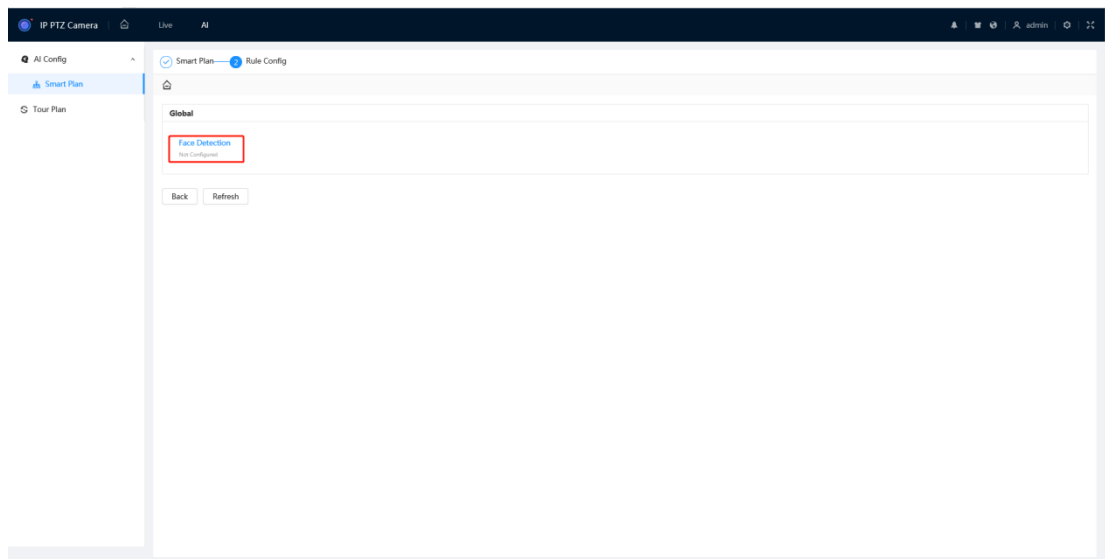

5. The icon beside the image can select the detection size/scope, etc. Click "Enable" to enable facial enhancement, and click "Apply" to apply.

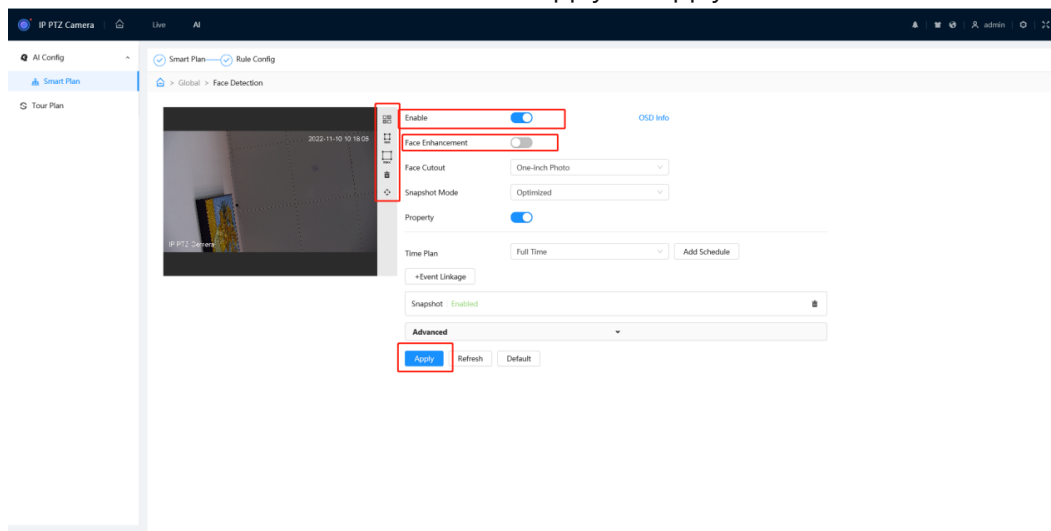

6. On the Live screen, select Face Mode.

