

RCW-400A

USER MANUAL

Elitech cloud login: www.i-elitech.com.



iOS APP
Scan the QRcode or
download on the App Store



Android APP
Scan the QRcode or
download on the Google play

Overview

RCW-400A is a 4-channel temperature and humidity data logger that not only has wide temperature measurement ranges, but also provides high precise sensitivity. Its large LCD screen can display time, current working status, memory capacity and recorded data information etc. at the same time. Its embedded buzzer and relay alarm design will give on-site alerting functions, where its SIM card slot design also allows SMS text message alerts via GSM technology. With the combination of its supported 3G data transmission method and Elitech cloud platform, users can not only check real-time data online, but also support remote online monitors and managements on all saved data through the Elitech App and the Elitech cloud platform via any web browsers.

The standard accessory for RCW-400A is the two-channel sensors wirings: One temperature and one humidity sensors. Users can extend to four-channel wirings: Two temperature and two humidity sensors or the four temperature sensors. The battery is built-in rechargeable lithium battery that also support continuous real-time data uploading and SMS text alerts even under power outages and blackouts. It can be widely used in food, pharmaceutical, cater-

Features

- ◆ Monitor the status of cold storages.
- ◆ Monitor and record temperature and humidity data.
- ◆ SMS text alert in case of over temperature and humidity limits.
- ◆ Continuously running for at least 6 hours in case of power outage.
- ◆ Buzzer alarm and relay alarm functions.
- ◆ Adjustable recording interval as needed.
- ◆ Maximum 20,000 recording points inside the device memory.
- ◆ Unlimited recording points on the cloud server.
- ◆ Remote data monitoring, uploading, printing and management via the Elitech cloud

Specifications

- ◆ Power supply: 12V/2.5A(DC)
- ◆ Measurement range: -40°C~ 70°C
- ◆ Temperature accuracy: $\pm 1.0^{\circ}\text{C}$ (-25°C~0°C); $\pm 0.5^{\circ}\text{C}$ (0°C~40°C); $\pm 2^{\circ}\text{C}$ (other);
If the sensor wire is longer than 50m, the accuracy deviates 1%
- ◆ Resolution: 0.1°C
- ◆ Humidity range: 10%RH~ 90%RH.
- ◆ Humidity accuracy: $\pm 5\%$ RH(@25°C, 30%RH~80%RH)-Typical situation;
 $\pm 5\%$ RH(@10°C, 30%RH~80%RH);
 $\pm 5\%$ RH(@40°C, 30%RH~80%RH)
- ◆ Temperature sensor: NTC
- ◆ Humidity sensor: Honeywell
- ◆ Log interval: 1 minute to 24 hours settable
- ◆ Memory: Maximum 20,000 readings for each channel
- ◆ Operating environment: Indoor use only, no exposure to rain or sun under
Temperature: -10°C~45°C, relative humidity: 30%~70%;
- ◆ Alarm output: Buzzer and relay
- ◆ Communication interface: 3G, SMS
- ◆ Battery: 3.7V, 2200mAH lithium battery

LCD Display

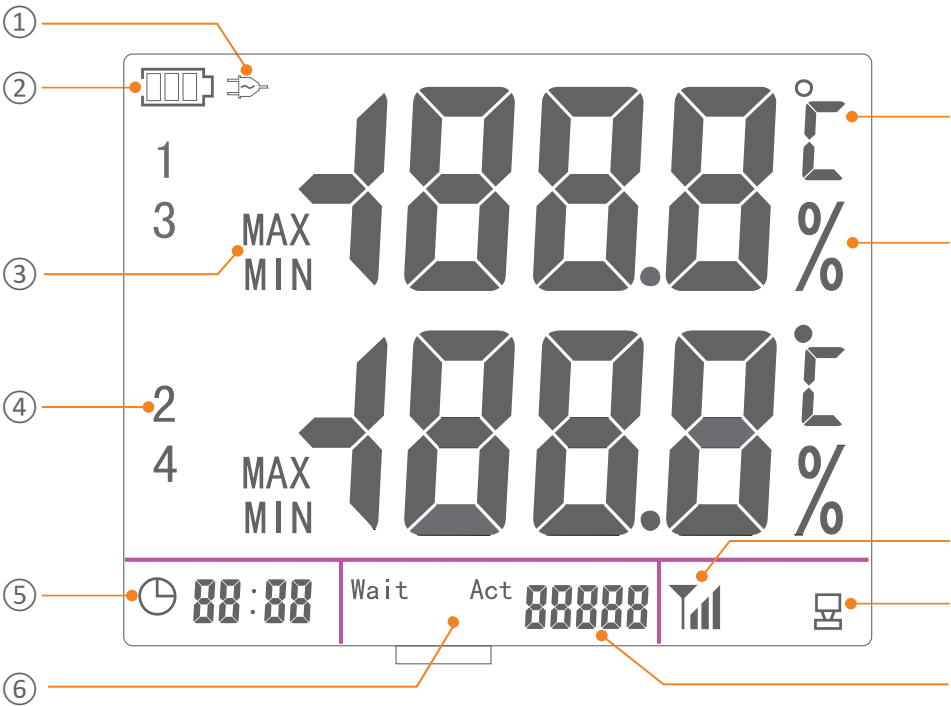

(1) Power charging indicator

(2) Battery level indicator

(3) Over limit alarm indicator: a.MAX: Over upper-limit; b. MIN: Nnder lower-limit

(4) Sensor channels: Rotate display 1&2 channels, 3&4 channels

a. Channel 1: Within pin 6,7,8,9 c. Channel 3: pin 14&15

b. Channel 2: Within pin 10,11,12,13 d. Channel 4: pin 16&17

(5) Date and time

(6) Recording status: a. Wait: waiting for recording; b. Act: recording

(7) Recorded points

(8) GSMnetwork signal strength for SIM card

(9) Elitech Cloud platform connecting indicator

(10) Humidity unit

(11) Temperature unit

Apperance

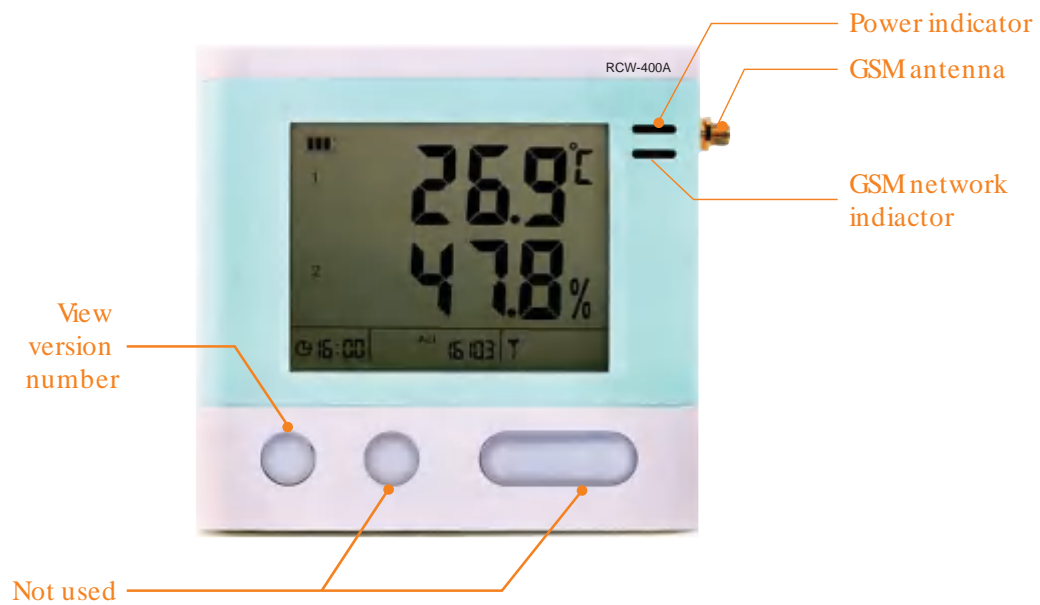

Operation

(1) Access the device ID

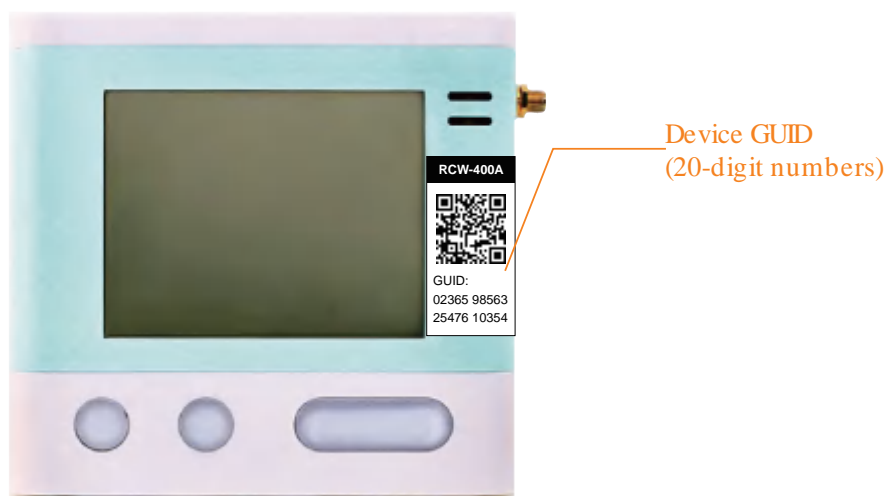

(2) SIM card installation and replacement

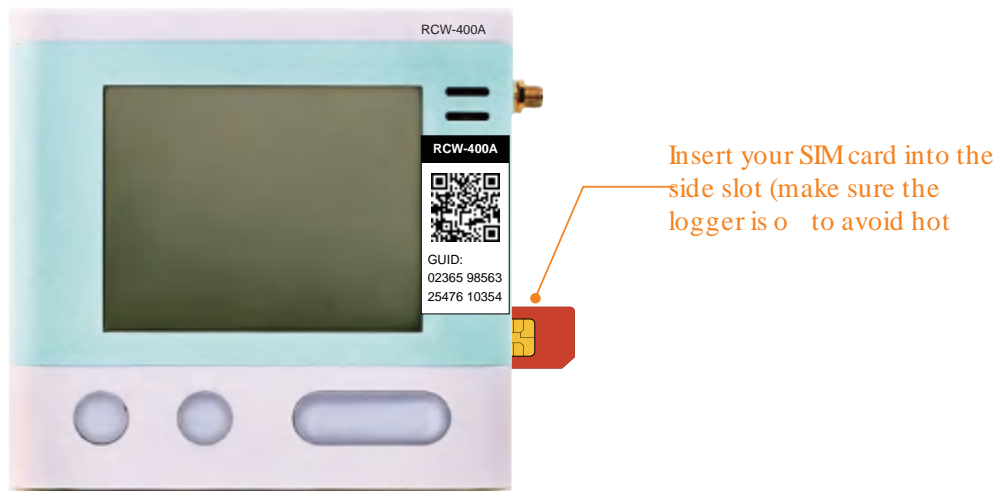

(3) Antenna installation

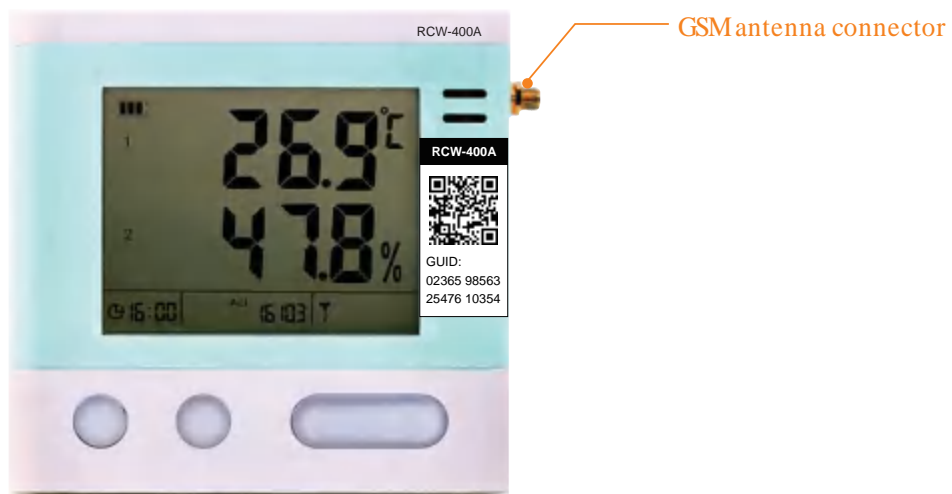

(4) Power ON/OFF and Charging

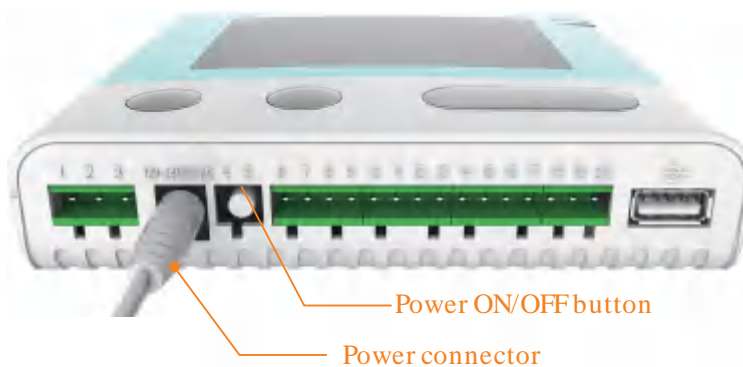

Sensors Installation

(1) Wiring diagram for 2 channel temperature sensors:
Channel 1 to pin 8&9, Channel 2 to pin 12&13.

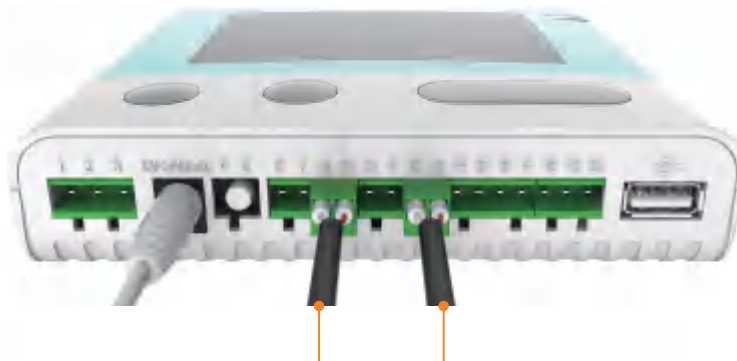

Wiring diagram for 2 channel temperature sensors

(2) Wiring diagram for 4 channel temperature sensors:
Channel 1 to pin 8&9, channel 2 to pin 12&13, channel 3 to pin 14&15, channel 4 to pin 16&17.



Wiring diagram for 4 channel temperature sensors

(3) Wiring diagram for 4 channel temperature and humidity sensors:
2 channel humidity sensors: One channel to pin 6, 7, 8, 9. Another one to pin 10, 11, 12, 13;
2 channel temperature sensors: One channel to pin 14&15, another one to pin 16&17.



2 channel humidity sensors 2 channel temperature sensors

(4) Wiring diagram for 2 channel temperature and humidity sensors:

1 channel temperature sensor: one channel to pin 8&9,

1 channel humidity sensor: one channel to pin 10, 11, 12, 13.



1 channel temperature sensor

1 channel humidity sensor

Note: The measured values will appear on screen after sensors plugged in for 15 to 20 seconds.

Elitech App

1. Download and Login:

Please scan the QRcode on the front of the manual or search Elitech on App Store or Google Play to download Elitech app.

Register and login to your account.

2. Add Device

Follow the steps below.

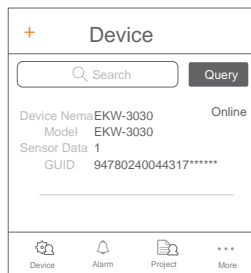

① Click "+".

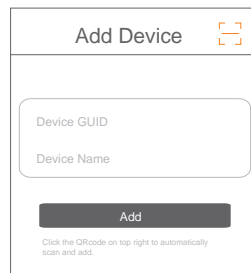

② Click and scan the QRcode on the back of the device.

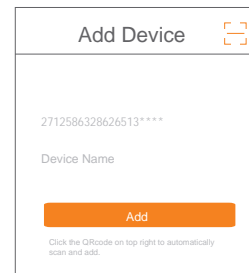

③ Click "Add" and the device will be added.

Elitech Cloud

1. Login Cloud Portal

Please type in the URL <http://www.i-elitech.com> to login for more operation.

Click 'Help' to obtain Cloud and App operation instructions.

2. Top up SIMcard

Please refer to the App Instruction Manual to recharge your SIM card. You may experience it for two month for free.



Elitech Technology, Inc.

1551 McCarthy Blvd Suite 112 Milpitas CA95035

Sales Support:sales@e-elitech.com

Tech Support: info@e-elitech.com

<http://www.elitechlog.com>