



**Affordable. Reliable. Home Improvement.**

## **MASSAGE CHAIR**

**MODEL: BH-8315**

**1. Introduction to the functions of the rotary knob button:**

<https://www.youtube.com/playlist?list=PL0BwQM2Ykbl6ljBDqagI7EybAZ42hyDOQ>

**2. Bluetooth Operation and Usage instructions:**

<https://www.youtube.com/playlist?list=PL0BwQM2Ykbl7zc2GEZIMldJsNdGjeNfJ->

**3. Zero Gravity Operation Usage Video:**

<https://www.youtube.com/playlist?list=PL0BwQM2Ykbl4Sw7KiG6g8Qx6S0FEEnE7bd>

**4. Screen Operation Guide Video Commentary:**

<https://www.youtube.com/playlist?list=PL0BwQM2Ykbl6dtWOtTsuVJuvucvnsjS1>

**5. 4D Intensity Adjustment Video Commentary:**

<https://www.youtube.com/playlist?list=PL0BwQM2Ykbl6WZaeHw9qzxUKz1ArQjeun>

**6. Offline Voice Operation Video Explanation:**

[https://www.youtube.com/playlist?list=PL0BwQM2Ykbl59\\_oFfElwoN\\_wD\\_htv1fNs](https://www.youtube.com/playlist?list=PL0BwQM2Ykbl59_oFfElwoN_wD_htv1fNs)



Technical Support and E-Warranty Certificate

[www.vevor.com/support](http://www.vevor.com/support)

# VEVOR



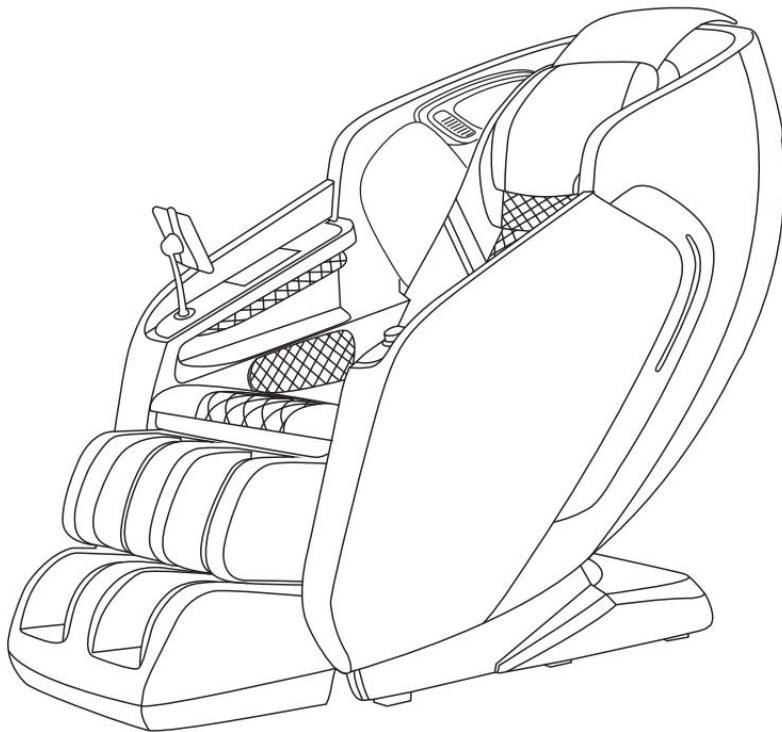

Affordable. Reliable. Home Improvement.

## MASSAGE CHAIR

**MODEL: BH-8315**



This is the original instruction, please read all manual instructions carefully before operating. VEVOR reserves a clear interpretation of our user manual. The appearance of the product shall be subject to the product you received. Please forgive us that we won't inform you again if there are any technology or software updates on our product.

	Warning-To reduce the risk of injury, user must read instructions manual carefully.
	Compliance is a CE security certification.
	<p><b>CORRECT DISPOSAL</b></p> <p>This product is subject to the provision of European Directive 2012/19/EC. The symbol showing a wheeled bin crossed through indicates that the product requires separate refuse collection in the European Union. This applies to the product and all accessories marked with this symbol. Products marked as such may not be discarded with normal domestic waste, but must be taken to a collection point for recycling electrical and electronic devices.</p>
	<b>Warning-</b> For Indoor Use Only
	<p><b>FCC Information:</b></p> <p><b>CAUTION:</b> Changes or modifications not expressly approved by the party responsible for compliance could void the user's authority to operate the equipment!</p> <p>This device complies with Part 15 of the FCC Rules. Operation is subject to the following two conditions:</p> <ol style="list-style-type: none"> <li>1) This product may cause harmful interference.</li> <li>2) This product must accept any interference received, including interference that may cause undesired operation.</li> </ol> <p><b>WARNING:</b> Changes or modifications to this product not expressly approved by the party responsible for compliance could void the user's authority to operate the product.</p> <p><b>Note:</b> This product has been tested and found to comply with the limits for a Class B digital device pursuant to Part 15 of the FCC Rules, These limits are designed to provide reasonable protection against harmful interference in a residential installation.</p> <p>This product generates, uses and can radiate radio frequency</p>

	<p>energy, and if not installed and used in accordance with the instructions, may cause harmful interference to radio communications. However, there is no guarantee that interference will not occur in a particular installation. If this product does cause harmful interference to radio or television reception, which can be determined by turning the product off and on, the user is encouraged to try to correct the interference by one or more of the following measures.</p>
--	--

- Reorient or relocate the receiving antenna.
- Increase the distance between the product and receiver.
- Connect the product to an outlet on a circuit different from that to which the receiver is connected.
- Consult the dealer or an experienced radio/TV technician for assistance.

## SAFETY INSTRUCTIONS

### **WARNING:**

**Before using, please read all instructions. Use the original power cord, and follow the specifications for power connection and switch operation to prevent safety hazards.**

**When using electronic products, follow basic safety precautions to check for the risks of electric shock, burns, fire, or personal injury, including the following:**

1. Be sure to use an outlet that matches the plug.
2. Make sure that the plug is fully inserted into the socket to reduce the risk of short circuit or fire.
3. After use or before cleaning, be sure to unplug the plug in time.
4. Do not use this product at high temperatures.
5. Do not store or use this product outdoors or in direct sunlight.
6. If there is a sudden power failure during use, please set the switch to the "0" position immediately, and unplug the plug to avoid damage to the product when a call comes in.
7. Do not operate the massage chair if the cord is wet or damaged.
8. Do not insert or unplug the plug with wet hands to avoid accidents.
9. When a child, handicapped, or handicapped person is near or using a massage chair, someone must be present to look after him.
10. Only use this product for the purposes described in this manual.
11. Do not use accessories not provided by Momoda.
12. Do not stand on it or jump on the calf rest so as not to cause damage.
13. Please do not try to sit on the armrest or backrest, so as not to tip the massage chair over and cause an accident.
14. Do not go to sleep during the massage.
15. Please keep the massage chair clean and avoid inserting other objects into the gaps of the massage chair
16. Do not move the massage chair directly by pulling the power cord.
17. Before each use, check whether there are abnormal cracks in the flannelette of the backrest of the massage chair.

18. This product is designed for home use only.
19. When you are not sure whether you can use the massage chair, please consult your doctor.
20. In order to avoid discomfort or injury caused by using this massage chair, the following people should consult a physician before using this product: those receiving treatment, with back disease, abnormal or distorted cervical spine.
21. If you feel pain during use, please stop using it immediately. If it is damaged during use, please seek medical attention immediately.
22. Do not massage red, swollen or inflamed skin.
23. This product only provides comfortable massage enjoyment for the family. It is not a professional massage medical device, so it cannot replace professional treatment.
24. It is recommended to use the massage chair for 30 minutes a day, and massage the same part should not exceed 15 minutes, otherwise excessive massage will result in counterproductive effects, and long-term use will cause the massage chair to overheat and shorten the service life of the product.
25. Do not use this product in an environment where gas or oxygen is injected. This product is not suitable for children under 12 years old.
26. Those who are not allowed to use this product: those who are physically, emotionally, or mentally defective, or who lack experience and knowledge. Unless they are supervised or instructed by the person responsible for their safety regarding the use of the product.
27. Children should be supervised to ensure that they do not play with the massage chair.
28. If the power cord is damaged, it must be replaced with a special cord or a special component purchased from its manufacturer or maintenance department.
29. The surface of the appliance heats up, so people who are not sensitive to heat must pay attention to it.
30. Do not use this machine under a voltage that does not meet the standards of this machine.
31. This product must use a grounded three-core power socket, and there

should be are liable and good grounding device.

32. Damaged leather or cloth covers should be replaced in time. Do not use this machine to avoid personal injury.
33. Do not allow water or moisture to enter the hand controller to avoid control failure.

## SAVE THIS MANUAL

### PARTS LIST

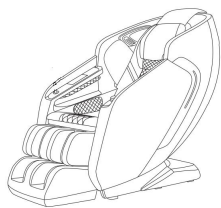

1PCS



1PCS



1PCS



1PCS

## ASSEMBLY STEP

1. Unpack the carton and take all massage chair units out of the carton.

lift the carton vertically

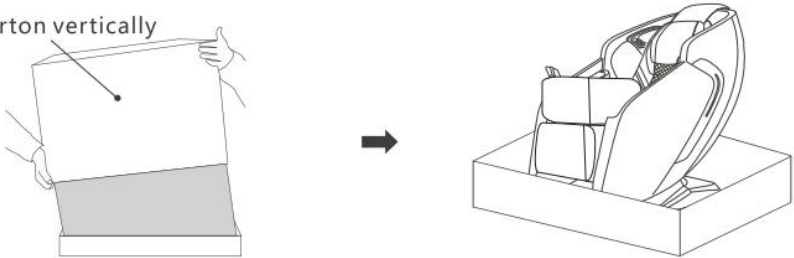

2. Seat Cushion Installation

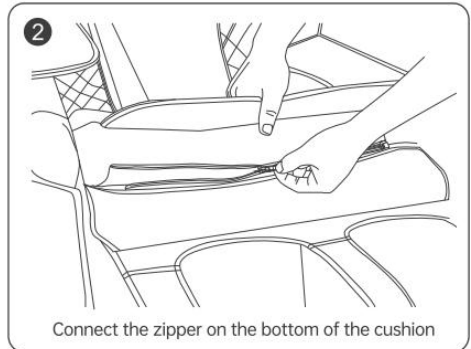
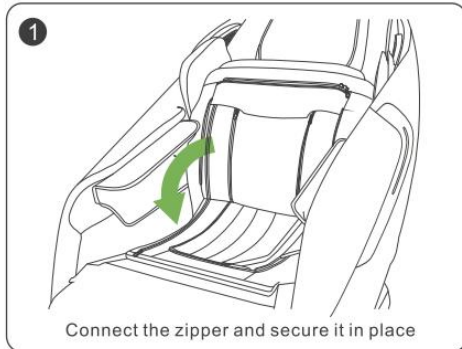

3. Install Tablet Holder

Insert the lower end of tablet holder into the socket and turn clockwise to secure the holder into place. Use an allen key to tighten the remote control bracket.

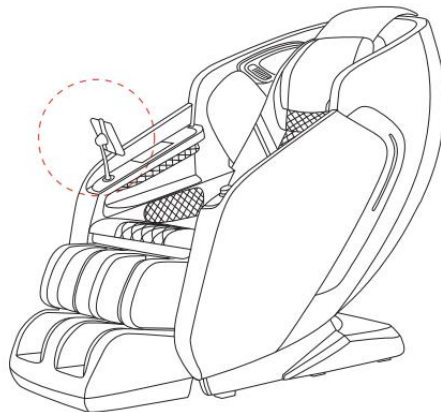
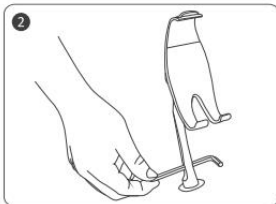
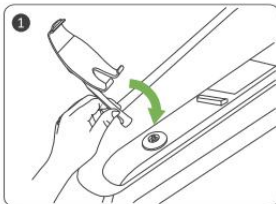

#### 4. Placing the Massage Chair

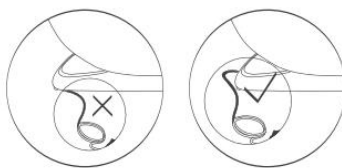
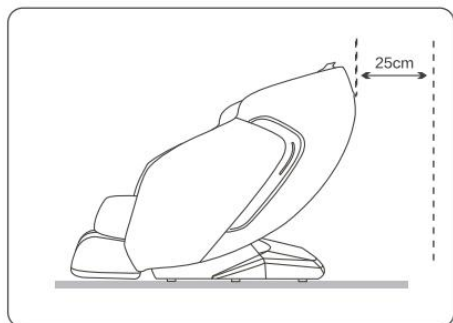

Do not place the massage chair on the power cord or run over the power cord.



#### CAUTION

- ◆ Carry the massage chair out of the carton and place at a desired location.
- ◆ Do not put this product near heat source, open flame or in direct sunlight.
- ◆ This may cause fading or damage.
- ◆ The bottom of the massage chair may scratch the floor, we recommend placing a piece of carpet or soft mat underneath it to avoid damaging the floor.
- ◆ Please allocate clearance to the front and back (a minimum 25cm clearance behind the backrest) of the product;
- ◆ Do not put the massage chair in high moisture environment or on uneven unlevelled floor.
- ◆ Keep it 1 meter away from the TV, radio or other audio/video appliance to avoid signal interference.

#### 5. Connect to power

Plug the power cord into the chair and connect to the power outlet, turn on the main power switch, you are set to go.

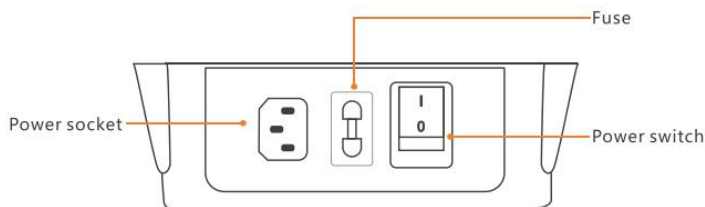

## MOVEMENT AND STRUCTURE

### Moving the Massage chair

1. Push down on the backrest and tilt the chair about 30°
2. Roll the chair on its casters to the desired location.
- 3.

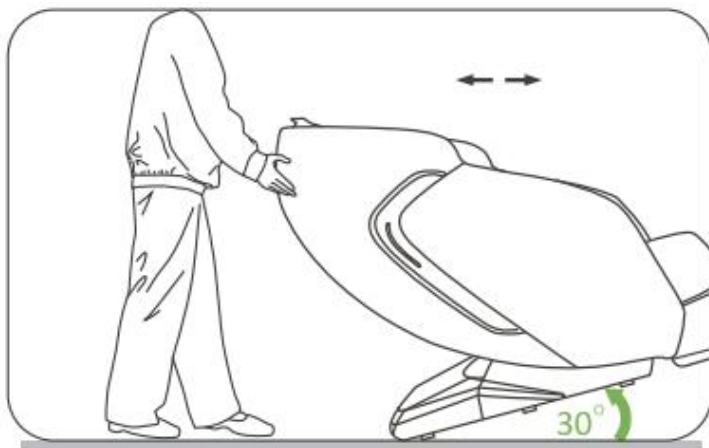

CAUTION

- Do not move the chair when there is user inside.
- Moving the chair may scratch the floor, we recommend placing a piece of carpet or soft mat underneath it.
- Please hold the backrest firmly when moving the massage chair to avoid falling.
- Make sure the footrest is fully retracted when moving the massage chair to avoid damage.

## Structure

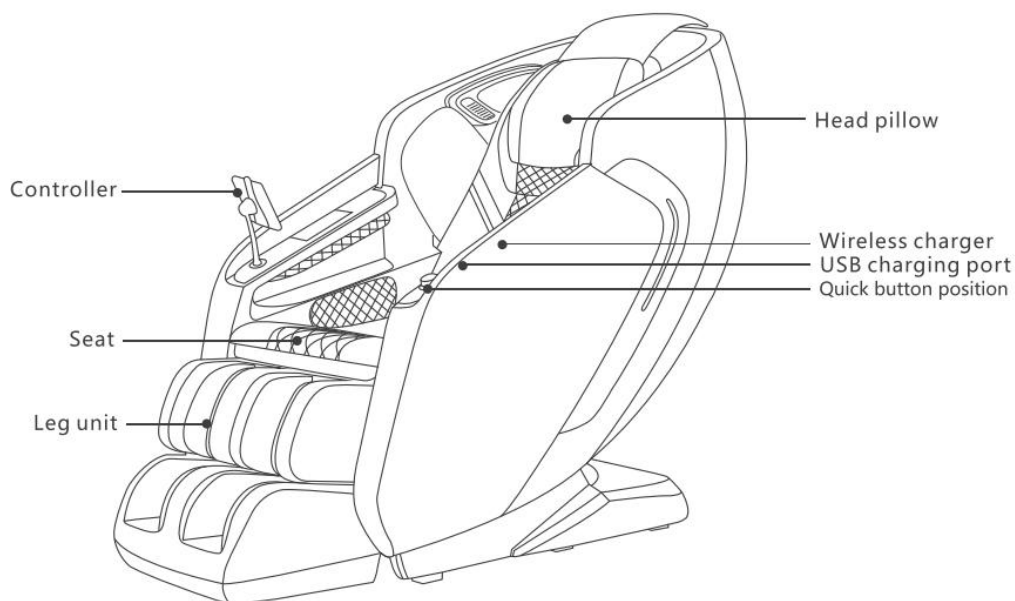

## Quick Button Instructions

Quick button position

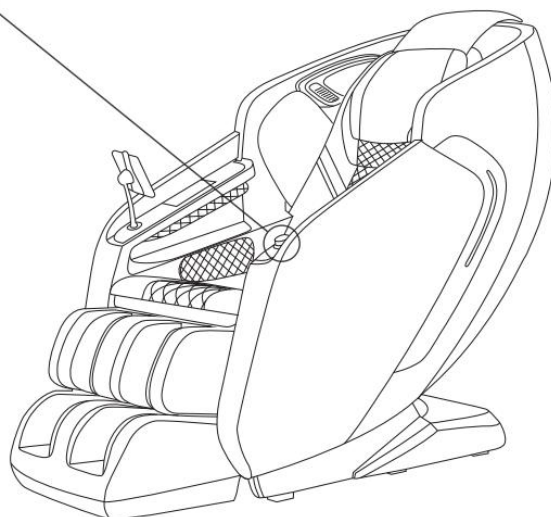

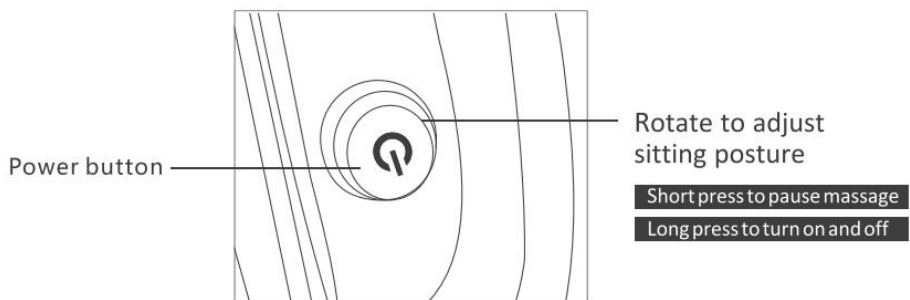

- Press and hold the power button for 3 seconds to turn on/off massage chair;
- After powering on, short press to pause massage, then short press to resume massage







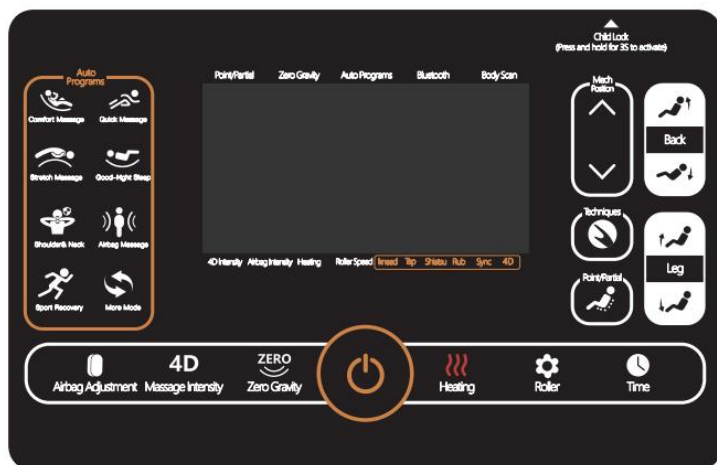

- After powering on, rotate the knob clockwise to raise the backrest; rotate it counterclockwise to lower the backrest.

## CONTROLLER INSTRUCTIONS

### Button Distribution Of Control Panel



### Controller Instructions

-  **Child Lock**  
When connected to power, press and hold this button for 3 seconds to lock/unlock the controller.
-  **Power Button**  
Short press to power on, short press to pause/resume massage during operation, and long press to power off.
-  **Comfort Massage**  
Moderate massage strength, specially designed for female users, providing a massage program that shapes a graceful and light figure without burden.
-  **Quick Massage**  
Quick and precise combination massage, saving time and relaxing the body.
-  **Stretch Massage**  
Full-body stretching to cater to users who need to stretch their muscles, relieving fatigue and restoring body vitality and flexibility.
-  **Good-night Sleep**  
Gentle massage with coordinated , alleviating fatigue and promoting a restful sleep, easing tension for a serene slumber.



### Shoulder & Neck Massage

Unique massage techniques targeting the shoulders and neck, effectively relieving shoulder and neck soreness and improving fatigue.



### Airbag Massage

Gentle and sequential compression by airbags, progressively providing deep relaxation and decompression throughout the entire body.



### Sport Recovery

Relieves post-exercise muscle soreness, discomfort in the neck, shoulders, back, waist, and legs, and helps muscles recover after exercise.



### More Mode



**Stress Relieving:** Gentle massage strength. Comforts the whole body, promotes blood circulation, relaxes the body and mind, effectively relieves various discomforts caused by long and continuous work, and eliminates overall fatigue.



**Thai Massage:** Simulates the techniques used in Thai massage, with a stronger intensity, providing a relaxing experience for the entire body.



**Waist & Hip Massage:** Unique massage techniques targeting the waist and hips, effectively relieving waist and hip soreness and improving lower back fatigue.



**Spine Care:** Unique massage techniques targeting the spine, effectively relieving spinal soreness and improving spine fatigue.



**Energy:** Gentle and comfortable massage to relieve physical fatigue, relax the body and mind, and boost vitality.



**Shiatsu Massage:** Utilizing kneading and acupressure massage techniques, as if gentle hands are providing a deep massage to soothe weariness and tension.



**Office Regimen:** Gradually applies varying levels of pressure to the entire body, effectively alleviating muscle soreness and promoting the recovery from fatigue.



**TV Mode:** Soft massage suitable for older users, effectively rejuvenating the body and improving blood circulation.



Press and hold to raise the backrest, release the button to stop.



Press and hold to lower the backrest, release the button to stop.



Press and hold to raise the footrest unit, release the button to stop.



Press and hold to lower the footrest, release the button to stop.



Press and hold Up button to move the massage rollers up, release the button to stop.



Press and hold Down button to move the massage rollers down, release the button to stop.



Press this button to switch to manual massage mode, press again to toggle manual massage techniques.



Under manual mode, Press this button to switch between fixed point-partial-full-body-upper body-lower body massage. You can press and hold Up/Down button to adjust the rollers to the desired position.



In automatic mode, the airbag system offers five levels of intensity adjustment and the option to disable the airbag function. The default airbag intensity is set to the third level.

In manual mode, the airbag adjustment button can sequentially switch the airbag positions in the order of full body - shoulder - arm - hip - leg - upper body - lower body - airbag off.



The intensity of the 4D massage can be adjusted into five levels of strength, with the default intensity set at the third level.



**Zero Gravity Adjustment Button:** There are three automatic reclining angles to choose from, suitable for individual preferences.



Press this button to navigate among: level 1,2,3 heating ,or Off (deactivate heating function).

Long press this key for 3 seconds to turn on and off the armrest LED light.



Press this button to navigate among: level 1,2,3 foot roller speed, or Off (deactivate foot roller function).

Press and hold this button for 3 seconds to deactivate Bluetooth function(default setting: off/on).



Press this button to set massage time.

You may toggle among 10-15-20-25-30 minutes settings (20minutes is the default setting).

Long press this key for 3 seconds to switch the voice control.

## HOW TO USE

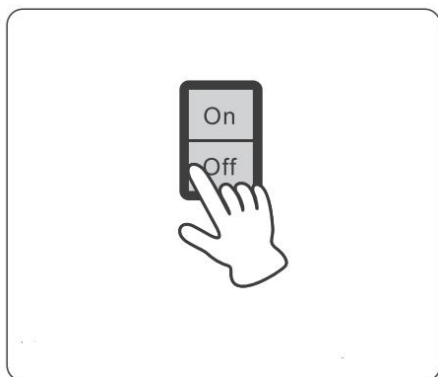

- Press the power switch at the back cover of the power box to stop all massage motions.
- When not in use for a long period of time, be sure to turn off the power switch.
- Disconnect the power cord from the electrical outlet.
- Do not drag the power cord to avoid damage to the cord, leading to fire or electric shock.



## Bluetooth Connection

- When the massage chair is on, the Bluetooth is on as the default setting, you may turn on Bluetooth on your mobile device, choose "BH-8315" to pair.
- You can enjoy music when Bluetooth is connected.
- Press and hold the "Roller" button on the control panel for 3 seconds to deactivate Bluetooth function(default setting:off/on).

## AI voice control

- Long press the "Time" button on the control panel key for 3 seconds to switch the voice control.
- Supported Language: English
- To wake up the "Voice Module," users should speak "Hello Hello" into the microphone. When the massage chair is in the shutdown mode, saying any of the following commands within 10 seconds will directly activate the massage.
- Voice Wake-up Commands. Turn voice on or off in Setting.

## NOTE:

- ◆ **When using the voice control function, the speech speed should not be too fast, and the voice commands should be issued according to the voice control entries.**
- ◆ **After each successful use of the voice-activated entry, it is recommended to give out the voice command after 1-2 seconds.**

Voice Wake-up Commands	AI Response
Hello Hello	I'm here
Massage on	OK,Massage on
Massage stop	OK,Massage stop
Comfort Massage	OK,Comfort Massage
Quick Massage	OK,Quick Massage
Stretch Massage	OK,Stretch Massage
Good-night Sleep	OK,Good-night Sleep
Shoulder and neck Massage	OK,Shoulder and Neck Massage
Air massage on	OK,Air massage on
Air massage stop	OK,Air massage stop
Up the seat position	OK,Up the seat position
Down the seat position	OK,Down the seat position
Change the other mode	OK,Change the other mode
Go little down	OK,Go little down
Go little up	OK,Go little up
Turn on the heat	OK,Turn on the heat
Turn off the heat	OK,Turn off the heat

## TROUBLESHOOTING

The sound made during operation	The sound produced by the structural design will not affect the machine.
The power is plugged in, but the massage chair cannot be operated.	<p>Check if the power head is plugged in or is powered on.</p> <p>Check whether the power switch of the massage chair is in the "I" position.</p> <p>Check whether the power cord is damaged.</p> <p>Check that the fuse is damaged and replace the fuse.</p> <p>Check whether the manual control line is inserted well and screwed</p>
The backrest cannot be raised and lowered freely.	<p>Check whether there are foreign objects stuck in the backrest and lower legs.</p> <p>Check whether the connecting wire is loose.</p>
During use, the controller can be operated, but the massage chair cannot be operated.	After a long period of operation, if the temperature of the machine is too high, the massage chair will It is automatically in the temperature protection state, please turn off the power and use it for 30 to 50 minutes to let the internal heat dissipation of the machine.
During use, the controller cannot be operated, and the massage chair also stops operating	After the automatic timing function is activated. If the set time is up, please press the button again to control it.

### Note:

- ◆ **If problem remains, please contact the dealer for maintenance.**
- ◆ **Important: Do not attempt to repair this product yourself; our company shall not be liable for the injury or damage caused by any servicing without authorization.**
- ◆ **Thank you for your cooperation.**

## PRODUCT MAINTENANCE

### Clean

Do not use steel wool, abrasive cleaners or corrosive liquids (such as gasoline or acetone) to clean the product.

- ❶ Unplug the plug from the power socket.
- ❷ Clean the massage chair, remote control and power cord with a dry cloth.
- ❸ Do not use a damp cloth or detergent.

### Storage

- ❶ Unplug the plug from the power socket.
- ❷ Store this product in a cool and dry place away from sunlight.
- ❸ Do not place heavy objects on the product.

If the leather case is damaged or mechanical failure, please stop using this product and inquire from the authorized after-sales service center or customer service center in your country (region).

If you do not use it for a long time, please unplug the power cord!

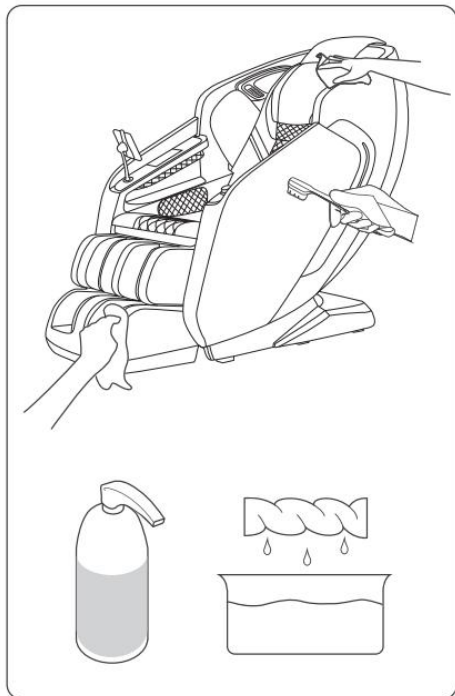

## PRODUCT PARAMETER

<b>Product Name</b>	Massage Chair
<b>Model No.</b>	BH-8315
<b>Rated Voltage</b>	AC100-240VAC
<b>Rated Frequency</b>	50/60Hz
<b>Rated Power</b>	120W
<b>Product Size</b>	Upright Condition: 1600*750*1160mm
<b>Net Weight</b>	79.2kg
<b>Wire Length</b>	1500mm
<b>Maximum User Weight</b>	350lbs

\* Products such as specifications, appearance, and design are subject to modification without prior notice.

**Manufacturer:** Shanghaimuxinmuyeyouxiangongsi

**Address:** Shuangchenglu 803nong11hao1602A-1609shi, baoshanqu, shanghai 200000 CN.

**Imported to AUS:** SIHAO PTY LTD. 1 ROKEVA STREETEASTWOOD NSW 2122 Australia

**Imported to USA:** Sanven Technology Ltd. Suite 250, 9166 Anaheim Place, Rancho Cucamonga, CA 91730

EC	REP
----	-----

E-CrossStu GmbH  
Mainzer Landstr.69, 60329 Frankfurt am Main.

UK	REP
----	-----

YH CONSULTING LIMITED.  
C/O YH Consulting Limited Office 147, Centurion House, London Road, Staines-upon-Thames, Surrey, TW18 4AX





**Technical Support and E-Warranty Certificate**  
**[www.vevor.com/support](http://www.vevor.com/support)**