

# **Roku™**

## Battery Camera

## Quick Start Guide

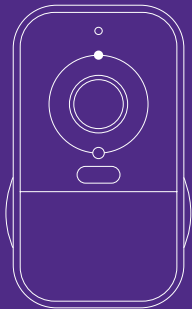

## What's included

---

- A** Roku Battery Camera
- B** USB-A to USB-C camera charging cable (indoor use only)
- C** 22mm M3 screws (x2)
- D** Anchors (x2)
- E** Mount
- F** Wall plate
- G** Window decal

## What you'll need

---

- Phillips screwdriver
- Your smartphone
- If using anchors, you'll need:
  - Drill (bit size 2.5mm or 1/8 inch)
  - Hammer

**A**

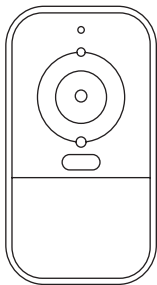

**B**

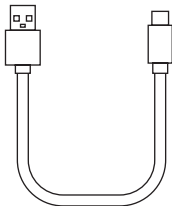

**C**



**D**



**E**



**F**



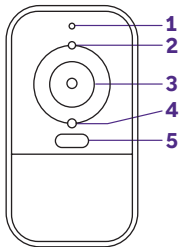

**FRONT**

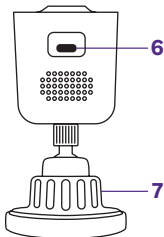

**BOTTOM**

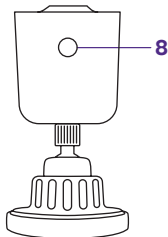

**TOP**

- ① Microphone
- ② Status light
- ③ Lens
- ④ Light sensor

- ⑤ Spotlight
- ⑥ USB-C charging port
- ⑦ Mount
- ⑧ Setup button

# Let's get started

---

## **STEP 1: Start charging your camera**

Plug in your camera using a wall charger. It can take 2-5 hours to charge fully.

**Tip:** For faster charging, use a high-power wall charger (like those used to charge tablets or laptops).

## **STEP 2: Download the Roku Smart Home app**

Scan the QR code below to download the Roku Smart Home app on your smartphone. Sign in with your Roku account or create one.

## **STEP 3: Set up your camera**

In the Roku Smart Home app, tap “Add Device” or “+” and find “Battery Camera.”

## **STEP 4: Place and mount your camera**

Follow the app instructions for camera setup and step by step mounting instructions.



## For the best experience, charge your camera before setup

**To charge camera:** Connect the charging cable to the USB-C port on the bottom of your camera.

### You'll need



Smartphone & app



Messaging & data rates  
may apply.

Continue on back ➡

## WALL MOUNT

1

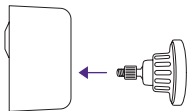

2



3

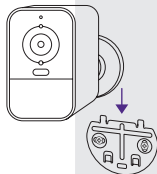

## CEILING MOUNT

1

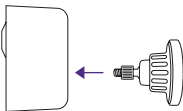

2

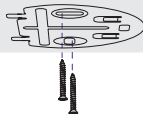

3

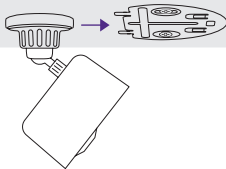

# What's that light mean?

Before Setup	
<b>Blue</b> - Pulsing	Ready to connect
<b>Yellow</b> - Slow blinking	Booting up/Updating firmware
<b>White</b> - Fast blinking	Connecting to network
After Setup	
<b>Red</b> - Blinking (3 times)	Error
<b>Green</b>	Fully charged

Status lights are located on the camera.

Use direct sunlight to keep your camera charged with Roku Solar Panel (sold separately).





## More features are waiting

Unlock the full potential  
of your camera with a  
**Roku Smart Home Subscription.**

Learn more at [go.roku.com/rokusmarthome](https://go.roku.com/rokusmarthome)

# Need help?



Setup  
videos



Common  
questions



Tips and  
tricks

Visit [go.roku.com/cameras](https://go.roku.com/cameras)

## Roku

© 2025 Roku, Inc. All rights reserved. Roku, the Roku logo, Roku Smart Home, and the Roku Smart Home logo are the trademarks or registered trademarks of Roku, Inc.