

## SPECIFICATIONS

<b>Model Number</b>	: WGP135
<b>Number of Buttons</b>	: 19
<b>Connectivity</b>	: StrikeSpeed Wireless, Wired
<b>Thumbstick Type</b>	: Hall-Effect
<b>Trigger Type</b>	: Hall-Effect
<b>Action Button Type</b>	: Membrane
<b>Turbo</b>	: Yes
<b>Vibration</b>	: 4-level Adjustable
<b>Programmable Buttons</b>	: 12
<b> polling Rate</b>	: 1000 Hz
<b>Battery Capacity</b>	: 600 mAh Li-ion
<b>Battery Life</b>	: Up to 20 Hours
<b>Size</b>	: 156*104*60 mm
<b>Weight</b>	: 187 ± 1 g
<b>Power Rating</b>	: 3.7V≈180 mA
<b>Compatibility</b>	: Windows 7 or later, Switch, Android, PS3, PS4

## PRODUCT TOUR

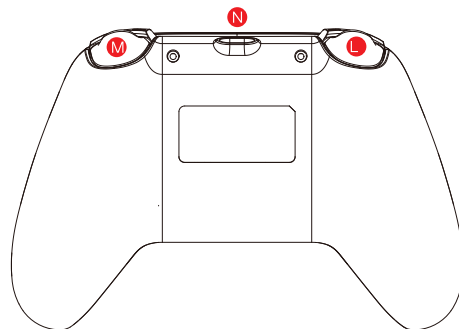
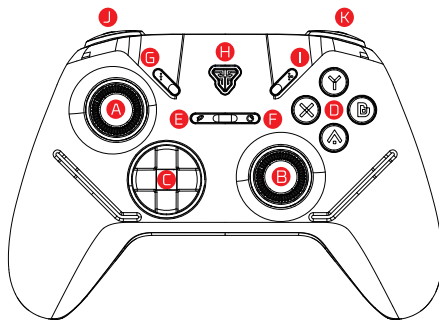

### EN

- |                           |                        |
|---------------------------|------------------------|
| <b>A</b> Left Thumbstick  | <b>H</b> Home Button   |
| <b>B</b> Right Thumbstick | <b>I</b> Start Button  |
| <b>C</b> Directional Pad  | <b>J</b> Left Bumper   |
| <b>D</b> Action Buttons   | <b>K</b> Right Bumper  |
| <b>E</b> Turbo Button     | <b>L</b> Left Trigger  |
| <b>F</b> Snap Button      | <b>M</b> Right Trigger |
| <b>G</b> Select Button    | <b>N</b> USB C Port    |

### ID

- |                           |                         |
|---------------------------|-------------------------|
| <b>A</b> Thumbstick kiri  | <b>H</b> Tombol Beranda |
| <b>B</b> Thumbstick Kanan | <b>I</b> Tombol Start   |
| <b>C</b> Pad Pengarah     | <b>J</b> Bumper Kiri    |
| <b>D</b> Tombol Aksi      | <b>K</b> Bumper Kanan   |
| <b>E</b> Tombol Turbo     | <b>L</b> Pemicu Kiri    |
| <b>F</b> Tombol Snap      | <b>M</b> Pemicu Kanan   |
| <b>G</b> Tombol Select    | <b>N</b> USB C Port     |

Join the Fantech  
Discord  
Community



### XYAB<>YXBA SWAP



1. Press & hold the Turbo button & R3 for 3 seconds.
2. When the controller vibrates, the action button has been changed.

\*There are 2 types of action button, Switch & Xbox.



### THUMBSTICK<>D-PAD SWAP



1. Press & hold the Start button & L3 for 3 seconds.
2. When the controller vibrates, the left thumbstick & D-pad button function has been switched.

### D-PAD BEHAVIOUR



1. Press & Hold Select & Right D-Pad for 3 seconds.
2. When the controller vibrates, the D-Pad button behaviour has been changed.

\*There are 2 types of D-Pad behaviour.



### COMBO SWAP FUNCTION



1. Press & hold the Turbo button & Snap button for 3 seconds.
2. When the controller vibrates, the mode has been changed (keyboard & mouse function).



## ANY QUESTIONS?

Thanks for choosing Fantech.  
If you have any question or need any help with your products,  
please do not hesitate to contact us.

 [support@fantechworld.com](mailto:support@fantechworld.com)

WGP13S  
**SHOOTER III**  
MULTI-PLATFORM GAMEPAD



## QUICK START GUIDE

PANDUAN CEPAT [ID]  
快速入门指南 [ZH]



## DOWNLOAD

To further customize your setting, please visit our website  
and download the software (if applicable).



[www.fantechworld.com](http://www.fantechworld.com)

## HOW TO CONNECT

### WIRED CONNECTION

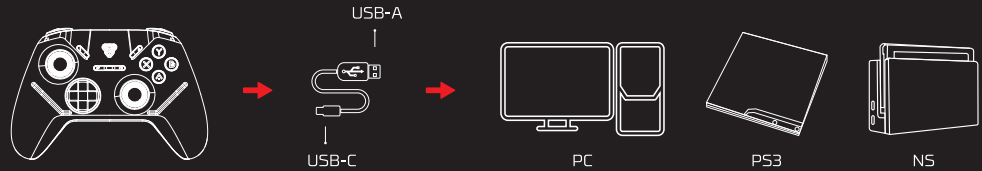

### 2.4GHZ CONNECTION

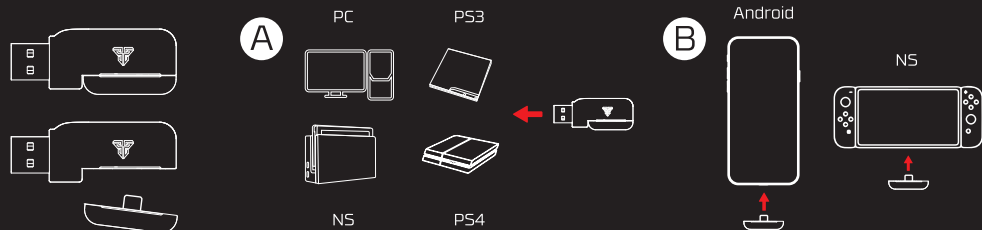

### LED INDICATOR



**X-Input**

(PC, Android)



**D-Input**

(PC, Android, Emu)



**S-Input**

(Emu, PS3, PS4, NS)

*\*On PC, to toggle from X-Input to D-Input, press the home button for 3 seconds.*

*\*On Android, LED will only show D-Input notification as small picture above.  
Switch from D-Input to X-Input by pressing the home & snap buttons  
simultaneously for 3 seconds.*

### FACTORY RESET



1. Press & hold the Select button & R3 for 8 seconds.
2. When the controller vibrates, the gamepad has been reset.

### TURBO MODE



1. To activate the turbo effect, hold down the Turbo button and press the action button you wish to assign.
2. To enable the auto-fire effect, hold the Turbo button and press the button that has already been assigned.
3. To remove the turbo effect, hold the Turbo button and press the assigned button again.

*\*The turbo function can be applied to these buttons:  
Action buttons, LT, RT, RB, LB.*

### MACRO MODE



1. Press & hold the turbo button until the gamepad vibrates to activate.
  2. Begin recording your macro, allowing up to 63 button inputs within a 5-minute window.
  3. Press the turbo button again to stop recording & to execute the macro, press the turbo button twice.
  4. To clear the macro, press & hold the turbo button until the gamepad vibrates, then press again the turbo button.
- \*The macro function can be applied to:  
these buttons:  
Action buttons, LT, RT, RB, LB,  
directional pad.*