

User Guide

M08F

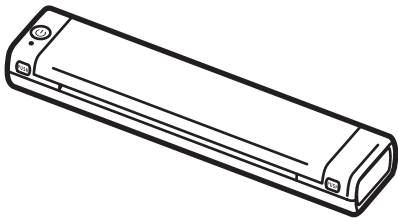

English

1. Product Introduction

1.1 Packing List

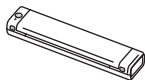

Printer
×1



Quick Start Guide
×1



Type-C Cable
×1



Velvet Pouch
×1

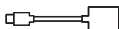

USB to Type-C Adapter
×1



Single-sided Thermal
Paper- 10 sheets×1

! Type-C data cable and USB adapter have been placed in the velvet bag.

1.2 Printer Parts Instruction

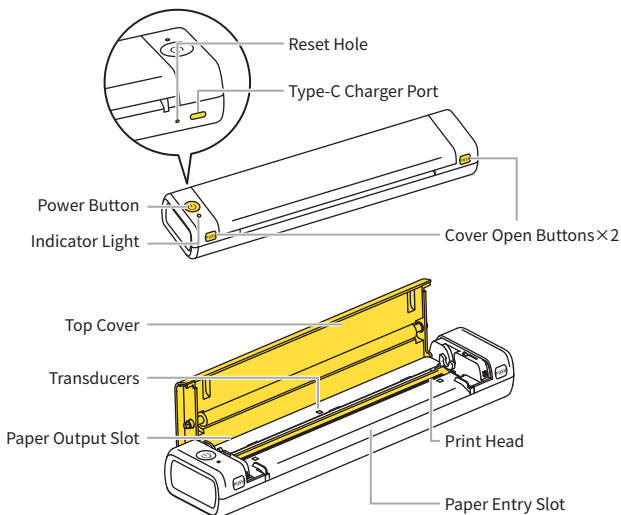

2. Getting Started

2.1 Downloading the App

Method 1: Search for the "Phomemo" app on App Store® or Google Play™ for download and installation.



Phomemo



Method 2: Scan the QR code to download the app. You can scan the code using your cell phone's camera, the built-in QR code scanning feature of your browser, or a dedicated QR code scanning app.



❗ As the Safari browser on Apple devices does not support direct QR code scanning, please use your device's built-in QR code scanner instead.

2.2 Paper Installation Guide

- 01** Long press the Power Button for 3 seconds until the Indicator Light is green to power up the printer.

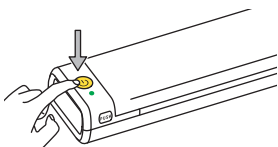

- 02** Simultaneously press the Cover Open Buttons with both hands.

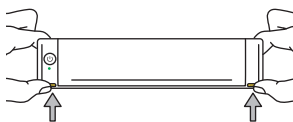

- 03** Open the Top Cover.

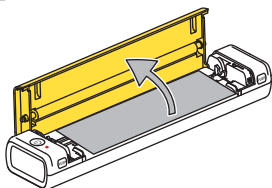

- 04** Remove the protective paper.

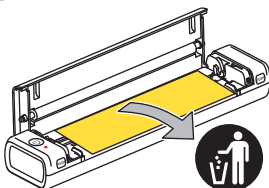

❗ If your printer version does not include the disposable protective paper, please skip this step.

- 05** Put the Top Cover back down, and press down on both of its ends at the same time until you hear a click, indicating the cover is securely closed.

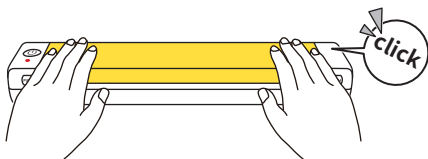

- 06** Insert the paper with the text side up into the Paper Entry Slot until the printer automatically pulls it in and the Indicator Light is lit green, signaling paper insertion is complete.

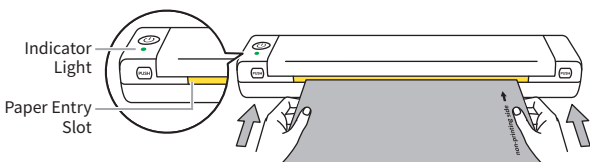

❗ The printed content will not appear on the side that reads "non-printing side."

2.3 User Guide: Printing via Mobile App

01 Open the "Phomemo" app.



02 Grant permissions.

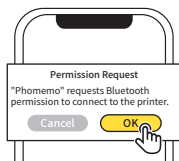

03 Wait for the printer to be searched.

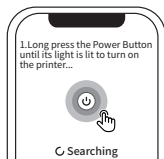

04 Tap [Connect Now].

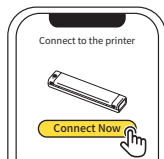

05 The printer is connected.
Tap [Paper loaded, starting printing].

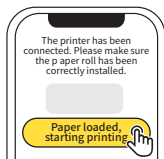

06 Edit your first image, and tap [] after you finish editing.



07 Confirm the preview of the image, and tap [Print].

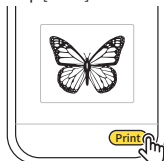

08 Printing is completed.



09 Retrieve the printout.

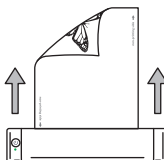

! The software interface is for illustration purposes only. Please refer to the actual operation page for accurate information.

2.4 User Guide: Printing via computer

- 01** Please make sure the printer is powered on and connect it to the computer using the original Type-C cable.

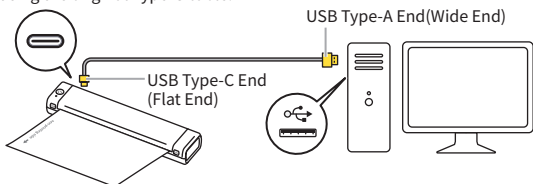

- ❗ • If your computer is Type-C interface, you can use the supplied adapter to convert the interface, the Type-C end of the adapter needs to be plugged into the computer side.
• The adapter is unidirectional, and the Type-C end of the adapter plugged into the printer end will fail to charge or fail to transfer data abnormally.

- 02** Visit m08f.phomemo.com to download and install the driver.

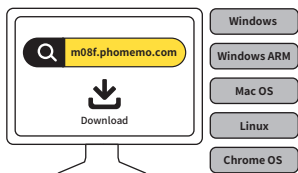

- 03** Select and open the file you need to print.

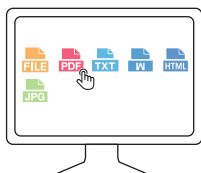

- ❗ The file formats supported by the printer include JPG, PDF, TXT, DOCX, HTML, FILE, etc.

- 04** Tap [🖨️].

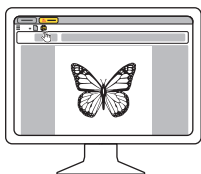

- 05** Select the M08F Printer, and click [Print] to start printing.

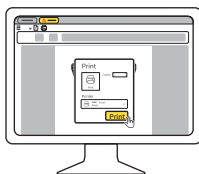

- 06** Retrieve the printout.

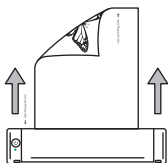

3. Cleaning and Maintenance

❗ Disconnect the printer from the power supply before starting any cleaning or maintenance.

If you encounter issues such as blank lines, blurry print, or missing words, it may be caused by dirt on the Print Head. Please follow these steps:

- 01 If you have just finished printing, wait for at least 30 minutes for the Print Head to cool down completely.
- 02 Use a cotton swab dipped in alcohol or a dry alcohol-soaked cotton ball to gently wipe the Rubber Roller and the Print Head left and right 5 times each, removing dust and stains from the surfaces.
- 03 Wait 5-10 minutes for the alcohol to evaporate completely before closing the Top Cover and completing the cleaning process. You may now continue using the printer.

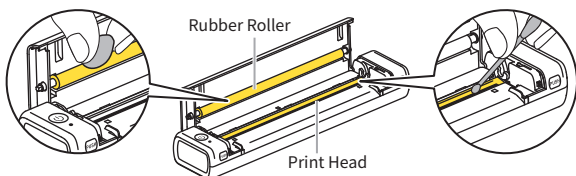

Print Head Warning: HOT component! Touching it when it is hot can cause burns to your fingers. Please wait for at least 30 minutes after turning off the power before touching it.

4. Charging Instructions

1. Please prepare your own power adapter (DC 5V/2A) with a Type-A port.
2. Insert the Type-C end (flat end) of the USB cable into M08F's Type-C Charger Port and plug the Type-A end (wide end) into the Type-A port of the power adapter.
3. After connecting the printer to an outlet using the power adapter, please check the status of the Indicator Light: a light flashing alternately between red and green indicates that the printer is off, while a flashing green light signals that the printer is on.
4. To ensure quick usage, please charge the printer for at least 20 minutes. For a complete charge, wait for 4 hours or until the Indicator Light is solid green.
5. As the printer may heat up during charging, avoid placing it on materials such as cotton or linen.
6. Once the battery is fully charged, please unplug the charger promptly.

❗ Avoid using the printer while charging. Using the printer while charging may lead to reduced charging speed, compromised print quality, and shortened battery life.

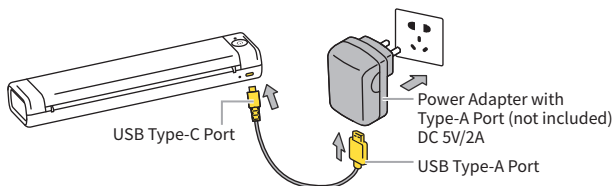







5. Additional Instructions

5.1 Button Instructions

Button Type	Operation	Function
 Power Button	Long press for 3s	Power on/off
	Double press when printer is on	Print a self-test page

5.2 Indicator Light Instructions

Status	Meaning	Advised Action
 Solid Green Light	Functioning/Fully charged	/
 Flashing Green Light	Charging while printer is on	/
 Solid Red Light	No paper installed	Install paper
	Printer overheated	Pause printing for 5-10 min
	Top Cover open	Close Top Cover
 Flashing Red Light	Low battery	Charge battery for 1h(or at least 20 min for quick usage)
 No light after long pressing Power Button for 3s	Battery depleted	Charge for 4h
 Alternately Flashing Red and Green Light	Charging while printer is off	/

5.3 Permission Description

For iOS users

1. The app requires access to the Internet.

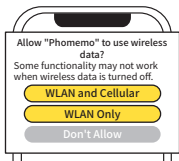

2. The app requires Bluetooth permission.

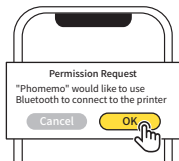

For Android users

1. The app requires Bluetooth permission.

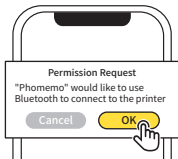

2. The app requires permission to search for nearby Bluetooth devices.



ⓘ For Android 12 and above, the app requires permission to search for nearby Bluetooth devices; for systems below Android 12, the app requires GPS permission in order to search for nearby Bluetooth devices.

3. Bluetooth Pairing Request.

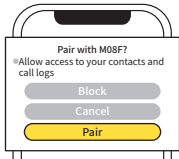

ⓘ You can simply tap "Pair" without checking "Allow access to your contacts and call history."

6. More Connection Methods

6.1 Connecting via QR Code

01 Open the "Phomemo" app.



03 Tap [Scan QR Code].



05 Device connected.

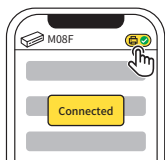

02 Tap [📄] at the top right corner.

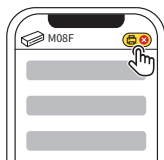

04 Scan the QR code on the printer.

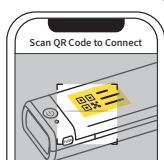

ⓘ Scan the QR code on the Top Cover of the printer for a fast connection with the printer.

6.2 Connecting via Bluetooth

01 Open the "Phomemo" app.



03 Go to Bluetooth Connections and search for the printer.

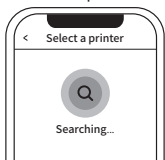

ⓘ Turn on Bluetooth permission to quickly find and connect to the printer.

05 Device connected.

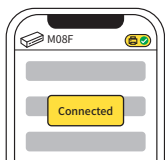

02 Tap [📄] at the top right corner.

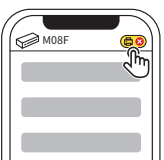

04 Select your printer.

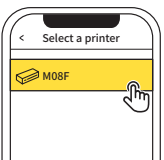

7. Information to User

7.1 FCC WARNING

Note: This equipment has been tested and found to comply with the limits for a Class B digital device, pursuant to part 15 of the FCC Rules. These limits are designed to provide reasonable protection against harmful interference in a residential installation. This equipment generates, uses and can radiate radio frequency energy and, if not installed and used in accordance with the instructions, may cause harmful interference to radio communications. However, there is no guarantee that interference will not occur in a particular installation. If this equipment does cause harmful interference to radio or television reception, which can be determined by turning the equipment off and on, the user is encouraged to try to correct the interference by one or more of the following measures:

- Reorient or relocate the receiving antenna.
- Increase the separation between the equipment and receiver.
- Connect the equipment into an outlet on a circuit different from that to which the receiver is connected.
- Consult the dealer or an experienced radio/TV technician for help.

Important: Change or modifications not expressly approved by the manufacturer responsible for compliance could void the user's authority to operate the equipment.

7.2 ISED NOTICE (Canada)

CAN ICES-003(B)/NMB-003(B)

This device contains licence-exempt transmitter(s)/receiver(s) that comply with Innovation, Science and Economic Development Canada's licence-exempt RSS(s). Operation is subject to the following two conditions: 1. This device may not cause interference. 2. This device must accept any interference, including interference that may cause undesired operation of the device.

This equipment complies with ISED radiation exposure limits set forth for an uncontrolled environment and meets RSS-102 of the ISED radio frequency (RF) Exposure rules. This equipment should be installed and operated keeping the radiator at least 20cm or more away from person's body.

Cet appareil contient un émetteur (S)/ récepteur (S) exempté (S) de licence qui est conforme aux RSS(S) exemptés (S) de licence d' innovation, Science et développement économique Canada. Le fonctionnement est soumis aux deux conditions suivantes: 1. Cet appareil ne peut pas causer d' interférences. 2. Cet appareil doit accepter toute interférence, y compris les interférences qui peuvent causer un fonctionnement indésirable de l' appareil.

Cet équipement est conforme aux limites d' exposition aux rayonnements ionisants fixées pour un environnement non contrôlé et répond à RSS-102 des règles d' exposition aux rayonnements ionisants (RF). Cet équipement devrait être installé et utilisé en gardant le radiateur au moins 20cm ou plus loin du corps de la personne.

7.3 Trademarks and Copyrights



Bluetooth®

The Bluetooth®/MD word mark and logos are registered trademarks owned by Bluetooth SIG, Inc. and any use of such marks by Zhuhai Quin Technology Co., Ltd. is under license. Other trademarks and trade names are those of their respective owners.

Apple, the Apple logo, iPhone, iPad, iPod, and iPod touch are trademarks of Apple Inc., registered in the U.S. and other countries. App Store is a service mark of Apple Inc.

Android and Google Play are trademarks of Google Inc. Google and Google Logo are registered trademarks of Google Inc.

7.4. IC Warning

IC Warning statement:

This device contains licence-exempt transmitter(s)/receiver(s) that comply with Innovation, Science and Economic Development Canada's licence-exempt RSS(s). Operation is subject to the following two conditions:

1. This device may not cause interference.
2. This device must accept any interference, including interference that may cause undesired operation of the device.

L' émetteur/récepteur exempt de licence contenu dans le présent appareil est conforme aux CNR d' Innovation, Sciences et Développement économique Canada applicables aux appareils radio exempts de licence. L' exploitation est autorisée aux deux conditions suivantes:

1. L' appareil ne doit pas produire de brouillage;
2. L' appareil doit accepter tout brouillage radioélectrique subi, même si le brouillage est susceptible d' en compromettre le fonctionnement.

RF exposure statement

IC RF exposure statement:

The device has been evaluated to meet general IC RF exposure requirement. The device can be used in portable exposure condition without restriction.

IC Déclaration d'exposition aux RF:

L'appareil a été évalué pour répondre aux exigences générales d'exposition aux RF d'IC. L'appareil peut être utilisé dans des conditions d'exposition portable sans restriction.