



User Manual

Electric Mini-Tank Water Heater

Products:

ES025

ES040

ES080

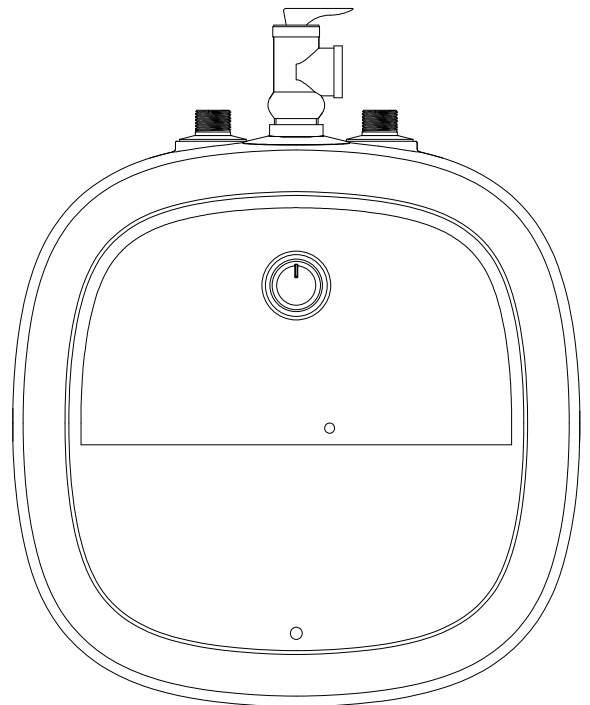

WARNING

Please read all instructions before using this water heater. Failure to follow the information in these instructions may result in fire, electric shock, property damage, injury or death.

CONTENTS

1 Safety Information	03
1.1 Safety Definitions	03
1.2 Safety Messages	03
2 Information about the product	05
2.1 Models overview	05
2.2 Dimensions	06
2.3 Technical data	07
3 Installation instructions	08
3.1 Mounting the heater	08
3.2 Pipe connections	08
3.3 Closed system thermal expansion	09
4 Use	10
4.1 Starting and testing	10
4.2 Temperature setting	10
5 Maintenance	11
5.1 Removing the cover	11
5.2 Draining the heater	11
5.3 Inspecting the anode rod	11
5.4 Removing the heating element	11
5.5 Descaling the heating element	12
6 Replacement of parts	13
6.1 Changing the anode rod	13
6.2 Changing the heating element	13
6.3 Changing the thermostat	13
7 Troubleshooting	14
7.1 Fault Assessment and Troubleshooting	14
7.2 Resetting High Limit Switch	15
8 Interior components diagram	16
French	17

SAVE THESE INSTRUCTIONS

1 Safety Information

1.1 Safety Definitions

This manual has safety information and instructions to help you eliminate or reduce the risk of accidents and injuries.



DANGER

Indicates an imminently hazardous situation which, if not avoided, will result in death or serious injury.



WARNING

Indicates a hazardous situation that, if not avoided, could result in death or serious injury.



CAUTION

Indicates a hazardous situation which, if not avoided, could result in property damage and minor or moderate injury.



NOTICE

This symbol indicates important information where there is no risk to people or property.

Additional symbols

Symbol	Explanation
■	Step in an action sequence
→	Cross-reference to another part of the document
•	List entry

1.2 Important Safety Instructions



WARNING

When using electrical appliances, safety precautions to reduce the risk of fire, electric shock or injury to persons should be followed.

1. READ ALL INSTRUCTIONS BEFORE USING THIS WATER HEATER.
2. This water heater must be grounded. Connect only to properly grounded outlet. See "GROUNDING INSTRUCTIONS" found on (specific page or section to be included).
3. Install or locate this water heater only in accordance with the provided installation instructions.
4. Use this water heater only for its intended use as described in this manual.
5. Do not use an extension cord set with this water heater. If no receptacle is available adjacent to the water heater, contact a qualified electrician to have one properly installed.
6. As with any appliance, close supervision is necessary when used by children.
7. Do not operate this water heater if it has a damaged cord or plug, if it is not working properly, or if it has been damaged or dropped.
8. This water heater should be serviced only by qualified service personnel. Contact nearest authorized service facility for examination, repair, or adjustment.
9. Do not use multi-outlet adaptors (i.e. power strips) with this water heater.
10. Failure to inspect the anode rod at least once a year could cause the tank to fail and leak. This condition is not covered under the manufacturer's warranty.
11. Any water heater should be installed in such a manner that if it should leak, the resulting flow of water will not cause damage to the area in which it is installed. National Plumbing codes require a drain pan for any water heater installation. Failure to install one is the sole responsibility of owner and/or installer. Reference UPC 2006 (Uniform Plumbing Code) Section 508.1, or IPC 2006 (International Plumbing Code) Section 504.7.



CAUTION

The installer should review the contents of this manual with the owner upon completion of installation, and the manual should be left with the owner and placed in a location close to the installation.



CAUTION

The manufacturer cannot be responsible for the damages caused by improper installation or by failure to follow instructions in this manual. Comply with the installation instructions before completing electric connection.



CAUTION

The thermostat has been pre-set at the factory at a temperature equal or below 51.7 °C (125 °F) (→Fig. 1).

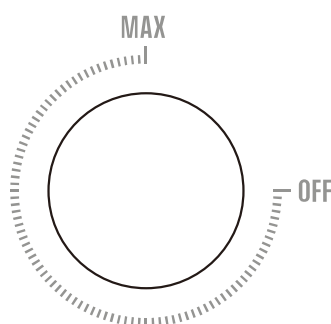

Fig. 1



CAUTION

Any water heater should be installed in such a manner that if it should leak, the resulting flow of water will not cause damage to the area in which it is installed. National Plumbing codes require a drain pan for any water heater installation. Failure to install one is the sole responsibility of owner and/or installer. Reference UPC 2006 (Uniform Plumbing Code) Section 508.1, or IPC 2006 (International Plumbing Code) Section 504.7.



DANGER

Hydrogen gas is produced in a hot water system served by this heater that has not been used for a long period of time (2 weeks or more). Hydrogen gas is extremely flammable. To reduce the risk of injury under these conditions, it is recommended that the hot water faucet be opened for several minutes at the kitchen sink before using any electrical appliance connected to the hot water system. When hydrogen is present, there will probably be an unusual sound such as air escaping through the pipe as the water begins to flow. There should be no smoking or open flame near the faucet at the time it is open.



CAUTION

Prior to connecting the power supply, ensure tank is full of water and system is purged of air.



NOTICE

Tank failure due to neglecting to maintain the anode rod is not covered under warranty (see Section 5 Maintenance).



WARNING

This product can expose you to lead, which is known to the state of California to cause cancer and birth defects or other reproductive harm. For more information, go to www.P65warnings.ca.gov.

2 Information about the product

2.1 Models overview

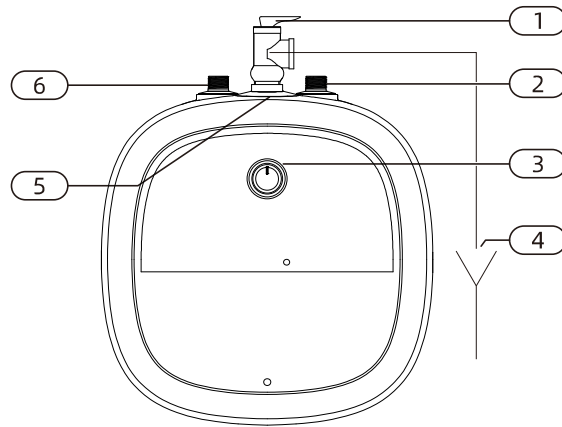
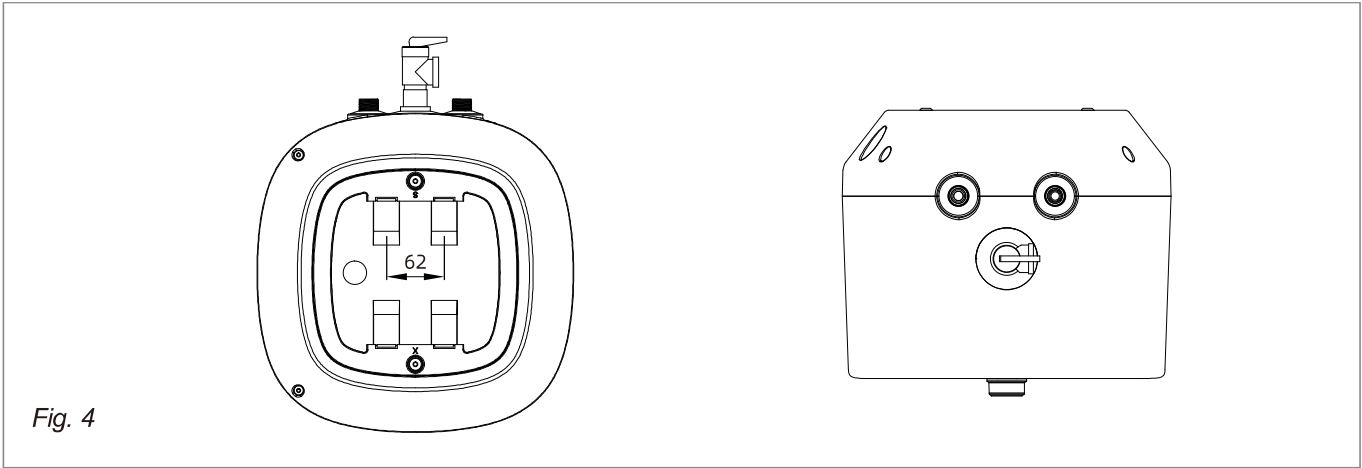
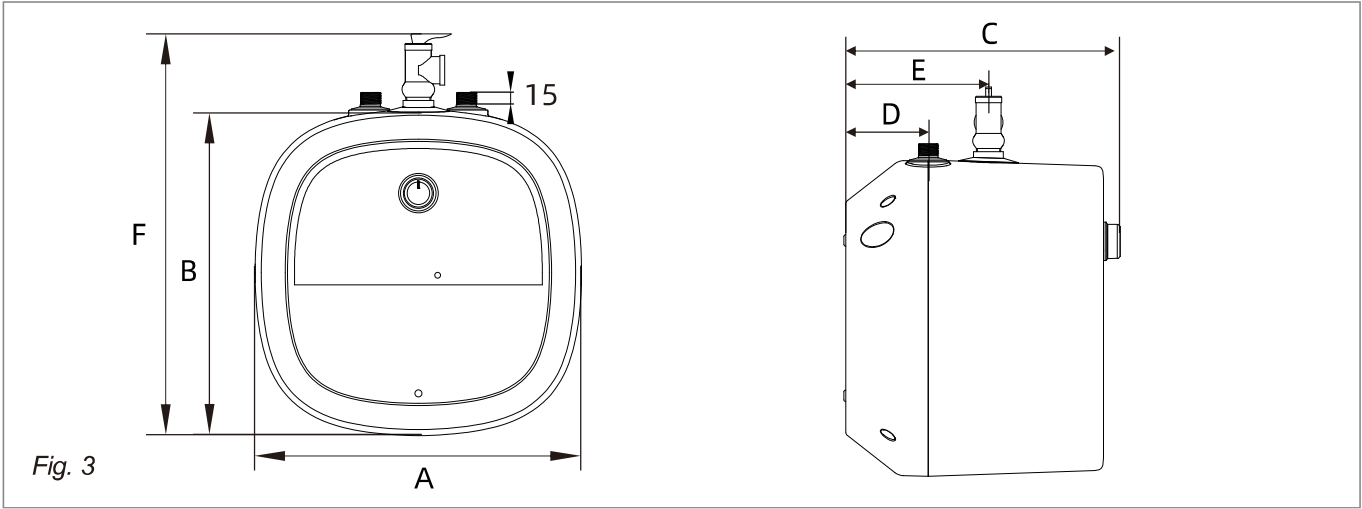

Fig. 2

1. Temperature & pressure relief valve, $\frac{3}{4}$ NPT male
2. Cold water inlet (BLUE) $\frac{1}{2}$ NPT male (ES025 and ES040)
Cold water inlet (BLUE) $\frac{3}{4}$ NPT male (ES080 equipped with converter)
3. Temperature Adjustment Knob
4. Temperature & pressure relief valve discharge line to drain
5. $\frac{3}{4}$ NPT female tapping for relief valve
6. Hot water outlet (RED) $\frac{1}{2}$ NPT male (ES025 and ES040)
Hot water outlet (RED) $\frac{3}{4}$ NPT male (ES080 equipped with converter)

2.2 Dimensions



Capacity	Dimensions (inch)					
	A	B	C	D	E	F
2.5 gal	13.39	13.39	11.42	3.58	6.14	16.89
4.0 gal	14.96	14.96	12.80	4.13	6.69	18.46
8.0 gal	17.32	17.32	15.35	5.20	8.38	20.82

* Vertically installation only

2.3 Technical data

Model (Units)	ES025	ES040	ES080
Capacity (Gallons)	2.5	4.0	8.0
Voltage (VAC)	120 for each model	120 for each model	120 for each model
Power at 120 VAC (Watts)	1440	1440	1440
Maximum water pressure (Psi)	150	150	150
Amperage (Amps)	12.0 for each model	12.0 for each model	12.0 for each model
Phases	1	1	1
Temperature range (°F)	55-145	55-145	55-145

3 Installation instructions

3.1 Mounting the heater

Wall mounting



NOTICE: Material damages!

Use screws that are suitable for the wall material and the weight of the heater.

- After the installation position of the water heater is determined, drill two holes with a spacing of 2.44 inch and a diameter of $\Phi 0.394$ inch in the horizontal direction of the wall according to the size as shown in the following figure, and the hole depth shall not be less than 2.76 inch. Insert two plastic expansion tubes into the hole, and fix the water heater bracket with fastening screws.

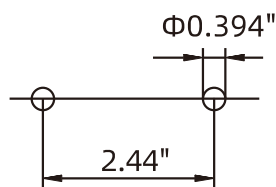

Install the wall hole

- Unclench the plastic shell in the back of water heater before hanging it, then align the two hanging holes on the back of the water heater with the two hooks of the water heater bracket and pull down with force to make the hanging holes hang into the hook.

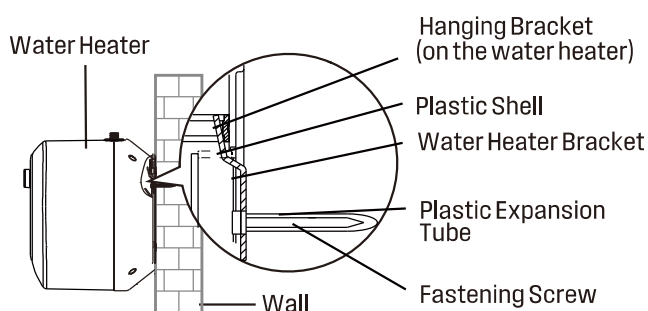

CAUTION

The appliance must be hung securely to prevent personal injury and property damage from falling.

Floor mounting

- Heater can sit on floor. When the water heater is placed on the floor, additional reinforcement is required

3.2 Pipe connections

- Connect the cold water inlet pipe to the inlet tapping (marked with a blue ring).
- Ensure a isolation valve is installed on the cold water supply to the water heater.
- Connect the hot water outlet pipe to the outlet tapping (marked with a red ring).



CAUTION

To reduce the risk of excessive pressures and temperatures in this water heater:

- Install the supplied temperature and pressure protective equipment required by local codes but not less than a combination temperature and pressure relief valve certified by a nationally recognized testing laboratory that maintains periodic inspection of production of listed equipment or materials, as meeting the requirements for Relief Valves and Automatic Gas Shut-off Devices for Hot Water Supply Systems, ANSI Z21.22.

The supplied temperature and pressure relief valve is marked with a maximum set pressure (150 psi) that does not exceed the marked maximum working pressure of the water heater.

- Install the valve in the opening provided and marked for this purpose in the water heater.
- Orient it or provide tubing so that any discharge from the valve will exit within 6 inches above, or at any distance below, the structural floor, and cannot contact any live electrical part. The discharge opening must not be blocked or reduced in size under any circumstances.

**NOTICE**

Wrap the Teflon tape around the threaded opening of the pressure relief valve at least 15 times (approximately 1.2 meters in length) in order to prevent water leakage.

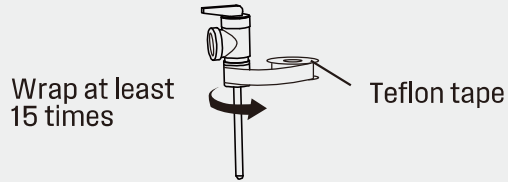
**NOTICE**

Wrap at least 8 turns (approximately 25.2 inches (65 cm)) of Teflon tape around the threaded opening of the hose connector.

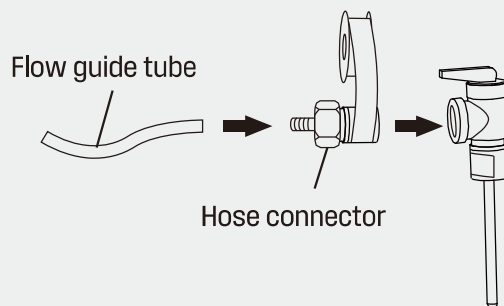

National Plumbing codes may require a drain pan for the water heater installation. Failure to install one is the sole responsibility of owner and/or installer. Reference UPC (Uniform Plumbing Code), or IPC (International Plumbing Code).

3.3 Closed system thermal expansion

Periodic discharge of the temperature and pressure relief valve or failure of the element gasket may be due to thermal expansion in a closed water supply system. The water utility supply meter may contain a check valve, backflow preventer or water pressure reducing valve which will create a closed water system.

During the heating cycle of the water heater, the water expands causing pressure inside the water heater to increase.

The temperature and pressure relief valve may discharge hot water under these conditions which results in a loss of energy and a build-up of lime on the relief valve seat.

The temperature and pressure relief valve may discharge hot water under these conditions which results in a loss of energy and a build-up of lime on the relief valve seat.

To prevent this from happening, there are two recommendations:

- Install a diaphragm-type expansion tank that is suitable for potable water on the cold water supply line. A minimum 0.5 gallon expansion tank should be used.

Contact the local water supplier or plumbing inspector for information on how to control this situation. Do not plug the temperature and pressure relief valve.

4 Use

4.1 Starting and testing



CAUTION

DO NOT supply power to water heater until filled with water.

To fill the heater:

- Open supply valve for water heater to fill with water.
- Open hot water tap(s) supplied by the water heater to purge air out of the system. Once air is purged, close hot water tap.
- Visually check for any leaks.

Turning heater on

For models which are not fitted with a switch:

- Supply power to the water heater by plugging in the power cord.

If the light does not come on, turn the control knob in a clockwise direction.

The light will come on until water temperature has reached the thermostat temperature setting. The light will come back on any time the water temperature inside the tank drops below the thermostat setting.



DANGER

If user's water pressure is high, TP valve may relieve pressure under high pressure during the heating process, water temperature will be over 145 °F after pressure relief, which can cause severe burns instantly or death from scalds. Please take attention!

4.2 Temperature setting

To fill the heater:

The temperature of the hot water is adjusted by rotating the knob M (Fig.5) located on the front cover. Temperature range is 55-145 °F.

- Turn the knob clockwise to increase temperature.
- Turn the knob counter-clockwise to decrease temperature.

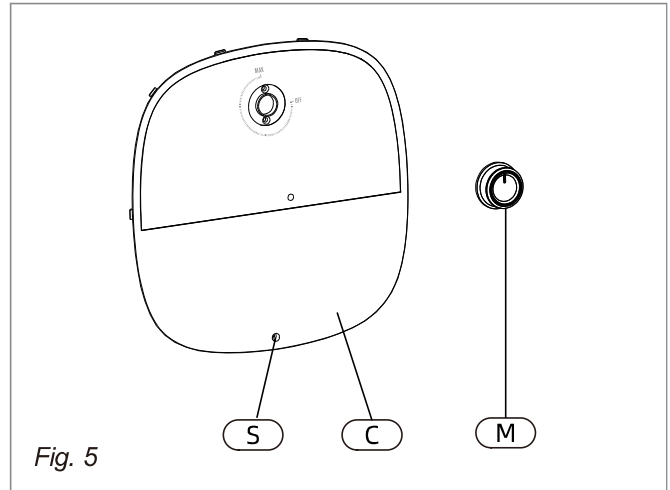

5 Maintenance



CAUTION

Do not attempt to repair this water heater yourself. Call a service person for assistance. Always turn off the power supply to the heater prior to servicing or draining the heater.



NOTICE

For most of these operations, the water will have to be drained from the heater. For all of these operations the cord should be disconnected and the front cover removed.

5.1 Removing the cover

- Remove rubber seal which covers the Phillips screw (Fig. 5 [S]), and unscrew the Phillips screw.
- The cover (Fig. 5, [C]) can now be removed by slightly rotate. When reassembling, work in the opposite way being careful to insert the tongue of the cover into the slot.

5.2 Draining the heater

If the heater has been installed with flexible hoses:

- Shut off the power supply.
- Turn the heater upside down over a sink to drain the water out of it.

5.3 Inspecting the anode rod

If the heater has been installed with flexible hoses:

The purpose of the anode rod (Fig. 8, [N]) is to protect the tank against corrosion. It is critical that the anode rod be inspected once a year to determine whether it requires replacement. To access the anode rod, the heating element must be removed (see Section 5.4 Removing the heating element). Upon inspection, the anode rod surface should appear smooth. If the rod surface appears pitted, bumpy, rusty, or if the rod is

missing completely, then it must be replaced.

To access the anode rod:

- Remove the heating element (see Section 5.4 Removing the heating element).

Original anode rod sizes

- Length 4.72" Diameter 0.787"

Certain installations may require more frequent replacement of the anode rod:

- recirculation applications
- poor water quality
- galvanic/electrolytic corrosion
- high flow applications

In the event of poor water quality, we recommends consulting a local water treatment professional for water treatment options. Always ensure the water heater is grounded. Damage resulting from poor water quality or failure to replace the anode rod is not covered under the manufacturer's warranty. For additional questions, please call Technical Service.

5.4 Removing the heating element

- Take out the power cord L from the plastic part. (Fig. 6)
- Use a cross screwdriver to unscrew the 3-in-1 cross screw J on the heating element terminals of red wire J and blue wire C. (Fig. 6)
- Remove the wire nail I and press the thermostat capillary G and the thermal cut-out capillary H, and take it out of the blind tube opening. (Fig. 6)
- Loosen the 5 nuts and spring washer on the heating element pressing plate A with the sleeve, and take out the heating element pressing plate A. (Fig. 6)
- Remove heating element B. (Fig. 6)

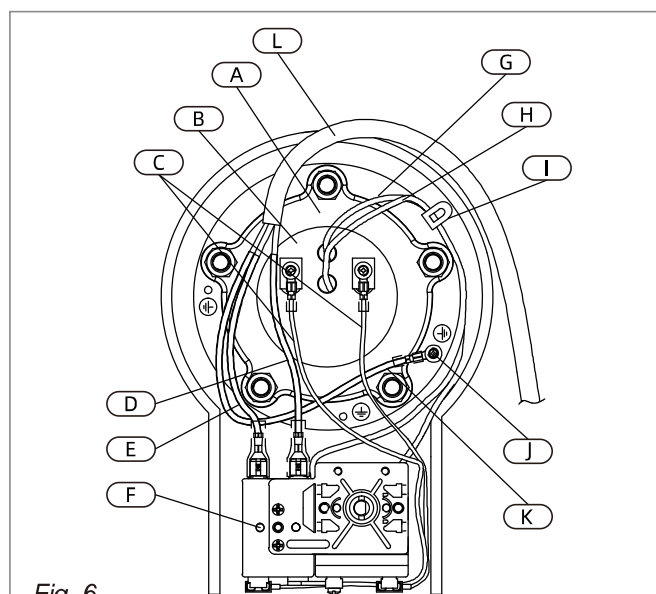

Fig. 6

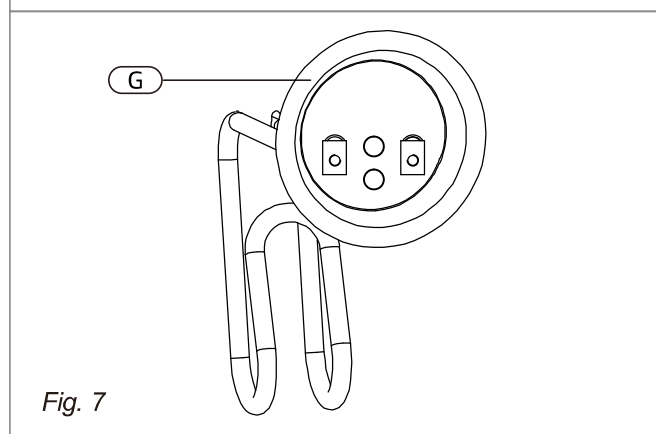

Fig. 7

- A. Heating Element Pressing Plate
- B. Heating Element
- C. Wire
- D. Live Wire
- E. Null Wire
- F. Return Pin
- G. Thermostat Capillary
- H. Thermal cut-out Capillary
- I. Wire Nail
- J. 3-in-1 Cross Screw
- K. Ground Wire
- L. Power Cord

5.5 Descaling the heating element

Scale deposits can affect the heating capability of the element.

Heavy scale can even cause damage to the element. The element can be descaled either chemically or manually:

- Soak the element in white vinegar or other descaling solution.
- Once descaled, rinse well with fresh water, to which you should add some baking soda.
- or-
- Once the element has dried, use a soft brush (non metallic to prevent damaging the stainless steel sheath) on element.
- Brush the dried mineral off.
- Reinstall the element with gasket and make the wire connections.

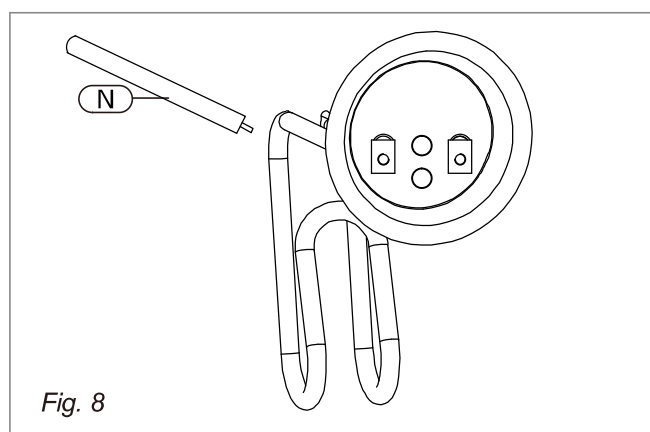

Fig. 8



NOTICE

Make sure the tank has been refilled with water before restoring power.

6 Replacement of parts

6.1 Changing the anode rod

- Turn off the power supply and drain the heater (see Draining the Heater).
- Remove heating element (see previous section).
- Unscrew anode rod from threaded connection.
- Remove and replace the anode rod (Fig. 8, [N]).
- Reinstall heating element.
- Refill tank with water before restoring power.

6.2 Changing the heating element

- Turn off power supply and drain the heater (see Draining the Heater).
- Remove the heating element (see section on Removing the Heating Element).
- Install new element with gasket, making sure the gasket and element are positioned correctly. Tighten the retaining nuts and make the wire connections.
- Ensure that the thermostat temperature sensor is inserted into the well located on the element assembly and secured with black rubber grommet.
- Refill tank with water before restoring power.

6.3 Changing the thermostat

- Turn off power supply.
- Disconnect the 2 wire connectors on thermostat.
- Loosen the two brass screws at right side of thermostat and pull wires out.
- Remove thermostat temperature sensor from well located in element assembly.
- Unscrew and remove the two Phillips screws holding the thermostat onto the tank.
- Install new thermostat and re-attach wiring and screws.
- Ensure that the thermostat temperature sensor is inserted into the well located on the element assembly and secured with black rubber grommet.

7 Troubleshooting

7.1 Fault Assessment and Troubleshooting

Problem	Solution
Water does not get hot	Make sure the power supply is on and working.
	If light does not come on, check that the high limit reset button is pushed in; follow steps in section 7.1.
	If the indicator light works properly but temperature does not get hot at the tap, test for a plumbing crossover; shut off cold supply to heater and open hot water tap. There should be no water flowing. Any continued flow indicates a crossover which will effect the temperature and will need to be corrected.
	Call a qualified service technician to test the resistance of the heating element (8-10 ohms). Heating element should be replaced if readings are outside these values.
Light not on	If the light does not come on, but water gets hot, check for faulty bulb.
	Check high limit reset button; follow steps in section 7.2.
Brown water	<p>Brown or rusty water indicates a "spent" anode rod and possible deterioration of the tank body.</p> <p>Inspect the tank for leaks.</p> <p>Check anode rod (see section on changing the anode rod).</p>
Leaking	Check water fittings and T & P fitting on top of tank.
	Remove front cover and inspect heating element gasket.
	If tank is leaking call Westinghouse Water Heating for warranty claim if still within warranty period.
	Check anode rod (see section on changing the anode rod).

7.2 Resetting High Limit Switch

Occasionally, the high temperature limit shut off device may trip the reset. This occurs when water temperature exceeds 190 °F. The shut off device may also trigger from a power outage or electrical storm. To reach the thermostat:

- Disconnect power cord and remove installation cover.
- Firmly press reset button (Fig. 9, [B]) with the tip of a ball point pen or similar object.

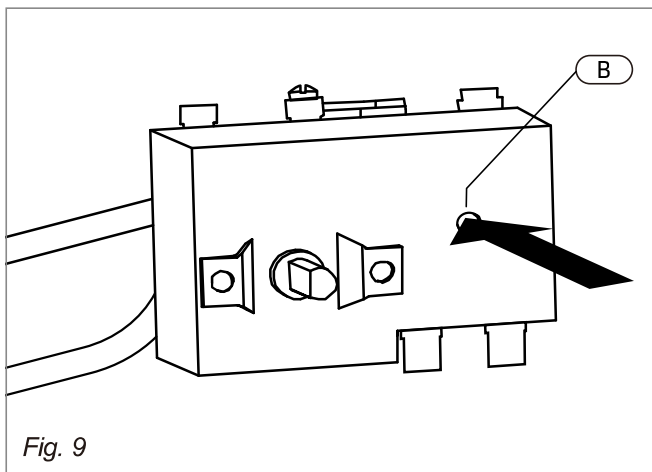

Fig. 9

A click indicates the reset was tripped.

- Reconnect power

IMPORTANT:

- Check the operation of the thermostat: Turn temperature dial from high to low.
- If the red light does not go off on low setting: Turn off power supply and call a service person to replace the thermostat.
- If the red light does go off the thermostat is working well: Place dial setting to desired setting.



NOTICE

A lower setting is more economical and reduces the risk of scalding.

- Replace cover plate.



CAUTION

Call a technician if the high limit needs to be reset frequently.

8 Interior components diagram

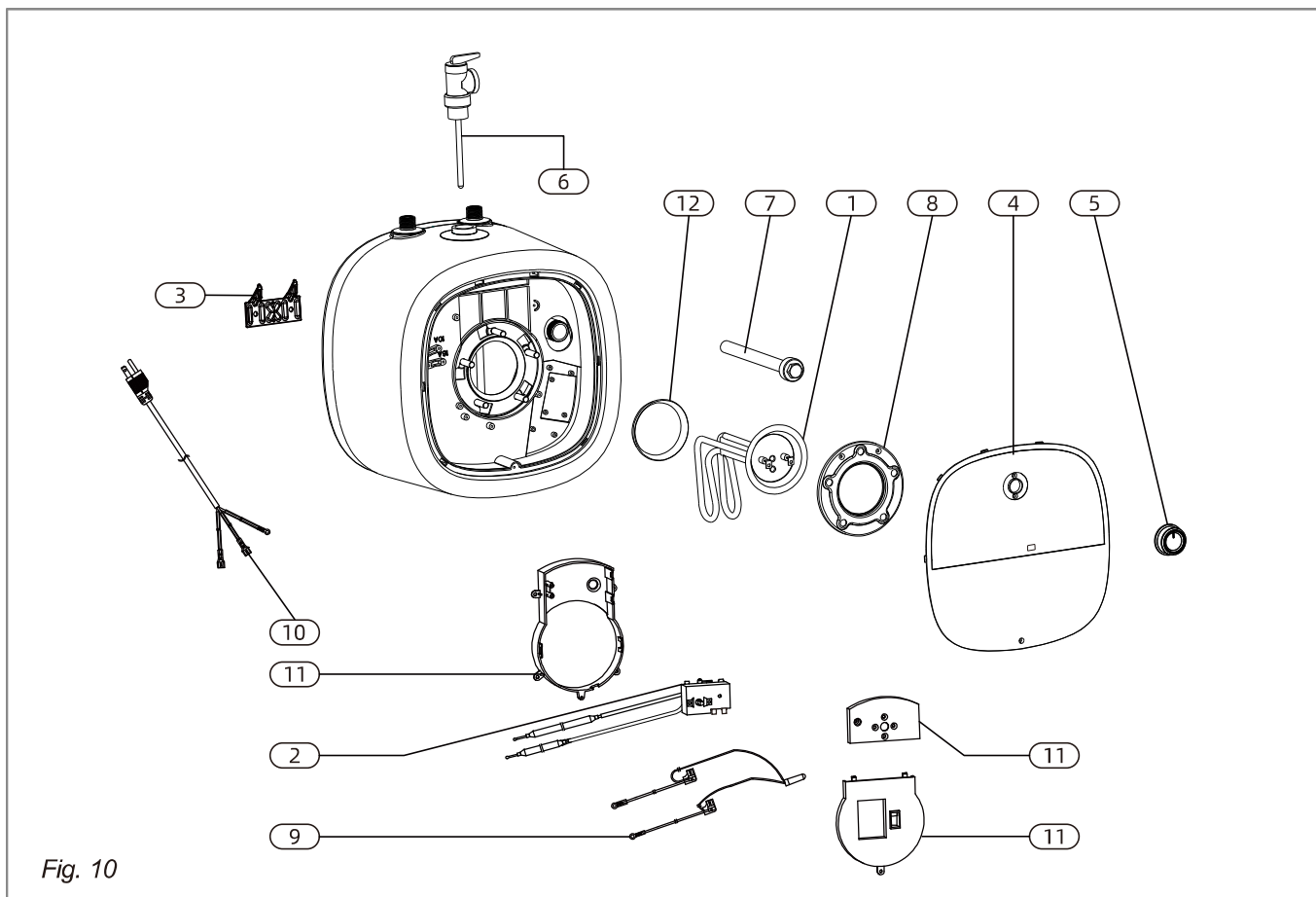

Fig. 10

Part	Description
1	Heating element 1440W
2	Thermostat
3	Heater wall hanging bracket
4	Plastic cover
5	Knob
6	Valve T&P ¾ (attached in the product package)
7	Magnesium anode D:20, L:120 mm
8	Gasket with 5 bolts
9	Lamp
10	Power cable
11	Fireproof component
12	Gasket