

LUOWARE®
WWW.LUOWARE.COM

SMART TOILET

INSTRUCTION MANUAL

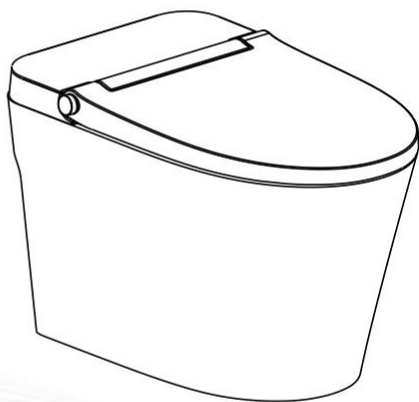

MODEL:
LW-S01, LW-S01 PRO

Customer Service Email:

support@luoware.com

We will respond within 12 hours.

- Thank you for purchasing our product.
Before using, please read the instruction carefully.
Please keep the instruction properly for further reference.
- Our company reserves the right of final interpretation for this manual. The manual is subject to change without notice.

Catalogue

Packing List	02
Installation of the Battery Box	04
Components	05
Technical Drawing	06
Features	06
Attentions	08
Installation Instruction	15
Preparation before Use	21
Panel Instruction	22
How to Use	26
Function Setting and Adjustment	27
Cleaning and Maintenance	32
Troubleshooting	36
Product Specification	37
Acceptance Record	38
Warranty	39

Packing List

Dear user,

Please count the following items after opening the package:

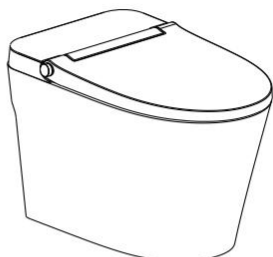

Smart Toilet

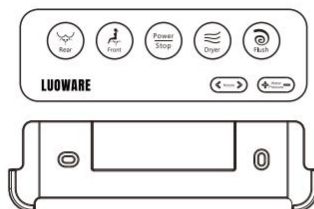

Remote Control & Mounting Bracket

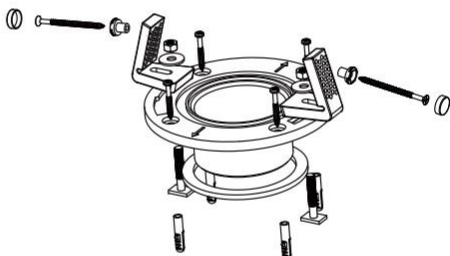

Flange, Sealing Ring,
Mounting Accessory Kit

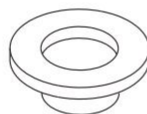

Wax Ring Gasket

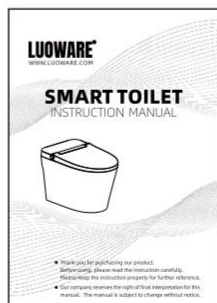

Instruction Manual

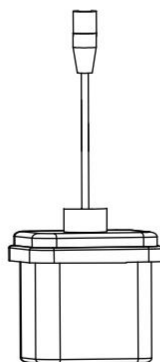

Backup Battery Box
for Power Outage Flush

Packing List

Dear user,

Please count the following items after opening the package:



3/8" to 1/2"
Connector
(Included)

- If your existing shut-off valve has a 3/8" outlet, you can use this connector to connect it to the T-Valve of our smart toilet.
- If your existing shut-off valve has a 1/2" outlet, you can connect it directly to the T-Valve of our smart toilet.

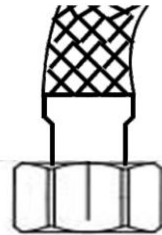

← Braided Hose
for Flushing Water
(Pre-installed
in the toilet)

Braided Hose
for Cleansing Water
(Pre-installed
in the toilet)

T-Valve
(Included)

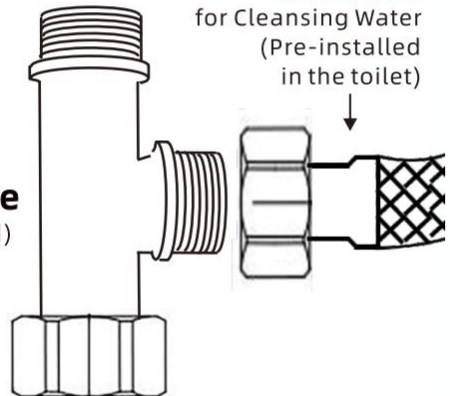

Shut-off Valve
(Optional, not included)

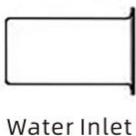

Water Inlet

1/2" Nom Outlet

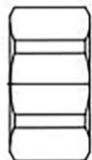

1/2" Nom/Comp Inlet

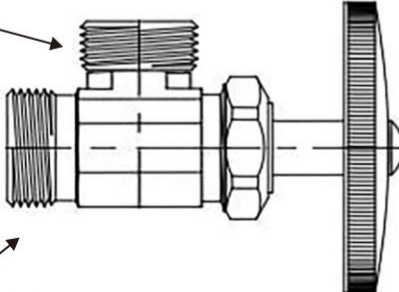

Battery Box for Power Outage Flush

Installation of the Battery Box for Power Outage

1. This battery box is for use as backup during power outages. **The battery box must not be used simultaneously with a plugged-in power source when the toilet is in operation.** It is recommended to connect it to the main unit only during power outages. We accept no responsibility for the consequences of using dual power sources at the same time, and such usage is not covered by the warranty.
2. Before activating the power outage flushing function, install 10 AA alkaline batteries (Batteries not supplied. Please purchase batteries separately before installation.) into the battery box in advance (open the battery box with a screwdriver). Do not mix new and old batteries, batteries of different models, or batteries from different brands. When replacing the batteries, ensure that all are replaced at the same time.
3. Please follow the "+" and "-" signs on the battery box when installing batteries. This battery box is a series battery group, and no single cell can be reversed. Failing to do so may cause battery damage, and in severe cases, may pose safety hazards such as explosion and combustion.
4. Take out the battery connection cable from the rear side of seat cover and connect it to the battery box, ensuring that it is plugged in place.
5. Do not disassemble the battery box unnecessarily. After replacing the battery, make sure to seal the battery box tightly. If moisture from the bathroom gets into the box, it could cause the batteries to rust and become damaged.
6. When replacing batteries, disconnect the battery box from the main unit.
7. To avoid potential hazards, this battery box cannot be recharged.
8. **In the event of a power outage, after connecting the backup battery box, press and hold the side knob for 3 seconds to activate the backup power supply of the unit. Then, press the knob once more to enable the flush.**

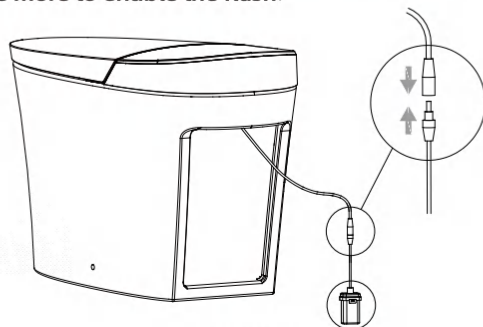

Components

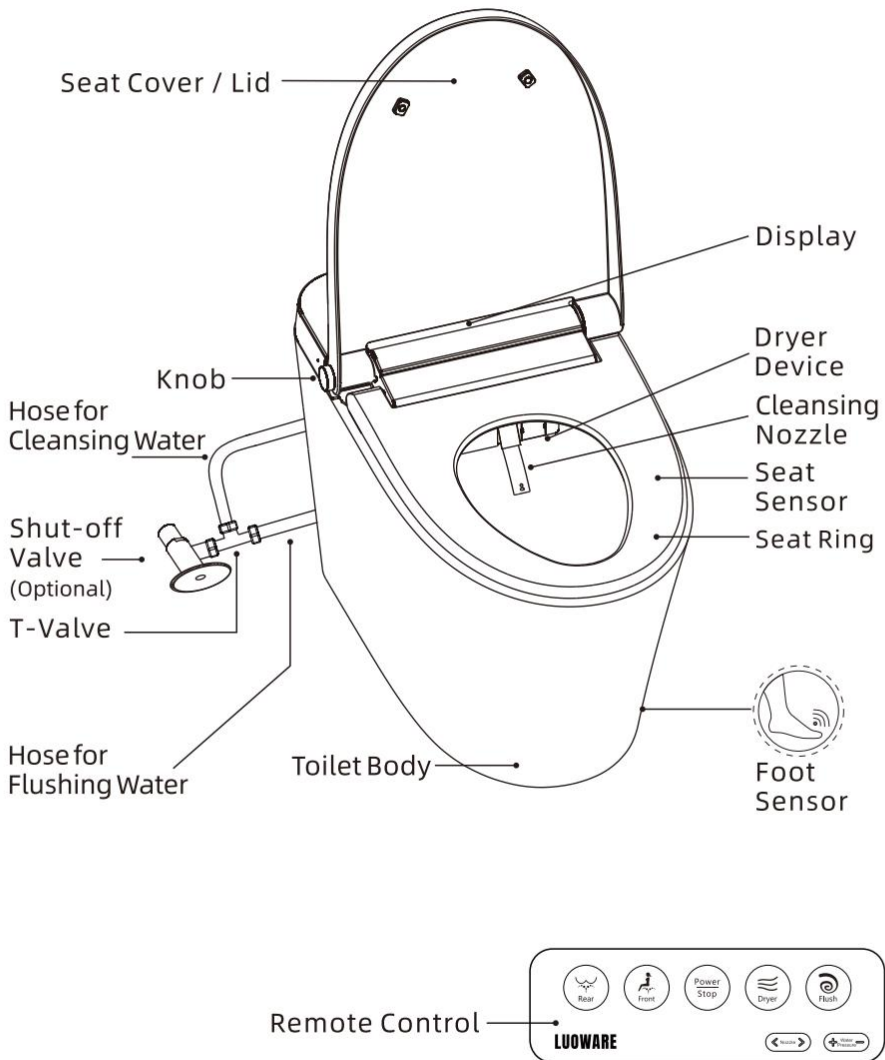

Technical Drawing

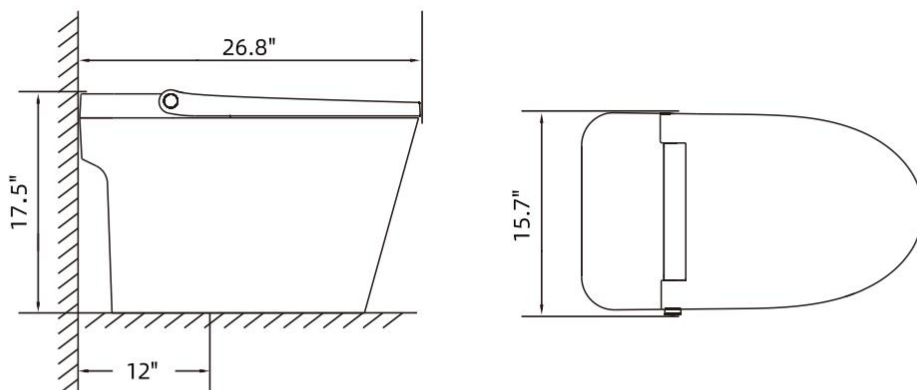

Features

Remark: The below features/functions can also be activated and adjusted by the wireless remote control, details will be listed in the later part of this manual.

COMFORT	DETAILS	LW-S01	LW-S01 PRO
Heated Seat	P30	●	●
Smart Seat Temperature	P30	●	●
Seat Temperature Adjustment	P30	●	●
Warm-Air Dryer	P29	●	●
Air Temperature Adjustment	P30	●	●

● indicates that the product includes the corresponding feature listed in the table, while a blank space indicates that the feature is not included.

The features of different models may vary slightly from those listed in the table. Please refer to the actual product for precise details.

Features

CONVENIENCE	DETAILS	LW-S01	LW-S01 PRO
Auto-Open Lid (Proximity)	P27		●
Auto-Close Lid/Seat and Flush	P27		●
Foot-Sensing Open-and-Close Lid/Seat	P27		●
Open/Close Lid/Seat via Remote Control	P27		●
Wireless Remote	P22,P23	●	●
Side Knob	P24	●	●
Seat Sensor	P26	●	●
Off-Seat Auto Flush	P26	●	●
Foot-Sensing Flush	P31	●	●
Flush via Remote Control	P31	●	●
Flush via Side Knob	P31	●	●
LED Panel	P25	●	●
Night Light	P30	●	●
Built-in Water Tank & Booster Pump	/	●	●
Soft-Close Lid/Seat	/	●	●
Power Outage Flush	P31	●	●
BIDET	DETAILS	LW-S01	LW-S01 PRO
Rear Cleansing (with Nozzle Oscillation)	P28	●	●
Front Cleansing (with Nozzle Oscillation)	P28	●	●
Aperient Wash	P28	●	●
Hot and Cold Water Massage	P29	●	●
Cleansing Strength Adjustment	P29	●	●
Cleansing Position Adjustment	P29	●	●
Cleansing Water Temperature Adjustment	P29	●	●
Self-Cleaning Nozzle	P30	●	●
Detachable Nozzle	P33	●	●
Instant Heated Water	/	●	●

● indicates that the product includes the corresponding feature listed in the table, while a blank space indicates that the feature is not included. The features of different models may vary slightly from those listed in the table. Please refer to the actual product for precise details.

Attentions



NO WATER

Do not pull the plug with wet hand.

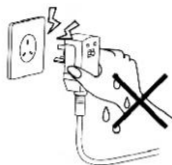

▲Otherwise, it may cause electric shock.



PROHIBIT

Do not pour water, detergent or deodorant on the smart toilet main unit and power plug. Otherwise:



▲It may cause fire, electric shock, short circuit or damage.

▲Injury or indoor water seepage may occur due to product damage.



PROHIBIT

When there is thunder, do not touch the power plug.

▲Otherwise, it may cause electric shock.



PROHIBIT

Do not touch the water inlet hose to the power plug or outlet.

▲Otherwise, it may cause fire, electric shock, heating, or short circuit due to condensation.



PROHIBIT

Do not damage the power cord or plug. Do not forcefully drop, pull, twist, bend, scratch, process, heat, place heavy objects on, tie, or clamp the power cord or plug.

▲Otherwise, it may cause product damage. Continuing to use the product in a damaged state may cause fire, electric shock, heating, or short circuit.



PROHIBIT

Do not use power outlets that are loose or malfunctioning.

▲ Otherwise, it may cause fire or short circuit.



PROHIBIT

Please use power outlets and wiring tools within the specified range.

▲ When the wiring exceeds the specified range of the outlet, it may cause fire due to overheating.



PROHIBIT

Do not use a power source other than the specified one (AC 120V, 60Hz). Please do not plug in until the inlet valve opens.

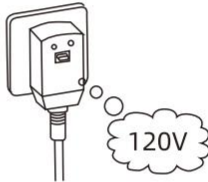

▲ Otherwise, it may cause fire.



NO
DISASSEMBLE

Do not disassemble, repair, or modify this product on your own.

▲ Otherwise, it may cause fire, electric shock, heating, short circuit or damage.



PROHIBIT

Do not install on a moving vehicle, ship, or other mobile structure. Otherwise:

▲ It may cause fire, electric shock, short circuit, or malfunction.

▲ The seat ring, seat cover, and smart toilet main unit may be damaged due to detachment and falling.



PROHIBIT

When the smart toilet malfunctions, do not continue to use it. In the following situations, turn off the power and close the water inlet valve to stop the water supply.

- *Water leaks from the hose or product inside to the outside.
- *The product has cracks or damage.
- *Abnormal sound or odor.
- *Product smoking.
- *Product abnormal heating.
- *The cushion of the seat ring falls off.

▲ Continuing to use the product in a malfunctioning state may cause fire, electric shock, heating, short circuit, injury, or indoor water seepage.



Do not use water sources other than tap water or potable well water (groundwater). Otherwise:

PROHIBIT

▲ It may cause corrosion in components or machine malfunctions.

▲ It may cause skin inflammation or burns due to unclean water.



Do not put your fingers or other objects into or block the warm air outlet, and do not place or cover objects or clothing on the warm air outlet.

PROHIBIT

▲ Otherwise, it may cause burn, electric shock, or burning of accessories.



Beware of low-temperature burns.

MANDATORY

▲ Improper use of the warm seat ring may result in low-temperature burns.

▲ If sitting on the seat ring for a long time, please set the temperature of the seat ring to normal/unheated (room temperature).

▲ When using the warm seat ring or warm air drying function, please set the temperature of the seat ring to normal/unheated (room temperature) and the temperature of the warm air dryer to the lowest setting for the following groups of people.

* Children, the elderly, and those who are unable to adjust the temperature to a suitable level themselves.

* Individuals with behavioral impairments such as patients or people with disabilities.

* Individuals who have taken hypnotic drugs (such as sleeping pills, cold medicine, etc.), heavy drinkers, and those who are excessively fatigued must use this product under the supervision of a responsible person.



Please confirm that the power outlet has been waterproofed.

MANDATORY

▲ Make sure of the position of the outlet before installation and keep it away from the bathtub as much as possible.

▲ If it is not waterproofed, it may cause fire or electric shock.

▲ For the installation and waterproofing of the outlet, please consult qualified professionals.



Please confirm that the outlet being used is correctly grounded.

MANDATORY

▲ Otherwise, it may cause electric shock due to malfunction or short circuit.

▲ When installing the ground wire, please entrust a professional installation company.



MANDATORY

Do not pull out the power plug by holding the power cord. When unplugging the power plug, do not hold the power cord, but hold the power plug.

▲Otherwise, it may cause fire or heating due to damage to the power cord.



MANDATORY

Please make sure to firmly insert the power plug into the outlet.

▲Otherwise, it may cause fire, heating, or short circuit.



MANDATORY

If the power cord is damaged, it must be replaced by the manufacturer, maintenance department, or other professionals to avoid potential hazards.



MANDATORY

When performing maintenance (not include the nozzle cleaning function), be sure to turn off the power.

▲Otherwise, it may cause electric shock.



MANDATORY

This is an electrical product. Do not install it in places where it is easy to be splashed with water or where the humidity is high. When using it in the bathroom, please install an exhaust fan or ventilation opening to keep the bathroom well ventilated.



▲Otherwise, it may cause fire or electric shock.



MANDATORY

When removing the smart toilet main unit, be sure to disconnect the power.

▲Otherwise, it may cause fire or electric shock.



MANDATORY

Individuals with physical, sensory, or cognitive disabilities, or those lacking experience and knowledge of this product (including children), must use this product under the supervision of a responsible person. Children should not play with this product.

▲Otherwise, it may cause burn, electric shock, fire, or injury.



NO BURNING

Do not let cigarettes or other sources of fire get close to the product.

▲Otherwise, it may cause fire.



PROHIBIT

When maintaining plastic parts (seat ring, seat cover, etc.) and water inlet hoses, please use kitchen detergent (neutral). Do not use the following items: toilet cleaner, household detergent, gasoline, benzene, washing powder, or nylon brushes. Otherwise:

▲It may damage plastic parts, causing cracks and resulting in personal injury or malfunction.

▲It may damage the water inlet hose and cause water leakage.



PROHIBIT

Do not forcibly impact the product. Do not place heavy objects on or stand on the seat ring, seat cover, or smart toilet main unit. Otherwise:

▲The product may crack, and the smart toilet main unit may detach and fall, causing personal injury.

▲Injury or indoor water seepage may occur due to product damage.



PROHIBIT

Do not use the smart toilet when its main unit is loose.

▲Otherwise, the smart toilet main unit may detach and fall, causing personal injury.



PROHIBIT

Do not use your hands to lift the smart toilet main unit by holding the seat ring or seat cover. Do not open the seat ring or seat cover when there are items on them.

▲Otherwise, the smart toilet main unit may detach and fall, causing personal injury.



PROHIBIT

Do not violently open or close the seat cover or seat ring, or swing the seat cover and seat ring quickly. Otherwise:

▲The flipping device may fail due to the powerful external force.

▲The main unit may break or detach from the toilet body due to powerful external force, causing personal injury.



PROHIBIT

Do not bend or damage the water inlet hose.

▲Otherwise, it may cause water leakage.



PROHIBIT

To prevent sudden water leakage, do not remove the t-valve and the hose when the shut-off valve is open.

▲ Otherwise, water may spray out.

▲ Please turn off the shut-off valve when you try to remove the t-valve and the hose.



PROHIBIT

Please use the new hose component provided with the product. The old hose cannot be reused.

▲ Using the old hose component may result in water leakage or hose rupture.



MANDATORY

When water leaks, be sure to turn off the shut-off valve.



MANDATORY

In order to prevent pipes or hoses from being damaged due to freezing, anti-freezing measures should be taken.

▲ When the water inlet hose is frozen, it may damage the main unit of the smart toilet or the pipe and cause water leakage.

▲ If the room temperature is below 32°F/0°C, it is recommended to empty the water inside the product to prevent internal cracking due to freezing.



MANDATORY

When the smart toilet is not used for a long time, be sure to drain the water from the smart toilet main unit and water inlet hose, and disconnect the power supply. When using it again, please first let the water flow through, and then use it. Otherwise:

▲ It may cause skin inflammation due to water deterioration.

▲ If the power is always turned on, it may cause fire or heating.



MANDATORY

When installing the water inlet filter, make sure to tighten it firmly to the correct position.

▲ Otherwise, it may cause water leakage.



MANDATORY

Do not use any paper other than toilet paper, and do not drop objects that may clog the drain into the toilet bowl.

▲ Otherwise, it may cause blockages in the ceramic pipes of the toilet.



Do not operate the remote control with wet hands, and do not spill water on the remote control.

PROHIBIT

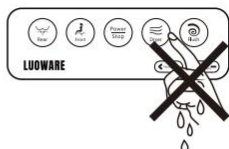

▲ Otherwise, it may cause remote control malfunctions.



Do not put any solid substances or corrosive liquids into the water tank.

▲ Otherwise, it may cause blockages or corrosion of the flushing water pipe.

PROHIBIT

Installation Instruction

■ Installation of the Smart Toilet

1. Confirmation of installation environment

Before installation, please confirm that the bathroom wall and floor tiles have been completed, and that the sewage pipes, water pipes, and electrical circuits have been reserved as shown in the figure below. This toilet rough-in is 300mm (11.81in); Water inlet pressure range: 0.15Mpa (dynamic) - 0.75Mpa (static); water inlet temperature: 4°C-35°C (39.2°F-95°F).

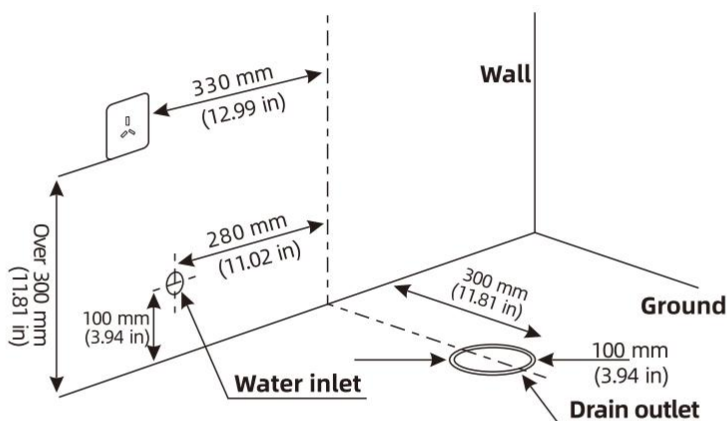

2. Assembly of shut-off valve (optional)

Install the shut-off valve (optional).

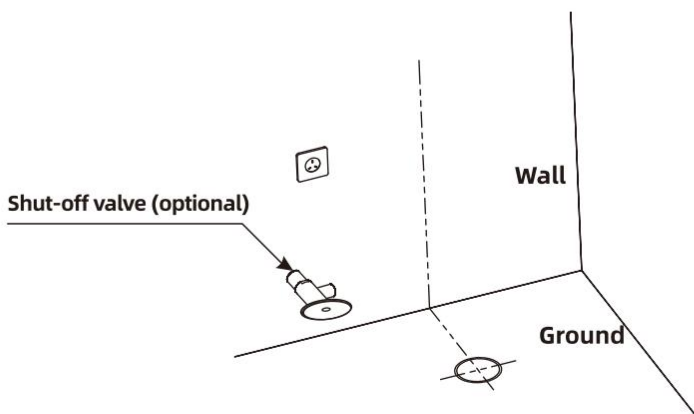

3. Installation and mounting of the toilet

(1.1) Assemble the mounting bracket with bolts and then secure them to the flange on the ground and tighten with nuts. **Please refer to Figure 1.0 on the next page for details.**

(1.2) Insert the wax ring gasket under the toilet.

(1.3) Install the toilet on the corresponding position.

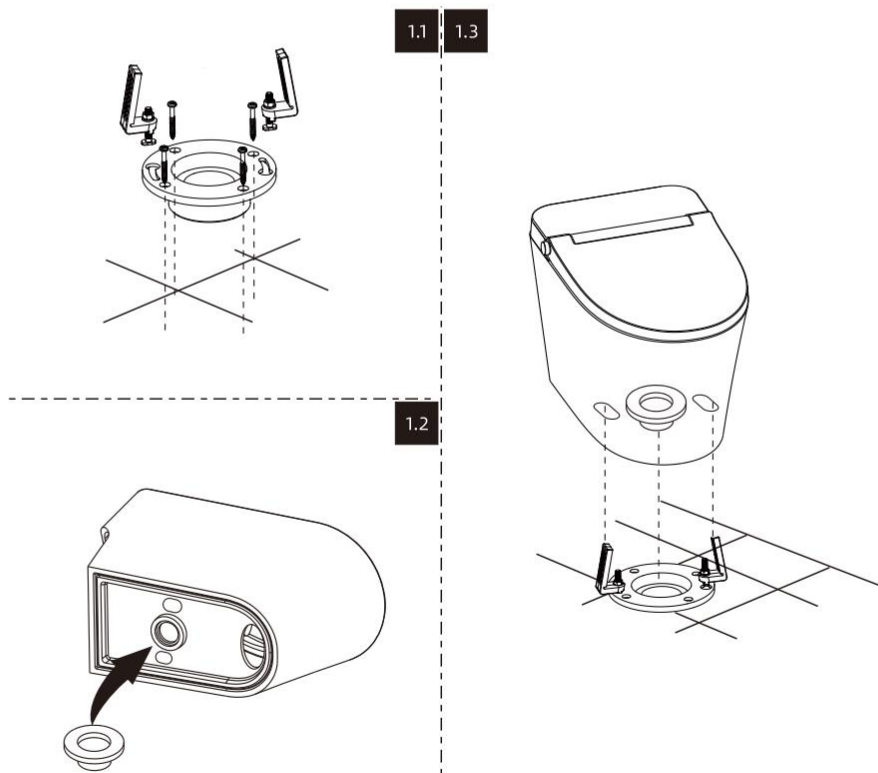

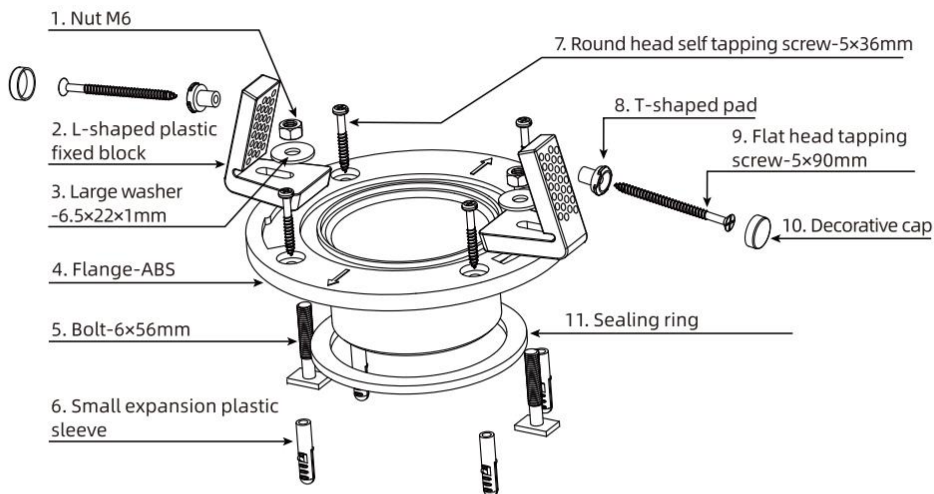

Flange accessories package

Details:

1. Nut M6 (2pcs)
2. L-shaped plastic fixed block (2pcs)
3. Large washer-6.5×22×1mm (2pcs)
4. Flange-ABS (1pc)
5. Bolt-6×56mm (2pcs)
6. Small expansion plastic sleeve (4pcs)
7. Round head self tapping screw-5×36mm (4pcs)
8. T-shaped pad (2pcs)
9. Flat head tapping screw-5×90mm (2pcs)
10. Decorative cap (2pcs)
11. Sealing ring

Optional accessories

12. Outer hexagon self tapping screw-10×65mm (2pcs)
13. Small washer-6×16×1mm (2pcs)
14. Large expansion plastic sleeve (2 pcs)

Optional accessories

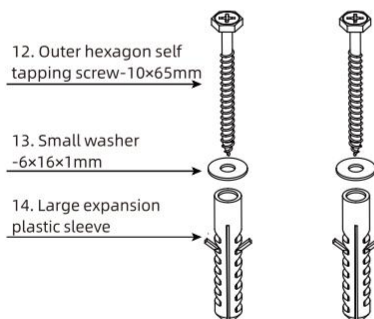

(2.1) Put the screw through the T-shaped pad and then install it through the holes (on both sides of the toilet ceramic) to the mounting bracket (L-shaped plastic fixed block) on the ground, and tighten it securely with a tool.

(2.2) Put the decorative cap on the T-shaped pad.

(2.3) Connect the water inlet hose and water pump with the water tank and tighten them with an adjustable wrench.

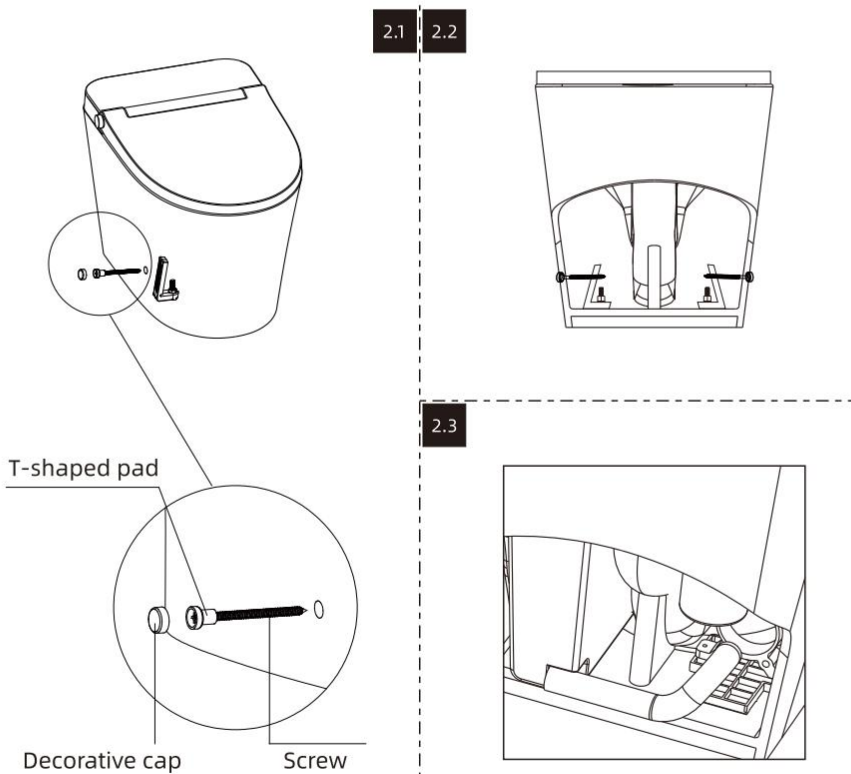

(3) Caulk the bottom of the toilet with silicone sealant.

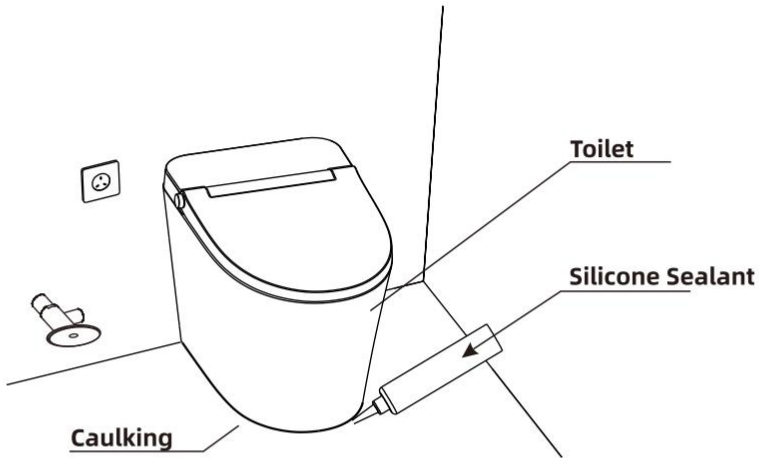

4. Connection of the water inlet hose

Connect the inlet hose with the shut-off valve & t-valve by using tools like wrench.
(Valve Installation - Refer to Page 3 for Details)

● Notice: After installation, turn on the shut-off valve to check whether it leaks.

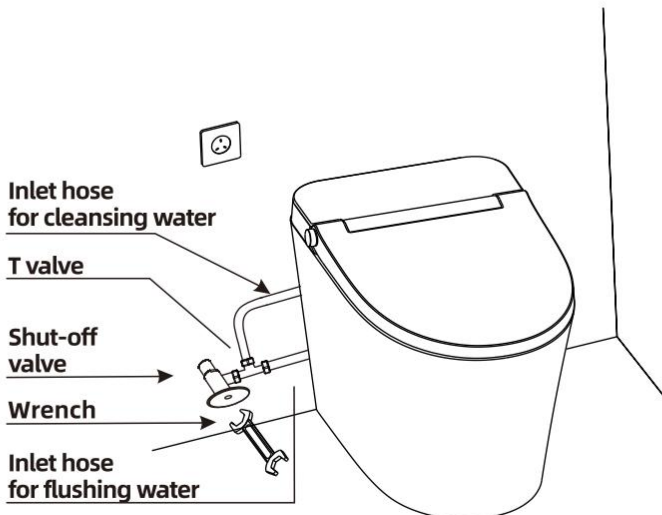

■ Installation of the Remote Control

1. Installation of remote control batteries.

Open the battery cover of the remote control and put two alkaline batteries (AAA) into the remote control one by one.

- When installing the batteries, do not reverse the positive and negative sides of the batteries.
- Do not use different or different types of batteries at the same time.
- Remove the batteries when it is not in use for a long time.

2. Confirm the installation location of the remote control.

Install the remote control in a suitable area where it is easy to get or operate when user sit on the smart toilet.

3. Install the remote control bracket on the wall.

Peel off the protective tape of 3M adhesive on the back of the bracket and apply to the selected dry tile surface.

4. Install the remote control.

Align the remote control with the bracket, insert it from top to bottom, and the installation is completed.

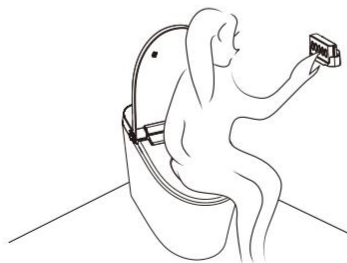
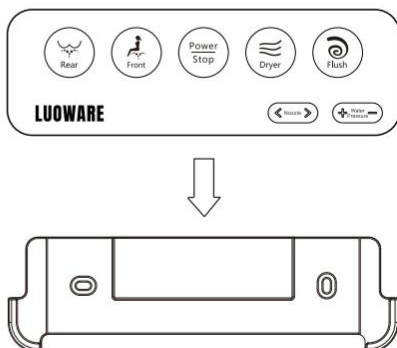

Preparation before Use

1. Open the shut-off valve

Turn the valve counterclockwise to fully open the water supply valve.

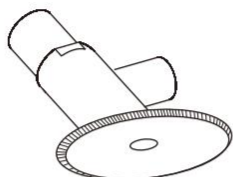

2. Plug the power plug into the outlet.

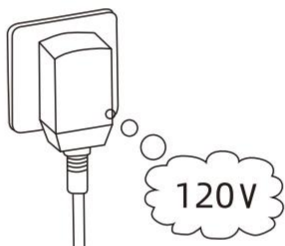

(1) Plug the power plug into a 120V power outlet. The smart toilet will perform a self-check run once, and the main unit will be in standby mode.

- Do not use wiring that exceeds the power supply specifications, such as an extension cord.
- The outlet must be reliably and safely grounded.

3. Adjust the cleansing water temperature and the seat temperature to the appropriate level.

4. Refer to Function Setting and Adjustment on Page 27 and use the remote control to operate various functions.

Panel Instruction

This product is designed primarily for remote control operation, with main unit panel operation as a supplement.

■ Remote Control Panel

MODEL: LW-S01

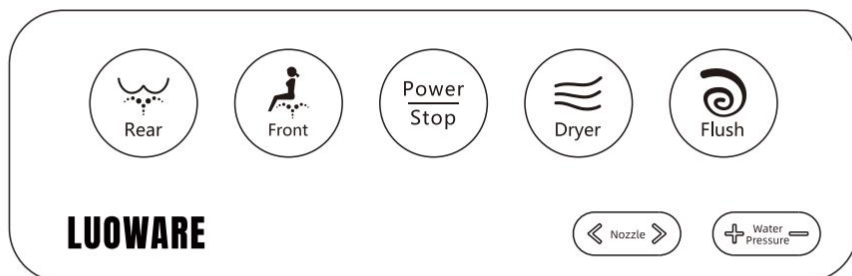

Front

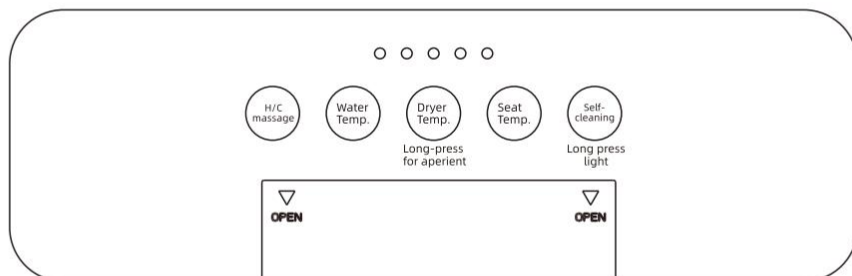

Back

Note: The appearance and functions of the remote control may vary slightly for different models. Please refer to the actual product for details.

● Match the remote control

Turn the side knob to the rear cleansing direction for 3 seconds. You will hear a short sound "beep", and the screen will flash once. Then turn the side knob to the front cleansing direction for 3 seconds to enter the mode with "beep-beep-beep" sound. If the remote control does not successfully match the toilet within 10 seconds, the screen (full screen) will flash continuously. If it reads the remote control serial number, the screen will return to normal after a long sound.

■ Remote Control Panel

MODEL: LW-S01 PRO

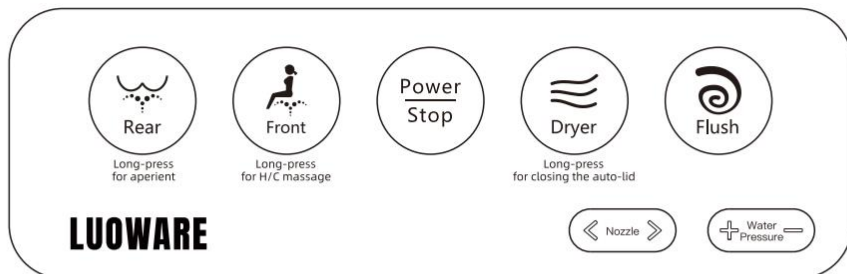

Front

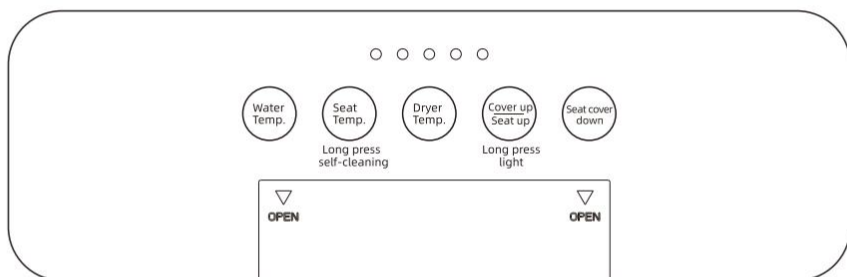

Back

Note: The appearance and functions of the remote control may vary slightly for different models. Please refer to the actual product for details.

● Match the remote control

Turn the side knob to the rear cleansing direction for 3 seconds. You will hear a short sound "beep", and the screen will flash once. Then turn the side knob to the front cleansing direction for 3 seconds to enter the mode with "beep-beep-beep" sound. If the remote control does not successfully match the toilet within 10 seconds, the screen (full screen) will flash continuously. If it reads the remote control serial number, the screen will return to normal after a long sound.

■ Function Side Knob (with Light Ring) on the Main Unit.

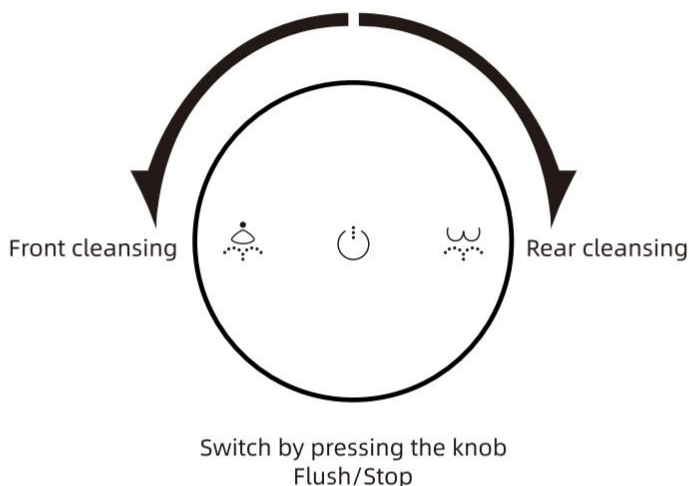

- When in non-working condition (e.g. not cleansing or drying), press the knob down vertically to flush once.
- When in a seated position, rotate clockwise to activate the rear cleansing function; rotate counterclockwise to activate the front/female cleansing function; press down vertically to stop the running function (such as rear cleansing, female cleansing, drying).
- When in the rear cleansing or front cleansing mode, rotate the knob in the same direction once more to activate the drying function.

■ Display Screen on the Main unit



Power indicator: Lights up when the main unit is turned on.



Temperature level: Displays the set temperature when the main unit is turned on.



Air temperature icon: When the icon lights up, it shows the set temperature of the air dryer.



Seat temperature icon: When the icon lights up, it shows the set temperature of the seat ring.



Cleansing water temperature icon: When the icon lights up, it shows the set temperature of the cleansing water.

- The temperature displayed on the screen is the set temperature. It will cycle through the cleansing water temperature, seat temperature, and air dryer temperature every 30 seconds.
- When the user leaves the toilet sensor area, the screen will automatically turn off after approximately 30 seconds.

How to Use

■ When Sitting on the Seat Ring

- Upon hearing the "beep" sound, the various functions of the smart toilet will begin to start up.
- The nozzle will clean itself automatically.

■ Start Rear Cleansing or Front Cleansing Function

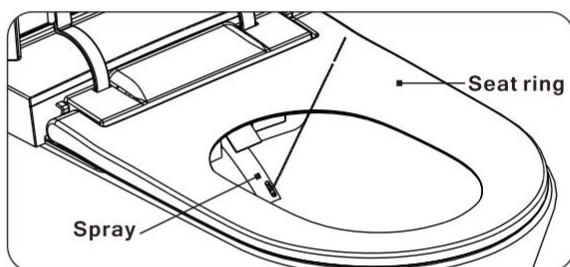

- Start the rear or front cleansing function using the remote control.
- Adjust the cleansing position and water pressure using the remote control.
- Start the drying function using the remote control.
- Press "stop" button to stop the bidet function (rear cleansing, front cleansing or drying).

■ When standing up from the seat (Off-Seat Auto Flush)

- The toilet will auto flush once.

Function Setting and Adjustment

■ Auto-Open Lid (Proximity)

LW-S01 PRO ONLY

● The lid will open automatically when the user approaches the front of the toilet. Long Press the button  on the remote control to turn this function on or off.

■ Lid/Seat Ring Open/Close

LW-S01 PRO ONLY



● The product has a foot sensing function for opening the toilet lid/seat ring. When user lifts their foot around the sensor, they can perform the lid/seat ring flipping operation.

In the unseated state:

- When the seat cover and seat ring are closed, lift your foot once around the sensor on the side of the toilet to flip the seat cover;
- When the seat cover is open and the seat ring is closed, lift your foot once around the sensor to flip the seat ring.
- When both the seat cover and seat ring are open, lift your foot once to close the seat cover and seat ring, and flush once (if the last operation performed was a flush, then it will not flush again this time).

● Press the button "Cover up/Seat up"  "Seat cover down"  on the remote control to open/close the lid and seat ring.

In the unseated state:

- Press the button "Cover up/Seat up"  to achieve the "seat cover up-seat ring up-seat ring down-seat ring up" function via the remote control.
- Press the button "Seat cover down" , and the seat ring and seat cover will close, and flush once (if the last operation performed was a flush, then it will not flush again this time).
- If both the seat ring and seat cover are in the closed state, pressing the "Seat cover down" button will not perform any operation.
- When the toilet is in rear cleansing, front cleansing, or drying mode, the lid/seat ring open/close function will be temporarily disabled.

■ Auto-Close Lid/Seat and Flush

LW-S01 PRO ONLY

- The lid/seat closes automatically 2 minutes after being vacated and flushes once. (If the last operation performed was a flush, it will not flush again this time.)

■ Aperient

● The product has aperient function where cleansing water comes from the single-hole of the nozzle to assist with bowel movements. Enjoy this feature by long pressing the button on remote control.



MODEL: LW-S01

or



MODEL: LW-S01 PRO

- In the seated state, press the button on the remote control with a following "beep" sound to start the aperient function. You can end it by pressing the "Stop" button on the remote control or pressing the side knob down vertically.
- In this mode, the water pressure is fixed and unadjustable, but the nozzle position and water temperature can be adjusted.

■ Rear Cleansing

● This product has a rear cleansing bidet function by using a single-hole high-pressure cleaning nozzle.



- Press the button on the remote control to enter the rear cleansing mode.
- In rear cleansing mode, the oscillating cleansing function is enabled by default (the nozzle moves back and forth). Press the button again to deactivate the oscillating cleansing function (the nozzle stops moving). You can switch between these functions circularly.
- Rear cleansing will automatically turn off after approximately 90 seconds. You can switch to other functions or simply press the button to deactivate it before the 90 seconds are up.
- The nozzle will automatically clean itself before and after rear cleansing.



■ Front Cleansing/Female Cleansing



● This product has a female cleansing function, with a dedicated nozzle hole for gentle cleansing.





- Press the button on the remote control to activate the front cleansing mode.
- In front cleansing mode, the oscillating cleansing function is enabled by default (the nozzle moves back and forth). Press the button again to deactivate the oscillating cleansing function (the nozzle stops moving). You can switch between these functions circularly.
- Front cleansing will automatically turn off after approximately 90 seconds. You can switch to other functions or simply press the button to deactivate it before the 90 seconds are up.
- The nozzle will automatically clean itself before and after front cleansing.





■ Water Pressure Adjustment

- In rear cleansing or front cleansing mode, press the button  to adjust the water pressure strength according to your preference.
- 4 levels of water pressure are available. Press the button  to enter the adjustment mode and adjust it to your desired intensity.



■ Nozzle Position Adjustment

- In rear cleansing or front cleansing mode, press the button  to move the nozzle back and forth and adjust the cleansing position to your liking.
- 5 levels of nozzle position are available. Press the button  to enter the adjustment mode and adjust it to your desired position.



■ Cleansing Water Temperature Adjustment

- Press the remote control button , and the main unit will respond with a "beep" sound prompt, entering the water temperature setting mode. Adjust the cleansing water temperature to the appropriate level.
- The water temperature can be adjusted to 4 different levels, including room temperature, high, medium, and low levels. Press the water temperature button  once to switch to another level.



■ H/C Massage

- Press the remote control button  **MODEL: LW-S01** or long press  **MODEL: LW-S01 PRO** will activate the nozzle to alternate between hot and cold water to massage, with the water temperature switching back and forth between normal/room temperature and the user's setting temperature level. If the user's setting temperature level is normal/room temperature, then the water temperature will alternate between the normal level and the low level.



■ Drying Function

- Press the remote control button  to activate the air dryer. By activating this function, the device will blow warm air onto the wet areas to dry them.
- Drying function will automatically turn off after approximately 3 minutes. You can switch to other functions or simply press the  button to deactivate it before the 3 minutes are up.

■ Air Dryer Temperature Adjustment

- Press the remote control button  , and the main unit will respond with a "beep" sound prompt, entering the dryer temperature setting mode. Adjust the air dryer temperature to the appropriate level.
- The dryer temperature can be adjusted to 4 different levels, including room temperature, high, medium, and low levels. Press the button  once to switch to another level.

■ Seat Ring Temperature Adjustment

- Press the remote control button  , and the main unit will respond with a "beep" sound prompt, entering the seat ring temperature setting mode. Adjust the seat ring temperature to your liking.
- The seat ring temperature can be adjusted to 4 different levels, including room temperature, high, medium, and low levels. Press the button  once to switch to another level.



■ Smart Seat Temperature

- The toilet seat is set to Smart Seat Heating mode by default, meaning it auto adjusts the seat temperature based on room temperature.
- Pressing the seat temperature button on the remote will deactivate Smart Seat Heating. Restart the smart toilet to re-enter Smart Seat Heating mode.

■ Night Light

- This product is equipped with lighting function for convenient use at night.
- Long press the remote control button  **MODEL: LW-S01** or  **MODEL: LW-S01 PRO** will turn on or turn off the night light function.

■ Nozzle Cleaning

- Press the remote control button  **MODEL: LW-S01** or long press  **MODEL: LW-S01 PRO** to activate the nozzle cleaning function, and the water flow continuously from the inside of the nozzle to clean it.
- This function can only be activated when the user is not seated.
- The nozzle cleaning process takes approximately 60 seconds and can be stopped by pressing the stop button  .

■ Power Button

- The power button  on the remote control can be used to turn the smart toilet system on or off. **LONG PRESS to turn it on/off.**

■ Flush via the Remote Control



- To flush the toilet once, press the flush button . If you want to flush continuously, there needs to be a 30-second interval between each flush.
- When the cleansing mode is activated, flushing the toilet will stop the cleansing function.

■ Flush via Foot Sensor

- Designed specifically for men's urination, no need to bend down to find the button or look for the remote control to flush, just place your foot in the sensing area to achieve flushing.
- To activate the flush, stretch your foot slightly against the sensor sign on the ceramic surface, and the water will start flowing once you remove your foot.

■ Flush via the Side Knob

- Press the knob down vertically to flush once.
- When the cleansing mode is activated, flushing the toilet will stop the cleansing function.

■ Flush During Power Outage

- In the event of a power outage, after connecting the backup battery box (refer to page 4 for installation instructions), press and hold the side knob for 3 seconds to activate the backup power supply of the unit. Then, press the knob once more to enable the flush.

Cleaning and Maintenance

■ Clean and Maintain the Power Plug

Please clean the power plug regularly. When cleaning, remove the power plug from the outlet and wipe it with a dry cloth.

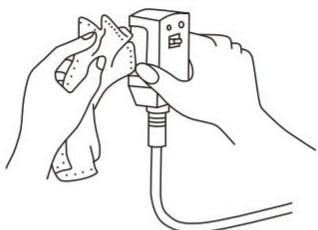

- Dust accumulation on the power plug may cause fire.

■ Clean and Maintain the Main Unit of the Smart Toilet

When cleaning the surface of the main unit, please wipe it with a soft, wet cloth.

- When cleaning and maintaining the smart toilet main unit, please pull the power plug out of the outlet to avoid any contact with water.
- If the surface has stubborn stains, you can use a soft, wet cloth with neutral kitchen detergent to clean it.



■ Clean and Maintain the Ceramic Part of the Smart Toilet

You can pour a neutral toilet cleaner onto a soft brush or sponge and use it to clean the ceramic part of the smart toilet. Rinse the area with tap water after cleaning.

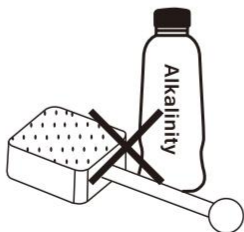
- Do not use detergents or disinfectants that contain chlorine or are acidic.
- Do not use brushes that contain abrasive materials.



■ Clean and Maintain the Nozzle

When the smart toilet is turned on, press the remote control button  or long press  **MODEL: LW-S01 PRO** to activate the nozzle cleaning function. The nozzle will extend and clean itself with water. And you can also remove the nozzle head for cleaning under tap water. Please do not forcefully stretch the nozzle.

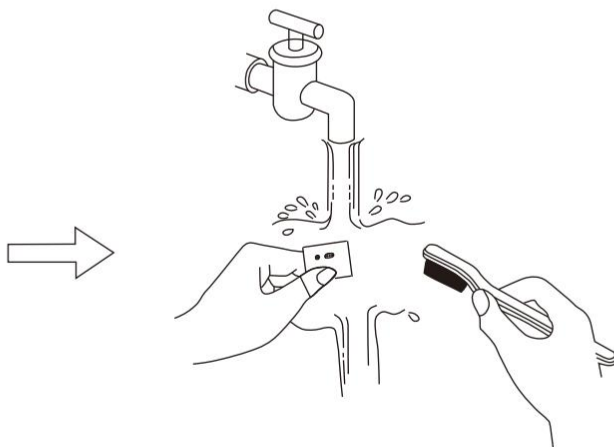
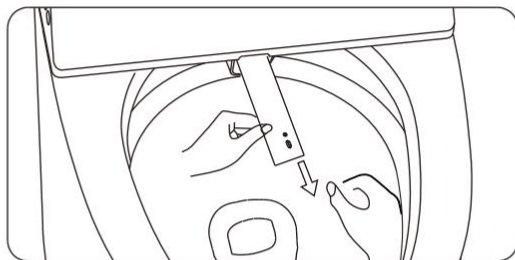

■ When not in use for a long time

When not using this product for a long time, please be sure to drain all the water from the smart toilet to prevent water deterioration and freezing. Also, turn off the power and remove the battery from the remote control.

(1) Close the shut-off valve and stop the water supply.

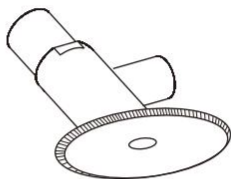

(2) Unplug the power plug from the outlet.

(3) Remove the water hose from the shut-off valve, drain the water from the hose, and then reinstall it.

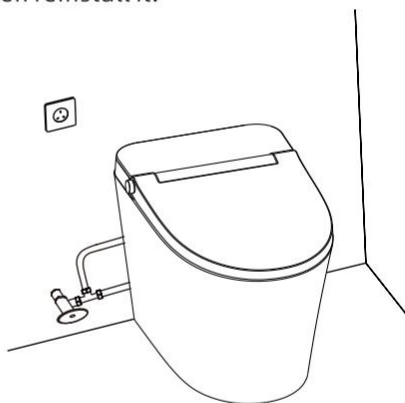

● When using again, open the shut-off valve, plug the power plug back into the outlet, turn on the power to use.

■ When Freezing Occurs

In cold seasons, the smart toilet may be damaged due to internal freezing. To prevent freezing, keep the power connected and perform the following operations:

- (1) Set the seat temperature and water temperature to the highest setting.
- (2) If the water hose inside freezes and causes the spray water to be blocked and unable to be ejected, please use a cloth soaked in warm water to warm up the water hose and slowly thaw it. You can also turn on the heater to warm up the room and let it thaw on its own.

■ When Condensation Appears

Due to the difference in temperature and humidity between bathroom and the ceramic parts/surface of the smart toilet, water droplets (condensation) may appear on the ceramic parts and surface of the main unit. Please ventilate the bathroom sufficiently to avoid condensation.

- When condensation appears, wipe it with a dry cloth.

■ Replacing the Remote Control Battery

When the remote control becomes unresponsive or the indicator light does not light up, please replace the battery with a new one.

- When installing the battery, do not reverse the positive and negative poles.
- Do not use batteries of different ages or different types at the same time.
- When not in use for a long time, be sure to remove the battery.

Troubleshooting

Some malfunctions can be resolved by simple operations. Please confirm the following items before authorizing a professional to repair the product.

Problem		Possible Reason	Solution
Press the power button and it does not work (the ambient light is not on).		Is the power outlet powered on?	Please confirm whether there is a power failure or whether the circuit breaker has tripped.
		Is the power plug switch in the off position? (Is the power plug indicator light off?)	Press the reset button on the power plug to light up the indicator light.
		Is the power plug plugged in properly?	Reconnect the power plug and insert it completely.
The remote control is insensitive or unresponsive.		Is the remote control battery dead?	Replace with a new battery.
The seat temperature, water temperature, and drying temperature are not hot enough.		Are the temperature settings appropriate?	Use the remote control to set the corresponding temperature.
The button does not respond.		During normal operation, some buttons may not respond.	Some operations cannot be performed simultaneously (such as flushing during cleansing). Please read this manual carefully.
The nozzle does not spray water or the water pressure is weak.	Alarm sound occurs.	Is the tap water turned off?	Wait for the tap water supply to be restored.
		Is the water supply valve open?	Turn on the water supply valve.
		Is the hose clogged?	Clean the hose.
	No alarm sound.	Is the water pressure too low? Is the water pressure setting on the remote control at the lowest level?	Press the button  to increase the water force.
		After sitting down, did you hear the prompt tone "beep"? Are you sitting within the effective range of the sensor?	Please sit on the seat and adjust to an appropriate sitting position.
Press any button and it does not work (the ambient light is on).		If you accidentally turn off the "POWER/STOP" button on the remote, all functions will be deactivated.	To reactivate them, long-press the "POWER/STOP" button.

Product Specification

Model		LW-S01 , LW-S01 PRO
Rated Voltage		120V~60Hz
Rated Power		1300W (water intake temperature of 59°F [15°C(±1°C)], water pressure of 0.24MPa, maximum level for front cleansing)
Power Cord Length		1.1M
Water Pressure Range		0.15MPa (dynamic pressure) ~ 0.75MPa (static pressure)
Flush Volume		1.11 gallons per flush (Less than 4.2L)
Cleansing Water Consumption		Less than 13.5oz/min (Less than 0.4L/min)
Energy Consumption per Unit Cycle		Less than 0.03kWh
Overall Unit Waterproof		IPX4
Product Dimensions		LWH: 26.8*15.7*17.5in (680*400*445mm)
Product Weight		84.9 LB (38.5KG)
Bidet Function	Water Heating Method	Instantaneous Heating
	Water Pressure	4-level adjustable
	Water Temperature	4-level adjustable: 1st level 95°F, 2nd level 100°F, 3rd level 104°F, room temperature
	Maximum Power for Water Heating	1200W
	Safety Device	Thermal Fuse
Heated Seat Ring	Heating Power	40W
	Seat Ring Temperature	4-level adjustable: 1st level 95°F, 2nd level 100°F, 3rd level 104°F, room temperature
	Safety Device	Thermal Fuse
Drying Function	Wind Speed	Greater than 8.9 mph (Greater than 4m/s)
	Heating Power	270W
	Wind Temperature	4-level adjustable: 1st level 95°F, 2nd level 113°F, 3rd level 131°F, room temperature
	Safety Device	Reversible Thermal Protector, Thermal Fuse
 ETL Listed		CONFORMS TO: UL STD.1431 & 1951 CERTIFIED TO: CSA STD. C22.2 No.68 & 64 ASME A112.4.2-2021/CSA B45.16-21

Acceptance Record

After the installation is complete, please test run the toilet and fill out the record sheet with the results:

Acceptance Item	Acceptance Result		
Is the power outlet AC 120V±10%, load ≥1300W?			
Is the power outlet loose, or is the power connection in bad contact?			
Is each accessory securely connected without water leakage?			
Is the toilet's ambient light on?			
Is the bidet nozzle leaking?			
Is the "flip" function of the lid/seat working properly?			
Is the "rear cleansing" function working properly (including levels adjustment)?			
Is the "front cleansing" function working properly (including levels adjustment)?			
Is the "oscillating cleansing" function working properly (including levels adjustment)?			
Is the "water temperature" working properly (including temperature adjustment)?			
Is the "seat ring temperature" working properly (including temperature adjustment)?			
Is the "nozzle cleaning" function working properly?			
Is the remote control working properly?			
Is the manual and automatic flushing function working properly?			
Is the "drying" function working properly (including levels adjustment)?			
Remark:			
Retailer:	Installation personnel:	Acceptance tester:	Date:

Warranty

To learn more about the warranty coverage for your product, including terms and conditions, please visit our website: <https://www.luoware.com>

LUOWARE[®]



WWW.LUOWARE.COM



INFO@LUOWARE.COM



SUPPORT@LUOWARE.COM



@LUOWARE.GLOBAL



@LUOWARE.GLOBAL



@LUOWARE