



# Quick Start Guide

## Guide de démarrage rapide

HDD AUDIO PLAYER  
HAP-Z1ES

## 1 Connect the unit to an amplifier Connectez l'appareil à un amplificateur

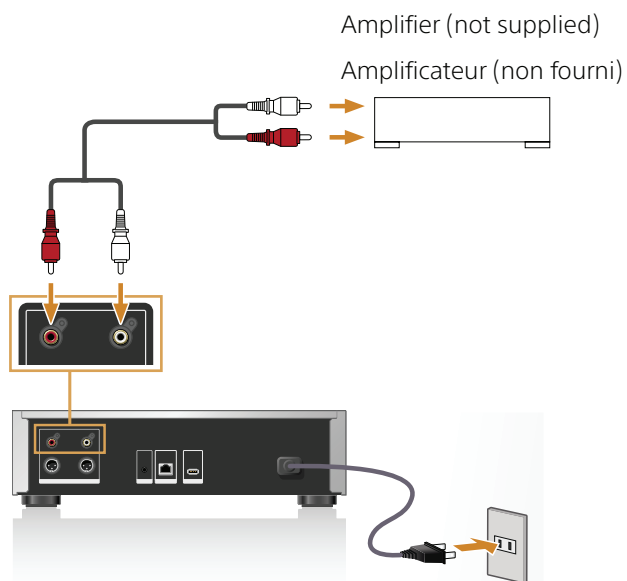

After connecting the unit and speakers, connect the AC power cord (mains lead) to a wall outlet (wall socket).

Après avoir connecté l'appareil et les enceintes, connectez le cordon d'alimentation secteur à une prise murale.

### Tip

You can also connect the unit to the amplifier using an XLR cable (not supplied).

### Conseil

Vous pouvez également connecter l'appareil à l'amplificateur à l'aide d'un câble XLR (non fourni).

## 2 Connect the unit and computer to the same network Connectez l'appareil et l'ordinateur au même réseau

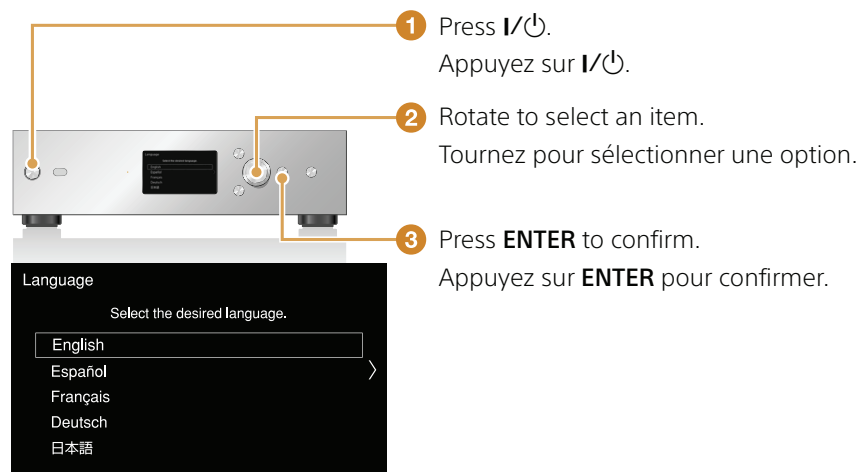

Turn on the power of the unit, and then set up the unit following the on-screen instructions.

You can connect the unit to the network using either a wireless or wired LAN connection.

**Mettez l'appareil sous tension, puis configurez-le en suivant les instructions à l'écran.**

Vous pouvez connecter l'appareil au réseau à l'aide d'une connexion sans fil ou d'une connexion LAN filaire.

### To transfer a large volume of content to the unit

Using a LAN cable allows you to transfer quicker. Connect a LAN cable first as shown in the illustration on the right, and then turn on the power of the unit.

### Pour transférer un volume important de contenu vers l'appareil

Utilisez un câble LAN pour procéder plus rapidement au transfert.

Connectez d'abord un câble LAN, comme illustré à droite, puis mettez l'appareil sous tension.

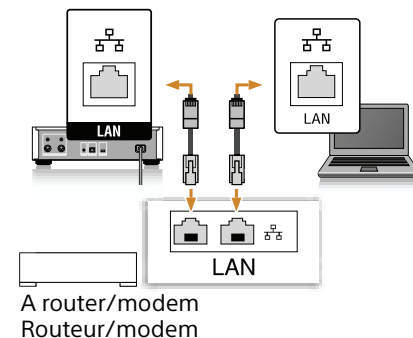

# 3 Transfer music files from your computer to the unit Transférez des fichiers audio depuis votre ordinateur vers l'appareil

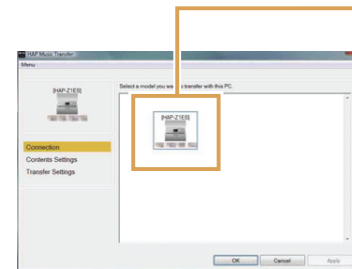
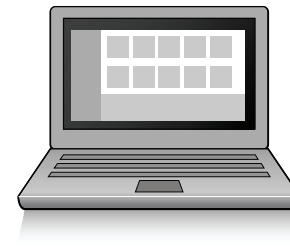
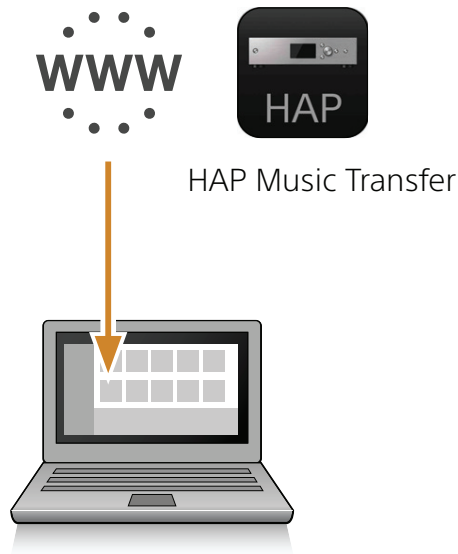

If the  icon is displayed, the unit and computer are successfully connected to the network.

Si l'icône  est affichée, l'appareil et l'ordinateur sont correctement connectés au réseau.

## 1 Install HAP Music Transfer on your computer.

HAP Music Transfer is software to transfer audio files from your computer to the unit.

## 1 Installez HAP Music Transfer sur votre ordinateur.

HAP Music Transfer est un logiciel de transfert de fichiers audio depuis votre ordinateur vers l'appareil.

## 2 Start up HAP Music Transfer, and then transfer music files to the unit.

Transferring many files to the unit or processing many files on the unit may take extra time to complete. During the data processing,  is displayed.

## 2 Démarrez HAP Music Transfer, puis transférez les fichiers audio vers l'appareil.

Le transfert de nombreux fichiers vers l'appareil ou le traitement de nombreux fichiers sur l'appareil peut nécessiter davantage de temps. Pendant le traitement des données,  s'affiche.

Visit the following website to download HAP Music Transfer: <http://esupport.sony.com/swu/8811>

Visitez le site Web suivant pour télécharger HAP Music Transfer : <http://esupport.sony.com/swu/8811>

# Playing back music Lecture de musique

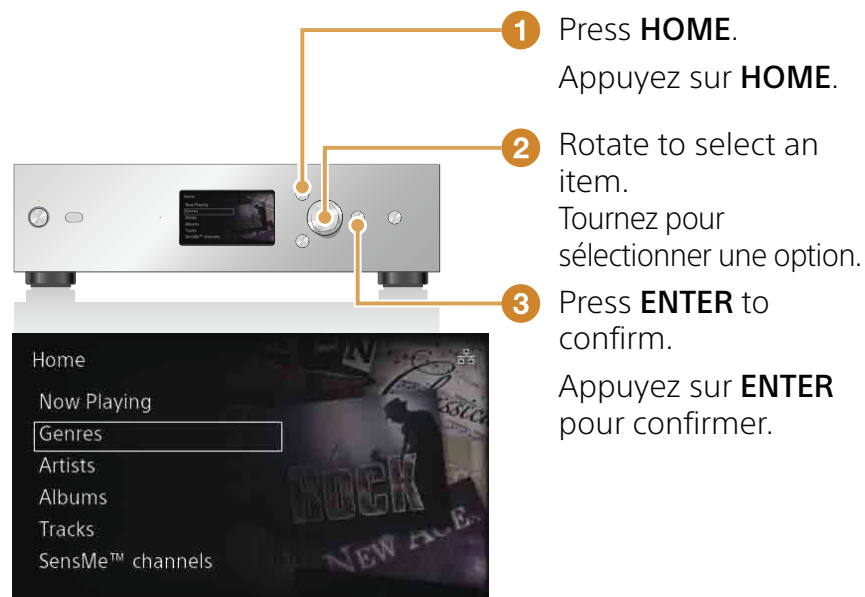

## Display the Home Menu, and then play back a music file.

The  icon is displayed while copying and transferring files. You can start to play back music from files transferred and registered on the unit.

## Affichez le menu Accueil, puis lisez un fichier audio.

L'icône  s'affiche lors de la copie et du transfert de fichiers. Vous pouvez lancer la lecture de musique de fichiers transférés et enregistrés sur l'appareil.

## To play back music with ease using your smart phone or tablet device

## Pour lire facilement de la musique avec votre téléphone intelligent ou votre tablette



Download "HDD Audio Remote" to your mobile device.

Téléchargez « HDD Audio Remote » sur votre périphérique mobile.

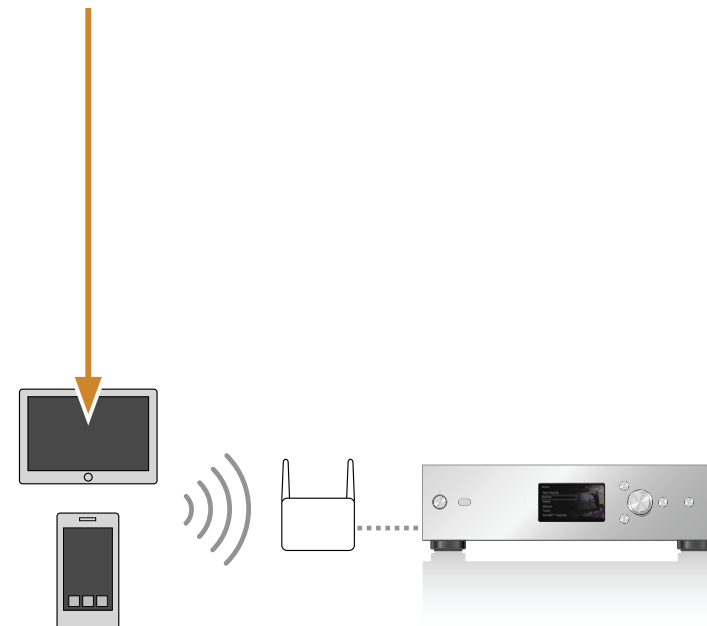

**Visit the website below for more information on the unit and how to get the most out of it:  
Visitez le site Web suivant pour obtenir plus d'informations sur l'appareil et savoir comment en profiter pleinement :**

<http://rd1.sony.net/help/ha/hapz1es/>

## Features Fonctions

---

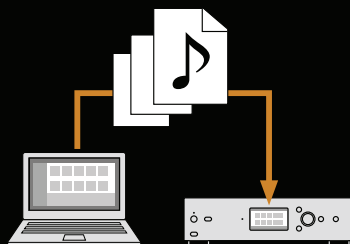

### Automatic transferring of music from your computer

Just complete steps 1 to 3 in this manual to transfer your music files over to the unit. That way, you can play them back even when not connected to the network.

### Transfert automatique de musique à partir de votre ordinateur

Il vous suffit d'exécuter les étapes 1 à 3 de ce manuel pour transférer vos fichiers audio sur l'appareil. Vous pourrez ainsi les lire même si vous n'êtes pas connecté au réseau.



### Playback of high-quality sound

High-resolution audio such as 192 kHz/24 bit and DSD can be played back. Also, MP3 and other compressed audio sources are played back in a way that re-creates high-range sound for a spacious feel.

### Lecture de son haute qualité

Les fichiers audio haute résolution ainsi que les fichiers de 192 kHz/24 bit et DSD peuvent être lus. De plus, les fichiers MP3 et autres sources audio compressées sont lus de façon à recréer des sons aigus pour une sensation d'espace.



### Easier operation with mobile devices

A special app is available for easier control of the unit. Just download "HDD Audio Remote" for the mobile device you use.

### Fonctionnement aisé avec les périphériques mobiles

Une application spéciale est proposée pour commander plus facilement l'appareil. Il vous suffit de télécharger « HDD Audio Remote » pour le périphérique mobile que vous utilisez.

Visit the website below for more information on how to use the unit:  
Visitez le site Web suivant pour obtenir plus d'informations sur  
l'utilisation de l'appareil :

<http://rd1.sony.net/help/ha/hapz1es/>



**SONY®**

# HDD AUDIO PLAYER

Reference Guide

US

Guide de référence

FR

HAP-Z1ES

## WARNING

**To reduce the risk of fire or electric shock, do not expose this apparatus to rain or moisture.**

The unit is not disconnected from the mains as long as it is connected to the AC outlet, even if the unit itself has been turned off.

To reduce the risk of fire, do not cover the top board of the appliance with newspapers, tablecloths, curtains, etc.  
Do not expose the appliance to naked flame sources (for example, lighted candles).

To reduce the risk of fire or electric shock, do not expose this appliance to dripping or splashing, and do not place objects filled with liquids, such as vases, on the appliance.

As the main plug is used to disconnect the unit from the mains, connect the unit to an easily accessible AC outlet. Should you notice an abnormality in the unit, disconnect the main plug from the AC outlet immediately.

Do not install the appliance in a confined space, such as a bookcase or built-in cabinet.

Do not expose batteries or appliances with battery-installed to excessive heat, such as sunshine and fire.

Indoor use only.

## For the customers in the U.S.A



This symbol is intended to alert the user to the presence of uninsulated “dangerous voltage” within the product’s enclosure that may be of sufficient magnitude to constitute a risk of electric shock to persons.



This symbol is intended to alert the user to the presence of important operating and maintenance (servicing) instructions in the literature accompanying the appliance.

## Owner’s Record

The model and serial numbers are located on the rear panel of the unit. Record the serial numbers in the space provided below. Refer to them whenever you call upon your Sony dealer regarding this product.

Model No. HAP-Z1ES

Serial No. \_\_\_\_\_

## Important Safety Instructions

- 1) Read these instructions.
- 2) Keep these instructions.
- 3) Heed all warnings.
- 4) Follow all instructions.
- 5) Do not use this apparatus near water.
- 6) Clean only with dry cloth.
- 7) Do not block any ventilation openings. Install in accordance with the manufacturer’s instructions.
- 8) Do not install near any heat sources such as radiators, heat registers, stoves, or other apparatus (including amplifiers) that produce heat.
- 9) Do not defeat the safety purpose of the polarized or grounding-type plug. A polarized plug has two blades with one wider than the other. A grounding type plug has two blades and a third grounding prong. The wide blade or the third prong are provided for your safety. If the provided plug does not fit into your outlet, consult an electrician for replacement of the obsolete outlet.



- 10) Protect the power cord from being walked on or pinched particularly at plugs, convenience receptacles, and the point where they exit from the apparatus.
- 11) Only use attachments/accessories specified by the manufacturer.
- 12) Use only with the cart, stand, tripod, bracket, or table specified by the manufacturer, or sold with the apparatus. When a cart is used, use caution when moving the cart/apparatus combination to avoid injury from tip-over.



- 13) Unplug this apparatus during lightning storms or when unused for long periods of time.
- 14) Refer all servicing to qualified service personnel. Servicing is required when the apparatus has been damaged in any way, such as power-supply cord or plug is damaged, liquid has been spilled or objects have fallen into the apparatus, the apparatus has been exposed to rain or moisture, does not operate normally, or has been dropped.

The following FCC statement applies only to the version of this model manufactured for sale in the U.S.A. Other versions may not comply with FCC technical regulations.

**NOTE:**

This equipment has been tested and found to comply with the limits for a Class B digital device, pursuant to Part 15 of the FCC Rules. These limits are designed to provide reasonable protection against harmful interference in a residential installation. This equipment generates, uses and can radiate radio frequency energy and, if not installed and used in accordance with the instructions, may cause harmful interference to radio communications. However, there is no guarantee that interference will not occur in a particular installation. If this equipment does cause harmful interference to radio or television reception, which can be determined by turning the equipment off and on, the user is encouraged to try to correct the interference by one or more of the following measures:

- Reorient or relocate the receiving antenna.
- Increase the separation between the equipment and receiver.

- Connect the equipment into an outlet on a circuit different from that to which the receiver is connected.
- Consult the dealer or an experienced radio/TV technician for help.

Properly shielded and grounded cables and connectors must be used for connection to host computers and/or peripherals in order to meet FCC emission limits.

### **CAUTION**

You are cautioned that any changes or modifications not expressly approved in this manual could void your authority to operate this equipment.

This equipment must not be co-located or operated in conjunction with any other antenna or transmitter.

This equipment complies with FCC radiation exposure limits set forth for an uncontrolled environment and meets the FCC radio frequency (RF) Exposure Guidelines in Supplement C to OET65. This equipment should be installed and operated keeping the radiator at least 20 cm or more away from person's body (excluding extremities: hands, wrists, feet and ankles).

### **For the customers in Canada**

Properly shielded and grounded cables and connectors must be used for connection to host computers and/or peripherals.

This device complies with Industry Canada licence-exempt RSS standard(s).

Operation is subject to the following two conditions:

(1) this device may not cause interference, and (2) this device must accept any interference, including interference that may cause undesired operation of the device.

This equipment complies with IC radiation exposure limits set forth for an uncontrolled environment and meets RSS-102 of the IC radio frequency (RF) Exposure rules. This equipment should be installed and operated keeping the radiator at least 20 cm or more away from person's body (excluding extremities: hands, wrists, feet and ankles).

## Copyrights



Gracenote®, Gracenote logo and logotype, and the "Powered by Gracenote" logo are either a registered trademark or a trademark of Gracenote, Inc. in the United States and/or other countries.

Wi-Fi®, Wi-Fi Protected Access® and Wi-Fi Alliance® are registered marks of the Wi-Fi Alliance.

Wi-Fi CERTIFIED™, WPA™, WPA2™ and Wi-Fi Protected Setup™ are marks of the Wi-Fi Alliance.

"ATRAC" and ATRAC Advanced Lossless are trademarks of Sony Corporation.

MPEG Layer-3 audio coding technology and patents licensed from Fraunhofer IIS and Thomson.

Windows Media is either a registered trademark or trademark of Microsoft Corporation in the United States and/or other countries.

This product is protected by certain intellectual property rights of Microsoft Corporation. Use or distribution of such technology outside of this product is prohibited without a license from Microsoft or an authorized Microsoft subsidiary.

Other trademarks and trade names are those of their respective owners.

### Gracenote® End User License Agreement

This application or device contains software from Gracenote, Inc. of Emeryville, California ("Gracenote"). The software from Gracenote (the "Gracenote Software") enables this application to perform disc and/or file identification and obtain music-related information, including name, artist,

track, and title information ("Gracenote Data") from online servers or embedded databases (collectively, "Gracenote Servers") and to perform other functions. You may use Gracenote Data only by means of the intended End-User functions of this application or device.

You agree that you will use Gracenote Data, the Gracenote Software, and Gracenote Servers for your own personal non-commercial use only. You agree not to assign, copy, transfer or transmit the Gracenote Software or any Gracenote Data to any third party. **YOU AGREE NOT TO USE OR EXPLOIT GRACENOTE DATA, THE GRACENOTE SOFTWARE, OR GRACENOTE SERVERS, EXCEPT AS EXPRESSLY PERMITTED HEREIN.**

You agree that your non-exclusive license to use the Gracenote Data, the Gracenote Software, and Gracenote Servers will terminate if you violate these restrictions. If your license terminates, you agree to cease any and all use of the Gracenote Data, the Gracenote Software, and Gracenote Servers. Gracenote reserves all rights in Gracenote Data, the Gracenote Software, and the Gracenote Servers, including all ownership rights. Under no circumstances will Gracenote become liable for any payment to you for any information that you provide. You agree that Gracenote, Inc. may enforce its rights under this Agreement against you directly in its own name.

The Gracenote service uses a unique identifier to track queries for statistical purposes. The purpose of a randomly assigned numeric identifier is to allow the Gracenote service to count queries without knowing anything about who you are. For more information, see the web page for the Gracenote [Privacy Policy](#) for the Gracenote service.

The Gracenote Software and each item of Gracenote Data are licensed to you "AS IS." Gracenote makes no representations or warranties, express or implied, regarding the accuracy of any Gracenote Data from in the Gracenote Servers. Gracenote reserves the right to delete data from the Gracenote Servers or to change data categories for any cause that Gracenote deems sufficient. No warranty is made that the Gracenote Software or Gracenote Servers are error-free or that functioning of Gracenote Software or Gracenote Servers will be uninterrupted. Gracenote is not obligated to provide you with new enhanced or additional data types or categories that Gracenote may provide in the future and is free to discontinue its services at any time.

GRACENOTE DISCLAIMS ALL WARRANTIES EXPRESS OR IMPLIED, INCLUDING, BUT NOT LIMITED TO, IMPLIED WARRANTIES OF MERCHANTABILITY, FITNESS FOR A PARTICULAR PURPOSE, TITLE, AND NON-INFRINGEMENT. GRACENOTE DOES NOT WARRANT THE RESULTS THAT WILL BE OBTAINED BY YOUR USE OF THE GRACENOTE SOFTWARE OR ANY GRACENOTE SERVER. IN NO CASE WILL GRACENOTE BE LIABLE FOR ANY CONSEQUENTIAL OR INCIDENTAL DAMAGES OR FOR ANY LOST PROFITS OR LOST REVENUES.

© Gracenote, Inc. 2009

---

## Precautions

### On safety

Should any solid object or liquid fall into the cabinet, unplug the unit and have it checked by qualified personnel before operating it any further.

### On power sources

- Before operating the unit, check that the operating voltage is identical with your local power supply.  
The operating voltage is indicated on the nameplate on the back of the unit.
- The unit is not disconnected from the AC power source (mains) as long as it is connected to the wall outlet, even if the unit itself has been turned off.
- If you are not going to use the unit for a long time, be sure to disconnect the unit from the wall outlet. To disconnect the AC power cord (mains lead), grasp the plug itself; never pull the cord.
- The AC power cord (mains lead) must be changed only at a qualified service shop.

### On placement

- Place the unit in a location with adequate ventilation to prevent heat buildup and prolong the life of the unit.
- Do not place the unit near heat sources, or in a place subject to direct sunlight, excessive dust, or mechanical shock.
- Do not place anything on top of the cabinet that might cause malfunctions.
- Use caution when placing the unit on surfaces that have been specially treated (with wax, oil, polish, etc.) as staining or discoloration of the surface may result.
- Do not place the unit on a device that may emit heat, such as an amplifier.

### On operation

Before connecting other equipment, be sure to turn off and unplug the unit.

### On cleaning

Clean the cabinet, panel, and controls with a soft cloth slightly moistened with a mild detergent solution. Do not use any type of abrasive pad, scouring powder, or solvent, such as alcohol or benzene.

If you have any questions or problems concerning your unit, please consult your nearest Sony dealer.

The HDD AUDIO PLAYER has a built-in antenna for wireless LAN. Make sure to set up the HDD AUDIO PLAYER far from speakers or other devices, so that the built-in antenna is not affected by those devices.

### Notes on the internal hard disk drive

The hard disk drive allows you to store large volumes of data or data with long recording times and play back data from your desired part with ease. Keep in mind the following cautions.

- Do not apply physical shock or vibration to the unit. Do not place the unit in an unstable place.
- Do not impose a sudden temperature change (10 °C or more /hour) to the unit. Doing so may cause moisture condensation.
- Disconnect the AC power plug from the wall outlet (wall socket) before moving the unit.
- Make sure of the following before unplugging the AC power plug.
  - 1 minute has passed since you turned off the unit.
  - The LCD screen is turned off.
- Do not replace or add hard disk drives on the unit. Doing so may cause a malfunction.
- Your data cannot be restored if the hard disk drive is broken from any cause.
- Due to the nature of the hard disk drive, we do not recommend you store data on the hard disk drive for a long period.

## About repairing the internal hard disk drive

- When conducting repairs or diagnostic checks, it may be necessary to access data stored on the hard disk drive for repair and testing purposes to verify how a problem occurred and to determine possible remedies. However, titles of files or any other information will not be duplicated or saved by Sony.
- If replacement or initialization is required, the hard disk drive will be formatted at our discretion. Be aware that all of the existing data on the hard disk drive will be erased (data covered by copyright laws).
- In regards to storage and disposal of the replaced hard disk drive, Sony will employ strict controls within reasonable limits, and assume full responsibility to ensure that third parties, including business partners to whom the storage and disposal work is delegated, do not mishandle the data on the hard disk drive.

## Disclaimer on compensation for lost recordings

Sony is not liable and will not compensate for any lost recordings or related losses, including when recordings are not made on the unit or external media/recording device due to reasons including unit failure, or when the data of a recording is lost or damaged as a result of the unit or external media/recording device failure or repair undertaken to the unit. Sony will not restore, recover, or replicate the data under any circumstances. We recommend you appropriately back up data stored on the hard disk drive of the unit, using your computer. If you do not have the original data on your computer anymore, we recommend you copy the data on the hard disk drive of the unit to your computer and back that up. Make sure you back up your data as stated above before sending the unit for repair. For details on how to copy data on the hard disk drive of the unit to your computer, refer to the Help Guide.

## Specifications

### Playback Specifications

Frequency response  
2 Hz - 80 kHz (–3 dB)  
Dynamic range  
105 dB or higher  
THD  
0.0015% or less

### Network section

Wired LAN  
1000BASE-T/100BASE-TX/10BASE-T  
Wireless LAN  
Compatible standards  
IEEE 802.11 b/g/n  
Frequency band/channel  
2.4 GHz band: channels 1-11

### HDD section

Capacity  
1 TB\*  
\* Some portions of the capacity are used for data management. Therefore, the capacity a user can use is less than 1 TB.  
Supported playback format  
DSD (DSF, DSDIFF), LPCM (WAV, AIFF), FLAC, ALAC, ATRAC Advanced Lossless, ATRAC, MP3, AAC, WMA (2 channels)

### Jack section

Output jacks  
LINE OUT UNBALANCED  
Output level: 2.0 Vrms (50 kilohms), Impedance: 10 kilohms or higher  
LINE OUT BALANCED  
Output level: 2.0 Vrms (50 kilohms), Impedance: 600 ohms or higher  
EXT port  
Type A USB, Hi-Speed USB, for connecting an external hard disk drive

continued

IR REMOTE OUT jack  
for connecting the monaural mini-plug cable (supplied) or IR blaster  
(supplied)

## **General and others**

Power requirements

AC 120 V 60 Hz

Power consumption

On: 35 W

During standby mode (when [Network Standby] is set to [Off]): 0.3 W

During standby mode (when [Network Standby] is set to [On] and a  
wired LAN is used): 2.6 W

During standby mode (when [Network Standby] is set to [On] and a  
wireless LAN is used): 2.8 W

Dimensions (approx.) (w/h/d)

430 mm × 130 mm × 390 mm (17 inch × 5 1/8 inch × 15 3/8 inch)

including projecting parts and controls

Mass (approx.)

14.5 kg (32 lb 0 oz)

Supplied accessories

AC power cord (1)

Remote control (RM-ANU183) (1)

R03 (size-AAA) batteries (2)

LAN cable (1)

Monaural mini-plug cable (1)

Audio cord (1)

IR blaster (1)

Quick Start Guide (1)

Reference Guide (this manual) (1)

Design and specifications are subject to change without notice.

<http://www.sony.net/>

©2013 Sony Corporation Printed in Malaysia



\* 4 4 7 2 8 5 1 1 1 \* (1)

4-472-851-11(1)



Thank you for purchasing this Sony product. Proper registration will enable us to send you periodic mailings about new products and other important announcements. Registering your product will also allow us to contact you in the unlikely event that it will need adjustment or modification. Please take the time to register your new product at our website:

**<http://www.sony.com/productregistration>**

You will find the product serial number on the main unit and the carton box.

If you have any operational questions regarding your new purchase, please contact your retailer. For the location of a Sony dealer in your area, or for any other questions, please call 1-800-222-SONY(7669).

Thank you.





# Garantie de trois ans protégeant les consommateurs

**SONY®**

Sony du Canada Limitée (ci-après nommé Sony), sous réserve des modalités et conditions énoncées dans les présentes, garantit le présent produit d'être sans défaut de fabrication ou de matériel durant la période de garantie spécifiée ci-dessous. Si un défaut de fabrication ou de matériel survient durant la période de garantie, Sony procédera, sans frais quant aux pièces ou à la main-d'œuvre, à la réparation du produit. Relativement au service de réparation, Sony utilisera des pièces neuves ou remises à neuf seulement.

## La durée de validité de la garantie est la suivante :

1. Main-d'œuvre : TROIS ans à compter de la date originale d'achat au détail.
2. Pièces : TROIS ans à compter de la date originale d'achat au détail.

## Conditions

### Réparations non autorisées, abus, etc. :

Sony n'est aucunement responsable de la réparation du produit au titre de la présente garantie limitée si le produit a été antérieurement transformé, modifié, réparé; si le produit a fait l'objet d'entretien par quiconque sauf un centre de réparation dûment autorisé par Sony pour dispenser de tel entretien; ainsi que si le numéro de série du produit a été modifié ou enlevé. En outre, la présente garantie n'est pas valide si, en tout temps avant ou après son achat original au détail, le produit a été accidenté; a fait l'objet d'un mauvais usage ou d'un abus; a été utilisé en contravention des instructions contenues dans le guide d'utilisation; a servi à des fins commerciales; ou a été l'objet d'un contrat de location. Si le produit sert à des fins commerciales ou locatives, la garantie commerciale courante de Sony s'appliquera. L'opinion de Sony en cette matière est définitive.

### Livraison du produit :

Le produit doit être expédié, frais de transport payés à l'avance, ou livré à l'un des centres de réparation autorisés de Sony au Canada, soit dans son emballage d'origine, soit dans un emballage comparable offrant un degré de protection comparable. Le produit doit être accompagné d'instructions indiquant l'endroit au Canada où le produit doit être retourné. Le produit réparé sera retourné au client, frais de transport payés à l'avance. Tous les accessoires qui sont inclus avec le produit doivent être énumérés individuellement sur le bon d'accompagnement rattaché au document d'expédition. Sony n'est aucunement responsable de la perte de ces accessoires ou de dommages qu'ils pourraient subir s'ils ne sont pas énumérés de la sorte. Tout accessoire défectueux devrait être expédié à Sony pour réparation en tant qu'élément distinct.

### Preuve de la date d'achat :

La présente garantie limitée s'applique au produit à compter de la date originale d'achat au détail. Par conséquent, le propriétaire doit présenter une preuve de date originale d'achat au détail.

### Produits visés par la présente garantie :

La présente garantie limitée s'applique aux produits ESPIRIT de Sony.

La présente garantie limitée peut s'appliquer à d'autres produits Sony lorsque celle-ci est incluse dans l'emballage original du produit.

La présente garantie limitée exclut les cabinets, accessoires ou piles cassés ou endommagés, les antennes et stylets exposés, ou la détérioration de pièces découlant de leur usure normale. La présente garantie limitée exclut l'entretien périodique des produits, tels que le nettoyage, la lubrification ou les vérifications.

### La présente garantie n'est valide qu'au Canada.

SAUF DANS LA MESURE OÙ LA LOI APPLICABLE L'INTERDIT, TOUTES LES AUTRES GARANTIES ET CONDITIONS, EXPRESSES OU IMPLICITES, RELEVANT OU NON D'UNE LOI, D'UN ACTE LÉGISLATIF, D'HABITUDES COMMERCIALES ÉTABLIES OU D'USAGES DU COMMERCE, Y COMPRIS, NOTAMMENT, TOUTE GARANTIE IMPLICITE DE QUALITÉ MARCHANDE OU DE L'ADAPTABILITÉ À UNE FIN PARTICULIÈRE, SONT DÉSAVOUÉES. SONY NE SAURAIT EN AUCUN CAS ÊTRE RESPONSABLE D'UN MONTANT SUPÉRIEUR AU PRIX RÉEL D'ACHAT DU PRODUIT; ET SONY NE SAURAIT EN AUCUN CAS ÊTRE RESPONSABLE DE DOMMAGES SPÉCIAUX, ACCESSOIRES OU CONSÉCUTIFS SUBIS RELATIVEMENT AU PRODUIT. SONY N'ASSUME NI N'AUTORISE AUCUN REPRÉSENTANT OU QUICONQUE À ASSUMER EN SON NOM UNE OBLIGATION OU RESPONSABILITÉ AUTRE QUE CELLES QUI SONT EXPRESSÉMENT DÉCRITES AUX PRÉSENTES. L'EXCLUSION DE GARANTIES ET CONDITIONS IMPLICITES N'EST PAS AUTORISÉE DANS CERTAINS TERRITOIRES.

### Enregistrement du produit:

Merci d'avoir choisi un produit Sony. Chez Sony, nous nous efforçons de créer des produits de la plus haute qualité afin de renforcer votre expérience et votre satisfaction. Afin d'assurer le meilleur soutien qui soit à votre produit, nous vous demandons de remplir une fiche d'enregistrement de produit sur le site [www.SonyStyle.ca/registration](http://www.SonyStyle.ca/registration) dans les quatre-vingt-dix (90) jours suivant la date d'achat.

Pour obtenir de l'aide concernant le service ou obtenir des renseignements sur le produit ou concernant l'enregistrement du produit, veuillez appeler le 1-877-899-7669.

Pour obtenir des renseignements concernant la garantie prolongée Sony Care, veuillez appeler le 1-800-773-9667.

**Pour le support technique et les mises à jour en ligne en tout temps, vous pouvez visiter le [www.fr.sony.ca/sonyca/view/french/support\\_electronics.shtml](http://www.fr.sony.ca/sonyca/view/french/support_electronics.shtml), ou appeler le Centre Sony de communication des renseignements aux clients au 1-877-899-7669.**

# Consumer 3 Year Warranty

**SONY®**

Sony of Canada Ltd. (hereinafter referred to as "Sony") hereby warrants, subject to the terms and conditions herein set forth, this product against defect in material and workmanship during the specified warranty period. In the event of a defect of material or workmanship during the specified warranty period, Sony will repair the same, effecting all necessary parts replacements with either new or refurbished parts, without charge for either parts or labour.

## **The warranty period is as follows:**

1. Labour: THREE years from the date of original purchase at retail.
2. Parts: THREE years from the date of original purchase at retail.

## **Conditions**

### **Unauthorized Repair, Abuse, Etc.:**

The unit must not have been previously altered, modified, repaired or serviced by anyone other than the service facilities authorized by Sony to render such services. The serial number on the unit must not have been altered or removed. The unit must not have been subject to accident, misuse, abuse or operated contrary to the instructions contained in the Owner's Manual, or used for commercial purposes, or used as a rental unit at any time prior to or after original purchase at retail. Should this unit be used for commercial purposes, or rental, Sony's standard commercial warranty will apply. The opinion of Sony with respect to this matter shall be final.

### **Proper Delivery:**

The unit must be shipped, freight prepaid, or delivered to one of the nearest Sony service facilities in Canada in either its original package or similar package affording an equal degree of protection, and with instructions indicating a location within Canada to which the unit must be returned. The repaired unit will be returned to customer freight prepaid. All accessories that are enclosed with the unit must be listed individually on the packing slip for the shipping documentation. Sony shall have no liability whatsoever for loss or damage to such accessories if they are not listed. Defective accessories should be returned to Sony as a separate repair item.

### **Proof of Date Purchase:**

This limited warranty applies to the product from the original date of purchase at retail. Therefore, the owner must furnish proof of original purchase at retail.

### **Subject Products:**

This limited warranty is applicable to Sony's Espirit products.

This limited warranty may be applicable to other Sony products, where the limited warranty is enclosed in the product's original packaging.

This limited warranty does not extend to broken or damaged cabinets, accessories, batteries, exposed antennas and styluses, or to parts wearing out due to normal wear and tear. This limited warranty does not cover regular product maintenance such as cleaning, lubrication or check-ups.

**This warranty is valid only in Canada.**

EXCEPT TO THE EXTENT PROHIBITED BY APPLICABLE LAW, ALL OTHER WARRANTIES AND CONDITIONS, EXPRESS OR IMPLIED, AND WHETHER ARISING BY LAW, BY STATUTE, BY COURSE OF DEALING OR USAGE OF TRADE, INCLUDING WITHOUT LIMITATION IMPLIED WARRANTIES OF MERCHANTABILITY, MERCHANTABLE QUALITY AND FITNESS FOR A PARTICULAR PURPOSE ARE DISCLAIMED. UNDER NO CIRCUMSTANCES SHALL SONY BE LIABLE FOR AN AMOUNT GREATER THAN THE ACTUAL PURCHASE PRICE OF THE UNIT OR FOR ANY SPECIAL, INCIDENTAL OR CONSEQUENTIAL DAMAGES SUSTAINED IN CONNECTION WITH SAID UNIT AND SONY NEITHER ASSUMES NOR AUTHORIZES ANY REPRESENTATIVE OR OTHER PERSON TO ASSUME FOR IT ANY OBLIGATION OR LIABILITY OTHER THAN SUCH AS IS EXPRESSLY SET FORTH HEREIN. SOME JURISDICTIONS DO NOT ALLOW THE EXCLUSION OF IMPLIED WARRANTIES AND CONDITIONS.

### **Product Registration:**

Thank you for choosing a Sony product. At Sony, we strive to create products of the highest quality to enhance your experience and enjoyment. To provide the best support for your product, we request that you complete a product registration form at [www.SonyStyle.ca/registration](http://www.SonyStyle.ca/registration) within ninety (90) days of purchase.

For service assistance, product information, or product registration please call: 1-877-899-7669.

For information about a Sony Care Extended Warranty, please call 1-800-773-9667.

**For online product support and updates at any time, please visit:** [www.sony.ca/sonyca/view/english/support\\_electronics.shtml](http://www.sony.ca/sonyca/view/english/support_electronics.shtml), **or call the Sony Customer Information Centre at 1-877-899-7669.**



**SONY®**General Stereo/Hifi Components/Tape Decks  
CD Players/Mini Disc Players/Audio Systems**Hifi Audio**

ES Products

# LIMITED WARRANTY (U.S. Only)

Sony Electronics Inc. ("Sony") warrants this product against defects in material or workmanship for the time periods and as set forth below when purchased directly from Sony or a Sony Retailer. Pursuant to this Limited Warranty, Sony will, at its option, (i) repair the product using new or refurbished parts or (ii) replace the product with a new or refurbished product. For purposes of this Limited Warranty, "refurbished" means a product or part that has been returned to its original specifications. **In the event of a defect, these are your exclusive remedies.**

**Labor:** For a period of five (5) years from the original date of purchase of the product ("Labor Warranty"), Sony will, at its option, repair or replace with new or refurbished product, product determined to be defective. If Sony elects to replace the product after this Labor Warranty has expired but while the Parts Warranty below is still in effect, it will do so for the applicable labor charge.

**Parts:** For a period of five (5) years from the original date of purchase of product ("Parts Warranty"), Sony will supply new or refurbished replacement parts in exchange for parts determined to be defective.

This Limited Warranty covers only the hardware components packaged with the Product. It does not cover technical assistance for hardware or software usage and it does not cover any software products whether or not contained in the Product; any such software is provided "AS IS" unless expressly provided for in any enclosed software Limited Warranty. Please refer to the End User License Agreements included with the Product for your rights and obligations with respect to the software.

**Instructions:** To obtain warranty service, you must deliver the product, freight prepaid, in either its original packaging or packaging affording an equal degree of protection to the Sony authorized service facility specified. **It is your responsibility to backup any data, software or other materials you may have stored or preserved on your unit. It is likely that such data, software, or other materials will be lost or reformatted during service and Sony will not be responsible for any such damage or loss.** A dated purchase receipt from Sony or a Sony Retailer is required. For specific instructions on how to obtain warranty service for your product,

Visit Sony's Web Site:

[www.sony.com/service](http://www.sony.com/service)Or call the **Sony Customer Information Service Center**  
**1-800-222-SONY (7669)**

For an accessory or part not available from your authorized dealer, call:

**1-800-488-SONY (7669)**

**Repair / Replacement Warranty:** This Limited Warranty shall apply to any repair, replacement part or replacement product for the remainder of the original Limited Warranty period or for ninety (90) days, whichever is longer. Any parts or product replaced under this Limited Warranty will become the property of Sony.

This Limited Warranty only covers product issues caused by defects in material or workmanship during ordinary consumer use; it does not cover product issues caused by any other reason, including but not limited to product issues due to commercial use, acts of God, misuse, limitations of technology, or modification of or to any part of the Sony product or product purchased from other than Sony or a Sony Retailer. To determine if a retailer is part of the Sony Retailer Network, please contact Sony's Customer Service Call Center or go to [www.sony.com/support](http://www.sony.com/support). This Limited Warranty does not cover Sony products sold AS IS or WITH ALL FAULTS or consumables (such as fuses or batteries). This Limited Warranty is invalid if the factory-applied serial number has been altered or removed from the product. This Limited Warranty is valid only in the United States.

**LIMITATION ON DAMAGES:** SONY SHALL NOT BE LIABLE FOR ANY INCIDENTAL OR CONSEQUENTIAL DAMAGES FOR BREACH OF ANY EXPRESS OR IMPLIED WARRANTY ON THIS PRODUCT.

**DURATION OF IMPLIED WARRANTIES:** EXCEPT TO THE EXTENT PROHIBITED BY APPLICABLE LAW, ANY IMPLIED WARRANTY OF MERCHANTABILITY OR FITNESS FOR A PARTICULAR PURPOSE ON THIS PRODUCT IS LIMITED IN DURATION TO THE DURATION OF THIS WARRANTY.

Some states do not allow the exclusion or limitation of incidental or consequential damages, or allow limitations on how long an implied warranty lasts, so the above limitations or exclusions may not apply to you. This Limited Warranty gives you specific legal rights and you may have other rights which vary from state to state.