

Assembly Instructions

46-inch Deck Mulch Kit

Before beginning installation, remove all parts from the carton to make sure everything is present. Carton contents are listed below. Part numbers are shown in parentheses.

One Mulch Plug (731-1636)

One 1/4" Machine Screw (710-0578)

One 1/4" Lock Nut (712-0291)

One 1/4" Plastic Wing Nut (712-3087)

NOTE: References to LEFT and RIGHT indicate the left and right sides of the tractor when facing forward in the operator's position. Reference to the FRONT indicates the grille end; to the REAR the drawbar end.



WARNING: Before beginning installation, place the tractor on a firm and level surface. Place the PTO in the disengaged (OFF) position, stop the tractor engine and set the parking brake.

1. Place the deck lift lever in the highest position on the right fender.
2. Insert the machine screw up through the mulch plug and fasten it in place with the lock nut. See Figure 1.
3. Pivot the discharge chute upward as shown in Figure 1 and carefully insert the mulch plug into the discharge chute opening.

NOTE: It is NOT necessary to remove the discharge chute to operate the mower with the mulch kit installed. It is also unnecessary to change the mower blades should you choose to operate the mower without the mulch plug installed.

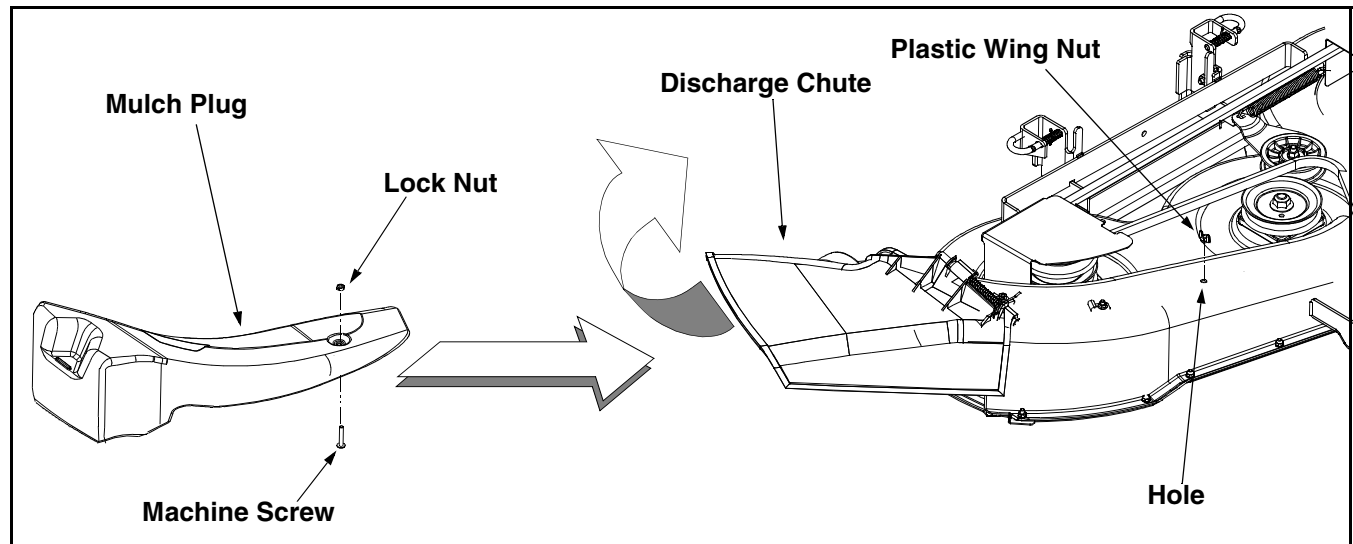

Figure 1

4. Make sure the mulch plug is firmly attached to the cutting deck by aligning the machine screw in the mulch plug with the hole in the deck surface and fastening with the plastic wing nut. Refer to Figure 1.

MTD PRODUCTS INC. P.O. BOX 368022 CLEVELAND, OHIO 44136-9722