



Green Lion

**3 IN 1 EXPERT
HAIR TRIMMER & SHAVER**

SKU: GNTM50TMXPTGY

Model No: GL-TM50

Table of Contents

Instruction for Use	2
Shaving Function	2
Trimming	2
Shaving Care	3
Body Trimming	3
Quick View	4
Battery Removing	6
Environmental Notes	6
How to Use Electric Shaver	6
Safety Instructions	7
Specification	8
Charging Guide	8
Digital Power Display Light	9
Accessory	9
Disposal	11
Warranty	11
Contact Us	11

Instructions for use

Press the switch button lightly to turn on the device.

Before shaving, be sure to use a comb to smooth your beard.

Shaving Function

Set the reserved length of the adjustable guide comb. If you are shaving for the first time, please set the maximum reserved length (5mm) first.

Press the switch button lightly to turn on the device.

Place the front of the guide comb flat on the facial skin.

Slowly slide over the beard. If necessary, slide back and forth from different directions.

If there is stubble accumulation on the trimming guide during the trimming process, please shut down, unplug the comb, and brush off any stubble.

If any length of beard or stubble needs to be trimmed to achieve a clean appearance, please follow the steps below for school uniforms, and do not install a guide comb on the blade.

Place the razor blade flat on the facial skin and slowly slide it along the direction of hair growth.

When shaving under the chin, it is necessary to shave upwards (Figure A).

Trimming

Hold this product with the back of the blade facing towards you, without the need to install a guide comb on the blade. First, gently place the blade close to the skin, then move it towards the edge of the beard line to achieve the desired position in the facial area.

Trim according to the desired shape.

Shaving Care

If using shaving gel, please follow the instructions for dry shaving.

Attention: After using shaving gel, please rinse the blade with warm water to remove any excess gel and debris.

Body Trimming

Parts

Body hair trimming blade

Body hair trimming: trimming of reserved length

Install body hair trimming blade accessories.

The body hair can be trimmed into three different lengths (6 ,3, and 9mm). Trim the desired length by sliding the guide comb into one of the three slots on the side of the blade (Figure E).

Body hair trimming: shaving

Remove the guide comb from the body hair clipper head and carefully examine the area of the body hair that will be shaved off.

Use the other hand to tighten the skin and make the hair stand upright.

Gently approach the skin and shave against the direction of hair growth.

After each use

First, clean the broken hair on the blade and accessory heads.

Separate the blade from the container host, rinse the blade and accessories with warm water, and wipe dry.

Quick View





1. Complete machine
2. Hair trimming head
3. Adjustable limit comb
4. Shaving and trimming head guide comb
5. Digital power display
6. On/Off button
7. Type-c USB charging cable

Battery Removing

We strongly recommend that professional personnel disassemble the rechargeable battery. The body or blades of the conditioner may have sharp edges, and improper handling can cause injury. Rechargeable batteries must be removed from the host before being discarded. To ensure complete discharge of this product, please let it run until it automatically stops.

Remove all accessories.

Tear off the screw under the bottom sticker knob and pry open the bottom cover. Then cut off the connecting pieces at both ends of the battery to remove it.

- Used batteries must be removed from this product and disposed of at the official designated recycling/collection point. After disassembling this product, do not attempt to turn it on again

Environmental Notes

To avoid environmental and health issues caused by harmful substances in electrical and electronic products, electronic products and appliances marked with this symbol must not be discarded without classification. They can, however, be recycled, reused.

How to Use Electric Shaver

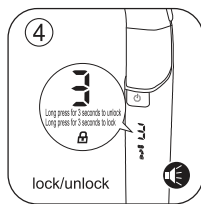
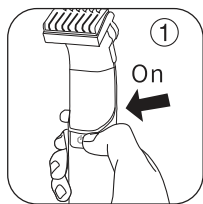

1. Start the switch button, and the display screen will light up synchronously, indicating that the product has been turned on. (Figure 1)
2. Let the electric shaver blade move against the direction of beard growth on the skin and make a straight and circular movement. (Figure 2)
3. The hair on the neck can also be shaved off. (Figure 3)
4. The long ammonium switch button lasts for 3 seconds, and the LED display screen of the electric shaver indicates that the safety lock is locked. Press and hold the button for 3 seconds to exit the travel lock status. (Figure 4)
5. Place the shaver body under a faucet for rinsing (It is recommended to use warm water for rinsing).

Safety Instructions

The product can be used by children aged 8 and above. Individuals with decreased physical, sensory, or psychological abilities, or lack of experience and knowledge should use it under supervision/guidance and with an understanding of the hazards contained in the product. Children are not allowed to use the product for play. The cleaning and user maintenance of the product should not be completed by children, except for children over 8 years old or children under adult supervision. Please keep the product and power cord out of reach of children under 8 years old.

- Do not use this product when the power cord is damaged.
- The battery of the product cannot be replaced.
- If the product is damaged or malfunctions, please stop using it immediately.
- Do not use accessories that are not standard with the product.
- Please always ensure that this product is under supervision, except during the charging process.

- Keep the power plug and power cord away from hot surfaces.
- Do not use wet hands to plug or unplug.
- Do not twist or twist the power cord, or wrap it around the product.
- The product is not suitable for commercial or beauty salon use.

Specification

Model No.	GL-TM50
Material	ABS+Stainless Steel
Blade	Stainless Steel
Motor	DC Brushed Motor
Power	5W
RPM Range	6300 RPM
Battery	600mAh
Charging Port	Type-C
Charging Time	1.5 Hrs
Working Time	1.5 Hrs
Waterproof	IPX6
Product Weight	121g
Product Dimensions	178*37.5*38.5 mm
Limit Comb	1-10 mm Adjustable

Charging Guide

Recommend fully charging the product before its initial use.

Ensure the product is powered off.

Connect the product to a USB power cable. Attach the other end of the USB cable to the USB port, and plug it into the main power source.

Digital Power Display Light



When charging, the display shows an increase from 0 % to 100 % . When the battery level is below 10 % , the display will flash 10 % to indicate charging. The charging is complete when the display shows 100 % . The display remains on for a long time.

Travel Lock Function - Press and hold the switch for three seconds to activate the lock. The lock light flashes and lights up. Long press for three seconds to turn off the lock light and power on.

Water Wash Reminder - The water wash reminder light will illuminate after 10 minutes of cumulative use and will turn off when the device is powered off.

Razors should not be overcharged. However, if not used for a long time (2-3 months), please unplug the power plug from the power supply.

To extend the battery life, fully discharge the battery every 6 months and then charge it for at least 2 hours.

The battery life after full charging can reach up to 100 minutes.

Accessory

Installation and Disassembly of Accessories (Figure B)

Before installing or disassembling accessories, ensure that the product is turned off.

Disassembly: Grip the blade tightly and lift it up.

Installation: Attach the required accessories onto the product and press down to lock them into place.

Installation and Disassembly of Fixed Guide Comb (Figure C)

Mount:

Hook the front part of the guide comb onto the blade.

Press down on the back of the guide comb until it clicks into place.

Detachment: Lift the tab on the back of the guide comb upwards until it disengages from the blade.

Installation and Disassembly of Adjustable Guide Comb (Figure D)

Mount:

Insert the adjustable guide comb onto the blade (as shown in the figure). Then press down on the tail of the guide comb to ensure that the three buckles on the guide comb are in place with the groove on the back of the blade (marked by 4).



Disposal

This product must not be disposed of as unsorted household waste. It is important to separate such waste for proper treatment and recycling, in compliance with local waste management regulations.

Warranty

Products that you buy directly from our **Green Lion** website or shop come with a 24-month warranty.

When you buy **Green Lion** products from any of our approved sellers, you only get a 12-month warranty. If you want to extend this warranty, go to our website at <https://www.greenlion.net/warranty> and fill out the form with your information. Don't forget to upload a picture of the product too. After we've checked and accepted your request, we'll send you an email to confirm that your product's warranty has been extended.

For more info, please check:
<https://www.greenlion.net/warranty>

Contact Us

If you have any questions about this Privacy Policy, please contact us at:

Website: <https://www.greenlion.net/>

Sales: sales@greenlion.net

Service Support: Support@greenlion.net

Telegram: [@greenlion_global](https://www.instagram.com/greenlion_global)

Instagram: [@greenlion_global](https://www.instagram.com/greenlion_global)