

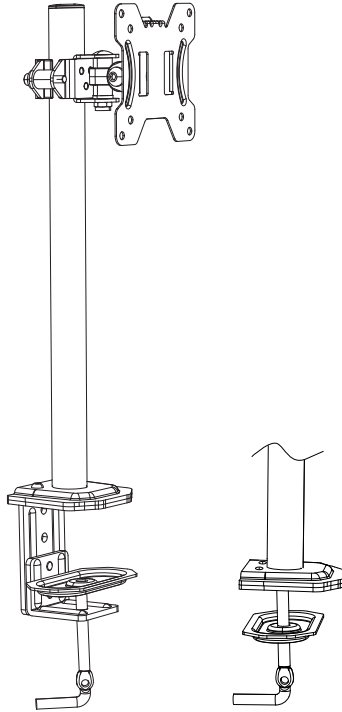

Monitor Desk Mount Instruction Manual

V6.0 (A)



Model: HNCM12

Thank you for choosing this HUANUO product! At HUANUO we strive to provide you with the best quality products and services in the industry. Should you have any issues, please don't hesitate to contact us at

Technical Support:

1-800-556-0533 Mon-Fri 8am - 8pm (CST)

Other Info:

support@huanuoav.com (US/CA)

IMPORTANT SAFETY INFORMATION

Please carefully read all instructions before attempting installation. If you do not understand the instructions or have any concerns or questions, please contact our Technical Support line at 1-800-556-0533 or customer service at support@huanuoav.com.

CAUTION: Avoid potential personal injuries and property damage!

- Do not use this product for any purpose that is not explicitly specified in this manual. Do not exceed weight capacity. We are not liable for damage or injury caused by improper mounting, incorrect assembly or inappropriate use.
- The desk must be capable of supporting five times the weight of the monitor and mount combined.

Check the VESA Pattern of Your Monitor before the Installation

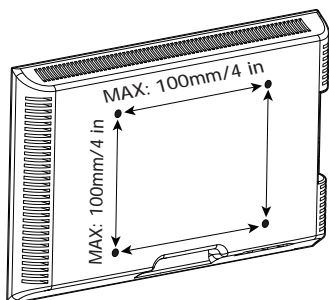

75 mm \approx 3 in
100 mm \approx 4 in

Minimum VESA pattern:
75mm/3 in (W)x75mm/3 in (H)

Note:

For the thin PB desks or glass table tops, you will need our Monitor Mount Reinforcement Plate HNDA1(ASIN: B08CK24TCX), which provides a better way to install your monitor mount on a desktop through C clamp installation.

If your monitor does not have any mounting hole, you will need our Universal VESA Bracket Kit HNMUA4(ASIN: B08BCWY5Q3)(Fits most monitors within the size of 32 in)

If your monitor VESA is greater than 100x100 mm/4x4 in or less than VESA 75x75 mm/3x3 in, this mount is NOT compatible.

If this mount is NOT compatible, please contact customer service at support@huanuoav.com to find a compatible mount.

Tools Needed (Not Included)

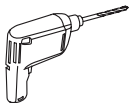

Phillips Screwdriver

Electric Drill(Optional)

7/16 in (11mm) -
55/64 in (22mm)
Electric Drill(Optional)

3/8 in (10mm)
Socket Wrench

Supplied Parts and Hardware

⚠ Warning: This product contains small items that could be a choking hazard if swallowed. Before starting assembly, verify all parts are included and undamaged. Do not use damaged or defective parts. If you require replacement parts, please contact our Technical Support line at 1-800-556-0533 or customer service at support@huanuoav.com.

• Please note: Not all hardware included in this package will be used.

Supplied Parts and Hardware for Step 1

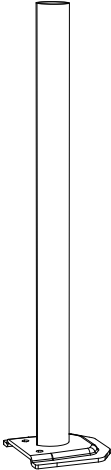

Pole
01 (x1)

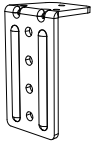

C-Clamp Brace
02 (x1)



Locking Plate
a (x1)

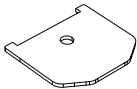

Bottom Pad
b (x1)

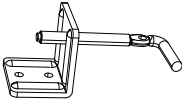

C-Clamp
03 (x1)



M8X10mm
D1 (x2)



Washer
M6
D2 (x1)



Bolt
M6X8mm
E (x2)



Washer
M10
C1 (x1)



Nut
M10
C2 (x1)



Bolt
M6X12mm
C3(x1)



13/64 in (5mm)
Large Allen Key
F1 (x1)



5/32 in (4mm)
Small Allen Key
F2 (x1)

Supplied Parts for Step 2

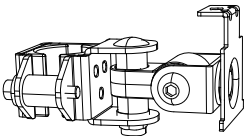

Monitor Connector
04 (x1)



Decorative Cover
c (x1)

Supplied Parts and Hardware for Step 3

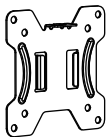

Faceplate
05 (x1)



Bolt
M4X12mm
A1(x4)



Bolt
M4X16mm
A2(x4)



Spacer
L5mm
B (x4)

Supplied Hardware for Step 4



Bolt
M6X16mm
F (x1)

Step 1 Install the Base

Option A:
C-Clamp Installation

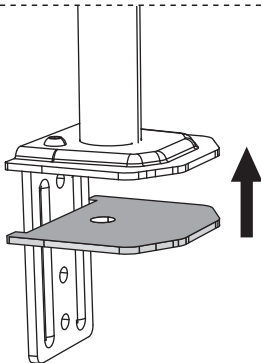
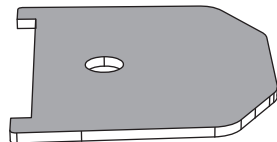
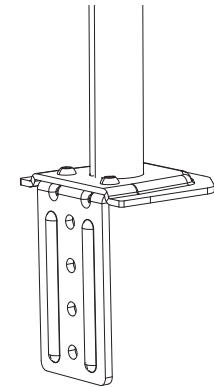
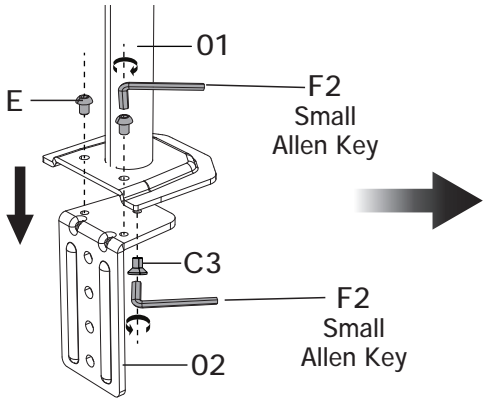

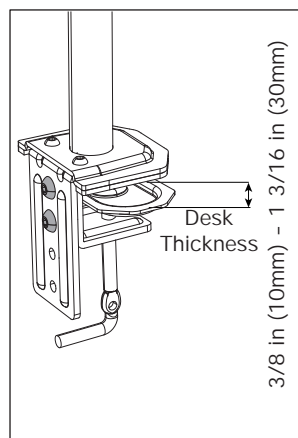
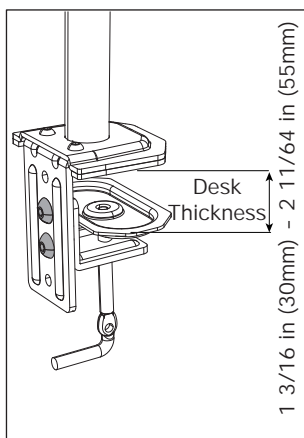
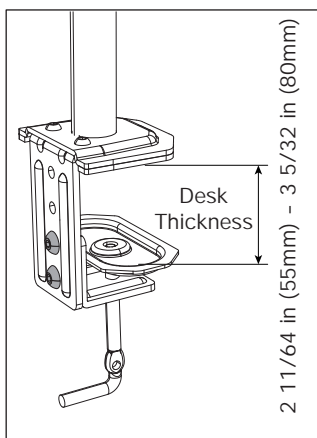
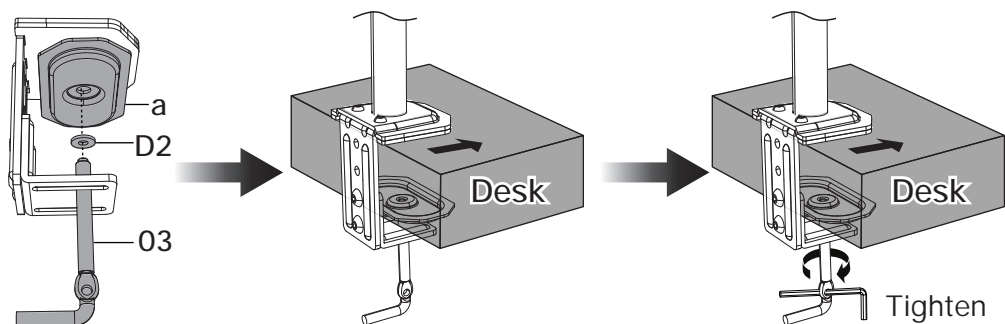
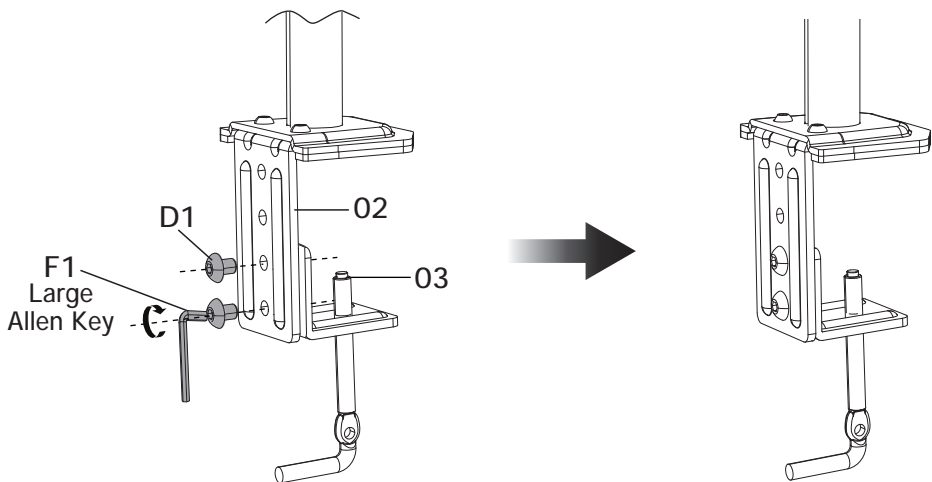

Option B: Grommet Installation

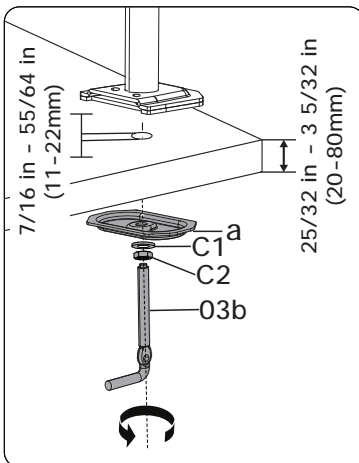
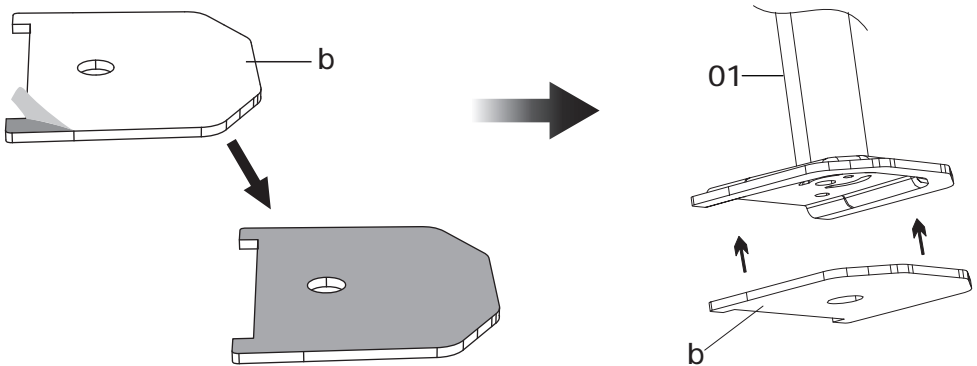
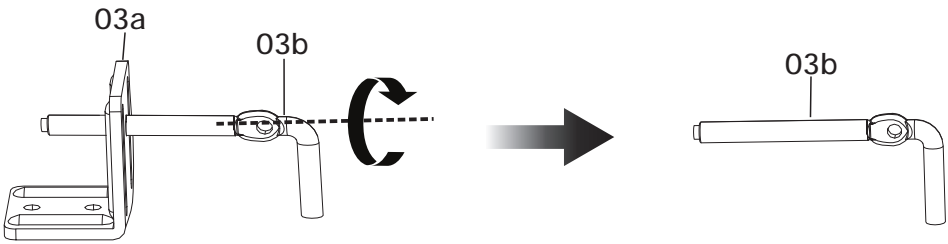

1. If the existing grommet hole comes with a plastic protector, remove it to ensure a flat surface before installing the desk mount.
2. If there is no grommet hole on your desk, mark the pilot hole on your your desired position. Drill a hole using the drill bit in a diameter of 7/16 in (11mm) - 55/64 in (22mm) at the marked position through the mounting surface.

Step 2 Secure the Monitor Connector and Decorative Cover to Pole Assembly

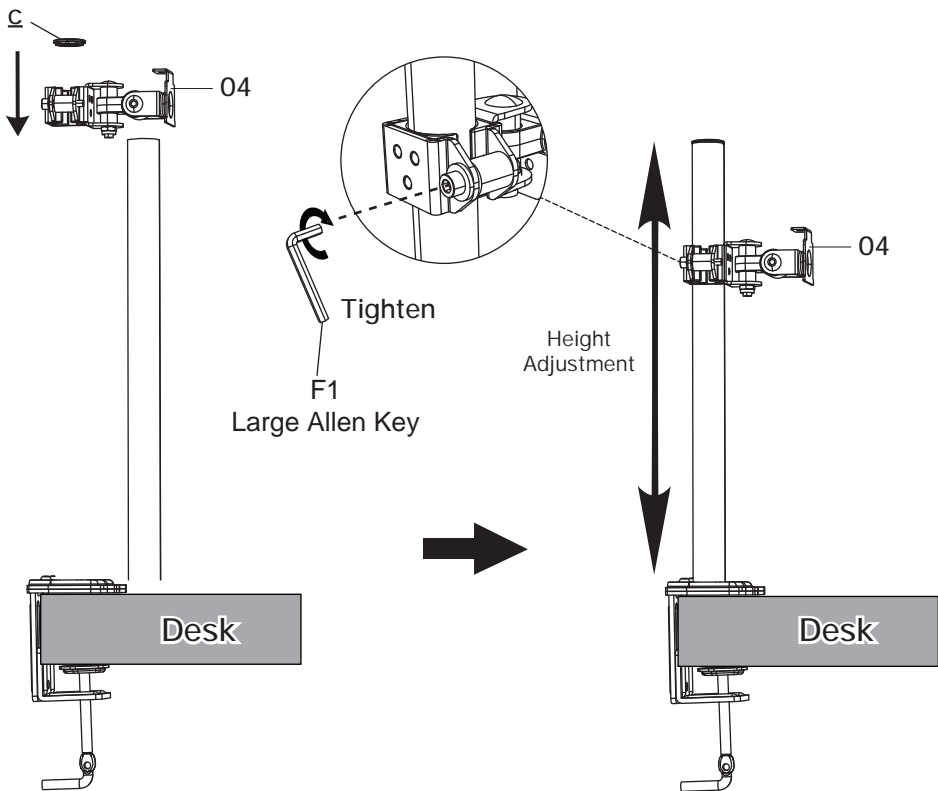

Step 3 Attach the Faceplate to the Back of Monitor

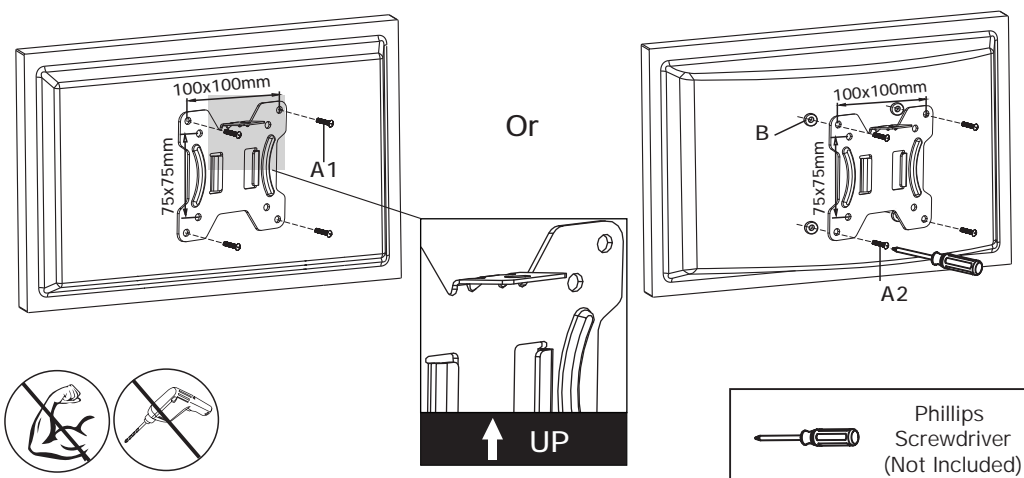

Step 4 Hang the Monitor to the Stand

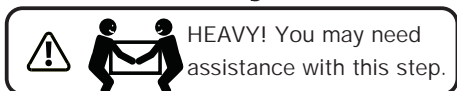
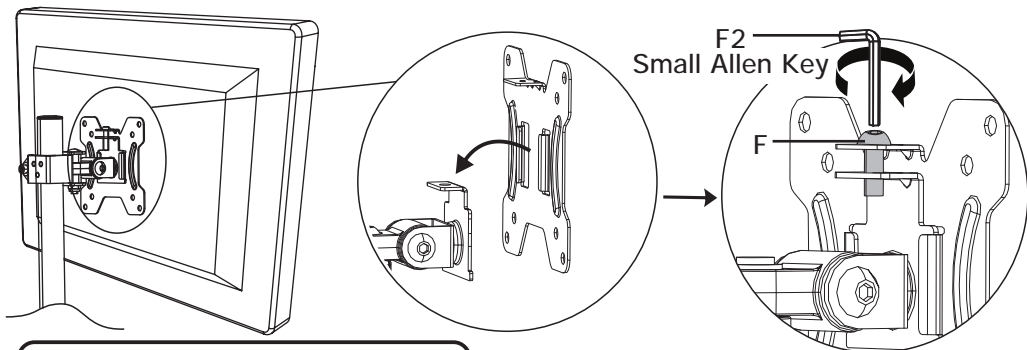

Step 5 Adjust the Tilt Angle and Manage the Cables

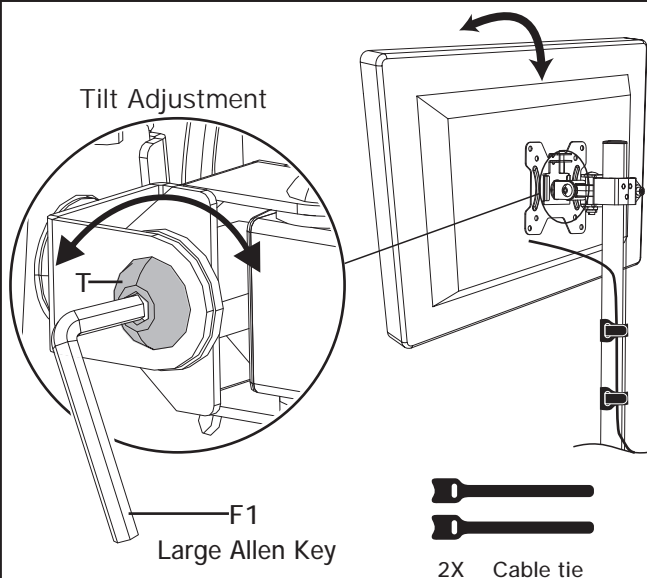

Tilt Adjustment

1. If the monitors can stay at the desired height by itself, no adjustment needed.
2. The tilt angle of the monitor will not be adjusted if the set screw [T] is over-tightened. In this case, you need to turn the set screw [T] in anti-clockwise direction to decrease torque until the monitors can be hovered at any position.
3. The monitors will drop automatically if the set screw [T] is over-loosen. In this case, you need to turn the set screw [T] in clockwise direction to increase torque until the monitors can be hovered at any position.

Warning:

To avoid tipping, please be careful not to extend the monitor too far backward. When you adjust the angle of the monitor, please make sure the monitor is balanced to avoid instability of the center of gravity of the base.

