

展开尺寸:464x176mm,成品尺寸：58x88mm
材质：105g铜版纸，正反面四色印刷

正面

PF3系列 脉冲激光测距望远镜使用指南

产品概述

感谢您购买和使用迈测激光测距望远镜，使用前请仔细阅读使用指南。
迈测PF3系列是一款用于高尔夫等户外活动测量的激光测距望远镜。
PF3系列设计简约，外型小巧，重量轻，便于携带；机身采用硅胶与ABS/PC材料，防摔耐摔，手感舒适。
PF3系列采用高尔夫弹道算法、TOF（光学飞行时间）等技术，实现高尔夫弹道补偿功能。高尔夫扫描功能和测距功能等，测量精度高，是打高尔夫等户外活动的有力“武器”。
PF3系列拥有测距、测高、测角、测速、高尔夫弹道补偿与扫描等多种功能，具有精度高、测量速度快、距离显示直观、耗电量低等特点，是户外活动的小助手。

安全说明

⚠️ 警告

在发射激光时，请不要凝视激光发射孔。通过本仪器注视太阳可能对眼睛造成永久损伤！
切勿将本仪器直接对准太阳，以免对内部组件造成永久损坏。
避免让目镜受到阳光直射。
不要将本仪器置于超出仪器储存温度的极端温度条件下(本仪器储存温度为-20~60°)。
②废物处置：
保护环境，人人有责！
严禁将废电池与生活垃圾一起弃置，请将废电池弃置在指定的垃圾收集站。
本产品不可与生活垃圾一同回收处理，请根据国家/地区实施的法规，合理弃置本产品。
③责任范围：
如未按本说明书使用测距望远镜，使用第三方配件或自行改造测距望远镜而造成的损失，本公司概不负责。

仪器外形

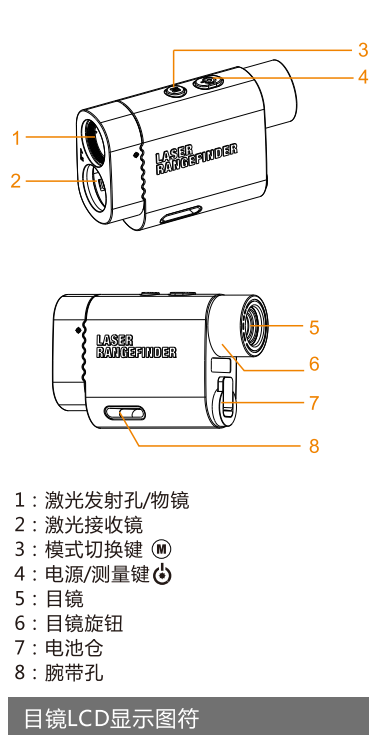

初始操作和设置

目镜
可通过旋转目镜旋钮调节目标清晰度。（见下图）。

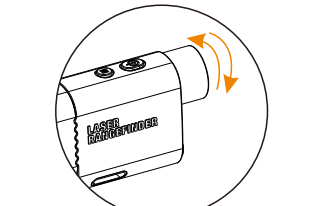

开机与关机

- 按下电源键“”打开电源。
- 若在8秒内无任何操作，本机将自动关机。

单位切换

长按“”2秒可切换数据单位米(m)或码(Yd)。

测量模式切换

*测量前，请先调整目镜旋钮使目标清晰。测量过程中如果目标反射弱或者超出测程范围，则显示“---”。
*测距望远镜的测程与被测目标的性质、目标表面的倾斜角度、天气能见度等有关。一般来说，目标表面光滑、亮色、面积大、光束与目标表面垂直，天气为阴天无雾时则测得远，反之测得近。
*连续测量：所有连续测量均为长按测量键2秒后进入，松手即停止连续测量。
短按“”可切换到以下4种测量模式：

① 高尔夫弹道模式

测距离+弹道距离+测角度
短按测量键“”进行单次测量；
长按测量键“”2秒进行连续测量。
弹道补偿角度/坡度：±20°

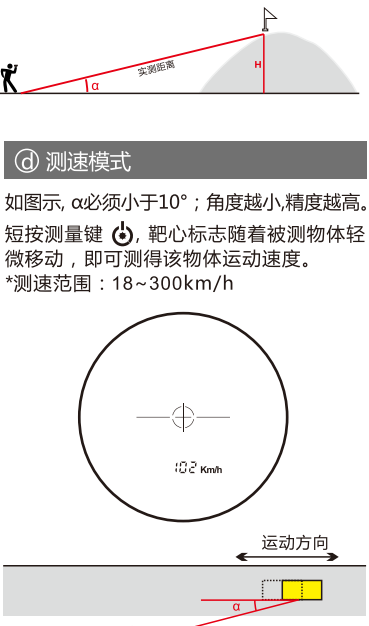
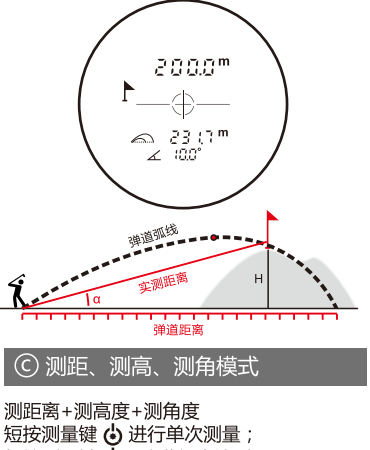
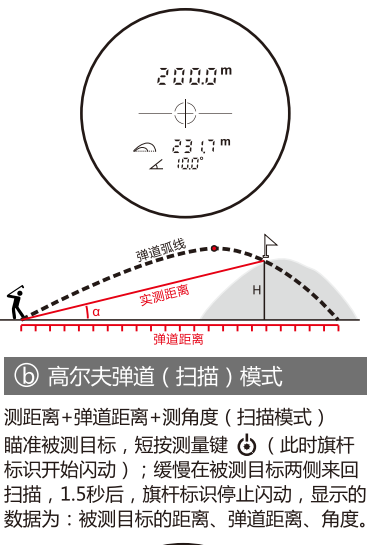

电池的安裝

您可以用1节CR2电池为本仪器供电。当“”（电池欠压指示）显示时，应及时更换电池，否则测距误差会增大；长时间不使用，应将电池从机内取出。

1、将望远镜电池盖上的旋转手柄向上拉起，如图1所示；并逆时针旋转，直到打开电池盖，如图2所示。

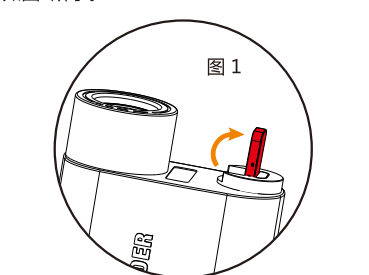

3、电池装配完成后，顺时针旋紧电池盖，如图4所示；然后将旋转手柄按下，如图5所示。

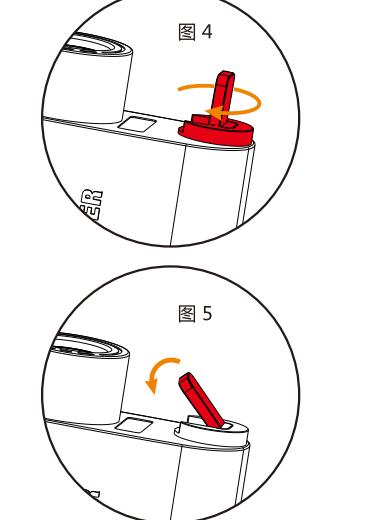

技术参数	
型号	PF3系列
量程①	600/800/1000/1200/1500m
电源	3V,CR2*1
测量单位	米(m)、码(Yd)
测距误差	±0.5m
测量角度范围	-90°~90°
弹道补偿角度范围	-20°~20°
测角误差	±1°
激光波长	905 nm
视力安全	FDA (CFR 21)
视场	7°
望远镜倍率	6X
望远镜物镜口径	22mm
望远镜目镜口径	16mm
出瞳直径	3.7mm
屈光度	±5D
屈光度调整	目镜调整
操作温度	0°C ~+40°C
测高功能	√
连续测距功能	√
旗杆锁定功能	√
测角	√
高尔夫弹道补偿	√
测速	√
测速范围	18~300km/h
液晶显示器	透过式LCD
自动关机	8秒无任何操作
尺寸	118*77*41mm

① 量程
最大量程会依据不同的机型版本而改变，实际量程见机器外包装；

注意事项
1、使用时不能用手指触摸镜头表面，以免损坏镜头表面的镀膜。 2、测距望远镜是经过仪器精确调校的，请勿随意拆卸。如有损坏，应送往专业维修部维修。 3、当外露玻璃镜片被玷污时，请用擦镜纸或布轻轻擦拭干净即可，切勿用其它物体擦拭，以免损伤光学玻璃表面镀膜。 4、携带或使用时，应避免碰撞或重压，更不要使其受到挤压或弯曲。 5、存放时应注意防潮，宜存放在干燥、阴凉、通风的地方，防止太阳直射，避免灰尘和温度突变。 6、如遇雨雾天气会对激光往返时间产生影响，可能导致测量误差加大，雨雾天气非常严重时会导致激光在空气中的往返轨迹偏差，甚至产生测量值错误。

联系我们



公司名称：深圳市迈测科技股份有限公司
中文网站：www.mileseeey.com
英文网站：www.mileseeey.net
联系电话：0755-86329055
公司地址：深圳市南山区留仙大道1213号众冠红花岭·业南区2区9栋6楼

版权声明

上述产品规格如有更改，恕不另行通知。所有版权归深圳市迈测科技股份有限公司所有。所有商标、产品图片、技术参数版权及所有权归深圳市迈测科技股份有限公司所有，侵权必究。

执行标准：QB/440305

反面

PF3 Series Pulse Laser Range Finder Instruction Manual

Product Overview

Thank you for using MileSeeey laser rangefinder, please read the instruction carefully before operation.
MileSeeey PF3 series laser rangefinders are designed for outdoor activities such as Golf, hunting, etc.
PF3 series offers great features of compact size, light weight, easy carrying; thanks to ABS/PC body material, it offers more comfortable user experience and high protective standard for the device.
PF3 series using Golf Trajectory algorithm, TOF (Time of Flight) technologies, to achieve a golf trajectory compensation, golf scanning and ranging functions, etc. High accuracy make it as the powerful weapon for playing golf and other outdoor activities.
PF3 series also offer comprehensive measuring functions of Distance, Height, Angle, Speed, Golf Trajectory Compensation and Scanning, etc. It's a perfect outdoor tool by its amazing features of high accuracy, quick response, transparent screen display and low power consumptions.

Safety Instructions

(1) ⚠️ Warning

- Do not stare into the laser beam.
- Eyes can be permanently damaged to look into sun with the device.
- Do not aim the device to the sun, it will cause permanent damage to inner components.
- Keep the eyepiece away from direct sunlight.
- Do not put the device out of the storage temperature of -20~60°C.

(2) Disposal

Everyone is responsible for environmental protection.
It's prohibited to dispose used batteries together with household waste, please collect used batteries to designated waste station.
This product must not be recycled with household waste. Dispose of the product appropriately in accordance with the national regulations in your country.

(3) Scope of Responsibility

MileSeeey will not be responsible if any use of accessories from other manufacturers without approval from MileSeeey.

Laser Rangefinder Appearance

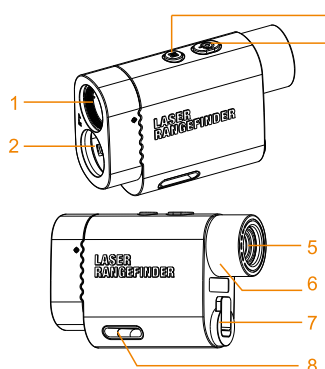

- Laser Emitter/ Objective Lens
- Laser Receiving Lens
- Mode Change Button
- Power/Measure Button
- Eyepiece
- Battery Compartment
- Battery Cover
- Strap Hole

Icons on LCD Display

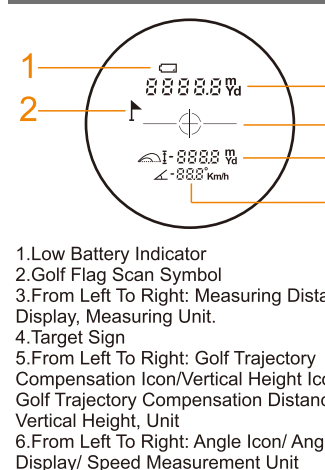

Initial Operation and Settings

Eyepiece
Adjust the eyepiece knob to focus the target.

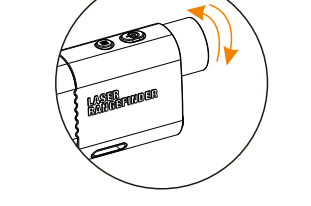

Switch ON or OFF

- Press the “” to Switch ON.
- Automatically switch off after 8s of inactivity.

Unit Change

Long press “” 2s to change the unit (m or Yd)

Measuring Mode Change

*Please adjust the eyepiece to focus the target before measuring.
In the course of the measurement, if the target reflection is weak or out of the measuring range, it will display as “---”.
*The measurement range will be affected by materials of the target, inclined angle of the target surface, visibility of the weather, etc.
In general, if the target surface is smooth and bright with larger area, the beam is perpendicular to the target surface and the weather is cloudy without fog, the measurement range will be longer, and vice versa.
*Continuous measurement: Long press Measure Button for 2s to activate the Continuous measurement, loosen to deactivate the operation.
Short press “” to switch to 4 measuring mode as below:
① Golf Trajectory Mode
Distance+ Trajectory+ Angle
Short press “” to activate Single distance measurement ;
Long press “” 2s to activate Continuous measurement
*Trajectory compensation angle/Slope: ±20°

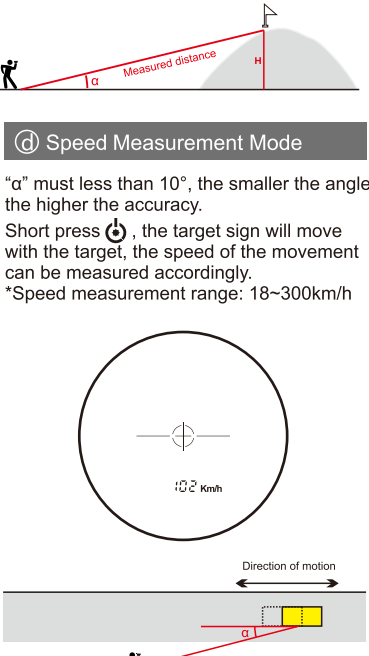
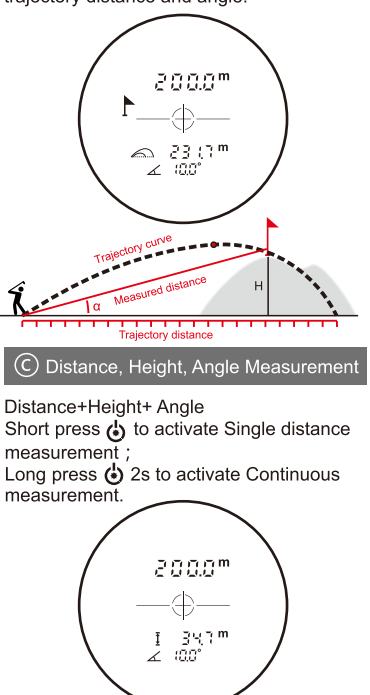
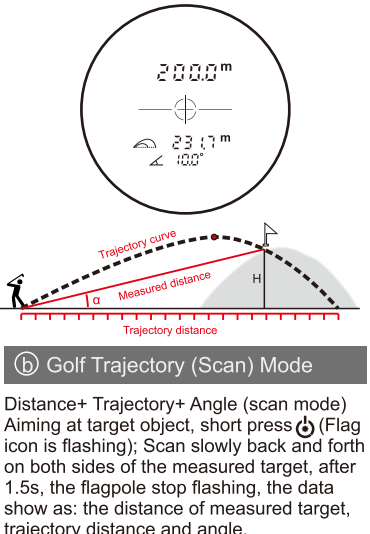

Battery installation and instructions

Please use 1x CR2 battery to power on the device.
When “” (Low battery) is displayed, pls replace the battery in time, otherwise the distance error will increase. Please take off the battery if it is not used for long time.
1. Pull up the rotary handle on battery cover (photo1) and turn it clockwise until the battery cover is opened (photo 2).

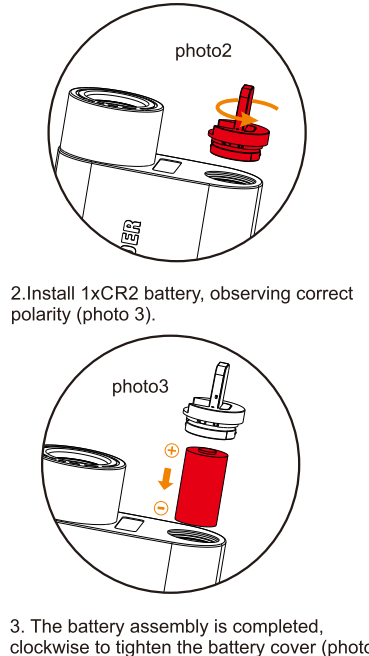
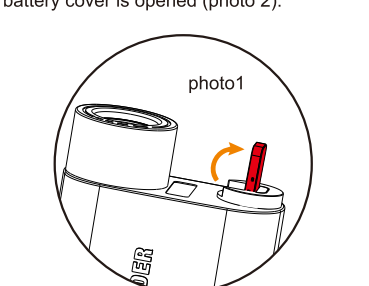

3. The battery assembly is completed, clockwise to lighten the battery cover (photo 4), then press the rotary handle (photo 5)

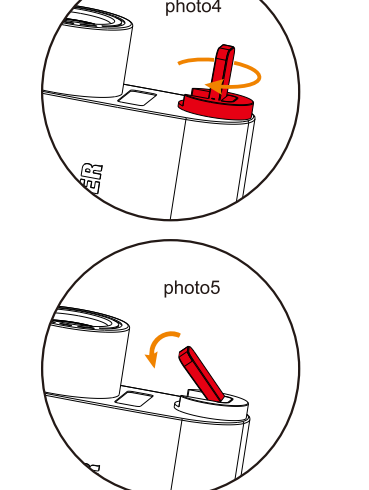

Technical Data	
Model	PF3 Series
Measuring Range①	600/800/1000/1200/1500m
Battery	Type3V,CR2*1
Measuring Unit	m/Yd
Measuring Accuracy	±0.5m
Measuring Angle	-90°~90°
Trajectory Compensation Angle Range	-20°~20°
Angle Accuracy	±1°
Wavelength	905nm
Vision safety	FDA (CFR21)
Field of View	7°
Scope Magnification	6x
Objective Lens Diameter	22mm
Eyepiece Lens Diameter	16mm
Exit Pupil Diameter	3.7mm
Dioptr	±5D
Dioptr Adjustment	Eyepiece adjustment
Operating temperature	0°C~+40°C
Height Measurement	√
Continuous Ranging Function	√
Flag Lock	√
Angle Measurement	√
Golf Trajectory Compensation	√
Speed Measurement	√
Speed Measurement Range	18~300km/h
Display	LCD
Auto Power Switch-off	8s after inactivity
Dimension	118*77*41mm

① The maximum range shall be different according to different models. The actual range refers to the package.

Notice
1.In order to protect the coating of the lens, do not touch lens with your fingers. 2. Laser rangefinder has been precisely calibrated by instruments, please send back to dealer for repairing instead of disassemble by yourself. 3.When the lens is contaminated, please wipe gently with clean cloth, do not use tough objects to wipe. 4.Avoid collision or heavy load when carry or use, especially keep away from baking or corrosion. 5.Keep the product away from moisture during storage. Please keep it in a dry, cool and well ventilated place to avoid direct sunlight, dust and temperature mutation. 6.Rain and fog will affect the laser ray-path, which may worsen the measurement accuracy. It also may cause errors under very bad weather condition.

Contact us



Shenzhen Mileseeey Technology Co., LTD.
Website: www.mileseeey.com (CN)
www.mileseeey.net (EN)
Telephone: +86 755 86329055
Add.: 6/F, Building 9, Zhongguan Honghuang Industrial South Park II, 1213 Liuxian Ave, Taoyuan Street, Nanshan District, Shenzhen, 518055, P.R. China.

Copyrights

The product specifications are subject to change without notice, all final interpretation rights were reserved by Mileseeey Technology Co., Ltd. All trademarks, product images, technical parameters are properties of Mileseeey Technology Co., Ltd. All rights reserved.

执行标准：QB/440305