

- For help on setting up your AT&T voicemail, go to [**att.com/voicemailsetup**](http://att.com/voicemailsetup).
- Visit [**att.com/whphelp**](http://att.com/whphelp) to view videos and interactive tutorials on how to set up, use and troubleshoot your Wireless Home Phone base.
- Refer to your User Guide for detailed information about using your Wireless Home Phone base, including advanced troubleshooting and frequently asked questions.
- Call AT&T Customer Care at 1-800-331-0500 for assistance with your AT&T service.

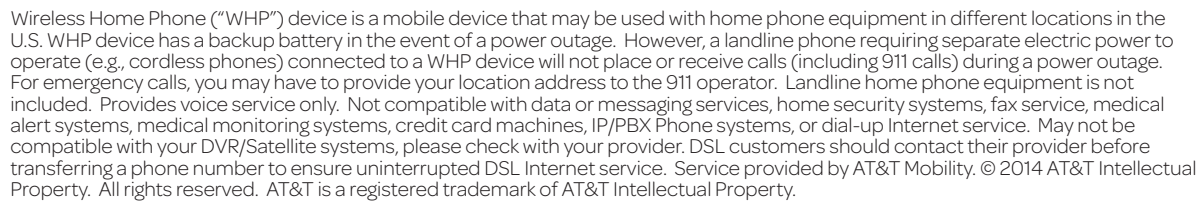

081704100247

The Wireless Home Phone base uses the AT&T cellular network and DOES NOT use your home phone wall jacks.

Your device should be located:

- Where you have a strong signal from a cell tower, typically near a window or outside wall. Signal strength may vary in different parts of your home.
- Near an electrical wall outlet.

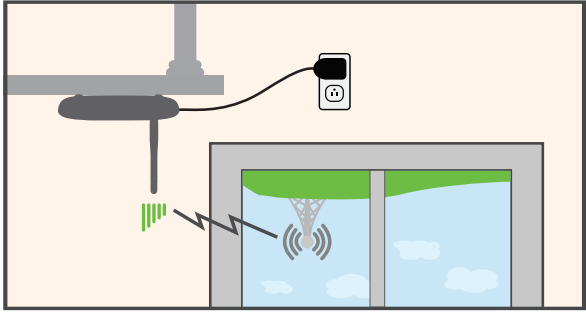

Transferring a Phone Number from a Prior Provider?

It may take up to 5 days to transfer your number to the Wireless Home Phone base.

You must keep a phone plugged into your wall jack to **receive** calls on your old service

until your transfer completes. However, you can **make** calls immediately on your Wireless Home Phone base. Check transfer status at att.com/port.

Getting to Know Your Device

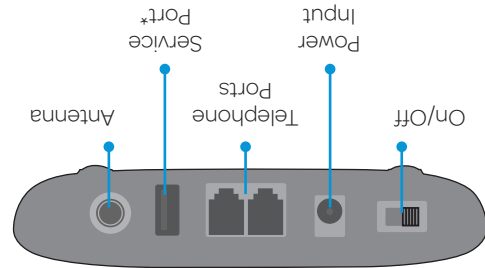
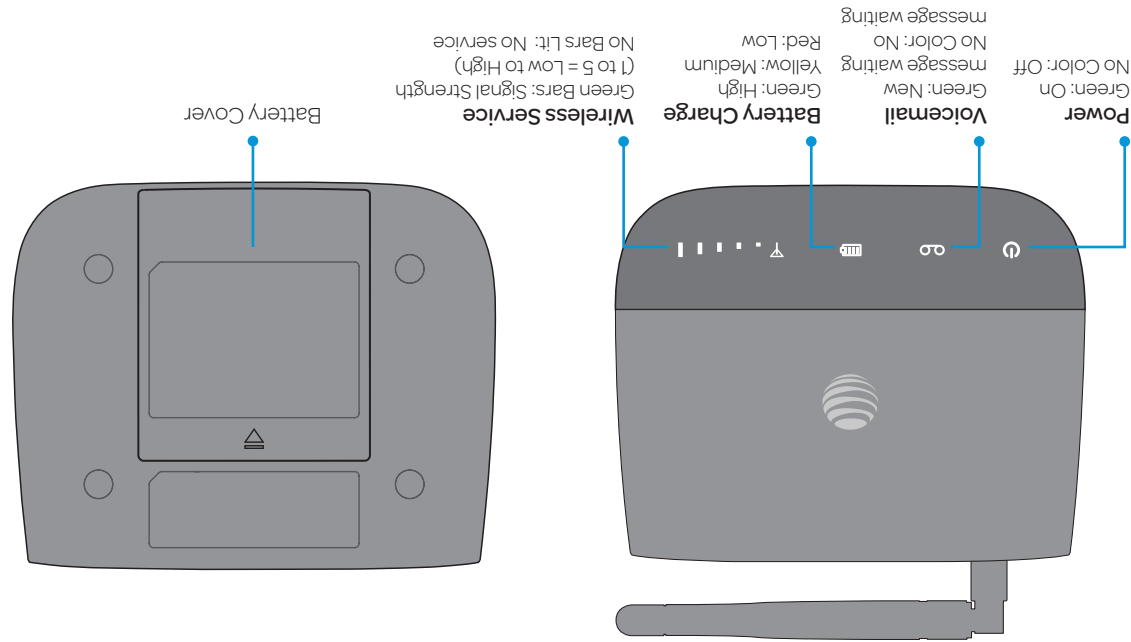

For more detailed information on Light Indicators, please refer to the User Guide.
*Reserved for AT&T technical support.

Quick Start

AT&T Wireless Home Phone



① Install the Back-up Battery

Remove the cover from the battery compartment.



Insert the back-up battery and replace the cover.

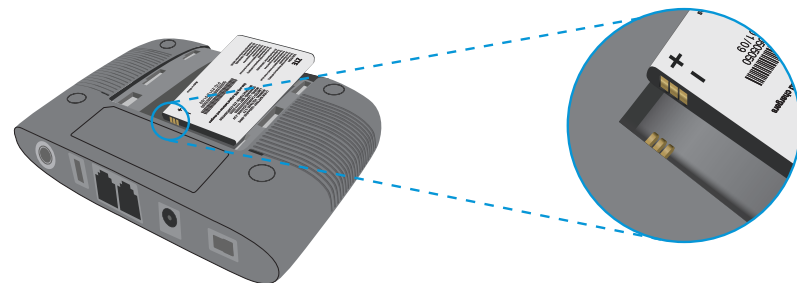

② Turn on Your Device

Plug the power cord into an electrical wall outlet.

Insert the small end of the power cord into the round Power Input port on the back of your Wireless Home Phone base.

Slide the **On/Off** switch to the **On** position.

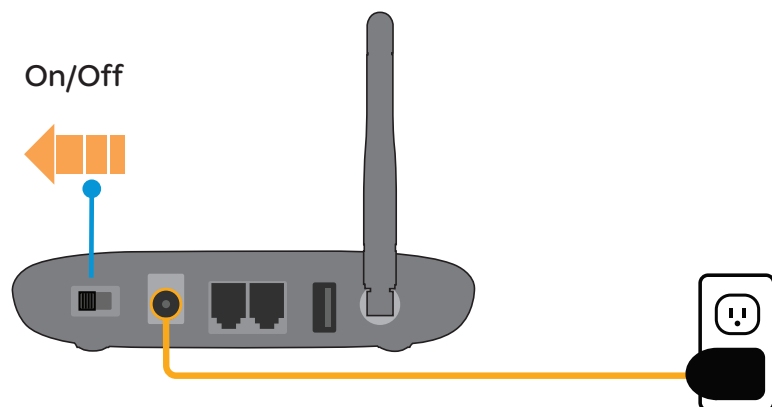

③ Check the Wireless Signal

Raise the antenna to an upright position and check the signal strength.

More green bars indicate a stronger signal. Your device can be relocated in your home for best performance.



④ Connect the Device to a Phone

1) Unplug your phone from your home phone wall jack.

2) Plug your phone into the "Phone 1" port on the Wireless Home Phone base, using your existing phone cable or included phone cable.

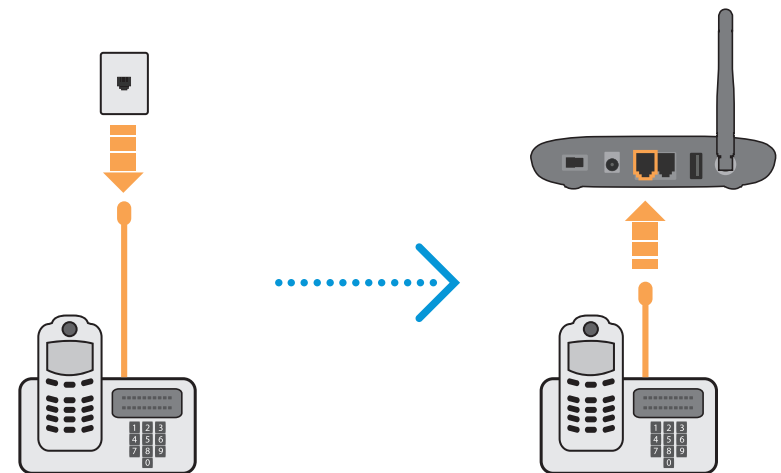

IMPORTANT: DO NOT plug the Wireless Home Phone base or your phones into your wall jacks.

⑤ Place a Test Call

Place a test call from your connected home phone. Make sure to dial the 10-digit phone number, including area code.

For best results, place the cordless phone base at least 12 inches from the Wireless Home Phone base.

NOTE: Keep your cordless phone plugged into a power outlet.

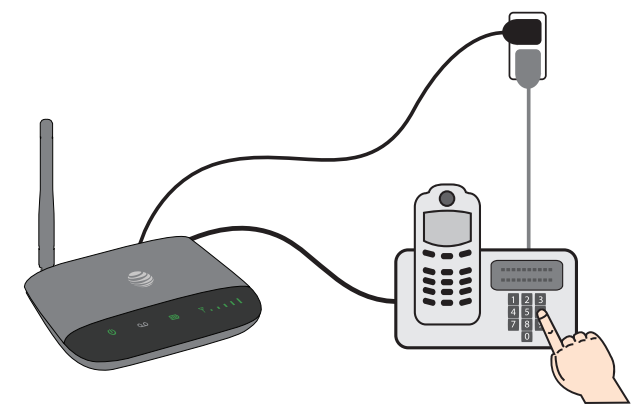

⑥ Set up Voicemail and Additional Phones

Voicemail is included with your service. **Dial "1" to set up and access.** If you choose to use an answering machine instead, set it to fewer than 5 rings.

To place phones throughout your home, use a cordless phone system with multiple handsets. Wall jacks are not used with Wireless Home Phone.

