

APPLICATION OPERATION MANUAL



SCAN TO DOWNLOAD APP

CHOOSE" SCENT TECH" APP TO DOWNLOAD

READ THE MANUAL CAREFULLY BEFORE USE AND KEEP IT PROPERLY

- This is Wifi operation for Diffuser
- Please download our app: scent tech, on google player or apple store, or scan QR on following photos.
- The machine can be set for 5 groups for different working periods , it can set different working days, working times according to different requests and suit for different places.
- Diffuser only work when your country time (As same as your Country work time once completing app config) is within work time. or not work
- For each work mode (Photos 5 below), time should be within 0:00-23:59, can not pass it, or system will not work. Also can not have same work time for each mode.
- If display button locked, that's because you locked on app. please unlock on Photos 13 below.

Any question? please contact us directly: sale@scent-master.com Whatsapp: +86 18158350716

1 INSTALLATION AND REGISTRATION INSTRUCTIONS

- 1) Scan the QR code and download the APP(**Scent Tech**) or download on google player or applestore.

Apple store



Google player



- 2) Open our app once completing download, then click" WIFI". **Must allow access for location and Nearby Devices. It will very important to connect WIFI signal.**



A. Click" WIFI"
(photos 1)

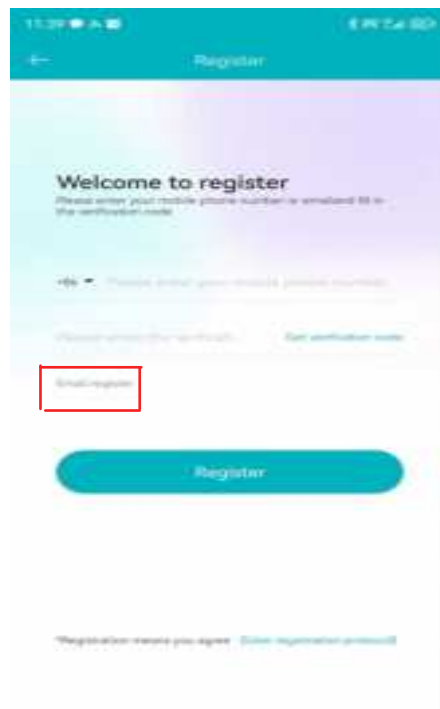

B.Register with email
(photos 2)

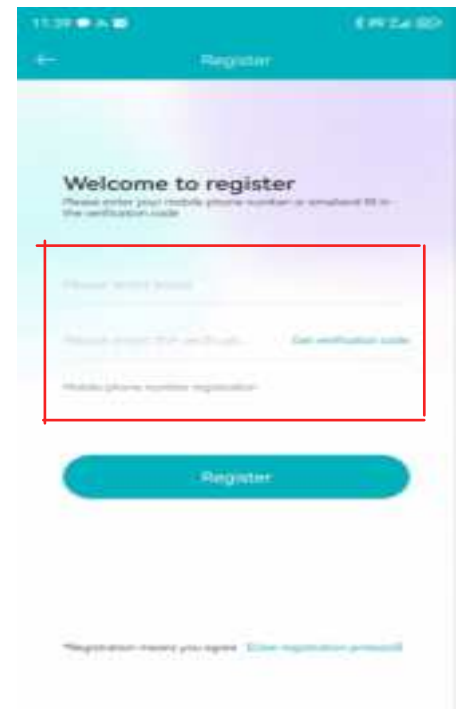

C. Completed Register
(photos 3)

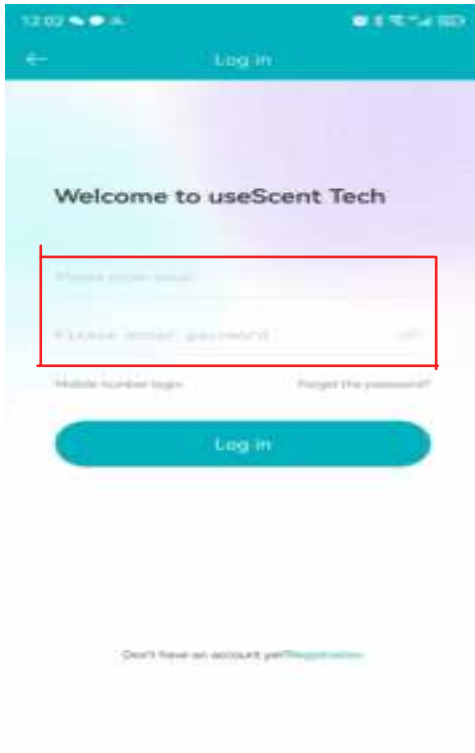

D.Login with email and password
(photos 4)

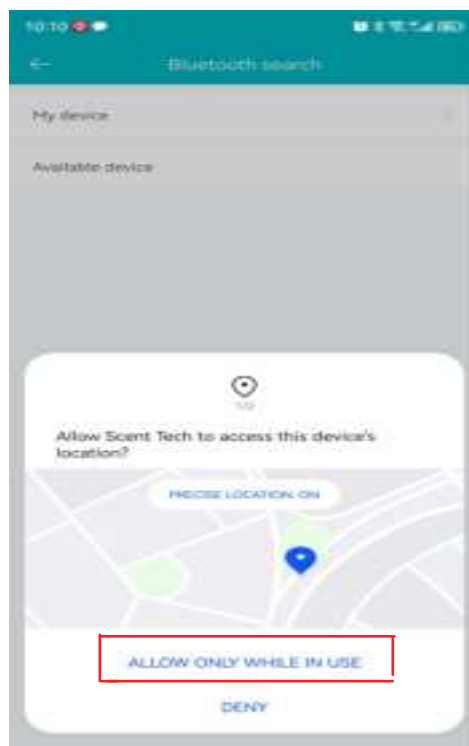

E.Click " Allow Only While
In use"
(photos 5)



F. Click " Allow " for Nearby
Devices access
(photos 6)



G.Click "+" to choose WIFI MODE
(photos 7)

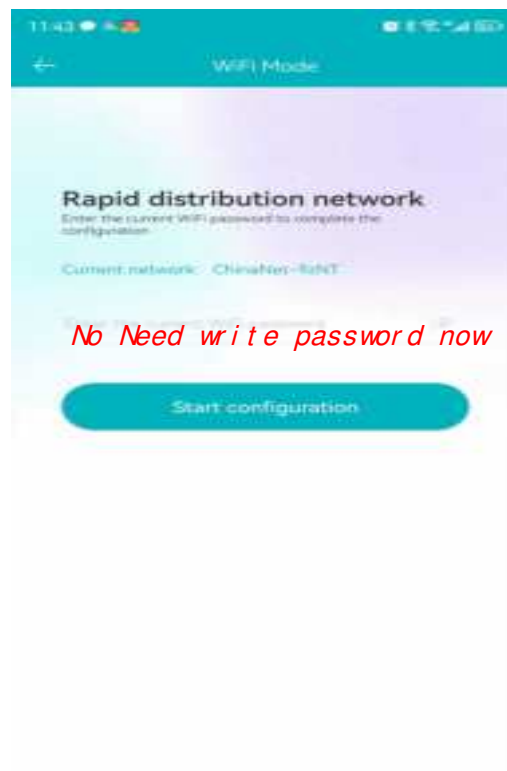

H. When you see this page
with your own wifi signal.
Please next step
(photos 8)

MOST IMPORTANT
to
Connect wifi



I. Press DOWN button 5 seconds till "-OF -" shown on display
(photos 9)

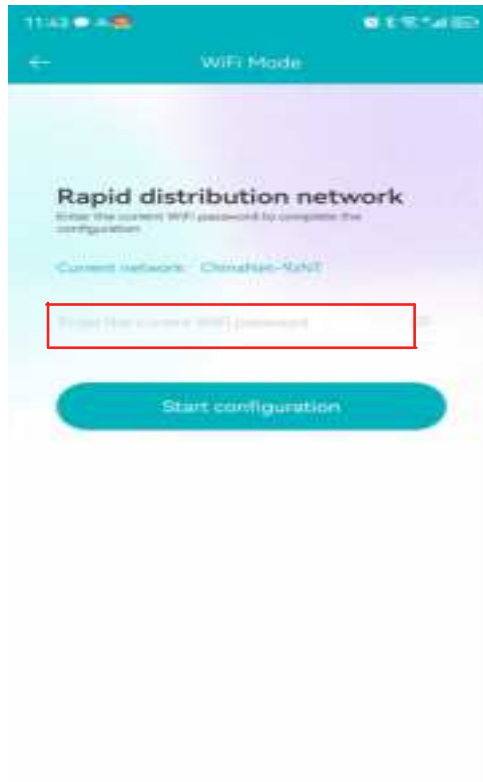

J. Write your wifi passwod here,then click" Start configuration"
(Keep diffuser close to wifi router)
(Keep wifi 2.4G,NOT 5G)
(photos 10)

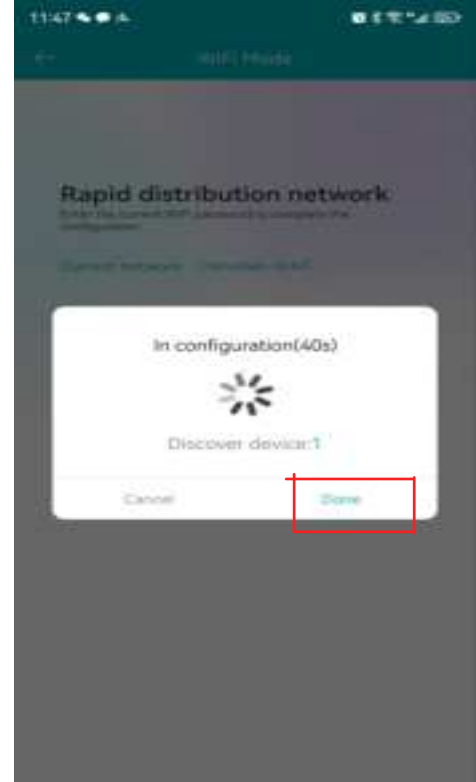

K. Click "Done" once connected well
(photos 1 1)

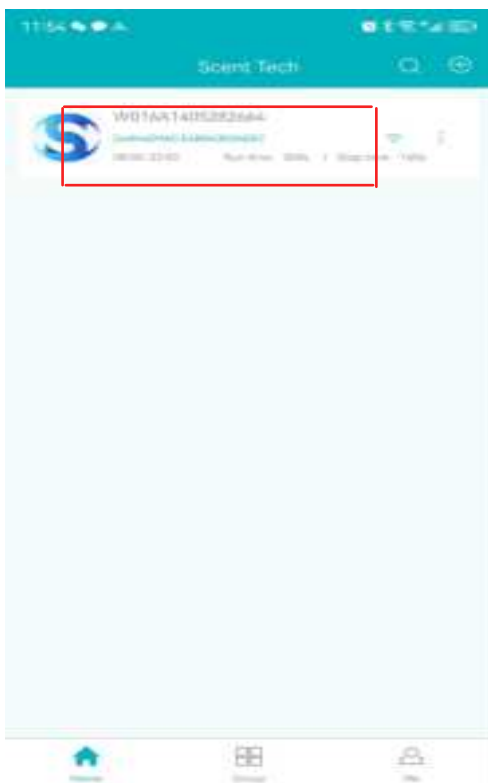

L. Click Devices connected for setting time
(photos 12)



M. Now we can see app setting page
(photos 1 3)

In next page, we will introuduce page detail and show how to set up work time on app

2 KNOW MORE ABOUT APP SETTING

Please click devices connected, you will see follow page

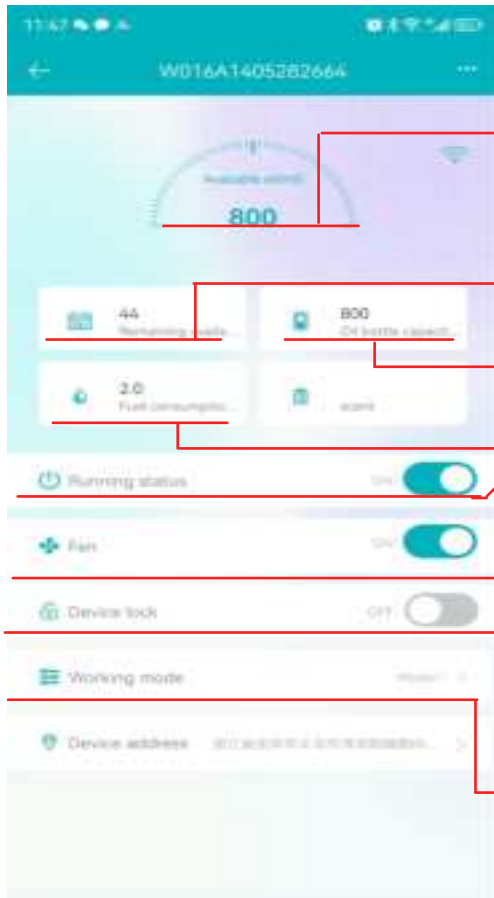

APP PAGE

(photos 14)

Oil Volume in bottle: Keep same oil volume in bottle

Oil last days: our app will calculate automatically

Bottle Volume: Fixed 800ml

Oil consumption: fixed 5ml/H

Running Status - 1. Diffuser no work when turn off
2. Diffuser will work according to

Fan Switch- 1. When turn on, diffuser fan will work together with diffuser.
2. When turn off, fan inside will not work

- Device Lock -
When turn on, display button locked. when turn off, button unlocked

- Working Mode -
You can set up accurate working mode here.

*When you click "Working mode" to set up work time,
you will see follow page*



Work time (from 0:01 to 23:59)

- Switch button: Turn on / turn off

- Continue work/pause time (300s run/20s stop)
- means: work 300 seconds, then pause 20 seconds, then work 300s, pause 20s...

- Work Days (Mon.....Sun)
- Means: work from monday to sunday

5 work time Available

Important:

1. Each mode, Time should be within 0:01-23:59, Can not pass it.

Example:

mode 1: 8:00-22:00 - Right
mode 1: 8:00-5:00 - Wrong

2. It can not have same work time for all mode, or diffuser no work

mode 1: 8:00-20:00
mode 2: 10:00-18:00

because mode 1,2 have same work time, so
diffuser will not work

5 Work Time Available

(photos 15)

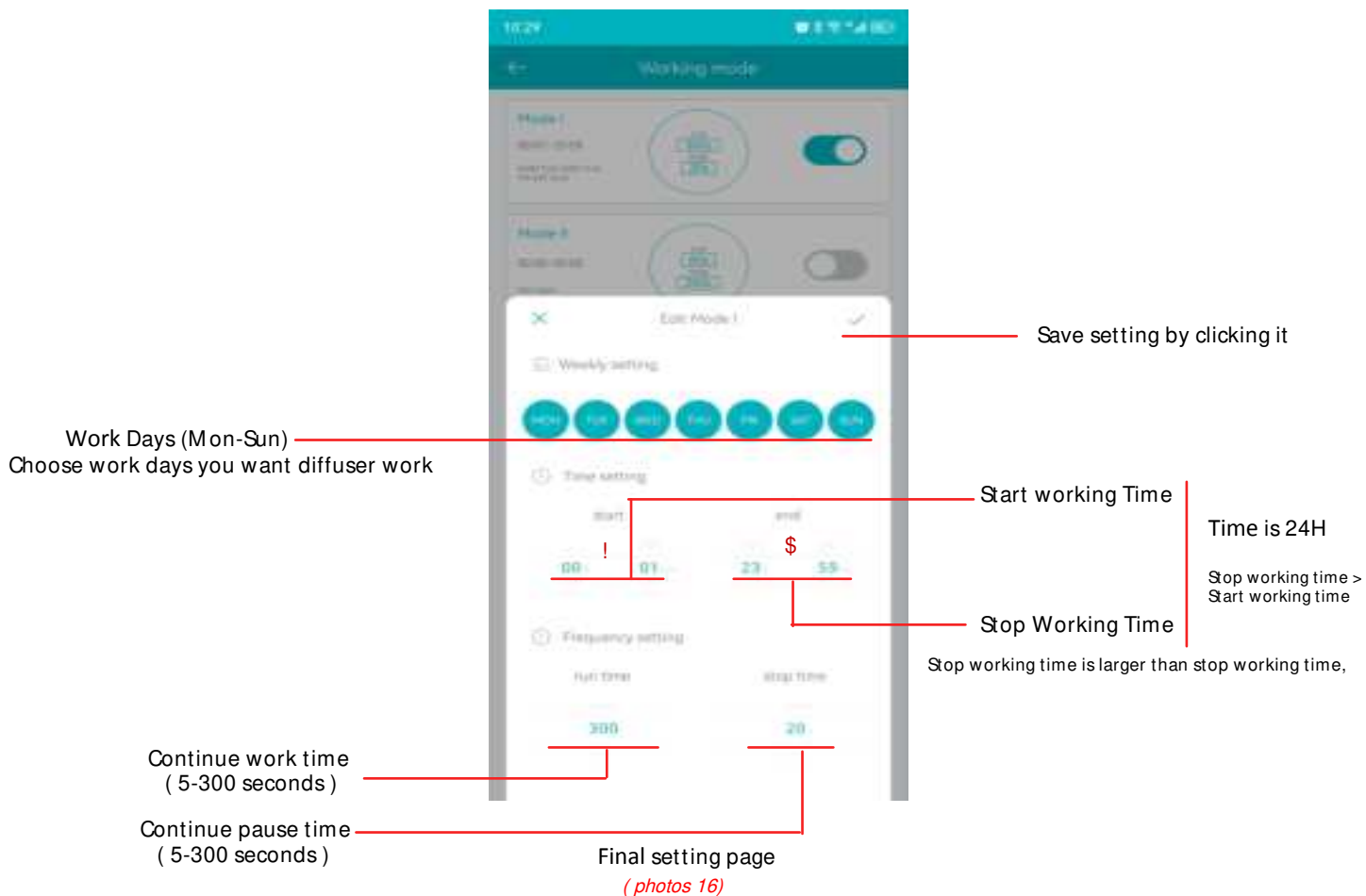

Most Important

Diffuser Only work when your country time(as same time as your country time) is within your work time (remark ! \$ in photos 16), or no work
The number of start working time (Remark ! in photos 16) is less than number of stopping working time (Remark & in photos 16)

3.LET'S DO EXAM PLE

Example 1:

If you want diffuser work from 0:01 am to 23:59pm. all days per week. want continue work 300 seconds, then pause 20 seconds.

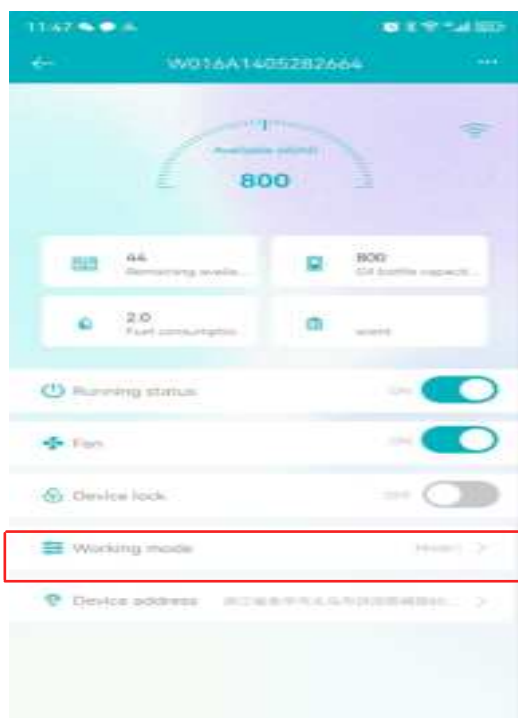

Step 1: Click Working mode (photos 17)



Step 2: Click mode 1 (photos 18)

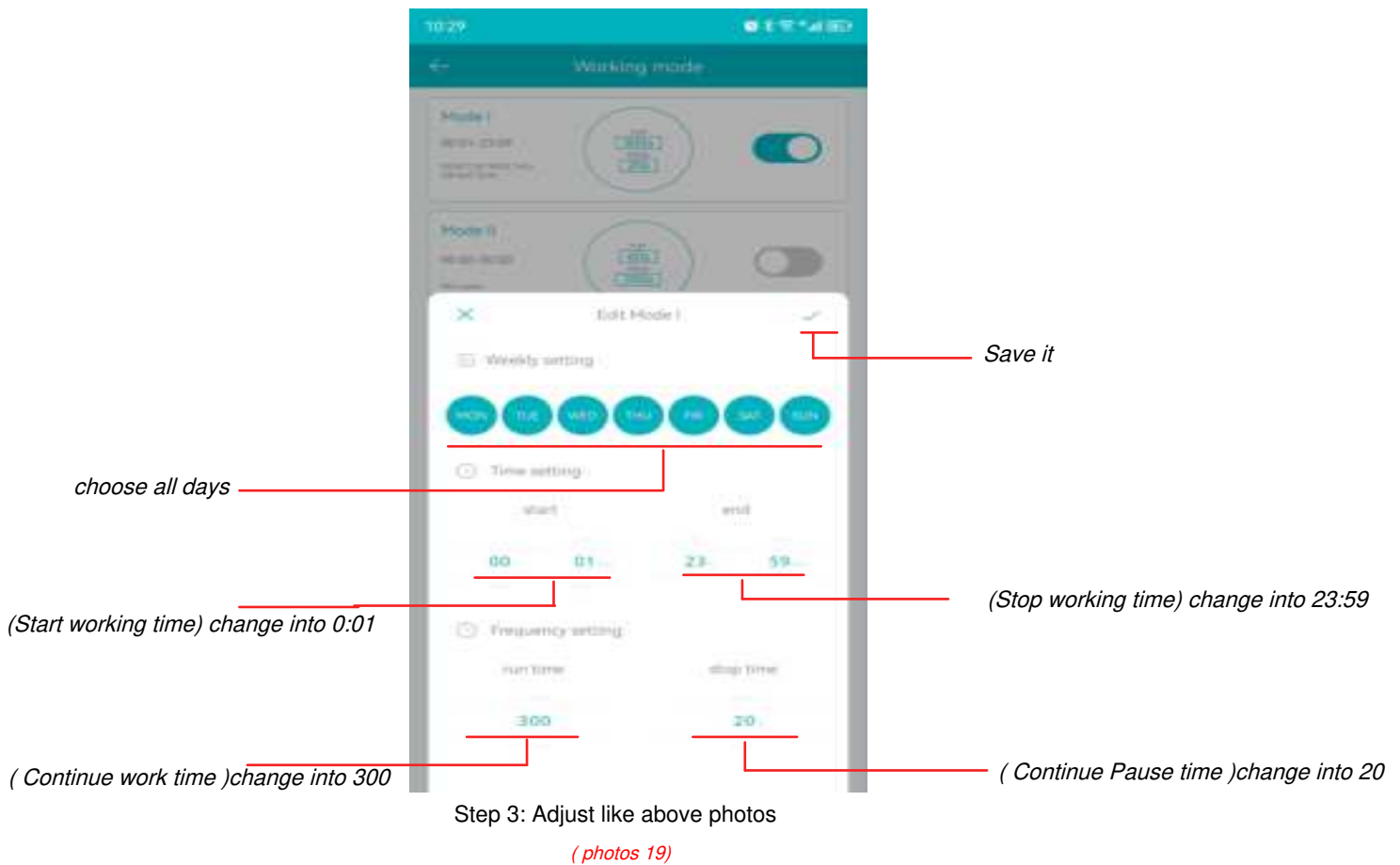

Example 2:

If you want diffuser work from 9:00 am to 4:00 Am Next days, all days per week. want continue work 300 seconds, then pause 20 seconds.

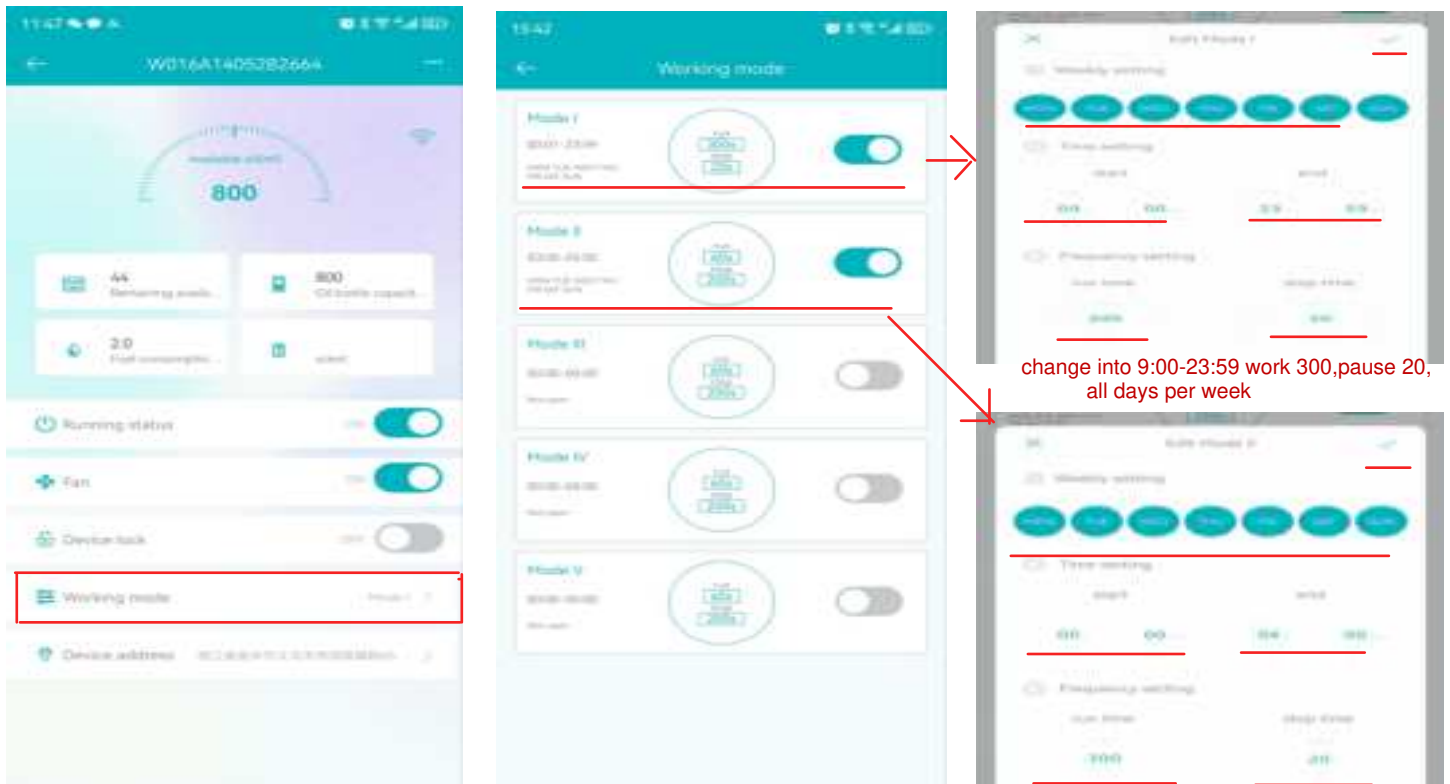

Step 1: Click Working mode
(photos 20)

Step 2: Click Working mode
(photos 21)

Step 3: Adjust work time for mode I, II
(photos 22)

Because 9:00-4:00am Next days, it has passed 23:59, so need change into 2 different work time:

1. mode 1: 9:00 - 23:59
2. mode 2: 0:00 - 4:00

4 PROBLEM & SOLUTION

A. Why can not successfully configure our app?

- Please check follows:

1. Have downloaded our app: Scent Tech
2. Allow all access for our app when opening our app
3. Keep your mobile Close to Diffuser

B. Why i can not press diffuser button?

Please unlock button on app here:

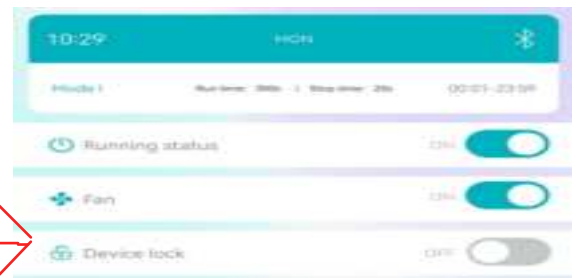

(photos 23)