

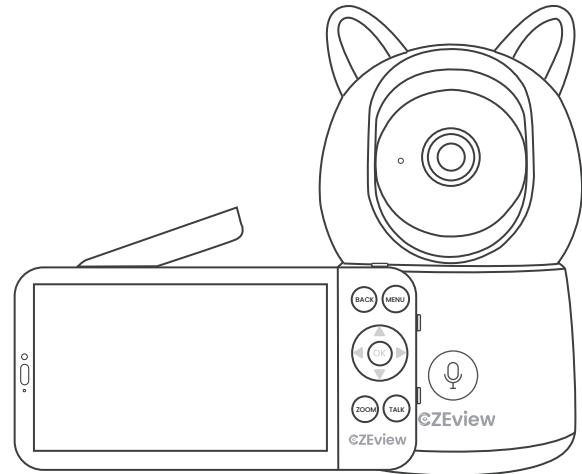

See Everthing, Miss Nothing

We hope you never have the need,
but if you do our service is friendly and hassle-free.

✉ support@czeview.net



Baby Monitor User Manual

CONTENTS

IMPORTANT SAFETY INSTRUCTIONS	P01
BATTERY	P02
CAUTIONS	P02
WHAT'S INCLUDED	P03
PRODUCT OVERVIEW	P04
SPECIFICATIONS	P06
PREPARATION	P07
CONNECTING/DISCONNECTING	P08
THE CAMERA FROM THE MONITOR	
• CONNECTING THE CAMERA TO THE MONITOR	P08
• UNBINDING THE CAMERA FROM THE MONITOR	P11
NIGHT VISION	P13
SAFETY PROTECTION	P13
SET UP THE SYSTEM	P14
• DOWNLOAD APP	P14
• REGISTER AND LOG IN TO YOUR ACCOUNT	P14
SET UP THE CAMERA ON THE APP	P15
• METHOD 1 CONNECT VIA BLUETOOTH	P15
ENABLED (RECOMMENDED)	
IMPORTANT TIPS	P19
• SCAN THE QR CODE FOR DETAILED USER GUIDE	P19
FCC STATEMENT	P20

IMPORTANT SAFETY INSTRUCTIONS

- Ensure adherence to all warnings and instructions marked on the product.
- Adult setup is mandatory.
- The product serves as an aid only and should not replace responsible and proper adult supervision.
- Not designed for use as a medical monitor.
- Avoid usage near water to prevent the risk of electric shock.
- Utilize only the adapters provided to avoid damaging the product.
- Employ only attachments and accessories endorsed by the manufacturer.
- Disconnect from the power source before cleaning. Avoid liquid cleaners; use a dry cloth instead.
- Unplug during prolonged periods of non-use.
- Keep power cords clear of obstructions and ensure they are not a tripping hazard.
- Operate solely with the power source type indicated on the product.
- Avoid placing on unstable surfaces to prevent falls.
- Ensure proper ventilation to avoid overheating. Never cover ventilation slots.
- Do not attempt to disassemble. Contact authorized service facilities for maintenance.
- Supervise children to prevent product tampering.
- Store small, detachable parts away from young children to prevent choking hazards.
- Not for use by individuals with limited physical, sensory, or mental capabilities without proper supervision.

BATTERY

- Use only the specified battery to prevent explosion risks.
- Avoid exposure to extreme temperatures and pressures, which can cause explosions or leaks.
- Do not dispose of the battery in fire or attempt to damage it mechanically.
- Follow proper disposal guidelines for used batteries to minimize environmental harm.

CAUTIONS

- Handle batteries with care to avoid burn, fire, and explosion hazards.
- Protect the product from extreme temperatures, sunlight, and heat sources.
- Prevent strangulation by keeping cords out of children's reach.
- Do not place the camera within or too close to the baby's crib or playpen to avoid suffocation and strangulation risks.
- Install the camera safely away from the crib to prevent injury.
- Be mindful of potential interference from other electronic devices and position the camera unit accordingly.
- Regularly test sound reception for optimal performance.
- Maintain a distance of at least 1.5m/4.9ft between the monitor and camera to prevent microphone feedback.

WHAT'S INCLUDED

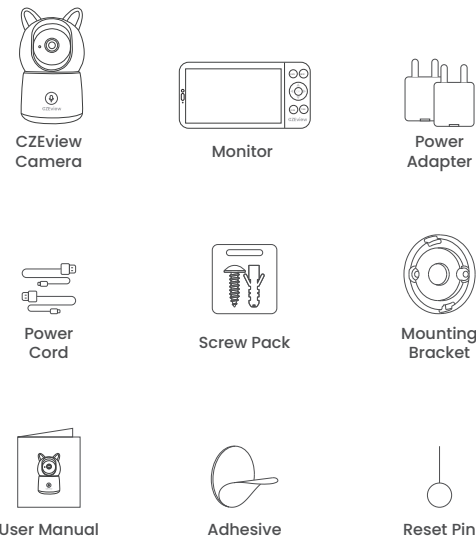

Note:
This package is designed exclusively for Single-Camera Baby Monitor purchasers. Dual-Camera Baby Monitor buyers receive an additional camera, power adapter, cord, screws, bracket, and adhesive.

PRODUCT OVERVIEW

•Camera

•Use the monitor/app to activate the light switch for three unique lighting modes.

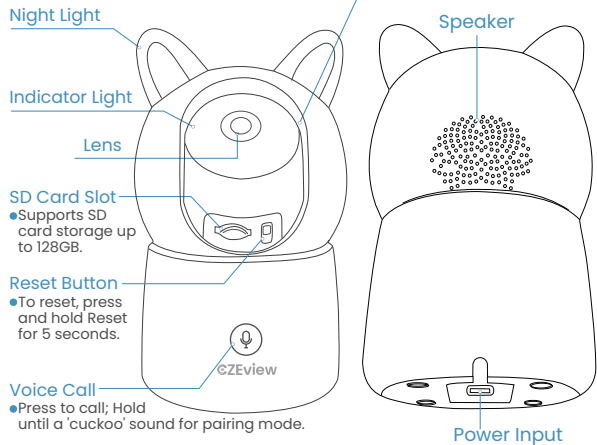

- Supports SD card storage up to 128GB.
- To reset, press and hold Reset for 5 seconds.
- Press to call; Hold until a 'cuckoo' sound for pairing mode.

Indicator Light	
Solid Red Light	• Device abnormal
Slow Red Flashes	• Awaiting Wi-Fi connection
Fast Red Flashes	• Search for Wi-Fi networks
Steady Blue Light	• Camera is normal
Slow Blue Flashes	• Connecting to Wi-Fi / AP Connection Status
Fast Blue Flashes	• Device Upgrading

• Monitor

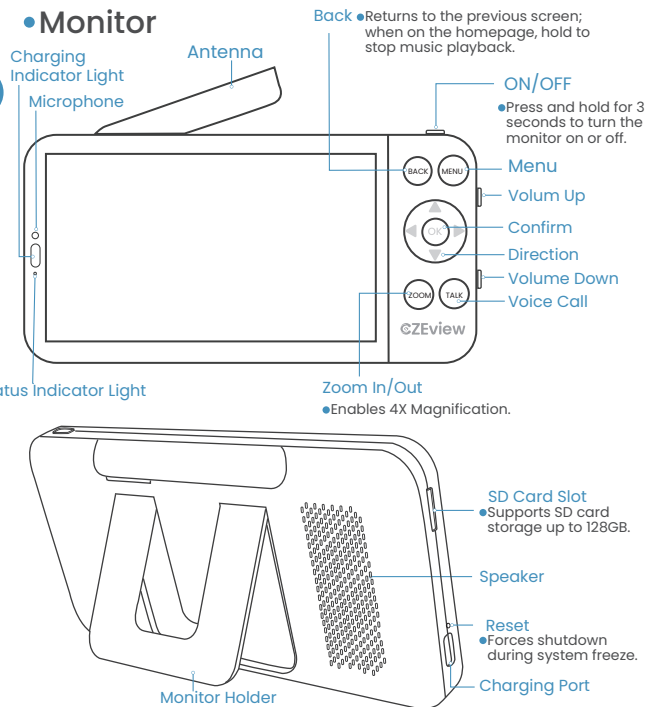

Charging Indicator Light

Solid Orange Light	• The monitor is charging
Solid Green Light	• The monitor is fully charged.
Light Off	• The monitor is not charging (not plugged in).

Status Indicator Light

Solid Orange Light	• The monitor is in use.
Light Off	• The monitor is powered off.

SPECIFICATION

SCREEN SIZE	5.5"
WIFI BAND	2.4GHz
PAN/TILT	355°/100°
TWO-WAY AUDIO	SUPPORTED
NIGHT LIGHT	THREE UNIQUE LIGHTING MODES AVAILABLE
LULLABY	14 LULLABIES VIA APP WITH SD CARD; 3 VIA MONITOR
HUMIDITY& TEMPERATURE DETECTION	SUPPORTED
MOVEMENT DETECTION	SUPPORTED
POWER SUPPLY	DC 5V/1A
LENGTH OF THE POWER CORD	4.9 FT
WORKING TEMP	32°F -104°F
LOCAL STORAGE	MICRO SD CARD (UP TO 128G)

PREPARATION

• LOCAL MONITORING

Operates independently of the internet, requiring a Micro SD card (**up to 128GB, NOT INCLUDED**) for recording and storage—optional if video and image storage isn't needed.

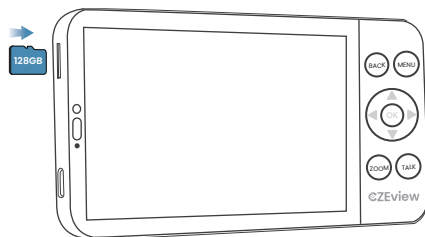

• APP MONITORING

Remote monitoring is enabled through an app, also necessitating a Micro SD card (**up to 128GB, NOT INCLUDED**) for storing videos and playing lullabies. Using an SD card is optional unless utilizing the specified feature. Alternatively, for video storage, consider subscribing to a cloud storage plan.

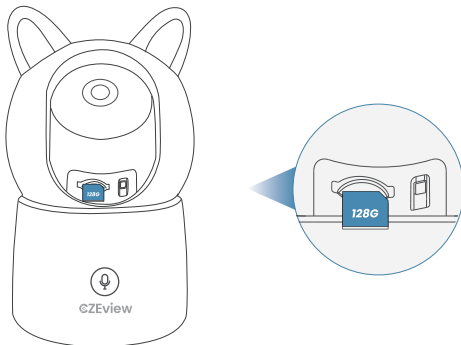

CONNECTING THE CAMERA TO THE MONITOR

To ensure a seamless setup, please observe the following guidelines before beginning:

- Ensure the monitor is fully charged prior to initial use.
- Maintain a distance of at least 1.5 meters (**approximately 4.9 feet**) between the monitor and camera to prevent microphone feedback.
- For successful pairing, the camera and monitor should not be more than 200 meters (**approximately 656 feet**) apart.

Power on the camera.

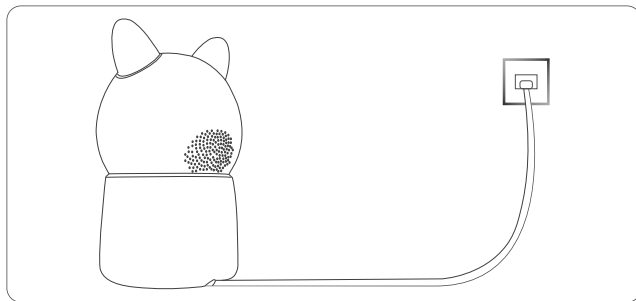

Press and hold the ON/OFF button on the monitor for three seconds to turn it on.

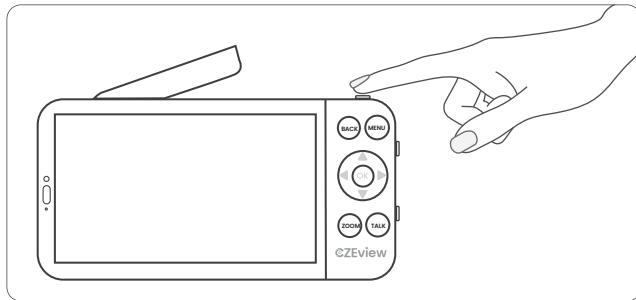

For optimal reception, fully extend the monitor's antenna.

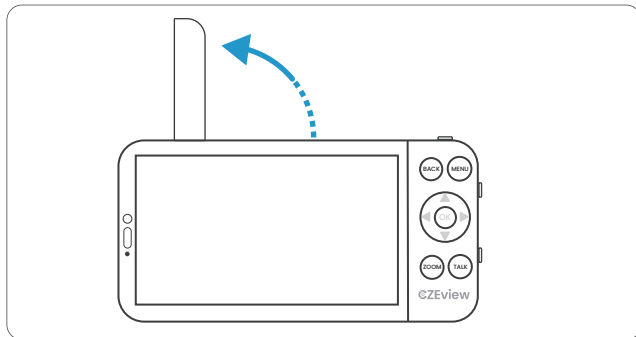

The camera will then automatically initiate and complete the connection process with the monitor.

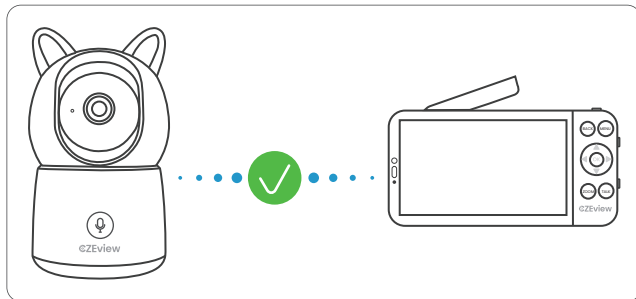

! Note:

If the camera fails to connect automatically, manually establish the connection as follows:

1. On the monitor, press the 'Menu' button (MENU).
2. Go to 'Settings' (gear icon) > 'Camera' (camera icon).
3. Under 'Camera Management,' choose 'Camera 1' or 'Camera 2' to pair.
4. Press and hold the 'Voice Call' button (microphone icon) on the camera until you hear a 'cuckoo' sound.
5. Press 'OK' (OK button) on the monitor to complete the connection.

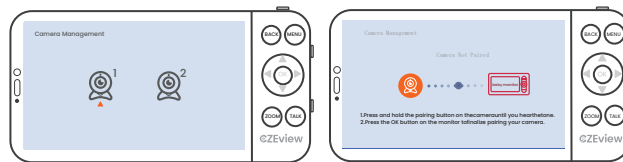

6. A solid blue indicator light on the camera and a success message on the monitor will confirm the connection.

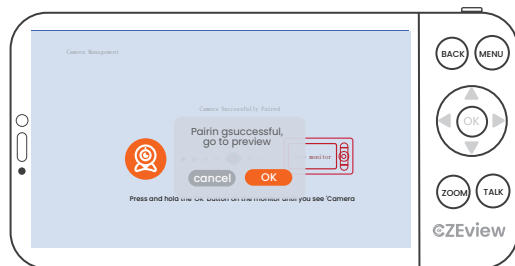

UNBINDING THE CAMERA FROM THE MONITOR

- On the monitor, press the 'Menu' button (MENU).
- Navigate to 'Settings' ⚙️ > 'Camera' (📷).
- In 'Camera Management', select either 'Camera 1' or 'Camera 2' that you wish to unbind.

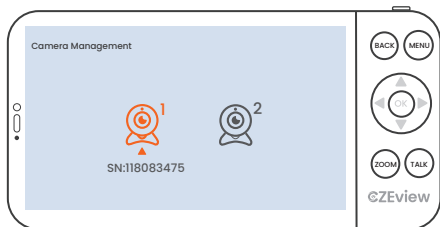

- Press and hold the 'OK' button on the monitor until you see 'Camera Not Paired' on the screen.

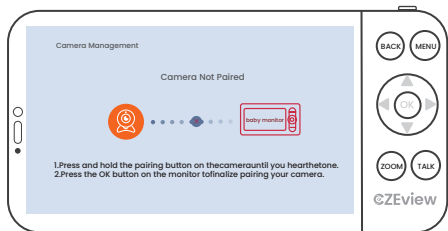

After unbinding, if the camera was not previously connected to the app, it will perform a pan/tilt check after 15 seconds, and its indicator light will start to flash red slowly. If it was already connected to the app, the camera will remain stationary, and the indicator light will stay solid blue.

! Note:

If you wish to reconnect the camera with the monitor, please follow the steps outlined in 'CONNECTING THE CAMERA TO THE MONITOR'.

CAMERA SELECTION METHOD (FOR DUAL-CAMERA BABY MONITORS ONLY)

The Dual-Camera Baby Monitor supports simultaneous live viewing from both cameras. To zoom in or out on a specific camera, it's necessary to select that camera first.

From the home screen, use the Zoom button (ZOOM) to alternate between Camera 1 and Camera 2 views.



To zoom, select the desired camera by pressing the 'OK' button (OK) on the monitor. This action switches the view to full-screen mode for the selected camera, enabling the zoom function.

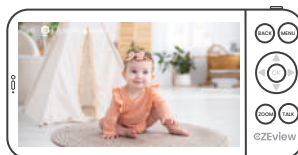

! Note:

To exit full-screen viewing mode and return to dual-screen mode, press the back button.



NIGHT VISION

When the camera lens is obstructed or there are obstructions near the lens, it can cause the night vision image to be blurry and whitened. Please use the pan/tilt function to adjust the direction of the camera until the quality of the night vision image returns to normal.



SAFETY PROTECTION

Adjust the Wi-Fi network channel for your privacy needs by turning it ON or OFF.

Press 'Menu'  on the monitor and select  > 'Safety Protection' .

- Disable the Wi-Fi network channel to keep live view videos private and inaccessible through the network.
- Once enabled, remotely monitor your baby and enjoy additional features offered by the APP. Access all visit records securely protected at home with AES 256-bit data encryption.

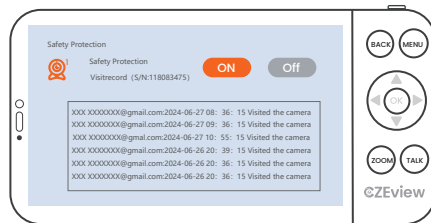

SET UP THE SYSTEM

• DOWNLOAD APP

Download 'CZEView' from the App store (ios) or coogle Play (Android) or scan the QR code below.



• REGISTER AND LOG IN TO YOUR ACCOUNT.

Launch the app, register an account with a valid email address at your first use, then log in.

Note:

1. Please allow the app access to your WLAN & Cellular Data for a successful connection;
2. Please allow the app to access push messages for detection notifications.

SET UP THE CAMERA ON THE APP

EN

• Before starting, please note:

1. Ensure the camera is on and press the 'RESET' button for 5 seconds until the indicator light flashes red, signaling it's ready for WiFi connection.
2. The monitor will be offline during WiFi setup, resuming once the app connects to the camera successfully.
3. Confirm 'CZView' app is downloaded.
4. Select the correct device type and model when adding a device.
5. Check for a stable network and keep the camera and mobile device close to the router during setup.
6. Please enter the correct password according to the instruction manual, ensuring it contains between 8 and 32 characters for a seamless Wi-Fi connection.
7. Avoid using emojis, special characters, or symbols in your WiFi name and password. Public networks (like in apartments, subways, airports, hotels, etc.) are not recommended.
8. Networks requiring web authentication are not supported.
9. WiFi networks with hidden hotspot names are not supported; ensure your hotspot name is visible.
10. VPNs or Proxy Servers are not compatible.

I. METHOD 1 CONNECT VIA BLUETOOTH ENABLED (RECOMMENDED)

! Note:

Please allow the app to access your Bluetooth and Location services to guarantee a successful connection.

1. On the Home page, select 'Scan Code' in the upper right corner to add a device. Then, tap 'Start Scanning' and align the camera with the QR code located on the camera body sticker.

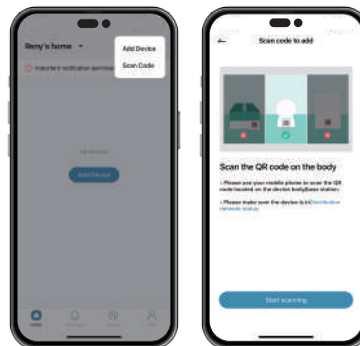

Video Monitor

Model:BM6

SN:XXXXXXXX

Input:5V 1A

Made in China

FCC ID: 2AZL7-ZY-BB1

Service Mail:support@czeview.net



2. The camera to be connected will appear. Tap 'Enter Configuration' to proceed.

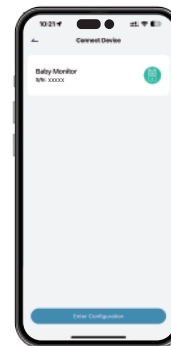

EN

3. Follow the on-screen instructions to complete the subsequent steps.

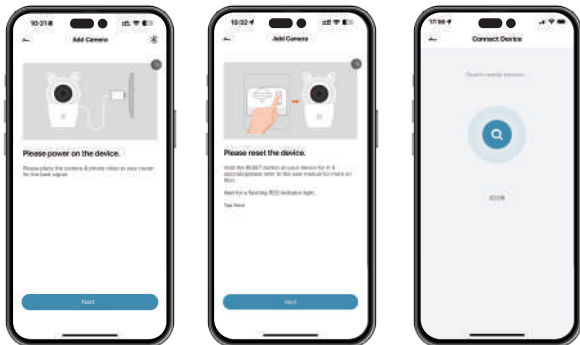

4. Select the same WiFi network your phone is connected to and enter the correct password.

5. Grant the app permission to access your Location.

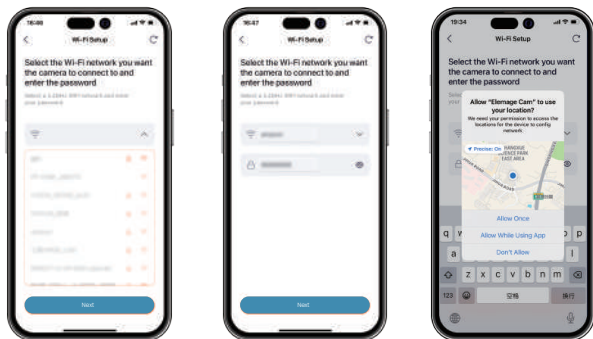

6. Wait to hear a 'cuckoo' sound, signaling the start of the connection process. Then, ensure that the indicator light changes to a steady blue, which signifies the setup has been successful. Afterward, press 'Next' to assign a name to your camera.

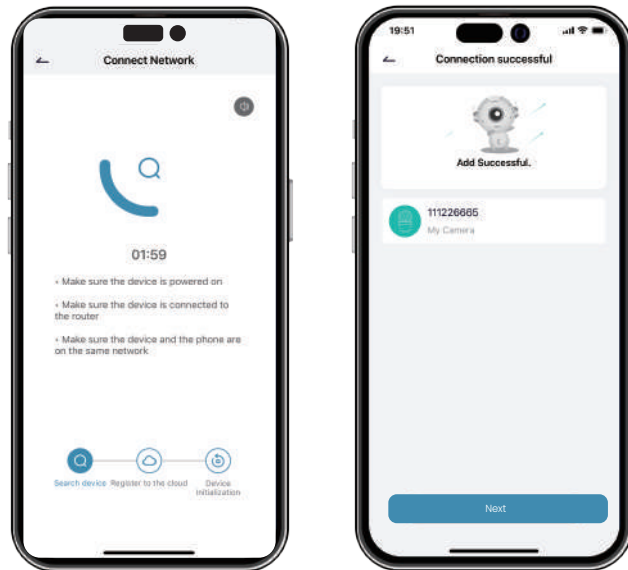

! Caution:

During the Wi-Fi setup, if the app displays a page indicating a connection failure, tap 'Re-add' in the upper left corner. Then, press and hold the 'Reset' button until you hear a 'cuckoo' sound. Ensure the indicator light changes to slow red flashes. Follow the instructions in the 'METHOD 1: CONNECT VIA BLUETOOTH ENABLED (RECOMMENDED)' section to re-add the camera to the app. Alternatively, tap the 'Other Methods' button to try a different method as outlined in 'METHOD 2: SCAN QR CODE', which is detailed in the 'IMPORTANT TIPS' section for further guidance.

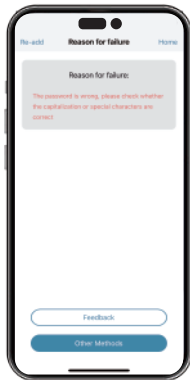

IMPORTANT TIPS

For detailed instructions on 'MONITOR FUNCTION', 'SETTING UP THE CAMERA ON THE APP', 'INSTALLING THE CAMERA', 'CONTROLLING THE CAMERA WITH ALEXA', 'APP FUNCTIONS', and 'TROUBLESHOOTING', please scan the QR code provided below.



NOTICE FCC Statement:

This device complies with Part 15 of the FCC Rules. Operation is subject to the following two conditions: (1) This device may not cause harmful interference, and (2) this device must accept any interference received, including interference that may cause undesired operation.

! Note:

This equipment has been tested and found to comply with the limits for a Class B digital device, pursuant to Part 15 of the FCC Rules. These limits are designed to provide reasonable protection against harmful interference in a residential installation. This equipment generates, uses, and can radiate radio frequency energy and, if not installed and used in accordance with the instructions, may cause harmful interference to radio communications. However, there is no guarantee that interference will not occur in a particular installation. If this equipment does cause harmful interference to radio or television reception, which can be determined by turning the equipment off and on, the user is encouraged to try to correct the interference by one or more of the following measures:

- Reorient or relocate the receiving antenna.
- Increase the separation between the equipment and receiver.
- Connect the equipment into an outlet on a circuit different from that to which the receiver is connected.
- Consult the dealer or an experienced radio/TV technician for help.

Changes or modifications not expressly approved by the party responsible for compliance could void the user's authority to operate the equipment.

RF Exposure Statement:

To maintain compliance with FCC RF exposure guidelines, this equipment should be installed and operated with a minimum distance of 20 cm between the radiator and your body. This device and its antenna(s) must not be co-located or operating in conjunction with any other antenna or transmitter.