

ACTIVESHOP[®]

INSTRUCTIONS FOR USE

Ultrasonic cleaner ACD-7920



Importer:

ACTIVESHOP Ltd.
8b Graniczna St., building
DC2A 54-610 Wrocław,
Poland
www.activeshop.com.pl
Rev. A/04/2024



Technical data:

Voltage	220 - 240 V 50Hz
Power	55 W
Vibration frequency	42 kHz
Dimensions	20.3 x 18.3 x 14.5 cm
Dimensions of the tank	14.8 x 12.6 x 4.7 cm
Tank capacity	850 ml
Minimum fluid level	400 ml
Maximum fluid level	700 ml
Weight	1.09 kg
Timer switch	90 - 600 s

- Disconnect the unit before filling. Do not exceed the "MAX" line to avoid overfilling.
- Do not fill the tank with abrasive or corrosive chemicals. It may cause it to leak and eventually destroy it.
- Do not use the washer if the cable or plug is damaged. If damaged, contact a service center for inspection and repair.
Store the washer in a safe, dry and non-sunny place
washer should never be left unattended while plugged in.
- Do not use while bathing.
- Disconnect the washer from the power source after use.
- Do not immerse the washer in water to avoid electrocution through the spot on the washer indicated by the arrow.

Washer construction and accessories:

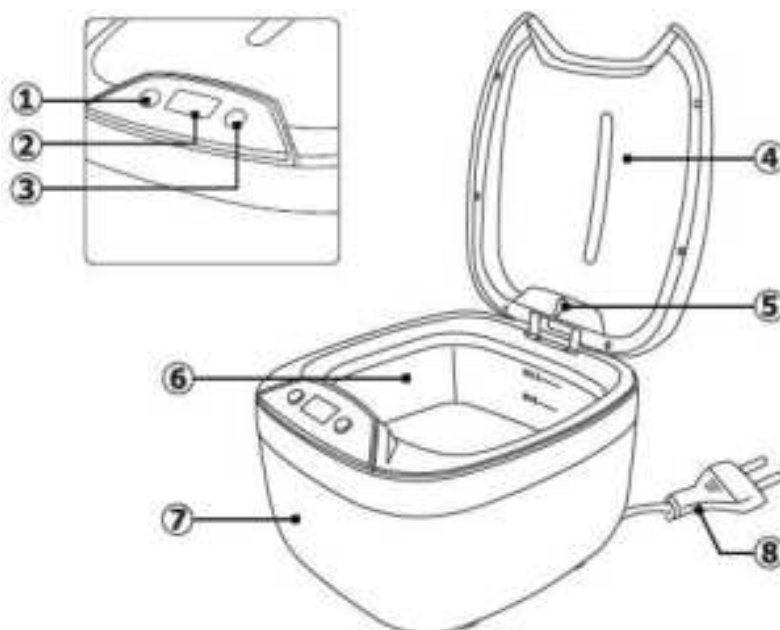

1. On/Off button
2. Display
3. Time change button

4. Lid
5. LED light
6. Tank

7. Housing
8. Power cable

Accessories (optional)



CD stand



Watch stand

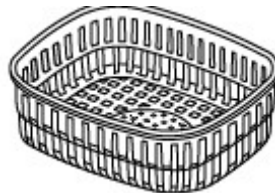

Basket

STORAGE AND HANDLING



1. Do not turn on the washer without water inside. Turning on the washer without water can damage the washer.
2. Do not overload the washer with continuous operation. After 30 minutes of continuous operation, let the washer rest for another 10 minutes.
3. Do not leave water in the washer permanently. You should pour the water or solution out of the washer after use. Leaving water or solution in the washer for a long time can damage it.
4. Take care of the outside of the washer. Wipe off any residual water or solution immediately. Use a damp towel to clean the washer. Wipe dry after washing.

INSTRUCTIONS FOR USE

1. Remove the lid. Put the products into the basket and then into the tank of the washer. For sharp objects that can damage the washer, be sure to use a basket. Remember also that the basket absorbs 30-40% of the ultrasonic energy of the washer.
2. Fill the tank with water. The water must cover the objects to be cleaned, but must not exceed the maximum liquid level.
3. Put the lid on, and then connect the washer to the power supply. The display will show 180. This is the default washing time with the washer.
4. Set the selected time with the time setting key. Possible selection 180s, 300s, 480s, 600s, 90s.

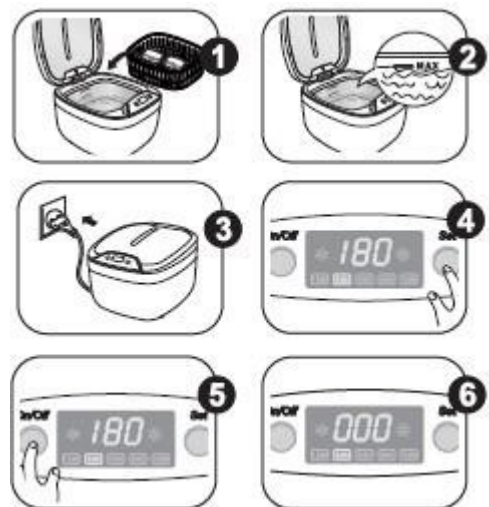

5. Turn on the washer with the switch. The cleaning process will start. The time will count down to 0.
6. When zero appears on the display, the washer will automatically stop working.
7. If you want to finish cleaning ahead of time, press the switch. If you need to repeat the cycle or increase the cleaning time, press the set button time, select the appropriate time and press the switch to the device.
8. When you have finished working, unplug the device from the power supply. Open the lid and pull out the cleaned items.
9. Pour out the remaining water and wipe the device dry.
10. Store the device in a dry and cool place.



CLEANING METHODS



Ordinary washing

Use water according to the instructions for use. Pour out the water when you are done



Washing in solution

Prepare the cleaning solution according to the manufacturer's recommendations. Be careful not to exceed the concentration of the solution. This can damage the seals in the washer, resulting in the risk of flooding electronic components. When you are finished, fill the washer with water, turn it on for 90 seconds, and then pour the residue out of the washer. This will prevent the washer from being damaged by prolonged contact with chemicals.



Washing in batches

For longer items that do not fit all the way into the washer, it is recommended to wash them in batches. To do this, place one side of the item in the water or cleaning solution first, and then rotate the item so that the other side of the item is in the water.

INSTRUCTIONS FOR USE OF OPTIONAL ACCESSORIES



Basket

The basket will work best for cleaning small items. Place the items in the basket, and then insert it into the tank of the washer. Try to make sure that the items do not come into contact with each other.



Watch stand

Use a stand to keep the watch above the surface of the water when cleaning the bracelet.



CD rack

Use the rack when cleaning CDs/DVDs. There can be 2 discs on the rack at the same time.

PRODUCTS NOT SUITABLE FOR WASHING IN AN ULTRASONIC CLEANER

- Delicate jewelry (pearls, emerald, ivory items, beads, seashells, agate).
- Welded, coated and glued components
- Other things such as wood, coated glass, ceramic products, camera filters.

SECURITY MEASURES

1. The device is a professional equipment for use in beauty parlors. Operation of the device only by qualified cosmetic personnel allows to avoid undesirable consequences during the treatment.
2. Do not disassemble the device or attempt to use it for purposes other than those indicated in this manual. All servicing and repairs must be performed only by an authorized service technician (ACTIVESHOP Ltd. company).
3. Do not install or operate the device near liquids, wet places or with wet hands - so that no liquids get into the device.
4. Immediately remove the plug from the outlet and contact the authorized service provided by ACTIVESHOP Ltd. in the following cases:
 - a) liquid has entered the device, b) the device emits a strange odor, smoke or makes strange sounds, (c) the power cord was damaged, (d) the device was knocked over or its housing was damaged.
5. Do not put any objects on the cables. Do not install the unit where someone may step on the power cord.
6. For safety purposes, unplug the power cord from the outlet each time you finish working with the device.

7. Do not insert anything into the opening of the device. If a foreign object gets into the hole, remove the cord from the outlet and contact the distributor or manufacturer.
8. Do not place the device on an unstable cart, shelf or vehicle. If dropped, the device may be damaged.
9. In order to guarantee the established useful life of the device, it is recommended to keep an interval of one minute before pressing the power button again (between switching on and off and vice versa).
10. The power supply must comply with the specifications on the nameplate. Otherwise, there is a risk of incorrect operation of the device its damage or even burning.

NOTES:

1. In case of damage to the power cord or other malfunctions, contact an authorized service center - this will avoid danger.
2. This equipment may be used by children at least 8 years of age and by persons with impaired physical and mental capabilities and persons with inexperience and lack of familiarity with the equipment, if supervision or instruction is provided regarding the use of the equipment in a safe manner so that the associated risks are understood.
3. The device is not intended for play by children. Do not allow children to play with the device.
4. Do not leave the device unattended when children or persons without sufficient knowledge of how to use the device are in the vicinity.
5. This electrical appliance is not a toy. Improper use or contact with the electrical appliance may pose a health risk or lead to death, so use and store the appliance out of the reach of children.



DISPOSAL OF THE DEVICE

Dispose of used electrical appliances, fixtures and packaging to raw material reprocessing centers in accordance with environmental protection principles. Electrical appliances should not be disposed of in household waste containers. Follow the rules for discarding this type of equipment. In order to protect the environment in accordance with Directive 2012/19/EC

Concerning waste electrical and electronic equipment, waste electrical equipment should be collected separately and then handed over to waste equipment collection centers electronic and electrical.

At the end of their useful life, as well as old appliances contain full-value recyclable components, so they should be handed over for recycling. Therefore, they should be handed over to appropriate collection points, as well as they can also be handed over to ACTIVESHOP Ltd.

STORAGE AND TRANSPORT

The device should be transported at a temperature in the range of (-) 20 °C to (+) 50 °C only in its original packaging. Store the device in a well-ventilated and relative humidity of no more than 75%. Operating temperature from (+) 10 °C to (+) 40 °C. During storage and transportation processes, the device must not be thrown or dropped, exposed to mechanical shocks or atmospheric agents.