

INSTRUCTION MANUAL

Redkey P9

Vacuum Cleaner

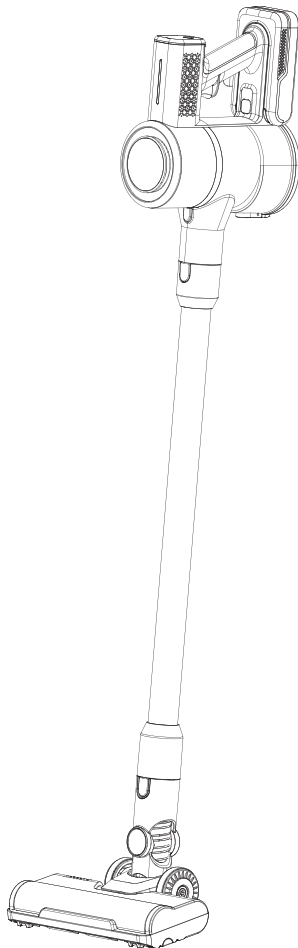

- English

SAFETY INSTRUCTION

1. Read this instruction booklet carefully.
2. This appliance is for domestic use only. Use as described in this instruction booklet.
3. Before using this appliance, check that the mains power voltage corresponds to the voltage shown on the rating plate.
4. Do not use the appliance to vacuum all the latter things:
 - Water and other liquids
 - Lighted stub, hot ashes and other combustible things
 - Sharp matter
 - Wood pieces, gesso, cement, calcimine and other tiny granules
 - Keep the vacuum cleaner away from stoves and heat-emitting appliance. Heat can deform and discolor the plastic parts of unit.
 - Always remove the plug from the power socket when the appliance is not in charging.
 - Never use spirits or other solvents to clean the appliance.
 - Never leave the appliance unattended when it is switched on. Keep the appliance out of the reach of children or the infirm.
 - Do not switch the appliance on if it appears to be faulty in any way.
 - The battery must be removed from the appliance before it is scrapped.
 - The battery is to be disposed of safely.
 - The appliance must be disconnected from the supply when removing the battery.
 - Never use spirits or other solvents to clean the appliance.
 - Do not put any object into openings. Do not use with any opening blocked; keep free of dust, lint, hair and anything that may reduce air flow.
 - Keep hair, loose clothing, fingers, and all parts of body away from openings and moving parts.
 - Only the adapter provided by the manufacturer can be used.
 - This appliance can be used by children aged from 8 years and above and persons with reduced physical, sensory or mental capabilities or lack of experience and knowledge if they have been given supervision or instruction concerning use of the appliance in a safe way and understand the hazards involved.

PARTS DESCRIPTION

1. Wall mount	5. Aluminum tube
2. Main unit	6. Motorized Floor brush
3. Crevice tool	7. Charger
4. 2 in 1 upholstery brush	8. Mini Motorized brush (Option)

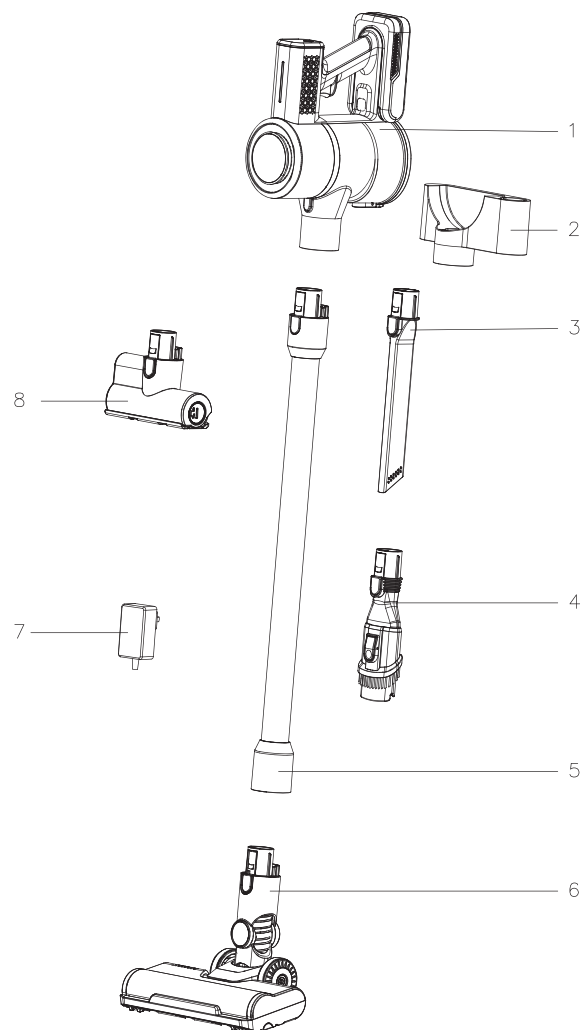

SAFETY INSTRUCTION

Tips

Before using the Cordless Vacuum cleaner for the first time, clean it with a soft, damp cloth and dry thoroughly. Do not immerse the Cordless Vacuum cleaner in water or any other liquid.

Assembling the Cordless Vacuum cleaner and Tools

Assembling the aluminum tube

Fit the tube onto the main body's air inlet until it clicks into the position, Fig 1. If need to remove the tube, hold the main body, press the release knob and remove the tube

Assembling the motorized floor brush

Fit the electrical floor brush on the tube until it click into the position, Fig 2. If need to remove the electrical floor brush, hold the aluminum tube, press the floor brush release knob and remove the brush from the tube.

Assembling the crevice tool

Fit the accessory on the main body's air inlet and/or on the tube until it clicks into the position. Fig 3. The 2 in 1 brush is good for cleaning stairs, corners, and hard-reach areas.

Assembling the 2 in 1 brush

Fit the accessory on the main body's air inlet and/or on the tube until it clicks into the position. Fig 4. The 2 in 1 brush is good for cleaning stairs, Corners and furniture etc.

Assembling the min motorized brush

Fit the accessory on the main body's air inlet and/or on the tube until it clicks into the position. Fig 5. The Mini motorized brush is good for cleaning sofa, curtain, bedding, and rugs etc.

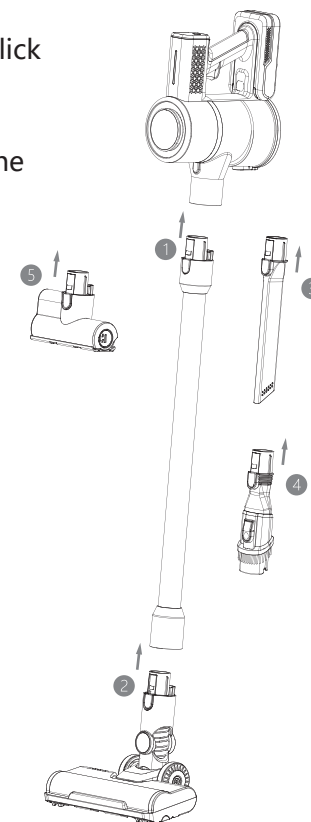

Operating the Cordless Vacuum Cleaner

Before first time use, ensure the vacuum cleaner has been charged 4-4.5hours. Turn on the Cordless vacuum cleaner by pressing the ON/OFF button.

NOTES: Battery indicator light represents battery capacity and will illuminate during use.

WARNINGS: Do not use the Cordless Vacuum cleaner without the removable filter nor dust bin present.

How to Charge the Product

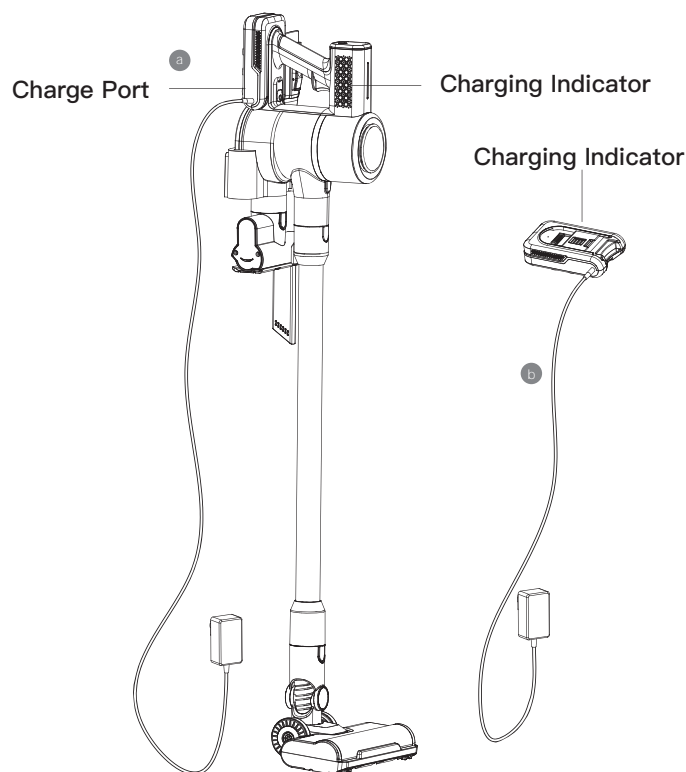

1. Turn off the Cordless vacuum cleaner.
2. Connect the adapter to the charging port on the main unit(a) or either you may charge battery pack individually(b)

3. Plug the adapter into the main power supply at either way At mode(a), the battery indicator will flash. Once the battery fully charged, the battery indicator lights will stay on. At mode(b), the battery indicator will flash with red light. Once the battery fully charged, the battery indicator will stay on with green light.

WARNING: Do not use any mains power adaptor other than that supplied, as using an alternative will increase the risk of injury and/or damage to main product.

How to operate the Product

TIPS: The appliance provides two speed option to enable multi cleaning. Suggest to use maximum power for massive dust or studied stains and use minimum power for fine dust or relative clean surfaces.

1. Power/Charge indicator
 - a) During working process, the light gives the indication of power level remained. 4 lights on when full charged and gradually reduce to 3 lights, 2 lights and 1 lights with ongoing power consumption.
 - b) During charging process, the light gives the indication of charging level. 1 light starts blink and stays on when it is well charged, then 2nd light, 3rd light and all 4 lights stay on when it is fully charged.
2. Roller Snap, the appliance will give warning when the floor brush is snapped or blocked by particle and the floor brush will stop after few seconds. Stop the appliance immediately and restart the appliance after blockage is removed.
3. Power level indication, the light for select level will be on when it is selected.

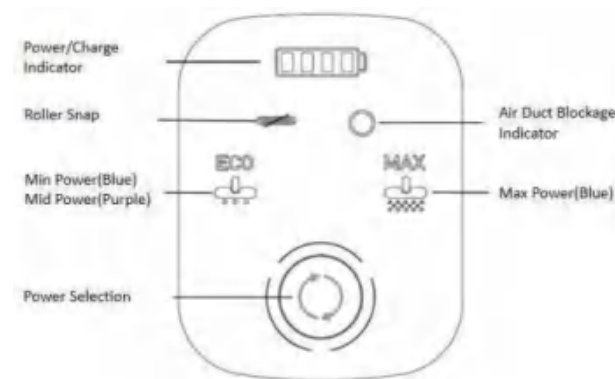

4. Power selection, press power selection button to select the min or max power subject to your needs.
5. When the air duct blockage indicator is always on, it indicates that the air inlet channel of the vacuum cleaner is blocked by foreign matters, prompting the user to clean the channel or clear the air inlet filter element

CARE AND MAINTENANCE

How to Clean the Inlet/Outlet Filters

1. Turn off the cordless vacuum cleaner
2. Press release button, the bottom late will drop down automatically, Fig 1.
3. Pull inlet HEPA filter downwards to remove the filter and put it back at counter way after cleaning, Fig.2.
4. Rotate the filter cap at anticlockwise direction to remove the cap and lift the outlet HEPA filter upwards to remove the fitter; put the filter back at counter way after cleaning, Fig. 3.

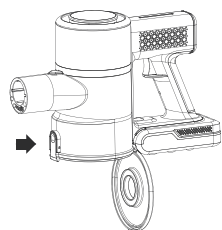

Fig 1.

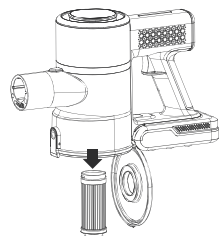

Fig 2.

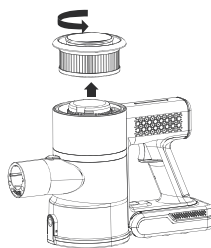

Fig 3.

5. Clean filters by slapping or washing with water wait for it to dry completely and naturally. Fig. 4.

6. Put the filters back into the dust cup carefully and after complete dry, Fig 4.



Fig 4.

How to Remove the Dust Cup and Preliminary Filter

TIPS: For deep cleaning, suggest to clean the dust cup and preliminary filter at certain frequency.

3. After dust cup is removed, hold the preliminary filter and turn it at anticlockwise direction to remove the preliminary filter, Fig. 2.

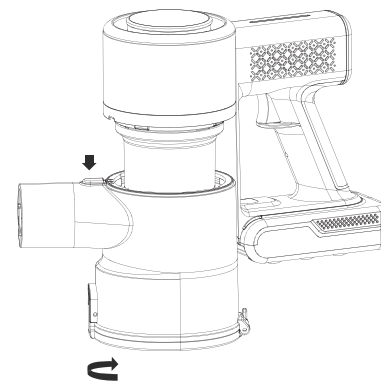

Fig 1.

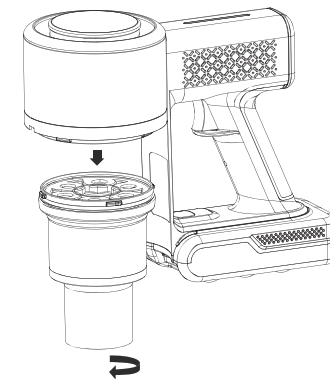

Fig 2.

4. Clean dust cup and preliminary filter by slapping or washing with water, wait for it to dry completely and naturally.
5. Put the preliminary filter back at counter way and make sure it is locked into position, Fig 1.
6. Put the dust cup at counter way and make sure it is locked into position with "click" sound is heard, Fig. 2.

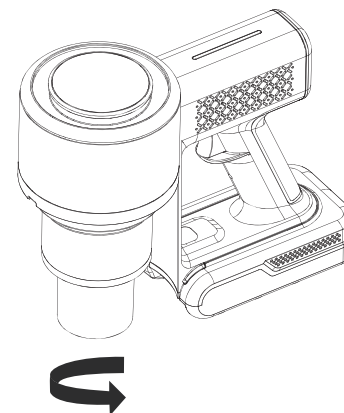

Fig 1.

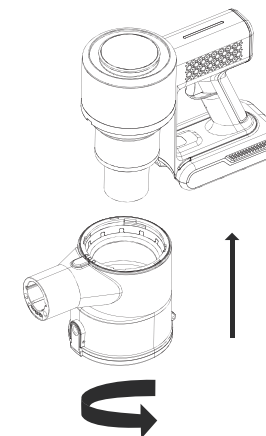

Fig 2.

How to Clean the Dust Cup

Without removing the dust cup, Press the dust cup release button directly, Then drop the dust into waste container, Fig 1.

Or you can remove the dust cup and Press the dust cup release button directly, Then drop the dust into waste container, Fig 2.



Fig 1.

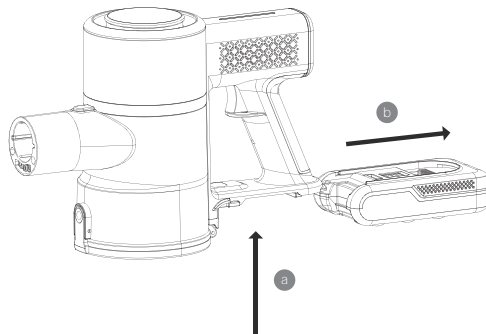

Fig 2.

How to Remove the Battery Pack

TIPS: The battery pack is detachable from main unit which be removed out for either individual charging or order extra one for replacement.

1. Turn off the cordless vacuum cleaner
2. Press the release button as indicated Fig (a) and pull out the battery pack backwards to remove from main unit Fig(b).
3. Put it back at counter way and make sure it is locked into position securely with "click" sound heard.



How to Clean Floor Brush

TIPS: Suggest to clean the brush frequently to ensure the pickup performance or damages caused by hair/cloth/big particles snapping.

1. Remove the floor brush from main appliance as described at previous chapter _Assembling the Cordless Vacuum cleaner and Tools
2. Push the release button per arrow direction(a)
3. Lift the arm to the side(b) 4. Move out the roller by pulling upwards(c)

Floor brush cleaning:



How to Clean Mini Motorized Brush

TIPS: Suggest to clean the mini motorized brush frequently to ensure the pickup performance or damages caused by hair/cloth/big particles snapping.

1. Remove the min motorized brush from main appliance when necessary.
2. Turn the cap clockwise by using a tool or a coin to move out the cap(a)
3. Move the roller out at the direction as per arrow(b)
4. Put it back at counter way and make sure the cap is locked into position securely

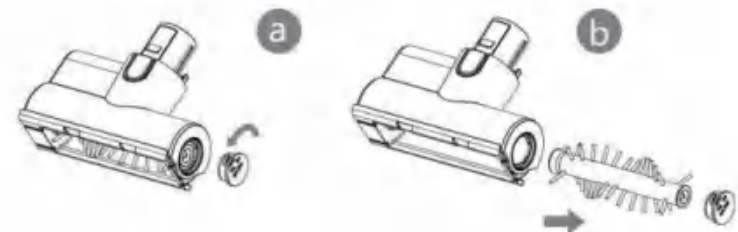

How to Store the Appliance

TIPS: After usages, suggest to store your appliance at safe places, away from hot or wet area or fire.

1. Disconnect the appliance from main power supply.
2. Empty the dust cup and clean the filters.
3. Store your appliance on wall mount and make sure it stays firmly.

TECHNICAL SPECIFICATION

Product Name	Cordless Vacuum cleaner
Model No	P9
Voltage	25.9V
Power	350W
Vacuum	30Kpa(max)
Charger input	100-240Vac 50/60Hz 0.4A
Charger output	30VDC 0.58A/0.6A
Dust capacity	600 ml
House material	ABS/PC
Product Size	1100x250x204mm

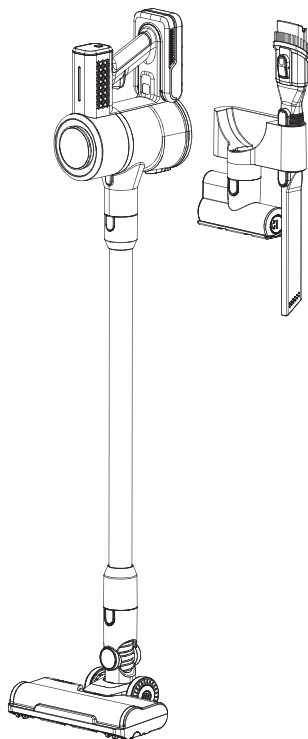

BATTERY REMOVAL AND DISPOSAL

Take your cordless vacuum cleaner at the end of the lifetime is not fit in the trash as it fitted with a Li-ion battery, it needs to be disposed in an environmentally friendly way.

Discarded batteries are non-environmentally friendly and disposed of it in accordance with applicable regulations.

- Discharge the battery by running the appliance to stop the engine at idle.
- Remove the battery pack from the appliance.
- Dispose of the battery to a collection of chemical waste.

TROUBLE SHOOTING

SYMPTOM	ROOT CAUSE	SOLUTION
Floor brush doesn' t work	<ol style="list-style-type: none">1. The brush is wrapped with long hair or other long fabrics stuff.2. The roller doesn' t put into position nor assembly correctly.	<ol style="list-style-type: none">1. Clean up the obstacle.2. Reassembly the roller in correct way
Motor doesn' t work	<ol style="list-style-type: none">1. Lower battery power.2. Overheat due to long time of operation.	<ol style="list-style-type: none">1. Charge the appliance.2. Restart the appliance after cooling down.
Suction gets weak	<ol style="list-style-type: none">1. Filters are blocked by dust2. Air channel in floor brush is blocked or the roller is snapped.3. The preliminary filter/metal mesh is blocked by paper chips or plush fiber.4. Air channel between dust cup and main appliance is blocked.	<ol style="list-style-type: none">1. Clean or replace filters.2. Clean up the obstacle.3. Check and clean the preliminary filter/metal mesh frequently.4. Clean up the obstacle.
Charging indicator doesn' t work nor blink	<ol style="list-style-type: none">1. Charger is not well connected.2. Battery is overheated.	<ol style="list-style-type: none">1. Check the charger if it is well connected to main power supply.2. Try to recharge after cooling down

WARRANTY INFORMATION

The warranty will not apply in cases of: The manufacturer provides warranty in accordance with the legislation of the customer's own country of residence, within 1 year, starting from the date on which the appliance is sold to the end user. The warranty only covers defects in material or workmanship. The repairs under warranty may only be carried out by an authorized service centre. When making a claim under the warranty, the original bill of purchase (with purchase date) must be submitted.

- Normal wear and tear
- Incorrect use, e.g. overloading of the appliance, use of non-approved accessories
- Use of force, damage caused by external influences
- Damage caused by non-observance of the user manual, e.g. connection to an unsuitable mains supply or non-compliance with the installation instructions
- Partially or completely dismantled appliances

CORRECT DISPOSAL OF THE PRODUCT

This marking indicates that this product should not be disposed with other household wastes throughout the EU. To prevent possible harm to the environment or human health from uncontrolled waste disposal, recycle it responsibly to promote the sustainable reuse of material resources. To return your used device, please use the return and collection systems or contact the retailer where the product was purchased. They can take this product for environmental safe recycling

