

**Industrial Wall-mount Managed Gigabit  
Ethernet Switch**

**WGS-4215-8P2X/WGS-4215-8P2XV**

Quick Installation Guide

# Table of Contents

1. Package Contents .....	3
2. Requirements .....	4
3. Wiring the Power Inputs.....	5
3.1 Terminal Block Connector Pinout .....	6
3.2 Wiring Completed in Three Steps .....	7
3.3 Wiring the Alarm Contact .....	8
4. Hardware Installation .....	9
4.1 Wall-mount Installation.....	9
4.1.1 WGS-4215-8P2X/WGS-4215-8P2XV .....	9
4.2 Wall Hanging Installation .....	10
4.2.1 WGS-4215-8P2X/WGS-4215-8P2XV .....	10
4.3 Magnet Installation .....	12
4.3.1 Magnet Installation of WGS-4215-8P2X/WGS-4215-8P2XV .....	12
5. Web Login.....	13
5.1 Starting Web Management.....	13
5.2 Saving Configuration via the Web.....	17
6. SSH Login.....	18
6.1 Configuring IP Address .....	19
6.2 Storing the Current Switch Configuration .....	20
7. LCD Touch Screen (WGS-4215-8P2XV only) .....	21
8. Recovering Back to Default Configuration.....	23
9. Customer Support .....	24





# 1. Package Contents

Thank you for purchasing PLANET Industrial Wall-mount Managed Gigabit Switch, WGS-4215 series. The table below shows the models with the number of ports:

Model Name	Copper Port	Fiber Port	LCD Screen
WGS-4215-8P2X	8 x 10/100/1000T	2 x 10G	-
WGS-4215-8P2XV	8 x 10/100/1000T	2 x 10G	2.4-inch TFT

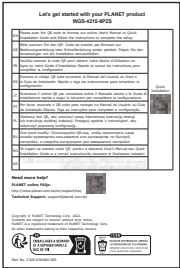
In the following section, unless specified, the term **“Wall-mount Managed Switch”** mentioned in this quick installation guide refers to the above models.

Open the box of the Wall-mount Managed Switch and carefully unpack it. The box should contain the following items:

The Wall-mount Managed Switch x 1	QR Code Sheet x 1 pc	Wall-mounted Kit x 1 set
 (Vary on the model)		
SFP Dust Cap x 2 pcs	Magnet Kit x 1 set	2-pin Terminal Block Connector x 1 pc
		

If any item is found missing or damaged, please contact your local reseller for replacement.

## 2. Requirements

- **Workstations** running Windows 7/8/10/11, macOS 10.12 or later, Linux Kernel 2.6.18 or later, or other modern operating systems are compatible with TCP/IP Protocols.
- Workstations are installed with **Ethernet NIC** (Network Interface Card).
- **Ethernet Port Connection**
  - Network cables -- Use standard network (UTP) cables with RJ45 connectors.
  - The above PC is installed with **Web browser**.



Note

It is recommended to use Google Chrome, Microsoft Edge or Firefox to access the Wall-mount Managed Switch. If the Web interface of the Wall-mount Managed Switch is not accessible, please turn off the anti-virus software or firewall and then try it again.

- The Workstations above have been installed with SSH and telnet client software, such as Tera Term or PuTTY.
- **A Flat-blade Screwdriver**

The screwdriver is to facilitate power cable connection to the WGS-4215-8P2X and WGS-4215-8P2XV.

### 3. Wiring the Power Inputs

The Wall-mount Managed Switch features a strong dual power input system (terminal block) incorporated into customer's automation network to enhance system reliability and uptime.

Model	Power Input Range	4-pin Spring Terminal Block
WGS-4215-8P2X		48~54V DC
WGS-4215-8P2XV		48~54V DC



Note

Maximum power requirements also rely on the real site application.

#### WGS-4215-8P2X

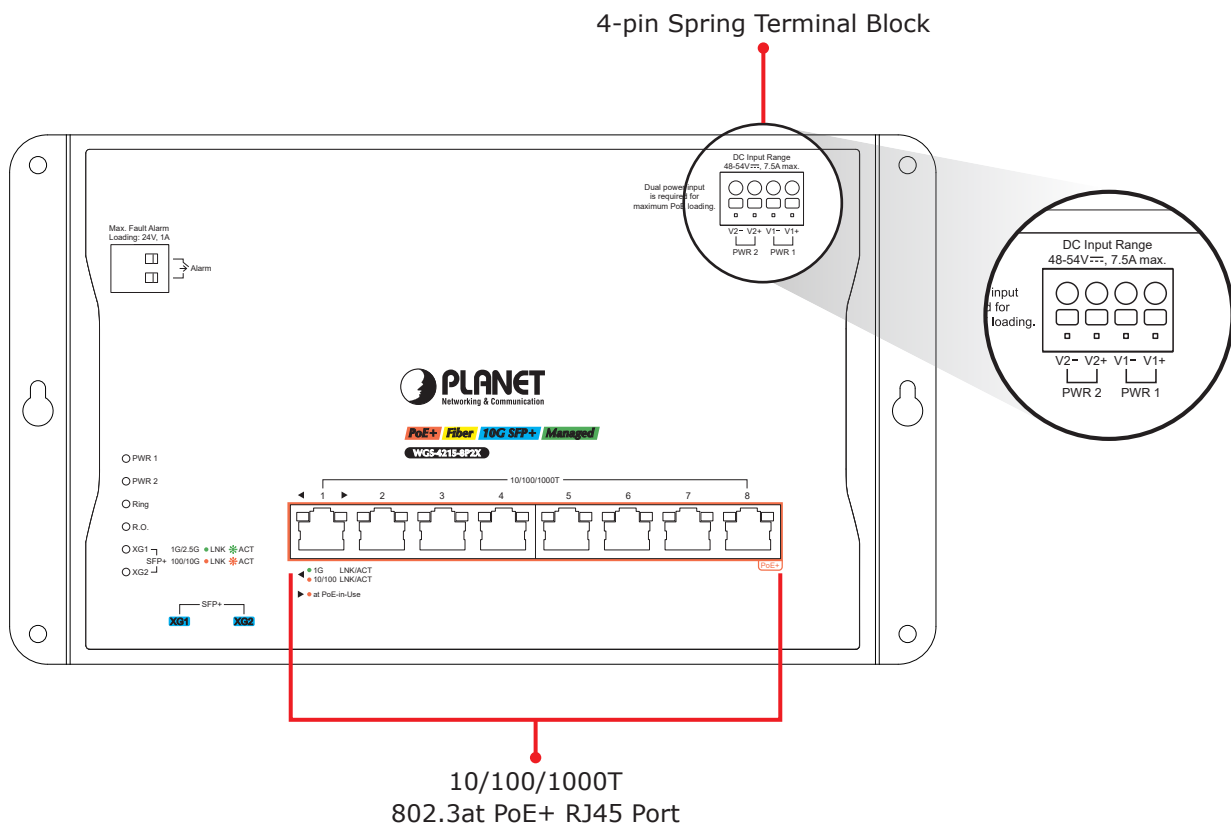

## WGS-4215-8P2XV

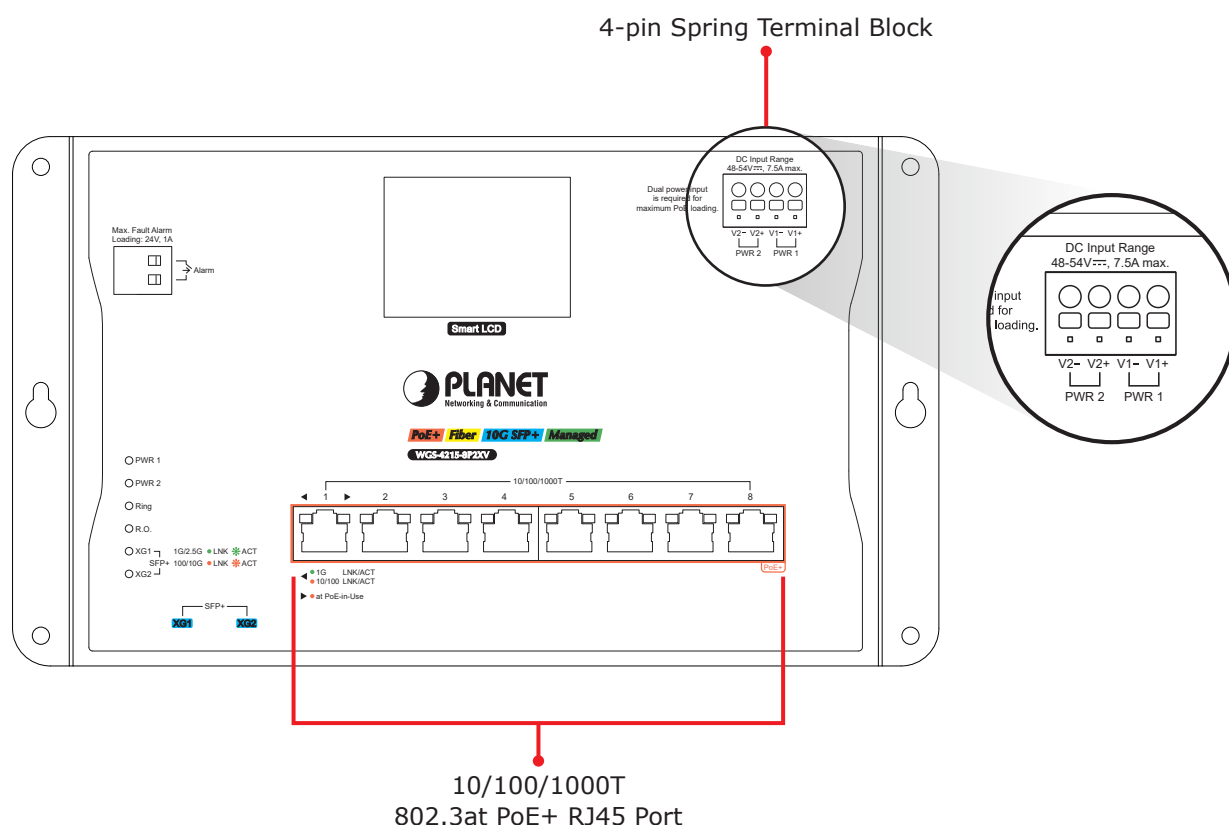

Note

Dual power input is required for a maximum PoE loading

■ Single power input: Max. 180W PoE budget

■ Dual power input: Max. 288W PoE budget

### 3.1 Terminal Block Connector Pinout

#### WGS-4215-8P2X/WGS-4215-8P2XV

The Front Panels of the **WGS-4215-8P2X** and **WGS-4215-8P2XV** consist of one **spring terminal block connector** within 4 contacts. Please follow the steps below to insert the power wire.

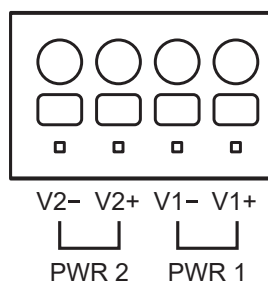

Insert positive and negative DC power wires into Contacts V1+ and V1- for Power 1, or Contacts V2+ and V2- for Power 2.



Caution

PWR1 and PWR2 must provide **exactly the same DC voltage** for power load balance while operating with dual power input.

### 3.2 Wiring Completed in Three Steps

**Step 1:** Insert the flat-blade screwdriver diagonally into the release hole.

**Step 2:** While keeping the flat-blade screwdriver in the release hole, insert the wire into the terminal hole. Push the wire in until the stripped portion is no longer visible to prevent shorting.

**Step 3:** Remove the flat-blade screwdriver from the release hole.

After connecting the wires, gently pull on the wire to make sure that it is securely fastened to the terminal block.

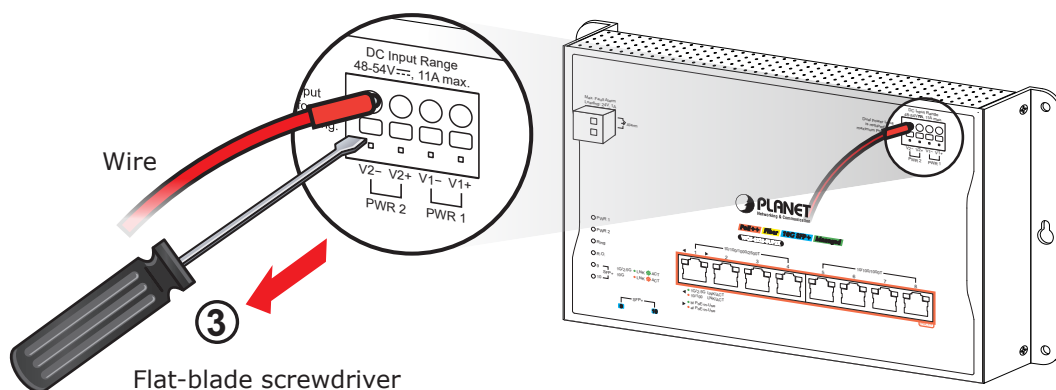
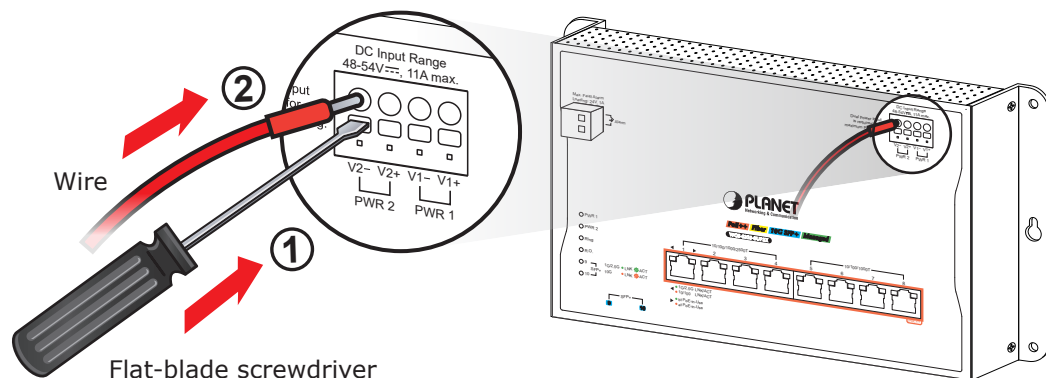



The wire gauge should be in the range from 12 to 16 AWG.

### 3.3 Wiring the Alarm Contact

The alarm contacts are in the middle of the terminal block connector as the picture shows below. Inserting the wires, the Wall-mount Managed Switch will detect the event status of the port or power failure and then form an open circuit. The following illustration shows an application example for wiring the alarm contacts.

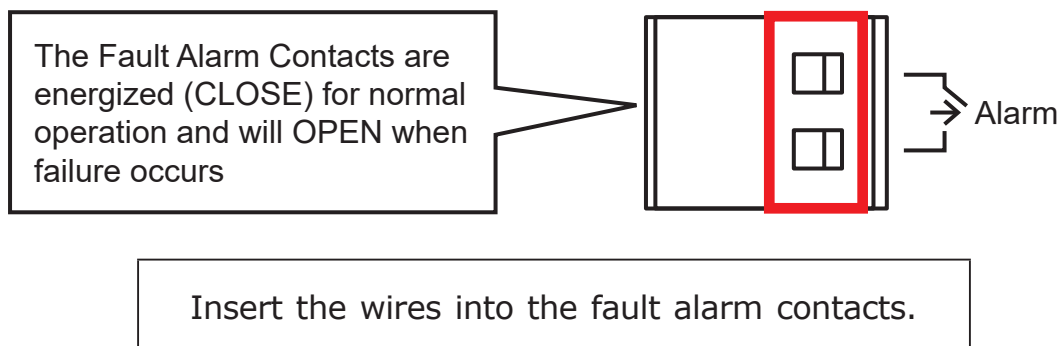

## 4. Hardware Installation

### 4.1 Wall-mount Installation

#### 4.1.1 WGS-4215-8P2X/WGS-4215-8P2XV

To install the Wall-mount Managed Switch on the wall, simply follow the following steps:

**Step 1:** Drill 4 holes with **8mm** diameter on the wall. The horizontal and vertical distances between the 2 holes are **230mm** and **124mm**, respectively.

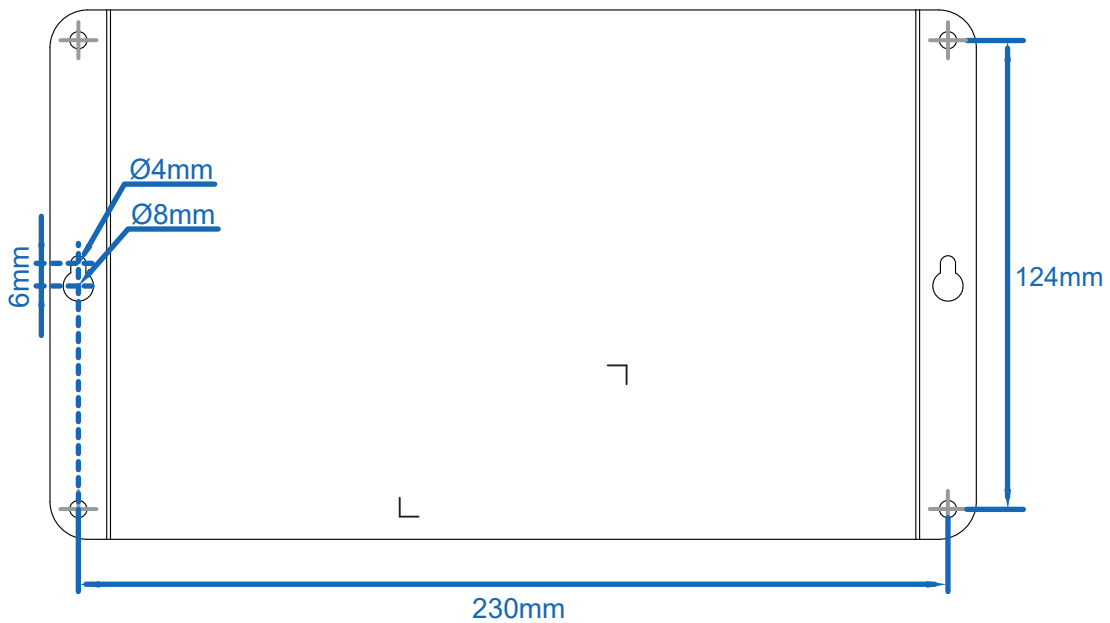

**Step 2:** Hammer the four anchors into the four holes.

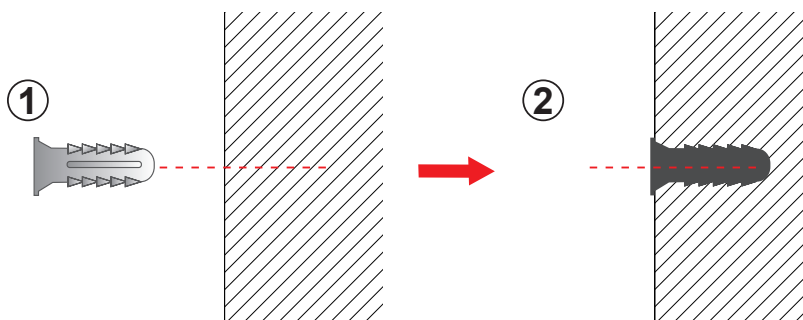

**Step 3:** Then the four given screws are screwed into the anchors to finish the wall-mount installation, as shown below.

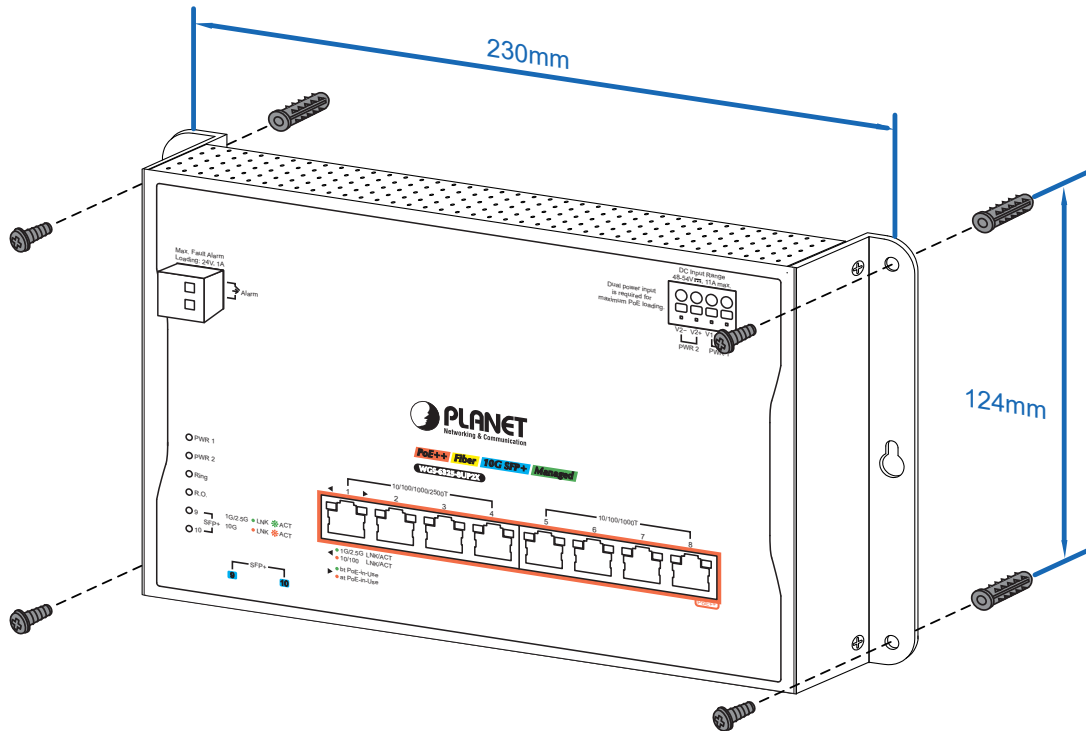

## 4.2 Wall Hanging Installation

### 4.2.1 WGS-4215-8P2X/WGS-4215-8P2XV

To hang the Wall-mount Managed Switch on the wall, simply follow the following steps:

**Step 1:** Drill **two** holes, each with a diameter of **8mm**, on the wall. The distance between the two holes should be **230mm**, and the line connecting them must be horizontal.

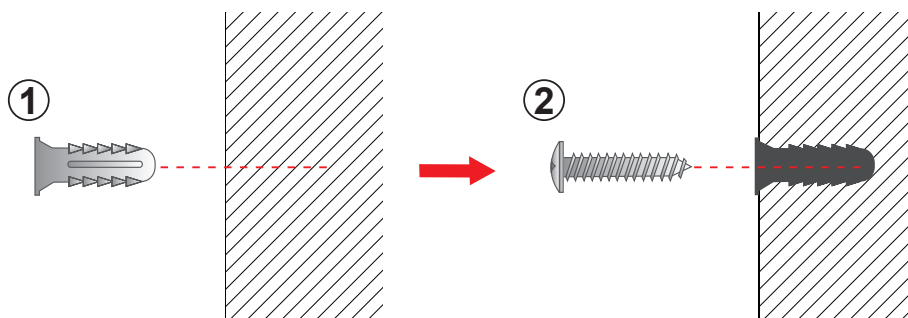

**Step 2:** Hammer two anchors into the hole. Afterwards, screw in the two screws, leaving a space of 2mm between them as shown in the circled diagram below.

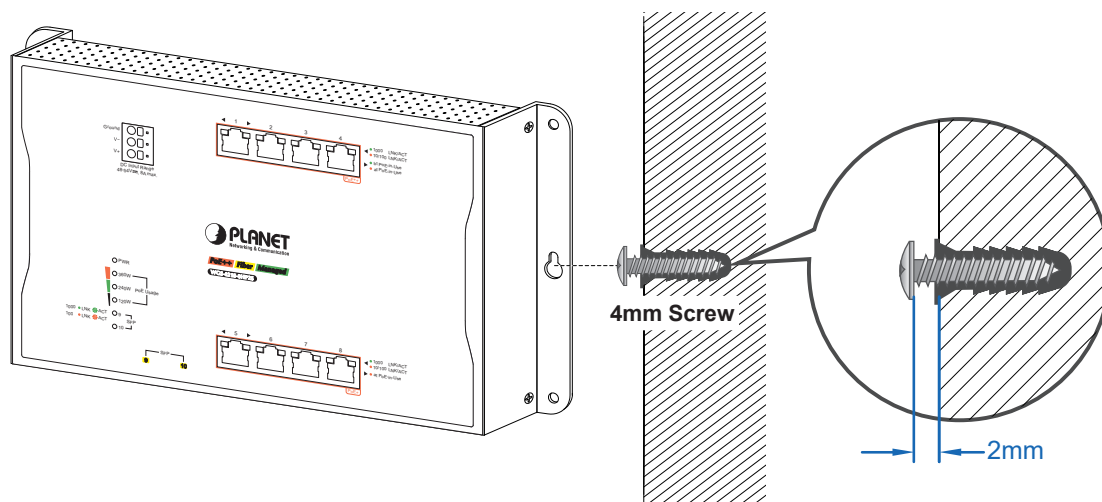

**Step 3:** The switch, shown in the picture below, can now be hung on the wall.

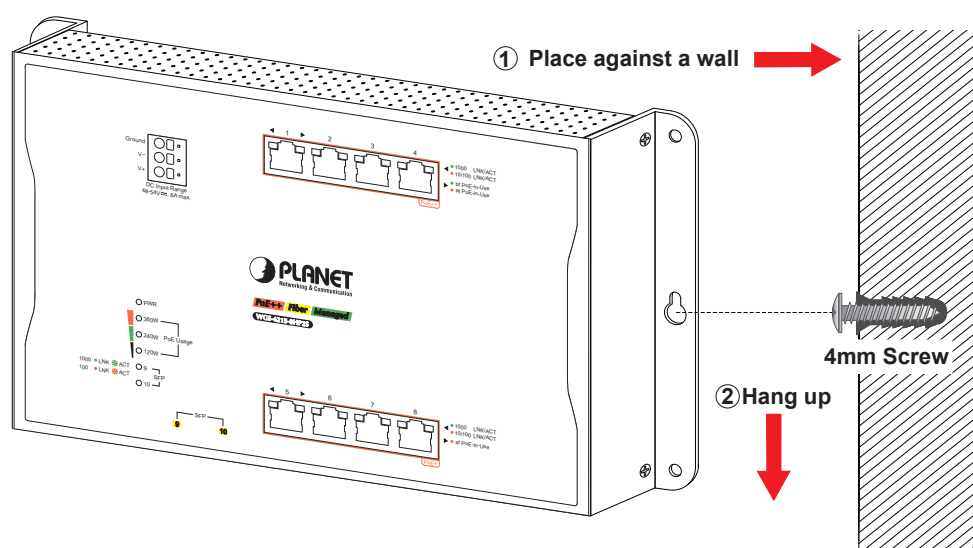

Caution

The installation of the above switch (not an actual picture) is the same as those of the WGS-4215-8P2X and WGS-4215-8P2XV.



Caution

Make sure the equipment is securely wall-mounted as strong vibration could cause it to drop or break.

## 4.3 Magnet Installation

### 4.3.1 Magnet Installation of WGS-4215-8P2X/WGS-4215-8P2XV

There are six holes on the unit, using six round magnets to install. Please refer to the following.

**Step 1:** Turn the switch to the back and place the six round magnets through the holes.

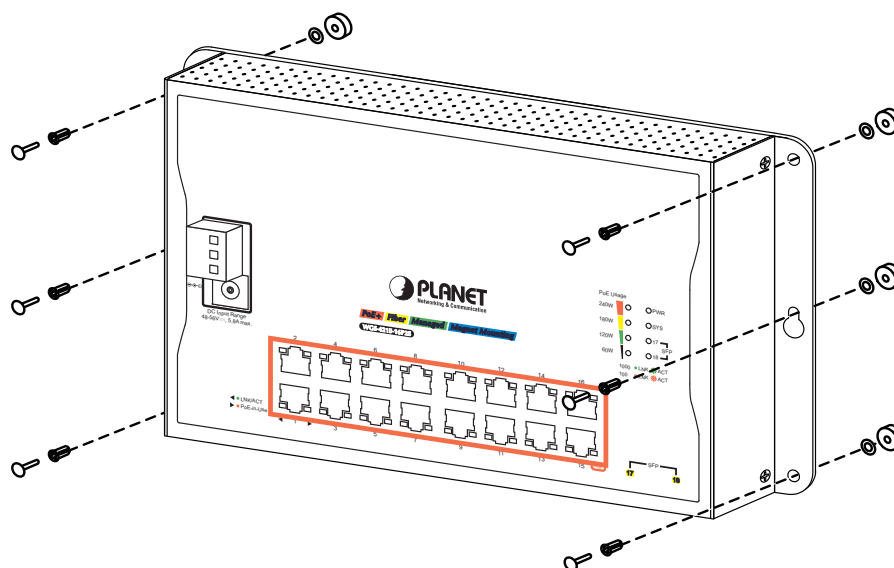

**Step 2:** Turn the switch to the front and push the plastic bolts into the holes to secure the magnets.

**Step 3:** Now you can place the switch on to any magnetic surface.



Caution

Make sure magnetic mounting is securely fixed, so that the switch will not drop or break due to vibration.



Caution

The installation of the above switch (not an actual picture) is the same as those of the WGS-4215-8P2X and WGS-4215-8P2XV.



Note

Please use the screw from the magnet kit to avoid breaking the device.

## 5. Web Login

### 5.1 Starting Web Management

The following shows how to start up the **Web Management** of the Wall-mount Managed Switch. Note the Wall-mount Managed Switch is configured through an Ethernet connection. Please make sure the manager PC must be set to the same **IP subnet address**.

For example, the default IP address of the Wall-mount Managed Switch is **192.168.0.100**, then the manager PC should be set to **192.168.0.x** (where x is a number between 1 and 254, except 100) and the default subnet mask is 255.255.255.0.

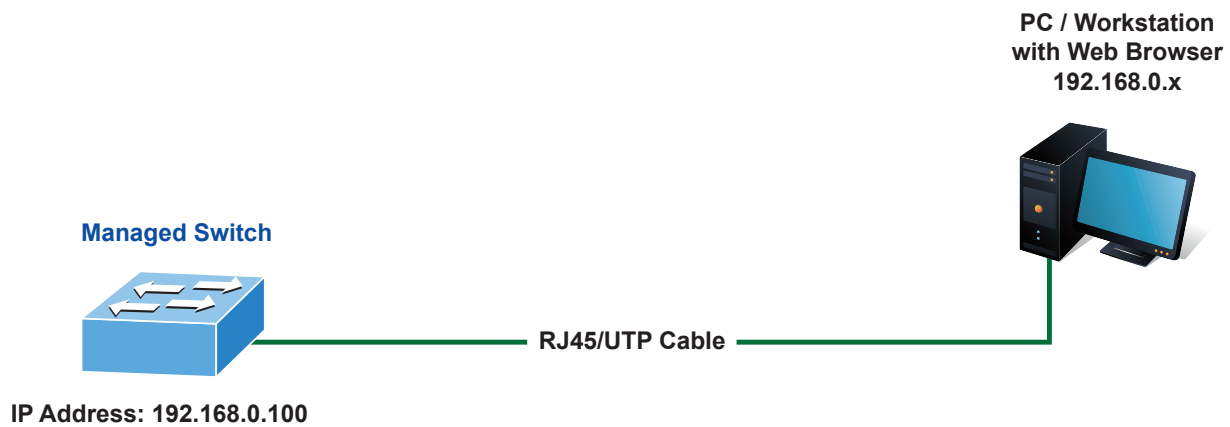

**Figure 5-1:** IP Management Diagram

## Logging in to the Wall-mount Managed Switch

1. Use Google Chrome or above Web browser and enter IP address **<https://192.168.0.100>** to access the Web interface.
2. When the following dialog box appears, please enter the default user name **"admin"** and the password. Refer to the following to determine your initial login password.

Default IP Address: **192.168.0.100**

Default Username: **admin**

Default Password: **sw + the last 6 characters of the MAC ID in lowercase**

3. Find the MAC ID on your device label. The default password is "sw" or "mc" followed by the last six lowercase characters of the MAC ID.

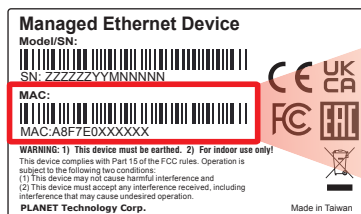
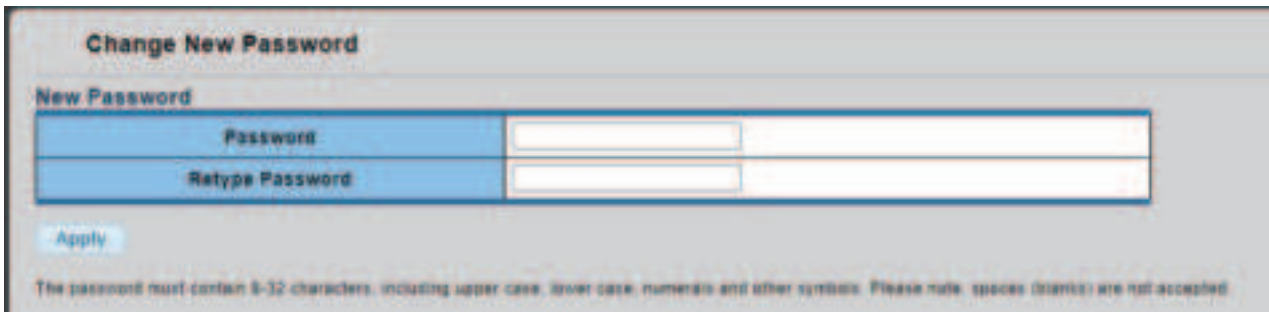

Figure 5-2: Industrial Managed Switch MAC ID Label



Figure 5-3: Web Login Screen

- After logging in, you will be prompted to change the initial password to a permanent one.



The screenshot shows a web form titled "Change New Password". It has two input fields: "Password" and "Retype Password". Below the fields is a blue "Apply" button. At the bottom, a small text note states: "The password must contain 8-32 characters, including upper case, lower case, numerals and other symbols. Please note, spaces (blanks) are not accepted."

**Figure 5-4:** Create a New Password

- Enter the default username and password, then set a new password according to the rule-based prompt and confirm it. Upon success, press any key to return to the login prompt. Log in with **"admin"** and the **"new password"** to access the Web interface.



The screenshot shows the Planet Web Login interface. At the top, there is a blue header with the "PLANET" logo and the text "Monitoring & Communication". Below the header, there are two input fields labeled "Username" and "Password". A blue "LOGIN" button is positioned below the fields.

**Figure 5-5:** Web Login with New Password



Note

The following web screen is based on the WGS-4215-8P2X. The display of the WGS-4215-8P2X is the same as the WGS-4215-8P2XV.

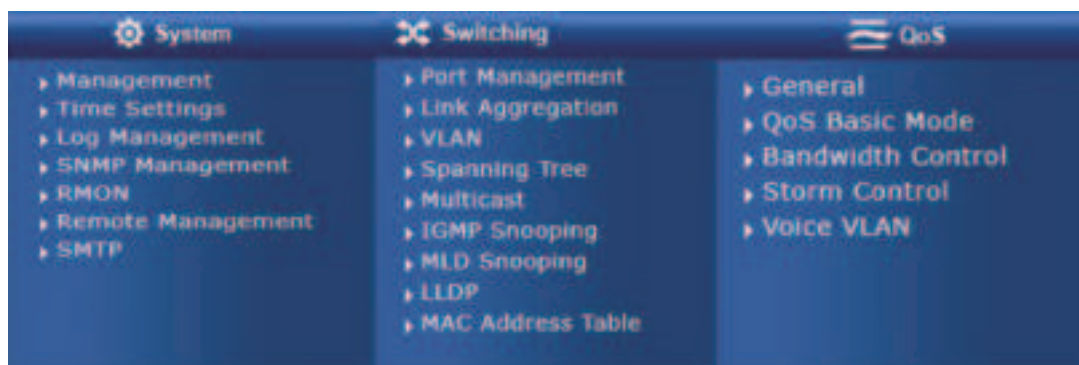

**Figure 5-6:** Web Main Screen of Wall-mount Managed Switch

The Switch Menu on the top of the Web page lets you access all the commands and statistics the Industrial Managed Switch provides. The Switch Menu always contains one or more buttons, such as **"System"**, **"Switching"**, **"QoS"**, **"Security"**, **"Ring"** and **"Maintenance"**.



**Figure 5-7:** Switch Menu



**Figure 5-8:** Switch Sub-menu

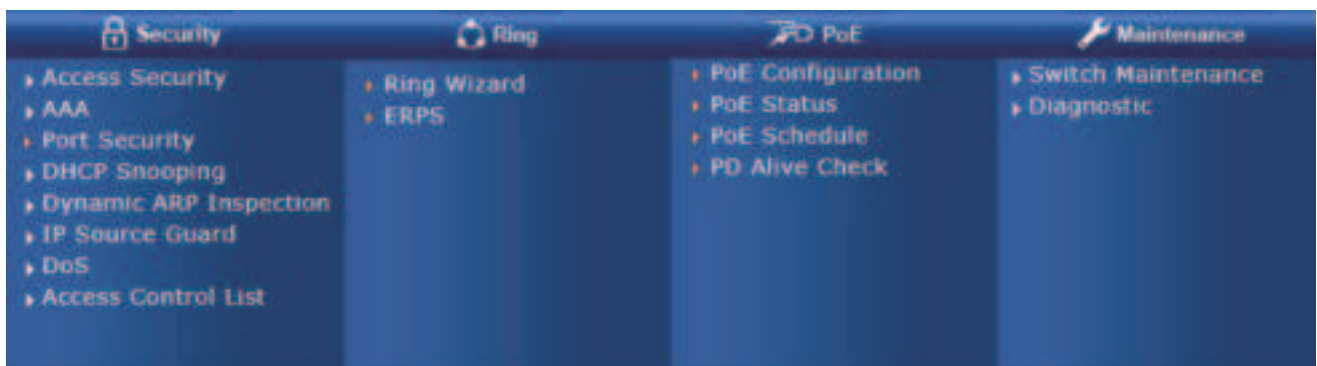

**Figure 5-9:** Switch Sub-menu

Now, you can use the Web management interface to continue the Switch management. Please refer to the user's manual for more.

## 5.2 Saving Configuration via the Web

In the Wall-mount Managed Switch, the running configuration file stores in the RAM. In the current version, the running configuration sequence of running-config can be saved from the RAM to FLASH by **"Save Configurations to FLASH"** function, so that the running configuration sequence becomes the startup configuration file, which is called configuration save.

To save all applied changes and set the current configuration as a startup configuration, the startup-configuration file will be loaded automatically across a system reboot.

1. Click **"Save > Save Configurations to FLASH"** to log in "Configuration Manager" Page.

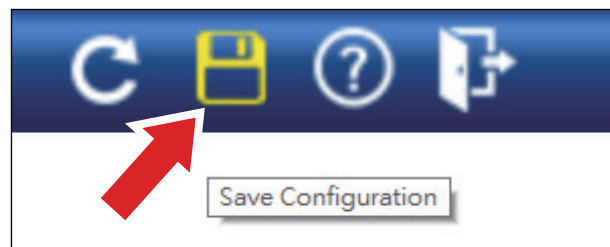

2. Press the **"Apply"** button to save running configuration to start up configuration.

Configuration Manager	
Save Configuration	
Source File	<input checked="" type="radio"/> Running configuration <input type="radio"/> Startup configuration <input type="radio"/> Backup configuration
Destination File	<input checked="" type="radio"/> Startup configuration <input type="radio"/> Backup configuration
<input type="button" value="Apply"/>	

## 6. SSH Login

The Wall-mount Managed Switch also supports SSHv2 for remote management. The switch asks for user name and password for remote login when using SSHv2 client software; please use the default username and password. Refer to **5.1 Starting Web Management** to determine your initial login password.

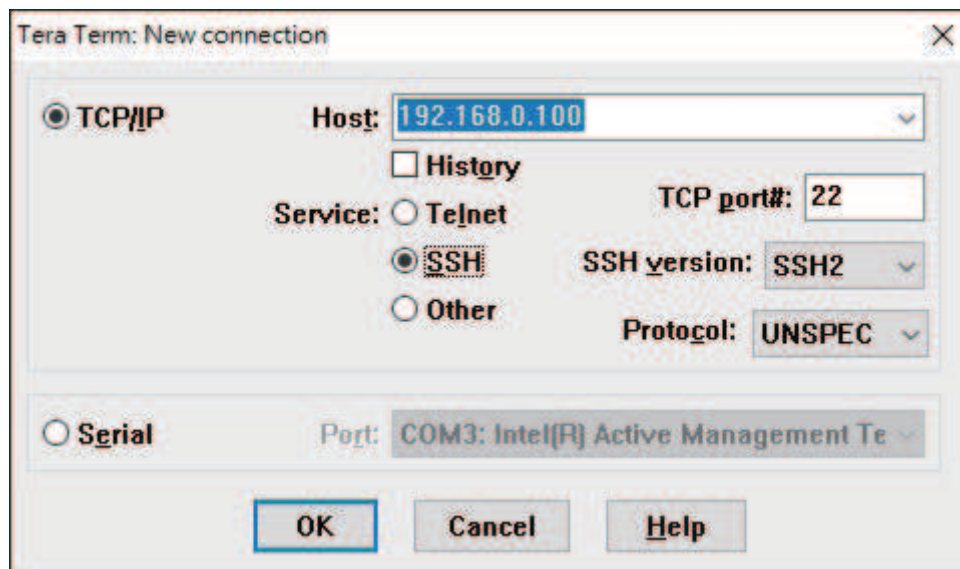

Default IP Address: **192.168.0.100**

Default Username: **admin**

Default Password: **sw + the last 6 characters of the MAC ID in lowercase**

Find the MAC ID on your device label. The default password is "sw" followed by the last six lowercase characters of the MAC ID.

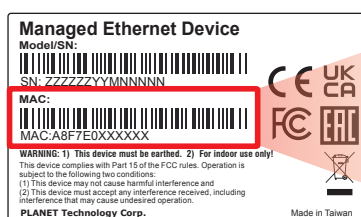

MAC ID: A8F7E0XXXXXX

Default Password: swXXXXXX

("x" means the last 6 digits of the MAC address.  
All characters should be in lowercase.)

**Figure 6-1:** Managed Switch MAC ID Label

Enter the default username and password, then set a new password according to the rule-based prompt and confirm it. Upon success, press any key to return to the login prompt. Log in with **"admin"** and the **"new password"** to access the CLI.

```
(New)Password: *****
Verify (New)Password: *****
Success.
Press any key to continue
Username: admin
Password: *****
```

### Figure 6-2: Create a New Password and Login Again

The user can now enter commands to manage the Wall-mount Managed Switch. For a detailed description of the commands, please refer to the following chapters.



### Note

1. For security reason, **please change and memorize the new password after this first setup.**
2. Only accept command in lowercase letter under console interface.

## 6.1 Configuring IP Address

The Wall-mount Managed Switch is shipped with default IP address shown below:

IP Address: **192.168.0.100**  
Subnet Mask: **255.255.255.0**

To check the current IP address or modify a new IP address for the Switch, please use the procedure as follows:

### ■ Display of the Current IP Address

1. The “#” prompt, enter the following command and press **<Enter>**.

WGS-4215-8P2X# **show vlan interface**

2. The screen displays the current IP address shown in Figure 6-3

[illegible]

**Figure 6-3: IP Information Screen**

## ■ Configuration of the IP Address

3. At the “#” prompt, enter “**configure**”.
4. At the “**(config)#**” prompt, enter the following command and press <Enter> as shown in Figure 6-4.

```
WGS-4215-8P2X(config)# interface VLAN 1  
WGS-4215-8P2X(config-if-vlan)# ip address 192.168.1.100 mask 255.255.255.0
```

The previous command would apply the following settings for the Wall-mount Managed Switch.

IP Address: **192.168.1.100**  
Subnet Mask: **255.255.255.0**

```
WGS-4215-8P2X# configure  
WGS-4215-8P2X(config)# interface vlan 1  
WGS-4215-8P2X(config-if-vlan)# ip address 192.168.1.100 mask 255.255.255.0  
WGS-4215-8P2X(config-if-vlan)# exit  
WGS-4215-8P2X(config)# exit  
WGS-4215-8P2X#
```

Figure 6-4: Configuring IP Address Screen

5. Repeat step 1 to check if the IP address has changed.

## 6.2 Storing the Current Switch Configuration

At the “#” prompt, enter the following command and press <Enter>.

```
# copy running-config startup-config
```

```
WGS-4215-8P2X# copy running-config startup-config  
Success  
WGS-4215-8P2X#
```

Figure 6-5: Saving Current Configuration Command Screen



Note

If you are not familiar with the Telnet command or the related parameter, enter “?” anytime in console to get the help description.

## 7. LCD Touch Screen (WGS-4215-8P2XV only)

The WGS-4215-8P2XV has a 2.4-inch color LCD touch screen with management functions. Tap the LCD touch screen to wake the LCD touch screen.



**Figure 7-1:** To wake the LCD touch screen

The factory default LCD configurations are shown as follows.

Default LCD: **Enable**  
Default Touch Screen: **Enable**  
Default Backlight Timeout: **Enable**  
Default Backlight Timeout Time: **300**  
Default Read Only Mode: **Disable**  
Default Screen: **Main Menu**  
Default Time Interval: **10**  
Default Color Scheme: **Dark**  
Default Pin Number: **1234**

You can use the Web management interface and click LCD, and then in the LCD Management, change LCD configuration.

- ▼ **Management**
- ▶ System Information
- ▶ IP Configuration
- ▶ IPv6 Configuration
- ▶ User Configuration
- ▶ Fault Alarm
- ▶ LCD Management
- ▶ Time Settings
- ▶ Log Management
- ▶ SNMP Management
- ▶ RMON
- ▶ Remote Management
- ▶ SMTP

LCD Management	
LCD Management	
LCD	<input type="radio"/> Disable <input checked="" type="radio"/> Enable
Touch Screen	<input type="radio"/> Disable <input checked="" type="radio"/> Enable
Backlight Timeout	<input checked="" type="radio"/> Disable <input type="radio"/> Enable
Backlight Timeout Time	<input type="text" value="10"/> (1-600)
Read Only Mode	<input checked="" type="radio"/> Disable <input type="radio"/> Enable
Default Screen	<input type="text" value="Main Menu"/>
Time Interval	<input type="text" value="10"/> (0-6000)
Color Scheme	<input checked="" type="radio"/> Dark <input type="radio"/> Light
Pin Number	<input type="text" value="1234"/> (0-9999)

Please refer to the user's manual for more.

## 8. Recovering Back to Default Configuration

### ■ IP Address has been changed or admin password has been forgotten –

To reset the IP address to the default IP address “**192.168.0.100**” or reset the login password to default value, press the **reset button** on the front panel for about **5 seconds**. After the device is rebooted, you can log in the Web interface management within the same subnet of 192.168.0.xx.

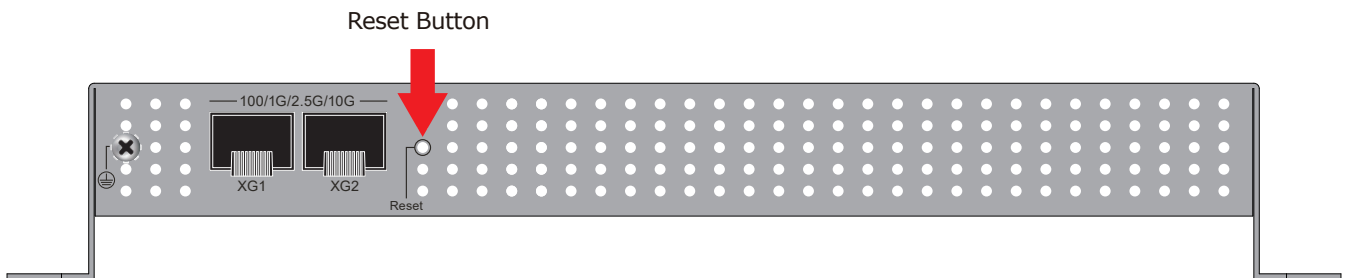

**Figure 8-1:** WGS-4215-8P2X(V) Reset Button

## 9. Customer Support

Thank you for purchasing PLANET products. You can browse our online FAQ resource and User's Manual on PLANET Web site first to check if it could solve your issue. If you need more support information, please contact PLANET switch support team.

PLANET online FAQs:

<https://www.planet.com.tw/en/support/faq>

Switch support team email address:

[support@planet.com.tw](mailto:support@planet.com.tw)

WGS-4215-8P2X/WGS-4215-8P2XV User's Manual:

<https://www.planet.com.tw/en/support/downloads?&method=keyword&keyword=WGS-4215&view=3#list>



Copyright © PLANET Technology Corp. 2024.

Contents are subject to revision without prior notice.

PLANET is a registered trademark of PLANET Technology Corp.

All other trademarks belong to their respective owners.