



Smart Bulb User Manual

CAUTION

USE IN DRY LOCATIONS. RISK OF ELECTRIC SHOCK OR BURNS

For indoor use only.

Do not install the device with wet hands or when standing on wet or damp surfaces.

Not for use in totally half or fully enclosed luminaires, especially luminaires with metal shade, which may distort the signal and make it harder to connect or control the lights

Do not use with Dimmers!

GET READY



iOS 10.0 & up



Android 4.4& up



2.4Ghz



Smart Life

Customer Service

Amazon messaging service

1. Search for LEDEPLY



2. Find our store

(click any of FECONN product detail page)

Sold by LEDEPLY and Fulfilled by Amazon.

3. Tap Ask a question

Have a question for
LEDEPLY?

Ask a
question

Email: ledeply@gmail.com

1.Download the 'Smart Life' App.

Register or log in if you already have an account



2.Add device

****If the light won't blink slowly or quickly, turn it off/on 10 times with intervals of at least 2s to reset it****

Connect via Bluetooth (Bulb blinks rapidly or slowly)

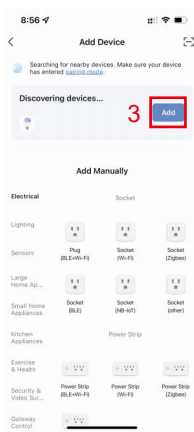
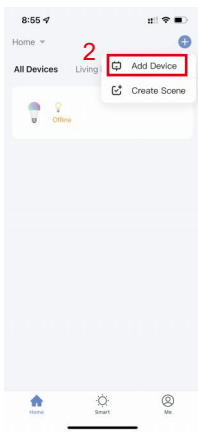
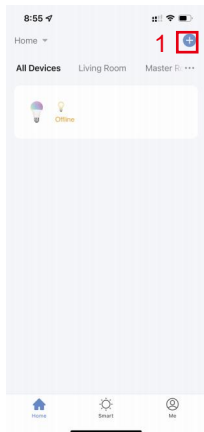

Connect via Bluetooth (Bulb blinks rapidly or slowly)

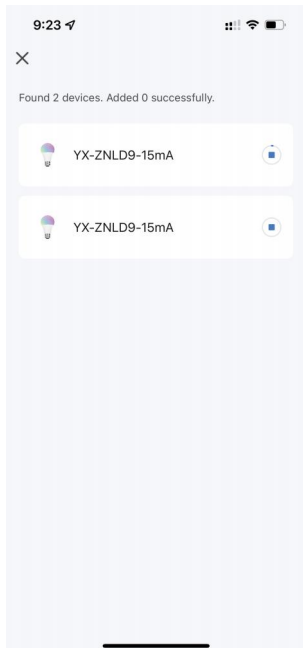
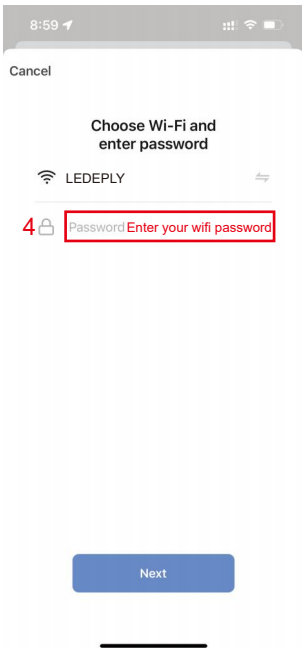

Connect via WIFI

EZ MODE(Recommend)

Bulb blinks rapidly

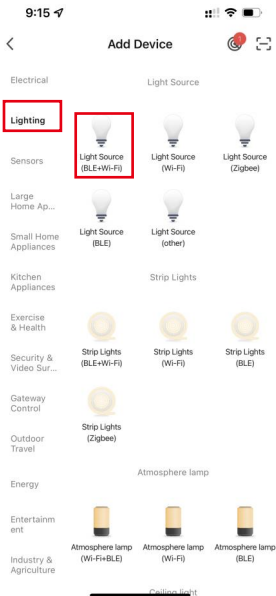

Select Lighting
==> Light source
(BLE+Wi-Fi)

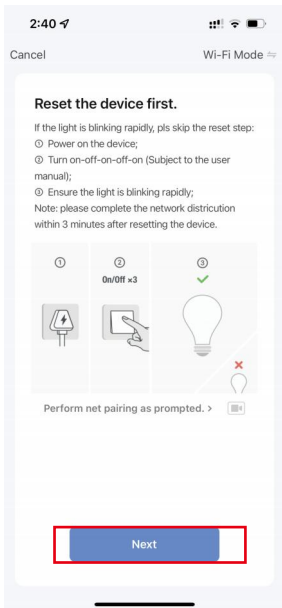

Reset the bulb then
Tap 'Next'

Connect via WIFI

EZ MODE(Recommend)

Bulb blinks rapidly

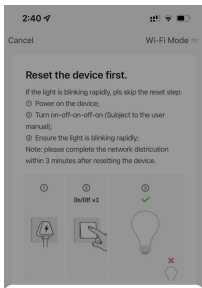

Check the status of the indicator light:



Tap 'Blink Quickly'

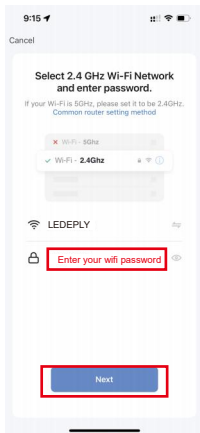

Enter your Wi-Fi password
and Tap 'Next'

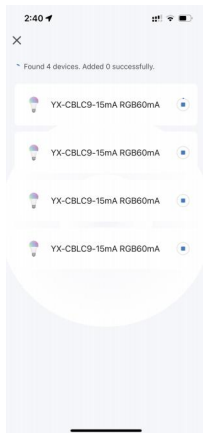

The app will try to
connect the smart bulbs

Connect via WIFI

AP MODE (ONE at a time)

Bulb blinks slowly

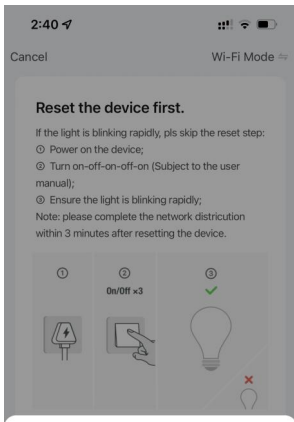

Check the status of the indicator light:

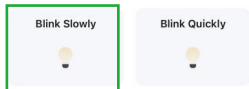

Choose Blink Slowly

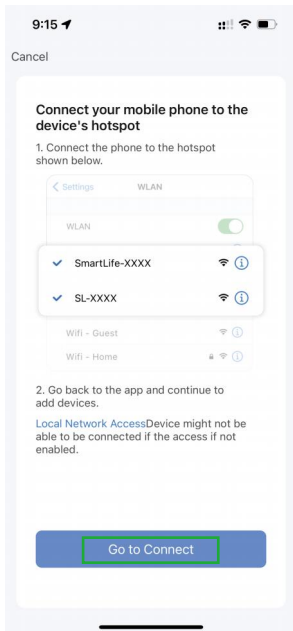

Tap 'go to connect'

Connect via WIFI

AP MODE (ONE at a time)

Bulb blinks slowly

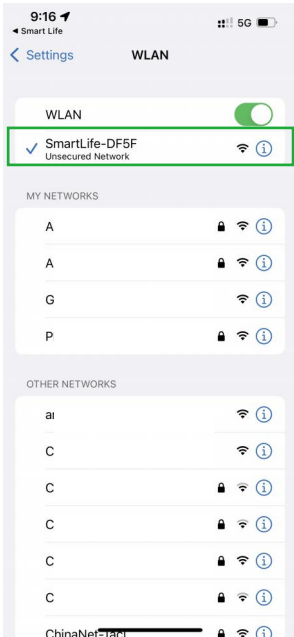

Connect to the
smartLife-xxx network

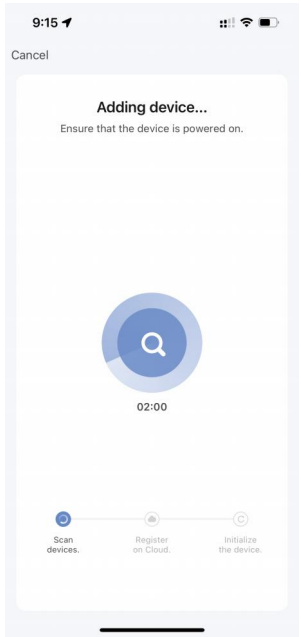

Go back to the smart life app, and it
will try to connect the bulb

Group Control

1. Tap a smart bulb in the device list to enter the its control panel.
2. Tap the edit icon
3. Click 'Create Group'

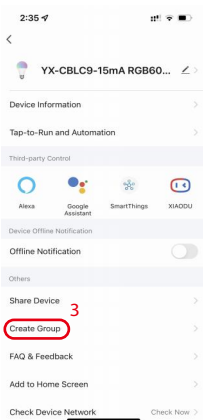
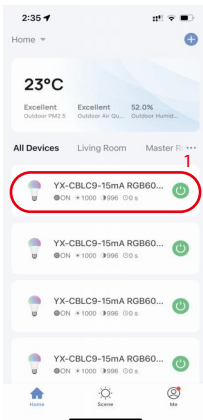

Group Control

4. Select devices for unified management.

5. Tap 'confirm' to complete the setup.

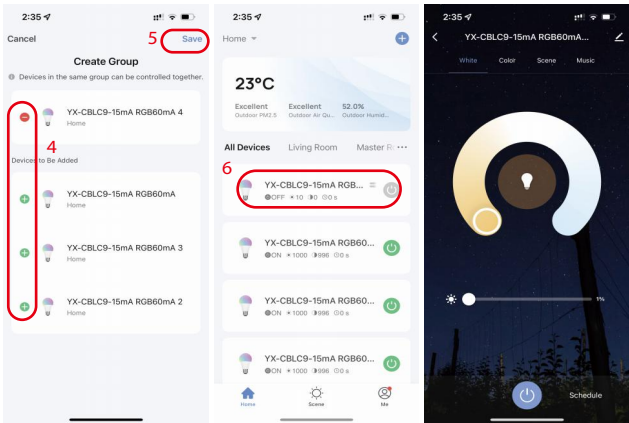

Now, you can use group control to control multiple bulbs

Alexa Settings

Enable the Smart Life skills in the Alexa APP, then log in your Smart Life account, it will automatically sync your smart bulb to Alexa.

After the synchronization is successful, you can use voice commands to control your smart bulbs.

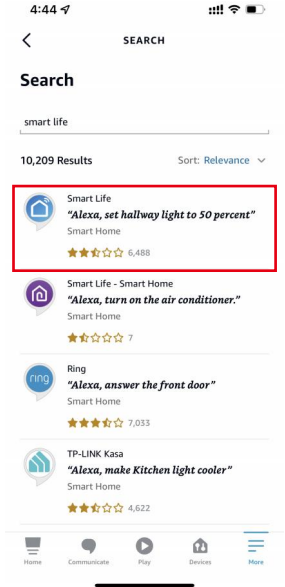
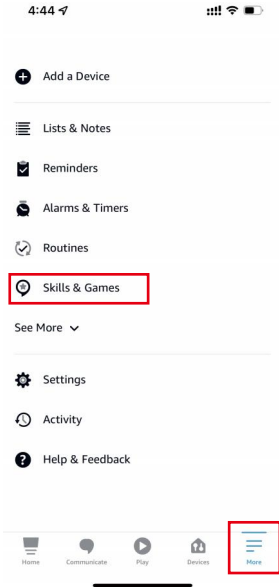

Google Assistant Settings

Tap 'Add' - 'Set up device' - 'Have something already set up?' - search for 'Smart Life' to add it and log in your smart life account.

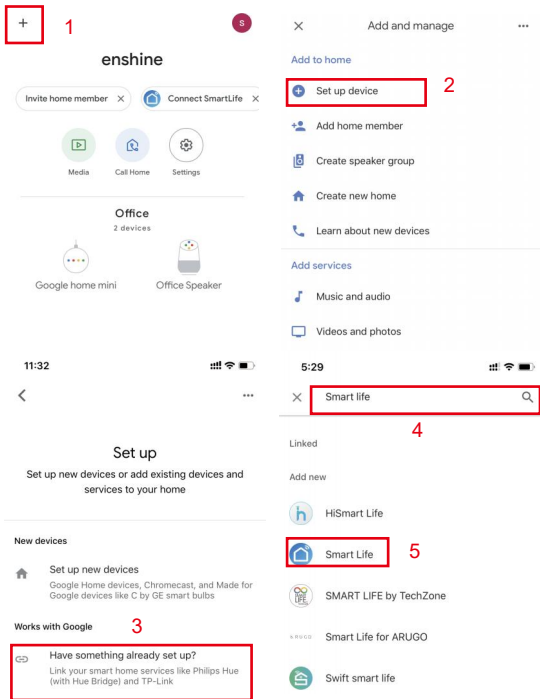



Smart bulb

FCC ID: 2AZNW-WSLB

Caution: This device complies with part 15 of the FCC Rules.

Operation is subject to the following two conditions: (1) This device may not cause harmful interference, and (2) this device must accept any interference received, including interference that may cause undesired operation.