

# Perryn spotlights

## INSTRUCTIONS

Single spotlight	1
Double spotlight	4

## Single spotlight

### INCLUDED

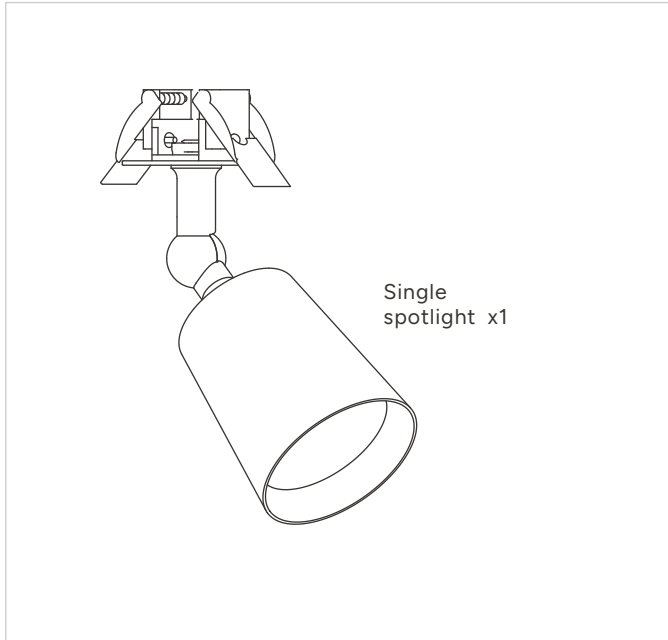

Before installation, the power supply should be isolated at the consumer unit circuit breaker. Check that the power is off.

These products must be installed by a qualified electrician in accordance with the latest building regulations.

The Perryn single spotlight is designed to be mounted onto a ceiling or wall with a void.

### TOOLS YOU'LL NEED

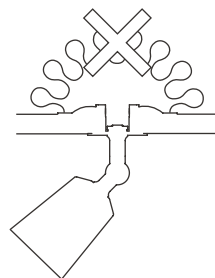
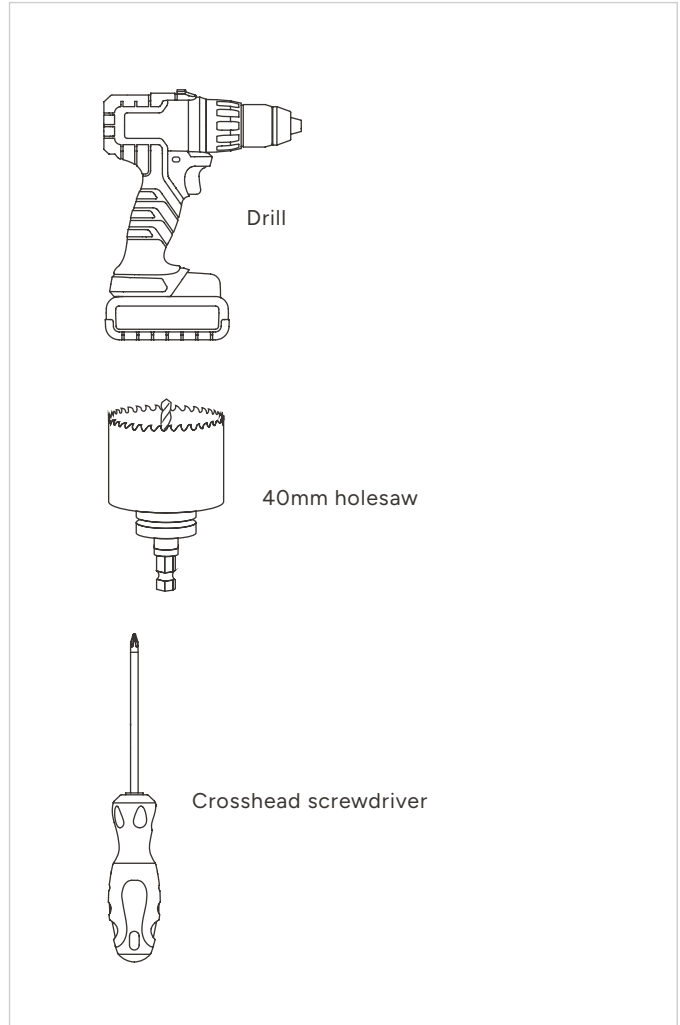

**Note:** the Perryn spotlight should not be covered with a thermally insulating material.

### Single spotlight

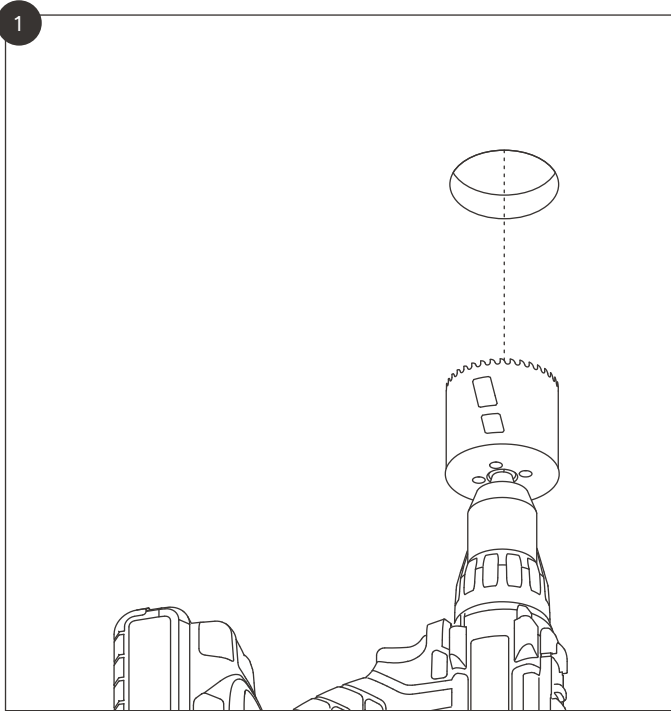

Drill the 40mm hole for the wires and latching mechanism. See the template on **page 3**.

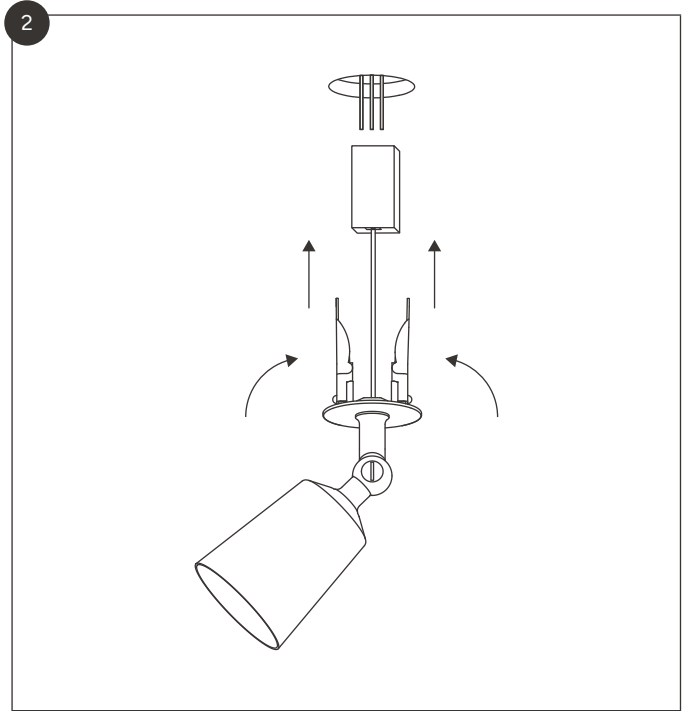

Fold the two spring clips in and insert the fitting through the hole, clips first.

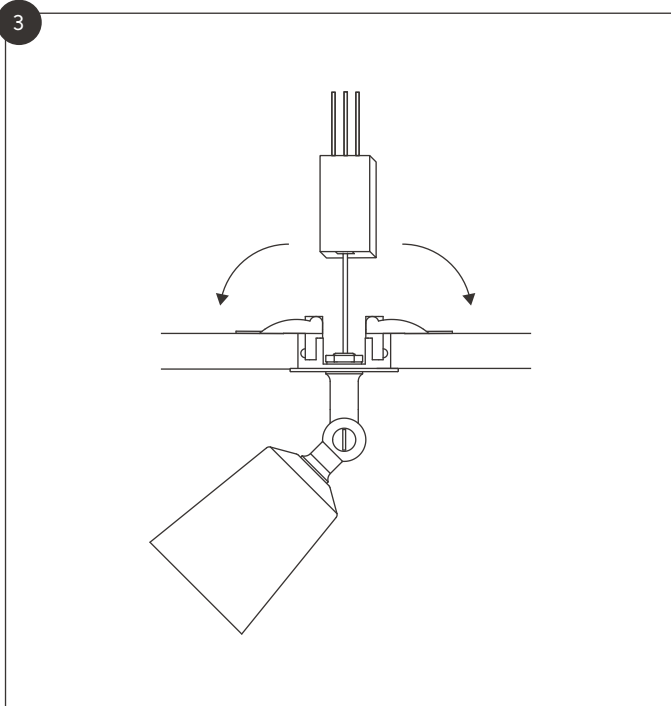

The spotlight should be pushed up into the ceiling until the springs fall into position. Position the spotlight as required.

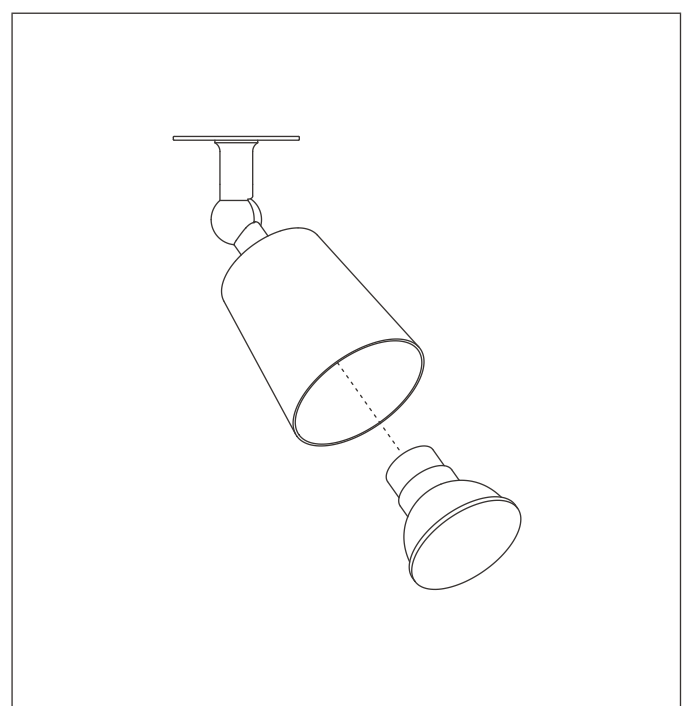

After positioning, insert a 50mm GU10 bulb (Arthur or Chester) or 35mm bulb (Court) into the shade and test the light to make sure the wiring is correct.

Single spotlight

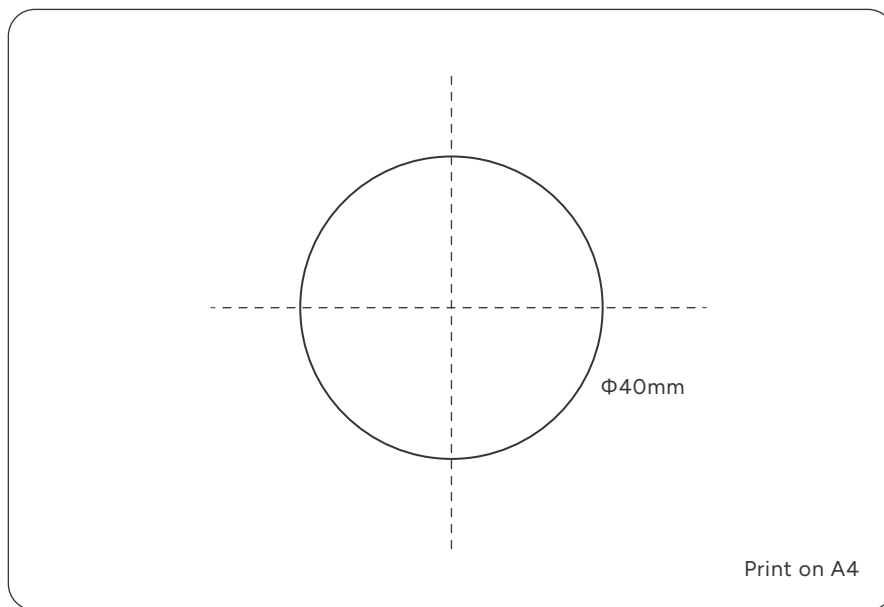

## Double spotlight

### INCLUDED

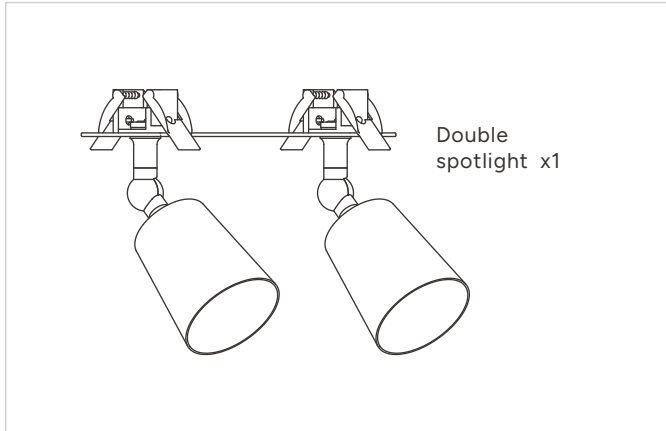

Before installation, the power supply should be isolated at the consumer unit circuit breaker. Check that the power is off.

These products must be installed by a qualified electrician in accordance with the latest building regulations.

The Perryn double spotlight is designed to be mounted onto a ceiling or wall with a void.

### TOOLS YOU'LL NEED

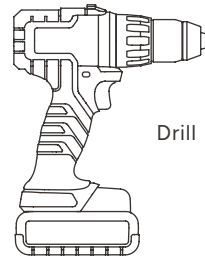

Drill

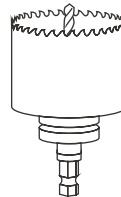

40mm holesaw



Crosshead screwdriver

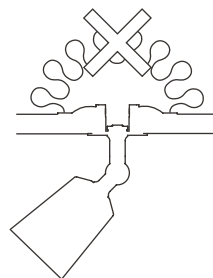

**Note:** the Perryn double spotlight should not be covered with a thermally insulating material.

## Double spotlight

1

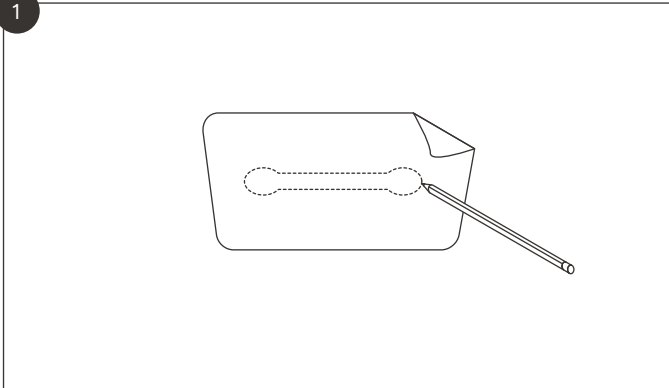

Drill two holes for the wires and latching mechanism 15cm apart. See the template on **page 6**. Using a small saw cut a track between the two holes.

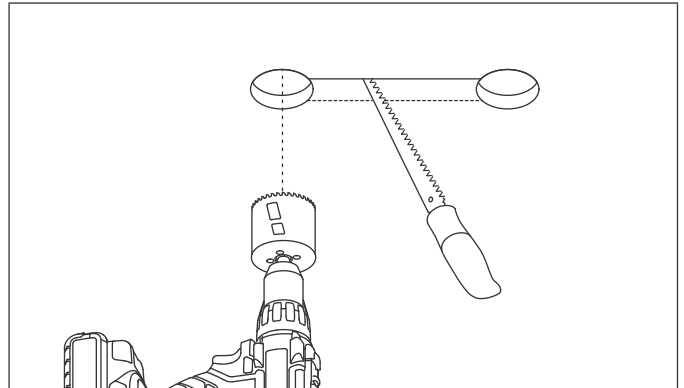

2

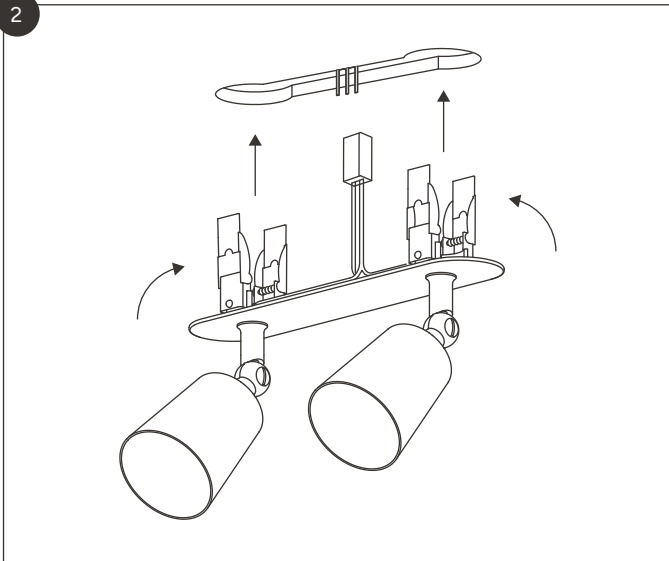

Fold the four spring clips in and insert the fitting through the hole, clips first.

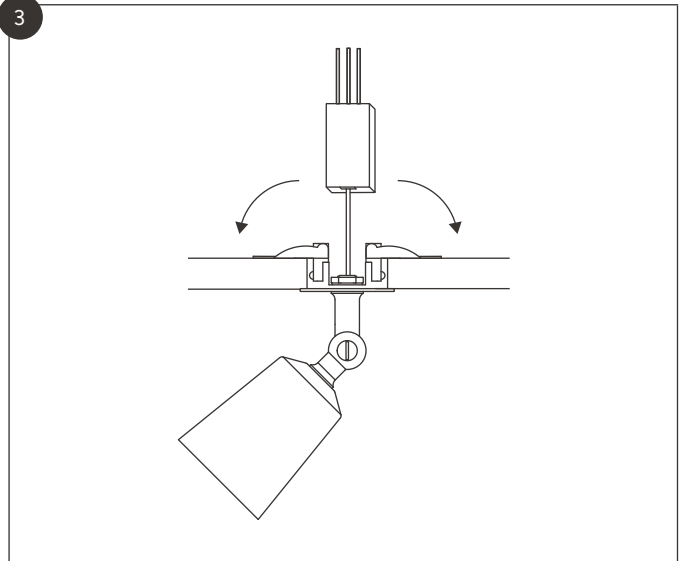

The spotlight should be pushed up into the ceiling until the springs fall into position. Position the shades as required.

4

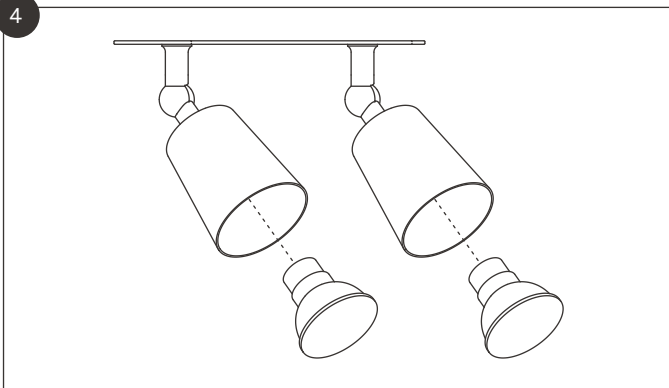

After positioning, insert 50mm GU10 bulbs (Arthur or Chester) or 35mm bulbs (Court) into the shades and test the light to make sure the wiring is correct.

Double spotlight

