

LUMARY SMART RGBAI DOWN LIGHT USER MANUAL



Lumary

Thank you for choosing Lumary! Are you excited to embark on a journey of smart living? Begin by downloading the Lumary App, your gateway to effortlessly managing your smart devices from anywhere using your smartphone or tablet. Our products seamlessly integrate with your home Wi-Fi, enabling you to command multiple devices with the mere touch of your fingertips.

At Lumary, we pride ourselves on being a leading producer of smart lighting solutions, dedicated to delivering unparalleled service. We are constantly refining our app and products to ensure that we meet and exceed your expectations. So, why wait? Illuminate your home with the sophistication and convenience of Lumary today. Let's make your space brighter and your life smarter.

Contents

Product & Notes	2-4
Installation	5-6
Application Connection	7-12
Group Control	13-15
UI Function Introduction	16-19
FAQ	20-23
Important Information	24-25
App-to-App Voice Control	26-32
After Sales & Social Media	33

Product&Notes

What's in the Box



- Lumary RGBAI Recessed Downlight

PACKAGE CONTENTS

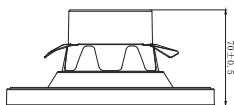

A

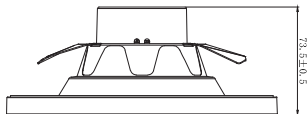

B



C

PART	DESCRIPTION	QUANTITY
A/B	4"or6" RGBAI Recessed Downlight	1
C	TP24 Connector	1

Get Ready

- Know your Wi-Fi network and password.
- Make sure your mobile device is running iOS 13.3 or higher and Android 9.0 or higher.
- Make sure you're connecting to a 2.4GHz Wi-Fi network (Lumary can't connect to 5GHz networks).

▲ SAFETY INFORMATION

Please read carefully and save these instructions, as you may need them at a later date. When using electrical equipment, basic safety precautions should always be followed as below:

WARNING – Risk of fire or electric shock. LED Retrofit Kit installation requires knowledge of luminaire electrical systems. If not qualified, do not attempt installation. Contact a qualified electrician.

WARNING – Risk of fire or electric shock. Install this kit only in luminaires that have the construction features and dimensions shown in the photographs and/or drawings and where the input rating of the retrofit kit does not exceed the input ratings of the luminaire. Do not make or alter any open holes in an enclosure of wiring or electrical components during kit installation.

WARNING – To prevent wiring damage or abrasion, do not expose wiring to edges of sheet metal or other sharp objects.

THIS RETROFIT KIT IS ACCEPTED AS A COMPONENT OF A LUMINAIRE WHERE THE SUITABILITY OF THE COMBINATION SHALL BE DETERMINED BY AUTHORITIES HAVING JURISDICTION. PRODUCT MUST BE INSTALLED BY A QUALIFIED ELECTRICIAN IN ACCORDANCE WITH THE APPLICABLE AND APPROPRIATE ELECTRICAL CODES. THE INSTALLATION GUIDE DOES NOT SUPERSEDE LOCAL OR NATIONAL REGULATIONS FOR ELECTRICAL INSTALLATIONS.

Installers should examine all parts that are not intended to be replaced by the retrofit kit for damage and replace any damaged parts prior to installation of the retrofit kit.

THIS DEVICE IS NOT INTENDED FOR USE WITH EMERGENCY EXITS or
NOT FOR EMERGENCY LIGHTING
SUITABLE FOR TYPE IC OR NON-IC LUMINAIRES

This lamp is only compatible with provided or other specified controls listed in these instructions for proper functionality. This lamp will not operate properly when connected to a standard incandescent dimmer or other off-shelf dimming controls.

The Lumary Retrofit Recessed Downlight is designed to install into most recessed can fixtures. However, please be aware that it may not be compatible with some models. Always ensure a secure fit into the can and ensure that the Lumary Retrofit Recessed Downlight fits firmly against the ceiling and does not sag out of the fixture.

The retrofit down light should be used only with metal housing, and the metal housing should be grounded.

INSTRUCTIONS

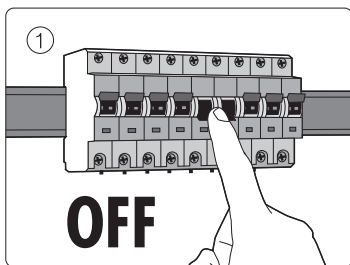
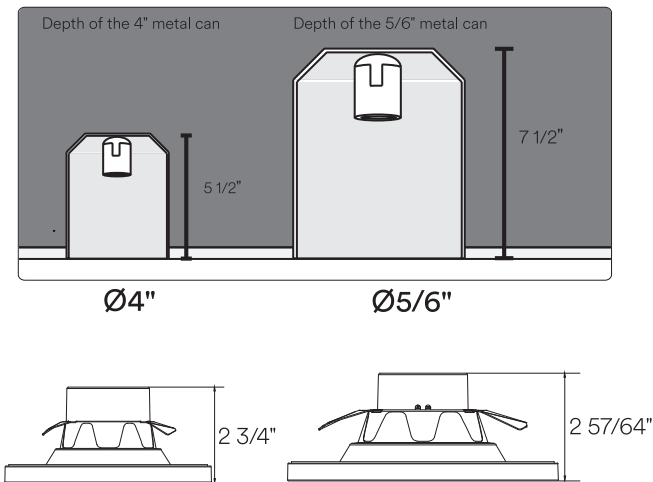

Step1 Switch off the mains before starting installation.

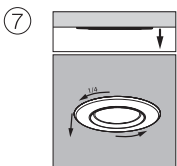
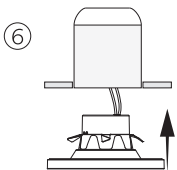
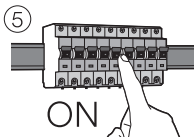
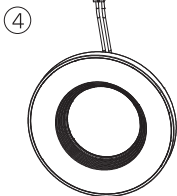
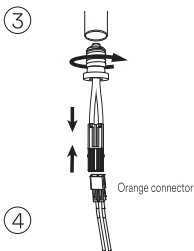

Step2

Check whether the product packaging is intact, any problems contact customer service e-mail.

Step 3

The E26 base with connector is included in the Lumary Downlight package.

Screw in the E26 base into the metal can, rotating it in an anti-clockwise direction in the holder.

Step4

Plug the orange connector into the base of the downlight.

Step5

Switch on the mains. Check that the light is in the distribution state or working properly.

Step6

Push the downlight upwards through the cut out towards the metal can. Your Lumary Downlight is installed.

Step7

Rotate the downlight anti-clockwise 1/4th of the circumference and pull it out.

Install the "Lumary" App

1. Find and install the "Lumary" App on App Store, Google Play.

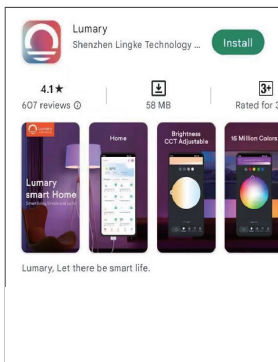
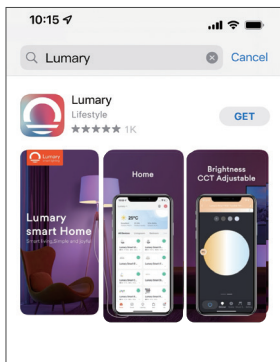

2. Register a Lumary account.

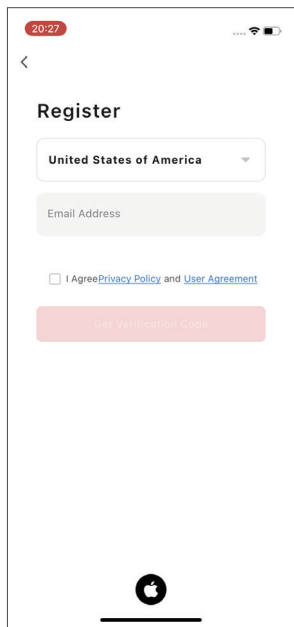

The screenshot shows the 'Register' screen of the Lumary app. At the top, the status bar displays the time 20:27, signal strength, Wi-Fi, and battery icons. A back arrow is in the top left. The title 'Register' is centered. Below it is a dropdown menu showing 'United States of America'. An 'Email Address' input field is below that. A checkbox is followed by the text 'I Agree [Privacy Policy](#) and [User Agreement](#)'. At the bottom is a pink button labeled 'Get Verification Code'. The iPhone home indicator is at the very bottom.

Enter your email address.

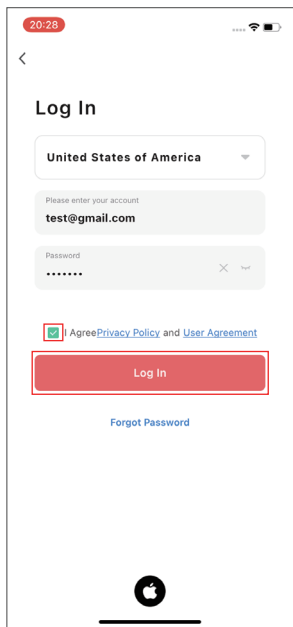

The screenshot shows the 'Log In' screen of the Lumary app. The status bar at the top shows the time 20:28 and system icons. A back arrow is in the top left. The title 'Log In' is centered. Below it is a dropdown menu showing 'United States of America'. A text prompt 'Please enter your account' is above an input field containing 'test@gmail.com'. Below that is a 'Password' input field with masked characters and a 'Show/Hide' toggle. A checkbox is followed by the text 'I Agree [Privacy Policy](#) and [User Agreement](#)'. Below this is a red button labeled 'Log In'. At the bottom is a blue link 'Forgot Password'. The iPhone home indicator is at the very bottom.

Log into the App.

Note: Please select your region and country.

3. Connect

NOTE: Lumary's products can't connect to 5GHz networks.

Steps:

1. Advised to enable Bluetooth, Enable Bluetooth to add some Wi-Fi device easily;
2. Each time the device without distribution network is powered on, confirm the light is breathing or blinking pairing mode;
3. Open the Lumary App, In the top corner of the Devices screen, click "+" and select "Add Device" to confirm that the device is paired.

If not, you need to use the wall switch to reset: on-off-on-off-on;

4. Find the device, choose Wi-Fi and enter password, press "Next". Click "Add", and wait patiently. After that, click "Done", and the device is successfully added to the App.

5. Other ways to add devices, Open the Lumary App>>In the top corner, click ">> Choose "Lighting">>Select "Light Source (BLE + Wi-Fi)">>Select "AP Mode" or "EZ Mode" in the upper right corner.

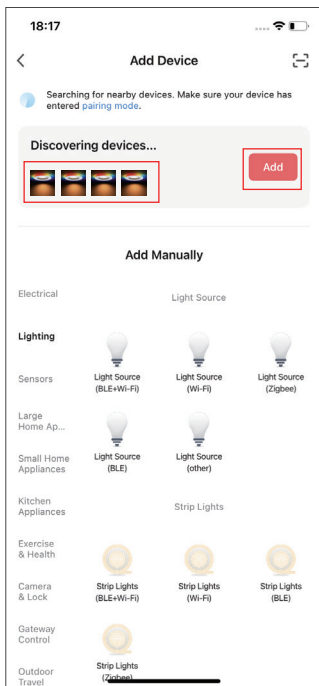
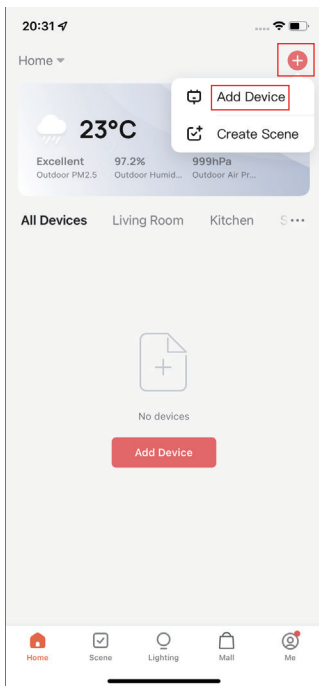

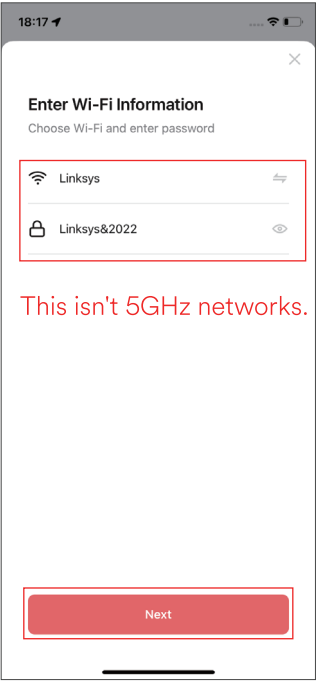

This isn't 5GHz networks.

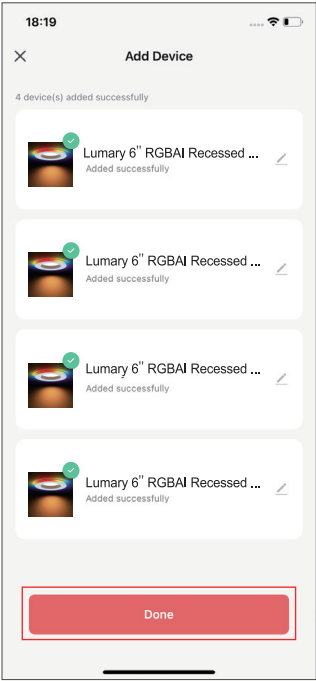

4. Troubleshooting

1. Can't connect to your Wi-Fi network.

Make sure you entered the correct Wi-Fi password during the Wi-Fi setup. Check whether there are any Internet connection problems. If the Wi-Fi signal is too weak, reset your Wi-Fi router and try again.

2. If you fail to bind, you will need two phones, one to set the hotspot and the other to connect the hotspot and add the device through the app. If the device is successfully added, the device is normal. The problem may be in the router, you need to check your router Settings to see if there are MAC and DHCP restrictions. Lumary's products do not support 5GHz networks.

3. If you have any questions. You can contact us via our after-sales email: support@lumary.tech or leave a message on our official social media account.

Group Control

1. Log in to Lumary App, tap the smart device and enter into, click"✎" in the top right corner.

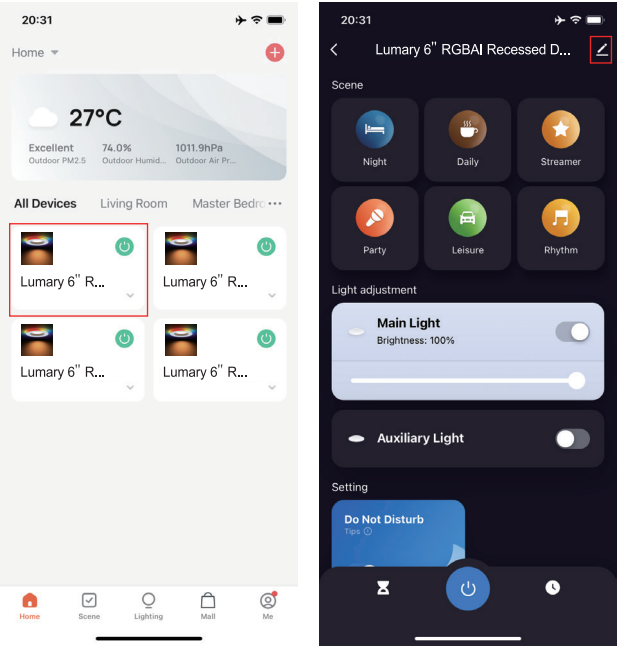

2. Click "Create Group", then select a device and save.

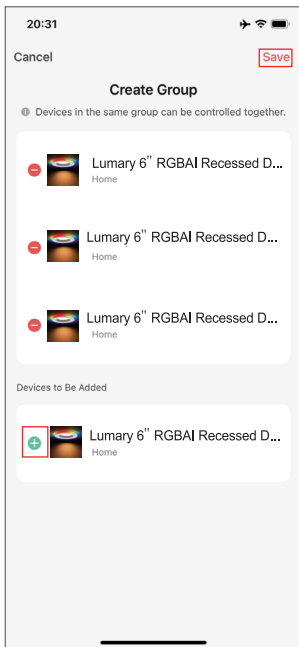
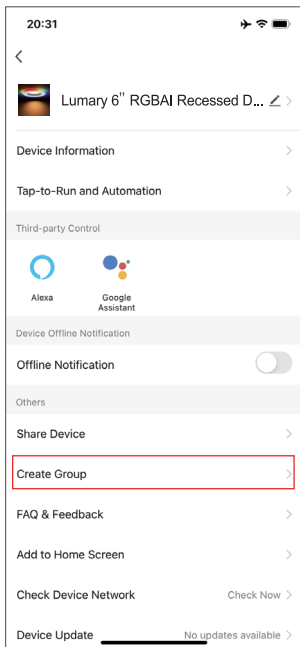

3.You can reset the group name and save it, and the group can control devices.

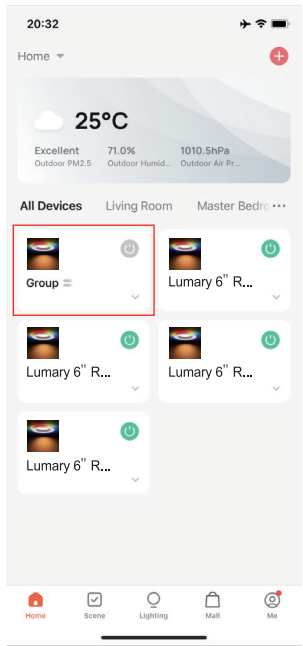
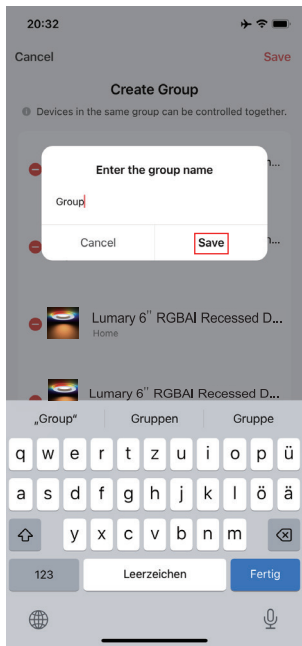

UI Function Introduction

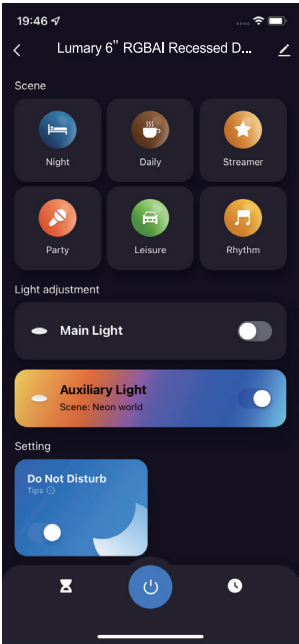

The main light and auxiliary light can be turned on at the same time. You can press and hold any icon to enter the new UI.

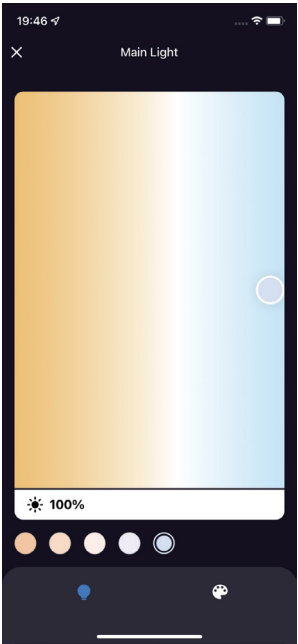

Main light adjust brightness and color temperature.

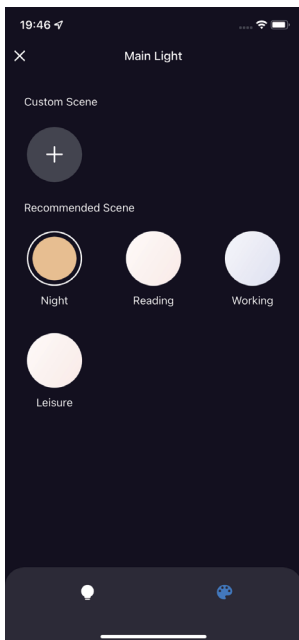

Main light
scene setting UI.

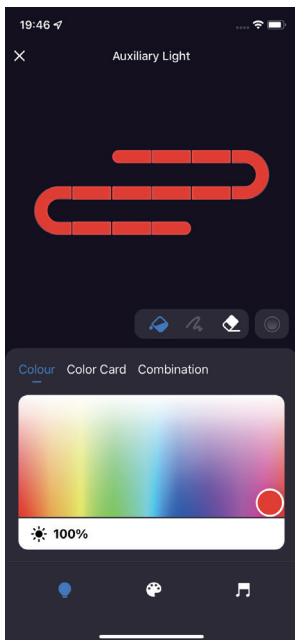

Auxiliary light
RGBAI setting UI.
Paint bucket filling adjustment
You can adjust the color and saturation, brightness and color card directly to the designed color block through the color disk in the color light interface.

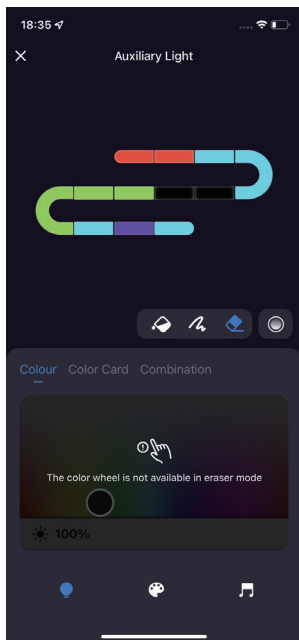
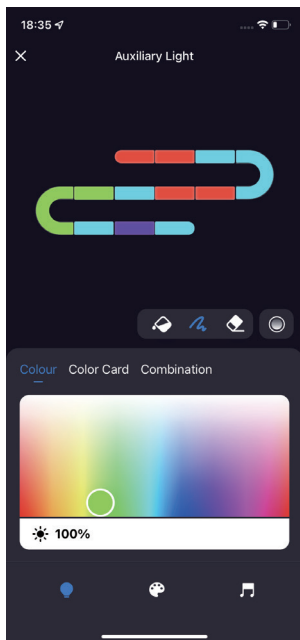

Eraser

In the color light or color card to choose the desired color, you can click or slide to smear the area above the strip of light, the strip of light to change the color, switch to like the skin eraser, it will click or slide to select the strip of light out.

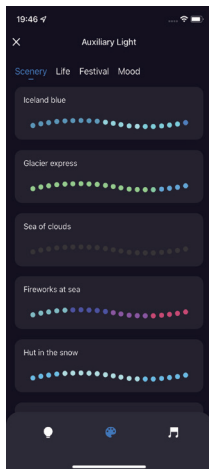
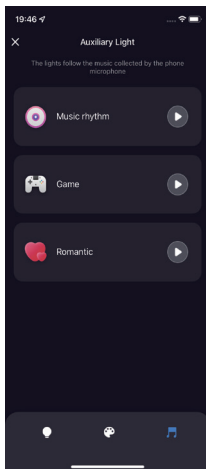
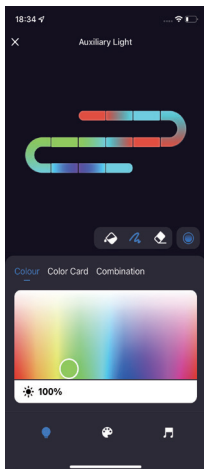

Color transition

When the light with multiple color light color smear, you can click the transition button to switch to the color transition state.

Music & Scence

FAQ

1. What should I do, if I don't have internet access to my Lumary product?

If you do not have a network, you will need two mobile phones, one to set up the hotspot and the other to connect to the hotspot and add the device via the app (refer to the guide).

2.If my Wi-Fi internet goes down, will Lumary App still work?

Lumary products need to be connected to Wi-Fi in order to use them remotely, and the device can be controlled simply using the app via the LAN as well as Bluetooth. For example: on, off, dimming, colour temperature, colors.

3. Why does the flickering occur with Lumary products?

Lumary's products are factory set to the default network configuration. If the device has not been connected to the network, it will flash for three minutes each time it is powered on. If the device has not been connected to the network, it will flash for three minutes every time it is powered on. If the device is connected to the network, it will stop flashing and will automatically connect to the network when it is switched off and on via the wall switch after 15 seconds.

4.Can I share with family and friends?

Yes, you can share access to your Lumary devices. In the Lumary App, from your main device list, click on one of the devices press the "..." button on the top right and click on "Share Device" to give or revoke sharing permissions. In order to share, the other user should already have downloaded the Lumary App and registered an account.

5.Can I group multiple Lumary devices together?

Yes, you can group multiple same-type devices by room, location, or however else you want. The same devices can be in multiple groups. For example, if you create a group for "Bedroom" and another group for "Entire House", your Bedroom lights can be included in both groups. From your main device list, click on one of the devices you want to group, press the "..." button on the top right for advanced settings, and click "Create Group". You'll be able to name a new group and choose which devices you'd like to group together.

6.My Lumary device has a funny name. How do I rename it?

From your main device list, click on one of the devices you want to rename, press the "..." button on the top right for advanced settings, and click "Modify Device Name" (or "Modify Group Name"). You'll then be able to choose a more familiar name. callly connect to the network when it is switched off and on via the wall switch after 15 seconds.

7.What's the wireless range?

The range of your home Wi-Fi is heavily dependent on your home router and the conditions of the room. Check with your router specifications for exact range data.

8.What should I do if the device Appears offline or is unreachable?

Make sure your Wi-Fi router is online and in range, and check that you have the latest Lumary functionality by clicking "Check for firmware update" in your device settings. Try to turn off the device >> clear the application cache >> reboot the router >> turn on the device after one minute and check and confirm the device status after five minutes.

9.How many devices can I control?

- The maximum number of timers that can be added to a single device: 30
- Maximum number of devices that can be added in a single home: 120
- The maximum number of Tap-to-Run that a single home can create: 100
- Maximum number of Automation that can be created in a single home: 100
- The maximum number of tasks that can be added in a Tap-to-Run: 150
- The maximum number of tasks that can be added in an Automation: 150
- The maximum number of conditions that can be added in an Automation: 10
- The maximum number of mobile devices that can simultaneously log in to an account is: 200
- The maximum number of Homes that can be created by a single App account is: 20
- The maximum number of home members that can be added in a single home is: 20
- The maximum number of rooms that a single home can create is: 20
- The maximum number of devices that can be added in a single room is: 50

- The maximum number of devices that can be added in a single device group is: 100
- The maximum number of device groups that a single home can create is: 20
- The maximum number of each device group that can be shared with other users is: 20
- The maximum number of each device that can be shared with other users is: 20
- The maximum number of each App account that can be invited by other homes is: 20

10.What should I do,when I find a problem with the purchased product?

Please email us (support@lumary.tech) with your Amazon order ID. We are dedicated to ensuring your 100% satisfaction. Rest assured if the problem is with this product, we'll be more than happy to exchange it for a new one immediately.

11.How do I reset the device?

To reconnect to Wi-Fi, Reset the device through the wall switch, on - off - on - off - on

- Reset once (press switch on - off - on - off - on) to reach Easy Mode, indicated by rapidly blinking white light. Refer to connect in Easy Mode.

- Reset again (press switch on - off - on - off - on) to reach AP Mode, indicated by slowly blinking white light. Refer to connect in AP Mode.

Important Information

Troubleshooting

Can't connect to your Wi-Fi network.

Make sure you entered the correct Wi-Fi password during the Wi-Fi setup.

Check whether there are any Internet connection problems.If the Wi-Fi signal is too weak, reset your Wi-Fi router and try again.

Parameter information

Name	Lumary RGBAI Recessed Downlight
Model	L-DL4D1/4 L-DL6D1/4
Input Voltage	120VAC,60Hz
Wattage	9W/13W
Color Temperature	RGBAI +Tunable White(2700K-6500K)
CRI	90+
Lumens	780lm/1000lm
Beam Angle	110°
Rated Life	25000h



RoHS



FCC ID:2ANDL-CBU

Made in China

CAUTION:

This device complies with Part 15 of the FCC Rules. Operation is subject to the following two conditions:

(1) this device may not cause harmful interference, and (2) this device must accept any interference received, including interference that may cause undesired operation. Changes or modifications not expressly approved by the party responsible for compliance could void the user's authority to operate the equipment.

NOTE: This equipment has been tested and found to comply with the limits for a Class B digital device, pursuant to part 15 of the FCC Rules. These limits are designed to provide reasonable protection against harmful interference in a residential installation. This equipment generates uses and can radiate radio frequency energy and, if not installed and used in accordance with the instructions, may cause harmful interference to radio communications. However, there is no guarantee that interference will not occur in a particular installation. If this equipment does cause harmful interference to radio or television reception, which can be determined by turning the equipment off and on, the user is encouraged to try to correct the interference by one or more of the following measures:

- Reorient or relocate the receiving antenna.
- Increase the separation between the equipment and receiver.
- Connect the equipment into an outlet on a circuit different from that to which the receiver is connected.
- Consult the dealer or an experienced radio/TV technician for help.

VOICE CONTROL GUIDE

Name and Control Each Device by Voice



Voice Control Quick Guide for Amazon Alexa

1. Log in to Lumary App, tap the smart device and enter into, click"  " in the top right corner.

2.Tap "Alexa" in Third-party Control.

3.Tap "Sign In With Amazon".

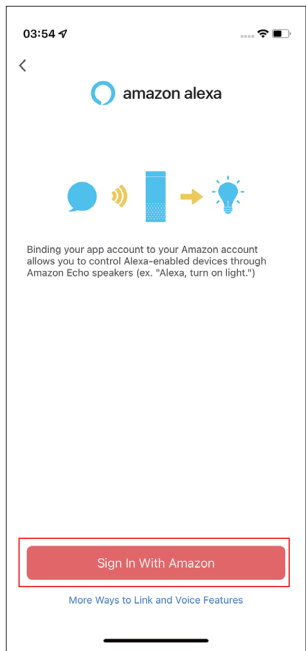
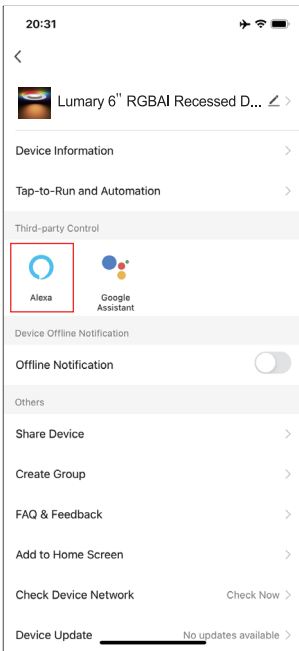

4. Tap "Allow";
5. Linked successfully, when add new device, there is no need to link again, just discover new device in Alexa.

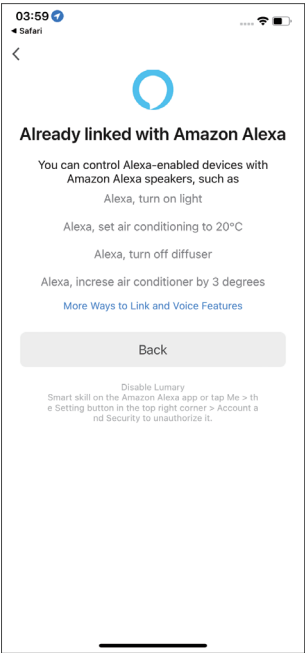



To control your Lumary smart device, just ask Alexa.

Make sure your devices are already set up using the Lumary app.

Things you can say*:

"Alexa, discover my devices."

"Alexa, turn on the bedroom light."

"Alexa, set the bedroom light to orange."

"Alexa, turn off the coffee machine."

"Alexa, set the living room to 50%."

"Alexa, dim porch light."

*Some commands require compatible devices.

Voice Control Quick Guide for Google Assistant

1. Log in to Lumary App, tap the smart device and enter into, click "✎" in the top right corner.
2. Tap "Google Assistant" in Third-party Control.
3. Tap "Link with Google Assistant".

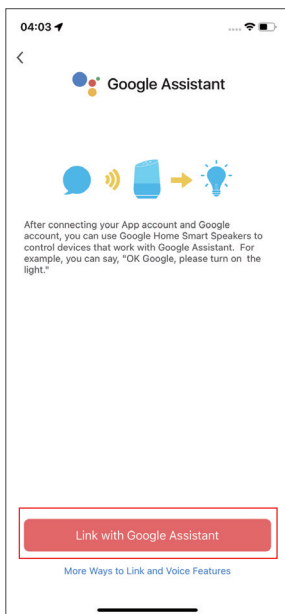
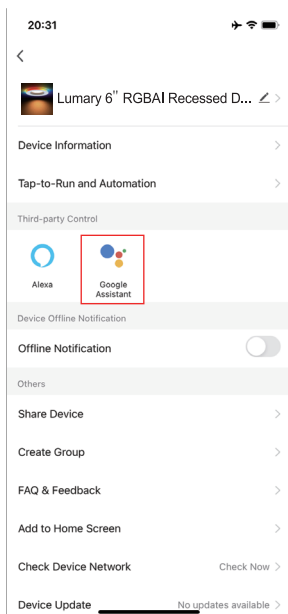

4. Click "Agree and link";

5. Linked successfully, when add new device, there is no need to link again, just discover new device in Google Home.

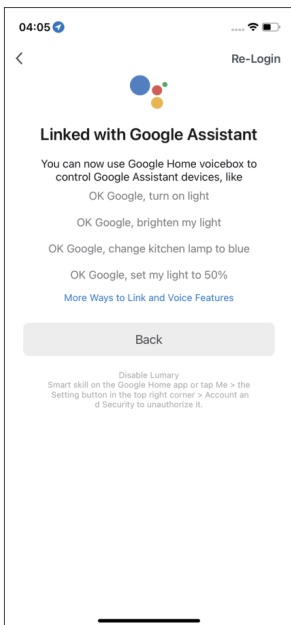
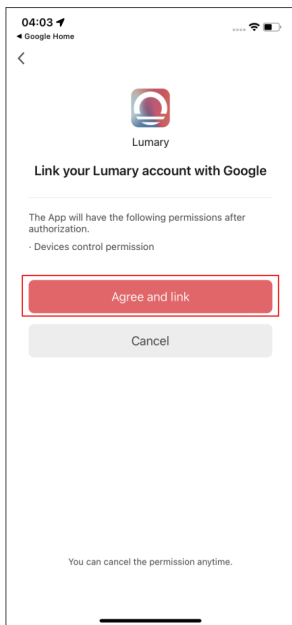



To control your Lumary smart device, just say "Hey Google", and ask.

Make sure your devices are already set up using the Lumary app.

Things you can say*:

"Hey Google, turn on all the lights in my bedroom."

"Hey Google, turn off the light."

"Hey Google, set the bedroom light to orange."

"Hey Google, turn off the coffee machine."

"Hey Google, set the living room to 50%."

"Hey Google, dim porch light."

*Some commands require compatible devices.

After Sales & Social Media

If you have any questions about product settings or operations, please feel free to reach out to us!

Customer Service Email:

support@lumary.tech

You can also find us on social media. Simply search for our username on your preferred platform, or scan the QR code for quick access.

- Facebook: @lumary.official
- X: @lumary_official
- Instagram: @lumary.official
- Pinterest: @lumary_official
- YouTube: @lumary.official
- Reddit: @Lumarysmartlight
- TikTok: @lumary.official



Facebook



Instagram



YouTube



TikTok



X



Pinterest



Reddit

Can't connect? Need help?



HAVING AN EASY TALK TO US BEFORE YOU RETURN
THE PRODUCT WILL FIX A PROBLEM MORE QUICKLY

Lumary support:

support@lumary.tech

Visit us at:

www.lumary.tech

www.lumarysmart.com