

INSTALLATION INSTRUCTIONS

TITAN[®] SERIES

MODEL ELT50, ELT50 N

CAUTION: For safety and proper operation, read and follow instructions carefully before installation.

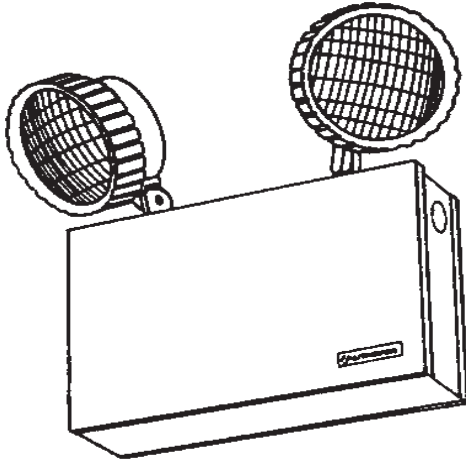

PARTS DESCRIPTION

- | | |
|-------------------------|-----------------|
| ① Housing | ⑥ Battery |
| ② Front cover | ⑦ Charger Board |
| ③ Lamp Head | ⑧ Ground Clip |
| ④ Keyhole Mounting Slot | ⑨ Ground Lead |
| ⑤ Oblong Mounting Slot | ⑩ Retaining Cap |
| | ⑪ Transformer |

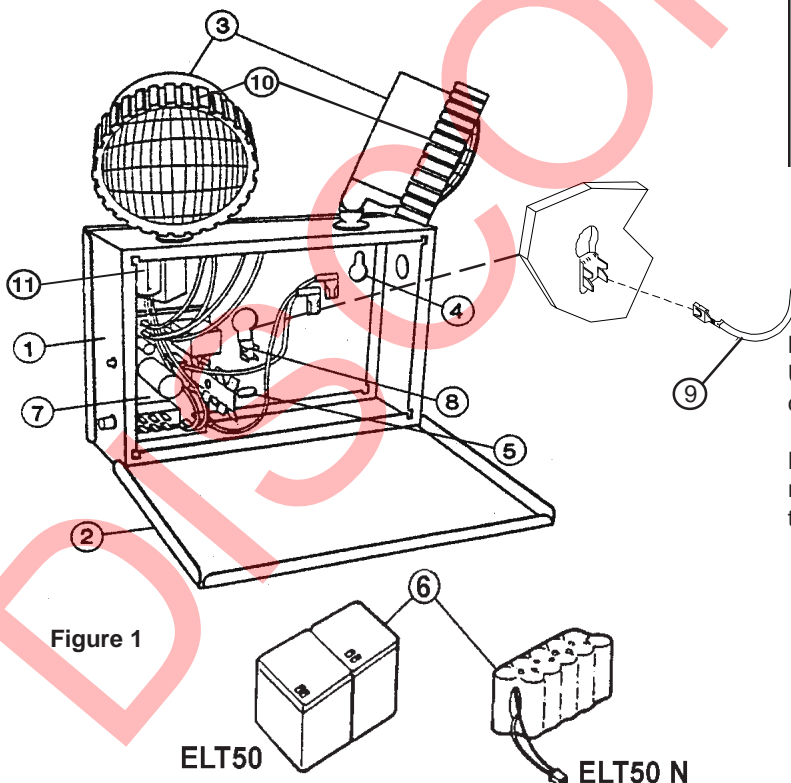

IMPORTANT SAFEGUARDS

1. **READ AND FOLLOW ALL SAFETY INSTRUCTIONS**
2. Do not use outdoors.
3. Do not let power supply cord touch hot surfaces.
4. Do not mount near gas or electric heater.
5. Use caution when servicing batteries. Battery acid can cause burns to skin and eyes. If acid is spilled on skin or in eyes, flush acid with fresh water and contact a physician immediately.
6. Equipment should be mounted in location and at heights where it will not readily be subjected to tampering by unauthorized personnel.
7. The use of accessory equipment not recommended by the manufacturer may cause an unsafe condition.
8. Do not use this equipment for other than intended use.
9. Before wiring to power supply, turn off electricity at fuse or circuit breaker.
10. Consult your local building code for approved wiring.
11. Fixture must be grounded to avoid potential electric shock.
12. Disconnect A.C. power and unplug battery before servicing.
13. All servicing should be performed by qualified personnel.
14. **CAUTION:** Halogen cycle lamp(s) may be used in this fixture to avoid shattering, do not operate lamp in excess of rated voltage. Protect lamp against abrasions, scratches and against liquids when lamp is operating. Dispose of lamps with care. Halogen lamps operate at high temperatures. Do not store or place flammable materials near lamps.

SAVE THESE INSTRUCTIONS

BEFORE INSTALLATION

Unit should be located to assure adequate clearance for front cover and lamp heads.

Do not position unit where it will be exposed to direct sunlight, radiators, or other heat sources. Prolonged exposure to high temperatures will shorten battery life and may void warranty.

CAUTION: Damage to battery will occur if battery is connected to charger board for a prolonged period of time without A.C. power provided.

MOUNTING TO WALL USING J-BOX

1. Remove all knockouts from rear of housing ①. Locate center 7/8" knockout over J-box.
2. Install fastener with a minimum pullout rating of 30 pounds in each keyhole mounting slot ④ and in lower oblong mounting slot ⑤ (see Fig. 1).

MOUNTING WITH SURFACE CONDUIT

1. Two 7/8" dia. knockouts are located on either side of housing ① for conduit connection. Remove keyhole mounting slot knockouts ④ and lower oblong mounting slot knockout ⑤ from rear of housing, and remove desired 7/8" knockout from side of housing.
2. Install fastener with a minimum pullout rating of 30 pounds in each keyhole mounting slot ④ and in lower oblong mounting slot ⑤ (see Fig. 1).

WIRING (Refer to Fig. 2,3,or 4)

1. Connect A.C. input as follows:
120V AC - Black and White leads
277V AC - Brown or Orange and White leads

NOTE: Unused lead must be properly capped with standard wirenut.

NOTE: Model ELT50 N is equipped with a terminal board for lamp, charger board, and battery connection (Refer to Fig. 2 and Fig. 3).

2. Place battery ⑥ inside housing ①, and connect battery terminals. In Model ELT50 N, battery is provided with double-stick tape. Remove paper backing from double-stick tape and secure battery in place.

CAUTION: Model ELT50 batteries are wired in series. Be sure to refer to wiring diagram Fig. 4 for proper connection of battery terminals.

3. Slide ground clip ⑧ onto slot in bottom of 7/8" knockout. Press flag terminal of green ground lead ⑨ onto flange of ground clip ⑧. Connect supply ground to green ground lead ⑨ using standard wirenut. For units that are mounted with surface conduit, attach ground clip and ground lead assembly to upper flanged lip of housing ①.

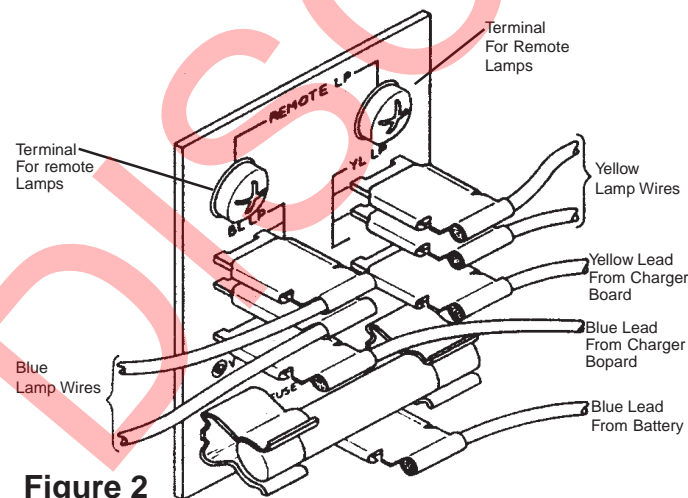

Figure 2

INSPECTION AND MAINTENANCE

NOTE: Emergency lighting systems should be tested as often as local codes require, or at least monthly, to ascertain that all components are operational.

- A. **NORMAL OPERATION:** When unit is functioning properly, with A.C. power provided, the "READY" light will be on.
- B. **TO TEST:** Push "TEST" button. D.C. lamps should come on and "READY" light should go out.
- C. **CHARGER BOARD REPLACEMENT:** Disconnect wiring as shown in Fig. 3, or Fig. 4. Charger board is secured to bracket with three nylon standoffs. Depress standoff locking flanges and lift charger board from unit. Install replacement charger board and reconnect wiring as shown in Fig. 3 or Fig. 4.
- D. **BATTERY REPLACEMENT:** Disconnect battery. Replace battery only with a manufacturer's recommended replacement. Reconnect battery as shown in Fig. 3 or Fig. 4.
- E. **TRANSFORMER REPLACEMENT:** Disconnect wiring as shown in Fig. 3 or Fig. 4. Remove mounting screws holding transformer to housing. Replace transformer with manufacturer's recommended replacement and secure to housing using mounting screws, and clips from old transformer.
- F. **LAMP REPLACEMENT:** For Standard Par 36 lamp head, replace lamp as follows:

Remove treaded retaining cap ⑩ by rotating counter-clockwise. Disconnect lamp leads and reconnect an identical replacement lamp. Replace retaining cap and rotate clockwise to secure in place.

For Square Sealed Beam Lamp head (option SSB), replace as follows:

- (1) Locate snaps along seam of lamp housing, insert a flat blade screwdriver, and twist to release each snap and separate two halves of lamp housing.
- (2) Remove leads from lamp and reconnect an identical replacement lamp.
- (3) Slide replacement lamp into one half of lamp housing so that square stud on rim of lamp fits into notched rib inside lamp housing.
- (4) Slide other half of lamp housing over lamp and snap upper or lower portion of housing together. Locate unsnapped portion of housing onto pedestal swivel track. Making sure that lamp leads are routed through hole in rear of lamp housing, snap housing completely shut.

For Designer Square (Option DS), Lamphead replace lamp as follows:

- (1) On each side of lens is a tab that snaps into the housing. Using a flat blade screwdriver, carefully pry one tab from housing to remove lens.
- (2) Remove lamp from socket and replace with an identical lamp.
- (3) Replace lens, snapping tabs firmly into grooves in side of lamp housing.

For Metal (Option MT) lamp head replace lamp as follows:

Remove lamp retaining ring. Remove leads from lamp and reconnect an identical replacement lamp. Replace retaining ring.

Figure 3
WIRING DIAGRAM:
MODEL ELT50 N

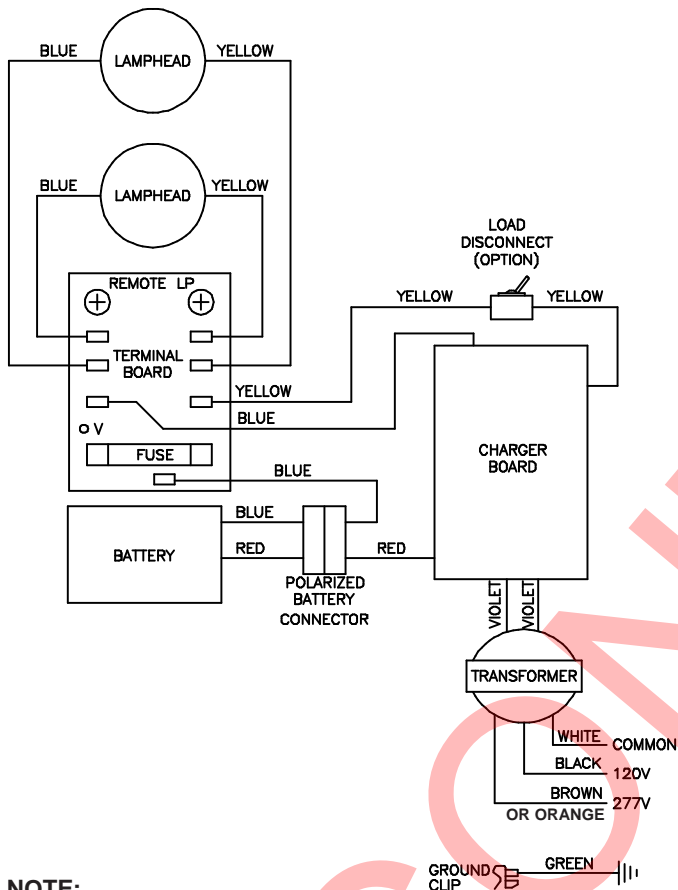

NOTE:

Use screw terminals on terminal board for remote lamp connection with Model ELT50 N.

NOTE:

This equipment to be connected to unswitched circuit only.

NOTE:

Allow battery to charge 24 hours before initial testing and 168 hours to fully charge battery.

Figure 4
MODEL ELT50
WITH OPTIONS

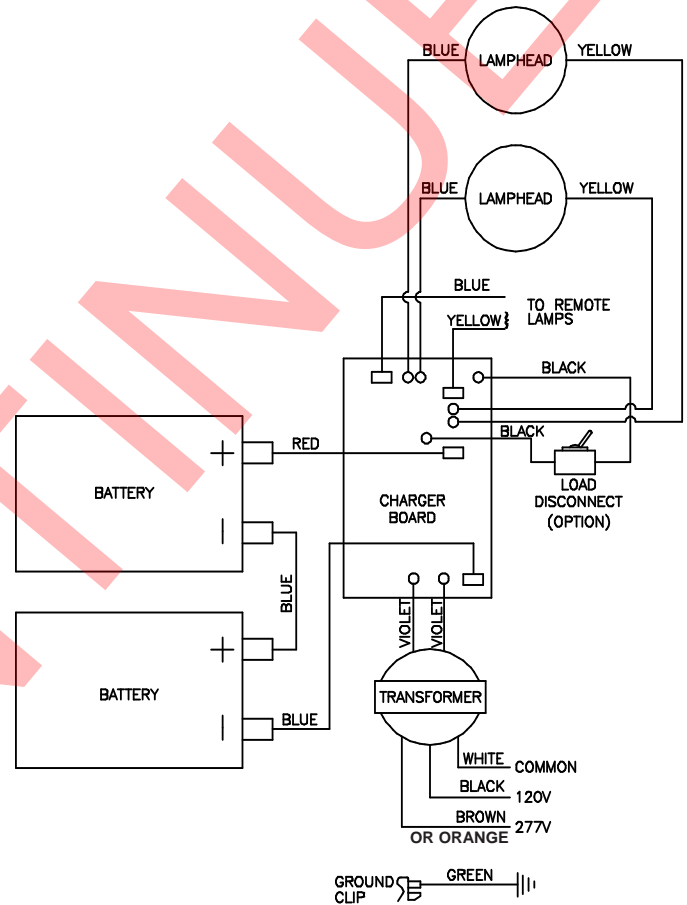

NOTE:

Designer Square (option DS) lamp leads may be red and blue.

NOTE:

Metal lampheads (option MT) lamp leads may be black.

Important Battery Information:

Batteries are perishable items. For best results, it is recommended that the battery receive an initial charge within the first 18 months of the manufacture date of the fixture. The mfg date can be found on the outside of the unit packaging and on the UL label as part of the Date Code/Series. Note: First two digits in the date code will represent the year and the second two digits will represent the month. Batteries beyond the initial charge recommendation time frame can often times be returned to full capacity by fully charging the battery shortly after installation. If the battery will not fully charge after the initial charge, replacing the battery with a fresh battery will resolve the issue.



An Acuity Brands Company

EMERGENCY LIGHTING SYSTEMS

TEL: 800-334-8694 Fax: 770-981-8141 www.lithonia.com

EMCSA00590
REV C