

# Quick Setup Instruction

This instruction helps you verify whether the unit is working properly after unboxing.

## 1. Install Batteries for Outdoor Sensor Array



Remove the battery door on the back of the sensor by removing the set screw.



Inserting 3x AA batteries in the battery compartment.

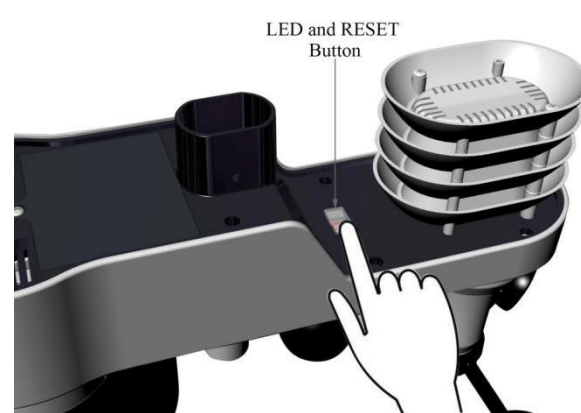

Close the battery door and Tighten the set screw. The sensor LED indicator will light for 3 seconds, and then flash once per 16 seconds thereafter. Each time it flashes, the sensor is transmitting data.

## 2. Plug in Adapter for Indoor Console



Pull out the stand on the back.



Connect the indoor console with the power adaptor.

**The Console** will instantly display indoor information, Integrated outdoor sensor data will update on the display within a few minutes. Do not press any buttons until the outside transmitter reports in, otherwise the outdoor sensor search mode will be terminated.  
**When** the outdoor transmitter data has been received, the console will automatically switch to the normal mode from which all further settings can be performed. While in the search mode, the remote search icon will be constantly displayed.



No Outdoor Sensor Data



Outdoor Sensor Data Updates

## 3. Sensors Verification

Put the outdoor sensor array and the indoor console at the same location in good ventilating condition.

**1. Verify temperature and humidity.** The difference between indoor and outdoor temperatures should be within 4°F/2°C. The difference between indoor and outdoor humidity should be within 10%. Usually the indoor temperature is a little bit higher than outdoor temperature due to warming up effect of the backlight. Let the unit stabilize for at least 30 minutes.

**2. Verify wind speed and wind direction.** Spin the wind cup and the wind vane and make sure the wind speed and wind direction information on display updates.

**3. Verifying Rain gauge.** Tip the sensor array back and forth several times. You should hear a “clicking” sound within the rain gauge. Verify the rain reading on the display console is not reading 0.00. Each “click” represents 0.01 inches of rainfall.

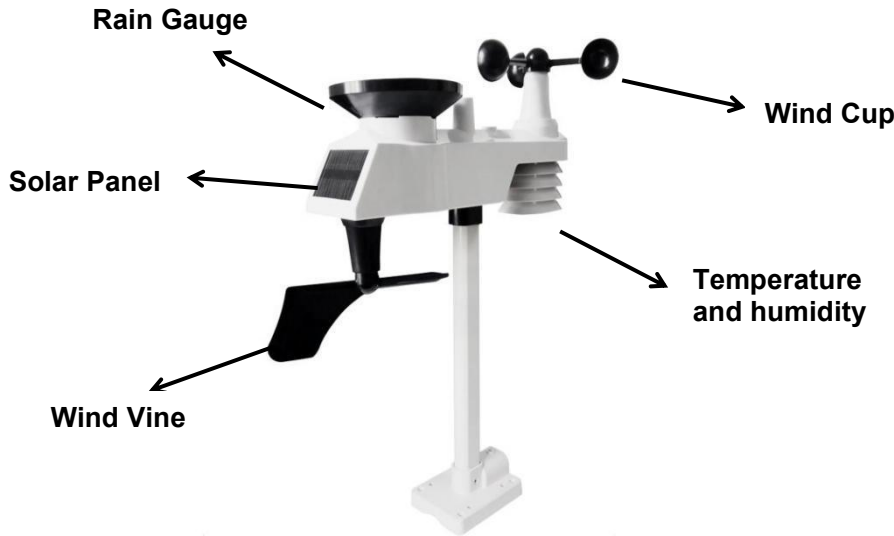

**4. Outdoor Integrated Sensor Installation**

Fasten the integrated transmitter to mounting pole brackets with foot-mounting, two  $\varnothing 3$  bolts and M3 nuts. Tighten the mounting pole to your existing mounting pole with the four  $\varnothing 5$  Bolts and M5 Nuts assembly, or fix on the wall with four tapping screw. Please ensure that the outdoor transmitter is fixed particularly tightly, otherwise windy conditions cause the transmitter to shake and thus misread the rainfall data.

*Install the sensor array at least four times the distance of the height of the tallest obstruction.*



**Horizontal Installation**

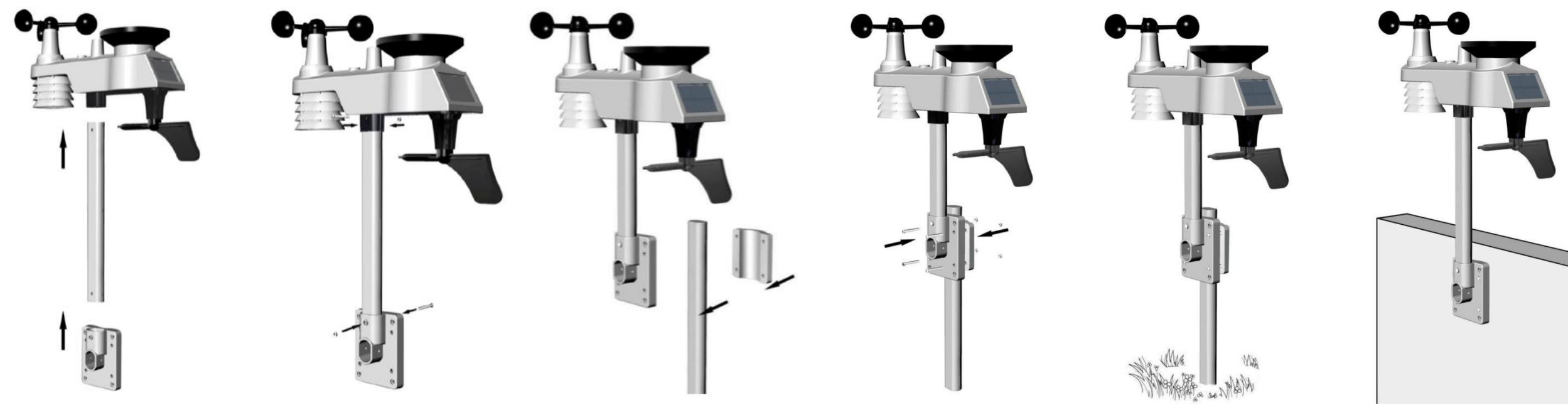

**Vertical Installation**