

GREY CORDLESS BRUSHED MOTOR HANDHELD VACUUM

3000098 - Instruction Manual

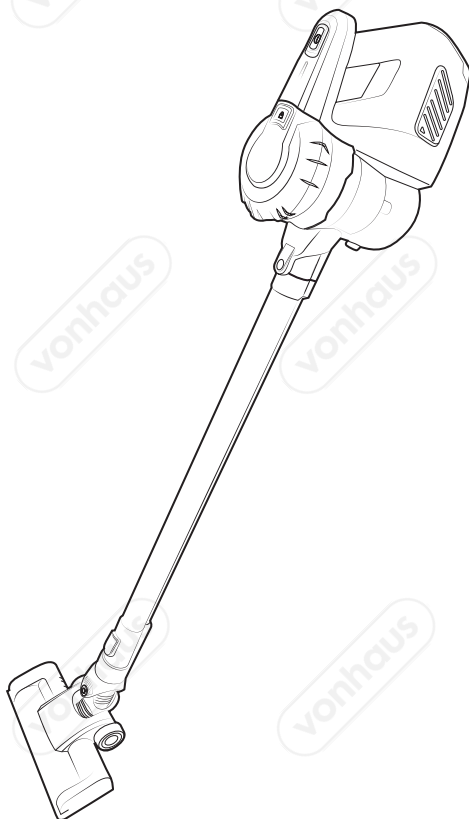

CONTENTS

Safety Instructions

1

Safety Instructions

2

Safety Instructions

3

Specifications

4

Charging, Handheld Useage

5

Upright Useage, Attchment Useage

6

Operation, Emptying the Dust Tank

7

Removing the Filters, Cleaning the Filters

8

Cleaning & Care, Wall Mounting

9

Troubleshooting

10

User Notes

11

Warranty

12

WARNING

PLEASE READ THESE INSTRUCTIONS CAREFULLY AND KEEP FOR FUTURE REFERENCE

INTENDED USE.

The appliance is intended for domestic use only. It is not intended for use in commercial or industrial environments and is not suitable for use outdoors or on wet surfaces.

This appliance is not intended for use by persons (including children) with reduced physical, sensory or mental capabilities, or lack of experience and knowledge, unless they have been given supervision or instruction concerning use of the appliance by a person responsible for their safety.

GENERAL PRECAUTIONS.

Do not allow the appliance to be used as a toy. Close attention is necessary when used near children.

If the appliance is not functioning properly, has been dropped, damaged, left outdoors or immersed in liquid, do not use, contact DOMU Brands Customer Services.

Do not use the appliance if any parts appear to be faulty, missing or damaged.

Ensure all parts are securely attached before using the appliance.

CABLES AND PLUGS.

Do not handle the plug or the Charger with wet hands.

Check to ensure your electricity supply matches that shown on the rating plate. The appliance must only be used as rated.

Keep the cable away from heated surfaces.

Do not run the appliance over the charging cable.

Do not unplug by pulling on the cable. To unplug, grasp the plug, not the cable.

Do not use with a damaged cable or plug. If the supply cable is damaged, it must be replaced by a qualified engineer or an authorised service agent in order to avoid a hazard.

RISK OF PERSONAL INJURY.

Charge the appliance 4-6 hours before initial use.

Never use the appliance without the Filter Assembly and HEPA Filter in place.

Do not use the appliance in areas where flammable or combustible liquids may be present.

When using the appliance for the first time, a smell or vapour may be given off. This will dissipate after a few uses and is normal.

Keep hair, loose clothing, fingers and all parts of the body away from openings and moving parts.

Do not insert any objects into openings or cover the appliance.

Take extra care when operating on stairs.

Do not use the appliance with no Dust Container attached.

Use only on dry, indoor surfaces.

In order to prevent damage to the appliance and reduce risk of fire and/or personal injury, the following objects are strictly prohibited from being sucked up:

- Any large or broken objects such as glass
- Anything that is burning or smoking such as cigarettes, matches or hot ashes
- Liquid spills

WARNING

PLEASE READ THESE INSTRUCTIONS CAREFULLY AND KEEP FOR FUTURE REFERENCE

- Reactive liquids (solvents, corrosives, detergents)
- Flammable or explosive substances such as alcohol, thinners etc.

Store the appliance safely after use to prevent any accidents.

Discontinue use if the battery runtime changes abruptly or the battery has been damaged.

Use only the charger supplied by DOMU Brands. If other chargers are used, this can cause the battery to fail causing damage to the battery, appliance or personal property.

Do not carry out any maintenance or repair work other than that shown in this manual, or as advised by the DOMU Brands Customer Care Helpline.

Store the appliance indoors, in a cool, dry place.

Use only as described in this manual and with DOMU Brands recommended attachments only.

BATTERY/CHARGER USE AND CARE.

The battery pack is not fully charged out of the box.

Recharge only with the charger specified by the manufacturer. A charger that is suitable for one type of battery pack may create a risk of fire when used with another battery pack.

Use power tools only with specifically designated battery packs. Use of any other battery packs may create a risk of injury and fire.

An extension cord should not be used unless absolutely necessary. Use of an improper extension cord could result in the risk of fire or electric shock.

The charger is not intended to be used

for any purpose other than charging the battery pack for this product. Any other use may result in risk of fire or electric shock.

First read the safety instructions and then follow the charging notes and procedures.

The charger is only designed to operate on standard household electrical power. Do not attempt to use it on any other voltage.

Never attempt to connect 2 chargers together.

Do not place any object on top of the charger or place the charger on a soft surface that may result in excessive internal heat.

Do not attempt to disassemble the charger. Take it to an electrician or power tool repairer when service or repair is required. Incorrect reassembly may result in a risk of electric shock or fire.

Do not expose the battery to direct sunlight for long periods of time.

Protect the battery and charger against water and moisture.

Protect the battery from heat and fire.

Place the charger in a position away from any heat source.

Remove the battery when the appliance is not in use or stored for extended periods of time.

When the battery pack is not in use, keep it away from other metal objects such as paper clips, coins, keys, nails, screws or other small metal objects that can make a connection from one terminal to another. Shorting the battery terminals together may result in burns or a fire.

To facilitate cooling of the battery pack after use, avoid placing the charger or battery pack in a warm environment such as a metal shed or an uninsulated trailer.

To reduce the risk of electric shock,

⚠ WARNING ⚠

PLEASE READ THESE INSTRUCTIONS CAREFULLY AND KEEP FOR FUTURE REFERENCE

unplug the charger from the outlet before attempting any cleaning. Removing the battery pack will not reduce this risk. To reduce risk of damage to the electric plug and cord, pull by the plug rather than the cord when disconnecting the charger.

Never attempt to open the battery pack for any reason or if the plastic housing of the battery pack breaks or cracks, immediately discontinue use and do not recharge.

Failure to follow these instructions will invalidate any guarantee.



1. Do not operate the Vacuum too close to heaters, radiators, cigarette butts and ect.



2. Never operate or plug in the Vacuum with wet/damp hands.



3. Remove any sharp or large objects before vacuuming.



4. Do not pull the plug away from the socket using the cable, always pull using the plug.

SPECIFICATION

VOLTAGE

V
22.2

BATTERY POWER

mAh
2200

WORKING TIME

MINS
25 High Power
40 Low Power

CHARGING TIME

HOURS
4

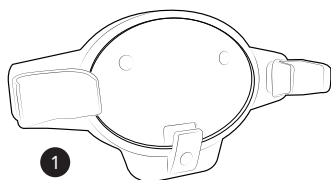

1



2

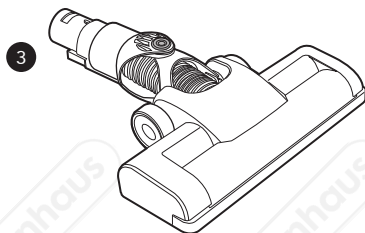

3

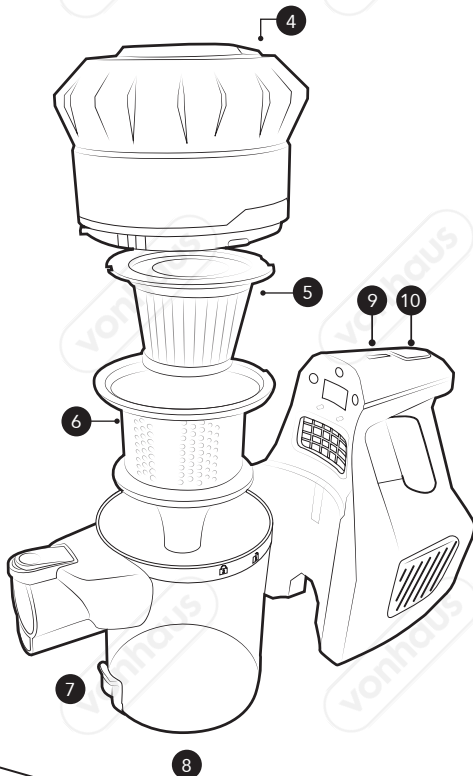

4

5

6

7

8

9

10

1. Wall Mount
2. Charger
3. Floor Brush
4. Dust Tank Release
5. Fabric Filter
6. Filter
7. Dust Tank Empty Clip
8. Dust Tank Cover
9. Indicator Light
10. On/Off Switch
11. Vacuum Tube
12. Long Crevice Tool
13. Brush/Crevice Tool

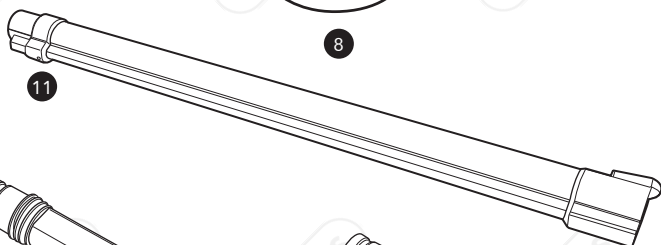

11

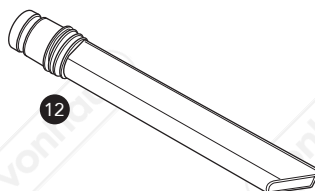

12

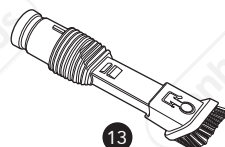

13

CHARGING

Charge the appliance fully before first use

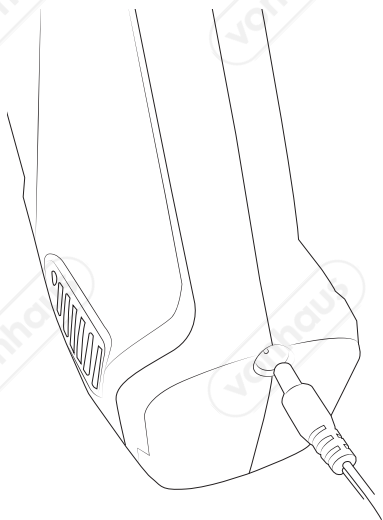

Insert the Charger (2) into the Charger Input.

Ensure it is positioned correctly for charging.

The Indicator Light (9) located on top of the Vacuum will flash red while charging.

Once the Vacuum is fully charged the light will illuminate a solid green.

Charge the Vacuum for up to 4 hours.

NOTE: It is normal for the Charger (2) to become warm to the touch during charging periods.

DO NOT: unplug the Charger (2) by pulling on the power cord.

Always unplug the Charger (2) in the event of prolonged absence (holidays, etc.). Recharge the appliance again before use as batteries may self discharge over increased periods of storage.

IMPORTANT! For best performance, the Charging Pin Connector must be clean and free from dust and dirt. The life expectancy of the battery will vary dependent on use.

USAGE - HANDHELD

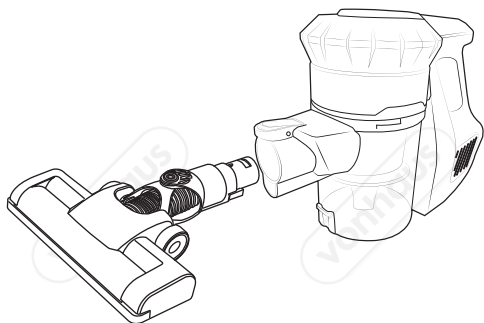

 Use only the attachments that comes supplied with this appliance.

The Handheld assembly uses the Motor Unit and the Floor Brush (3).

To assemble, align the clip on the Floor Brush (3) with the clip on the Handle and Motor Unit and push in until it clicks audibly into place.

To remove the Floor Brush (3) press the clip on the Handle and Motor Unit to release.

USAGE - UPRIGHT

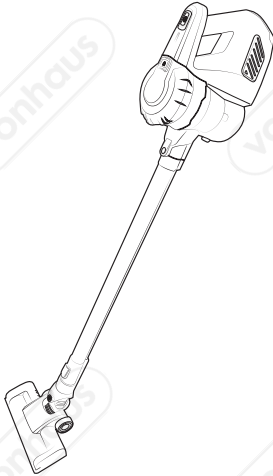

⚠ Use only the attachments that comes supplied with this appliance.

The upright assembly uses the Vacuum Tube (11) , the Motor Unit and the Floor Brush (3).

Align the clip on the Vacuum Tube (11) with the connection clip on the Motor Unit and push in until it audibly clicks into place.

To attach the Floor Brush (3), align the clip on the Floor Brush with the Vacuum Tube connection clip and push in until it audibly clicks into place.

To remove the Vacuum Tube (11) press the release clip on the Handle and Motor Unit.

To remove the Floor Brush (3) press the release clip on the Vacuum Tube (11).

USAGE - ATTACHMENTS

Use only the attachments that comes supplied with this appliance.

To assemble, align the clip on either the Long Crevice Tool (12) or Brush/Crevice Tool (13) on the Motor Unit and push in until it audibly clicks into place.

To remove either attachment press the Clip on the Handle and Motor Unit to release.

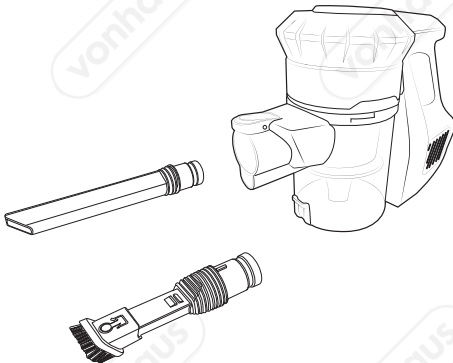

⚠ Use only the attachments that comes supplied with this appliance.

NOTE The Vacuum Tube (11) may be used to extend reach as required.

OPERATION

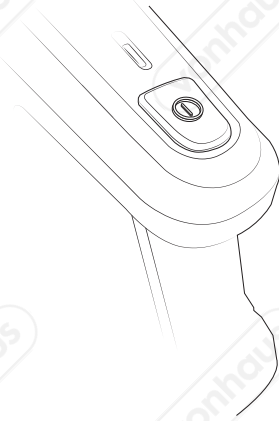

To power on push the ON/OFF Button **(10)** once.

The Indicator Light **(9)** will illuminate Green to indicate the vacuum is On, and operating in Quiet Mode.

To increase the power to maximum setting, press the On/Off Button for a second time.

To switch off, press the On/Off Button once again.



WARNING This unit is designed for dry vacuuming use only.
Do not use to pick up liquids or on wet surfaces.
Do not pick up anything that is burning or smoking.

EMPTYING THE DUST TANK

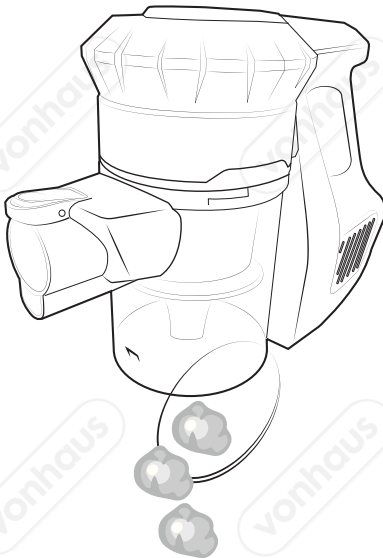

Release the Dust Tank Empty Clip **(7)** over a waste disposal bin to release the debris.

Re-close the Dust Tank Cover **(8)** when finished. An audible click will confirm the latch is securely closed.

REMOVING THE FILTERS

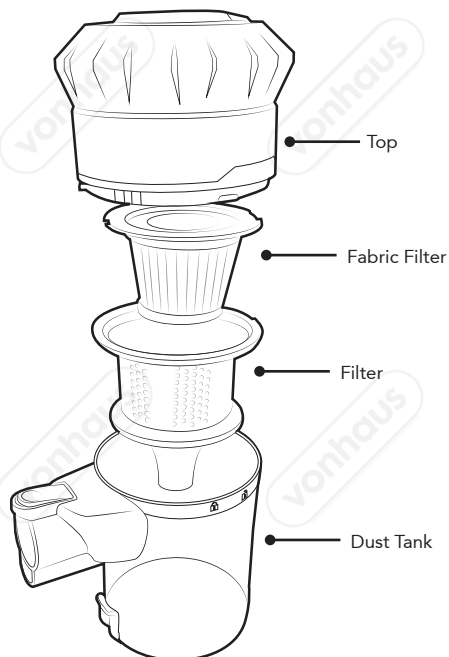

Press Down the Dust Tank Release (4), and remove the Main Unit.

Twist the top of the Dust Tank to the left to access the Filters.

Remove the Fabric Filter (5) and Filter (from the Dust Tank).

NOTE: Take care when re-assembling the Filters ensure the Filter is the correct way around and the cavity passes the Pins.

CLEANING THE FILTERS

Rinse both the Filters separately under cold water as required.

Dry the Filters with a soft dry cloth.

IMPORTANT! Never replace the Filters unless it is completely dry.

Allow the Filters to dry fully for at least 24 hours in natural sunlight.

IMPORTANT! Never force dry the Filters, as this may cause irreversible damage to the filter.

IMPORTANT! Never operate the appliance without the Filters in place.

NOTE For Best cleaning results, filters require cleaning at least every 3 months, depending on use.

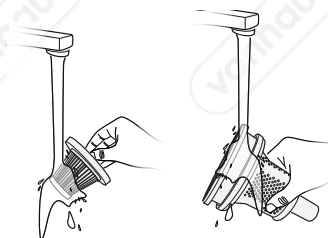

24 Hours

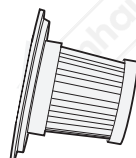

CLEANING & MAINTENANCE

BRUSH REMOVAL & CLEANING

Slide the Locking Clip away from the Brush Head to release the Brush.

IMPORTANT Always ensure the Vacuum is switched off before performing maintenance and cleaning.

⚠ WARNING Always detach the Floor Brush (3) from the Handle and Motor Unit before removing/cleaning the Brush Head.

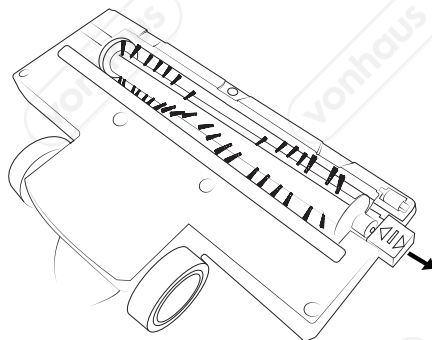

WALL MOUNTING

The Wall Mount (1) is wall mountable.

Accurately mark up the area you wish to place the Wall Mount (1) on the wall.

⚠ IMPORTANT Ensure there are no cables or pipes directly behind the area of the wall the charging dock is to be placed.

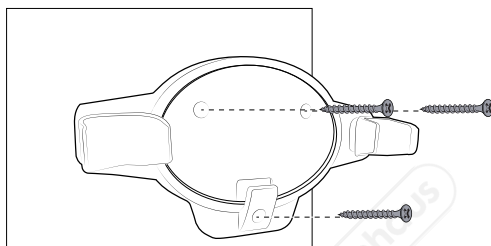

* Wall Plugs & Screws are not supplied

Store the Vacuum Cleaner and Accessories onto the Wall Mount.

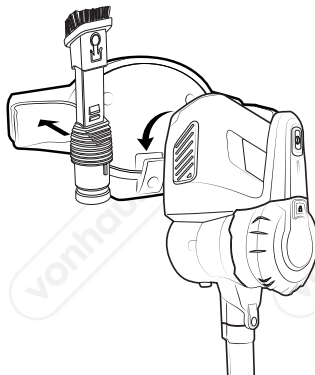

TROUBLESHOOTING

PROBLEM	SOLUTION
NO POWER	<p>Check the appliance is fully charged before use</p> <p>Empty Dust Tank and clean the Filters.</p>
LOSS OF SUCTION	<p>Check openings for any blockages. Unplug and remove if necessary.</p> <p>Ensure the Filters are correctly in place.</p> <p>Empty Dust Tank and clean the Filters.</p> <p>Contact DOMU Brands Customer Services if the Filters has become damaged.</p> <p>Recharge for 4-5 hours.</p>
FLOOR BRUSH NOT ROTATING	<p>Remove the Brush from the Floor Brush and check for any obstructions such as tangled hair or clogged dirt.</p> <p>Ensure the Brush has been correctly inserted into the Floor Brush and locked into position using the Locking Clip.</p> <p>The appliance may need recharging. Connect to the Charger and charge the appliance fully until the fully charged.</p>
BATTERY INDICATOR LIGHT ILLUMINATING RED DURING USE	<p>Floor Brush is jammed. Switch off the Vacuum and remove the blockage from the Floor Brush.</p>

USER NOTES

vonhaus

vonhaus

vonhaus

vonhaus

vonhaus

vonhaus

vonhaus

vonhaus

vonhaus

vonhaus

vonhaus

vonhaus

vonhaus

vonhaus

vonhaus

vonhaus

CUSTOMER SERVICES

If, for any reason you are experiencing difficulty using this appliance, please contact **hello@domu.co.uk**

DISPOSAL INFORMATION

Please recycle where facilities exist. Check with your local authority for recycling advice.

WARRANTY

To register your appliance and find out if you qualify for a free extended warranty, go to:

www.VonHaus.com/warranty

Please retain a proof of purchase receipt or statement as proof of the purchase date.

The warranty only applies if the appliance is used solely in the manner indicated in this manual and all instructions have been followed accurately. Any abuse of the appliance or the manner in which it is used will invalidate the warranty.

Returned goods will not be accepted unless re-packaged in its original packaging and accompanied by a relevant and completed returns form. This does not affect your statutory rights.

No rights are given under this warranty to a person acquiring this appliance second-hand or for commercial or communal use.

COPYRIGHT

All material in this instruction manual are copyrighted by DOMU Brands Ltd.

Any unauthorised use may violate worldwide copyright, trademark, and other laws.

VonHaus.com

Thank you for purchasing the Grey Cordless Handheld Vacuum.

VonHaus is a registered trademark of DOMU Brands Ltd.
Made in China for DOMU Brands Ltd M24 2RW.

VonHaus