

COFFEE MAKER

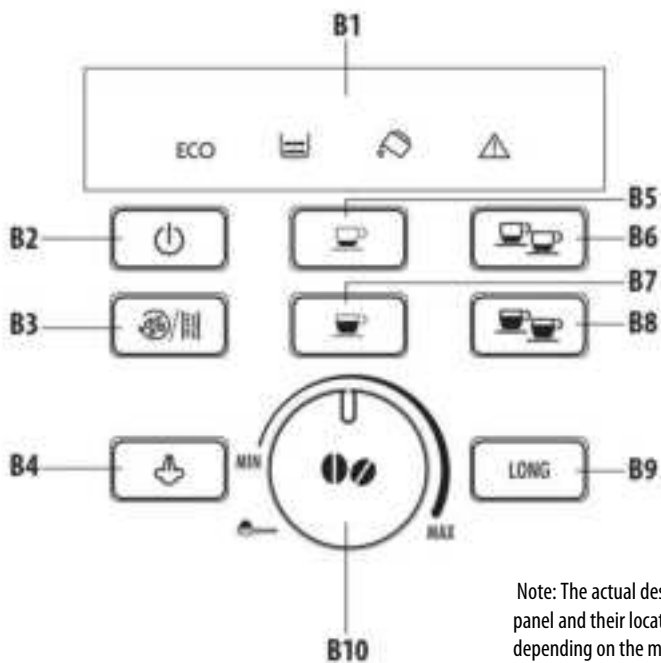

DeLonghi

"Recipe book not included"

B

Note: The actual descriptions of control panel and their locations may vary depending on the model.

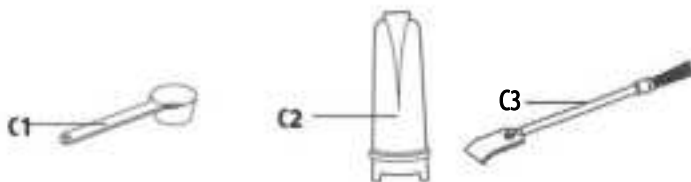
C

Accessory type and quantity may vary depending on the model

A

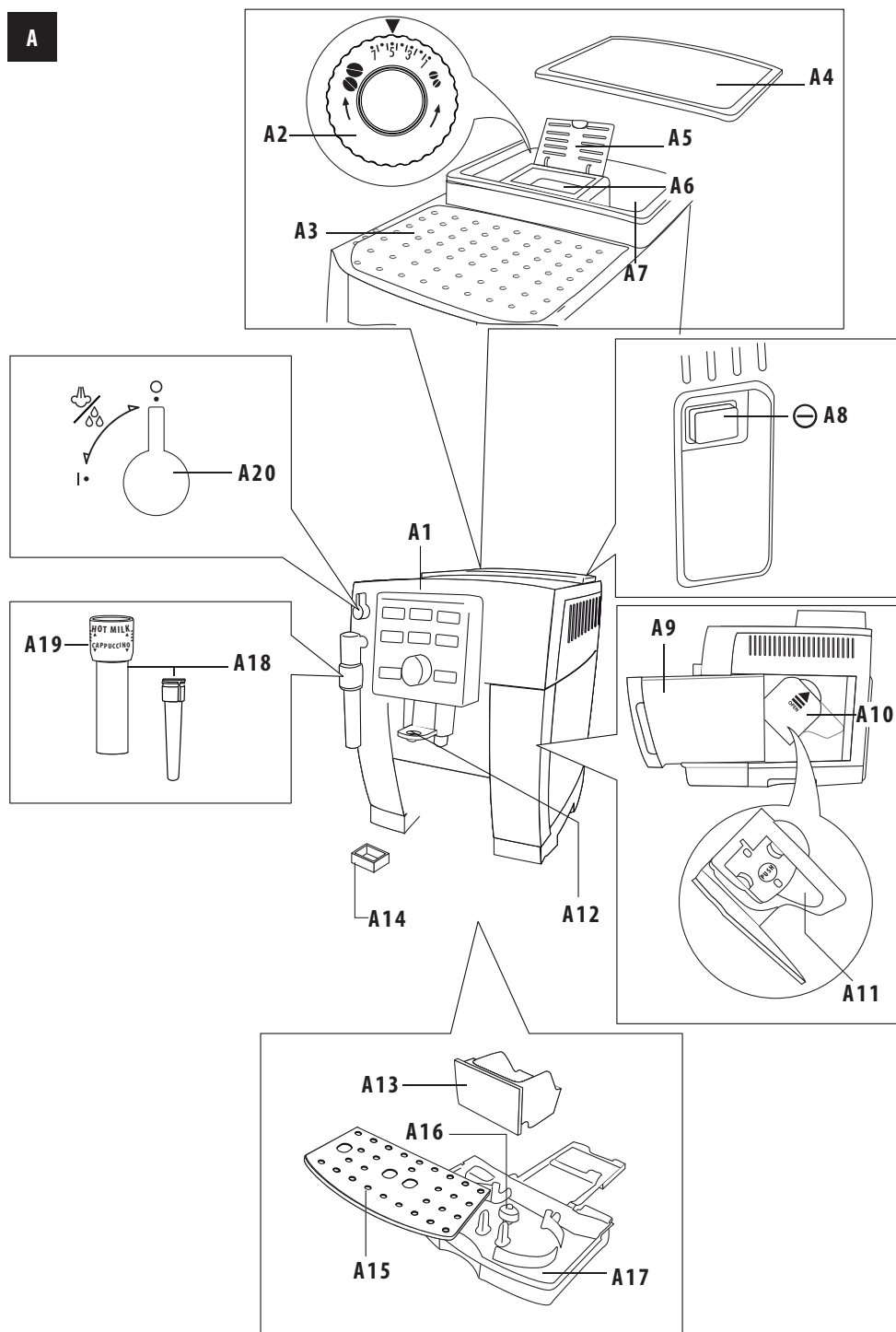

The images shown here are for illustrative purposes only and may be subject to change.

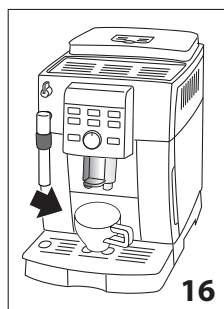
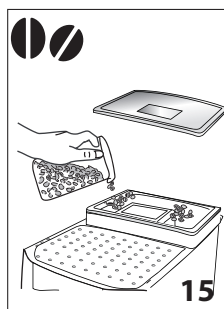
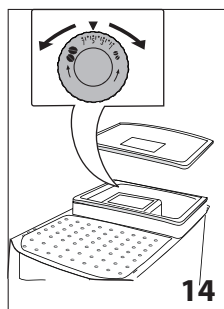
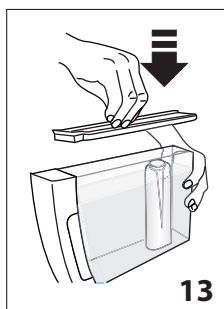
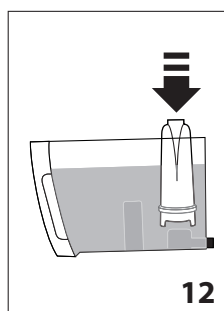
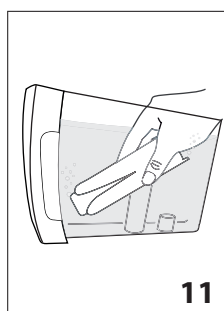
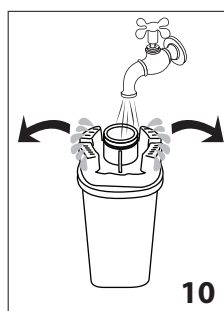
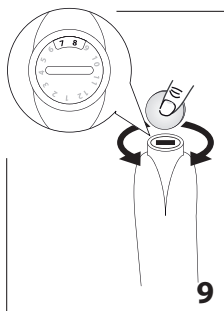
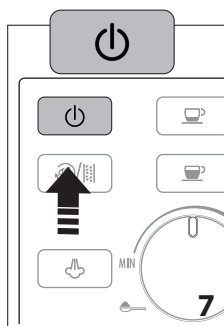
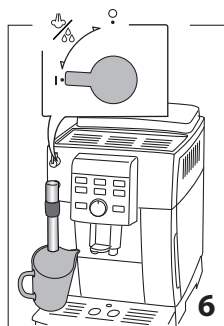
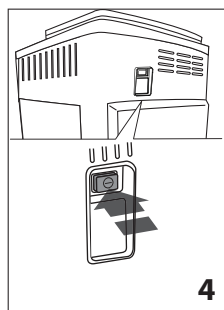
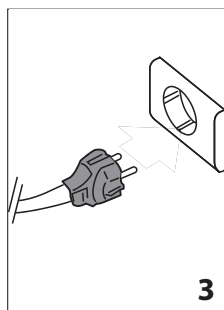
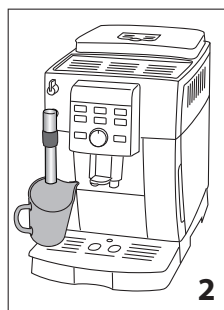
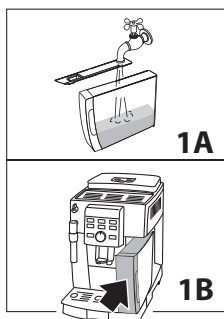

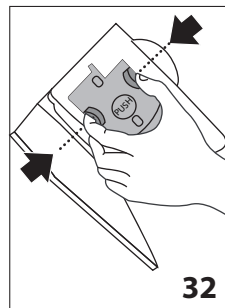
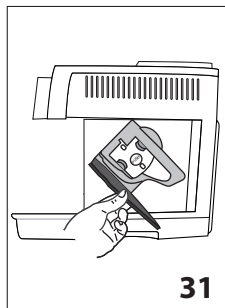
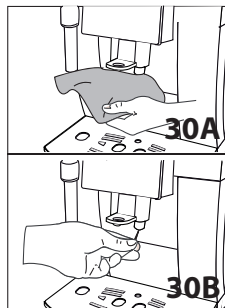
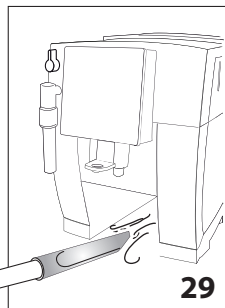
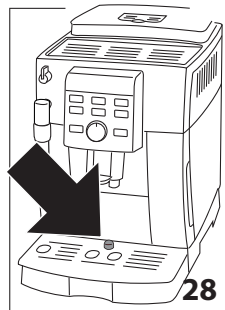
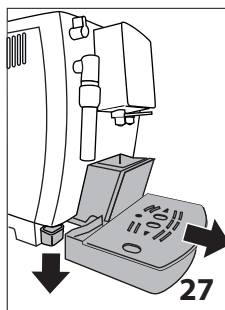
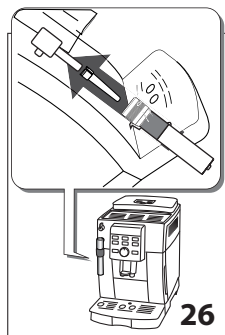
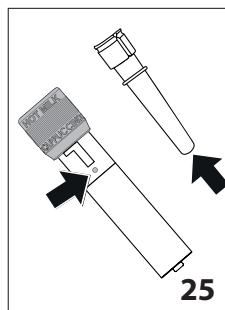
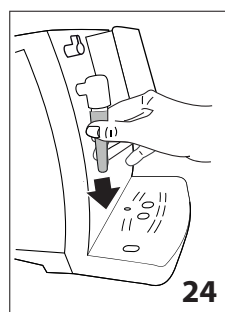
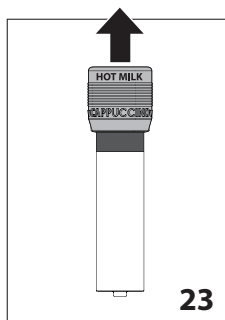
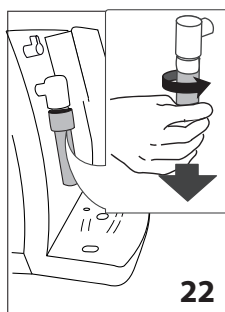
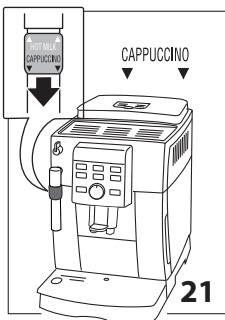
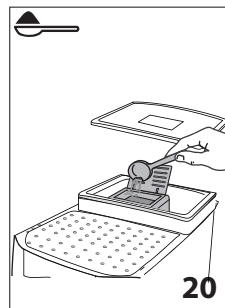
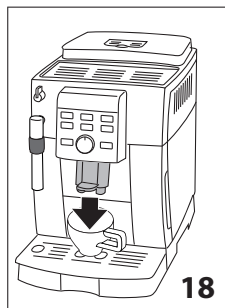
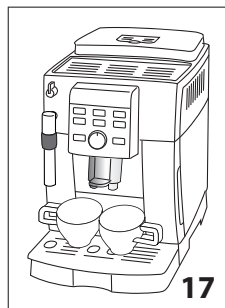

1. IMPORTANT SAFEGUARDS

When using electrical appliances, basic safety precautions should always be followed, including the following.

- Read all instructions carefully.
- Make sure the voltage of your electrical system corresponds to the voltage shown on the bottom of the machine.
- Do not touch hot surfaces. Use handles or knobs.
- To protect against fire, electrical shock and personal injury, do not immerse cord, plug or appliance in water or other liquid.
- Keep the appliance out of the reach of children and do not leave appliance unattended while in operation.
- Unplug from the outlet when not in use and before cleaning.
- Do not operate with a damaged cord or plug, or after the appliance malfunctions, or has been damaged in any manner.
- The use of accessory attachments not recommended by the manufacturer may result in fire, electrical shock, or personal injury.
- Do not use outdoors.
- Make sure the power cord does not hang over the edge of the table or counter-top to avoid getting accidentally caught or entangled.
- Do not place the appliance or its electrical parts on or near electric stoves, cooking surfaces, or gas burners.
- Plug cord into the wall outlet. To disconnect, first turn machine "off", then remove plug from wall outlet.
- Do not use the appliance for other than the intended use. This appliance is to be utilized for domestic use only. The manufacturer declines all responsibility for any damage caused by improper, incorrect, or irresponsible use.

WARNING: To reduce the risk of fire or electric shock, do not remove the cover or the exterior of the unit. Don't attempt to repair or modify the machine, doing so will void the warranty.

SAVE THESE INSTRUCTIONS

THIS APPLIANCE IS FOR HOUSEHOLD USE ONLY

1.1 Short cord instructions

- A short power cord is provided to reduce risks resulting from becoming entangled in or tripping over a longer cord.
- Longer, detachable power supply cords or extension cords are available and may be used if care is exercised in their use.
- If an extension cord is used, the marked electrical rating should be at least as great as the electrical rating of the appliance. If the appliance is provided with 3- wire, grounding type cord, the extension should be a GROUNDING TYPE 3 - WIRE CORD. The longer cord should be arranged so that it will not drape over the counter-top or table top where it can be pulled on by children or tripped over.
- Your product is equipped with a polarized alternating current line plug (a plug having one blade wider than the other). This plug will fit into the power outlet only one way. This is a safety feature. If you are unable to insert the plug fully into the outlet, try reversing the plug. If the plug should still fail to fit, contact your electrician to replace your obsolete outlet. Do not defeat the safety purpose of the polarized plug.

2. INTRODUCTION

Thank you for choosing the ECAM2312X automatic coffee and cappuccino maker.

We hope you enjoy using your new appliance.

Take a few minutes to read these instructions.

This will avoid all risks and damage to the machine.

2.1 Symbols used in these instructions

Important warnings are identified by these symbols.

It is vitally important to observe these warnings.



Danger!

Failure to observe the warning could result in life threatening injury from electric shock.



Important!

Failure to observe the warning could result in injury or damage to the appliance.



Danger of burns!

Failure to observe the warning could result in scalds.



Please note:

This symbol identifies important advice or information for the user.

2.2 Letters in brackets

The letters in brackets refer to the legend in the Description of the Appliance.

2.3 Troubleshooting and repairs

In the event of problems, first try and resolve them following the information given in the section "16. EXPLANATION OF LIGHTS" and "17. TROUBLESHOOTING". If this does not resolve the problem or you require further information, Contact a service center.







3. DESCRIPTION

3.1 Description of the appliance

- A1. Control panel (see "3.2 Description of the control panel")
- A2. Grinding adjustment dial
- A3. Cup shelf
- A4. Beans container lid
- A5. Pre-ground coffee funnel lid
- A6. Pre-ground coffee funnel
- A7. Beans container
- A8. Main switch
- A9. Water tank
- A10. Infuser door
- A11. Infuser
- A12. Coffee spouts (adjustable height)
- A13. Coffee grounds container
- A14. Condensate tray
- A15. Cup tray
- A16. Drip tray water level indicator
- A17. Drip tray
- A18. Cappuccino maker
- A19. Cappuccino maker selection ring
- A20. Steam/hot water dial

3.2 Description of the control panel

The lights on the buttons come on steadily or flash as appropriate. The meanings are indicated in brackets in the description.

- B1. Indicator light panel (see "3.4 Description of lights")
- B2.  button: to turn the appliance on and off (*light flashing - the appliance is heating up; light on - the appliance is ready for use*)
- B3.  button: to rinse or descale the appliance (*white light on - the appliance is rinsing; red and white lights flashing alternately - the appliance needs descaling*)
- B4.  button: to deliver steam to make cappuccino and milk based coffees (*light on - the "steam" function has been selected; light flashing - you must turn the steam dial; light fading - the appliance is heating up*)
- B5.  button: to make 1 cup of short espresso coffee (*light on - this setting has been selected*)
- B6.  button: to make 2 cups of short espresso coffee (*light on - this setting has been selected*)
- B7.  button: to make 1 cup of long espresso coffee (*light on - this setting has been selected*)
- B8.  button: to make 2 cups of long espresso coffee (*light on - this setting has been selected*)

B9. **LONG** button: to make 1 cup of LONG coffee (*light on - this setting has been selected*)

B10. Selection dial: turn to select coffee taste or to use pre-ground coffee

3.3 Description of the accessories

- C1. Coffee measure
- C2. Water softener filter
- C3. Cleaning brush

3.4 Description of lights



An alarm is displayed on the control panel (see section "16. EXPLANATION OF LIGHTS").



Light on: the grounds container is missing and must be inserted;

Light flashing: the grounds container is full and must be emptied.



Light on: the water tank is missing;

Light flashing: there is not enough water in the tank.

ECO "Energy Saving" mode is active.

4. BEFORE USE

4.1 Checking the appliance

After removing the packaging, make sure the product is complete and undamaged and that all accessories are present. Do not use the appliance if it is visibly damaged. Contact a service center.

4.2 Installing the appliance



Important!

When you install the appliance, you should respect the following safety warnings:

- The appliance could be damaged if the water it contains freezes.
Do not install the appliance in a room where the temperature could drop below freezing point.
- The appliance gives off heat. After positioning the appliance on the worktop, leave a space of at least 3 cm between the surfaces of the appliance and the side and rear walls and at least 15 cm above the coffee maker.
- Water penetrating the coffee maker could cause damage.
Do not place the appliance near taps or sinks.

- Arrange the cord in such a way that it cannot be damaged by sharp edges or contact with hot surfaces (e.g. electric hot plates).

4.3 Connecting the appliance



Important!

Check that the mains power supply voltage corresponds to that indicated on the rating plate on the bottom of the appliance.

Connect the appliance to an efficiently earthed and correctly installed socket with a minimum current rating of 10A only.

If the power socket does not match the plug on the appliance, have the socket replaced with a suitable type by a qualified professional.

4.4 Setting up the appliance



Please note :

- Coffee has been used to factory test the appliance and it is therefore completely normal for there to be traces of coffee in the mill. The machine is, however, guaranteed to be new.
- You should customize water hardness as soon as possible. Proceed as described:
Remove the water tank (A9), fill to the MAX line with fresh water (fig. 1A) then put back in the appliance (fig. 1B).
 1. Place a container with a minimum capacity of 100 ml / 3,38 fl. oz. under the cappuccino maker (A18) (fig. 2).
 - 2.
 3. Connect the appliance to the mains electricity supply (fig. 3) and make sure the main switch (A8) at the back of the appliance is pressed down (fig. 4).
 4. The  button (B4 - fig. 5) flashes on the control panel (B).
 5. Turn the steam dial (A20) to the I position (fig. 6). Water is delivered from the cappuccino maker, then the appliance goes off.
 6. Turn the steam dial to the 0 position.

The coffee machine is now ready for normal use.



Please note :

- When setting up the appliance, you need to make 4-5 cups of coffee or 4-5 cappuccinos before the appliance starts to give satisfactory results.
- To enjoy your coffee even more and improve the performance of your appliance, we recommend installing a water softener filter (C2) as described in section "9. WATER SOFTENER FILTER". If your model is not provided with a filter, you can contact a service center.

5. TURNING THE APPLIANCE ON

Please note :

- Before turning the appliance on, make sure the main switch (A8) on the back of the appliance is pressed (fig. 4).
- Each time the appliance is turned on, it performs an automatic preheat and rinse cycle which cannot be interrupted. The appliance is ready for use only once this cycle is complete.

Danger of burns!

During rinsing, a little hot water comes out of the coffee spouts (A12) and is collected in the drip tray (A17) underneath. Avoid contact with splashes of water.

- To turn the appliance on, press the  button (B2 - fig. 7). The light flashes while the appliance is heating up and performing the automatic rinse cycle. By circulating hot water, the appliance heats both the boiler and the internal circuits.

When all the lights on the buttons are on, the appliance has reached the correct temperature and you can now select any function.

6. TURNING THE APPLIANCE OFF

Each time the appliance is turned off, it performs an automatic rinse cycle which cannot be interrupted.

Danger of burns!

During rinsing, a little hot water flows from the coffee spouts (A12).

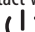
Avoid contact with splashes of water. To turn the appliance off, press the  button (B2, fig. 7). The appliance performs a rinse cycle then goes off (stand-by).

Please note:

If the appliance is not used for an extended period, also press the main switch (A8 - fig. 4).

Important!

To avoid damaging the appliance, never place the main switch in the 0 position until the appliance has been turned off using the  button.







7. AUTO-OFF

Auto-off can be set so that the appliance goes off after 15 or 30 minutes, or after 1, 2 or 3 hours.

To change the Auto-off setting, proceed as follows:

1. With the appliance turned off but the main switch (A8) pressed down, press and hold the  button (B8) until the lights on the control panel come on;

2. Press the  button (B5) until the lights corresponding to the time elapsing before the appliance goes off automatically come on:



15 minutes **ECO**
30 minutes **ECO** 
1 hour **ECO** 
2 hours **ECO** 
3 hours **ECO**   

3. Press the  button (B7) to confirm the selection. The lights go off.

8. ENERGY SAVING

Use this function to enable or disable energy saving. When enabled, the function reduces energy consumption in compliance with European regulations.

Energy saving mode is active when the ECO light is on.

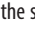
1. With the appliance turned off but the main switch (A8) pressed down, press and hold the  button (B4) until the **ECO** light comes on (fig. 8).
2. To deactivate the function, press the  button (B5) until the **ECO** light flashes.
3. To re-activate the function, press the  button again: the **ECO** light comes on.
4. Press the  button (B7) to confirm the selection. The **ECO** light goes off.

Please note :

When in energy saving mode, a few seconds may elapse before the first coffee is delivered as the appliance must heat up again.

9. WATER SOFTENER FILTER

Certain models are fitted with a water softener filter (C2). If this is not the case with your model, you are recommended contact a service center.

Important:

- Keep in a cool dry place out of direct sunlight.
- After opening the packaging, use the filter at once.
- Remove the filter before descaling the machine.

To use the filter correctly, follow the instructions below.

9.1 Installing the filter



1. Remove the filter (C2) from the packaging.
2. Turn the date indicator disk until the next two months are displayed (fig 9).

Please note:

The filter lasts about two months if the appliance is used normally. If the coffee machine is left unused with the filter installed, it will last a maximum of three weeks.

3. To activate the filter, run tap water through the hole in the filter as shown in the figure until water comes out of the openings at the side for more than a minute (fig. 10).
4. Extract the tank from the appliance and fill with water (fig. 1A).
5. Insert the filter in the water tank and immerse it completely, sloping it to enable the air bubbles to escape (fig. 11).
6. Insert the filter in the filter housing and press as far as it will go (fig. 12).
7. Close the tank with the lid (fig. 13), then replace the tank in the machine.
8. Place a container with a minimum capacity of 500 ml/ 16,91 fl. oz. under the cappuccino maker.
9. Turn the steam dial to the **I** position to deliver hot water.
10. After the machine has delivered at least 500 ml of hot water, turn the steam dial back to the **0** position.

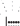
Please note:

Occasionally one delivery of hot water is not enough to install the filter and the    lights come on during installation.
If this happens repeat the installation procedure from point 9. The filter is now active and you can use the coffee machine.

9.2 Removal and replacement of the water softener filter

After two months (see date indicator disk), or if the appliance has not been used for 3 weeks, the filter (C2) must be removed from the tank (A9) and replaced with a new one, repeating the installation procedure above.

10. MAKING COFFEE

10.1 Selecting the coffee taste

Turn the coffee taste selection dial (B10) to set the required taste. Turning it clockwise increases the quantity of coffee beans the appliance will grind and therefore the strength of the coffee obtained.

Turn the dial to MIN for an extra mild coffee and to MAX for an extra strong coffee.

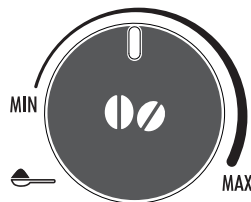





Please note :

- The first time you use the appliance, you will need to make a number of coffees to identify the correct dial position through trial and error.
- Do not turn the dial too far towards MAX, otherwise the coffee may be delivered too slowly (a drop at a time), particularly when making two cups of coffee at the same time.

10.2 Selecting the quantity of coffee in the cup

The appliance is set by default to automatically make the following quantities of coffee:

- short espresso coffee (≈40ml/ 1,35 fl. oz) when the  button (B5) is pressed;
- long espresso coffee (≈120ml/ 4.06 fl. oz) when the  button (B7) is pressed;
- two short espresso coffees when the  button (B6) is pressed;
- two long espresso coffees when the  button (B8) is pressed.

To change the quantity of coffee the appliance delivers automatically into the cup, proceed as described below:

- press and hold the button corresponding to the quantity to be modified until the short espresso coffee or long espresso coffee light flashes. When the appliance starts delivering coffee, release the button;
- when the coffee in the cup reaches the desired level, press the same button again to memorize the new amount.

The machine is now reprogrammed with the new quantities.

Please note :

It is possible to memorize just the single cup quantity. The two cup quantity reprogrammes automatically.

10.3 Adjusting the coffee mill

The coffee mill is set by default to prepare coffee correctly and should not require regulating initially.

However, if after making the first few coffees you find that the coffee is either too weak and not creamy enough or delivery is too slow (a drop at a time), this can be corrected by adjusting the grinding adjustment dial (A2 - fig. 14).

i Please note :

The grinding adjustment dial must only be turned when the coffee mill is in operation.

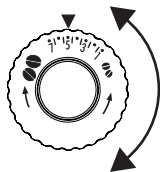

If the coffee is delivered too slowly or not at all, turn one click clockwise towards "7".

For fuller bodied creamier coffee, turn one click anticlockwise towards "1" (do not turn more than one click at a

time otherwise the coffee could be delivered a drop at a time). These adjustments will only be evident after at least 2 cups of coffee have been delivered. If this adjustment does not obtain the desired result, turn the dial another click.

10.4 Set temperature

To modify the temperature of the water used to make the coffee, proceed as follows:

1. With the appliance turned off but the main switch (A8) pressed down (fig. 4), press and hold the ☕ button (B5) until the lights on the control panel (B) come on;
2. Press the ☕ button to select the required temperature:



3. Press the ☕ button (B7) to confirm the selection. The lights go off.

10.5 Tips for a hotter coffee

For hotter coffee, you should:

- before delivering the coffee, perform a rinse cycle by pressing the ☕/☕ button (B3). Hot water is delivered from the spout, heating the internal circuits of the appliance and thus raising the coffee temperature;
- warm the cups with hot water (using the hot water function);
- set a hotter coffee temperature (see the section "10.4 Set temperature").

10.6 Making coffee using coffee beans

! Important!

Do not use caramelized or candied coffee beans as they could stick to the coffee mill and damage it.

1. Fill the container (A7 - fig. 15) with coffee beans.
2. Place under the coffee spouts (A12):

- 1 cup, if you want to make 1 coffee (fig. 16);
- 2 cups, if you want 2 coffees (fig. 17).

3. Lower the spouts as near as possible to the cup. This makes a creamier coffee (fig. 18).
4. Press the button corresponding to the required coffee:

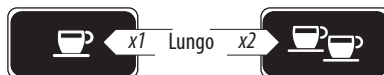

5. Delivery begins and on the control panel (B), the light on the selected button comes on.

Once the coffee has been made, the appliance is ready to make the next drink.

i Please note :

- While the machine is making coffee, delivery can be interrupted at any moment by pressing one of the illuminated coffee buttons.
- At the end of delivery, to increase the quantity of coffee in the cup, just press one of the coffee icons (within 3 seconds).

i Please note :

For hotter coffee, see section "10.5 Tips for a hotter coffee".

! Important!

- If the coffee is delivered a drop at a time, too weak and not creamy enough or too cold, read the tips in the section "17. TROUBLESHOOTING".
- Lights may be displayed on the control panel during use. Their meaning is given in the section "16. EXPLANATION OF LIGHTS".

10.7 Making coffee using pre-ground coffee

! Important!

- Never place coffee beans in the pre-ground coffee funnel (A6) as this could damage the appliance.
- Never add pre-ground coffee when the machine is off or it could spread through the inside of the machine and dirty it. This could damage the appliance.
- Never use more than 1 level measure (C1) or it could dirty the inside of the coffee machine or block the funnel.



i Please note :

When you use pre-ground coffee, you can only make one cup of coffee at a time.

1. Make sure the appliance is on.

- Turn the coffee taste selection dial (B10) anticlockwise as far as it will go to the ☰ position (fig. 19).
- Make sure the funnel is not blocked, then add one level measure of pre-ground coffee (fig. 20).
- Place a cup under the coffee spouts (A12).
- Press the required 1 cup coffee button (☰ -B5 or ☷ -B7).
- Preparation begins.

11. MAKING LONG COFFEE

LONG coffee can be made using either coffee beans or pre-ground coffee.

Follow the directions above to prepare the machine and press the **LONG** button (B9).

12. MAKING CAPPUCCINO AND HOT MILK (NOT FROTHED)



Danger of burns!

During preparation, steam is given off. Take care to avoid scalds.

- When preparing cappuccino, make the coffee in a large cup;
- Fill a container (preferably one with a handle to avoid scalding) with about 100 gr/ 3,53 oz of milk for each cappuccino. In choosing the size of the container, bear in mind that the milk doubles or triples in volume;



Please note :

For a richer denser froth, use skimmed or partially skimmed milk at refrigerator temperature (about 5°C). To avoid milk with poor froth or large bubbles, always clean the cappuccino maker as described in the section “12.2 Cleaning the cappuccino maker after use.”;

- Make sure the cappuccino maker selection ring (A19) is positioned downwards in the “CAPPUCCINO” position (fig. 21);
- Press the ☷ button (B4): the fading light on the button indicates that the appliance is heating up;
- Immerse the cappuccino maker (A18) in the milk container.
- When the light ☷ flashes after a few seconds, turn the steam dial (A20) to the I position (fig. 6). Steam is delivered from the cappuccino maker, giving the milk a creamy frothy appearance and making it more voluminous;
- For a creamier froth, rotate the container with slow movements in an upward direction. (You should not deliver steam for more than 3 minutes at a time);
- When you have obtained the required froth, stop steam delivery by turning the steam dial back to the 0 position.



Danger of burns!

Stop steam delivery before removing the container with the frothed milk to avoid burns caused by splashes of boiling milk.

- Add the milk froth to the coffee prepared previously. The cappuccino is ready. Sweeten to taste and, if desired, sprinkle the froth with a little cocoa powder.

Press any button to exit the steam function.

12.1 Making hot milk (not frothed)

To make hot milk without froth, proceed as described in the above section, but with the cappuccino maker selection ring (A19) positioned upwards in the “HOT MILK” position.

12.2 Cleaning the cappuccino maker after use.

Clean the cappuccino maker (A18) each time you use it to avoid the build-up of milk residues or blockages.



Danger of burns!

When cleaning the cappuccino maker, a little hot water is delivered. Avoid contact with splashes of water.

- Deliver a little water for a few seconds by rotating the steam dial (A20) to the I position. Then turn the steam dial to the 0 position to stop the flow of hot water.
- Wait a few minutes for the cappuccino maker to cool down. Turn the cappuccino maker downwards to remove it (fig. 22).
- Move the selection ring (A19) upwards (fig. 23).
- Remove the nozzle downwards (fig. 24).
- Make sure the two holes shown by the arrow in fig. 25 are not blocked. If necessary, clean with a pin.
- Replace the nozzle, move the ring downwards and put the cappuccino maker back on the nozzle (fig. 26), turning it and pushing it upwards until it is attached.

13. PREPARING HOT WATER



Danger of burns!

Never leave the machine unattended while delivering hot water. The spout of the cappuccino maker (A18) becomes hot while water is being delivered and must be held by the handle only.

- Place a container under the cappuccino maker (as close as possible to avoid splashes).
- Turn the steam dial (A20) to the I position. Delivery begins.
- Stop by turning the steam dial to the 0 position.



Please note :

If “energy saving” mode is active, you may have to wait a few seconds before the hot water is delivered.

14. CLEANING

14.1 Cleaning the machine

The following parts of the machine must be cleaned regularly:

- the appliance's internal circuit;
- coffee grounds container (A13);
- drip tray (A17) and condensate tray (A14);
- water tank (A9);
- coffee spouts (A12);
- the cappuccino maker (A18) (see section "12.2 Cleaning the cappuccino maker after use.");
- pre-ground coffee funnel (A6);
- infuser (A11), accessible after opening the service door (A10);
- control panel (A1).



Important!

- Do not use solvents, abrasive detergents or alcohol to clean the coffee machine. With De'Longhi superautomatic coffee machines, you need not use chemical products to clean the machine. The descaler recommended by De'Longhi is made from natural and completely biodegradable substances.
- None of the components can be washed in a dishwasher.
- Do not use metal objects to remove encrustations or coffee deposits as they could scratch metal or plastic surfaces.

14.2 Cleaning the machine's internal circuit

If the appliance is not used for more than 3/4 days, before using it again, we strongly recommend switching it on and:

- performing 2/3 rinse cycles by pressing the  button (B3);
- delivering hot water by turning the hot water/steam dial (A20) to the I position.



Please note:

After cleaning, it is normal for the grounds container (A13) to contain water.

14.3 Cleaning the coffee grounds container

When the  light flashes, the coffee grounds container (A13) must be emptied and cleaned. Unless you clean the grounds container, the light will continue to flash and the appliance cannot be used to make coffee.

To clean (with the machine on):

- Remove the drip tray (A17) (fig. 27), empty and clean;
- Empty the grounds container and clean thoroughly to remove all residues left on the bottom.
- Check the red condensate tray (A14) and empty if necessary.



Important!

When removing the drip tray, the grounds container **must** be emptied, even if it contains few grounds.

If this is not done, when you make the next coffees, the grounds container may fill up more than expected and clog the machine.

14.4 Cleaning the drip tray and condensate tray



Important!

If the drip tray (A17) is not emptied regularly, the water could overflow from the edge and seep inside or around the machine. This could damage the machine, the surface it rests on or the surrounding area.

The drip tray is fitted with a level indicator (A16) (red) showing the level of water it contains (fig. 28). Before the indicator protrudes from the cup tray (A15), the drip tray must be emptied and cleaned.

To remove the drip tray:

1. Remove the drip tray and the grounds container (A13) (fig. 27);
2. Empty the drip tray and grounds container and wash them;
3. Check the condensate tray and empty if necessary;
4. Replace the drip tray and grounds container.

14.5 Cleaning the inside of the coffee machine



Danger of electric shock!

Before cleaning internal parts, the machine must be turned off (see section "6. TURNING THE APPLIANCE OFF") and unplugged from the mains power supply. Never immerse the coffee machine in water.

1. Check regularly (about once a month) that the inside of the appliance (accessible after removing the drip tray - A17) is not dirty. If necessary, remove coffee deposits with a sponge.
2. Remove all the residues with a vacuum cleaner (fig. 29).

14.6 Cleaning the water tank

Clean the water tank (A9) regularly (about once a month) with a damp cloth and a little mild washing up liquid.

14.7 Cleaning the coffee spouts

1. Clean the coffee spouts (A12) with a sponge or cloth (fig. 30A).
2. Check that the holes in the coffee spouts are not blocked. If necessary, remove coffee deposits with a toothpick (fig. 30B).

14.8 Cleaning the pre-ground coffee funnel

Check regularly (about once a month) that the pre-ground coffee funnel (A6) is not blocked. If necessary, remove coffee deposits.

14.9 Cleaning the infuser

The infuser (A11) must be cleaned at least once a month.



The infuser may not be extracted when the machine is on.

1. Make sure the machine is correctly turned off (see section "6. TURNING THE APPLIANCE OFF").
2. Remove the water tank (A9).
3. Open the infuser door (A10) (fig. 31) on the right side of the appliance;
4. Press the two colored release buttons inwards and at the same time pull the infuser outwards (fig. 32);



DO NOT USE WASHING UP LIQUID TO CLEAN THE INFUSER AS IT MAY DAMAGE IT.

5. Soak the infuser in water for about 5 minutes, then rinse under the tap;
6. Clean coffee residues from the support where the infuser rests;
7. After cleaning, replace the infuser by sliding it onto the internal support, then push the PUSH symbol fully in until it clicks into place;



Please note :

If the infuser is difficult to insert, before insertion, adapt it to the right size by pressing the two levers (fig. 33).

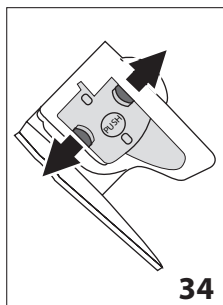
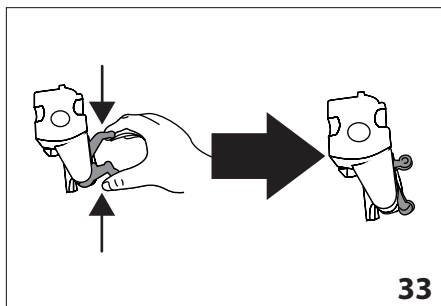











8. Once inserted, make sure the two colored buttons have snapped out (fig. 34).
9. Close the infuser door;
10. Put the water tank back.

15. TECHNICAL DATA

Voltage:	120 V~ 60 Hz max. 10A
Power:	1250W
Pressure:	1,5 MPa (15 bar)
Water tank capacity:	60,86 oz/1,8 l
Size LxDxH:	9.45x16.93x13.77 in / 240x430x350 mm
Cord length:	1150 mm
Weight:	19 lb/8,9 Kg
Beans container capacity:	8,82 oz / 250 g max.

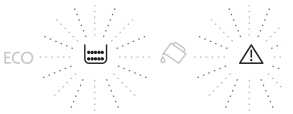
16. EXPLANATION OF LIGHTS



LIGHT	POSSIBLE CAUSE	SOLUTION
 FLASHING	Insufficient water in the tank (A9).	Fill the tank with water and/or insert it correctly, pushing it as far as it will go until it clicks into place.
 FLASHING	The tank (A9) is not correctly in place.	Insert the tank correctly and press as far as it will go.
 FLASHING	The grounds container (A13) is full.	Empty the grounds container and drip tray (A17), clean and replace. Important: when removing the drip tray, the grounds container MUST be emptied, even if it contains few grounds. If this is not done, when you make the next coffees, the grounds container may fill up more than expected and clog the machine.
 FLASHING	After cleaning, the grounds container (A13) has not been replaced.	Remove the drip tray (A17) and insert the grounds container.
 FLASHING	The «pre-ground coffee» function has been selected without placing any pre-ground coffee in the funnel (A6).	Place pre-ground coffee in the funnel or deselect the “pre-ground” function.
 FLASHING	The grinding is too fine and the coffee is delivered too slowly or not at all.	Repeat coffee delivery and turn the grinding adjustment dial (A2, fig. 14) one click clockwise towards «7» while the coffee mill is in operation. If after making at least 2 coffees delivery is still too slow, repeat the correction procedure, turning the Grinding adjustment dial another click until delivery is correct (see the section: «10.3 Adjusting the coffee mill»). If the problem persists, turn the steam dial to the I position and deliver a little water from the cappuccino maker (A18).
	If the water softener filter (C2) is present, an air bubble may have been released inside the circuit, obstructing delivery.	Deliver a little water by turning the steam dial (A20) to the I position until the flow is regular.
 RED AND WHITE ALTERNATE FLASHING	The machine must be descaled.	

 <p>FLASHING</p>	Too much coffee has been used.	Select a milder taste or reduce the quantity of pre-ground coffee, then make the coffee again.
 <p>FLASHING</p>	The coffee beans have run out.	Fill the beans container (A7).
	The pre-ground coffee funnel (A6) is clogged.	Empty the funnel with the help of a knife, as described in the section «14.8 Cleaning the pre-ground coffee funnel».
 <p>FLASHING</p>	The infuser has not been replaced after cleaning (A11).	Insert the infuser as described in the section “14.9 Cleaning the infuser».
	The inside of the appliance is very dirty.	Clean the inside of the appliance thoroughly, as described in the section “14 Cleaning». If the message is still displayed after cleaning, contact a service center.
 <p>FLASHING</p>	Indicates the hot water/steam dial must be turned (A20).	Turn the hot water/steam dial.

17. TROUBLESHOOTING

Below is a list of some of the possible malfunctions.

If the problem cannot be resolved as described, contact a service center.

PROBLEM	POSSIBLE CAUSE	SOLUTION
The coffee is not hot.	The cups were not preheated.	Warm the cups by rinsing them with hot water. Please note: the hot water or rinse function can be used.
	The internal circuits of the appliance have cooled down because 2/3 minutes have elapsed since the last coffee was made.	Before making coffee, press the  /  rinse button (B3).
The coffee is weak or not creamy enough.	The coffee is ground too coarsely.	Turn the grinding adjustment dial (A2) one click anticlockwise towards «1» while the coffee mill is in operation (fig. 14). Continue one click at a time until coffee delivery is satisfactory. The effect is only visible after delivering 2 coffees (see section «10.3 Adjusting the coffee mill»).
	The coffee is unsuitable.	Use pre-ground coffee for espresso machines.
The coffee is delivered too slowly or a drop at a time.	The coffee is ground too finely.	Turn the grinding adjustment dial (A2) one click clockwise towards «7» while the coffee mill is in operation (fig. 14). Continue one click at a time until coffee delivery is satisfactory. The effect is only visible after delivering 2 coffees (see section «10.3 Adjusting the coffee mill»).
Coffee does not come out of one or both of the spouts.	The coffee spouts (A12) are blocked.	Clean the spouts with a toothpick.
The frothed milk has large bubbles	The milk is not cold enough or is not semi-skimmed.	You should ideally use skimmed or semi-skimmed milk at refrigerator temperature (about 5°C). If the result is not as you wished, try changing brand of milk.
The milk is not frothed	The cappuccino maker (A18) is dirty.	Clean as described in the section «12.2 Cleaning the cappuccino maker after use».
Steam delivery stops	A safety device stops steam delivery after 3 minutes.	Wait a few minutes and then enable the steam function again.
The appliance does not come on	It is not plugged into the mains socket.	Plug into the mains socket (fig. 3).
	The main switch (A8) is not turned on.	Press the main switch into the I position (fig. 4).

