

What's in the Box

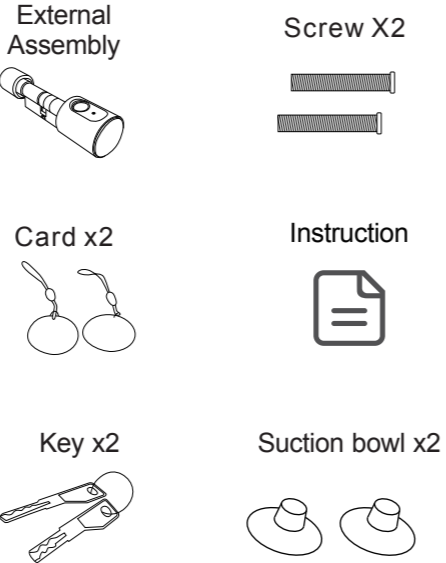

1

STEP-1

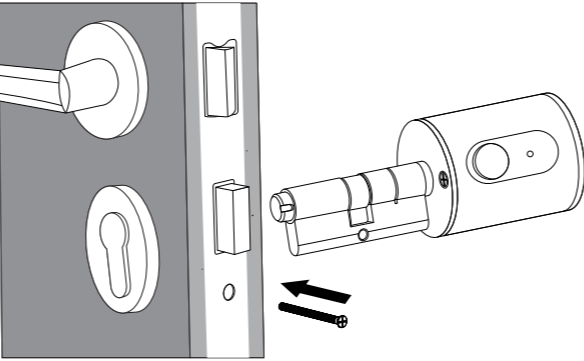

2

STEP-2

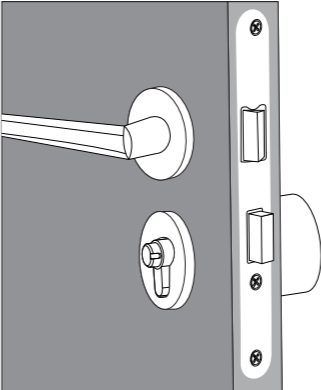

3

STEP-3

Insert the inside knob accurately until it reaches the end position. Then tighten the screw.

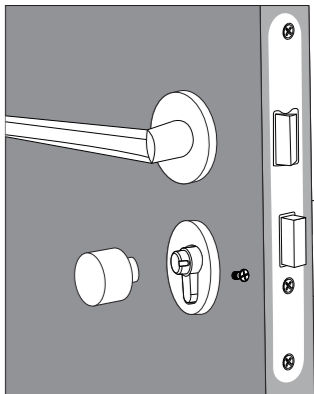

Remove the face cover using a Suction bowl

Take off the battery cover, install CR123A 3.0V battery into battery compartment and then install back the battery cover and face cover

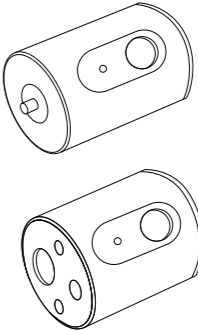

4

In-App SetUp

Register App Account

Download "Tuya Smart" App from App Store or Google Play.

Register an Account with your Mobile number or E-mail ID, If you already have an account, please ignore this step.



5

Configuration

Make sure you have trun on Mobile Bluetooth and nearby the Lock. Tap "Add Device" or the icon "📶" in the top right corner, the Lock will pop up in the list, choose "Go to add", the Lock will Buzz when successful paired.

Fingerprint Setting (Fingerprint version only)

Select the device on the "Home" page and click "Set". Tap "Fingerprint Management" >> Add Finger >> Select User >> Start Collecting 5times or more >> Finished.

6

Password Setting (Password version only)

Digital keypad: 1-5 ,#(# is the confirm key; )

Go back to "Set", Tap Password Management >> Add Password >> Select User >> Add Password or Randomly Generated >> Save.

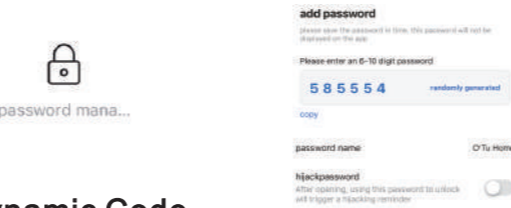

Dynamic Code

Go back to "Home" page, swipe left, tap "Get Dynamic Code". Code valid within 5 minutes.



7

IC Card Setting

Go back to "Set", Tap Door Card management >> Add Card >> Select user >> Tap Start Collecting >> Put the ID Card on the identification area until buzz >> Save.



In-App management

Now, you can use App, password, Fingerprint, Card, or Key unlock the Door. After each unlocking, it will automatically lock within 5 seconds.

8

Reset

Select the device on the Home page and click "🔧" on the top right hand corner. Tap "Remove Device" >> Disconnect and Wipe data". Note: All data will be erased if reset.

FAQ

Check the Profile >> FAQ to find some answers. For more, please feedback to us in App.

9