

European multiway dimmer

INSTRUCTIONS

Isolate the power supply at the consumer unit circuit breaker. Check that the power is off. These products must be installed by a qualified electrician in accordance with the latest building regulations.

FEATURES

- Suitable for one-way or multiway dimming (multiple dimmers controlling the same light).
- Minimum load down to 5W of capacitive or resistive load, incl. dimmable LED and incandescent lighting.
- Minimum brightness level can be programmed.
- Built in thermal cut-off and short circuit protection.
- Soft-start operation to extend bulb life.
- Complies with IEC EN60669.

WARNING & INSTALLATION INFORMATION

Electric shock hazard. Hazardous voltage may be present at the output of the dimmer despite setting the dimmer to zero brightness level. Look out and tag the input circuit before accessing the wiring connections. Failure to follow this warning can result in death or serious injury.





- The dimmer should be protected by a 6A or up to 16A maximum circuit breaker.
- Multiway dimmers must be used in parallel.
- Multiple compatible loads can be used per circuit, as long as it is within the maximum wattage ratings for the dimmer. We recommend a maximum of 15 lamps per circuit.

MULTI-GANG DERATING

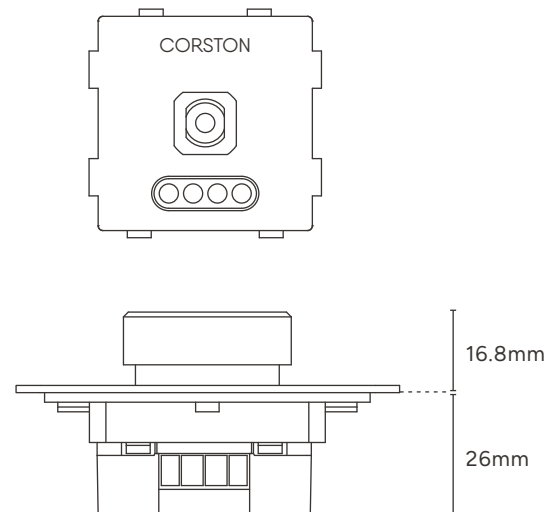
For applications where dimmers are multi-ganged, derate the maximum load rating of the unit according to the derating tables below:

Dimmers	Max. load per dimmer
	TE
x1	250W
x2	225W
x3	200W



Parameter	Value
Supply voltage & frequency	220-240V ~ 50Hz
Rating	5-250W: trailing edge LEDs 5-250W: incandescent lighting
Dimming technology	Trailing edge dimming mode
 R.C.	
Compatible loads	 Dimmable LED lighting with compatible electronic transformers
	 Incandescent lighting, MV halogen lamps
	 LV halogen lighting with electronic transformers
Operating temperature	0-45°C
Operating humidity	10-90% R.H.

European multiway dimmer instructions

SETTING THE MINIMUM BRIGHTNESS

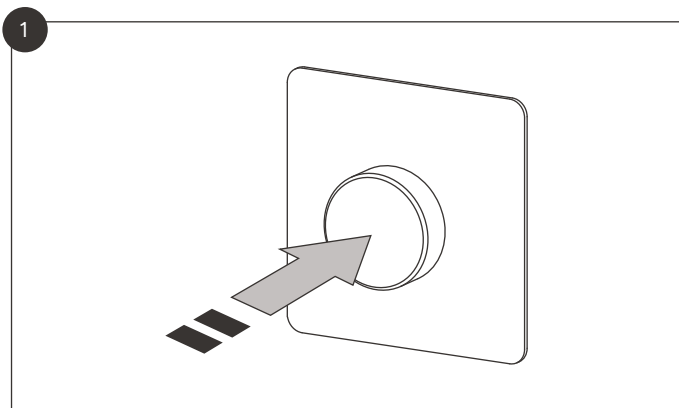

Press the knob twice.

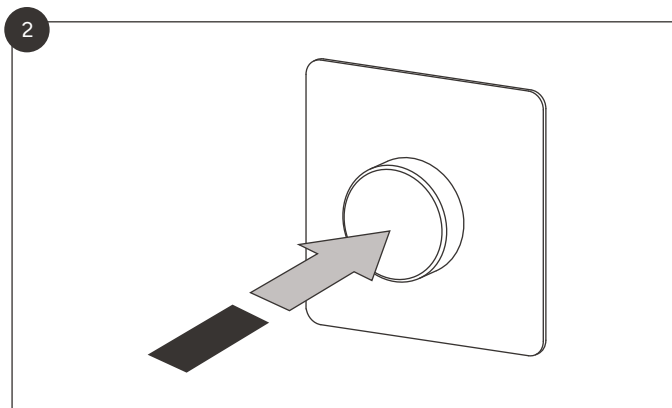

Press and hold the knob to set the mode.

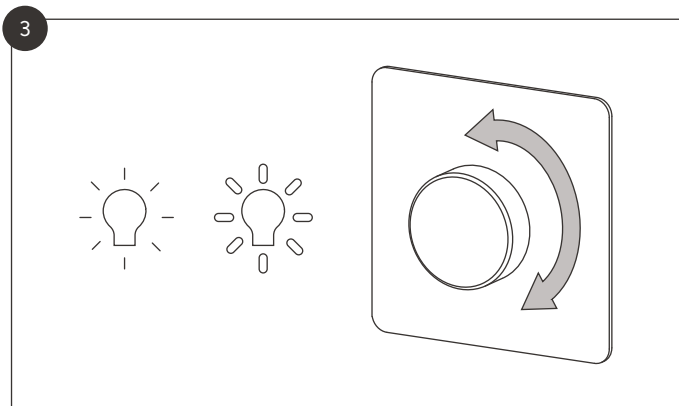

Adjust dimmer to desired min. brightness.

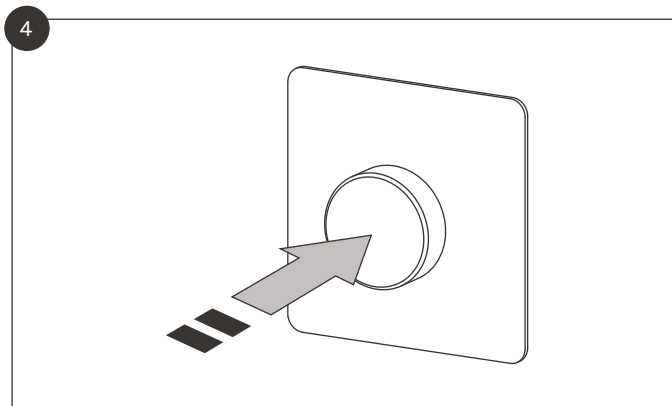

Press the knob twice to save the setting.

European multiway dimmer instructions

ONE-WAY WIRING DIAGRAM

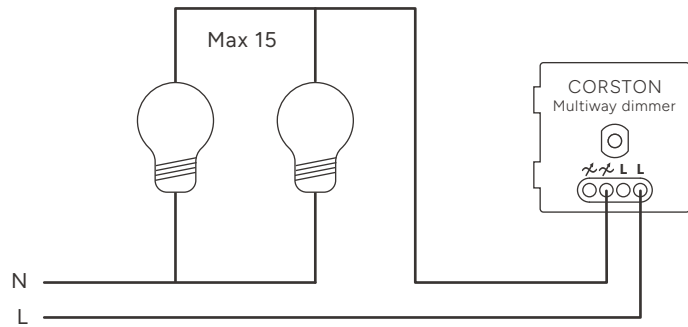

Some lamps may exhibit unexpected performance characteristics when cold. Dimming performance should improve after the lamp warms up.

MULTI-WAY WIRING DIAGRAM

Example 1

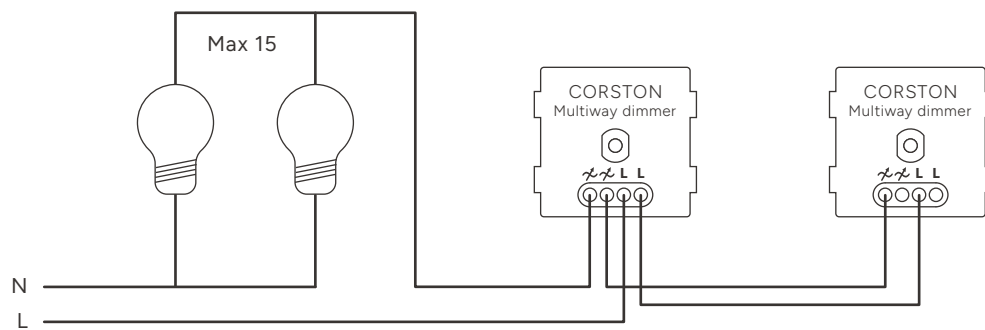

Example 2

