



Tommy Docks

8608 Progress Way, Weston, WI 54476

Phone : 715-842-3804

Toll Free : 866-675-1880

Installation of Tommy Docks Flexx Floating Dock and Accessories

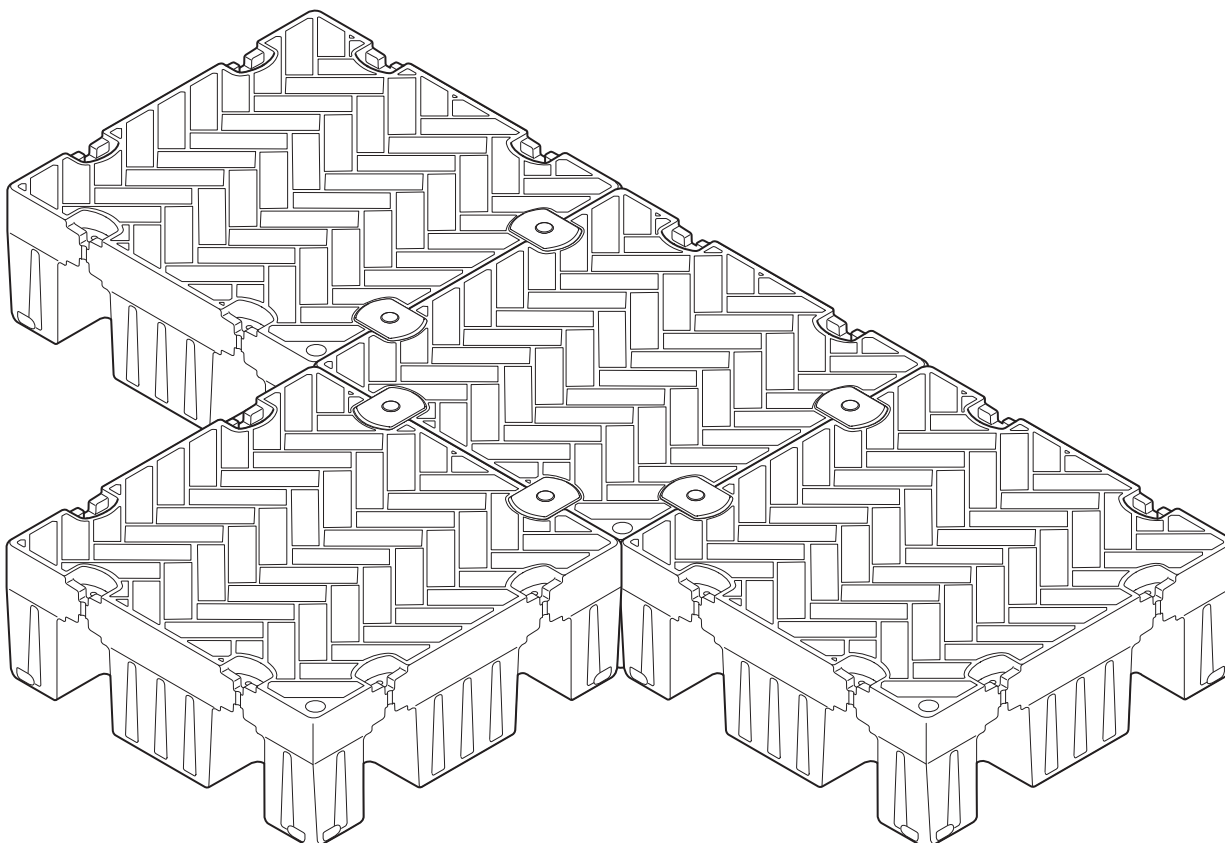

Table of Contents

Connecting Flexx Floats	2-3
Anchoring Options	4-8
Attaching Flat Face Connectors.....	9
Attaching Gangway	10
Attaching Ladder	11-13
Attaching Handrail Balusters	14-16
Attaching Bumpers.....	17
Attaching Cleats	18
Attaching Pocket Filler	18

www.tommydocks.com



1/2" x 8"
Bolt



1/2" x 1-1/4"
Washer



1/2" Square
Nut



Connectors



Cap

Recommend Tools

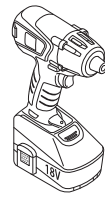

Cordless Drill



3/4" Socket

The included hardware is made of universal stainless steel. To prevent potential seizing, it is recommended to apply a marine-grade anti-seize compound or lubricant to the threads of the bolts before assembly.

1

Sit the Square Nut in the Bottom Connector. Then take the 1/2" x 8" Bolt and put it through the Washer, Top Connector and then the Bottom Connector as shown. Hand tighten the bolt to the 1/2" Square Nut under the Bottom Connector then stop after the Nut is flush with the bottom of the bolt.

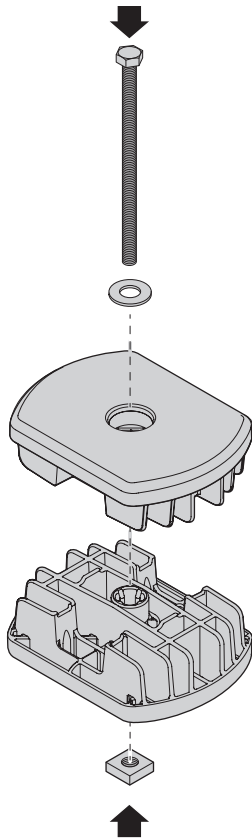

2

Place each Connector Assembly into the Float as shown to connect another float **(2a & 2b)**.

Note: It is important that the bolt is not tightened all the way up to allow for the Connector Assembly to fit into place.

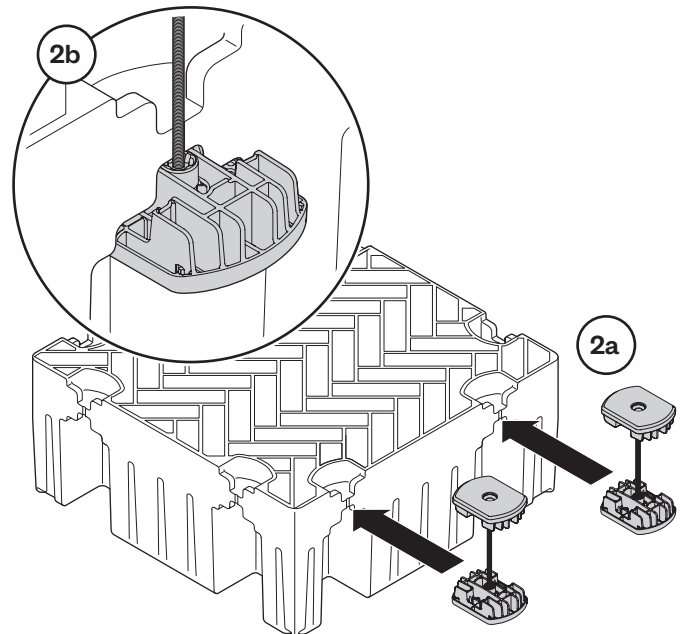

3

With the additional Float put into place, tighten each Bolt. Continue this process to arrange the remaining Floats. Insert the Cap on each connector to cover the fastener in the center.

Note: If you unscrew the Square Nut too fast to remove the Connectors, the Nut may fall into the water.

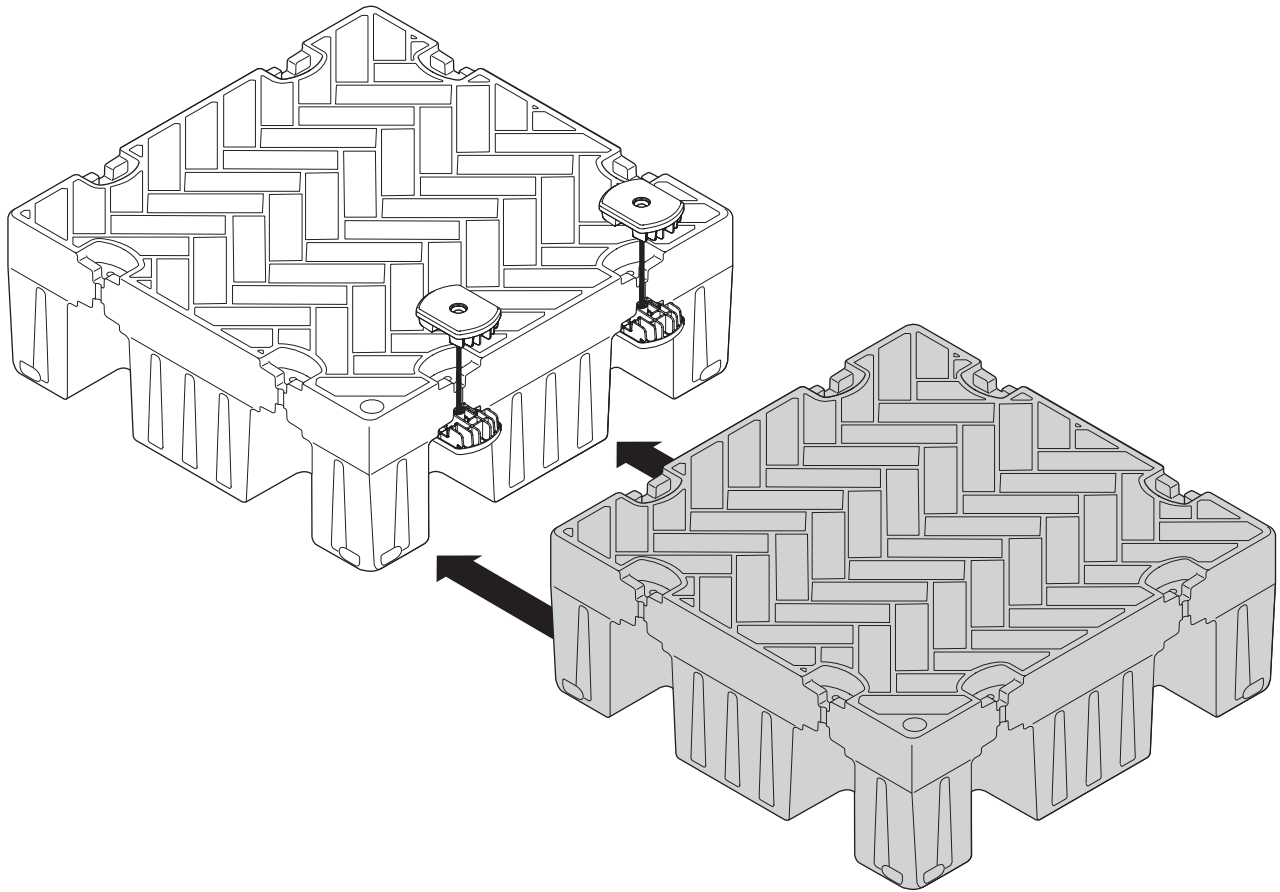

Note: Floats must be connected together to a flat face. You will not be able to attach the connectors to two sides of the float at once.

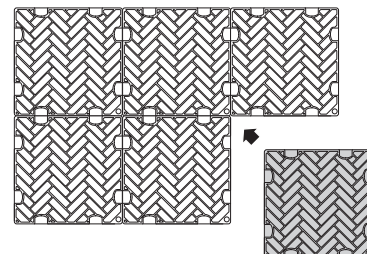
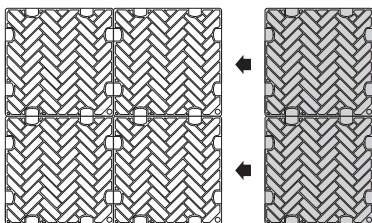

4a. Pipe Guide (0-8')

For water depths up to 8 feet, use pipe guides with augured aluminum pipe. Ensure sufficient pipe length above the deck to accommodate water fluctuations. Beyond 8 feet, installing pipe becomes increasingly challenging.

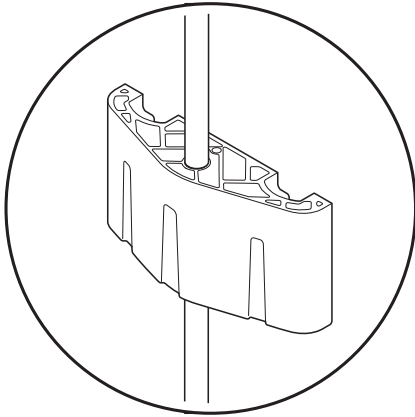

TDFX-200, TDFX-201, TDFX-202

4b. Anchor Line (8'+)

For depths exceeding 8 feet, utilize anchor lines (rope, chain, or cable). Choose anchors suitable for your lake bottom conditions, such as mushroom anchors, deadweight anchors, screw anchors, or pile anchors. Ensure the lines are long enough to reach from the anchor point to the dock with some slack then tighten the lines once satisfied with position. Opt for marine-grade ropes or chains for durability.

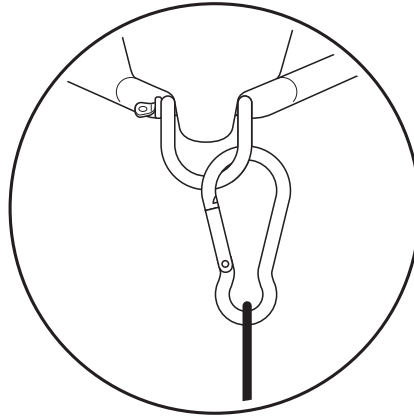

TDFX-204

4c. Shore Arm (8'+)

In depths of 8 feet or more, shore arms can secure the system to the shoreline, eliminating the need for water-based anchoring. Ideal for waterfronts with deep drop-offs and fluctuating water levels.

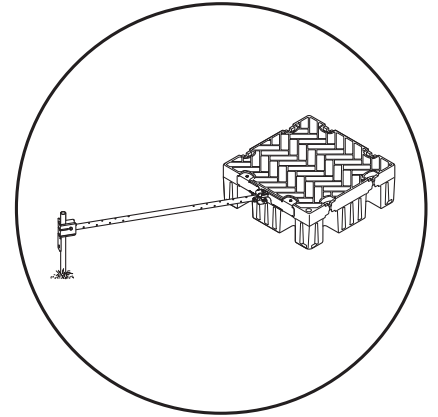

TDFX-219

There are many variables to consider when choosing the correct anchoring system. For assistance or inquiries, contact us at (715) 842-3804 or email info@tommydocks.com or visit tommydocks.com.

4a Pipe Guides, TDFX-200, TDFX-201, TDFX-202

Once the layout is assembled, position the Flexx Pipe Guide along the side of the desired Flexx Float and secure it with two sets of Connectors (refer to Step 1-3). It is recommended to stagger the Pipe Guides along the seams to provide the best anchoring support across the dock layout. Use the Flexx Auger Wrench to drive the posts into the lake bottom.

Note: The Flexx Auger Wrench pictured (item TD-10089) is sold separately.”

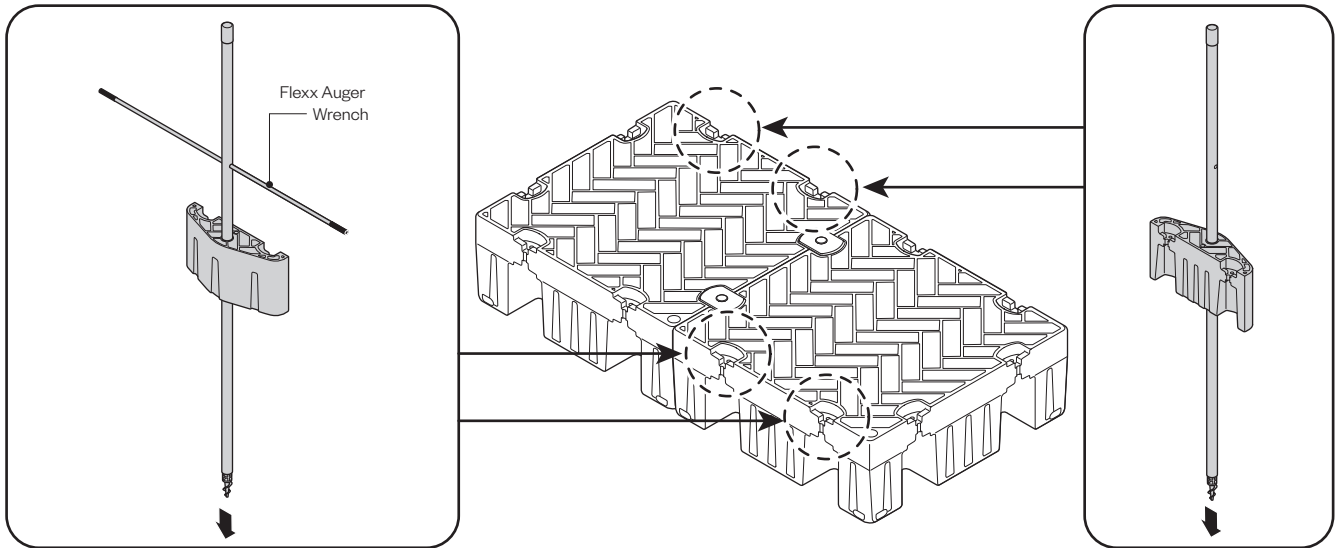

4b Anchor Line, TDFX-204

Fasten the D-Ring to the bottom corner of the desired Flexx Float **(a & b)**. Once in place, clip on the Anchor Line to the D-Ring using the attached Carabiner **(c & d)**. Run the Anchor Line through your anchor and drop into the water. Criss-cross the lines for an optimal hold on the dock.

Note: If not using the Anchor Line Kit, the D-Ring (item TDFX-401) is sold separately.

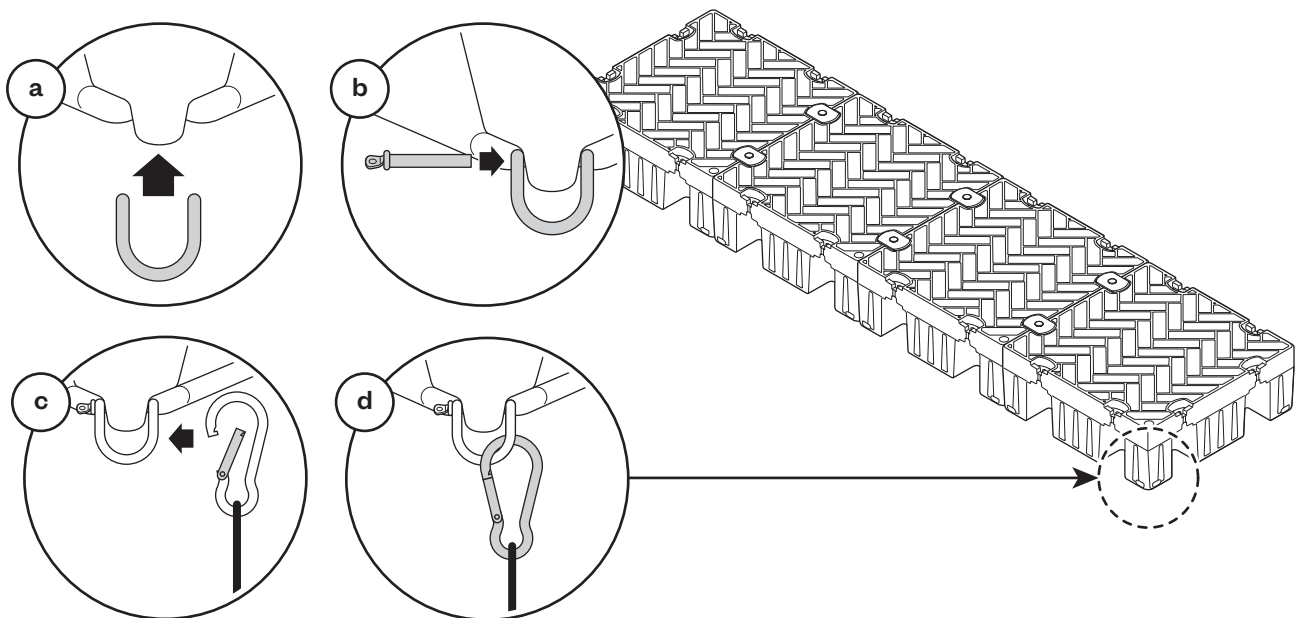

4c Shore Arm, TDFX-219

Place the Left Shore Arm Bracket into the left insert of the desired Flexx Float **(a)**. Then place the Right Shore Arm Bracket in the right insert of the float **(b)** so the two center pieces align **(c)**. Attach the Brackets by using the ½"-13 x 5-½" Bolt and ½" Nut **(d)**. Place the Shore Arm Hinge over the center part of the Shore Arm Brackets **(e)**. Fasten the ½"-13 x 6" Partially Threaded Bolt through to the ½" Nut on the bottom **(f)**.

Swivel the Shore Arm Hinge to install hardware **(g)**. Insert the end of the shore Arm Pole into the flanges of the Shore Arm Hinge, making sure holes in the Shore Arm Pole are aligned with the holes in the flanges of the Shore Arm Hinge and secure using one (1) ½"-13 x 3-¼" Bolt and one (1) ½" Nut **(i)**. Connect the two Shore Arm Poles to each other by placing each end of Shore Arm Extension into each Shore Arm Pole end **(j)**. Choose desired length and then fasten the two posts to the Shore Arm Extension with two (2) 1-½"-13 x 3" Bolts, two (2) ½" Washers and Lock Nuts **(k)**.

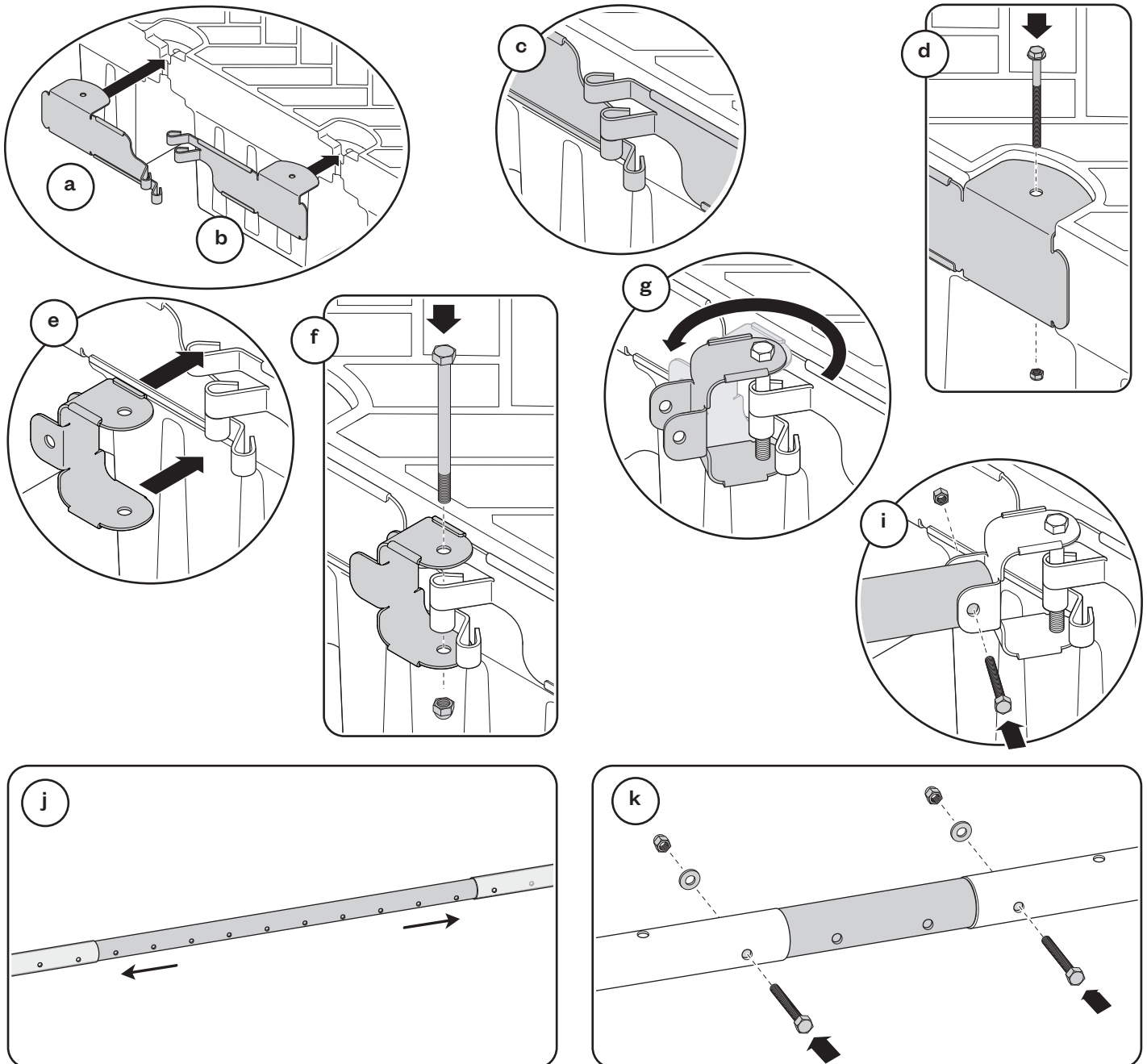

- 4d** Place the Shore Arm Stake Bracket onto the top part of the Stake **(a)** and fasten together using two (2) 1-½"-13 x 3" Bolts, two (2) ½" Washers and two (2) Lock Nuts **(b)**. Then secure the stake to shore. Once assembled, take the end of the Shore Arm Pole and place it into the Shore Arm Stake Bracket and fasten it to the Stake Bracket making sure holes in the Shore Arm Pole are aligned with the holes in the Shore Arm Stake Bracket **(c)**. Fastening using one (1) ½"-13 x 3-¼" Bolt and one (1) ½" Nut **(d)**. Assembly is now complete **(e)**.

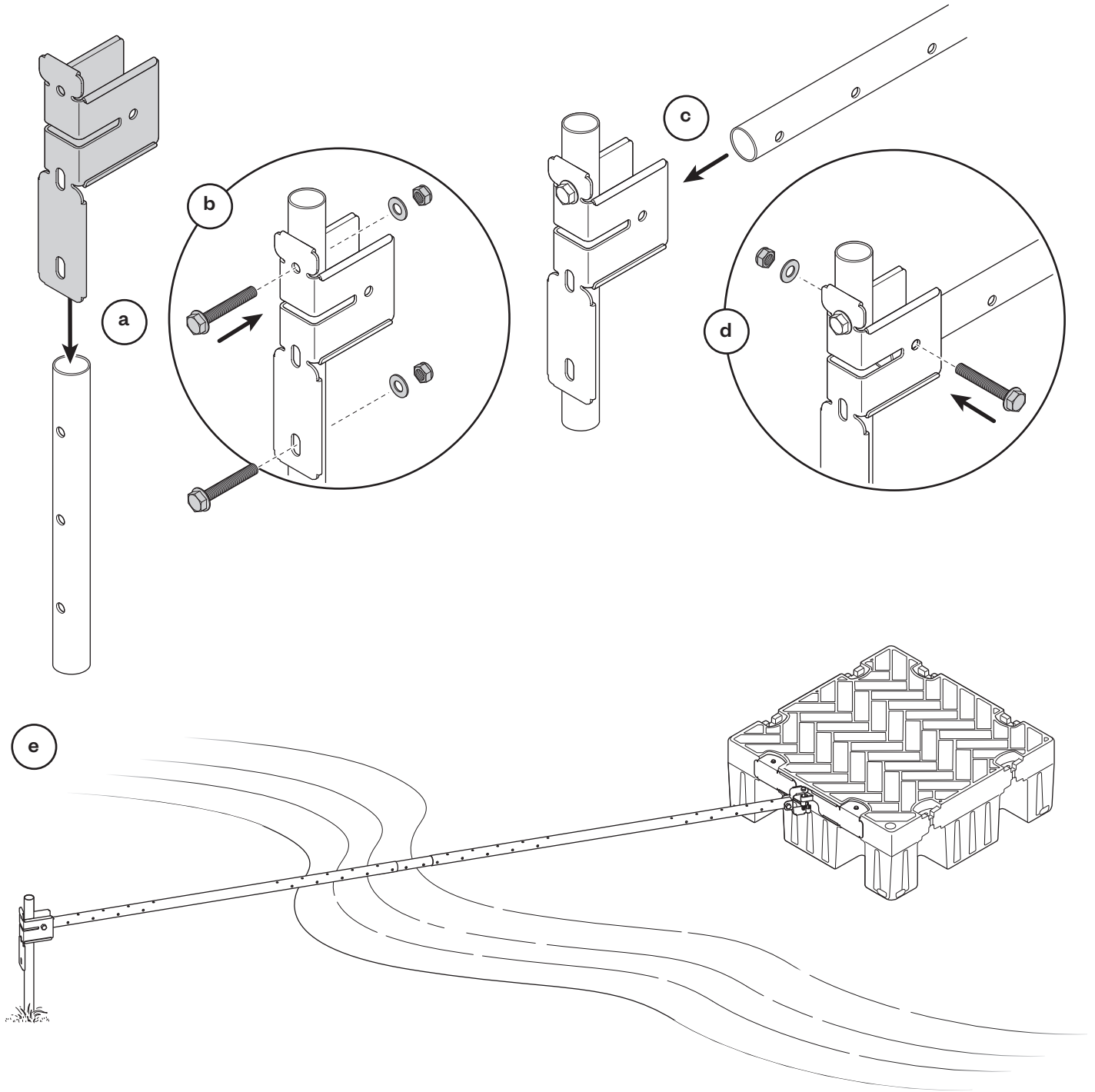

4e

Shore Arm Seawall Kit, TDFX-229

Assemble the Shore Arm Seawall kit by taking the Seawall Bracket and sliding the rounded flange into the slit of the Shore Arm Stake Bracket **(a)**. Then take the Shore Arm Seawall Pin piece and run it through the hole lined up on the two brackets **(b)**. Turn Seawall Bracket right or left to better enable installation of bolts **(c)**. Then fasten the Shore Arm Stake Bracket to the Pin using two (2) 1-½"-13 x 3" Bolts, two (2) ½" Washers and two (2) Lock Nuts **(d)**. Use desired fasteners to mount the Seawall Bracket to your seawall.

Note: The Shore Arm Seawall Kit (item TDFX-229) is sold separately.

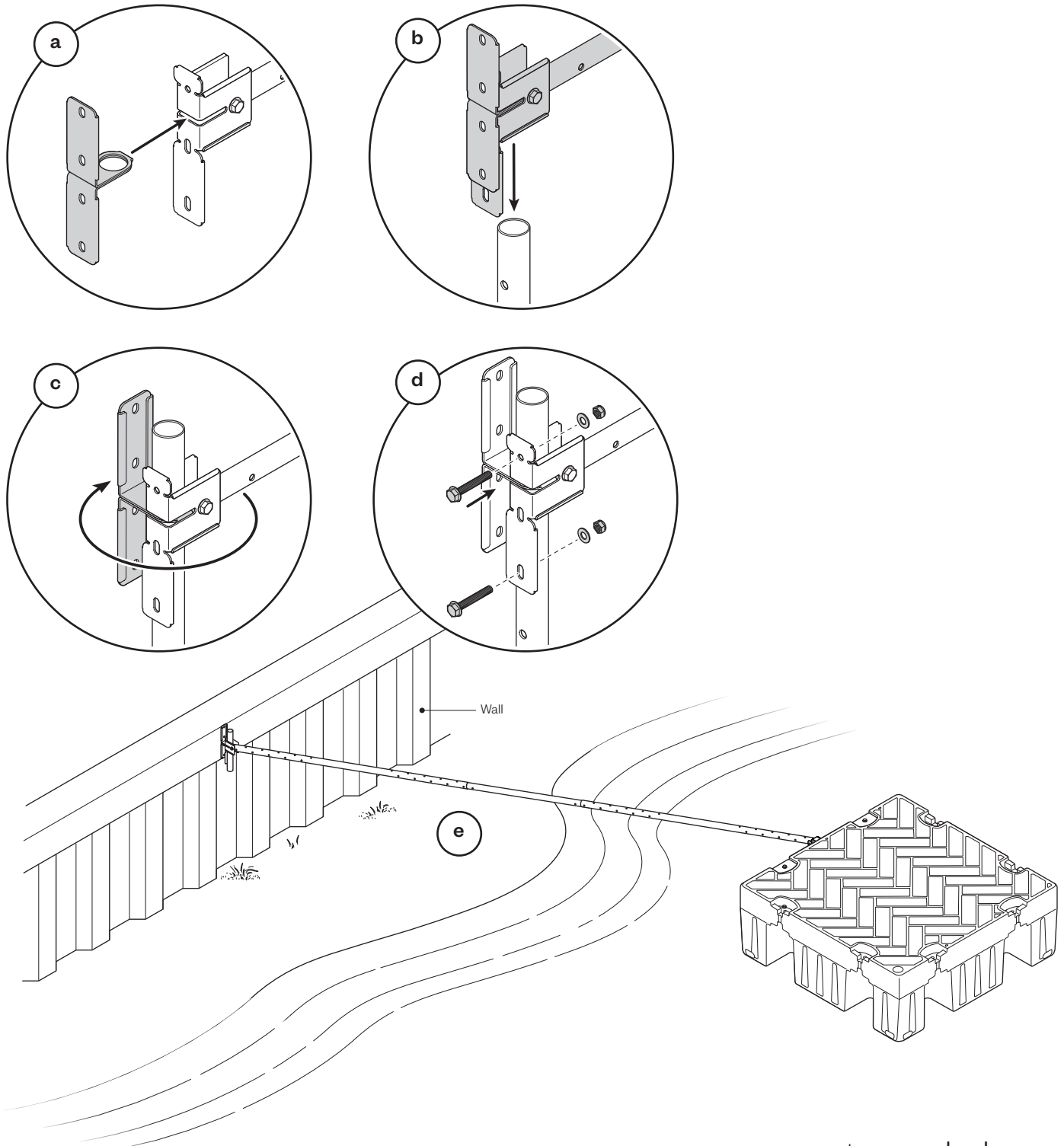

5

Flat Face Connectors, TDFX-106

After assembling the layout, insert the Flat-Face Connectors to the desired Flexx Float **(a)** and attach the top Flat Face Connector to the bottom Flat Face Connector by running one (1) 1/2" x 5" Partially Threaded Bolt through the top 1/2" Washer and securing from underneath with the other 1/2" Square Nut **(b)**. Push the Square Nut into the bottom Flat Face Connector and use the Cordless Drill to fasten into the insert **(c)**. Insert the Cap on each connector to cover the fastener in the center.

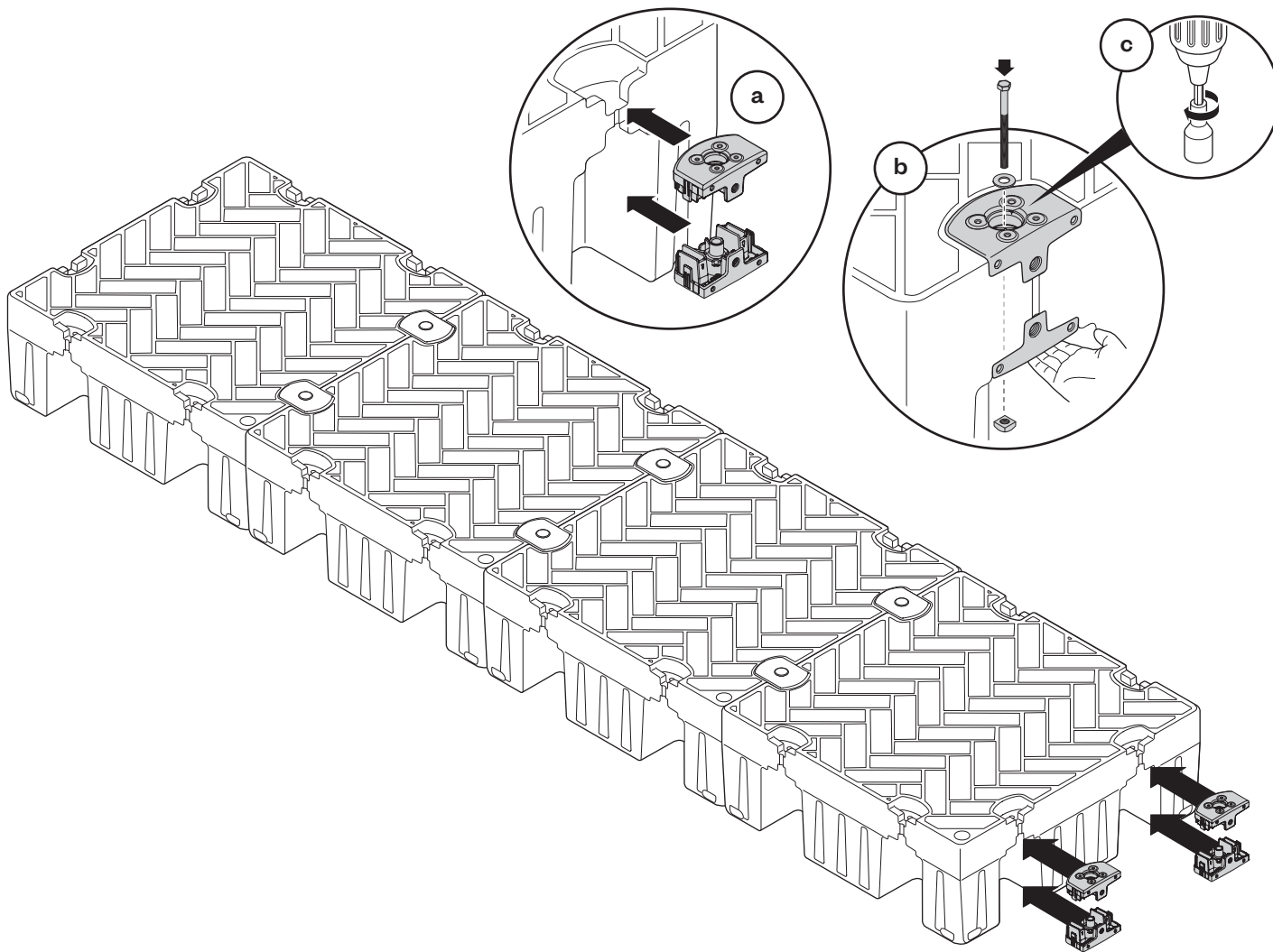

6**Flexx Gangway, TDFXGWT-304, TDFXGWT-308, TDFXGWT-312**

Align Gangway Hinge with Flat Face Connectors **(a)** and attach using the eight (8) ¼"-20 x ⅝" Hex Flange Screws **(b)**.

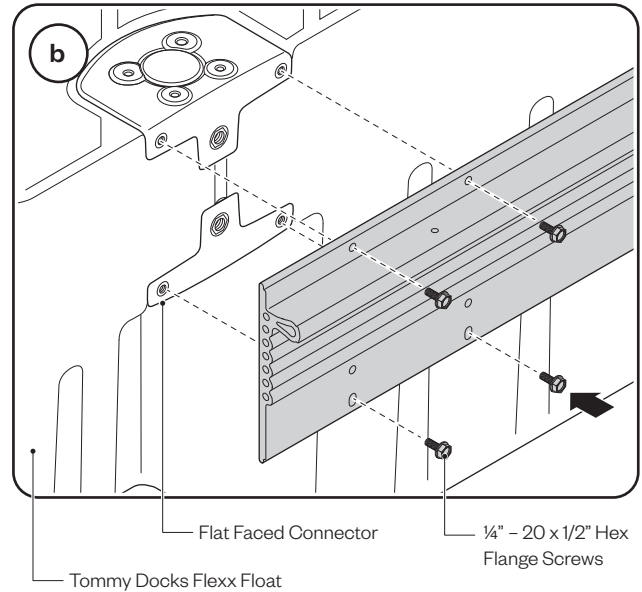
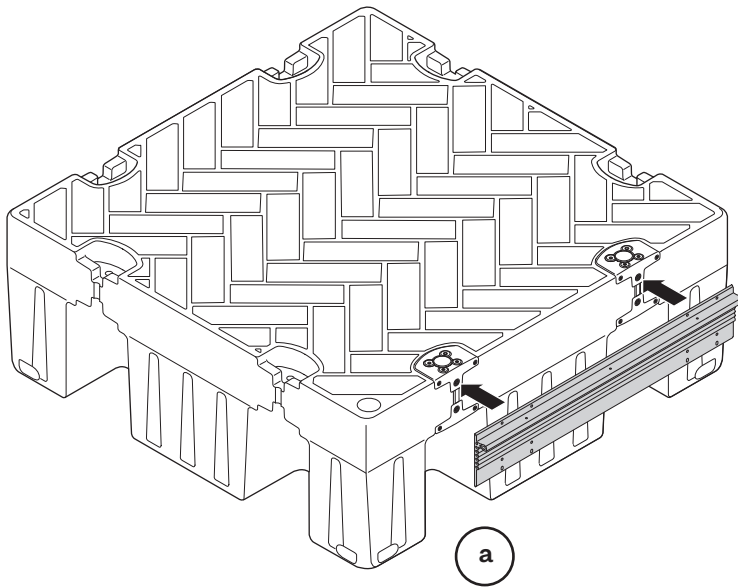
**6a**

Insert End Rail #1 of the Gangway section to the Hinge Piece **(a)** and fasten together using three (3) ¼"-20 x 3" Truss Head Phillips Screws **(b)**.

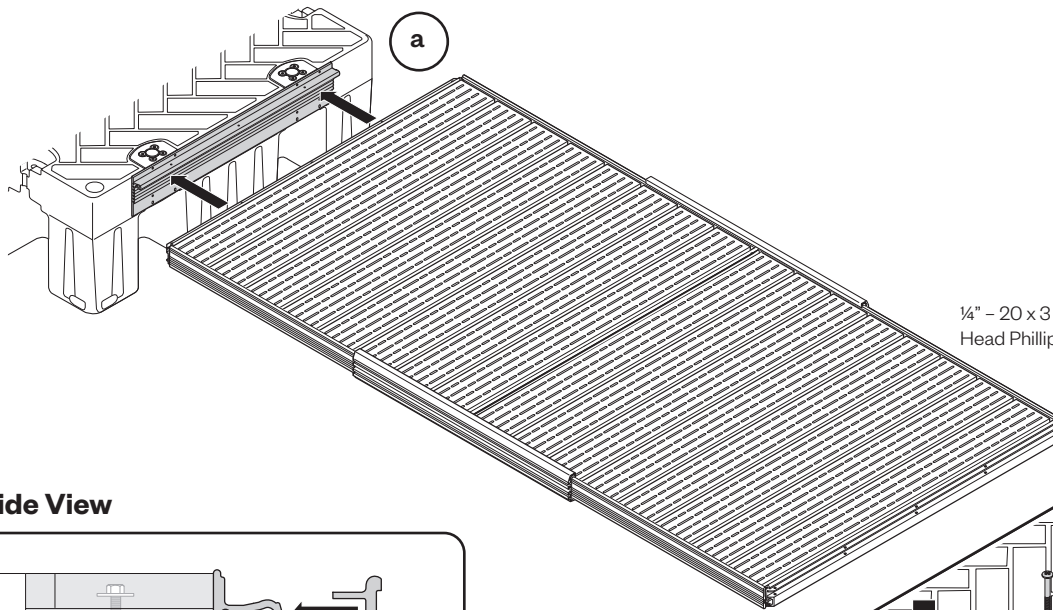
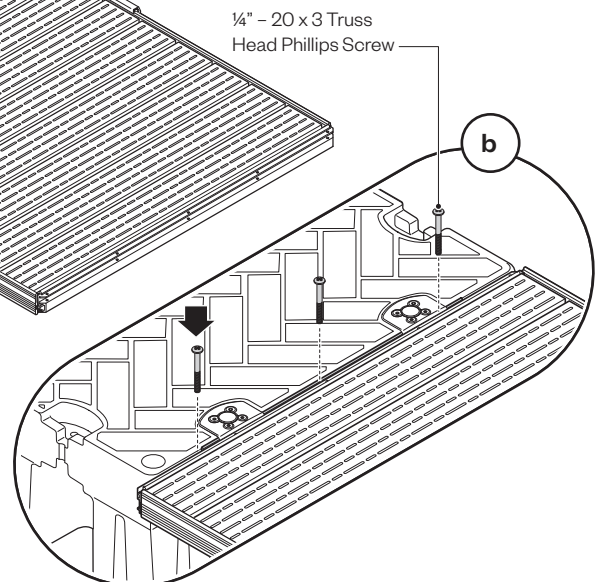
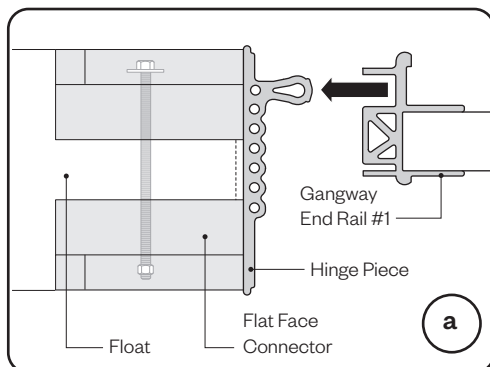
**Side View**

7

Dock Ladder Kit, TDFX-207

First assemble the Ladder Handles to the Ladder Rung portion by taking one (1) ½-13 x 6" Bolt and one (1) ½" Washer and putting it through the Rung Portion first to the outside of the Ladder Handle **(a)**. Then add a second ½" Washer and ½" Cap Nut to the Bolt End that passes through the Ladder Handle **(b)**. Repeat this step for the other Ladder Handle **(c & d)**.

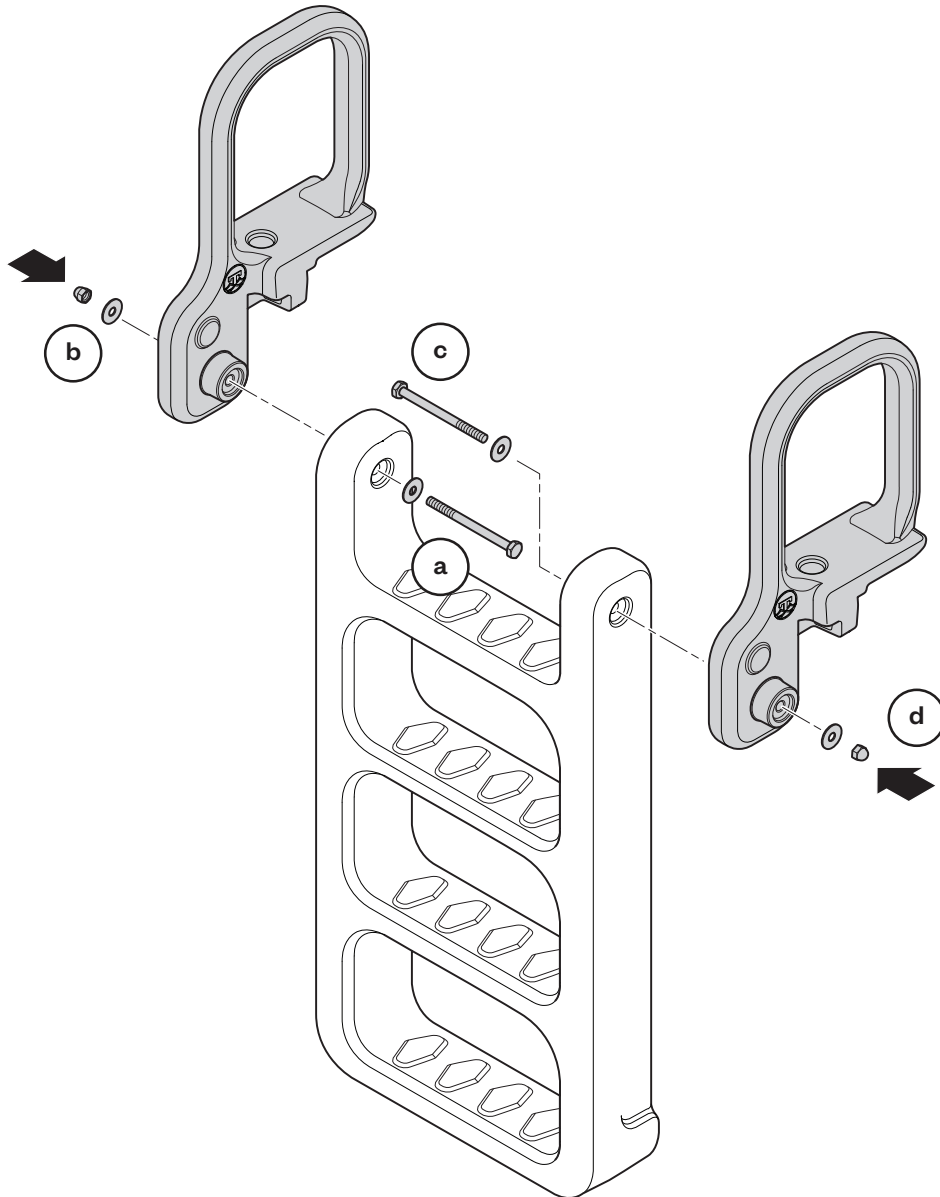

- 7a** Drop the assembled Ladder into the desired inserts in the Flexx Float. The Ladder will stay in place once set in the inserts.

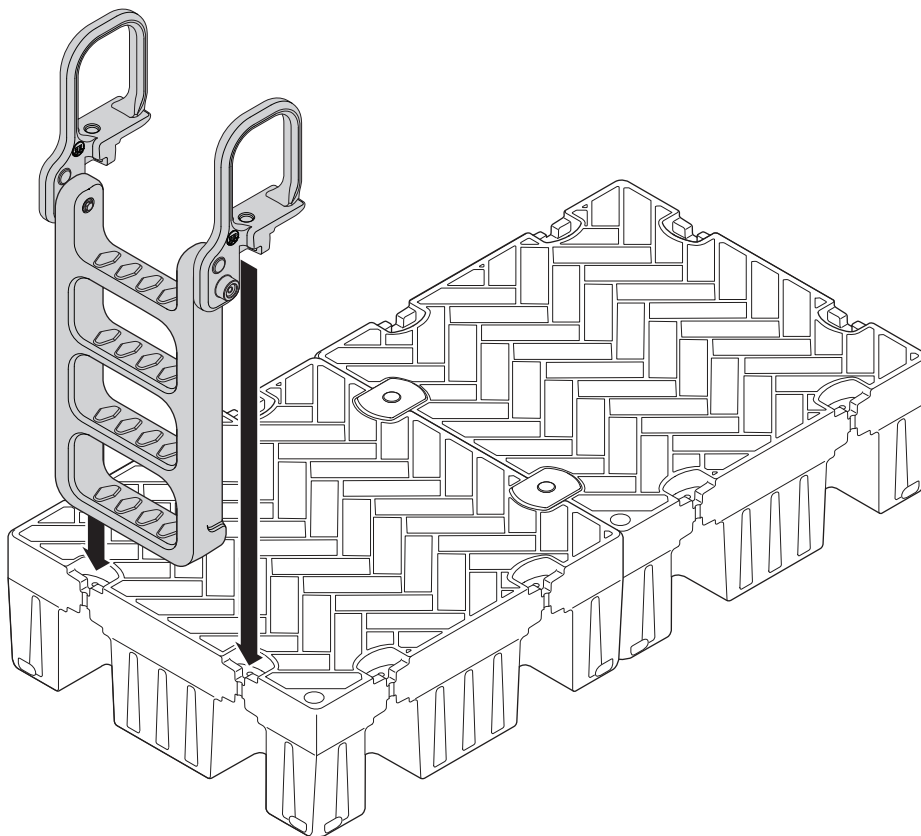

- 7b** Insert one (1) 1/2" Washer and one (1) 1/2"-13 x 5" Bolt through the top portion of the base each Ladder Handle.

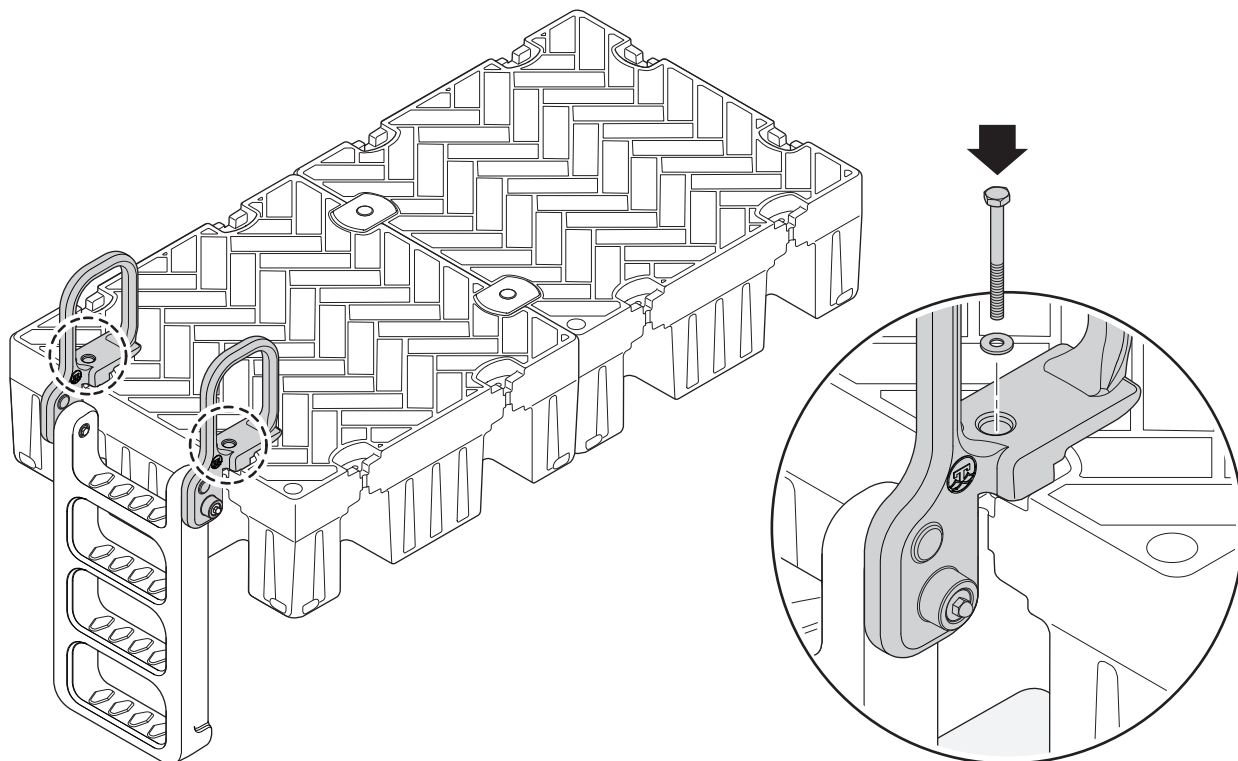

- 7c** Once each Bolt is passed through each Ladder Handle, push one (1) Flat Face Connector up into the bottom of each insert of the Flexx Float (each Bolt from the top should be felt through the bottom of each Connector).

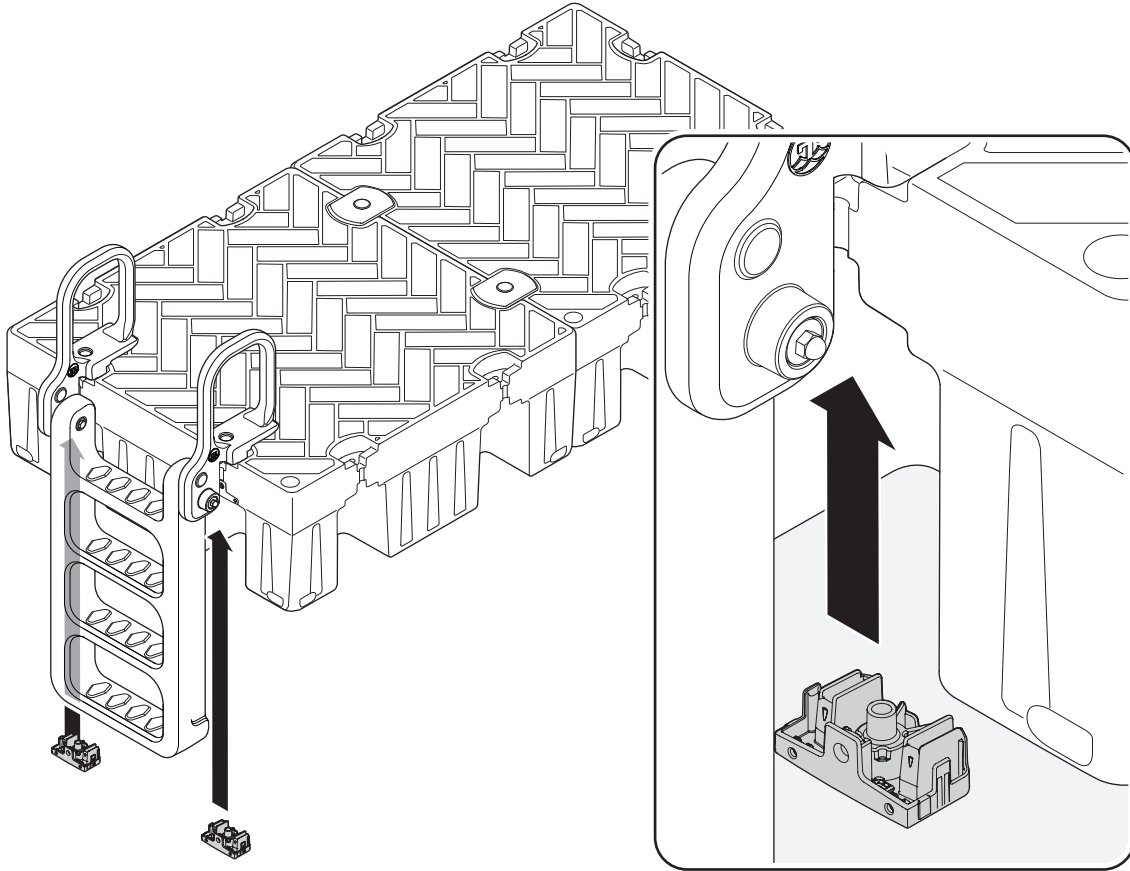

- 7d** Hold the Bottom Flat Face Connector in place with one hand to prevent it from falling **(a)**. Once you feel the Bolt through the bottom of the Flat Face Connector, add a Square Nut to the Bolt and position the Connector so the Square Nut seats inside and no longer spins freely **(b)**. Once the Square Nut is securely seated on the Ladder Handle, use a 3/4" deep well socket with a power drill to tighten the Bolt **(6)**. Repeat this process on the other Ladder Handle. After assembly, insert the Cap into each Ladder Handle to cover the fasteners.

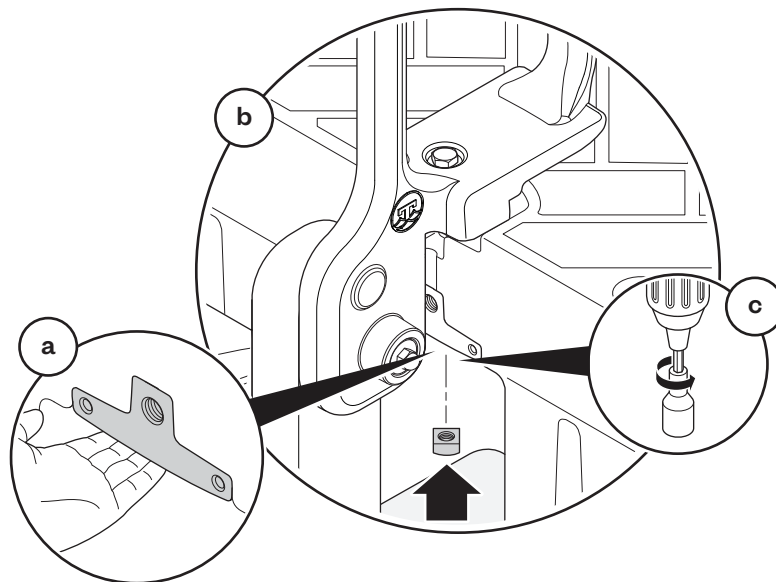

8

Handrail Baluster, TDFX-114

Place the Flexx Handrail Baluster into the desired insert on the dock **(a)**. Seat the Square Nut into the Connector and hold it in place underneath the insert **(b)**. Insert the ½" x 8" Bolt with the Washer through the top of the Handrail Baluster and into the bottom of the Connector **(c)**. Tighten the Bolt with a cordless drill to secure the Handrail Baluster **(d)**.

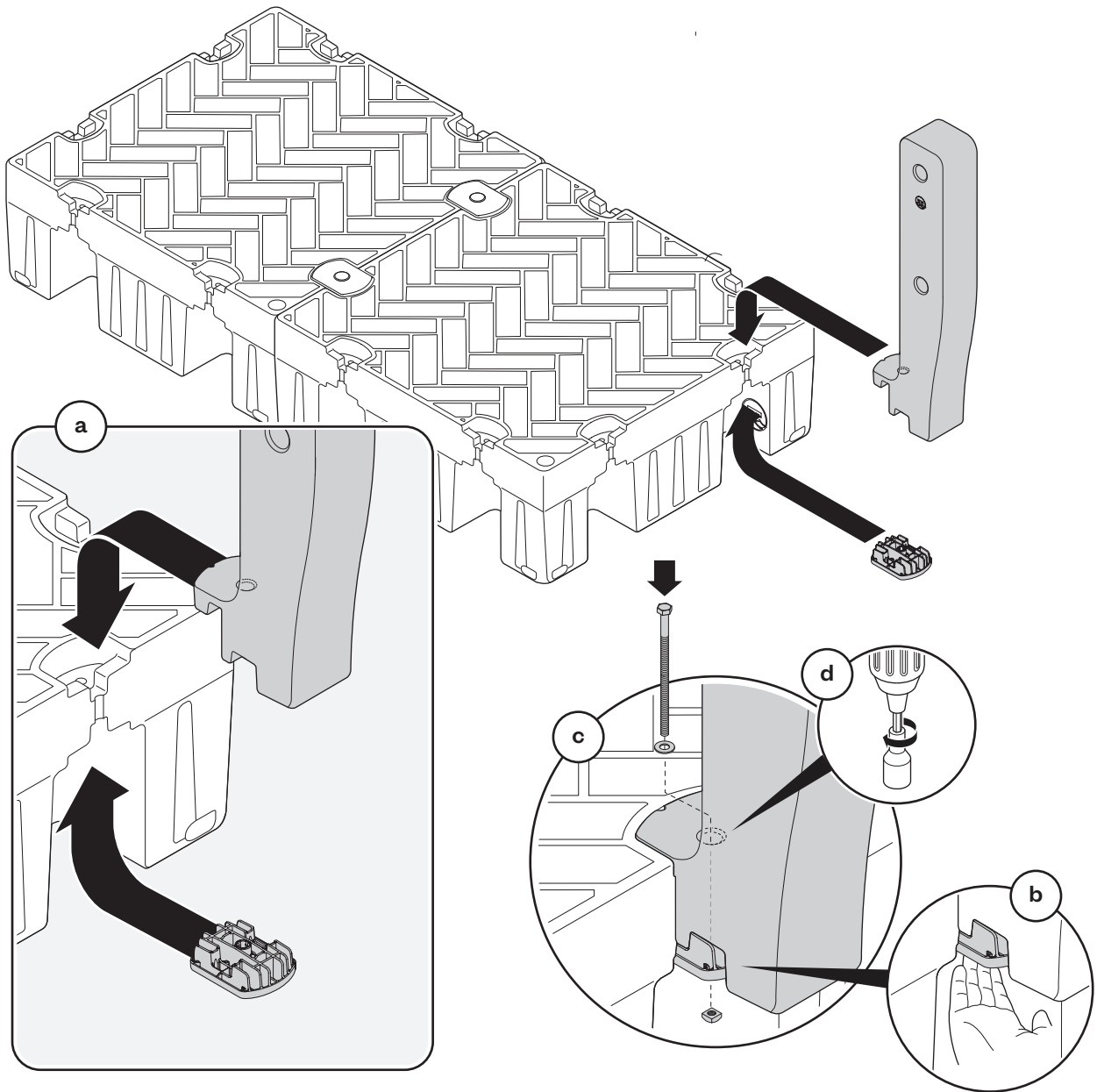

8a

Repeat this step for the remaining Handrail Balusters throughout the dock. Insert the Cap on each Handrail Baluster to cover the fastener.

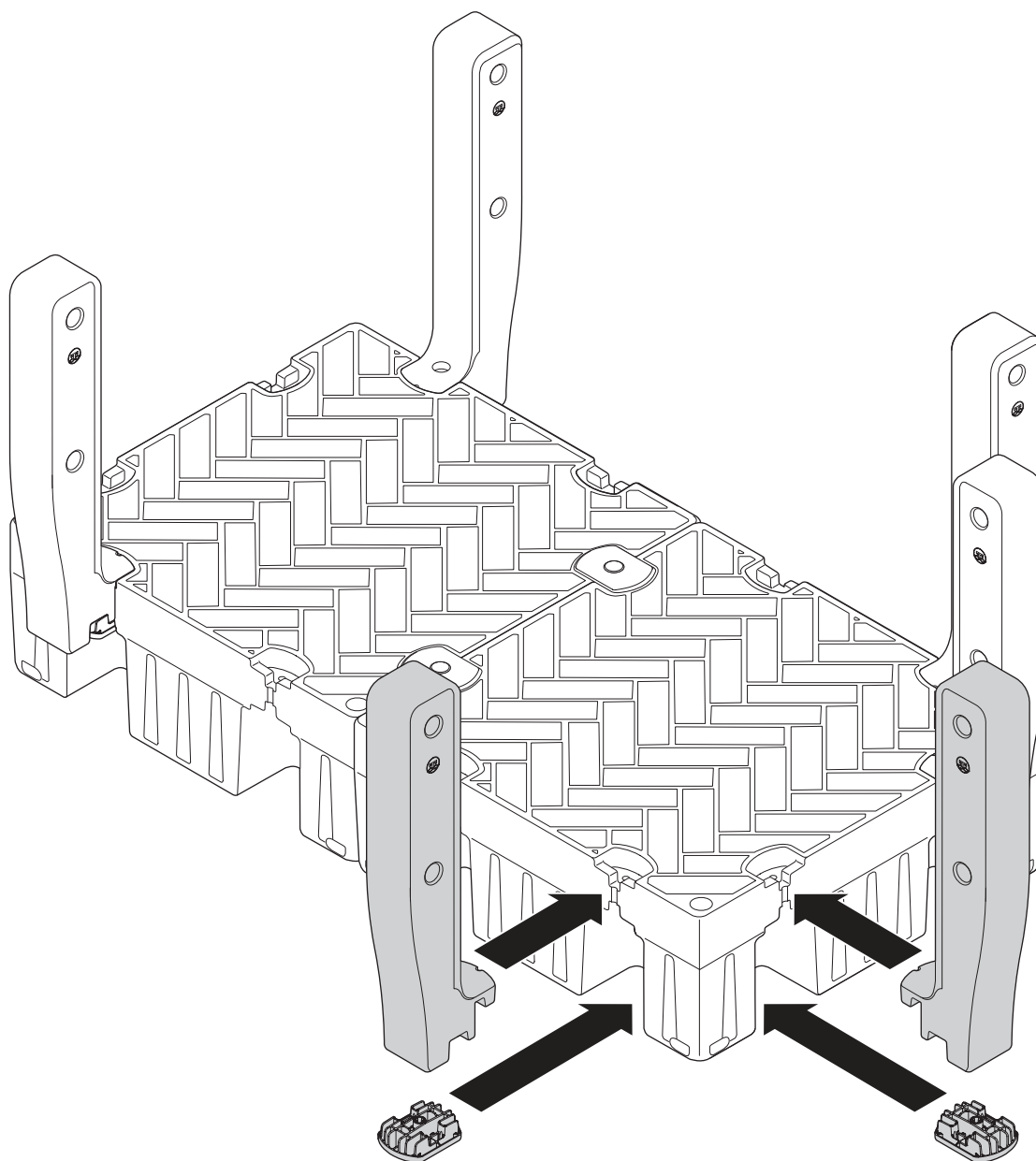

8b First, tie off one end of the Nylon Rope and insert it through holes in the Handrail Baluster. Leave another 1-2 feet of rope at the other end for tying off. Cut any excess rope and cover the ends with the enclosed Rubber Caps. Seal or adhere the caps with a heat gun to prevent fraying.

Note: You may use 2" OD aluminum pipe or ½" schedule 40 PVC pipe as an alternative handrail.

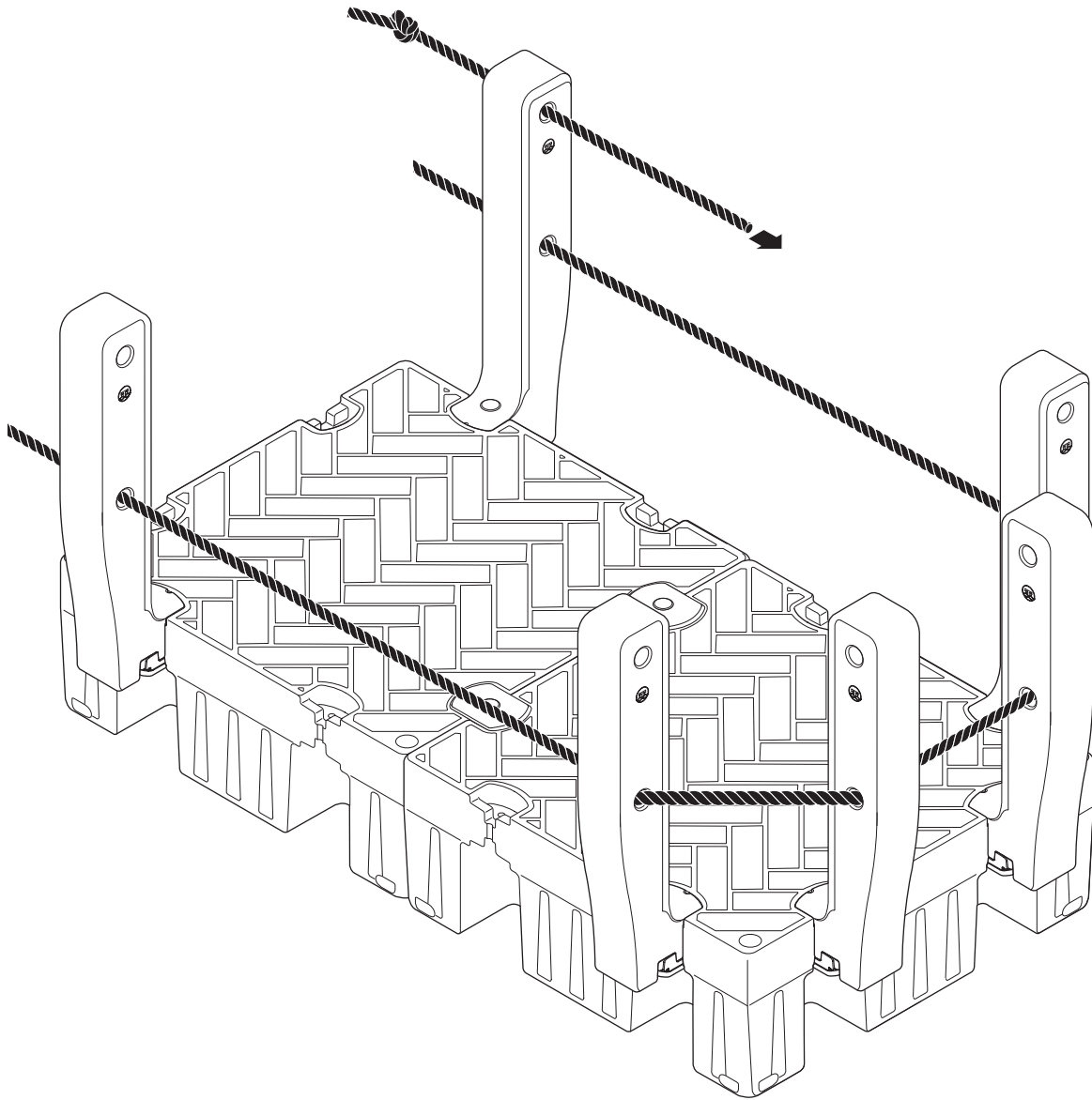

Bumper Kit, TD-30518

Align the Bumper Adapter Plates to the Flat Face Connectors **(a)** and attach using two (2) ½"-13 x ¾" Hex Head Screws **(b)**. The Adapter Plate can also be fastened vertically. Attach bumpers using four (4) ¾" Screws, Washers and Nuts per Straight Bumper **(c)**.

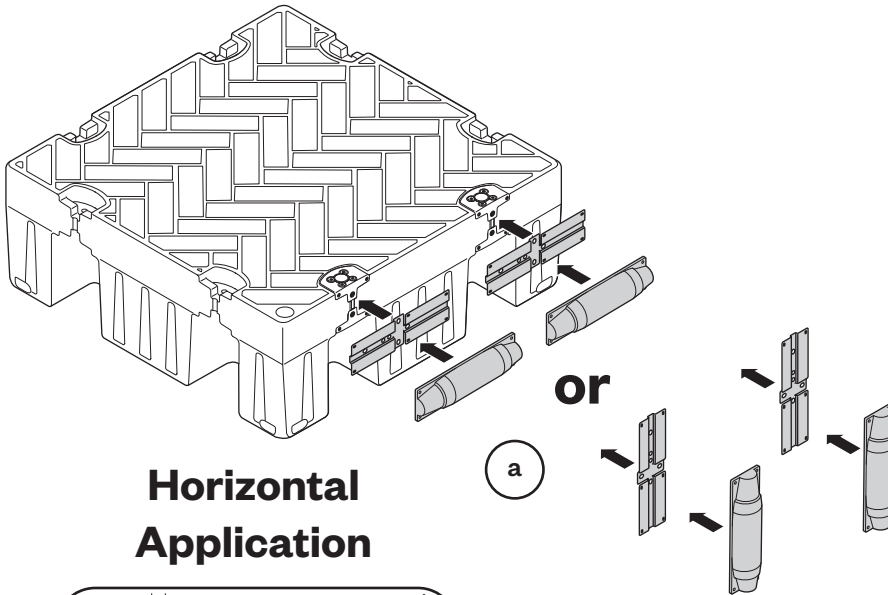

Horizontal Application

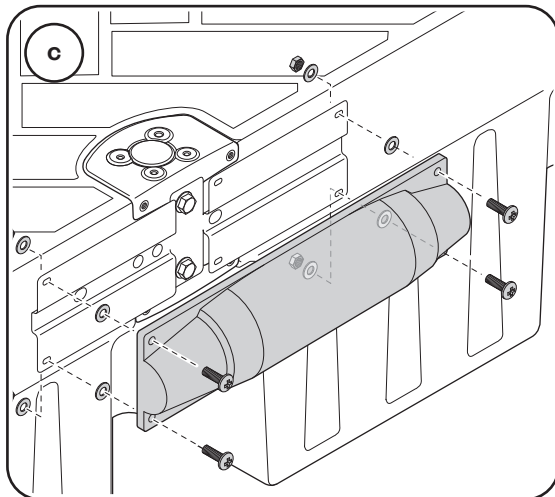
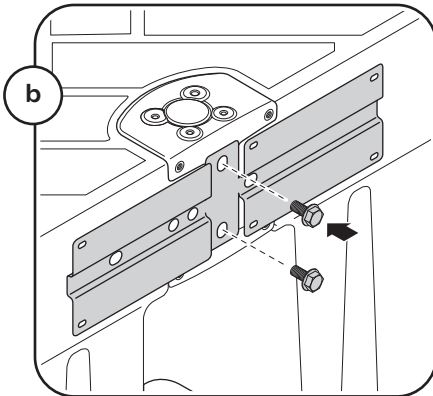

Vertical Application

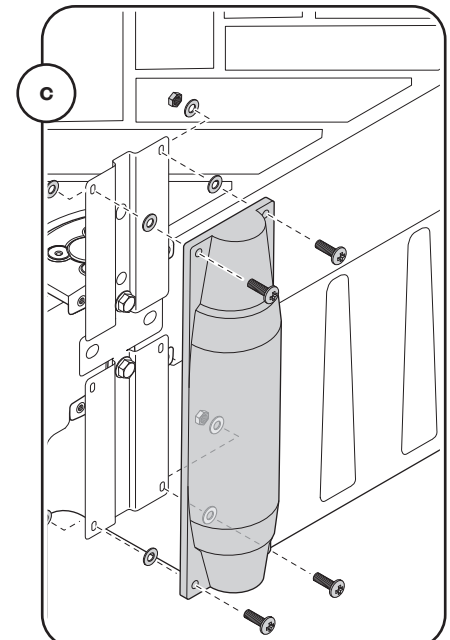
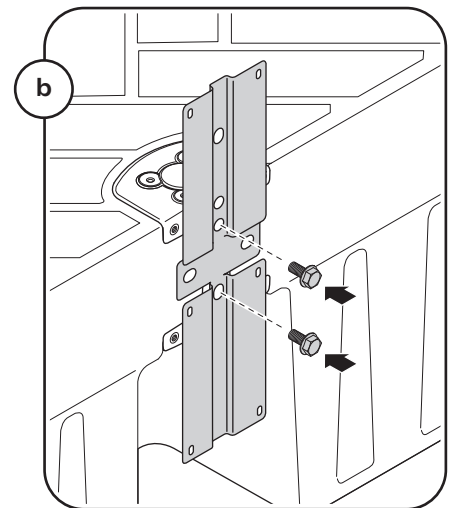

10 Dock Cleat Kit, TD-30525

Using the provided hardware, attach the Dock Cleats to the surface of the Flat Face Connectors using the provided hardware. Use two (2) 10-32 x 1-3/4" Philips Flat Head Screws for attaching the 6" cleats **(a)** and use two (2) 1/4"-20 x 2" Philips Flat Head Screws for attaching the 8" cleats **(b)**.

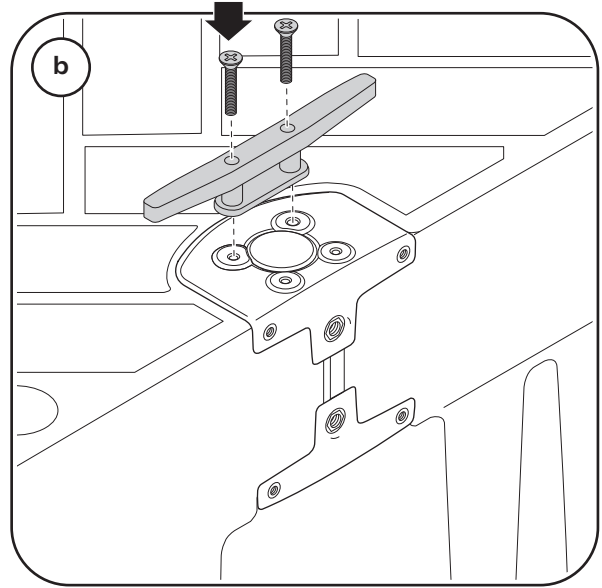
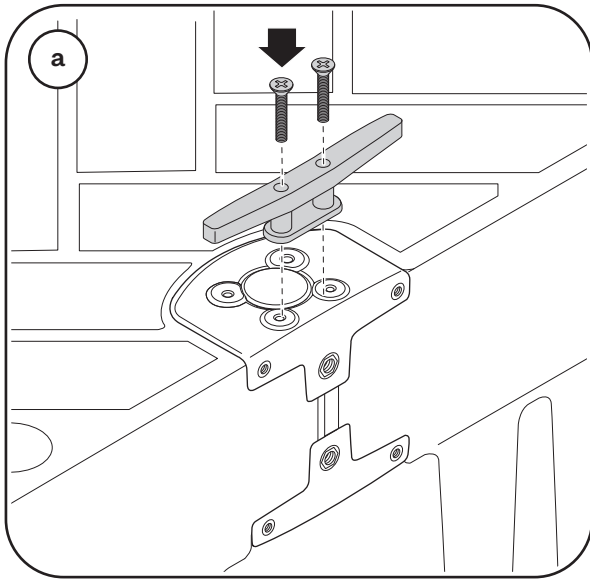

11 Pocket Filler, TDFX-119, TDFX-120

Press fit the Pocket Filler into each desired insert on the outer perimeter of the dock **(a)**. Place the Cap or solar light on top for a clean look or remove to insert the Solar Light option **(b)**.

