

Folding Storage Box Installation Steps

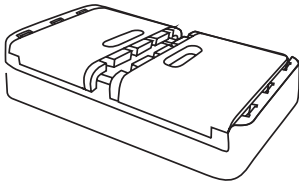

1

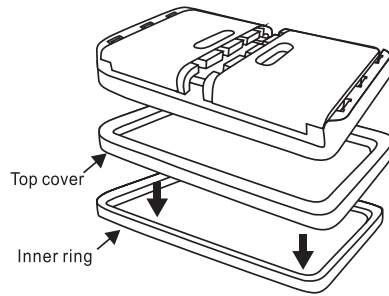

2

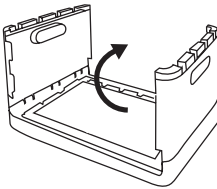

3

Unfold the two side panels.

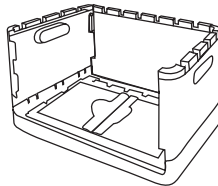

4

Unfold the back panel and fasten the connection.

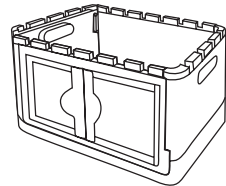

5

Unfold the front panel and fasten the connection.

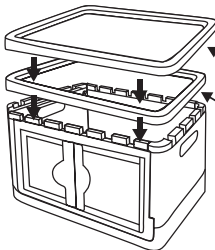

6

Cover the reinforced bezel.

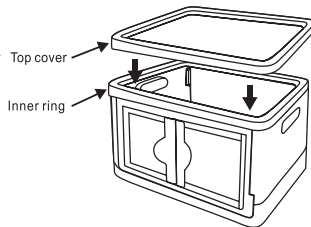

7

Install the top panel.

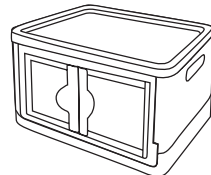

8

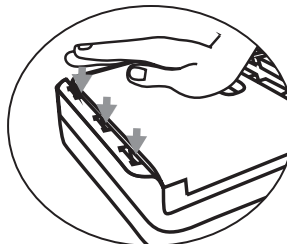

Before the assemblment, please check the each connection is correct or not; If the connection is loose, please press the folding storage box to ensure that it's more solid (You can also refer the picture)

Warm Tips

- 1.This product is made of PP, which is easy to produce deformation in a high-temperature environment.
Please keep it away from heating objects such as furnaces.
- 2.Use sponge and detergent for daily cleaning.
Please do not use a brush to clean.
- 3.Make sure the buckle is pressed in place,
it will be more stable.