



INSTRUCTION MANUAL

SOCKETS



REGISTER YOUR PRODUCT AT

RETROTOUCH.CO.UK/REGISTER

WARNING: BEFORE COMMENCING INSTALLATION ALWAYS ISOLATE YOUR MAINS ELECTRIC SUPPLY AT THE CONSUMER UNIT

Read the instructions carefully before starting the installation process and keep them for future reference. If in any doubt, always consult a qualified electrician or an experienced person registered with an electrical Competent Person Scheme.

This product should be installed in accordance with the relevant sections of the building regulations code, and the current edition of the IET Wiring Regulations (BS 7671) and appropriate statutory regulations.

INSTALLATION – WIRING INSTRUCTIONS



1. Ensure your mains supply to the circuit is isolated at the consumer unit
2. Unscrew the existing socket plate from the wall/mounting
3. Note the cable connections (Take a photo)

4. Disconnect wires from the existing switch and remove switch
5. Reconnect the wires to the new switch to the correct matching terminal
6. Ensure all earth connections have the green/yellow earthing sleeve on.
7. Check all screw terminals are correctly tightened and no bare wires are visible (Do not over tighten)
8. Where dual earth terminals are available, this is for installations where additional earth capacity is needed to comply with 607 IEE Wiring Regulations.
9. Carefully push back the cables and reinstall the socket with the screws provided
10. Fit the fascia cover back on, clip the top side on first then push the lower part of cover till it clicks in place. (Ensure the cover slots are at the bottom)
11. Once installation is complete, replace the fuse/reset RCBO and switch the power back on at the consumer unit and test.
12. To power on the socket, the switch rocker has a pip to indicate "ON" position.

IMPORTANT: An Earth wire must be installed if a metal back box or product with metal front plate is installed. To avoid fire hazard, do not exceed the maximum rated current of the switch.

WIRE IDENTIFICATION – TWIN & EARTH

As from 1st April 2004 new colour codes for hard wire installations was introduced.

	Earth = Green / Yellow Sleeveing
	Live - Brown (after Apr 04) Red (Pre Apr 04)
	Neutral = Blue (after Apr 04) / Black (Pre Apr 04)

To prevent fire hazard always use correct rating cable, size & type for the application.

SOCKET PLATE TYPES:

Single Socket | Double Socket | Double Socket Cooker Switch

All Retrotouch sockets feature a double pole switch that isolates both live and neutral connections, providing full disconnection and improved safety during maintenance or in case of faults.

DOUBLE SOCKET – WIRING

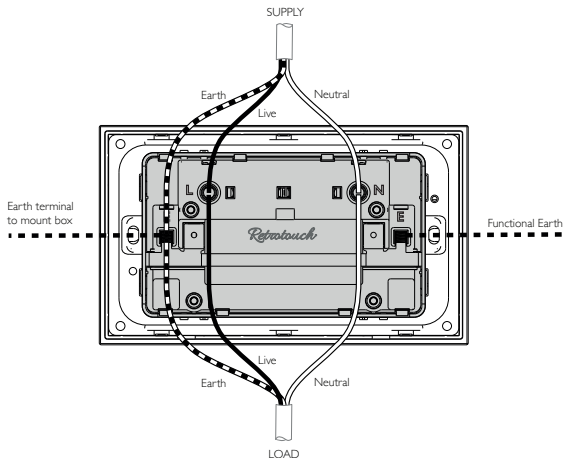

SINGLE SOCKET – WIRING

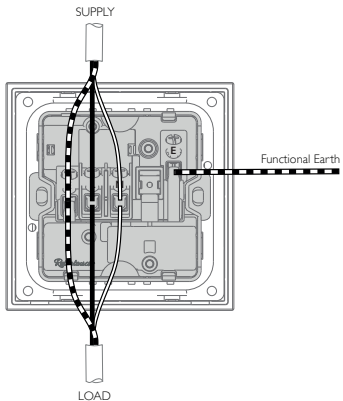

COOKER SOCKET – WIRING

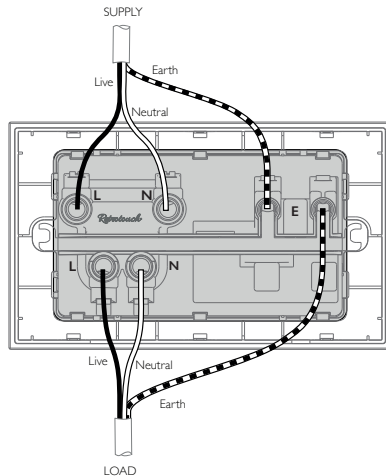

REMOVE THE DECORATIVE FRONT PANEL

Using a medium sized flat screwdriver. Insert the screw driver in the location notch on the bottom of the cover and twist to unclip the cover.

Keep the decorative panel in a safe place. Once installed and the wall painted, then re-attach the decorative panel for a clean finish.

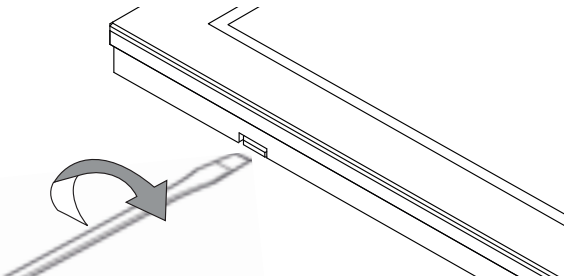

*Retro*touch

SPECIFICATION

Do not exceed the Load Rating of this device as stated on the rear of product:

Voltage: 220-240V ac (50/60Hz)

Rating Socket: 13A DP

Rating Cooker: 45A DP

Terminal capacity: 2 x 2.5mm² 1 x 4mm² 1 x 6.0mm²

Min box depth: 25mm

Use: Indoor Use Only

The product has been independently tested to comply with relevant clauses of the applicable standards BS 1363 (BS4177 Cooker) and certified with CE, UKCA, and RoHS marks to demonstrate conformity.

EU COMPLIANCE CONTACT INFORMATION:

For any inquiries or assistance regarding this product, please contact our EU Authorised Representative:

Eurolink Europe Compliance Limited 25 Herbert Place, Dublin, D02 AY86. Republic of Ireland

Phone: +44 (0)1793 784545 Email: admin@eurolink-europe.ie



WARRANTY

Retrotouch will repair or replace the product, at its discretion, if defective **within 10 years** of delivery due to faulty materials and/or workmanship. The guarantee is void if the product has been improperly installed, maintained, or altered.

This guarantee states the Company's entire liability and excludes consequential losses, damages, or installation costs. It does not affect the consumer's statutory rights.



SCAN FOR SUPPORT

*Retro*touch

Contact Address/Support:

Retrotouch (UK) Ltd

Unit 4 IO Centre, Salbrook Road Industrial Estate, Salfords, Surrey,
RH1 5GJ ENGLAND

For technical assistance please contact our support team on:
+44 (0) 1293 279 426 or support@retrotouch.co.uk

UK
CA



RoHS
COMPLIANT