

Please read the instructions carefully before installing. Our company will not be held responsible for problems caused by not following original instructions.

NOTICE BEFORE INSTALLATION

WATER PRESSURE

■ Water pressure standard

Water pressure standard rate: 0.15MPa-0.55MPa Open the valve and let water run into a bucket with volume measure for 15 seconds. If water in the bucket is more than 4 L, minimum water pressure is met. Please adjust the angle to fit in using when if the water pressure is too high.

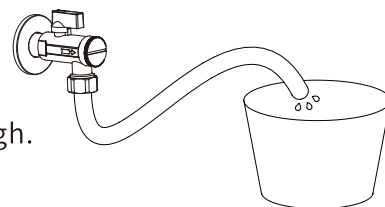

■ Drainage operation

Turn on the angle valve and drain off water over 2 minutes before installing inlet tube onto angle valve.

INSTALLATION SPACE

- Ensure there is enough space around the unit, confirm the bathroom door or shower door will not hit the unit when they open.
- Ensure the minimum distance from the wall to the center of the floor drain is 305mm or 12" long.
- A GFI plug is required close to the unit.

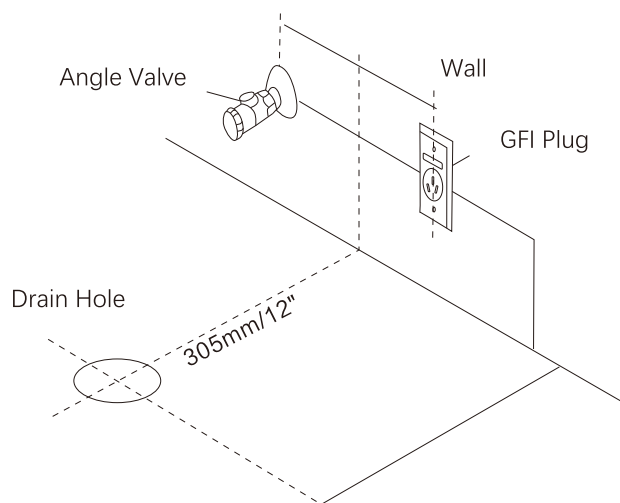

INSTALLATION DRAWING PLAN

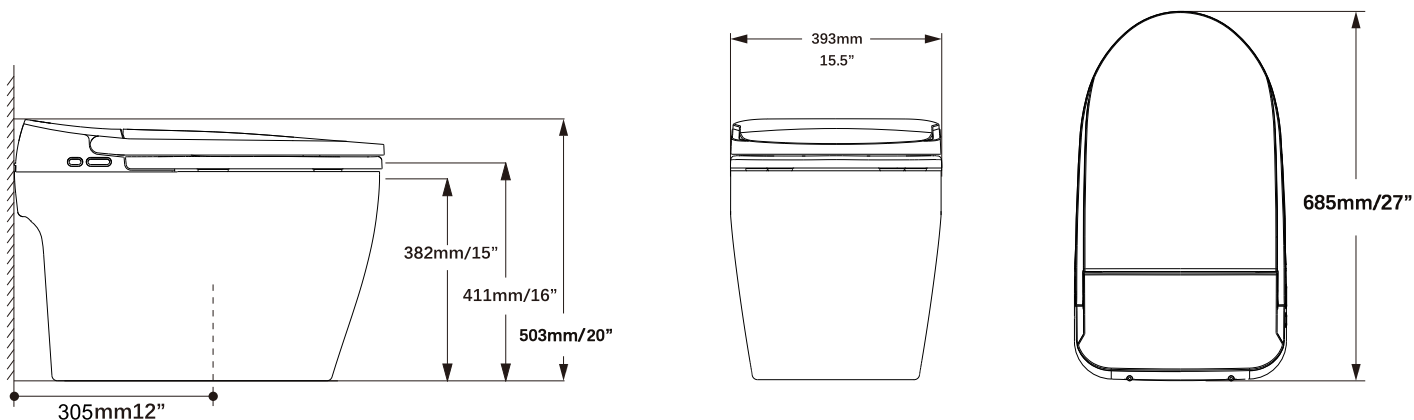

CAUTION

- The drawing plan is not the actual scale of the unit.
- When doing the installation in cold weather, leave the unit in room temperature for at least four hours before installing.

INSTALLATION STEPS

1. For the bathroom newly installing a toilet , a flange with bolt shall be added.

Note: You need to install flange according to the size and position of the two bolt holes at the bottom of the ceramic.
See Figure 1

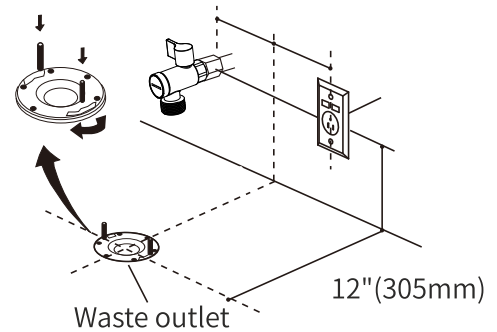
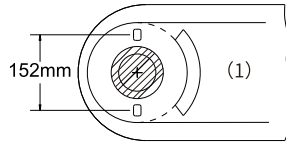

2. Lift the flip lid assembly from the toilet, up from the inside.

Note: Do not pull the lid roughly when lifting the toilet flip lid

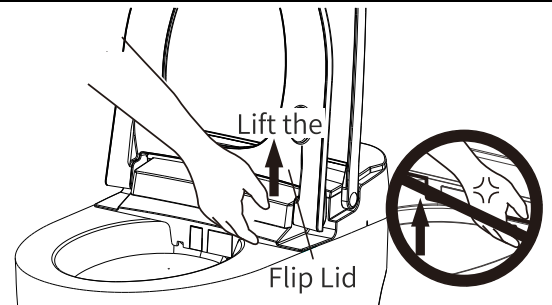

3. Install a flange under the toilet.

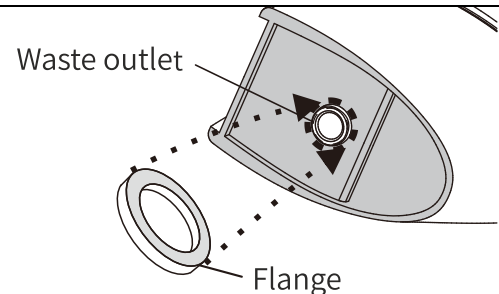

4. Put toilet on the flange, making sure the bolts line up with the holes in the toilet.
(from the top)

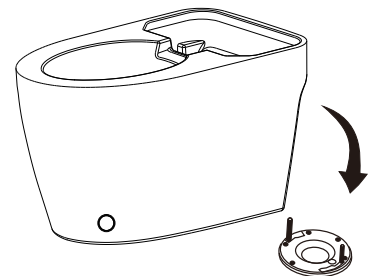

5. Use a spanner to lock the nut and other accessories to the retaining bolts.
(from the top)

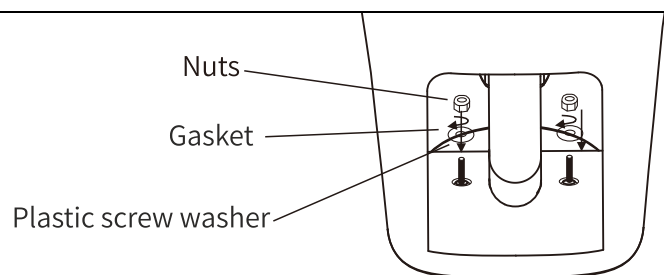

6. To install seat cover and ceramic bowl: the seat cover shall be aligned with the ceramic bowl.

Then press down with hands

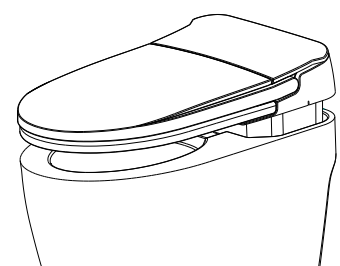

7. Install the water inlet angle valve and connect the dedicated hose (before connect the dedicated hose, please drainage for 3-5 minutes, ensuring the pipe it is clean and won't be blocked)

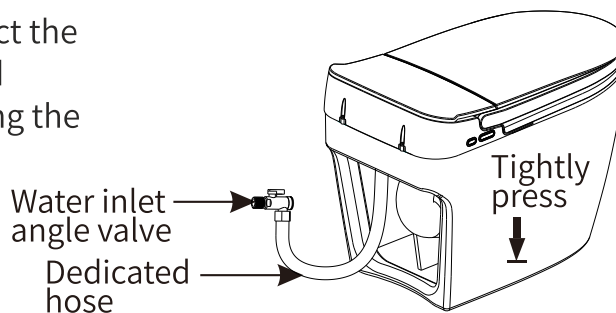

Filter screen should be cleaned with clear water every three months

Steps to clean filter screen: Turn off the valve, unscrew filter screen, carefully rinse with clean water.

Pipe and valve could be different from above graphic, due to production batches, please refer to actual product

BATTERY INSTALLATION

Steps

1. Find Figure 2 to install the battery into the battery box.
2. Insert a new battery in the direction of the arrow and tighten the waterproof cap lockwise.
3. Press the flush button to make sure it flushes properly

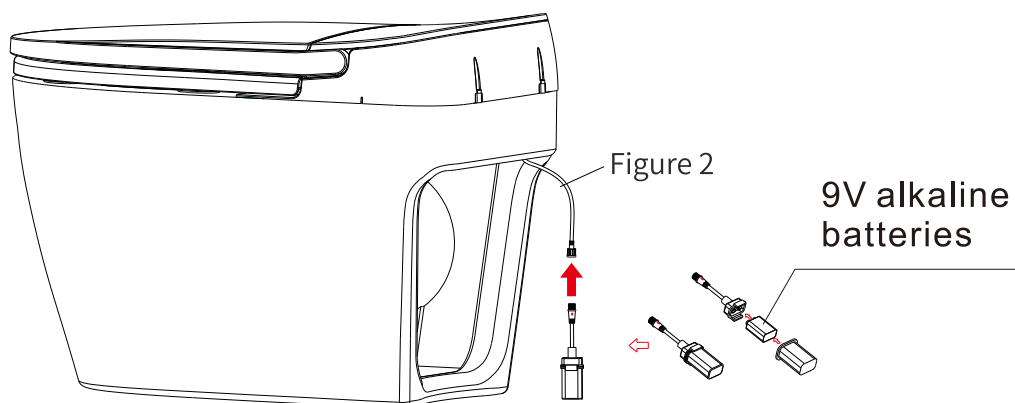

Note

1. The intelligent toilet accessories have been debugged and are strictly prohibited for personal disassembly.
2. Please use the fittings and hoses provided by our company. Old fittings and hoses cannot be reused.

MAINTENANCE

REGULAR MAINTENANCE

Cleaning the unit

1. Gently wipe dirt and stains with a dry soft cloth or sponge, do not apply any chemical solutions to the unit.

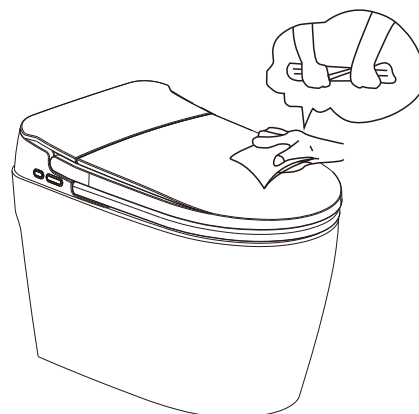

Cleaning the nozzle

1. Works when user not sitting on the unit.
Press female clean button by side button, the nozzle will stretch out and self-cleaning function will initiate. When self-cleaning function turns on, the nozzle will not spray water. Gently wipe the nozzle with a soft cloth or brush with toothbrush.
2. The cleansing schedule is 90 seconds, the nozzle will be static in first 70 seconds and will move back and forth in last 20 seconds. Nozzle will retract back to the unit after cleansing. Repeat the process if necessary.
3. Warning, do not apply force by pulling, pushing or attempt to bend the nozzle, this will result in damage or electrical shock.

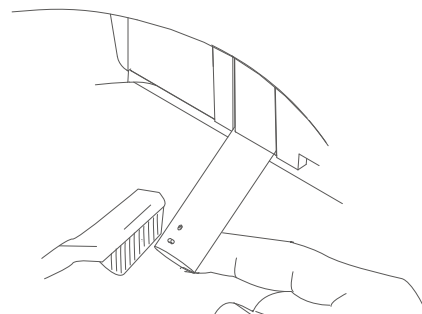

Cleaning the filter

1. Power off the unit, unplug power cord with dry hand. Use tool to unscrew the filter if necessary.
2. Rinse with clear water, use a brush if necessary.
3. Install the filter back to its original position, check for leakage.

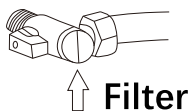

Installation Guide

Concealed Trap Toilet with L Bolts Brackets

1)

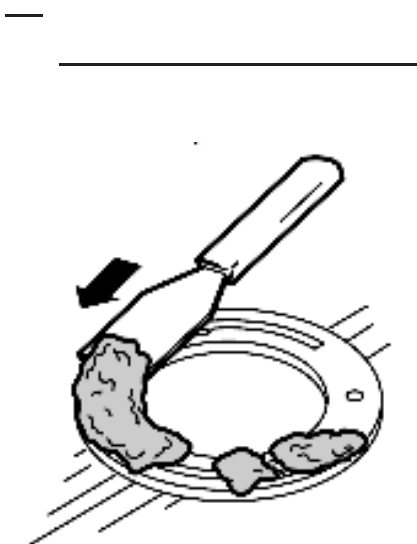

2)

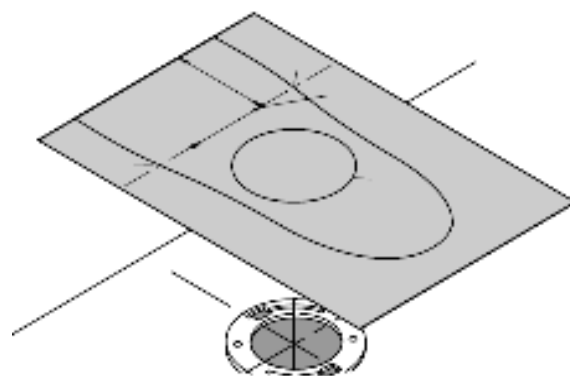

3)

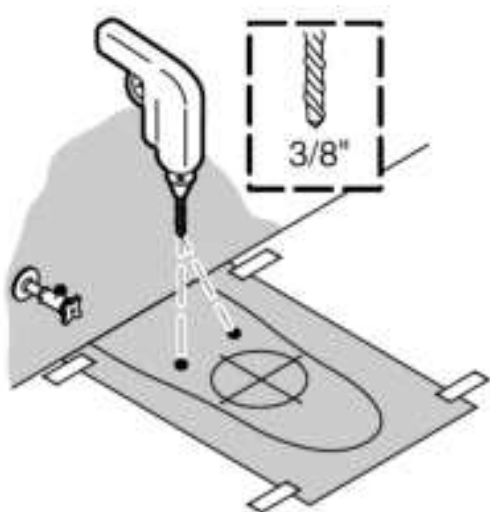

5)

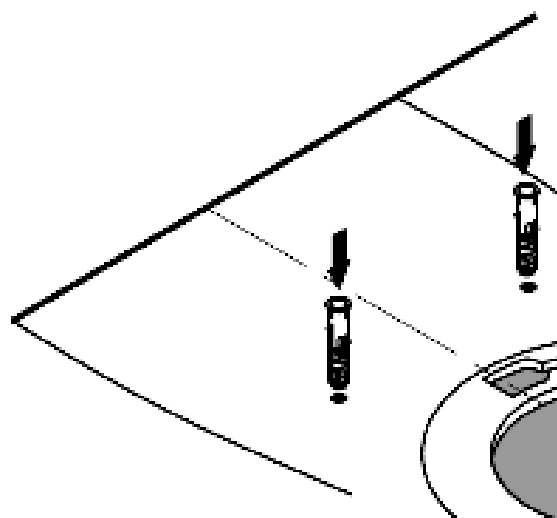

6) Install the mounting L Shaped brackets.

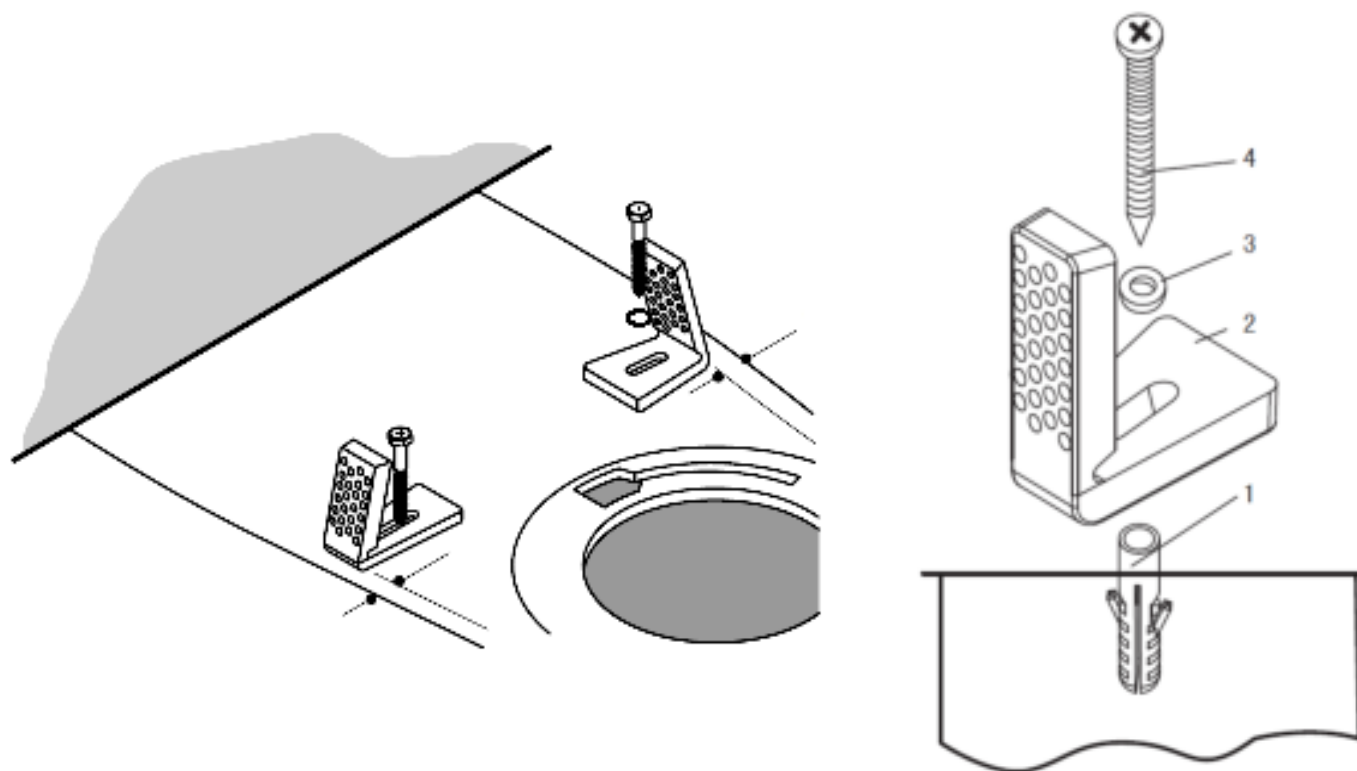

7) Place the Wax ring

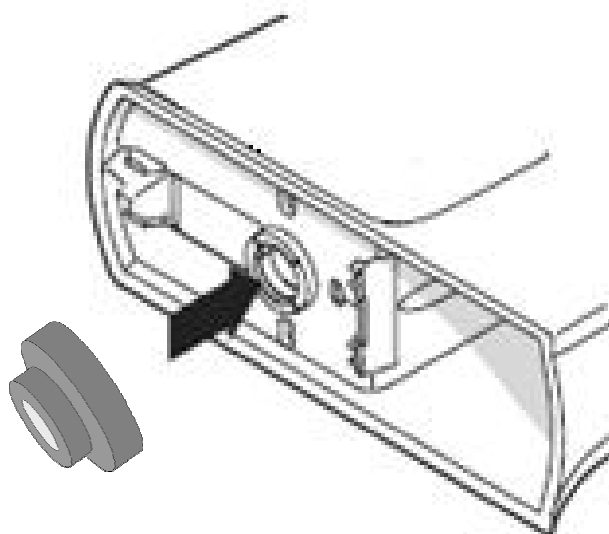

8) Apply weight evenly.

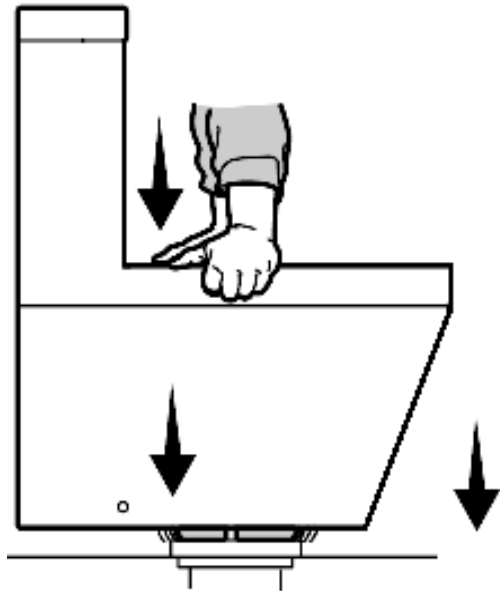

9) Carefully lower toilet over the mounting brackets.

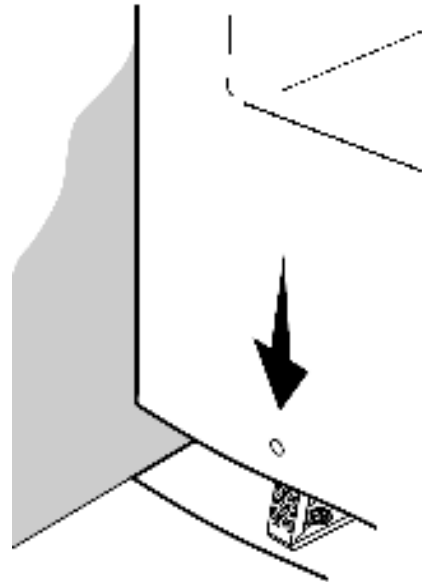

10) Install the bolts into the bracket, and tighten evenly. Do not overtighten! Affix bolt caps after installation.

