

# Install and Connect MP54 (E2)

## Package Contents

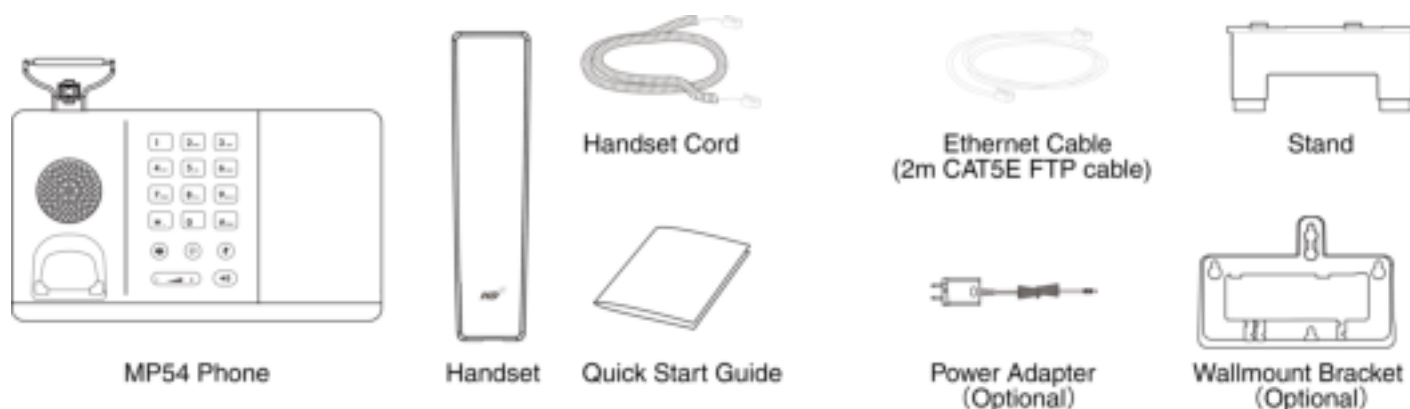

### **NOTE**

We recommend that you use the accessories provided or approved by Yealink. The unapproved third-party accessories may result in reduced performance.

## Assemble MP54 (E2) and Put it on a Table



## (Optional) Mount MP54 (E2) on the Wall

## 1. Mount the screws

Yealink provides the wall mount drilling templates, which locate and mark the position for mounting the screws (not provided) on the wall, as shown below:

- For American standards:

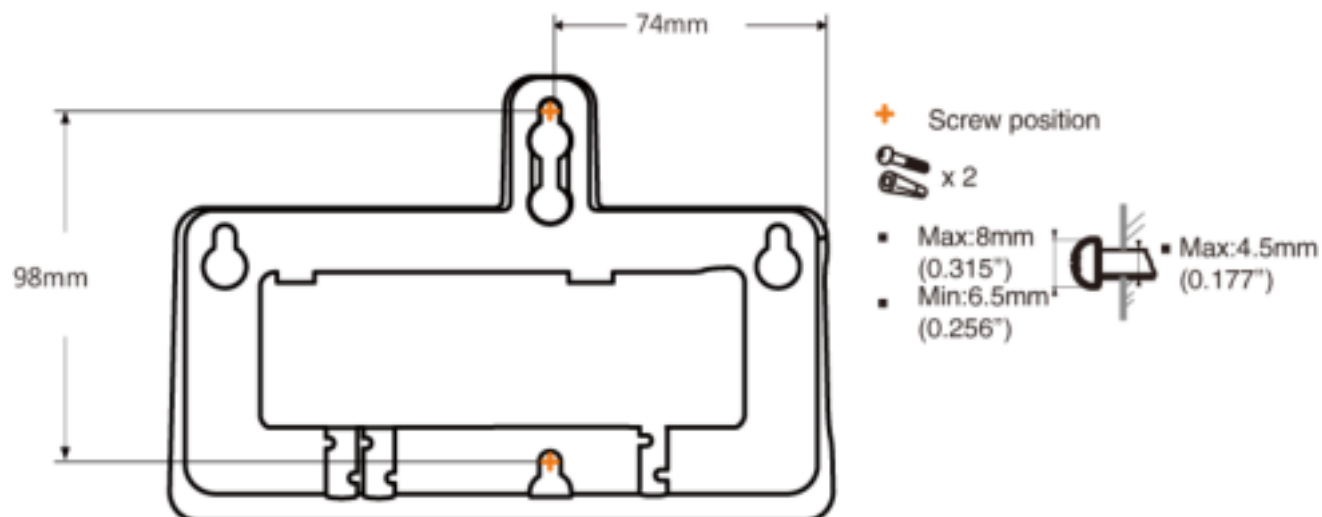

- For others:

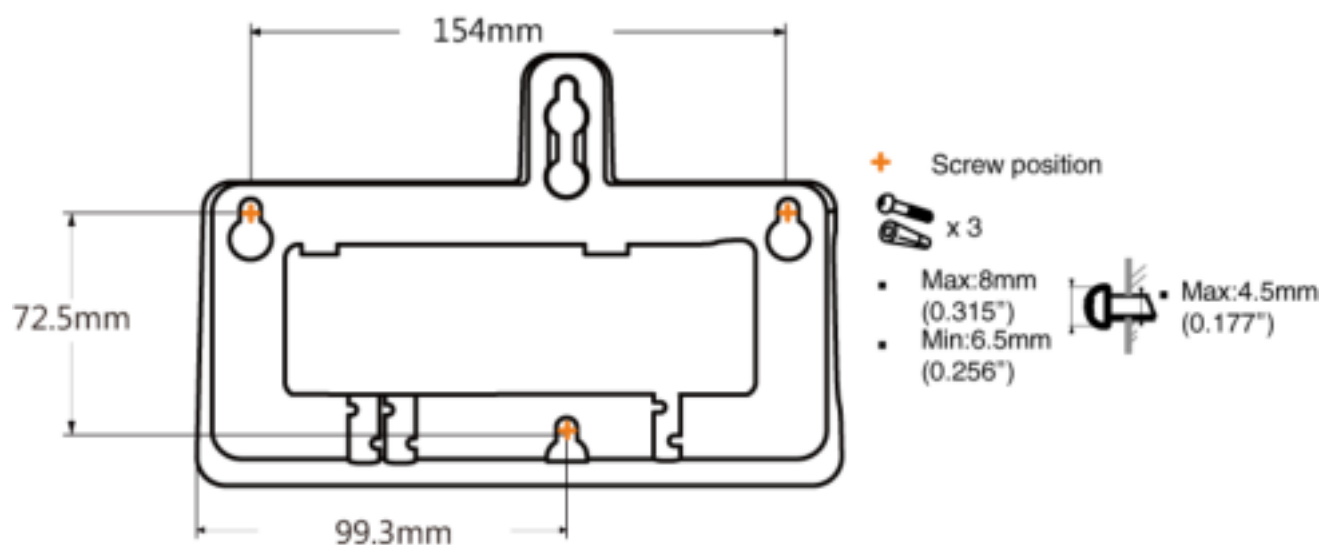

2. Attach the wall mount bracket

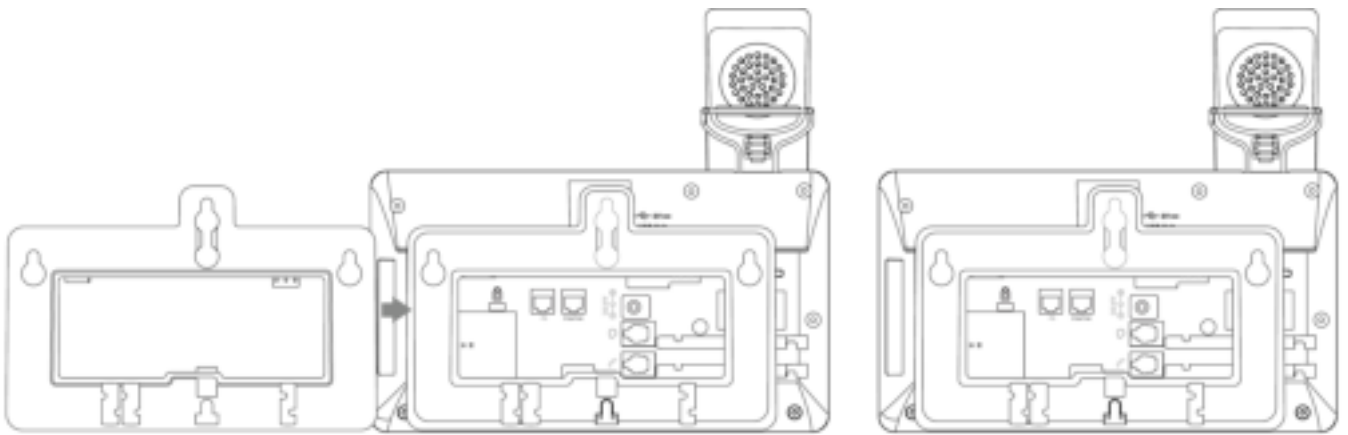

3. Adjust the hookswitch tab

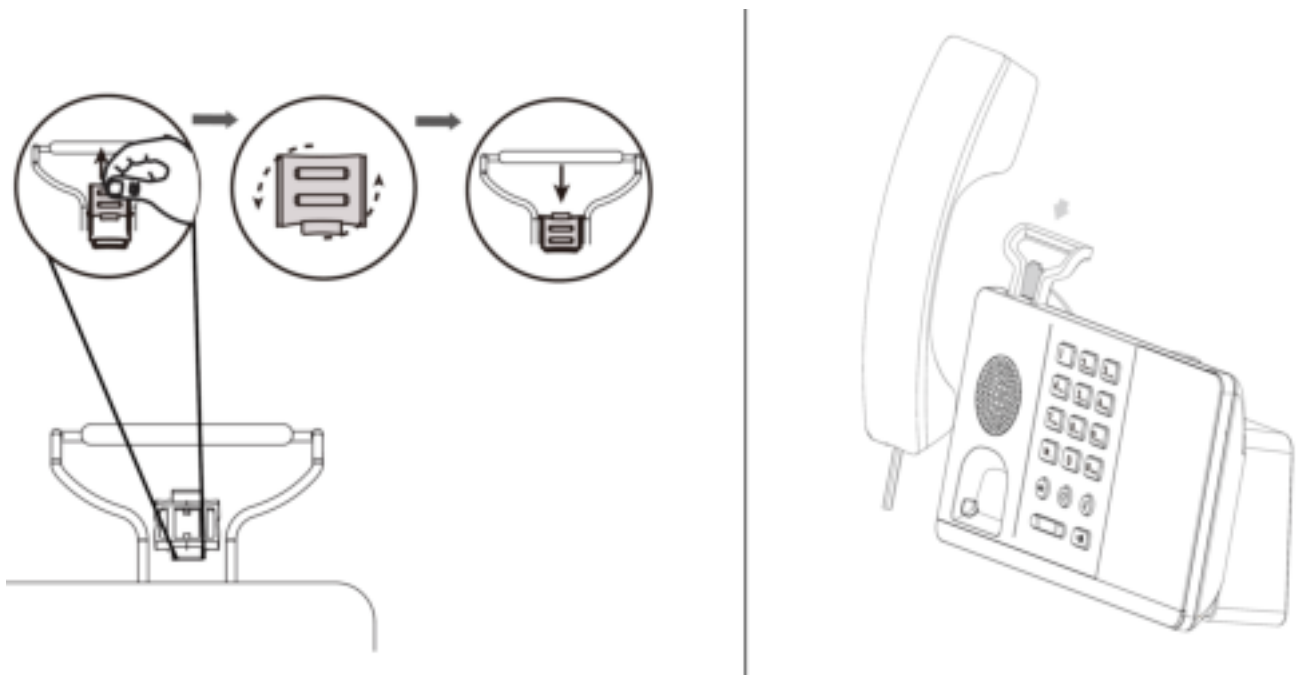

#### 4. Mount the IP phone to the wall

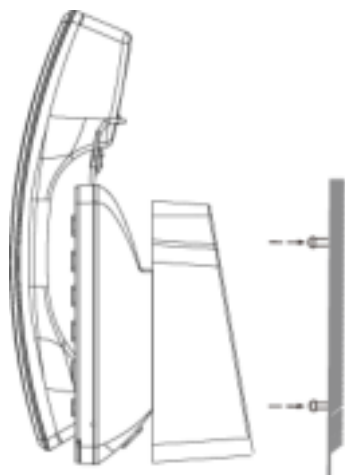

### Connection

