

Turn Signal Switch

Model 104

Installation and Specifications Manual

Microflex Labs
RideLightSolution.com

Description

The model 104 turn signal switch provides left and right turn signal momentary switches for 2-inch diameter steering column mounting. Adapters are available for use with other common diameters.

The switch uses digital hall-effect sensors to detect the presence of a magnet. A magnet, mounted to the lever is moved for right or left switching. When the magnet is moved close to one of the sensors battery voltage is produced on the output. When the lever is released, it springs back to the center position and the output returns to 0 volts. There are no mechanical switch contacts to wear or corrode. Electronics are fully sealed in epoxy providing a tough weather-proof turn signal switch that can be used in wet locations, including high pressure spray washing, and has an IP68 rating.

Model 104 outputs cannot provide enough power to drive lights directly. The model 104 switch must be used with a lights controller.

The lever knob is removable to allow for a custom knob to match your vehicle design.

Features

- Sealed hall-effect digital switches
- Suitable for wet locations
- Can be installed without removing the steering wheel
- Billet aluminum enclosure
- Stainless-steel hardware
- Removable lever knob allows for customization
- Wide operating voltage range - can be used on 6V, 12V, and 24V systems



Specifications

Supply Power (Battery)	
Minimum	5 Volts
Max	30 Volts
Operating Current	3mA (max)
Harness	
Red Wire	Battery (+), 22-Gauge
Black Wire	Ground, 22-Gauge
Yellow Wire	Left Turn - Lever Down, 22-Gauge
White Wire	Right Turn - Lever Up, 22 Gauge
Cable	Black PVC .20 [5mm] Diameter
Length	36" [900mm]
Switches	
Drive Current, Each Switch	20mA (max)
Open	0.5V (max at 1K Ω load)
Closed	Supply - 0.5 V (min)
Materials	
Enclosure, Lever, and Knob	6061-T6 Aluminum
Screws	Stainless Steel
Electronics enclosure	ASA plastic
Environmental	
Operating Temp	-22°F to 122°F [-30°C to 50°C]
Storage Temp	-40°F to 158°F [-40°C to 70°C]
Seal	Epoxy Potting
Weight	6oz [175g]
IP Rating	68

Specifications

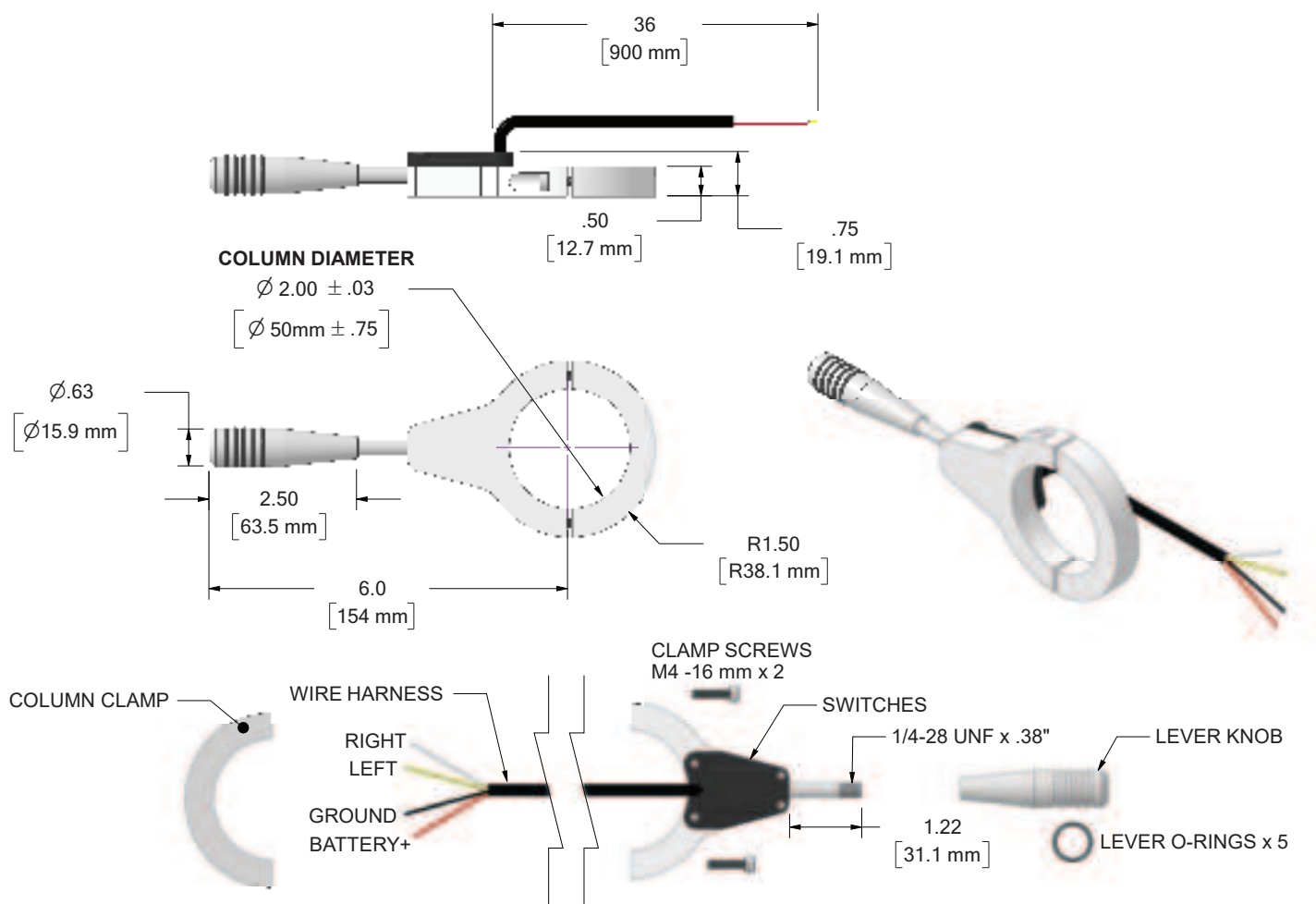

Microflex Labs
35900 Royal Road
Pattison, Texas 77423
USA

RideLightSolution.com

