

ColorFit Ultra 3 Luminary

Please refer to this manual
before using the product

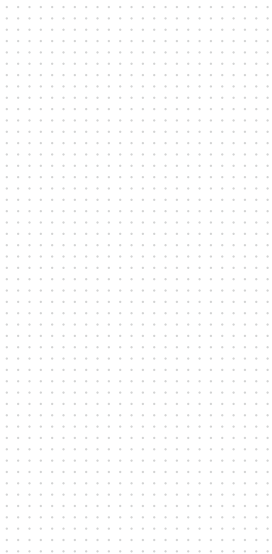

TABLE OF CONTENT

• What's in the Box	01
• Watch Overview	
• Charge the Watch	02
• Turn the Watch On and Off	03
• Watch Navigation	04
-Button	
-Home Screen Navigation	
• Setup	05
-App Setup	
-Pair the Watch	
• General Device Information and Tips	06-13
• Safety Information	16
• Medical Information	17
• Disposal Information	18
• Customer Support	19

WATCH OVERVIEW

- Noise Health
- Noise Buzz
- Clock
- Workouts
- Sports Record
- Reminders
- Music
- Weather
- Breathing Light / Lumilert
- Glow Friend / Lumiping
- Watch faces
- Flashlight
- Calculator
- Settings

PACKAGE CONTAINS

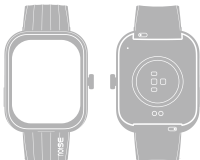

ColorFit Ultra 3 Luminary Smartwatch x 1



Charging Cable x 1

CHARGING COLORFIT ULTRA 3 LUMINARY SMARTWATCH

Before using your ColorFit Ultra 3 Luminary for the first time, charge the battery to its full capacity. Use the charging cable provided with the watch to charge. On a full charge, ColorFit Ultra 3 Luminary can last up to 7 days.

Note: The battery life and time to fully charge your device may vary as per usage and other factors.

CHARGE COLORFIT ULTRA 3 LUMINARY

- Plug the USB cable into a power adapter and the adapter into an electrical socket. (Power adapter not included).
- Place the magnetic charger into the magnetic charging points of the smartwatch.
- While your watch is charging, the screen will show its progress.
- Once the battery is fully charged, remove the charger.



POWER ON

- Press and hold the upper side button for a few seconds to turn on the watch.

POWER OFF

- Press and hold the side button for a few seconds.
- Select "Power Off" and confirm to power off.

WAKING UP THE WATCH

To preserve battery life, the watch screen turns off when not in use.
To turn the screen back on, you can wake up the watch by:

- Pressing the upper side button
- Turning on the wrist sense



WATCH NAVIGATION

The ColorFit Ultra 3 Luminary smartwatch has a AMOLED touchscreen. Navigate the watch by tapping on the screen, swiping side to side, swiping up and down, and rotating the crown.

SIDE BUTTON NAVIGATION

- Press the side button to turn on the watch display.
- Rotate the side button to change the watch face.

HOME SCREEN NAVIGATION

The home screen is the watch face.
From the home screen:

- Swipe right to check your Activity data.
- Swipe left to check your heart rate.
- Swipe up to go to quick settings.
- Swipe down to check message notifications.
- Press the lower side button to go directly to Sports Mode from the home screen.



APP SETUP

Before pairing, make sure that your smartphone and smartwatch are next to each other.

- Turn on the Bluetooth and location on your mobile device.
- On your smartphone, download the NoiseFit app from the Play Store or the App Store and install it.
- The app will ask for personal information such as your gender, birthday, height, weight and step length to calculate your stride length, distance covered, and calorie burn rate.

Note: Ensure your smartphone is running on Android 9+ or iOS 11+ and is connected to mobile data or a Wi-Fi network.

PAIR THE WATCH

- Open the NoiseFit App and allow the BT and GPS positioning to be turned on.
- Feed-in your personal information and health goals in the app.
- Go to the 'Device' page and select 'Add Device' in the app, the watch name and MAC address and link the watch. You can also scan the QR code on the ColorFit Ultra 3 Luminary from the NoiseFit App.

BT CALL CONNECTIVITY

To establish Bluetooth calling connectivity, follow these steps. For automatic connection:

- After pairing the watch with the NoiseFit App, the watch's calling Bluetooth would be activated. Now connect it with your phone's Bluetooth to use the calling feature conveniently.

MANUAL CONNECTION

In case the Bluetooth calling connectivity has not been established earlier, you'll have to do the steps manually.

- Go to Settings.
- Search for the device and pair your smartphone to attend your calls from the watch.

BT CALL CONNECTIVITY REMOVAL

In Android devices, to remove the BT connection, you can unpair from the app and the phone's

BT settings. Go to the phone's BT settings and forget ColorFit Ultra 3 Luminary. In iOS devices, to remove the BT connection, you can unpair from the app and the phone's BT settings. Go to the phone's BT settings and forget ColorFit Ultra 3 Luminary and ColorFit Ultra 3 Luminary Calling.

NOISE HEALTH

Noise health comes with a collection of wellness features so that you can take better care of yourself. You can check your activity, heart rate, blood oxygen, sleep, breathing, stress levels and cycle tracker by tapping on Noise Health.

ACTIVITY

Tap on activity to get a detailed daily activity report on calories burned, steps taken, standing minutes, distance covered and active time. You can set or edit your daily activity goals on the NoiseFit App while setting up the watch.



HEART RATE

Select the heart rate feature to start measuring. Ensure that there is no gap between the back panel of the watch and the wrist. Hold still while it measures your heart rate.



BLOOD OXYGEN

The smartwatch supports viewing of the highest and lowest values of blood oxygen level of the day. Ensure that there is no gap between the back panel of the watch and the wrist. Hold still while it measures your blood oxygen level.



SLEEP

Tap sleep to view your previous sleep duration. You can view your most recent sleep records and sleep quality in various sleep stages on the NoiseFit App.



BREATHE

The breathe feature lets you adjust your breathing rhythm as per your convenience. Choose from 3 speeds - fast, moderate & slow. Choose the duration and start.



STRESS

Select stress to start the measurement. Ensure that there is no gap between the back panel of the watch and the wrist. Hold still while it measures your stress levels.



CYCLE TRACKER

You can use this feature to keep track of your menstrual cycles and plan better. Feed in the information to start tracking.

NOISE BUZZ

Tap on the Noise Buzz to access the dial pad, save up to 10 contacts on your watch, view your contacts and check call history.

CLOCK

Tap on the clock to access your alarms, timer and stopwatch.

WORKOUTS

Tap on workouts and select your preferred form of exercise.

SPORTS RECORD

Tap on sports records to check on your recent performance.

REMINDERS

Select reminders to set your preferred reminder. You can add or edit reminders on the NoiseFit App.

MUSIC

You can control your favourite songs and podcasts that play from your phone, right on your wrist as long as the watch is connected with the NoiseFit App on the phone. You can play/pause music, go to the next/previous track and increase/decrease volume.

WEATHER

ColorFit Ultra 3 Luminary supports 7-day weather viewing in a location of your choice as long as it is synced with the NoiseFit App. You can view it today's current weather and for the next 4 days as well. Go to the NoiseFit App, select 'Devices' and click on 'Weather settings' to enable the feature.

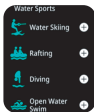

BREATHING LIGHT/LUMILERT

You can set different colours for your notifications and alerts or up to 5 different apps. Switch on Breathing Light and colour code your notifications in red, green, yellow, blue and white. Go to the NoiseFit App, select 'My Device' and click on 'Breathing Light/Lumilert' to enable the feature.

GLOW FRIEND/LUMIPING

You can send real-time emojis/reactions to up to 5 friends on your device. Note that your friends must also have the ColorFit Ultra 3 Luminary smartwatch to activate this feature. Go to the NoiseFit App and make sure you're connected to the community so it reflects on LumiPing. Select 'My Device' and click on 'Glow Friend/Lumiping' to enable this feature. Switch it on and then search for your friends within the NoiseFit App community on the menu to add them as Glow Buddies.

WATCH FACES

Long press the home screen to access your saved watch faces. Swipe left/right to navigate. You can customise your watch face on the NoiseFit App.

FLASHLIGHT

You can use this feature to turn on the screen brightness and see your surroundings better. Go to the Flashlight. Tap to turn on.

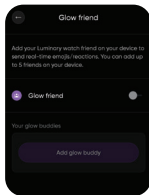
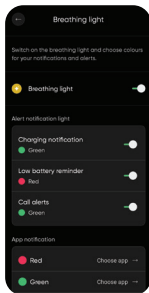

CALCULATOR

You can use this feature to do basic calculations.



SETTINGS

WRIST AWAKE

Tap on Wrist Awake. Activate the wrist awake feature for a set amount of time or leave it on all-day.

TAP TO WAKE UP

Tap on wake up. Activate the wake up feature for a set amount of time or leave it on all-day.

BRIGHTNESS

You can set the brightness as per your preference.

SCREEN TIMEOUT

Tap on screen timeout and select the right amount of time before your screen times out.

ALWAYS ON DISPLAY

Tap on Always on Display and choose the time you want the screen to remain on. Leaving this feature on all the time can impact battery consumption.

DO NOT DISTURB

Tap on Do not disturb and select the amount of time you want notifications to be turned off.

RINGTONE VIBRATION

You can set the ring and vibration as per your preference.

MENU VIEW

Tap on the menu view and make your selection from a grid or list view.

AUTO SPORTS DETECTION

Tap on Auto sports detection to turn it on or off.

WIDGET SORTING

You can use this feature to personalise the widgets' display as per your preference.

ABOUT CALLS

To use this feature, connect your phone's Bluetooth with your watch's Bluetooth.

DEVICE INFO

Tap on Device Info to view your device information.

QR CODE

Tap on QR code to scan your device.

REBOOT

You can also choose this option to reboot your watch.

POWER OFF

You can select this option to power off your watch.

RESET

You can choose to reset. Do note if you choose to reset, all your data and settings will be erased.

QUICK SETTINGS

You can swipe up from the watch's home screen to gain access to quick settings.

SILENT MODE

FIND PHONE

BRIGHTNESS

DND

POWER SAVING MODE

SETTINGS



DEVICE INFORMATION AND TIPS

DEVICE INFORMATION

The ColorFit Ultra 3 Luminary smartwatch contains the following

- 1.96" AMOLED screen display (410*502 px)
- BT calling (built-in microphone & speakers, recent calls, dial pad, contacts)
- 150 cloud-based & customisable watch faces
- Health tracking with NoiseFit App (Activity tracking, blood oxygen monitor, sleep tracker, 24*7 heart rate monitor, breathe, stress tracker, female cycle tracker)
- 7 days of use, 2 days with calling & 30 days on standby.
- Utility/productivity features (Stopwatch, alarm, timer, reminder, DND, weather, camera/music controls, breathing light/Lumilert, glow buddy/Lumiping)
- IP68 waterproof

TIPS

How do I update my ColorFit Ultra 3 Luminary?

You can update your ColorFit Ultra 3 Luminary via the NoiseFit App. Go to My Device and select Check for Updates.

How do I find my watch's current firmware version?

You can find the watch's current firmware on the watch.

Go to 'My Device' on the NoiseFit App.

Select "Upgrade", choose "Check for Updates" and update if one is available.

How do I save battery?

Follow these simple steps to save ColorFit Ultra 3 Luminary battery.

- Minimise the screen brightness.
- Limit the notifications you receive from the NoiseFit App.

How does the watch estimate how many calories have been burned?

ColorFit Ultra 3 Luminary estimates how many calories you've burned based on the physical data you entered when you set up your account.

How do I change my activity goals?

You can do it through the NoiseFit App.

Go to 'My Profile' and select 'Goal' .

Change your goals and confirm.

How do I log my weight?

You can log in your weight the first time you set up your NoiseFit App. However, you can update the weight later via the NoiseFit app. Go to My Profile, select Personal Information and change or update your weight. You can update your birthday, height, country and e-mail ID as well.

DISPOSAL AND RECYCLING INFORMATION

Electrical and electronic devices may not be disposed of with domestic waste. Consumers are obliged by law to return the electrical and electronic devices at the end of their service lives to the public collecting points set up for this purpose or point of sale. Details of this are defined by the national law of this respective country. By recycling, reusing materials or other forms of utilising old devices, you are making an important contribution to protecting our environment.

REGULATORY INFORMATION

USA: Federal Communications Commission (FCC) Statement

This device complies with Part 15 of the FCC rules. Operation is subject the following two conditions:

This device may cause harmful interference, and this device must accept any interference received, including interference that may cause undesired operation. Warning: Changes or modifications not expressly approved by the party responsible for compliance could void the authority to operate this equipment.

Note: This equipment has been tested and found to comply with the limits for a Class B digital device, pursuant to part 15 of the FCC Rules. These limits are designed to provide reasonable protection against harmful interference in a residential installation. This equipment generates, uses and can radiate radio frequency energy and, if not installed and used in accordance with the instructions, may cause harmful interference to radio communications. However, there is no guarantee that interference will not occur in a particular installation.

If this 76 equipment does cause harmful interference to radio or television reception, which can be determined by turning the equipment off and on, the Max is encouraged to try to correct the interference by one or more of the following measures:

- Reorient or relocate the receiving antenna.
- Increase the separation between the equipment and receiver.
- Connect the equipment into an outlet on a circuit different from that to which the receiver is connected.
- Consult the dealer or an experienced radio/TV technician for help.

The ColorFit Ultra 3 Luminary watch is not a toy. The watch contains small components that could be a choking hazard and are not intended for use by small children or pets. Unless otherwise specified, devices and services are not medical devices and are not intended to diagnose, treat, cure or prevent any disease. We develop products and services to track daily activity and wellness information as accurately as possible. The accuracy of devices is not intended to be equivalent to medical devices or scientific measurement devices. In some cases, prolonged use of products may cause skin irritation. Prolonged contact may contribute to skin irritation or allergies. To reduce the possibility of irritation, keep the watch and watch band clean and dry. Don't wear it too tight and give your wrist a rest by removing the watch after an extended period of wear. If you feel soreness, tingling, numbness, burning or stiffness in your hands or wrists while or after wearing the watch, please immediately discontinue use.

INSTRUCTIONS

- Keep the device dry and clean regularly and especially after prolonged use as moisture and dirt can build up underneath the band and can cause skin irritation.
- Do not wear the device too tight but make sure that the bottom sensor is lightly in contact with your skin and there is a gap of about one finger's width between the wrist strap and your wrist.
- Do not use household cleaners to clean the device. Use soap-free cleaners instead.
- For stains that are difficult to remove, it is recommended to scrub with alcohol.
- The device is not suitable for diving, swimming in the sea or sauna; it is suitable for swimming pools, showers (cold water) and swimming in shallows.
- Keep it away from direct sunlight, high temperatures or humid conditions as it may damage the band over time.

CUSTOMER SUPPORT

If you experience any problem with the watch, it may be fixed by restarting your watch. For any assistance, please reach out to us at link:
<https://support.gonoise.com/support/home>

