



# BG-N21

## BATTERY GRIP

Designed for the  
Nikon Z 6 and Z 7  
Mirrorless Cameras

 VELLO®

USER'S MANUAL

# Thank you for choosing Vello

The Vello BG-N21 battery grip offers extended shooting time and comfort when shooting in a vertical (portrait) orientation. The grip is compatible with the Nikon Z 7 and Z 6 mirrorless cameras, and it accepts up to two Nikon EN-EL15a/EN-EL15b rechargeable batteries. You can charge the batteries inside the grip, without removing them, via the included USB-C™ power adapter. The BG-N21 offers an alternate shutter release button that triggers the camera via the included cable, making the grip ideal for shooting portrait photography. And the control-lock switch disables the shutter release button to prevent unwanted exposures.

*Please read through this entire manual  
before using the BG-N21 battery grip.*



# Precautions

1. The BG-N21 should be used only with the compatible devices specified in this manual.
2. Use only with the batteries and battery holders recommended in this manual.
3. If you notice smoke, noise, or an unusual smell from the battery pack, discontinue use immediately. Remove the batteries, and take the device to a Vello authorized reseller.
4. The battery level may not display properly if batteries are installed before mounting the grip.
5. Remove batteries from the grip when not in use.
6. Do not attempt to disassemble.
7. Avoid exposing this product to water or extreme humidity, and keep it in a cool, dry place.
8. Keep out of reach of children.
9. All images are for illustrative purposes only.

# Specifications

Power source	Up to two Nikon EN-EL15a/EN-EL15b type rechargeable Li-ion batteries
USB port	USB-C
USB input	5 V / 2.4 A
Operating temperature	32°F to 104°F (0°C to 40°C)
Dimensions (H × W × D)	1.8 × 5.4 × 2.9 in. (4.6 × 13.6 × 7.3 cm)
Weight	7.3 oz. (208 g) without batteries

# Overview

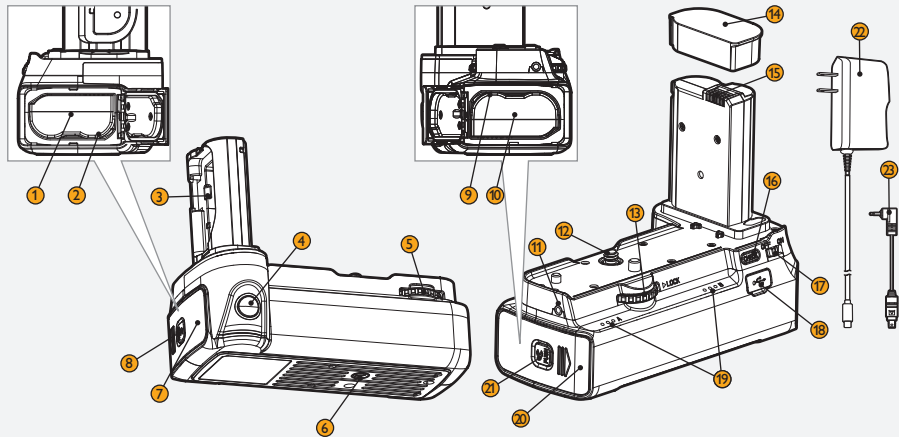

- ① Battery compartment B
- ② Compartment B battery latch
- ③ Camera battery door holder
- ④ Shutter release button
- ⑤ Front thumbwheel
- ⑥ Tripod socket
- ⑦ Battery compartment B door
- ⑧ Battery compartment B door latch

- ⑨ Compartment A battery latch
- ⑩ Battery compartment A
- ⑪ 2.5 mm remote cable socket
- ⑫ Mounting screw
- ⑬ Rear thumbwheel
- ⑭ Contact cover
- ⑮ Power contacts
- ⑯ Battery power check button

- ⑰ Control lock switch
- ⑱ USB-C port
- ⑲ Battery status LEDs
- ⑳ Battery compartment A door
- ㉑ Battery compartment A door latch
- ㉒ USB-C power adapter
- ㉓ Shutter release cable (2.5 mm)

# Attaching the Battery Grip

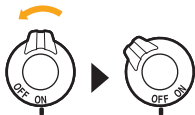

1. Ensure that the camera power is turned off, and the grip's control lock switch is in the Off position.

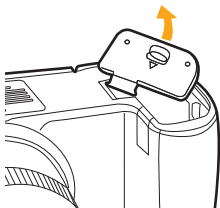

2. Remove the camera's battery chamber door. Pull gently at a 45° angle until the door detaches.

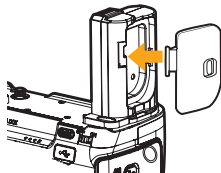

3. Insert the chamber door into the BG-N21's camera battery door holder for safekeeping.

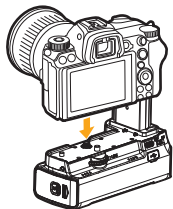

- 4.** Insert the battery grip's power contacts into the camera's battery chamber.

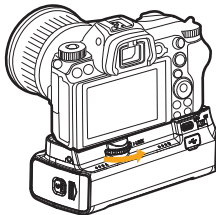

- 5.** Rotate the rear thumbwheel counterclockwise until the grip is secured to the camera.

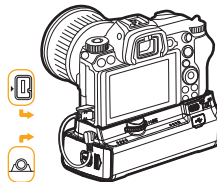

- 6.** Connect the shutter release cable from the 2.5 mm remote cable socket on the grip to the remote port on the camera.

# Inserting the Batteries

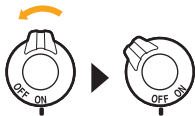

1. Turn off the camera's power, and make sure the grip's control lock switch is in the Off position.

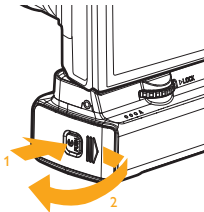

2. Press the door latch of battery compartment A or B, and slide the door to the rear of the grip, following the arrows. Open the compartment door.

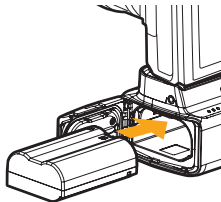

3. Insert the battery until it locks into place.





4. Close the compartment door, and slide it to the front of the grip until it clicks.

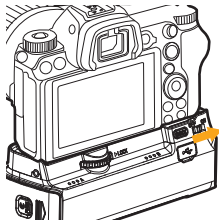

5. Turn on the camera power, and make sure the grip's control lock switch is in the On position.

*Note: When removing the grip, turn off the camera's power and the grip's control lock switch, and then remove the batteries.*

# Removing the Batteries

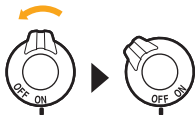

1. Turn off the camera's power, and make sure the grip's control lock switch is in the Off position.

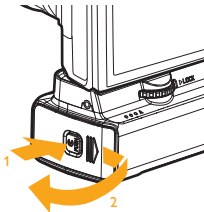



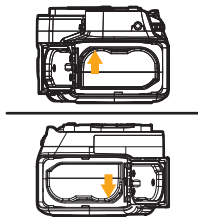

2. Press the door latch of battery compartment A or B, and slide the door to the rear of the grip, following the arrows. Open the compartment door.



3. Press compartment A's battery latch to the left until the battery slightly pops out. Press compartment B's battery latch to the right until the battery slightly pops out.

# Checking the Batteries' Power

Press the CHECK button to check the battery's power. The LEDs will display the status for 3 seconds.

	Full
	Medium
	Low
	Battery needs to recharge.

## In-Grip Battery Charging

You can charge the batteries inside the grip, without removing them, using the included 5 V / 2.4 A power adapter. Make sure you turn off the camera to begin charging. Then use the included power adapter to connect the battery grip's USB-C port to an AC outlet.

The LEDs will glow red when charging, and turn off when fully charged. If there are two batteries in the grip, the one with more power will charge first.

# ONE-YEAR LIMITED WARRANTY

This VELLO product is warranted to the original purchaser to be free from defects in materials and workmanship under normal consumer use for a period of one (1) year from the original purchase date or thirty (30) days after replacement, whichever occurs later. The warranty provider's responsibility with respect to this limited warranty shall be limited solely to repair or replacement, at the provider's discretion, of any product that fails during normal use of this product in its intended manner and in its intended environment. Inoperability of the product or part(s) shall be determined by the warranty provider. If the product has been discontinued, the warranty provider reserves the right to replace it with a model of equivalent quality and function.

This warranty does not cover damage or defect caused by misuse, neglect, accident, alteration, abuse, improper installation or maintenance. EXCEPT AS PROVIDED HEREIN, THE WARRANTY PROVIDER MAKES NEITHER ANY EXPRESS WARRANTIES NOR ANY IMPLIED WARRANTIES, INCLUDING BUT NOT LIMITED TO ANY IMPLIED WARRANTY OF MERCHANTABILITY OR FITNESS FOR A PARTICULAR PURPOSE. This warranty provides you with specific legal rights, and you may also have additional rights that vary from state to state.

To obtain warranty coverage, contact the Vello Customer Service Department to obtain a return merchandise authorization ("RMA") number, and return the defective product to Vello along with the RMA number and proof of purchase. Shipment of the defective product is at the purchaser's own risk and expense.

For more information or to arrange service, visit [www.vellogear.com](http://www.vellogear.com) or call Customer Service at 212-594-2353.

Product warranty provided by the Gradus Group.

[www.gradusgroup.com](http://www.gradusgroup.com)

VELLO is a registered trademark of the Gradus Group. © 2020 Gradus Group LLC. All Rights Reserved.



[www.vellogear.com](http://www.vellogear.com)

All other trademarks are the property of their respective owners.

GG1