

Smart Plug

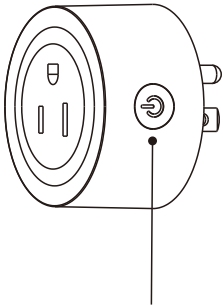

ON / OFF

- **APP Remote Control**
You can control the switch at anywhere and time,as long as your smartphone has network.
- **Voice Control**
Simply give a voice command to Alexa or Google Home to turn on/off switch when your hands are full.
- **Timing/Countdown/Schedule**
- **For details, see “WIFI SMART SOCKCT user manual”**

How to operate

Touch Panel

UP

DOWN

ON / OFF

• Single press to increase brightness (10 levels)

• Long press and hold to maximize brightness (100% brightness)

• Single press to decrease brightness (10 levels)

• Long press and hold to minimum brightness (1% brightness)

• Single press to turn on/off

• Long press to enter the night light when the light is off

• When the light is on:
Double click to enter the 1-minute countdown
Long press to enter the 45-minute countdown

Switch indicator
Press "▲" or "▼" indicator light off/on When light off

CHIPHY Athena

LED Smart Tray floor lamp

Model	F1004
Item No.	RF04-001
Dimensions	D11.8*H69.3 inch
Material	Aluminum / Steel / PC
Power	40W
Volt	100-240V
Frequency	50/60Hz
Luminous flux	3000lm
CCT	4000K
CRI	Ra≥95
Lifespan	50000h

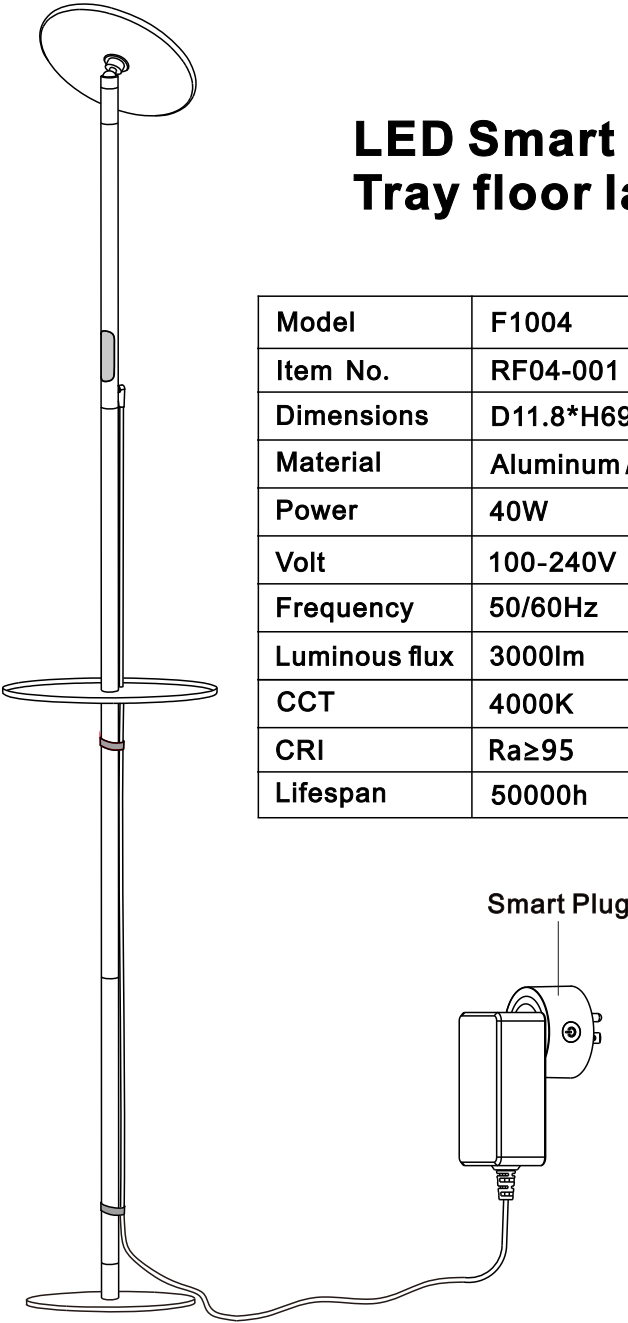

Parts identification guide

A*1



B*1



C*1



D*1

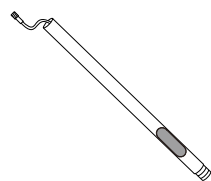

E*1

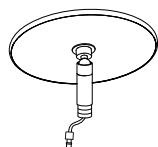

F*1

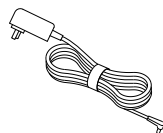

I*1



G*1

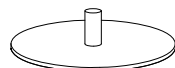

H*1

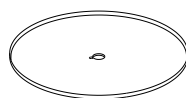

Installation options

Height

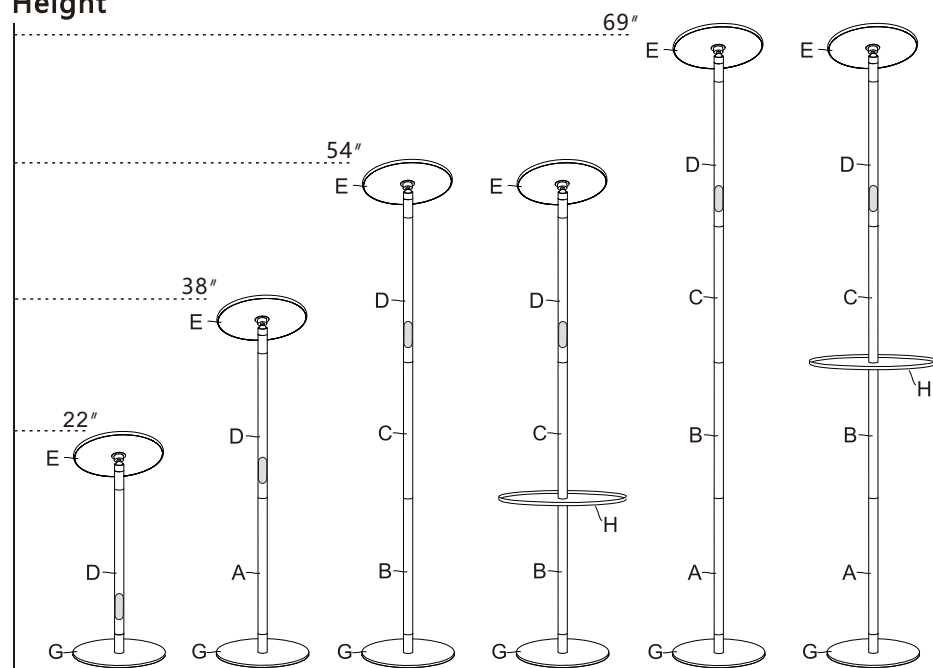

Exploded view

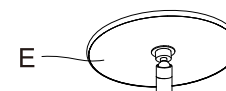

Warning: No turning

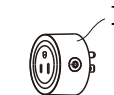
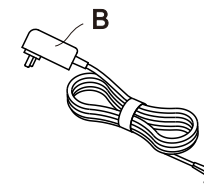
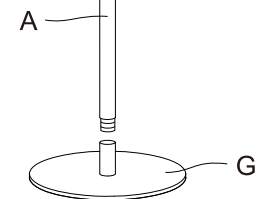
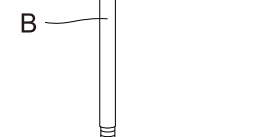
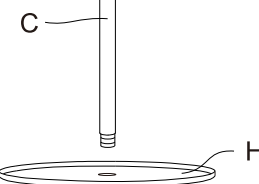
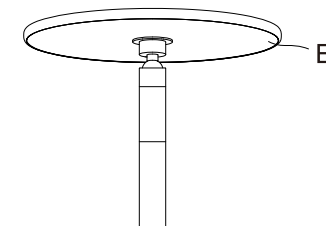
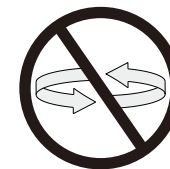

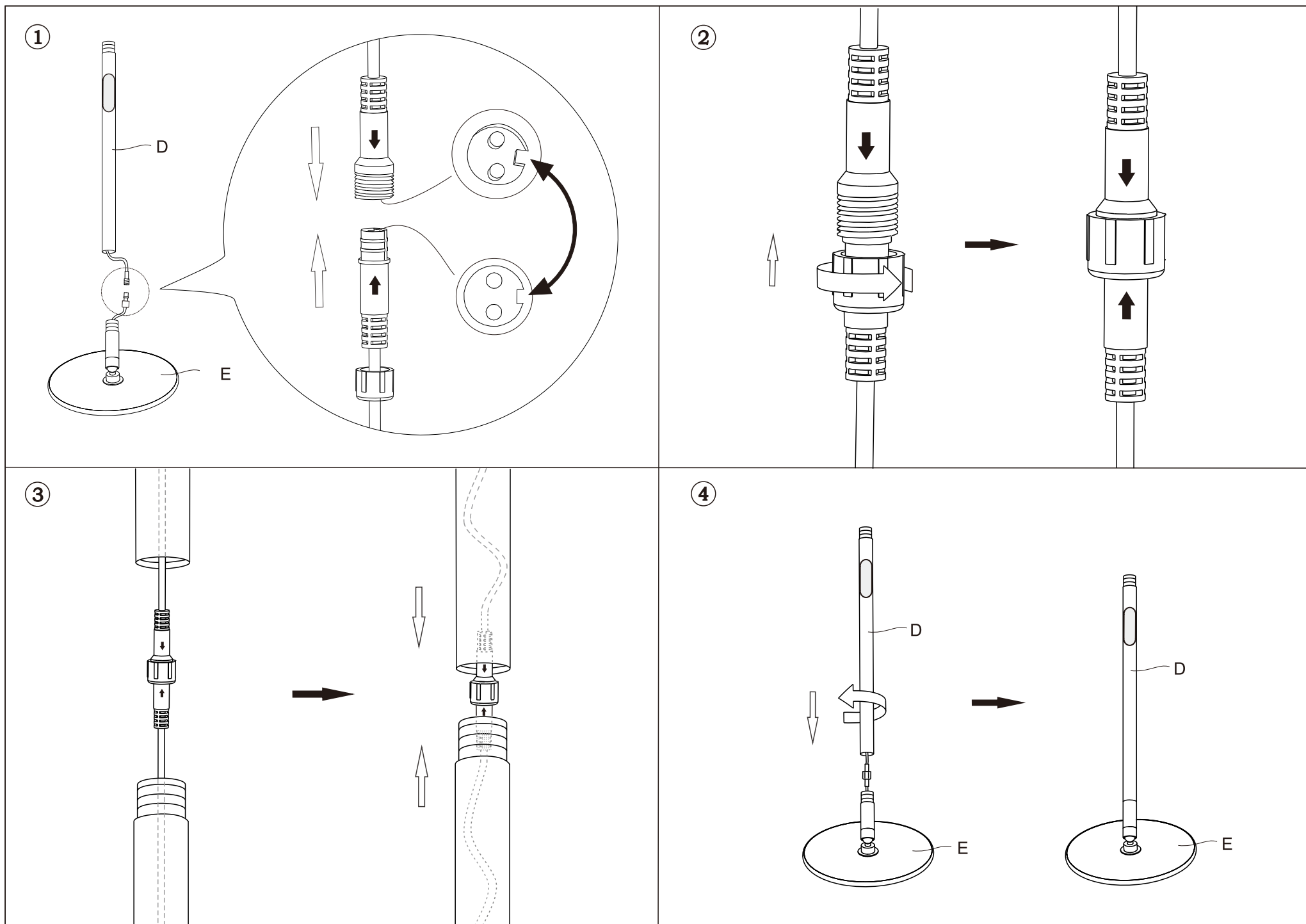

⑤

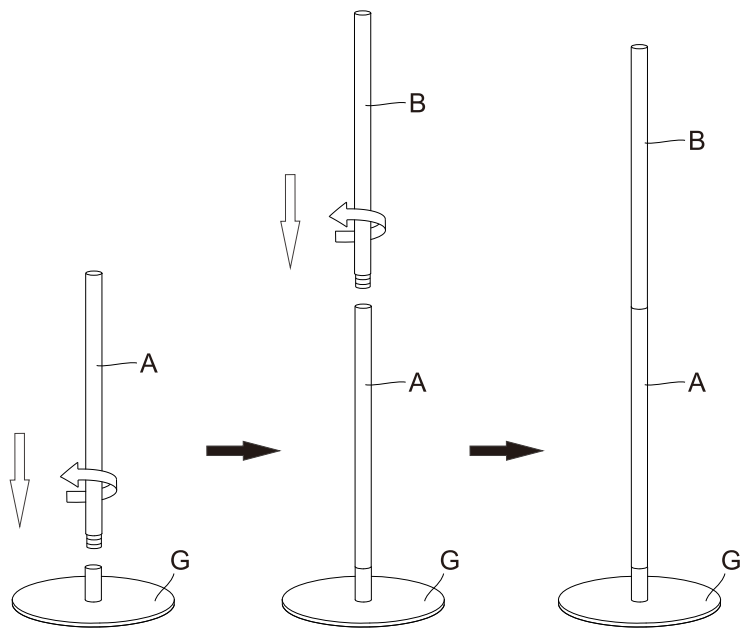

⑥

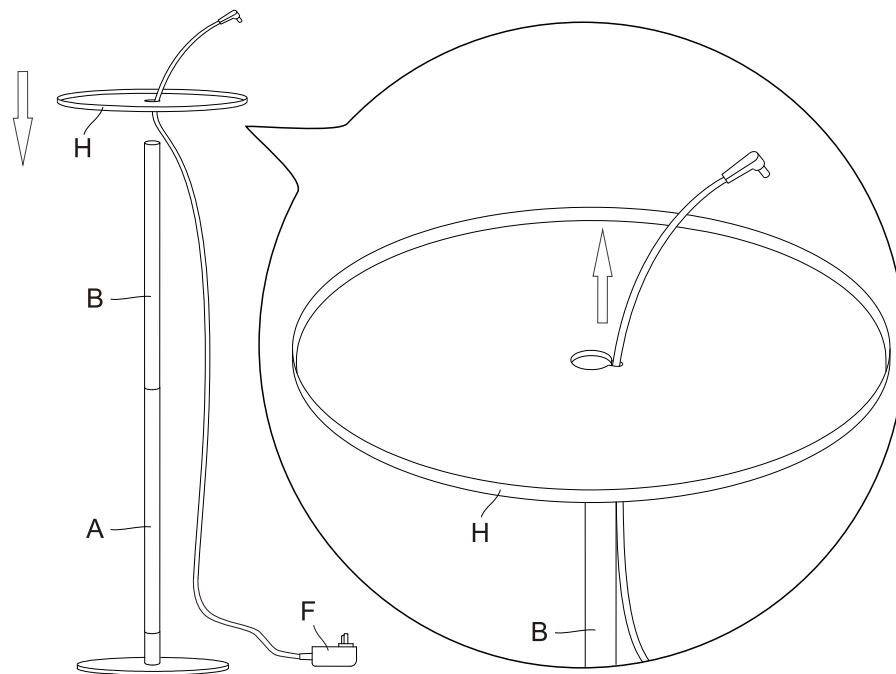

⑦

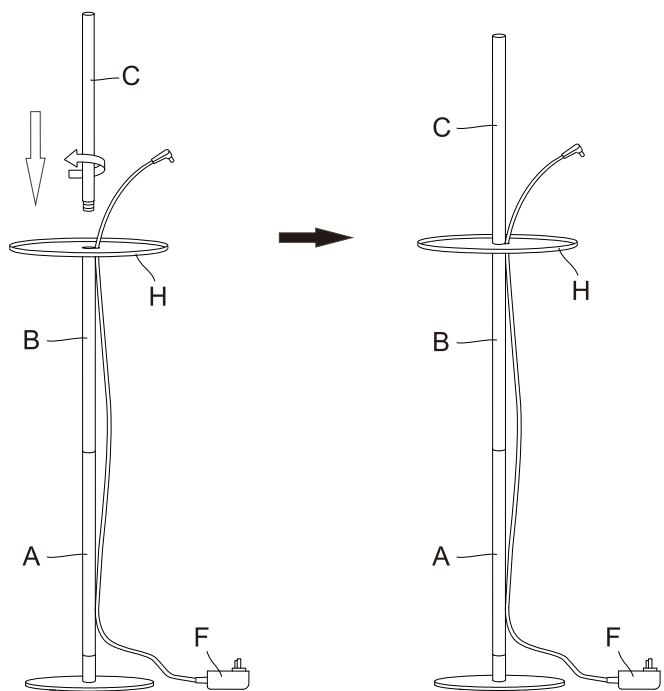

⑧

