

NINJA®

BL450 Series

INSTRUCTIONS



THANK YOU FOR PURCHASING
The Nutri Ninja® Pro



REGISTER YOUR PURCHASE

- ninjakitchen.co.uk/register-guarantee/
Scan QR code using mobile device

RECORD THIS INFORMATION

Model Number:
Serial Number:
Date of Purchase:
(Keep receipt)
Store of Purchase:

TECHNICAL SPECIFICATIONS

Voltage: 220-240V~, 50-60Hz
Power: 900 Watts

TIP: You can find the model and serial numbers on the QR code label located on the back of the unit by the power cord.

CONTENTS

Product Registration. 3
Important Safeguards. 4
Getting to Know Your Nutri Ninja® Pro 6
Before First Use 6
Use 7
Suggested Uses 8
Care & Maintenance. 9
Troubleshooting Guide. 10
Replacement Parts 10

PRODUCT REGISTRATION:
Please visit ninjakitchen.co.uk/register-guarantee or call 0800 862 0453 to register your new Ninja® product within 28 days of purchase. You will be asked to provide the store name, date of purchase, and model number along with your name and address. The registration will enable us to contact you in the unlikely event of a product safety notification.

IMPORTANT SAFEGUARDS

HOUSEHOLD USE ONLY • READ ALL INSTRUCTIONS BEFORE USE

When using electrical appliances, basic safety precautions should always be followed, including the following:

WARNING

To reduce the risk of fire, electric shock, serious injury, death, or damage when using this appliance, follow these basic safety precautions.

- 1 Read all instructions prior to using the appliance and its accessories.
- 2 Carefully observe and follow all warnings and instructions. This unit contains electrical connections and moving parts that potentially present risk to the user.
- 3 **ALWAYS** exercise care when handling the Pro Extractor Blades® Assembly. The blades are sharp. **ONLY** grasp the Pro Extractor Blades Assembly by the outer perimeter of the blade assembly base. Failure to use care when handling the blade assembly will result in a risk of laceration.
- 4 Take your time and exercise care during unpacking and appliance setup. This appliance contains sharp, loose blades that can cause injury if mishandled.
- 5 Take an inventory of all contents to ensure you have all parts needed to properly and safely operate your appliance.
- 6 Turn the appliance **OFF**, then unplug the appliance from the socket when not in use, before assembling or disassembling parts, and before cleaning. To unplug, grasp the plug by the body and pull from the socket. **NEVER** unplug by grasping and pulling the flexible cord.
- 7 Before use, wash all parts that may contact food. Follow washing instructions covered in this instruction manual.
- 8 To protect against the risk of electric shock, **DO NOT** submerge the appliance or allow the power cord to contact any form of liquid.
- 9 **DO NOT** use this appliance outdoors. It is designed for indoor household use only.
- 10 **DO NOT** operate any appliance with a damaged cord or plug, or after the appliance malfunctions or is dropped or damaged in any manner. This appliance has no user-serviceable parts. If damaged, contact SharkNinja for servicing.
- 11 **DO NOT** abuse the power cord. Never carry the appliance by the power cord or yank it to disconnect from electrical socket; instead grasp the plug and pull to disconnect.
- 12 Extension cords should **NOT** be used with this appliance.
- 13 Appliances can be used by persons with reduced physical, sensory or mental capabilities or lack of experience and knowledge if they have been given supervision or instruction concerning use of the appliance in a safe way and if they understand the hazards involved. Children should not play with the appliance. This appliance should not be used by children. Keep the appliance and its cord out of reach of children.
- 14 Before each use, inspect blade assemblies for damage. If a blade is bent or damage is suspected, contact SharkNinja to arrange for replacement.
- 15 **DO NOT** attempt to sharpen blades.
- 16 **DO NOT** allow the unit or the cord to hang over the edges of tables or worktops. The cord may become snagged and pull the appliance off the work surface.
- 17 **DO NOT** allow any part of the unit to contact hot surfaces, including stoves and other heating appliances.
- 18 **ALWAYS** use the appliance on a dry and level surface.
- 19 **NEVER** place a blade assembly on the motor base without it first being attached to its corresponding container (bowl, jug, cup) and lid.
- 20 Blades are sharp. Handle carefully.
- 21 **ONLY** use attachments and accessories that are provided with the product or are recommended by SharkNinja. The use of attachments not recommended or sold by SharkNinja may cause fire,

SAVE THESE INSTRUCTIONS

electric shock, or injury.

- 22 The use of attachments, including canning jars, not recommended by the manufacturer may cause a risk of injury to persons
- 23 **DO NOT** process dry ingredients without adding liquid to the cup. This product is not intended for dry blending
- 24 **DO NOT** use stainless steel cup accessory model XSKDWSS24 with blender.
- 25 During operation and handling of the appliance, avoid contact with moving parts.
- 26 **DO NOT** operate the appliance with an empty container.
- 27 **DO NOT** fill containers past the MAX FILL or MAX LIQUID lines.
- 28 **DO NOT** microwave any containers or accessories provided with the appliance.
- 29 **DO NOT** perform grinding operations with the Single-Serve Blending Cup and Pro Extractor Blades® Assembly.
- 30 Before operation, ensure all utensils are removed from containers. Failure to remove utensils can cause containers to shatter and potentially result in personal injury and property damage.
- 31 Keep hands, hair, clothing, as well as utensils out of container while processing to reduce the risk of severe injury to persons or damage to the appliance. A scraper may be used but only when the appliance is not running.
- 32 **NEVER** operate the appliance without lids and caps in place. **DO NOT** attempt to defeat the interlock mechanism. Ensure the container and lid are properly installed before operation.
- 33 **DO NOT** expose the containers and accessories to extreme temperature changes. They may experience damage.
- 34 **NEVER** leave the appliance unattended while in use.
- 35 **DO NOT** blend hot liquids. Doing so may result in pressure buildup and steam exposure that can pose a risk of the user being burned.
- 36 **DO NOT** remove the cup from the motor base while the appliance is running.
- 37 If the appliance overheats, a thermal switch will activate and temporarily disable the motor. To reset, unplug the appliance and allow it to cool for approximately 30 minutes before using again.
- 38 Remove the Pro Extractor Blades™ Assembly from the Nutri Ninja cup upon completion of blending. Do not store ingredients before or after blending them in the cup with the blade assembly attached. Some foods may contain active ingredients or release gases which will expand if left in a sealed container, resulting in excessive pressure buildup that can pose a risk of injury. For ingredient storage in the cup, use only spout lid to cover.
- 39 The maximum wattage rating for this appliance is based on the configuration of the Pro Extractor Blades Assembly and Single-Serve Blending Cup. Other configurations may draw less power or current.
- 40 Max ON time is 1 minute under 900W load. If the appliance overheats, a thermal switch will become activated and shut off the motor. To reset, unplug the appliance and let it cool down for approximately 30 minutes before using again.
- 41 **DO NOT** process dry ingredients without adding liquid to the Single Serve Blending Cup. The Single Serve Blending Cup is not intended for dry blending.
- 42 **DO NOT** spray the motor base with any liquids. Turn off and unplug the motor base before cleaning.
- 43 Do not misuse the appliance to avoid potential injury.

SAVE THESE INSTRUCTIONS

GETTING TO KNOW YOUR NUTRI NINJA® PRO

MAIN UNIT

- A** Pro Extractor Blades® Assembly
- B** Spout Lid (x2)
- C** 500ml. Nutri Ninja® Cup
- D** 600ml. Nutri Ninja® Cup
- E** 900ml Nutri Ninja® Cup
- F** Motor Base (power cord not shown)

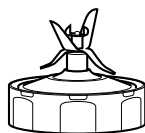

A



B

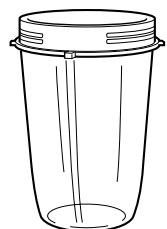

C

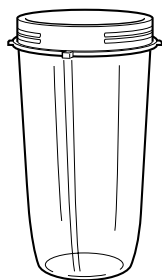

D

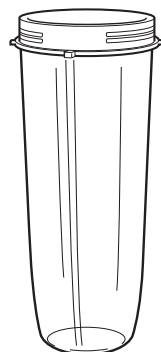

E

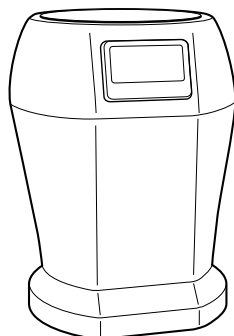

F

BEFORE FIRST USE

- 1** Remove all packaging material and labels from the appliance. Separate all parts from each other.
- 2** Wash the lids, Nutri Ninja Cups and Pro Extractor Blades® Assembly in warm, soapy water. When washing the Pro Extractor Blades Assembly, use a dishwashing utensil with a handle to avoid direct hand contact with blades.
- 3** Handle blade assemblies with care to avoid contact with sharp edges. Rinse and air-dry thoroughly.
- 4** The lids, Nutri Ninja Cups, and Pro Extractor Blades Assembly are all dishwasher safe. It is recommended that the lids and Pro Extractor Blades Assembly be placed on the top rack. Ensure that the Pro Extractor Blades Assembly is removed from the cup before placing in the dishwasher.
- 5** Wipe the motor base clean with a damp cloth.

USE

IMPORTANT: Review all warnings on pages 4-5 before proceeding.

TIPS:

- For best results, use short “PULSES”.

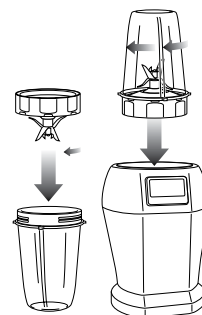

ASSEMBLY

- 1** Place the motor base on a clean, dry, level surface such as a worktop or table top. Add ingredients to the Nutri Ninja® Cup. Place the Pro Extractor Blades Assembly onto the cup and twist it on tightly until you have a good seal.
- NOTE:** Do not overfill! To avoid spilling, do not add ingredients past the “MAX” fill line.
- 2** Turn the cup upside down and place it onto the motor base, aligning the tabs on the cup with the motor base. Turn it clockwise, the unit is ready for use.

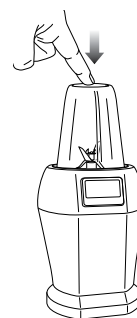

PULSE

- 3** Press down on the top of the cup in short intervals to activate.

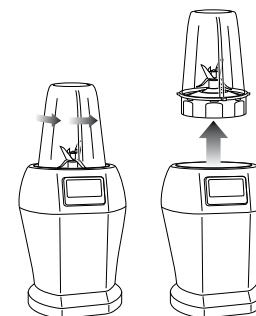

REMOVAL

- 4** When ingredients have reached the desired consistency, stop the appliance by removing your hand from the cup. Wait for the motor to stop running. Then turn the cup anti-clockwise and pull straight up to remove.

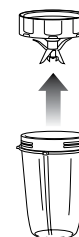

- 5** Turn the cup upright and remove the Pro Extractor Blades Assembly by twisting the Pro Extractor Blades Assembly anti-clockwise.
- 6** Do not store blended contents with the Pro Extractor Blade Assembly attached.
- 7** Place the spout lid onto the cup, twist to seal and enjoy!
- 8** For storage, only use spout lid to cover.
- 9** Be sure to store the Pro Extractor Blades Assembly attached to an empty cup when not in use.
- 10** Make sure that the motor base is unplugged when not in use.

SUGGESTED USES

PURPOSE	SUGGESTED CUP	TYPE OF FOOD
Chopping/Pulsing	500ml Nutri Ninja® Cup 650ml Nutri Ninja® Cup 900ml Nutri Ninja® Cup	Salsa Leafy Herbs Nuts Chocolate
Grating	500ml Nutri Ninja® Cup 650ml Nutri Ninja® Cup 900ml Nutri Ninja® Cup	Cheese Breadcrumbs
Mixing	500ml Nutri Ninja® Cup 650ml Nutri Ninja® Cup 900ml Nutri Ninja® Cup	Batters Dips
Sauces*	500ml Nutri Ninja® Cup 650ml Nutri Ninja® Cup 900ml Nutri Ninja® Cup	Vinaigrettes Salad Dressings Simple Sauces*
Frozen Blending	500ml Nutri Ninja® Cup 650ml Nutri Ninja® Cup 900ml Nutri Ninja® Cup	Ice Frozen Fruit Ice Cream
Nutrient Juices/Smoothies	500ml Nutri Ninja® Cup 650ml Nutri Ninja® Cup 900ml Nutri Ninja® Cup	Fruits Vegetables Leafy Greens

* When blending sauces, make sure they're cooled to room temperature first.
Ninja® containers are not intended for hot blending.

⚠ CAUTION: DO NOT process dry ingredients without adding liquid to the cup.
This product is not intended for dry blending.

FILLING YOUR NUTRI NINJA® CUP

For best results, always follow recipe directions when filling your Nutri Ninja cups. When you're not using a recipe, use the following guidelines:

Start with your fresh fruit or veggies. Then add any nuts, seeds or powder followed by any liquids like juice or milk. More liquid can help to integrate powder. Then add your frozen fruit and ice. Remember to securely tighten the blade and don't overfill the cups.

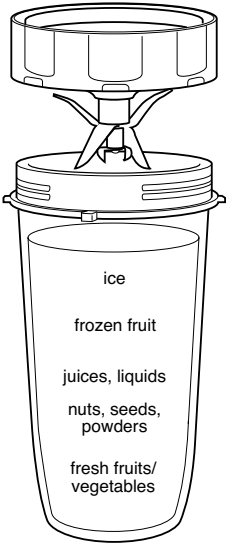

CARE & MAINTENANCE

CLEANING

- 1 Separate all parts from each other.
- 2 **Hand-Washing**
Wash the lids, Nutri Ninja® Cups and Pro Extractor Blades® Assembly in warm, soapy water. When washing the Pro Extractor Blades Assembly, use a dish-washing utensil with a handle to avoid direct hand contact with blades. Handle Pro Extractor Blades Assembly with care to avoid contact with sharp edges. Rinse and air-dry thoroughly.

Dishwasher

Containers, lids, and Pro Extractor Blades Assembly are all top-rack dishwasher safe. Ensure the Pro Extractor Blades Assembly is removed from the cup before placing in the dishwasher.

- 3 Wipe the motor base clean with a damp cloth

STORING

Store the Nutri Ninja Pro upright with the blade assembly attached to the Nutri Ninja Cup. Do not place anything on top. Store the rest of the attachments in a safe place where they will not be damaged and won't cause harm. Loosely wrap the power cord around the cord wrap.

NOTE: Do not store blended or unblended ingredients in the Nutri Ninja Cup with the blade assembly attached.

RESETTING THE MOTOR THERMOSTAT

The Nutri Ninja Pro features a safety system which prevents damage to the unit's motor and drive system should you inadvertently overload your appliance. If the appliance is being overloaded, the motor will stop. To reset the appliance, follow the resetting procedure below:

- 1 Unplug the appliance from the electrical socket.
- 2 Remove and empty the cup and ensure that no food is jamming the Pro Extractor Blades Assembly.
- 3 Allow the appliance to cool for approximately 30 minutes.
- 4 Re-install the cup onto the base and re-plug the appliance into the electrical socket.
- 5 Proceed to use the appliance as before while making sure not to exceed the recommended maximum capacities.

TROUBLESHOOTING GUIDE

WARNING: To reduce the risk of shock and unintended operation, turn power off and unplug unit before troubleshooting.

Motor doesn't start or Pro Extractor Blades Assembly doesn't rotate.

- For the cups, make sure that the tabs are seated in the slots and turned clockwise.

Food is unevenly chopped.

- Either you are chopping too much food at once, or you are not pulsing properly.
- Reduce the amount of food in the cup.

Food is too finely chopped or too watery.

- The food has been over processed. Use short pulses for best results. Press down on the cup in short intervals.

Cup is leaking.

- Make sure the lid or blade assembly is properly assembled on the cup. Leaking may occur if it is misaligned when twisted onto the cup. Turn the lid tightly clockwise.

Unit doesn't turn on.

- Make sure the unit is plugged in.
- Rotate and press down on the cup to turn the unit on.
- Make sure the Pro Extractor Blades Assembly is properly assembled on the cup and is not misaligned.

Unit doesn't turn off.

- Unplug the power cord from the electrical socket and call customer service for support.

Doesn't mix well.

- Pulse ingredients for best results. Press down on the cup in short intervals for even blending and chopping. For frozen ingredients, pulse in short intervals of 2 to 5 seconds and repeat.

Lid/blade assembly will not properly align to the cup.

- Set the cup on a level surface. Place the lid or Pro Extractor Blades Assembly on top of the cup and align the threads so that the lid/blades sit flat on the cup. Twist clockwise so that the lid/blades evenly align to the cup until you have a tight seal.

REPLACEMENT PARTS

To order additional parts and accessories, visit **ninjakitchen.co.uk**.

NOTES

[illegible]

VISIT US ONLINE AT:

ninjakitchen.co.uk

Or follow us on any of our social media pages:



@ninjakitchenuk



NOTE: Save these instructions. Keep for future reference.



This marking indicates this product should not be disposed of with other household waste. To prevent possible harm to the environment or human health from uncontrolled waste disposal, recycle it responsibly to promote the sustainable reuse of material sources. To return your used device, please use the return and collection systems or contact the retailer where this product was purchased. They can take this product for environmentally safe recycling.

**SharkNinja Europe Limited,
3150 Century Way,
Thorpe Park,
Leeds,
LS15 8ZB, UK
0800 862 0453
ninjakitchen.co.uk**

**SharkNinja Germany GmbH, c/o Regus Management GmbH,
Excellent Business Center 10.+11. Stock,
Westhafenplatz 1 60327 Frankfurt am Main, Germany**

Illustrations may differ from actual product. We are constantly striving to improve our products; therefore the specifications contained herein are subject to change without notice.

NINJA, NUTRI NINJA, and PRO EXTRACTOR BLADES are registered trademarks of SharkNinja Operating LLC.

© 2021 SharkNinja Operating LLC

BL450Series_IB_Mv1_211124
PRINTED IN CHINA

