

TESLONG

Inspection Camera User Manual

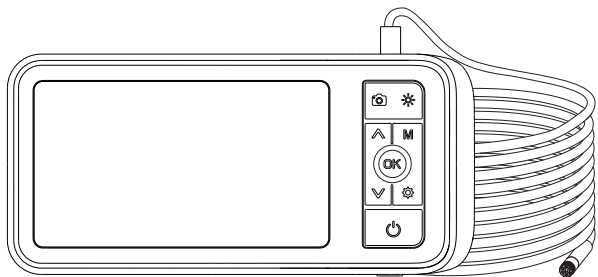

Model No.: MS450-NTC

Product Manual

MS450-NTC is a high performance industrial endoscope with a 4.5-inch high definition color screen. It is ergonomically designed so that users can control the main buttons with just 1 hand. The snapshot and recording functions are supported: photos and videos can be saved on TF memory card (Micro-SD card). This product is equipped with an LED-assisted illumination and small-diameter HD camera. The camera uses a high-sensitivity chip to help this product perform in the dark.

The camera probe is interchangeable, it can connect to different probes with different sizes, dimensions, angles, or focal lengths.

Warning: This product is an industrial endoscope camera and is not intended for medical use or human examination.

Safety and Maintenance

- DO NOT violently hit the camera probe, DO Not imprudently pull the cable. When used in the environment with sharp objects, be extra careful to prevent the probe's waterproof protective layer from being scratched during usage.
- The camera probe materials are not resistant to high temperature. When checking the vehicle engine, please ensure that temperature inside the engine is at the normal temperature.
- This product is not suitable for people with limited physical, sensory or mental capabilities.
- DO NOT allow children to touch or operate this device.
- In case the device is damaged, DO NOT disassemble it by yourself. Please contact the seller or the agent where you bought it to get repair service.

Battery Description

- Please use 5V household charger that meets safety regulations to charge this device.
- If you do not use the device for a long time, please ensure that it is charged at least once every 3 months to prevent irreparable damage caused by excessive battery discharge.

— 01 —

Functions

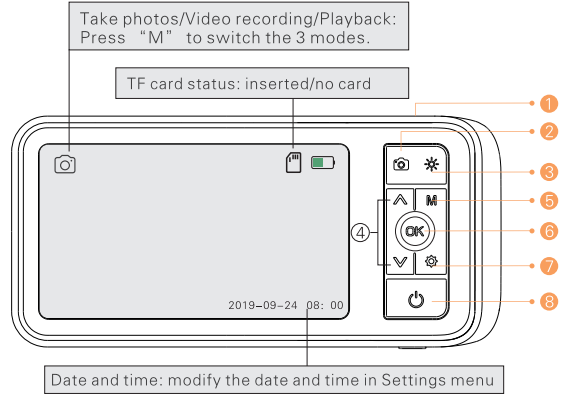

- Camera probe connector.
- Snap: Take photos/start or end video recording.
- Light control: To adjust the the LEDs brightness of the camera.
- Down: 1.5X Zoom
Up: Image rotate 180°
- Mode: Take Photos, video recording & playback.
- Enter: Confirm selection/freeze screen.
- Settings: Enter or exit settings menu.
- Power: Press and hold for a few seconds to turn ON/OFF .

— 02 —

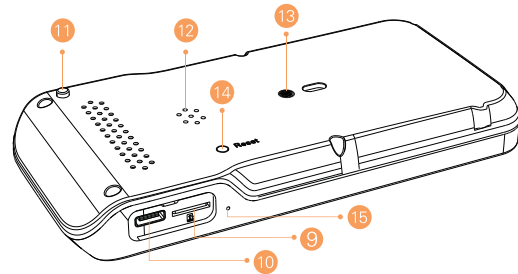

- TF card slot
- Charging port
- Camera probe lock (Press this button to unlock and pull out the camera probe)
- Speaker
- Installation hole of Screen bracket
- Reset
- Microphone

Take Photos

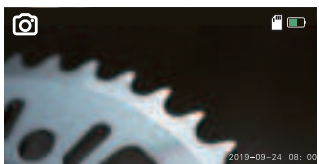

Press [M] to switch to the take photos , and press [9] to take a photo.

Video Recording

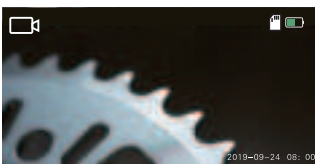

Press [M] to switch to video recording mode, press [9] to start recording.

— 03 —

Instructions

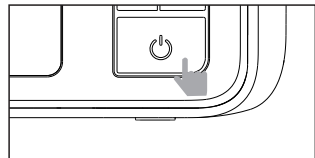

Press & hold the Power button for a few second to turn ON/OFF device.

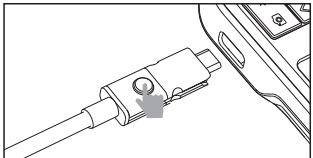

Notice: Press this button to switch the front and side lenses. When connecting a dual lens camera probe.

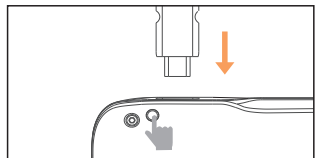

Press this button then pull out the Type-C plug of the probe from the monitor.

Note: Connect camera probe then turning on device. Restart device if replacing camera probe.

How to insert TF card:

- Power off device first before insert TF card.
- Make sure the direction and the front and back sides is correct when insert the TF card.
- Do not use excessive pressure when inserting or removing the TF card to prevent damages of card slot structure.
- You can only take photos or recording videos when a TF card is inserted in the device.

— 04 —

Language Settings

The default language is English, and the system supports English, Chinese, German,French, Spanish, Italian, Russian, and Japanese.

Setting path:

Press the [9] button twice to enter setting page.
Select second item (Language).
Press up and down to select the language you need.
Press [9] to save your choice.

Copy photo and video files to computer

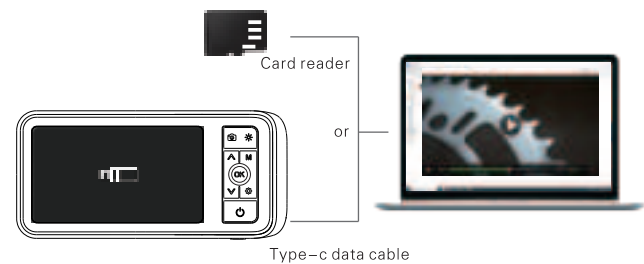

You can use a TF card reader to copy data directly or use a type-C cable to connect to a computer for copying.

— 05 —

Specification Parameters

Screen

Screen: 4.5-inch HD Display
Screen resolution(Pixels): 854x480
Support probe resolution(Pixels): 1.0 Megapixel HD
Image Capturing resolution(Pixels): 1920x1080
Video Recording resolution(Pixels): 1280x720
Port: Type-C charging port, TF memory card slot

Camera

Diameter: 5.5mm or optional
Probe Length: optional
Resolution: 1.0 Megapixel HD
Viewing angle: 70°
Depth of Field: 30mm—100mm
Light Source: 6 adjustable high-intensity LEDs

Others

Operating Temperature: 32°F to 113°F (0°C to 45°C)
Power Source: 2500mAh Lithium Battery
Working Time: 3-4 hours
Charging Time:3-4 hours

Packaging

Monitor, camera probe, Type-C charging cable, user manual, screen bracket
Accessories-pick up hook, magnet, mirror
(Note: 3.9mm NO accessories)

— 06 —



Customer Service

Please contact us if you have any product quality problems, we would love to hear from you.

Manufacturer Service

support@teslong.com | info@teslong.com

1-877-899-8809 (US)
(Mon-Fri 8:00 AM-5:00 PM PST)

FC CE RoHS
© TESLONG MS450-NTC 202109 V3
3.06.02.000216