



# **34" CURVED ULTRAWIDE FREESYNC GAMING MONITOR**

**(3440 X 1440, WQHD 165HZ)**

KAMN34F14QUVA

# SAFETY & WARNINGS

Ensure to read all instructions and warnings in this user guide prior to first use. Retain this user guide for future reference.

- This monitor is designed with ventilation holes on the back of the casing. Do not cover or block them.
- Avoid placing the monitor near heaters, stoves, fireplaces or other heat sources.
- Do not place this monitor in rooms lacking adequate ventilation.
- Do not insert any objects or spray any liquids into the vents.
- Do not position the monitor in unsafe locations. If the monitor falls, it may be damaged and cause injury to people within its vicinity.
- Do not place heavy objects on the monitor, its power cord or any connected cables.
- Do not open the back panel of the monitor as it contains a high-voltage current even when not plugged in.
- Unplug the monitor if it will not be used for an extended period.
- Ensure the monitor is unplugged before cleaning.



The terms HDMI and HDMI High-Definition Multimedia Interface the HDMI Logo are trademarks or registered trademarks of HDMI Licensing Administrator, Inc. in the United States and other countries.

# COMPONENTS



Monitor



Power cord

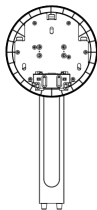

Stand stem



DP cable



Stand base



## User guide

Check if all items are included in your monitor set, if there are missing items; contact [help.Kogan.com](https://www.help.kogan.com) for support.

# OVERVIEW

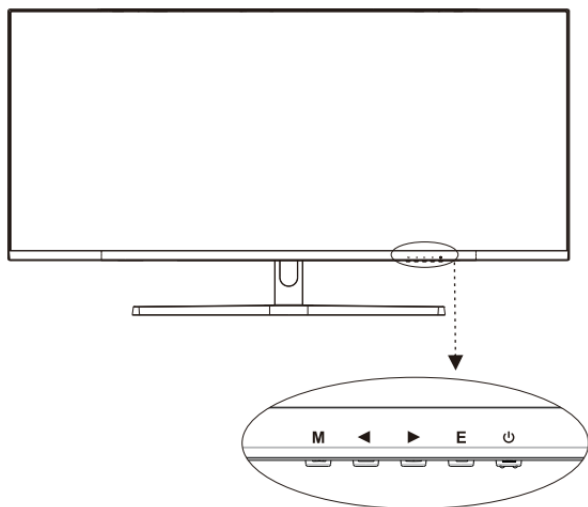

Standby Power Off/On



E-Exit/Input Menu



Up/Brightness



Down/Volume



M-Menu/Select

## Button Function

1. Press menu key display OSD and select.
2. Press E key display source (HDMI/DP optional).
3. Press down key volume; Press up key brightness.

# ASSEMBLY

1. Gently lay the monitor on the cloth with the screen facing down.
2. Align the stand base with the stand stem, then clip the stand base into the stand stem.
3. Attach the assembled stand to the rear of the monitor.

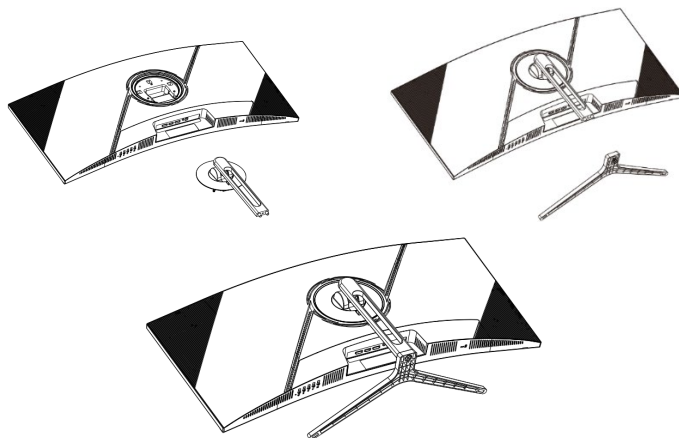

## Adjusting the angle of the monitor

1. The screen can be tilted forwards up to  $5^{\circ}$  or backwards up to  $15^{\circ}$ .
2. To adjust the angle, hold the edges of the screen with both hands and tilt.

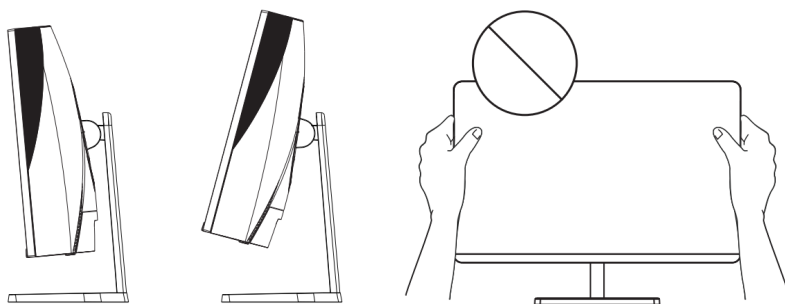

**Note:** Do not directly touch the screen when tilting.

# VESA MOUNT

If mounting to a wall, ensure the stand base and stand stem are disconnected from the monitor.

1. With the display side facing down, lay the monitor on a soft cloth to prevent damage.
2. Identify the four wall mounting screws on the back of the monitor.
3. Mount the monitor as desired with the steps provided with your VESA mount.

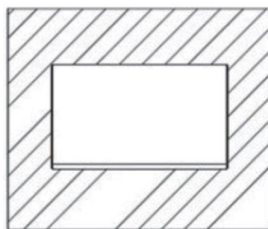
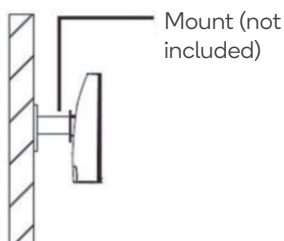

## Notes:

- Ensure there is at least a 10cm clearance away from all sides of the monitor.
- The mounting hole distance for this monitor is 75mm x 75mm.
- VESA mount and mounting accessories are not included.
- Images are for reference only.

# OPERATION

1. Connect the monitor to your computer via HDMI/DP.
2. Connect one end of the power cable into the power port of the monitor. Connect the other end into an outlet, then turn the outlet on.

**Note:**

It is recommended that a surge protector with adequate voltage is used if the monitor cannot be directly connected to an outlet.

3. Press the power button to turn the monitor on.

## On-Screen display (OSD) menu

The OSD menu allows adjustments to various settings for the monitor.

1. Press the menu/select button to access the OSD menu.
2. Press the up and down buttons to browse through the categories of settings. Press the menu/select button to enter the sub-menu.
3. Press the up and down buttons to browse through the sub-menu. Press the menu/select button to enter the adjustment settings of the desired setting.
4. Press the up and down buttons to adjust the desired setting. Press the menu/select button to confirm the adjustment.
5. Press the exit/input menu button to exit the OSD menu.

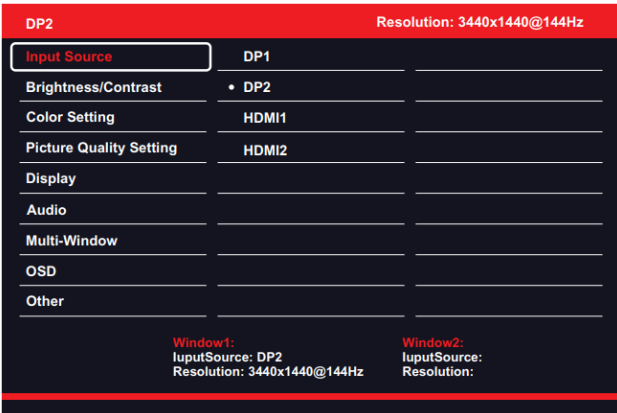

### OSD menu settings

Below is a list of the settings available that can be adjusted through the OSD menu.

Main Menu	Sub-Menu	Options	Description
Input Source	DP1		Select the input signal source
	DP2		
	HDMI1		
	HDMI2		
Brightness/ Contrast	Brightness	0-100	Adjust display brightness
	Contrast	0-100	Adjust display Contrast
	DCR	Off/On	Turn DCR function off/on
Colour Setting	Gamma	Off/1.8/2.0/2.2/2.4	Off/1.8/2.0/2.2/2.4
	Picture Mode	Standard/Game Movie/Reading/ RTS/FPS	Select the Picture Mode
	Colour Temp	Normal/Warm/Cool	Setting colour temperature
		User	Red/Green/Blue
	Hue	0-100	Adjust display hue
	Saturation	0-100	Adjust display saturation
	Low Blue Light	Off/Weak/ Medium/Strong	Adjust display low Blue
Picture Quality Setting	Sharpness	0-100	Adjust display sharpness
	Response Time	Off/Weak/ Medium/Strong	Set response time
	Super Resolution	Off/Weak/ Medium/Strong	Adjust the Super Resolution of the monitor
	Black Level	0-100	Adjust display Black level
	Owl Sight	Off/Weak/ Medium/Strong	Turn Owl Sight off/on
Display	Image Ratio	Auto/16:9/4:3/21:9	Set aspect ration
Audio	Mute	On/Off	Turn Mute function off/on
	Volume	0-100	Adjust audio volume



Multi-Window	Multi-Window	Off	Select window mode of the monitor
		PIP Mode	
		PBP Mode	
	Sub Win2 Input	DP1	Select sub-windows input source
		DP2	
		HDMI1	
		HDMI2	
	PIP Size	Small	Setting the PIP size
		Medium	
		Large	
	PIP Position	Top Right	Setting the PIP position
		Top Left	
		Bottom Right	
		Bottom Left	
	Sound Source	Window1	Select Sound Source of the monitor
		Window2	
	Swap	/	Swap the PIP window
OSD	Language	English/François Español/Deutsch Italiano	Setting the OSD language
	H Position	0-100	Adjust the horizontal position
	V Position	0-100	Adjust the vertical position
	Transparency	0-100	Adjust the OSD transparency value
	Time Out	10-60	Set how long the OSD remains
	OSD Rotation	Normal/90/180/270	Adjust the OSD Rotation
Other	Adaptive Sync	On/Off	
	HDR	On/Off	
	MPRT	Off/Weak/ Medium/Strong	
	Cross	Off/Mode1/Mode2 /Mode3/Mode4	
	Reset	/	Restore to factory settings

## FreeSync

- To use this feature, ensure your hardware has FreeSync capabilities and that the graphics drivers are fully up to date.
- After connecting the monitor, you may receive a prompt to enable the feature on your computer. If you do not receive the prompt, you may need to enable the function in the graphics card menu.
- Check your graphics card manufacturer's documentation for instructions on how to turn on and/or enable FreeSync.

**Note:** The feature is enabled by default when set to a 165Hz refresh rate.

## Input menu shortcut

To quickly change the input source between HDMI and DP:

1. Press the exit/input menu button to access the input menu.
2. Press the up and down buttons to highlight the desired input source, then press the menu/select button to confirm.

## Brightness shortcut

When outside the OSD menu, press the up and down buttons to adjust the brightness.

## ECO modes

There are various pre-set colour modes suited for various use cases available on this monitor. These can be accessed using the ECO modes menu. The modes include the following:

- Standard (suitable for most activities)
- Movie (best suited when watching movies)
- RTS (best suited when playing real time strategy games)
- FPS (best suited when playing first person shooter games)
- Game (best suited for general gaming)
- Text (best suited when reading text)

# CONNECTIVITY

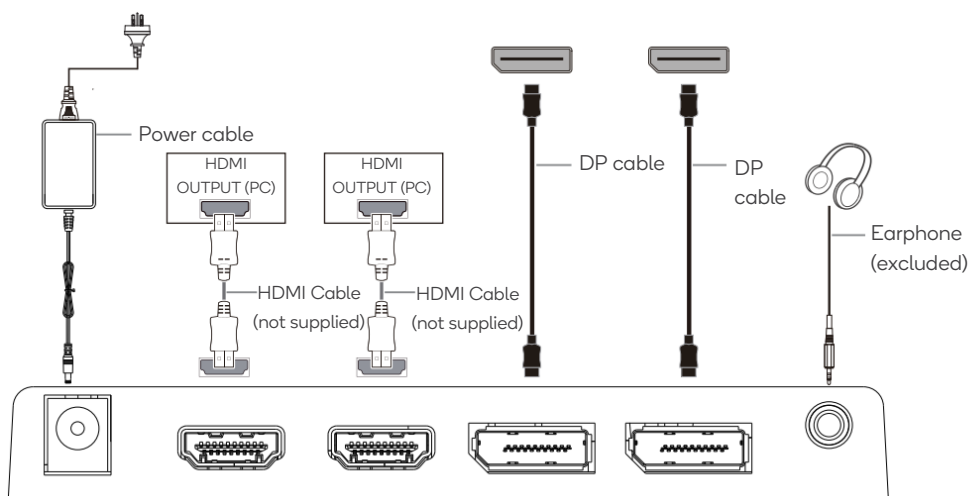
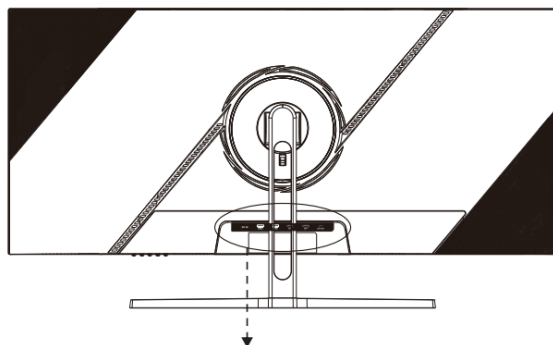

**Note:** Before connecting, ensure the display is switched off.

**Power cable**

Connect one end of the power cable into the power port on the monitor. Connect the other end into a power socket.

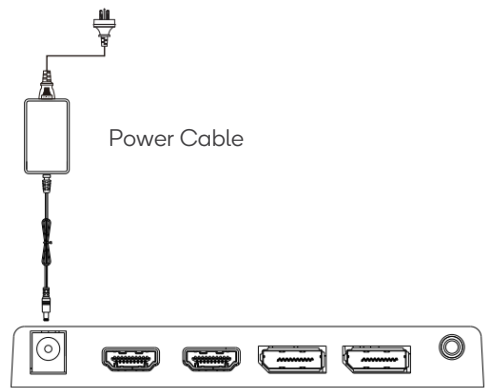

**HDMI**

- For the monitor to receive HDMI signals to your computer, plug one end of the included HDMI cable into the HDMI port on the monitor.
- Plug the other end into the HDMI port on your computer.

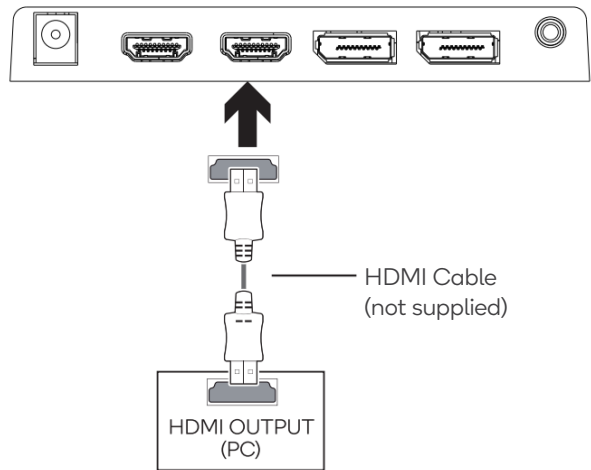

### Audio port (3.5mm)

- To receive audio signals to your computer, plug your earphones, headphones or other audio device (not included) into the 3.5mm audio port on the monitor.
- If any audio device is connected to the computer at the same time, it will not produce sound.

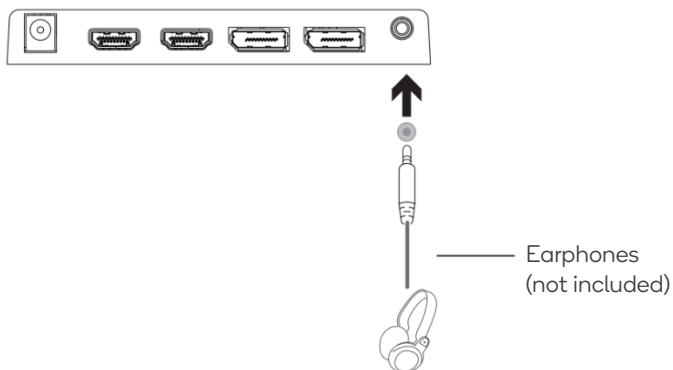

### DisplayPort (DP)

- Connect the supplied DP cable to the DP IN port at the back of the monitor.
- Plug the other end into the DP port on your computer.

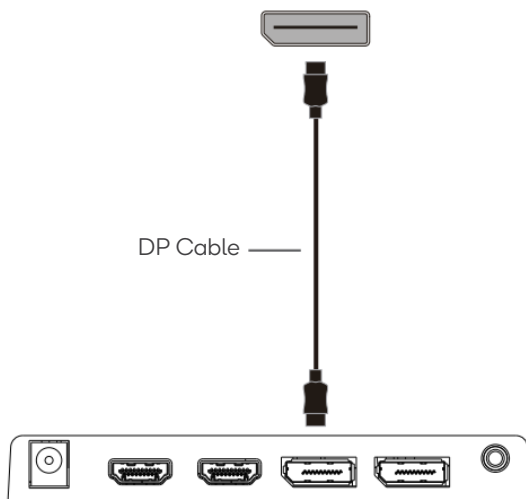

# SPECIFICATIONS

Screen size	34"
Aspect ratio	21:9
Backlight	E-LED
Brightness	300cd/m <sup>2</sup>
Panel	VA
Resolution	3440 x 1440
Refresh rate	165Hz
Response time	9ms
Viewing angle	178° (H) / 178° (V) (typical)
Contrast ratio	3000:1
VESA mounting	75 x 75mm
Colours	16.7M
FreeSync	Yes
Signal input	x2 HDMI 2.0, x2 DP1.4
Power	DC 12V, 5A
<b>Audio</b>	
Audio out	Yes
Speakers	Yes
<b>Accessories</b>	
Power cable	Yes
DP cable	Yes
<b>Additional functions</b>	
Low blue light	Yes
Flicker-free	Yes
<b>Physical dimensions</b>	
Dimensions (with stand)	807.8 x 190.4 x 434.9mm
Dimensions (without stand)	807.8 x 117.7 x 361.8mm
Net weight	5.30kg
Gross weight	7.80 kg

# CLEANING & CARE

Ensure the monitor is turned off and unplugged before cleaning.

- Wipe the body with a slightly damp, clean cloth.
- Wipe the screen with a dry microfibre cloth.

**Note:**

Do not use cleaning alcohol, ammonia-based liquids or other harsh cleaners.

### **Need more information?**

We hope that this user guide has given you the assistance needed for a simple set-up.

For the most up-to-date guide for your product, as well as any additional assistance you may require, head online to **[help.kogan.com](https://help.kogan.com)**

**kogan.com**