

# Medium wall light

## INSTRUCTIONS

### INCLUDED

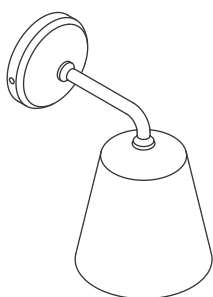

Light body x1

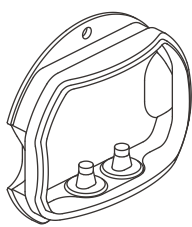

Wall mount x1

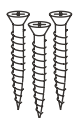

Wall screw x3

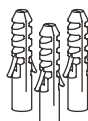

Anchor x3



2-terminal  
WAGO x1

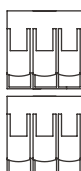

3-terminal  
WAGO x2



Hex key x1

### TOOLS YOU'LL NEED

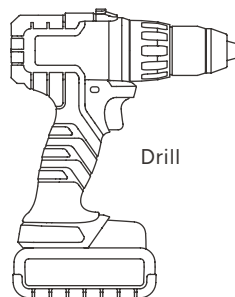

Drill



6mm drill bit



Crosshead screwdriver

## Medium wall light instructions

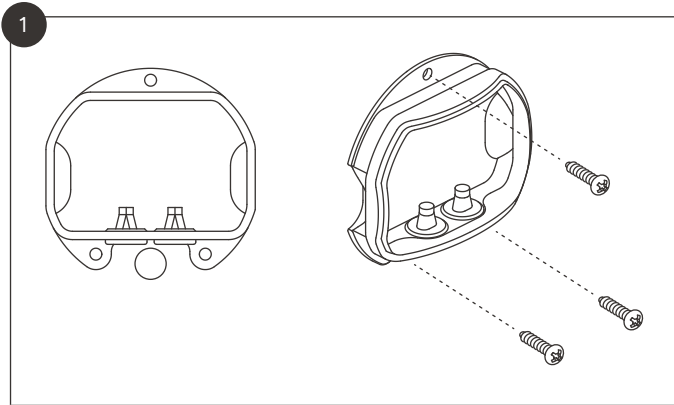

Install the wall light mount. See **page 4** for dimensions.

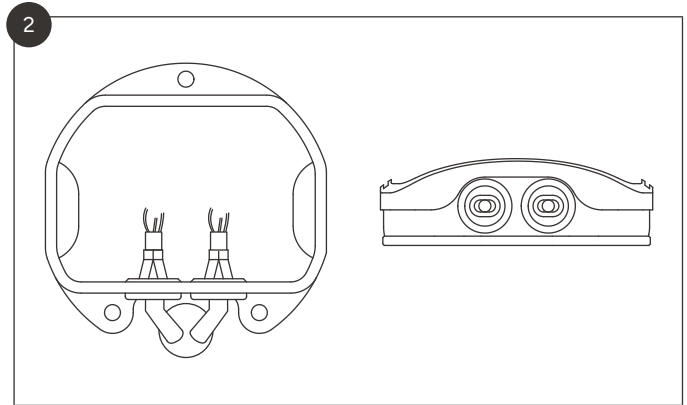

Push the wires through the grommet.

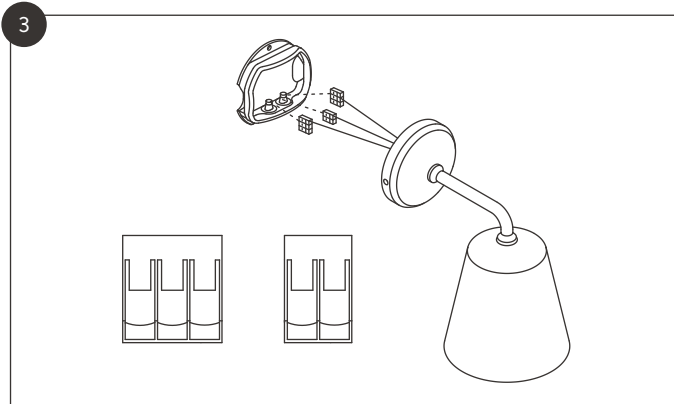

Connect the WAGOs inside the base.

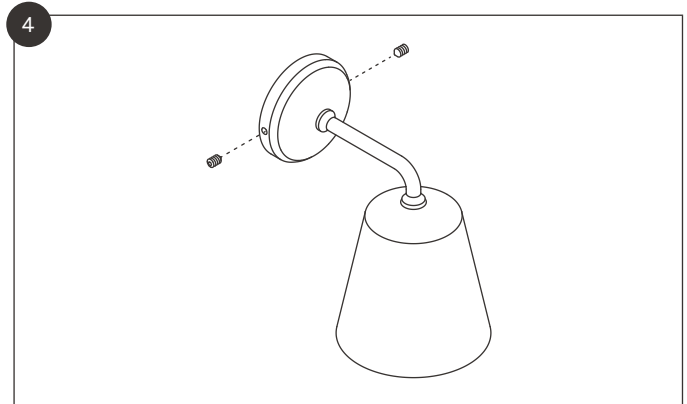

Tighten the grub screws.

## Medium wall light instructions

5

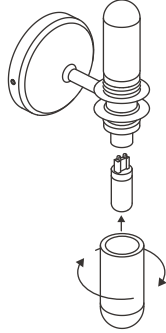

Unscrew the glass cover to fit the bulb.

**Note:** the glass cover protects the bulb in wet environments and is required for the IP rating. If the light is installed in a dry setting, you can remove the glass cover to increase the life expectancy of the bulb.

6

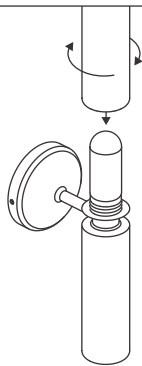

**Claremont:** screw the shade onto the body.

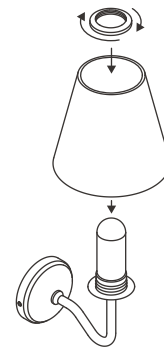

**Malvern:** use the shade ring to secure the shade.

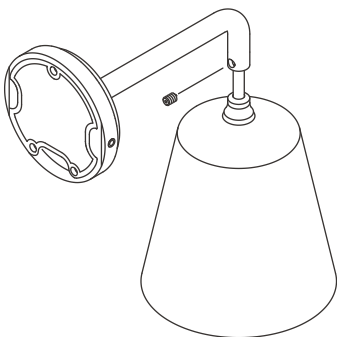

**Richmond (hanging):** use the grub screw to adjust the shade height.

