

PROFESSIONAL FLAT COFFEE GRINDER

CG301

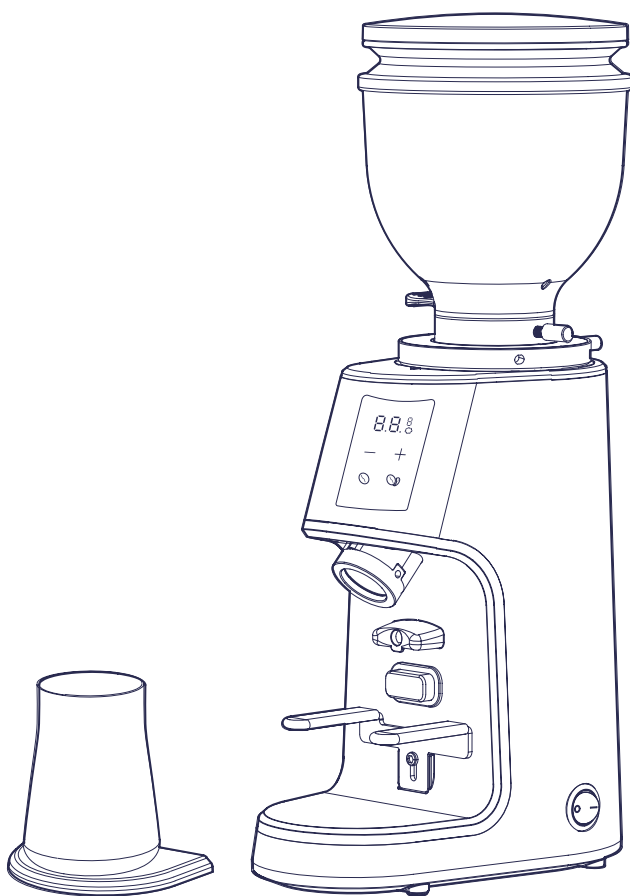

USER MANUAL

CONTENTS

■ Important Safeguards	1
■ Specification	3
■ Special Notes On Plug	3
■ Know Your Burr Grinder	4
■ Operating Your Burr Grinder	5
■ Before First Use	6
■ Operating Your New Appliance	7
■ Operating instructions	9
■ Burr Grinder Use Tips	11
■ Cleaning the Burr Grinder	12
■ Troubleshooting	13
■ Disposal	13

IMPORTANT SAFEGUARDS

Before using this product, read all instructions for use carefully and save for future reference.

1. Read all instructions before use.
2. When moving the grinder, **do not** just hold the hopper! Please hold the machine body with your hand!
3. To prevent fire, electric shock and personal injury, **do not** immerse the cord, plug or body in water or other liquids.
4. This product should **not** be operated by children or persons with mobility impairments; except under the close supervision of a competent adult who can ensure that they can operate it safely.
5. The plug must be removed from the socket when **not** in use, before installing or removing parts and before cleaning the machine. To unplug, grasp the plug and pull it from the electrical outlet, **do not** pull the power cord to unplug.
6. **Do not** operate the product if the power cord or plug is damaged, or if the unit malfunctions. and return the equipment to an approved service center for inspection and repair.
7. Use of non-original approved parts may result in fire, electric shock or injury.
8. **Do not** use the product outdoors, on moving vehicles, boats, or airplanes. do not use the product on an inclined table.
9. **Do not** allow the power cord to hang over the edge of a table or cabinet, or connect to any surface with a heat source, or allow the power cord to become tangled.
10. Check the bean cups for foreign objects before use.
11. Be sure to operate the product with the lid of the bean cup closed.
12. **Do not** place the machine on or near a gas or electric burner or in a heated oven.
13. This product is designed for home use only. Any commercial use, improper use or failure to follow instructions will void the warranty.
14. Avoid contact with moving parts and **do not** attempt to defeat any safety interlock mechanisms.
15. This product is designed to be used only for coffee beans that have already been roasted. **Do not** use the appliance for any other purpose (e.g. hard seeds, herbs, nuts, etc.) as this may damage the machine.
16. All machines are rigorously inspected before leaving the factory and tested with coffee beans for actual grinding, which may result in slight traces of use or coffee residue.

17. When in use, the coffee beans should **not** exceed the maximum "MAX" scale of the bean box.
18. If the power supply cord is damaged, it must be replaced by the manufacturer, its service department or a professional from a similar department in order to avoid danger.

SAVE THESE INSTRUCTIONS

HOUSEHOLD USE ONLY

Specification

Rated Voltage	120V~
Frequency	60Hz
Wattage	260W

Special Notes On Plug

This appliance incorporated a polarized plug (one blade is wider than the other). To reduce the risk of electric shock, this plug will fit in a polarized outlet only one way. If the plug can not fit fully into the socket, reverse the plug. If it still does not fit, contact a qualified electrician. Do not attempt to modify the plug in any way as this is a safety feature.

Know Your Burr Grinder

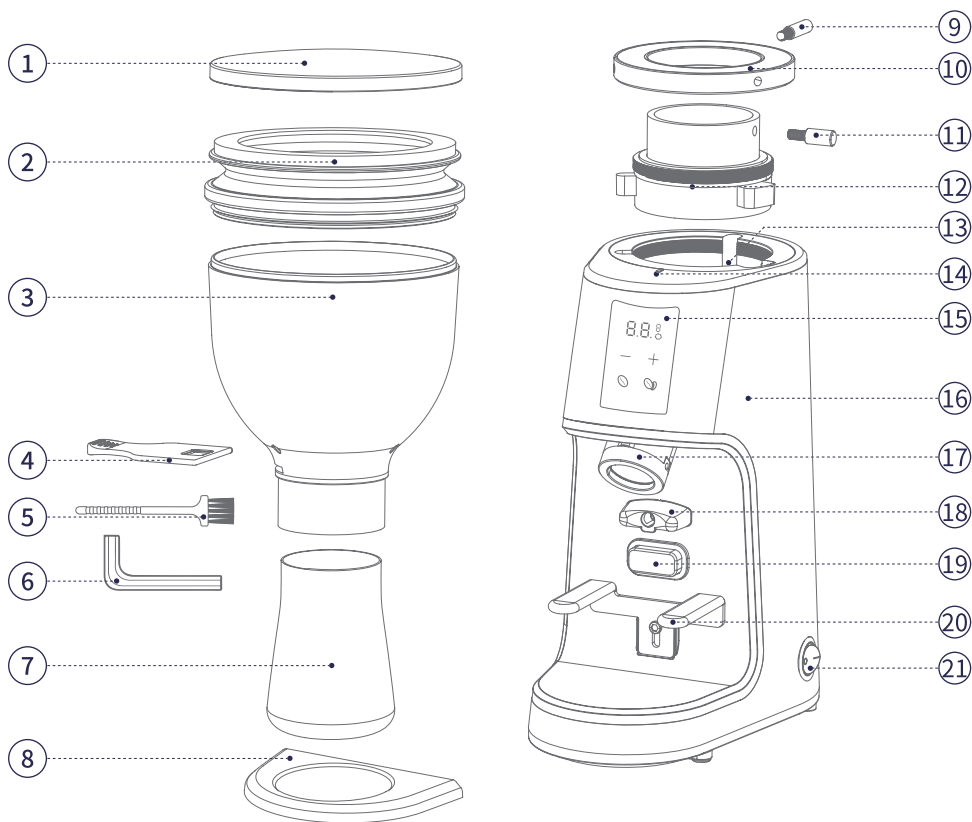

1 Bean Hopper Lid

2 Grounds Duster

3 Bean Hopper

4 Trap Door

5 Brush

6 Hexagon Spanner

7 Stainless Steel Cup

8 Silicone Pad

9 Hand-Lock Screw

10 Grind Size Selector

11 Hand-Lock Screw

12 Upper Burr Assembly

13 Grinding Room

14 Scale Point

15 Control Panel

16 Grinder Body

17 Grounds Chute

18 Filter Module

19 Start/Stop Switch

20 Portal Filter Bracket

21 On/Off Switch

+ Grinding Time Increase Button

- Grinding Time Decrease Button

Single Shot Button





Double Shot Button

8.8.8 Grinding Time Digits

Operating Your Burr Grinder

BURR GRINDER OVERVIEW

Your Burr Grinder has 100 unique grind size settings that are suitable for a range of brewing methods, from the finest setting for espresso to the coarsest setting for French press. By adjusting the Time Buttons, you can choose maximum 30 seconds for a single cup, 60 seconds for a double cup,grinding time accurate to 0.1 seconds.

	Espresso	Moka	Americano	Cold brew Pour Over	French Press
Coffee Type					
Coarseness	Fine	Slight fine	Middle coarse	Slight coarse	Coarse
Setting	1-20	20-40	40-60	60-80	80-100

Note: Above info as reference, grinding coarseness should be adjusted according to actual coffee bean type and taste preference.

Note: The **Bean Hopper** holds a maximum of 9 oz (250 g) of coffee beans.

*Capacity may vary depending on coffee type and roast.

Before First Use

Remove and safely discard all packing materials attached to your product. Wash hopper, cradles, grounds container, container lid and cleaning brush in warm soapy water and dry thoroughly. Wipe exterior of grinder with a soft damp cloth and dry thoroughly. Place grinder on flat level surface and plug power cord into 120V outlet.

ENERGY SAVING FEATURE

The grinder will automatically switch off if not used for 2 minutes.

To reactivate the machine whilst in POWER SAVING/SLEEP MODE, Press Start/Stop Button.

Operating Your New Appliance

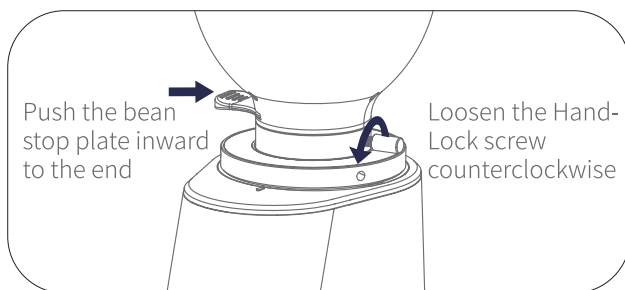

Attention before use

1. Make sure the coffee grinder is unplugged or the On/Off switch is off.
2. Make sure there are no coffee beans in the bean container.
3. Loosen the hand-lock screw counter-clockwise until the bean box can be removed upwards (Note: If there are coffee beans inside the bean container, you need to push the bean stop plate inward to the end before removing the bean hopper to prevent the coffee beans from leaking out).

TIPS: The initial position is the finest setting. Turn counterclockwise to make it coarser. Do not turn clockwise!

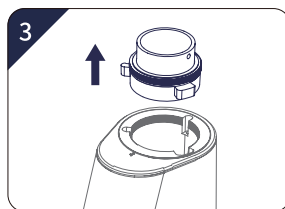
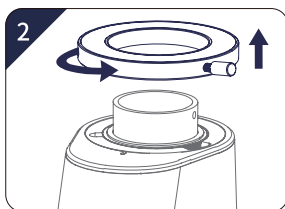
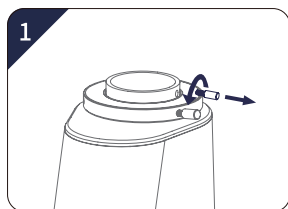

To remove the upper burr assembly

1. Unscrew the hand-lock screw counterclockwise and take out.
2. Press the upper burr assembly's center ring all the way down while rotating the scale ring counterclockwise until it comes off completely.
3. The upper burr assembly can now be taken out upwards.

NOTE: Since the upper burr assembly and the bean grinding room are precision machining, it should be taken out slowly and gently upward to avoid damage.

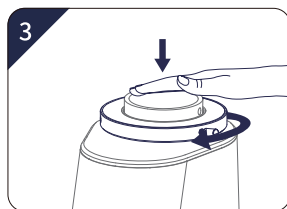
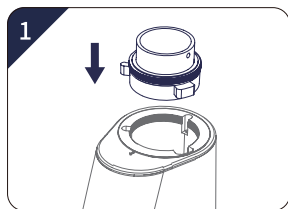

Assemble upper burr assembly, coarseness ring and bean container

1. Align the three ears of the cleaned upper burr assembly with the three slots on the bean grinding room, and slowly enter it in a smooth state.
2. Ensure that there is no residue on the screw threads and place the scale ring down onto the upper burr assembly; Keep pressing the center ring of the upper burr assembly down and rotate the scale ring clockwise until the scale ring is screwed on tightly.
3. Put the bean container on the upper burr assembly and lock the hand-lock screw clockwise tightly.

NOTE: There will be no functions once take out the upper burr assembly.

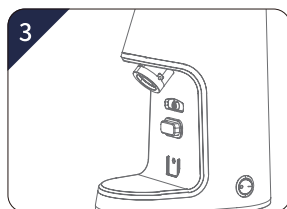
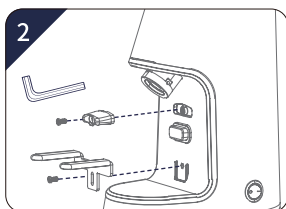
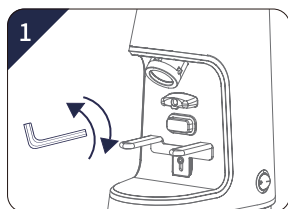

Remove and assemble the portafilter bracket and portafilter block

1. Hexagonal wrench to loosen the screws on the portafilter bracket, the height of the portafilter bracket can be adjusted up and down and tight screws, to proper height of the portafilter to better catch the coffee powder.
2. The portafilter bracket and portafilter block can be removed with the hexagonal wrench.

NOTE: In order to catch coffee powder by coffee ground jug.

Operating instructions

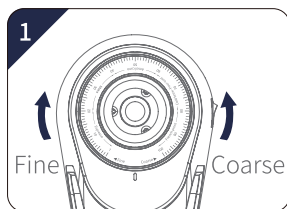

1. Rotate the Grind Size Selector (clockwise rotation for fine, counterclockwise rotation for coarse) to select the appropriate coarseness. Total 100 coarseness setting options.
When the number on the scale circle is aligned with the reference point on the top cover, it represents the coarseness setting selected.

Note: When there are remaining coffee beans or coffee ground in the grinding room, it is not possible to adjust to be finer; only when the grinding room is clean or when it is grinding, it can be adjusted to be finer. In order to adjust the coarseness of the coffee ground more precisely, it is recommended to rotate the bean cup at the same time to adjust the coarseness while the machine is starting up.

2. Put the right amount of coffee beans into the bean box, the coffee beans should not exceed the MAX level. Pull the Trap Door and the coffee beans fall automatically into the grinding room. Grinding time increase button: (+); Grinding time decrease button: (-);
Single shot button: (S); double shot button: (D); grinding time digits: 8.8.8



After the power cord is plugged in, press the On/Off switch, the grinder beeps for one time, the display shows default setting.

Grind Operation



Single-shot grinding operation: touch the single-shot grinding button. The default time display shows 10 seconds, you can touch the time increase/decrease button "+" "-" to adjust the time, the time range is 0-30 seconds. Press the start/stop switch to start grinding till display shows 0 or Press the start/stop switch again to stop grinding. Single shot light turn to be orange, other button light up. Time indicate 10s, Grinding time is kept in memory when work next time, even in the situation after power off.



Double-cup grinding operation: touch the double-shot grinding button. The default time display shows 20 seconds, you can also touch the time increase/decrease button "+" "-" to adjust the time, the time range is 20 to 60 seconds. Press the start/stop switch to start grinding till display shows 0 or Press the start/stop switch again to stop grinding. Double shot light turn to be orange, other button light up. Time indicate 20s, Grinding time is kept in memory when work next time, even in the situation after power off.

NOTE: Grinder has grinding time memory function. It will memorize the time if the cycle is finished.

Manual mode: Press single shot and double shot buttons   at the same time for 2 S; Display shows: 

Single shot and double shot light up white at the same time. Press start/stop button, both single shot and double shot light dim. Single shot and double shot light up at the same time when finish grinding for 60 seconds, or press again ON/OFF switch to stop grinding. Single shot and double shot light up at the same time, Press any buttons to quit manual mode.

Restore default setting: press time increase and time decrease buttons   at the same time for 2 seconds.

Turn on/off buzzer: Press time increase button and double shot button   at the same time for 2 seconds to turn on or turn off the buzzer.

Protection: Max cumulative grinding time is 30 minutes. If it keeps grinding for 30 minutes, the display show show "E2". The grinder enters into protection mode. Stop for 10 minutes it will recover.

Note: Continuous grinding is cumulative if the time between each break is less than 10 minutes.

Burr Grinder Use Tips

- Fresh ground coffee is the key factor in making delicious coffee.
- The flavor and strength of the coffee can be adjusted to your personal preference by varying the type of beans, the amount of coffee, and the fineness of the grind to achieve the desired taste.
- It is best to use fresh coffee beans labeled with the date of roasting.
- Store your coffee beans in a cool, dry environment that is protected from light.
- Vacuum-pack, if possible.
- Purchase beans in small batches to minimize storage time, preferably less than a week at a time.
Once ground, coffee beans quickly lose their aromatic flavor. For the best brewing results, make coffee immediately after grinding.
- Do not store coffee beans in the bean cup for long periods of time.
- When storing the machine after use, run the machine to finish grinding the remaining coffee beans and clean the machine.

Cleaning the Burr Grinder

NOTE:

Unplug the Burr Grinder before cleaning.

Regularly clean the grinding room and the outlet tube will prolong the life of the grinder, in addition to maintaining serving hygiene.

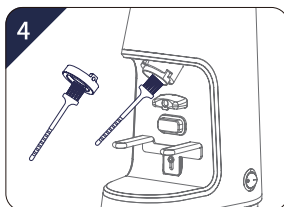
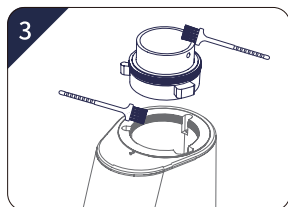
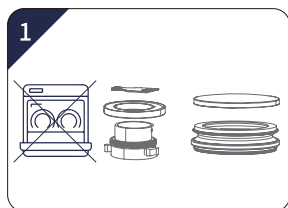

1. Do not put it in the dishwasher. The Bean hopper, Bean hopper lid, Grounds container, Grounds container lid, brush can be cleaned with warm, soapy water, then rinse with clean water and dry thoroughly.
2. Wipe clean the main body with a soft, damp cloth. Dry thoroughly with a soft dry cloth.
3. Take out bean container and coarseness ring, use brush to clean the blades and grinding room.
4. Take out the outlet tube and clean internally with the brush.

Troubleshooting

Problem	Solution
No coffee ground output	Bean stop plate was not pull out. Pull the bean stop plate to the end.
Not work	Not plug on or on/off switch is on off status. Plug in and turn the on/off switch on.
Not work	Coarseness ring was not assembled to position. Tighten the coarseness ring.
Not work	Motor PTC protection. Unplug the power cord, wait for 10mins.
E1	1. The dial is not in place. Properly reattach the dial. 2. The grinder has overheated. Please remove power plug from power outlet. Leave for 10 minutes to cool down before using again.
E2	Program protection(30min). Unplug the power cord, wait for 10mins.

If your problem is not listed, please contact Customer Support at



support@shardor1.com

Disposal

This product should not be disposed of with other household wastes. To prevent possible harm to the environment or human health from uncontrollable waste disposal, it should be recycled responsibly.

Thank you for purchasing the **Coffee Grinder**