

Unpacking and Setup

IMPORTANT: Read the Operator's manual thoroughly, and follow safe operating practices.

WARNING: When working with the product, wear the required personal safety equipment.

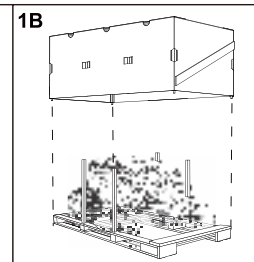
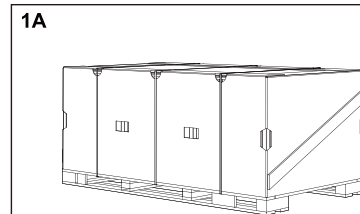

1. OPENING THE PACKAGING

The machine is shipped partially dismantled and packaged in a metal crate to protect it during transport. The packaged machine will appear as in Fig 1A.

- Remove all shrink wrap and cut the two plastic straps that surround the package.
- Lift off the corrugated exterior cover assembly and discard the four wooden support posts. (Fig 1B)

NOTE WEAR HEAVY GLOVES.

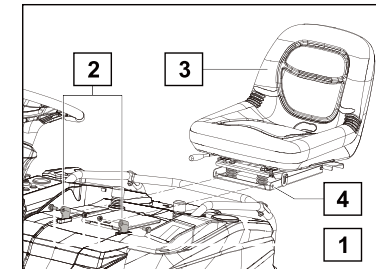

2. MOUNT THE SEAT

- Remove the two nuts and bolt (1) from mower's mounting brackets (2).
- Place the Seat (3) on top of springs and align the holes on the seat's mounting bracket (4) with the holes in mower's mounting brackets (2).
- Reinsert the two nuts and bolt (1) and tighten. Test that Seat rotates upwards towards the steering wheel.

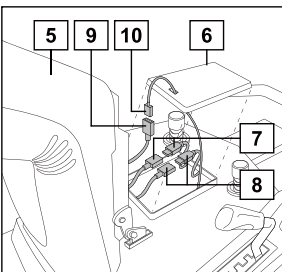

3. CONNECT BATTERY AND OPERATOR PRESENCE SWITCH

- Lift the Seat (5) and remove the Battery Compartment Lid (6).
- Connect the RED Positive Wire Connectors (7) and the BLACK Negative Wire Connectors (8).
- Connect the Wire Harness (9) to the Operator Presence Switch (10) under the seat.
- Replace Battery Compartment Lid (6)

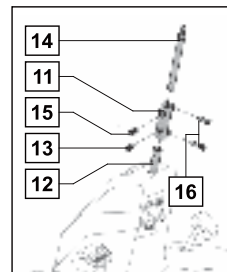

4. MOUNT THE STEERING COLUMN

- Mount the Coupler (11) onto the mower's Steering Shaft (12) using screw M8 x 20 (13).
- Insert the Steering Column (14) into the Coupler (11) and fasten with screw M8 x 20 (15).
- Complete assembly by tightening the screws M8 x 20 (16).

NOTE THE SCREWS FOR THIS ASSEMBLY ARE TYPICALLY FOUND INSTALLED IN THE COUPLE.

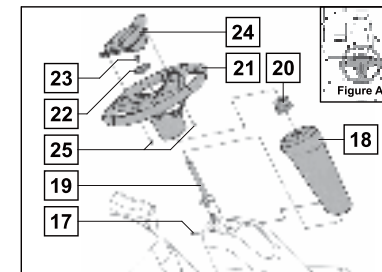

5. MOUNTING THE STEERING COLUMN COVER AND STEERING WHEEL

- Remove the Column Cover Screw M6 X 25 (17) from the bucket nut mounted onto the Column Cover (18).
- Slide the Column Cover (18) over the Steering Column assembly (19). Reinsert and tighten Column Cover Screw M6 X 25 (17).
- Insert the Splined Hub (20) onto the Steering Column assembly (19). Mount the Steering Wheel (21), Spacer (22), and secure assembly with Nut M8 (23).
- Insert Steering Wheel Cover (24) into the Steering Wheel (6) and secure with two Screws (25) (Screws are typically found installed in the Steering Wheel Cover).

NOTE BE SURE TO ALIGN DIRECTION OF STEERING WHEEL AS SHOWN IN FIGURE A.

IMPORTANT AFTER INSTALLING THE STEERING WHEEL AND SEAT, INCREASE THE TRACTOR'S CUTTING DECK HEIGHT TO ITS MAXIMUM LEVEL.

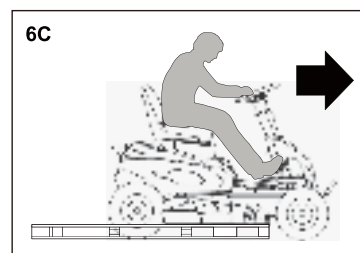
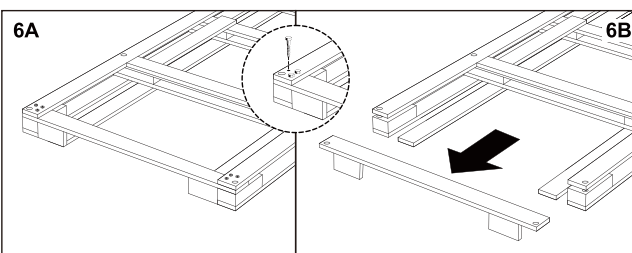

6. DRIVE RIDING MOWER OFF THE PALLET

- After installing the steering wheel and seat, increase the tractor's cutting deck height to its maximum level.
- Remove the six bolts near the front of riding mower's pallet (Fig 6A) and remove the wooden cross plank from the base pallet. (Fig 6B).
- Follow the instructions in section CONTROLS AND STARTUP and carefully drive the Riding Mower forward off the wooden base platform. (Fig 6C)



Get the most out of your PRORUN equipment, scan the QR code for helpful instructional videos, quick-start guides, manuals, parts lists, and more.

NEED HELP? Call PRORUN Customer Service at 704-698-8036 (toll-free), or email info@proruntech.com.

300*195