



EVEO Dual Monitor Mount

Installation guide

Required before installation



It's important to paste Anti-slippery protective pads to prevent accidental damage to your belongings.

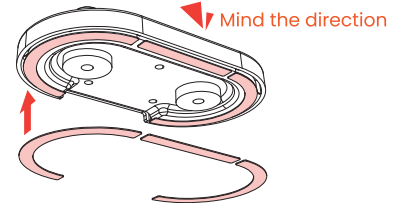
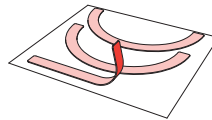

Peel the anti-slippery protective pads off, stick them on the base.

1. Setup the base

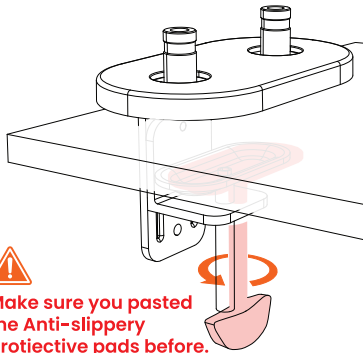

Clamp the base on the table and fix it in place.

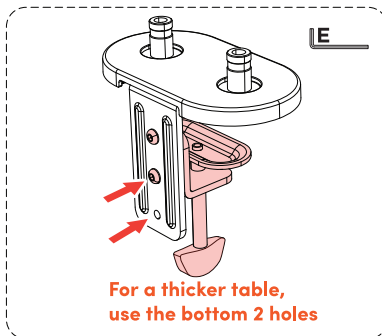

2. Arms and Monitors

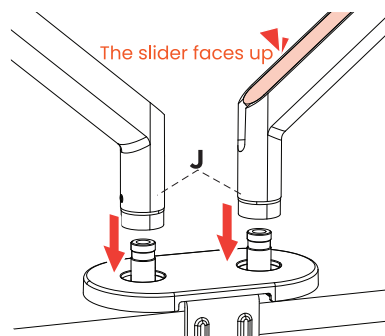

Place the lower arms and the upper arms.

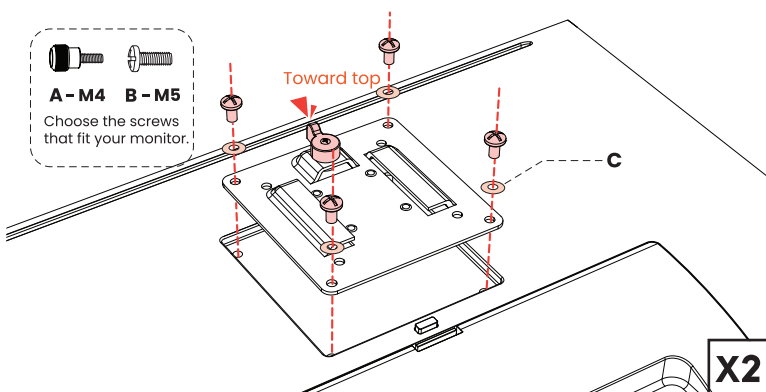
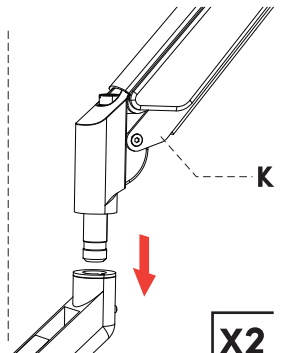

Attach the VESA plates on your monitors.

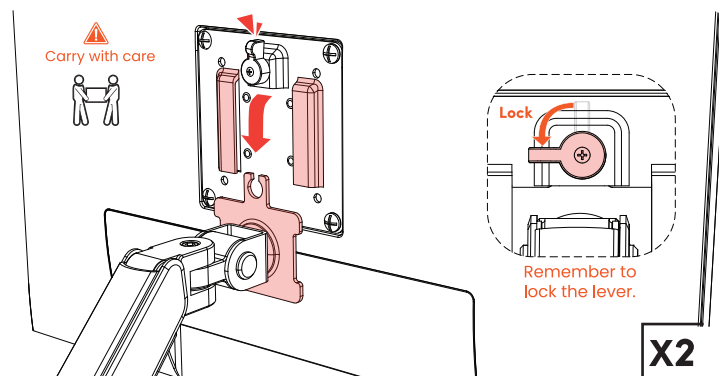

Attach the monitor to the arm and turn the lock.

3. Adjustments

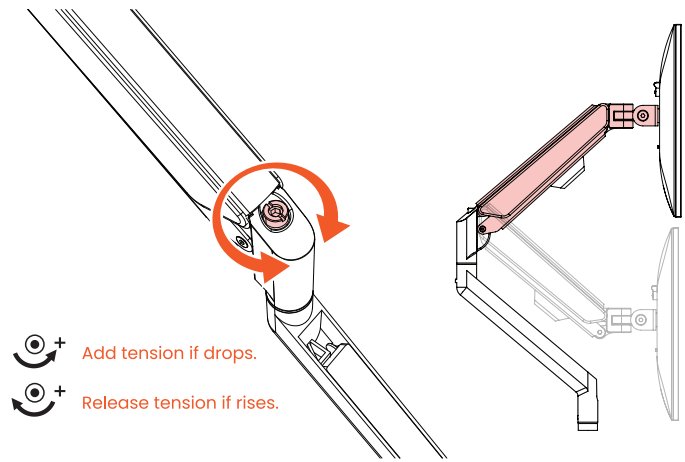

Adjust the tension by turning the screw.

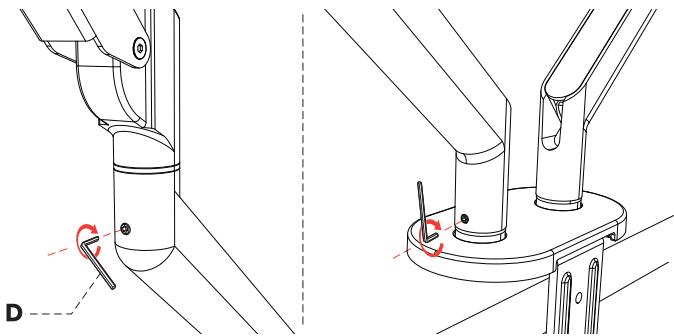

Tighten the screw to lock the rotation if needed.

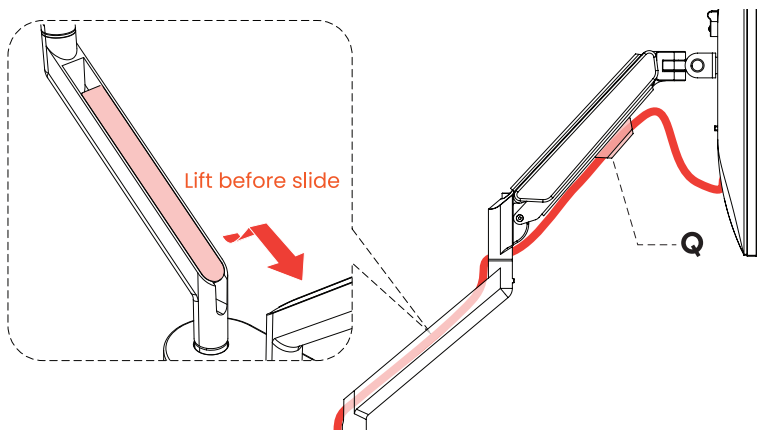

Attach the cable managing parts and let the cables

Grommet Installation (Optional)

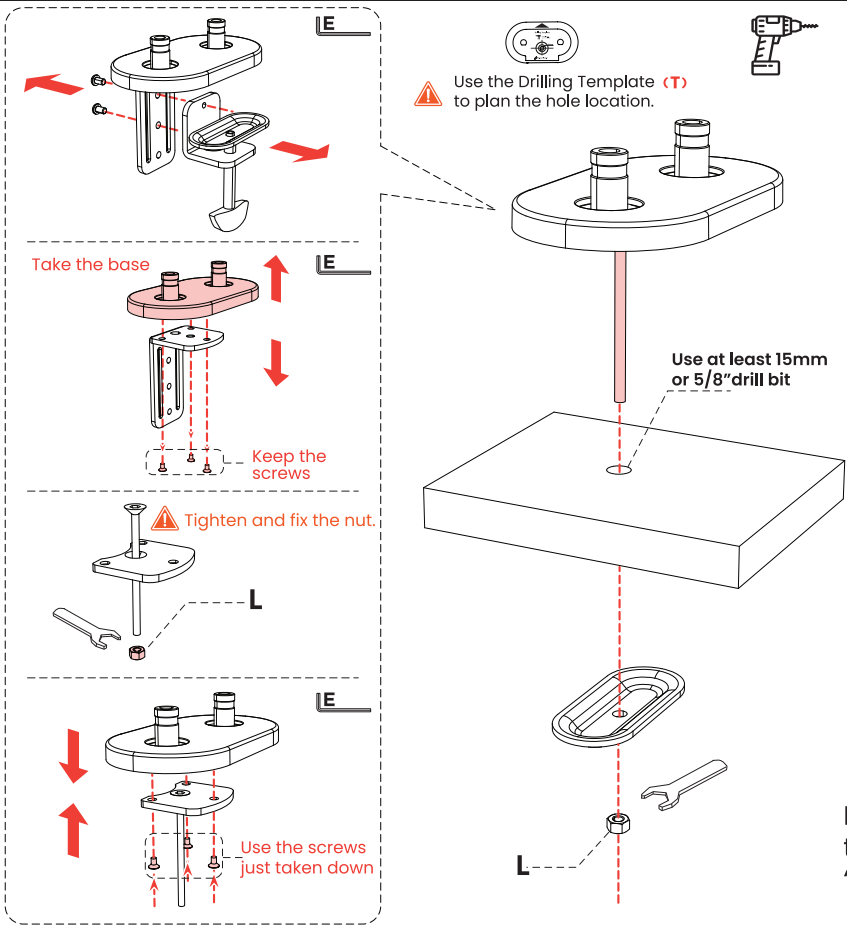

Fix the base through the hole. Then follow "2. Arms & Monitors".