

User Manual ZBMINIL2-E (EN)

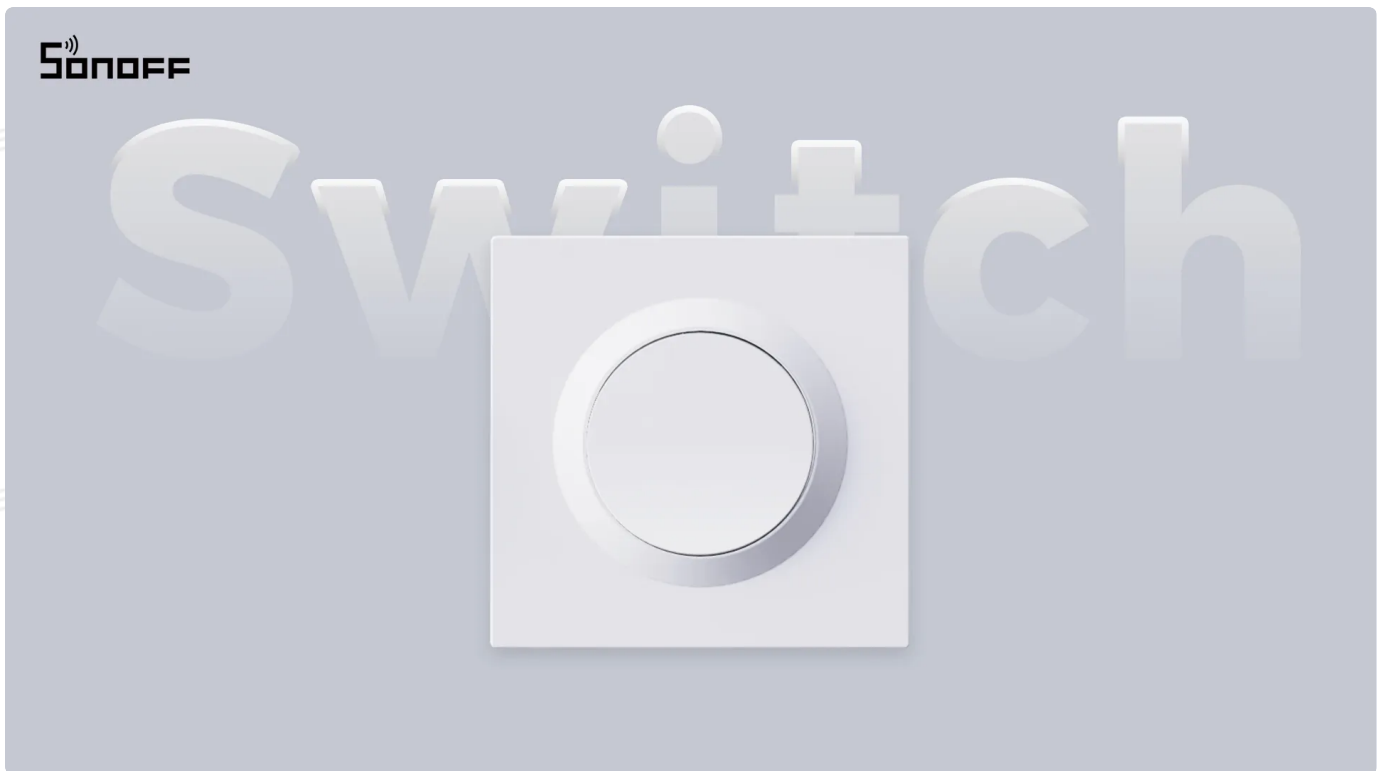

Zigbee Smart Wall Switch (No Neutral Required)

User Manual V1.0

Introduction

A Zigbee 3.0 1-gang smart wall switch, using no neutral-required wire mode, supports up to 6A load. It allows you to customize the on/off schedule and can also be integrated with other SONOFF devices in a smart scene, enabling your home automation.



Remote Control



No Neutral Wire
Required



Smart Schedule



Smart Scene

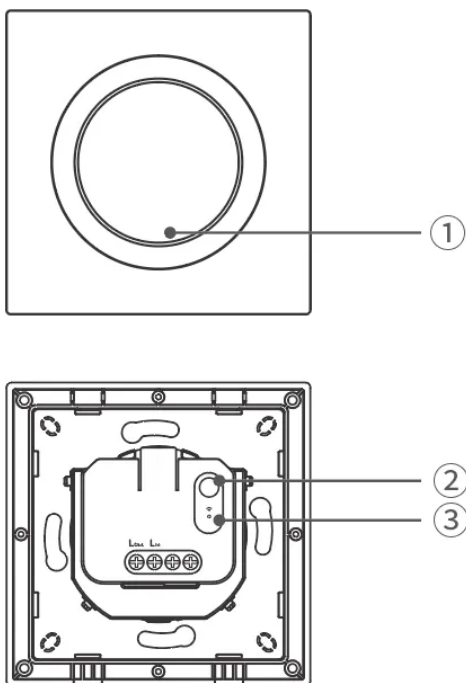

① Switch Button

- Single press: Turn on/off the smart device
- Quickly execute 5 "ON → OFF" cycles: Device enters the pairing mode. (Pairing time 3 minutes)

② Device Button

- Press and hold for 5 seconds: Device enters the pairing mode. (Pairing time 3 minutes)
- Press three times quickly: Switch external switch type.

③ LED indicator (Green)

- Slow flash (when the relay is in the off state): Device is in pairing mode.
- Keeps on (when the relay is in the open state): Connected to the gateway normally.
- Fast flash (when the relay is in the on state): Network connection abnormal, Orb-ZBW1L is connected to the parent device normally, but the router is disconnected from the gateway.
- Slow flash (when the relay is in the on state): Network connection abnormal, Orb-ZBW1L is disconnected from the parent device.

Platform Certification



Specification

Product name	Orb-ZBW1L
Product series	Fusion series
Product type	Zigbee smart wall switch (No neutral required)

Model	ZBMINIL2-E
MCU	EFR32MG22
Rating	100-240V~ 50/60Hz 6A Max Resistive load μ
LED	150W Max@100V, 300W Max@240V
Max. load	1440W
Min. load	3W
Wireless connectivity	Zigbee 3.0
Net weight	80g
Product dimension	86x86x35.8mm
Color	White
Casing material	PC
Diameter of wiring (recommend)	16AWG to 14AWG SOL/STR copper conductor only
Applicable place	Indoor
Working temperature	10T40 (-10°C~40°C)
Working humidity	5-95%RH, non-condensing
Certification	CE/RoHS

Installation

1. Power off

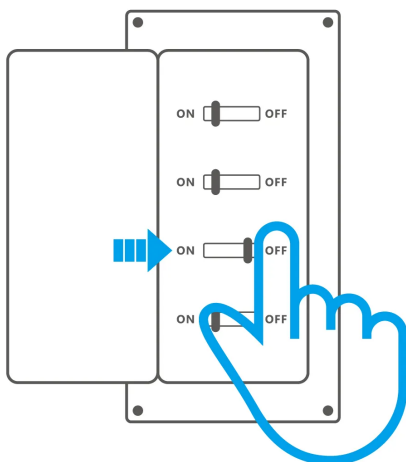

WARNING

Please install and maintain the device by a professional electrician. To avoid electric shock hazards, do not operate any connection or contact the terminal connector while the device is powered on!

2. Wiring instruction

- ⓘ To ensure the safety of your electrical installation, it's essential that either a Miniature Circuit Breaker (MCB) or a Residual Current operated Circuit-breaker with Integral Overcurrent protection (RCBO) with an electrical rating of 6A has been installed before the ZBMINIL2-E.
- ⓘ Make sure all wires are connected correctly.

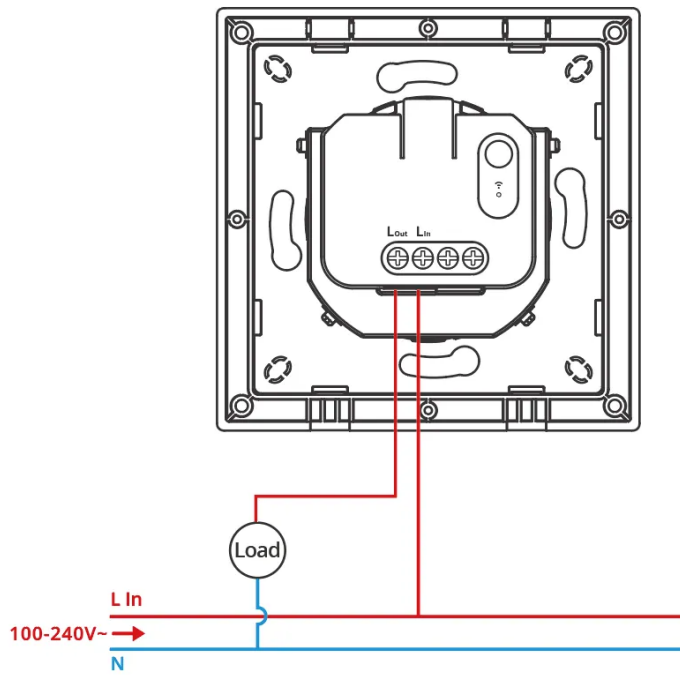

Instructions for wiring symbols

Terminals		Wire	
L In	Live Line	L In	Live Line (100–240V~)
L Out	Live Output Terminal (100–240V~)		

3. Power on

After powering on, the device will enter the pairing mode defaulted during the first use and the LED signal indicator will "flash slowly".

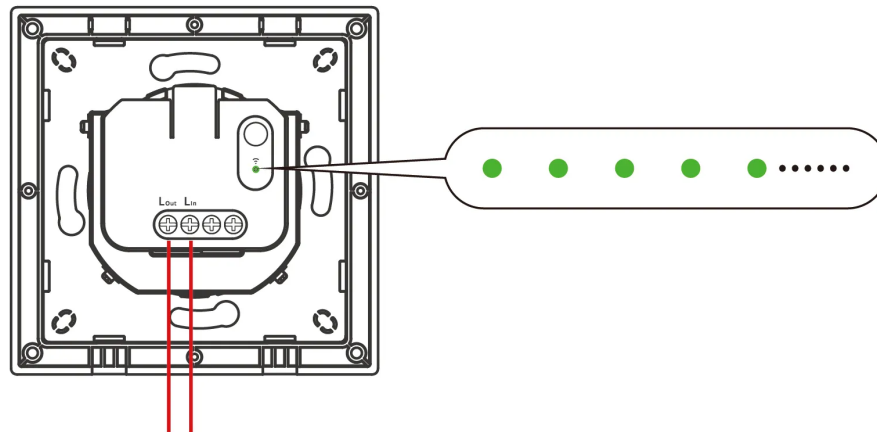

ⓘ The device will exit the pairing mode if you do not operate it within 3mins. When you want to enter the pairing mode again, long press any button on the device for 5 seconds until the signal light "flashes slowly" and release.

ⓘ The device will remain in the off state and cannot be controlled by the device's button or external switch when it is in Pairing Mode.

Add Device

① Download the eWeLink App

Please download the "eWeLink" App from Google Play Store or Apple App Store.

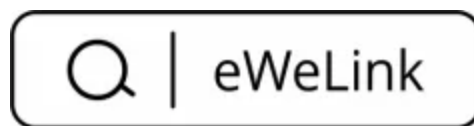

② Add SONOFF Zigbee Gateway

③ Network Configuration

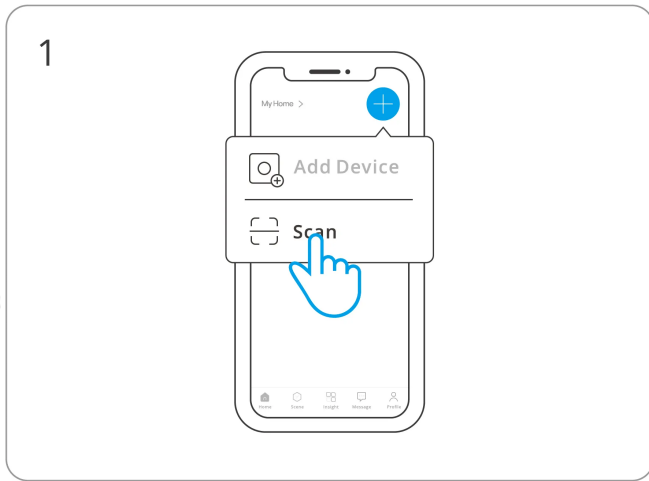

Enter "Scan"

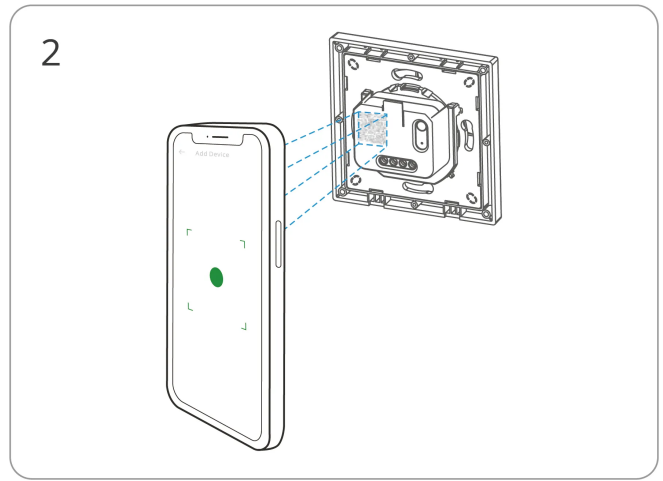

Scan the QR code on the device

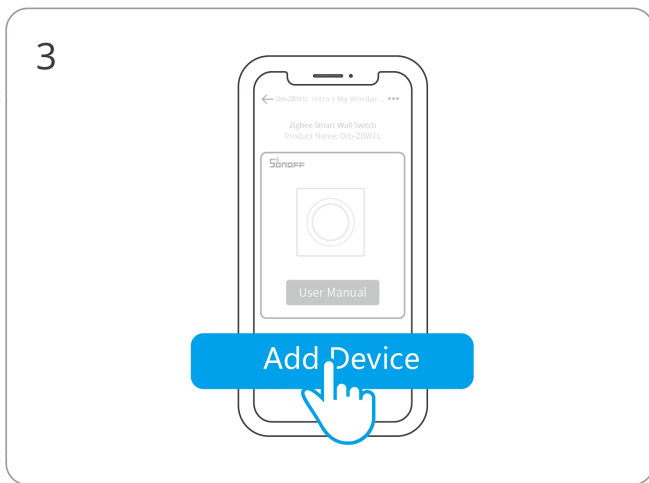

Select "Add Device"

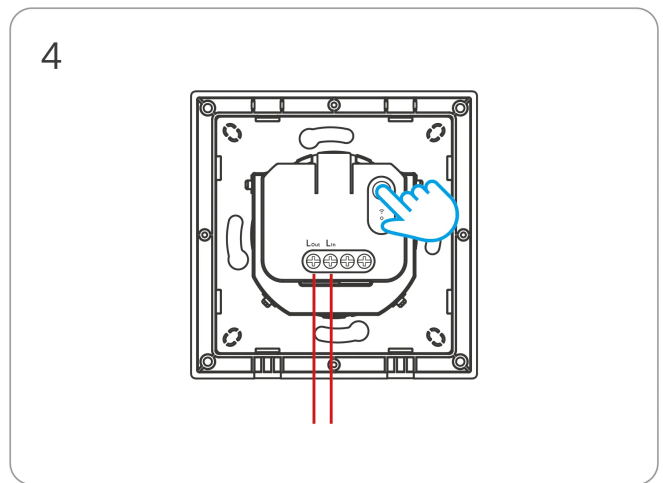

(If the device exits pairing mode)

Long press the button for 5 seconds

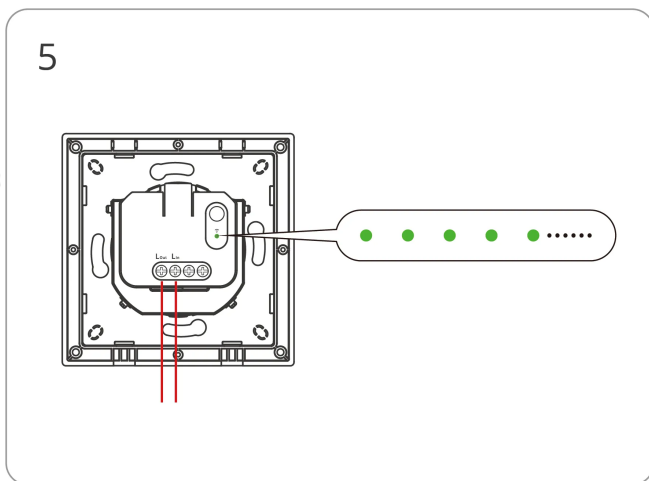

Check LED indicator flashing status (Slow flash)

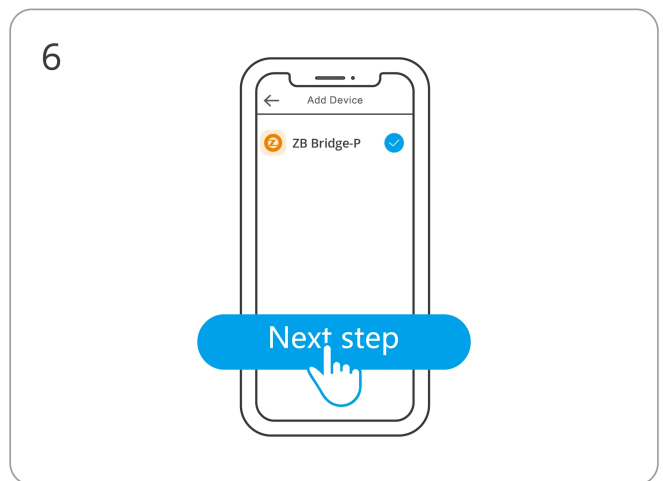

Select Zigbee gateway

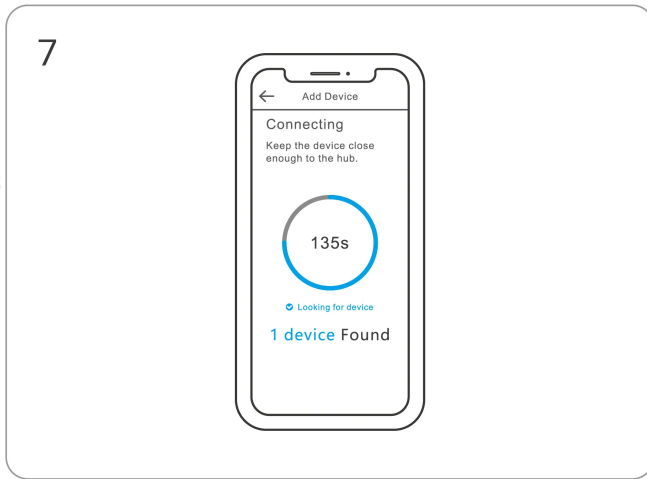

Wait until the addition is done.

Compatible SONOFF Gateways

Recommended SONOFF gateway models: ZBBridge-P, ZBBridge-U, NSPanel Pro, iHost.

Other compatible SONOFF gateway models: ZBDongle-P, ZBDongle-E.

Installation

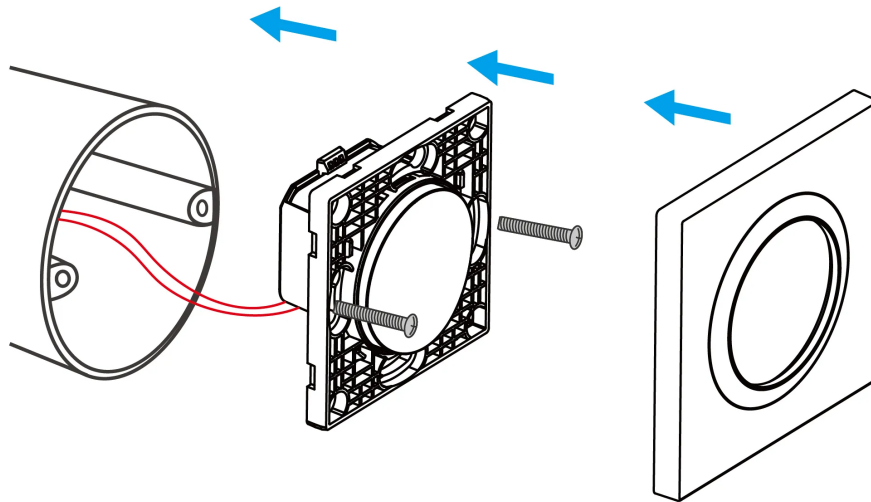

Factory Reset

Trigger conditions (any one condition met)

- Press and hold the device button for 5 seconds.

- Quickly perform 5 cycles of "ON→OFF".
- Delete the device on eWeLink.

EU Declaration of Conformity

Hereby, Shenzhen Sonoff Technologies Co., Ltd. declares that the radio equipment type ZBMINIL2-E is in compliance with Directive 2014/53/EU. The full text of the EU declaration of conformity is available at the following internet address: <https://sonoff.tech/compliance/>

For CE Frequency

EU Operating Frequency Range:

Zigbee: 2405–2480MHz

EU Output Power:

Zigbee≤10dBm

WEEE Disposal and Recycling Information



WEEE Disposal and Recycling Information All products bearing this symbol are waste electrical and electronic equipment (WEEE as in directive 2012/19/EU) which should not be mixed with unsorted household waste. Instead, you should protect human health and the environment by handing over your waste equipment to a designated collection point for the recycling of waste electrical and electronic equipment, appointed by the government or local authorities. Correct disposal and recycling will help prevent potential negative consequences to the environment and human health. Please contact the installer or local authorities for more information about the location as well as terms and conditions of such collection points.

Warning

Under normal use of condition, this equipment should be kept at a separation distance of at least 20 cm between the antenna and the body of the user.

Dans des conditions normales d' utilisation, cet équipement doit être maintenu à une distance d' au moins 20 cm entre l' antenne et le corps de l' utilisateur.

Scatola	Manuale	Borsa	Borsa
PAP 21	PAP 22	CPE 7	LDPE 4
Carta	Carta	Plastica	Plastica
RACCOLTA DIFFERENZIATA			
Verifica le disposizioni del tuo Comune.			
Separa le componenti e conferiscile in modo corretto.			

SONOFF

Manufacturer: Shenzhen Sonoff Technologies Co., Ltd.

Address: 3F & 6F, Bldg A, No. 663, Bulong Rd, Shenzhen, Guangdong, China

ZIP code: 518000

Service email: support@itead.cc

Website: sonoff.tech

Made in China



FR

**Cet appareil et
ses accessoires
se recyclent**

À DÉPOSER
EN MAGASIN



À DÉPOSER
EN DÉCHÈTERIE



OU

Points de collecte sur www.quefairedemesdechets.fr
Privilégiez la réparation ou le don de votre appareil !

